

HomeLine
HLHW-400
Built In WiFi
Solution



HomeLine HLHW-400 Built In WiFi Solution Instruction Manual

[Home](#) » [HomeLine](#) » HomeLine HLHW-400 Built In WiFi Solution Instruction Manual 

Contents

- [1 HomeLine HLHW-400 Built In WiFi Solution](#)
- [2 Product Usage Instructions](#)
- [3 Technical data](#)
- [4 Description](#)
- [5 Installation](#)
- [6 FAQs](#)
- [7 Documents / Resources](#)
 - [7.1 References](#)

HomeLine

HomeLine HLHW-400 Built In WiFi Solution



Specifications

- Model: HomeLine Panel Heater

- Available Wattage Options: 400W, 800W, 1200W
- Heat Output:
 - Nominal Heat Output: 0.4 kW (400W), 0.8 kW (800W), 1.2 kW (1200W)
 - Minimum Heat Output: 0 kW
 - Maximum Continuous Heat Output: 0.4 kW (400W), 0.8 kW (800W), 1.2 kW (1200W)
- Auxiliary Electricity Consumption:
 - At Nominal Heat Output: N/A
 - At Minimum Heat Output: N/A
 - In Standby Mode: 0.001057 kW
- Type of Heat Input: Electric
- Type of Heat Output/Room Temperature Control: Various options available

Product Usage Instructions

Installation

1. Choose a well-insulated room for sporadic use.
2. Mount the panel heater securely on the wall.
3. Ensure proper electrical connection following local regulations.
4. Connect to a WiFi network for additional functionality.

Operation:

- Turn on the panel heater using the power button.
- Select the desired heat output level.
- Adjust any room temperature control settings as needed.
- Monitor the heater's performance and adjust settings accordingly.

Maintenance

- Regularly clean the panel heater to prevent dust buildup.
- Check for any loose connections or signs of wear and tear.
- Seek professional assistance for any repairs or technical issues.

Table VI:	Model identifier for electric local space heaters		
Model number:	HomeLine HLHW-400		
Item	Symbol	Value	Unit
Heat output			
Nominal heat out-put	P _{nom}	0,4	kW
Minimum heat output (indicative)	P _{min}	0	kW
Maximum continuous heat output	P _{max,c}	0,4	kW
Auxiliary electricity consumption			
At nominal heat output	e _{lmax}	N/A	kW
At minimum heat output	e _{lmin}	N/A	kW
In standby mode	e _{lSB}	0,001057	kW
Type of heat input, for electric storage local space heaters only (single select)			
manual heat charge control, with integrated thermostat			Yes No
manual heat charge control with room and/or outdoor temperature feedback			Yes No
electronic heat charge control with room and/or outdoor temperature feedback			Yes No
fan assisted heat output			Yes No
Type of heat output/room temperature control (single select)			
single stage heat output and no room temperature control			Yes No
Two or more manual stages, no room temperature control			Yes No
with mechanic thermostat room temperature control			Yes No
with electronic room temperature control			Yes No
electronic room temperature control plus day timer			Yes No
electronic room temperature control plus week timer			Yes No
Other control options (multiple selections possible)			
room temperature control, with presence detection			Yes No
room temperature control, with open window detection			Yes No
with distance control option			Yes No
with adaptive start control			Yes No
with working time limitation			Yes No
with black bulb sensor			Yes No

Table VI:	Model identifier for electric local space heaters		
Model number:	HomeLine HLHW-800		
Item	Symbol	Value	Unit
Heat output			
Nominal heat out-put	P _{nom}	0,8	kW
Minimum heat output (indicative)	P _{min}	0	kW
Maximum continuous heat output	P _{max,c}	0,8	kW
Auxiliary electricity consumption			
At nominal heat output	e _{lmax}	N/A	kW
At minimum heat output	e _{lmin}	N/A	kW
In standby mode	e _{lSB}	0,001057	kW
Type of heat input, for electric storage local space heaters only (single select)			
manual heat charge control, with integrated thermostat			Yes No
manual heat charge control with room and/or outdoor temperature feedback			Yes No
electronic heat charge control with room and/or outdoor temperature feedback			Yes No
fan assisted heat output			Yes No
Type of heat output/room temperature control (single select)			
single stage heat output and no room temperature control			Yes No
Two or more manual stages, no room temperature control			Yes No
with mechanic thermostat room temperature control			Yes No
with electronic room temperature control			Yes No
electronic room temperature control plus day timer			Yes No
electronic room temperature control plus week timer			Yes No
Other control options (multiple selections possible)			
room temperature control, with presence detection			Yes No
room temperature control, with open window detection			Yes No
with distance control option			Yes No
with adaptive start control			Yes No
with working time limitation			Yes No
with black bulb sensor			Yes No

Table VI:	Model identifier for electric local space heaters		
Model number:	HomeLine HLHW-1200		
Item	Symbol	Value	Unit
Heat output			
Nominal heat out-put	P _{nom}	1,2	kW
Minimum heat output (indicative)	P _{min}	0	kW
Maximum continuous heat output	P _{max,c}	1,2	kW
Auxiliary electricity consumption			
At nominal heat output	e _{lmax}	N/A	kW
At minimum heat output	e _{lmin}	N/A	kW
In standby mode	e _{lSB}	0,001057	kW
Type of heat input, for electric storage local space heaters only (single select)			
manual heat charge control, with integrated thermostat			Yes No
manual heat charge control with room and/or outdoor temperature feedback			Yes No
electronic heat charge control with room and/or outdoor temperature feedback			Yes No
fan assisted heat output			Yes No
Type of heat output/room temperature control (single select)			
single stage heat output and no room temperature control			Yes No
Two or more manual stages, no room temperature control			Yes No
with mechanic thermostat room temperature control			Yes No
with electronic room temperature control			Yes No
electronic room temperature control plus day timer			Yes No
electronic room temperature control plus week timer			Yes No
Other control options (multiple selections possible)			
room temperature control, with presence detection			Yes No
room temperature control, with open window detection			Yes No
with distance control option			Yes No
with adaptive start control			Yes No
with working time limitation			Yes No
with black bulb sensor			Yes No

Thank you

- Thank you very much for choosing a Homeline device. You have made a good choice! We hope you will be satisfied about its functioning.
- To get maximum profit from your product, it is important to read this manual attentive and totally before use, and to understand what is written. Read especially the safety instructions: they are there to protect you and your environment.
- Keep the manual in a safe place for future reference. Store also the package: that is the best protection for your product in times of no-use. And if you at any time pass the appliance on, pass on the manual and package too.
- We wish you a lot of fun with the Homeline!
- This manual has been complied with the utmost care. Nevertheless, we reserve the right to optimize this manual at any time and to adjust it technically. The image used may differ.

Symbol explanation



Do not cover the device!

Important warning



This device is drip-proof / splash-proof and may be used in bathrooms and other damp rooms. To prevent contact with water, the device must be mounted in bathrooms and in a humid place at a fixed location at least 100 cm from water taps and water reservoirs. The use of the device on feet is not permitted in bathrooms and damp rooms.

Technical data

Type	400 wifi	800 wifi	1200 wifi
Supply Voltage	220-240V / 50Hz		
Capacity	400W	800W	1200W
Setting options	400W	300-500-800W	500-700-1200W
Thermostat	+		
Day-timer	+		
Weekly timer	+		
Insulation class	IP24		
Dimensions	21,5 x 40 x 42,9 cm	21,5 x 56 x 42,9 cm	21,5 x 70,5 x 42,9 cm
Weight	2,5 kg	3,3 kg	4,0 kg

Warning electric heaters

Safety warning – general

1. Read the user instructions carefully and completely before using (and installing) this device. Keep the instruction leaflet somewhere safe so that you can consult it and pass it on in future.
2. Before use, check your new device (including cable and plug) for any visible damage. Never use a damaged device but take it back to the supplier for a replacement.
3. In the event of incorrect usage or installation, there is a risk of electric shocks and/or a fire hazard.

Warnings position of the device with wall mounting

1. Do not use the device before it has been fully installed as set out in the user instructions. Never use the device standing up or leaning against something, or similar. Never insert the plug into the socket before the device has been correctly installed at the appropriate place.
2. When installing, the following minimum distances should be considered:
 - Minimum distance to ceiling: 150 cm
 - Minimum distance to side walls: 30 cm
 - Minimum distance to the ground: 30 cm
 - Minimum distance to the front: 50 cm
3. The air around the device must be able to circulate freely. Never install it too close to large objects and never under a shelf, cupboard, curtains or similar. The minimum distances from large objects such as shelves, cupboards, etc. to the top, sides and underneath of the device are equal to the aforementioned minimum distances to ceilings, side walls and the ground, respectively.
4. This device is, in principle, suitable for installation in damp spaces such as bathrooms, wash rooms etc. (IP24). The device may only be used in the bathroom if it is installed at a fixed point and the device is at least 100 centimetres from water-points and water reservoirs (tap, bath, shower, toilet, sink, swimming pool, etc.). Make sure that the device cannot fall into water and that it cannot be penetrated by water. If the device does get wet make sure you remove the plug from the socket! Do not use a device that is wet inside but take it to be repaired. Never immerse the device, cable or plug in water or any other fluid and never touch device with wet hands.
5. If the device is installed in a bathroom, it must be installed such that the switches and other operating components cannot be touched by a person in the bath or shower.
6. The wall or ceiling to which the device is secured and the ceiling and walls within 1 metre of the device must not be made of flammable materials. Materials must be resistant to temperatures of at least 200°C without burning, melting, deforming or bursting into flames. Check regularly to ensure that the wall and ceiling are not overheating; this could be dangerous!
7. Only use the device if it has been secured properly. Make sure that you always use attachment materials that are suitable for the surface you are working with; consult an expert if required.
8. With wall installation: never block the space between the device and the wall.
9. If this device is connected directly to your electrical installation, it must be installed by a specialist, taking into account the valid regulations/legislation.

Warnings position of the device with free-standing use

1. Only use the device when the feet/wheels have been installed. Using the device without feet/wheels creates a significant risk of fire. Always remove the plug from the socket if you are installing/removing.
2. Do not use this device in the immediate vicinity of a bath, shower or swimming pool.
3. This device is drip-proof / splash-proof and may be used in bathrooms and other damp rooms. To prevent contact with water, the device must be mounted in bathrooms and in a humid place at a fixed location at least 100 cm from water taps and water reservoirs. The use of the device on feet is not permitted in bathrooms and damp rooms. Do not place the device near water-points and/or water reservoirs. Make sure that the device cannot fall into water and that it cannot be penetrated by water. If the device does get wet make sure you remove the plug from the socket! Do not use a device that is wet inside but take it to be repaired. Never immerse the device, cable or plug in water or any other fluid and never touch device with wet hands.
4. The air around the device must be able to circulate freely. Never install it too close to walls or large objects and never under a shelf, cupboard, curtains or similar. When locating the device, make sure you have the following minimum free space:
 - Front, minimum free space 50 cm
 - Back, minimum free space 30 cm
 - Sides, minimum free space 30 cm
 - Top, minimum free space 150 cm
5. Always place the unit on a sturdy, flat horizontal surface
6. The base on which the device is placed must not be made of flammable materials. It must be resistant to temperatures of at least 125°C without burning, melting, deforming or bursting into flames. Check regularly to ensure that the surface is not overheating; this could be dangerous!
7. Never place the device on surfaces such as beds or deep-pile carpet as openings could be blocked.

Other warnings position of the device

1. Never install / place this device behind a door or by an open window, where rain could get in.
2. Do not place the device near, under or facing an electrical socket and not in the vicinity of an open fire or heat source.
3. Do not use the device nearby or facing furniture, curtains, paper, clothing, bedding, towels or other flammable materials. Keep at least 1 metre from device!
4. Do not use the heater outdoors or in areas that are smaller than 7m³ (Homeline 400) / 10m³ (Homeline 800) / 15m³ (Homeline 1200).
5. The device contains hot and/or glowing and sparking components. Do not, therefore, use where fuels, paint, flammable fluids and/or gases are stored. Do not use the device in an environment that poses a fire risk, e.g. near gas tanks, gas pipes or aerosols. This is an explosion and fire risk!

Warnings – use

1. Do not use additions/accessories on the device that have not been supplied or approved by the manufacturer.
2. Only use the device for its intended purpose and in the manner set out in this instruction leaflet.
3. Some parts of this device will get very hot and could cause burns. You must pay particular attention to children, vulnerable persons and pets that are present near the device. Never leave them alone with a working device.

4. Never cover or block the device; it will overheat and this could lead to a fire risk. Never hang or place objects such as clothing, towels, blankets, cushions, paper, etc. on the device. The minimum distance of 1 metre between the device and flammable materials must always be applied. Ventilation openings should never be blocked as this may pose a fire risk. Never use the device to dry clothing or place anything on it. Do not let anything lean against the device!
5. The device is exclusively intended for normal, household usage. Only use for providing heat in your home.
6. The connection voltage and frequency, as given on the device, must correspond to that of the socket to be used. The electrical socket to be used must be an earthed connection. The electrical installation must be protected via a 30 mA earth leakage circuit breaker. The electrical socket that you are using must be to hand at all times in order to be able to remove the plug from the socket in the event of an emergency.
7. To avoid overloading and/or fuses being blown, do not use any other equipment on the same socket or electrical group as the one used for the device.
8. Unroll the electric cable for the device fully before inserting the plug into the socket and ensure that the electrical cable does not come into contact with the fireplace or get hot. Do not run the electrical cable under carpet, cover with mats, runners or similar and do not place in areas that are walked on frequently. Ensure that it cannot be stepped on and that no furniture is placed on top of it. Do not bend the electrical cable around sharp corners and do not roll up too tightly after use! Prevent the electrical cable coming into contact with oil, solvents and sharp objects. Check the cable and plug regularly for damage. Do not bend or pinch the electrical cable and do not wind it around the device; this could damage the insulation!
9. The use of an extension cable is not advised as this can lead to overheating and fire. If the use of an extension cable is unavoidable, make sure that it is not damaged and that it is an approved extension cable with a minimum diameter of $3 \times 1,5 \text{ mm}^2$ and a minimum permitted capacity of 1000 Watt (Homeline 400) / 1500 Watt (Homeline 800) / 2000 Watt (Homeline 1200). Always fully extend the cable in order to prevent overheating.
10. Only connect the device to a fixed socket. Do not use multi-plug adapters or similar.
11. During use, the plug may begin to feel warm; this is normal. If it's really warm, there may be something wrong with the socket. Please contact your electrician.
12. Always turn off the device and remove the plug from the power socket: Never turn the device off using the plug!
13. Prevent foreign objects entering the radiation/ventilation or outlet openings on the device. This may cause electric shock, fire or damage.
14. Never leave a working device unattended but switch off and then remove the plug from the socket. Always remove the plug from the socket when the unit is not in use! Always remove plug by pulling on the plug itself; never pull on the electrical cable!
15. Apart from manual use, this device can also be operated via an app or timer. However you operate it, make sure that the safety guidelines are taken into account at all times! Do not operate the device with an additional time clock, timer, volume control or any other device that automatically turns on the device.
16. This device gets hot during use. Never touch the device when it is on or shortly thereafter; it could burn you.
17. Never operate the device with wet hands.

Who can use the device?

1. Children younger than 3 must be kept out of the vicinity of the device unless they are continuously supervised.
2. Children between the ages of 3 and 8 may only switch the device on or off if it is set up or installed at its usual location and they are supervised or have received instructions regarding the safe use of the device and understand the corresponding hazards. Children between the ages of 3 and 8 may not insert the plug into the

socket, adjust the device settings or clean or maintain it.

3. This device can only be used by children from the age of 8 and elderly persons and persons with diminished physical or mental capacities or a lack of experience and expertise if they are supervised or have received instructions regarding the safe use of the device and understand the corresponding hazards.
4. Children may not clean or maintain the device without supervision.
5. Children may not play with the device.

Warnings for maintenance

1. Keep the device clean. Dust, dirt and/or deposits in the device often lead to overheating. Ensure that this type of build-up is regularly removed.
2. Always switch the device off, remove plug from socket and let the device cool down before you:
 - clean the device
 - users – maintain the device.
 - touch or move the device.
3. Never switch the device on if you have noticed damage to the device itself, the cable or plug or if it does not work properly, makes strange noises, smells odd or you can see smoke, or if it has fallen or shows any other signs of damage. Remove the plug from the socket immediately. Take the entire device back to your supplier or a recognised electrician to be checked and/or repaired. Always ask for original parts to be used.
4. The device may only be opened and/or repaired by a competent and qualified person. Do not carry out your own repairs as this could be dangerous! Repairs carried out by unauthorised persons or changes made to the device could damage the dust/waterproof capacity of the device and will nullify the guarantee and the manufacturer's liability.
5. If the electrical cable is damaged, it must be replaced by the manufacturer, their service department or somebody with similar qualifications in order to prevent creating a hazard.

Failing to adhere to points 3, 4, 5, could lead to damage, fire and/or personal injury. They will invalidate the guarantee and the supplier, importer and/or manufacturer shall not be liable for the consequences.

Description

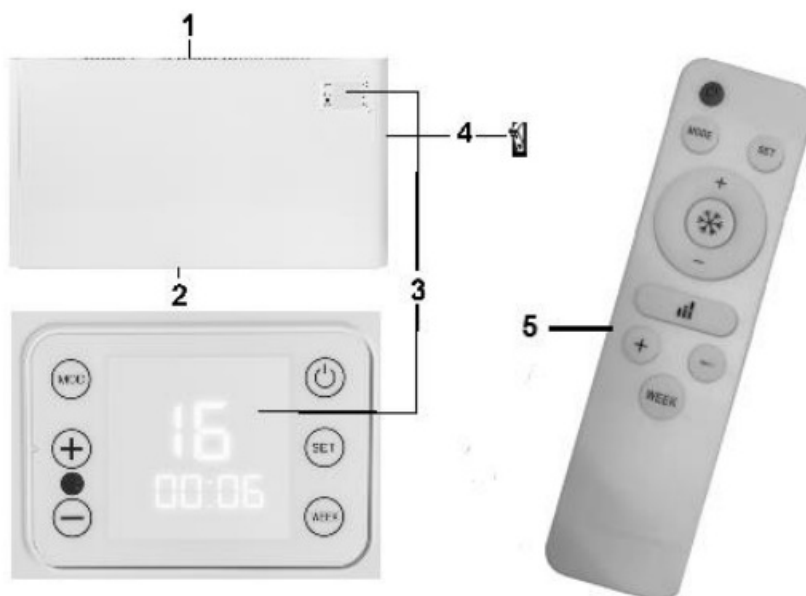

1. Heat outlet grille
2. Air inlet grille
3. Operating panel and LED display
4. Main switch
5. Remote control

The LED-display (3) has 4 lines:

- **1st line:**

- 3 suns, that indicate whether the heater is set to low, medium or high capacity.
- **Note:** Does not apply to Homeline 400, this model only has 1 heating level (400W full power).
- The wifi symbol. If there is a wifi connection, this symbol will stay on.
- “**P**”: thermostat function or working according to weekly timer.
- “**M**”: working on set capacity.

- **2nd line:**

- SET indicates that a day or time can be set.
- ON indicates that the heater is switched on.
- OFF indicates that the heater has been switched off by the stand-by button or the topple safeguard.
- The figures show the temperature

- **3rd line:**

- The time: both the ordinary time and the set times for the weekly timer.

- **4th line:**

- The days of the week: 1 = Monday, 2 = Tuesday and so on.

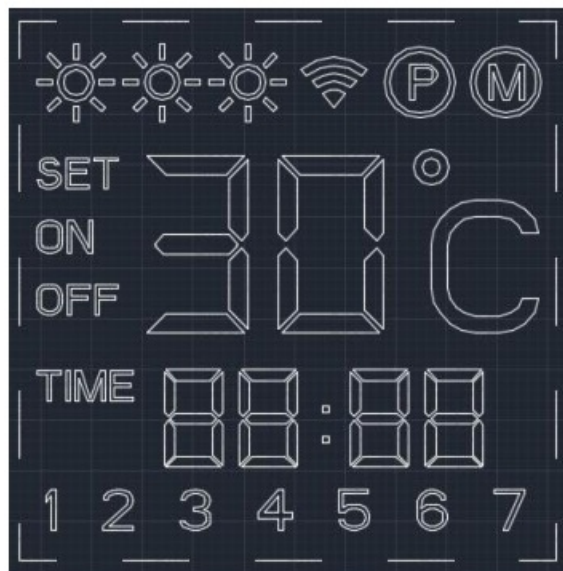

Installation

- Remove all packaging material and keep out of reach of children. After removing packaging, check the appliance for damage or other signs that could indicate a fault/defect/malfunction. In case of doubt, do not use the appliance, but contact your vendor for inspection or replacement.
- Choose a suitable location (wall-mounted or free-standing) for the device to take into account all the warnings

mentioned earlier in this manual.

Wall mounting

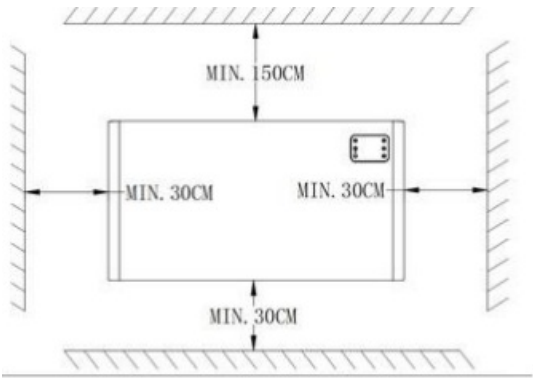

	400XS	800XS	1200XS
A	195mm	255mm	400mm
B	325mm	485mm	630mm
C	305mm		

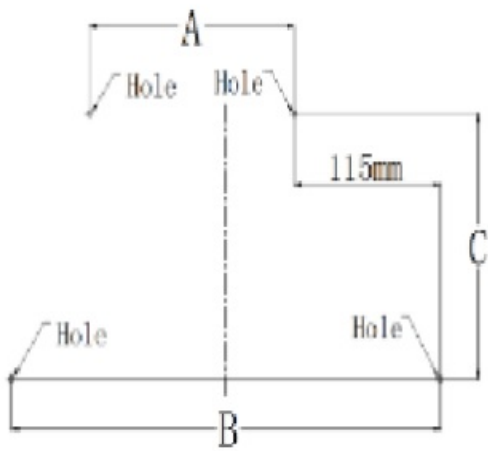

400W

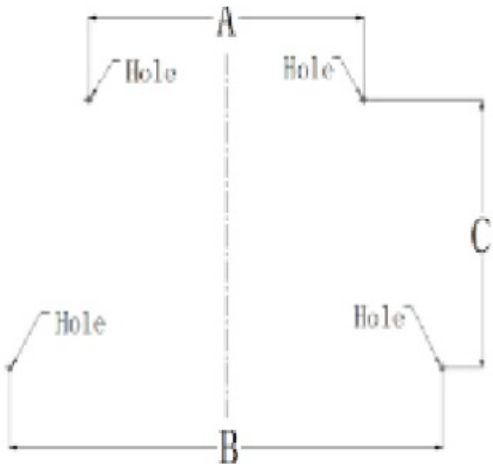

FOR OTHER

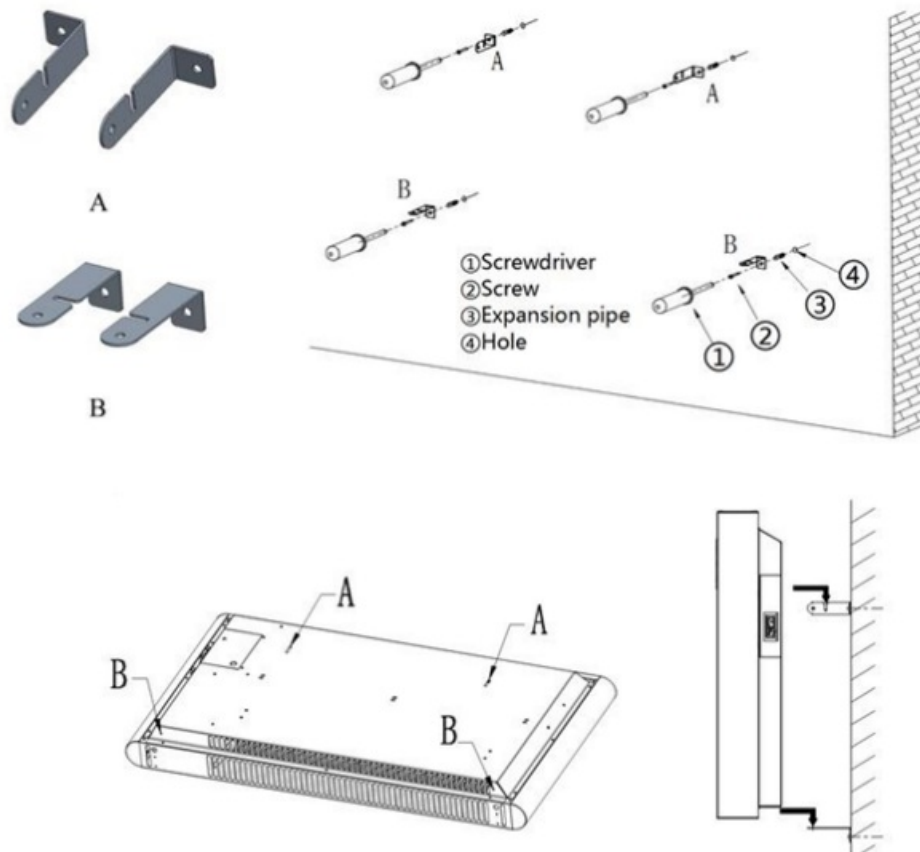

- Secure the 2 hanging brackets on the wall. Choose a left and a right bracket and secure them with the channel to the top, the short sides against the wall and facing one another (see diagram). Drill 2 holes in the wall, with a distance of 195 mm (Homeline 400) / 255 mm (Homeline 800) / 400 mm (Homeline 1200) between them, at least 61 cm. above the floor and horizontal. Push plugs into the drilled holes and screw the brackets to the wall using the 2 large screws.
- Screw the other 2 brackets with the smaller screws below the heater, in the relevant holes (see diagram): screw through the long side of the bracket, the short side facing down. The short side will come to lie against the wall.



- Hang the heater on both brackets and let it drop into the channels.
- The short sides of the other 2 brackets will fall against the wall. Mark where these must be screwed to the wall and lift the heater out of the brackets.
- Drill 2 holes at the marked locations and insert plugs.
- Hang the heater back on the brackets, let it drop into the channels and screw the last 2 large screws through

the lower brackets against the wall.

- Check to ensure your heater is horizontal and secure, with a minimum distance to the floor, ceiling and any side walls.

Freestanding

Attach the feet supplied to the underside of the heater (see picture):

- Turn the heater upside down. Place a blanket (or something similar) under the heater to prevent damage!
- Place the feet on their place on the bottom of the heater. This will ensure that the threaded holes will align correctly.
- Securely attach the feet to the heater using the (2×2) self-tapping screws.

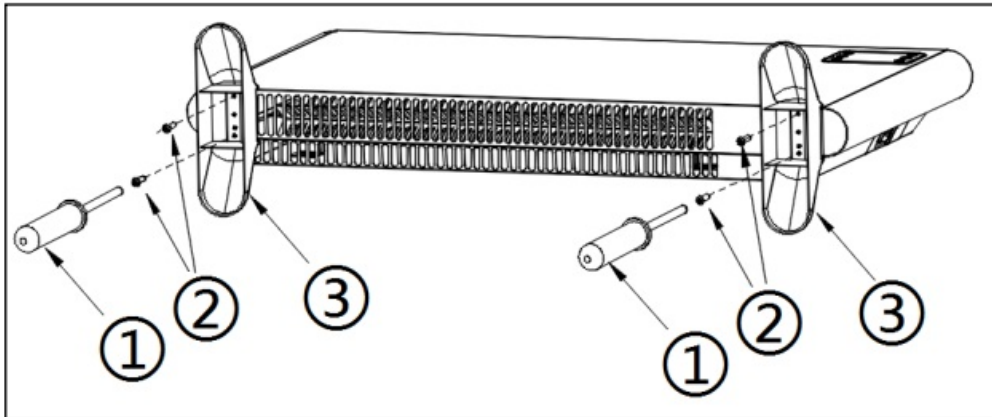

- Return the heater to the upright position.
- Make sure a working heater is always placed on a solid, flat and horizontal surface. Deep-pile carpeting is unsuitable!

Using for the first time and operation

- Check to make sure the main switch is set to O (off).
- Check that the heater is stable and upright, in line with instructions.
- Now insert the plug into the 220/240V socket.
- Set the main switch to I (on). The display will show: OFF

Using the operating panel:

The operating panel (3) has 6 buttons: MOD / SET / WEEK / + / – / ON-OFF



- Press the ON/OFF button in order to switch the heater on. The display lights up and the heater can be operated.
- Now, set the day and time. Press and hold SET until SET appears on the screen. The numbers of the weekdays (line 4) will blink. Use the + and – buttons to find the right day (1 – Monday, 2 = Tuesday, etc.) and confirm with SET. The hour will now blink. Use the + and – buttons to set the right hour and confirm with SET. The minutes will now blink. Use the + and – buttons to set the right minutes and confirm with SET. The day and time are now set.
- **Please Note:**
 - The day and time settings will be lost if the heater is switched off using the main switch or plug; these will be retained if the ON/OFF button is used.

- If you do not set a time and day, the heater will assume that it is day 1 and 00.00.
- The screen goes off automatically after 2 minutes and can be turned on again with any button.
- Press MOD to set whether you wish to work with the M or P function.
Under the M-function, you use the + and – buttons (remote control: with the bar button) to set the capacity at which the heater will work: low, medium or high -see technical details. The thermostat cannot be adjusted.
- **Note:** Does not apply to Homeline 400, this model only has 1 heating level (400W full power).
- Under the P-function, you can use the + and – buttons to set the desired temperature for the heater, which it will then try to maintain. The heater will automatically select the correct capacity: 1 or 2 degrees of heat = low, 3, 4 or 5 degrees of heat is medium and 6 or more degrees of heat is high. Once the desired temperature is reached, the heater automatically turns off, and then back on again when it cools down.
- **Note:** Does not apply to Homeline 400, this model only has 1 heating level (400W full power).
- Under the P-function, you can also set the weekly timer. Pressing WEEK, allows you to set or check the weekly timer. Please note! To set the weekly timer, you must first enter the day and time correctly.

Setting weekly timer:

- Press the WEEK button and hold it in. A blinking '01' will now appear on the display. Use the + and – buttons to choose "01" (one-off setting) or "[[" (the setting your install will be implemented every week). Confirm with SET.
- **Note:** the setting(s) that you enter under 'one-off' (01) must fall into the current week. On Sunday (day 7) at 24.00, all one-off settings will be turned to non-active. A setting that you enter on Tuesday for Saturday will work, but a setting that you enter on Saturday for Tuesday will not.
- **Note:** a one-off setting (01) will only be implemented by the heater once, but the timer setting will stay as non-active in the memory and therefore takes the place of one of the four possible settings on that day. You are better off
- deleting it, see later.
- ON now blinks. Use the + and – buttons to choose between ON and OFF: with or without 'anticipation'. With ON, the heater will check the temperature in the room 20 minutes before it set activation time. If it needs to be heated by over 6 degrees, the heater will switch on at full capacity in order to heat the room to the right temperature by the activation time. For 3, 4 or 5 degrees' difference, it will switch on in the medium setting and for 1 or 2 degrees, it will switch on at low capacity. If you would prefer not to have this function, switch 'anticipation' to: OFF. Press set to confirm.
- **Note:** Does not apply to Homeline 400, this model only has 1 heating level (400W full power).
- **Please Note:** The choice of 'one-off' or 'repeated' and 'yes or no' for 'anticipation' now applies to all timer settings!
- "01 SET ON" appears on the screen to signify that you can set the first 'on' time. You can now use the + and – buttons to select the day of the week for the setting. Press SET for the right day.
- The temperature (standard 25°) now appears on the display and blinks. Use the + and – buttons to adjust it, from 0 to 37°C. Confirm with SET.
- The hour will now blink. Choose the right hour and confirm with SET.
- The minutes will now blink. Choose the right minutes and confirm with SET. The first activation time is now set.
- Now, "01 SET OFF" will appear on the display, to indicate that you must set the deactivation time. Do this in the

same way as set out in the above 2 points. Your first setting is now entered. A '02' will now appear on the display. You can now set a second activation/deactivation time; a total of 4 per day and 28 per week. If you don't need to, wait until the screen returns to the standard settings.

Attention! All timer settings (maximum 28 per week) will be processed completely one by one. Therefore, make sure that they do not contradict each other!



- Now switch the heater on using the ON/OFF switch. The screen will show P and OFF to indicate that a setting has been programmed but that the heater is currently off. At the set time, it will switch on and off automatically.
- The set timer details will be retained after it is switched off using the main switch or plug.
- If you press repeatedly on WEEK, you will see the following timer settings, one after the other:
 - One-off or repeated
 - Anticipation on or off
 - Thermostat setting
 - Timer on-time
 - Timer off-time
 - Next timer setting
- If you would like to delete a specific setting, press and hold WEEK and then search for the timer setting that you need. Go past 01-][and on/off first by pressing SET briefly. When the number of the timer setting that you wish to change appears, press SET for a little longer. You will hear a short beep and the selected setting has been deleted.
- If you wish to delete all timer settings, press the WEEK button and hold. Press and hold the MOD and SET buttons at the same time, until you hear a beep. The screen will show 88:88, indicating that all settings have been deleted.
- **Please Note:** all timer settings can only be deleted with the buttons on the operating panel, not with the remote control!
- If you wish to retain the timer details but do not want to use the timer for a while, push and hold the WEEK button and then push and hold the MOD until TIME disappears from the screen to indicate that the data will be retained but will not be active. By pressing MOD again until TIME appears, you will reactivate the timer.

Screen protection: If the settings on a working heater are not adjusted for 2 minutes, the LED display will go out but ON will stay on. It will light up again when you press a button. If the heater is switched off using the ON/OFF button, the OFF screen will stay on.

Using with the remote control:

The remote control (5) has the same 6 buttons as the operating panel (MOD = MODE) and works in roughly the same way, but:



-  You cannot use the remote control (under M-mode) to set the capacity with the + or – buttons. Use the bar button for this purpose. Note: Does not apply to Homeline 400, this model only has 1 heating level (400W full power).
-  The remote control has a frost protection button; the heater maintains the room at 5°C. The screen shows FP. Deactivate by pressing again. Nothing else can be set under this setting.

If the heater is working on frost protection setting and a timer setting becomes active, the heater will start to work according to the timer setting. When the heat goes off, the heater will not return to the frost protection setting, but go off.

Working with the app via wifi:

- The heater can also be operated using an app on your smartphone. The heater must be connected with a wifi modem. See www.target.no for instructions on how to install the app. By activating the app on your smartphone or tablet, and selecting the device, you can operate the heater with the smartphone. You do not need to set a day or time as they are set automatically (both on the app and on the display).
- You can use the app to switch the device on and off (without anticipation), regulate the temperature and capacity, and set the frost protection setting. The app can also be used to set 20 on and off settings daily, on the weekly timer.



If the device is connected with wifi and is switched on, the display will show (during screen saver) the wifi symbol and ON. If the device is connected to wifi but switched off, the display will show the wifi symbol and OFF.

Note: timer settings that are created using the app are not visible on the display; timer settings that are created

using the operating panel or remote control are not visible on the app! Once there is a wifi connection, you cannot create a new weekly timer using the panel or the remote control (WEEK and SET buttons are turned off); any existing, manually entered weekly timer settings will remain active under wifi.

Do not use both methods at the same time!!!

- When the heater has logged into wifi, an automatic connection will be made when it is switched on. The wifi symbol will be on all the time. If the wifi symbol blinks quickly, there is no connection.
- You can reset the wifi settings by pressing and holding the MODE button. Existing connections will be deleted, the wifi symbol will begin to blink and a new connection will be made.
- You can switch off the wifi connection (and the blinking wifi symbol) by pressing and holding the ON/OFF button. If you hear a long beep, the wifi is switched off; the wifi symbol will go out. By pressing and holding the ON/OFF button, you will hear a short beep to indicate that wifi is switched on again. The wifi symbol will come back on.
- **Warning!** After switching the heater on or off, you will hear a quiet sound. This is normal and no reason to worry. It is just the material expanding and shrinking during heating and cool-down.

Wi-Fi and app operation

- The heater can also be controlled with an App. To do this, the heater must be connected to a Wi-Fi modem.
- Download the Homeline Smart App
 - Search for 'Homeline Smart' in the App store or Google Play and follow the download instructions.
 - The Homeline Smart App will be added.
 - For more information about the App see: www.target.no.

Safety precautions App

Safety and remote operation

Your Homeline heater can be easily operated, via the same WLAN, via a different WLAN, or via a 3G or 4G mobile network. This makes it possible to operate your heater remotely, without your direct supervision. Beware that even when operating the heater remotely, all safety precautions stated in the user manual supplied must be observed. Read and understand these safety precautions and make sure that all safety precautions are taken also with remote operation.

Safety and setting the timer

- The Homeline Smart App has a 'Smart Timer' with which you can create a schedule yourself with days and times on which the heater is to automatically switch itself on and off. Any timer data entered into the Homeline Smart App will be stored in the heater. This means that, once you have entered the timer data and the heater loses the connection with the Wi-Fi modem, the heater will still be able to switch itself on and off on your specified times. Storing the timer data in the heater is a safety precaution. Your set on and off times schedule will also work without a Wi-Fi connection. So the heater will not unexpectedly continue heating up if the Wi-Fi connection (temporarily) fails.
- The Smart timer data will be stored, even if the heater is switched off or the plug is removed from the socket. The set Smart timer data can only be checked via the App and also only be removed via the App. Bear this in

mind when entering the data into the Smart Timer. The Smart Timer data is not visible on the heater. Regularly check in the App whether the entered Smart Timer data are still correct.

Safety measures

- The heater is equipped with a topple safeguard which switches the heater off if it accidentally falls over. It will start working again once it has been set upright.
but, before reusing, switch it off, unplug and check for damage. Do not use the heater if it is damaged or malfunctioning, but have it inspected/repaired!
- In case of internal overheating, the overheating safeguard will switch the heater off. This may occur if the heater cannot give off enough heat or if it cannot draw in enough fresh air. As mentioned above, this is generally caused by (partially) covering the heater, obstructing the air intake and/or outlet grills or installing the heater too close to a wall or something similar. After cooling down, the heater will automatically switch on again but if the cause has not been eliminated, this could be repeated (with all of the corresponding risks) In case of overheating, switch off the heater and unplug. Give the heater time to cool down, remove the source of the overheating and use as normal. If the problem persists or if you have not been able to trace the source of the overheating, turn the heater off immediately and unplug. Contact a servicing point to have the heater repaired.

Cleaning and maintenance

- Keep the heater clean. Deposits of dust and dirt in the appliance are a common cause of overheating so these should be removed regularly. Switch off the heater, remove the plug from the socket and allow the heater to cool down before cleaning or carrying out maintenance work.
 - Wipe the outside of the heater regularly with a dry or slightly damp cloth. Do not use aggressive soaps, sprays, cleaners or abrasives, waxes, polishes or chemical solutions!
 - If the heater is hung on the wall, clean the back and the space behind the heater. Then remove the heater from the wall, see 'Installation'.
 - Use a vacuum cleaner to carefully remove any dust and dirt from the grills and ensure that the air intake and outlet openings are clean. Be careful not to touch or damage any internal parts during cleaning!
 - The heater contains no other parts which need maintenance.
 - At the end of the season, store the cleaned heater in the original packaging if possible. Store it upright in a cool, dry and dust-free place.



Removal

- In the EU this symbol indicates that this product may be disposed of as ordinary household waste. Old equipment contains valuable materials, suitable for recycling. These materials should be made suitable for reuse in order to prevent any adverse effects to health and the environment caused by unregulated waste collection. Therefore, please make sure that you bring old equipment to a designated collection point. Alternatively, contact the original supplier, who can make sure that as many of the components as possible can be recycled.

CE declaration

Hereby, Target, Fredrikstad-NO declares that the electric convector heater, brand Homeline type 400/800/1200 meets and is in accordance with the following standards:

LVD standard:

- LVD 2014/35/EU
- EN 60335-2-30:2009+A11:2012 EN 60335-1:2012+A11:2014

RED Standard:

- EN 300328 V2..2.2:2019
- EN 301489-1 V2.2.3:2019
- EN 301489-17 V3.2.2:2019
- EN 62311:2008
- EN 55014-1:2017RoHS 2011/65/EU&(EU)2015/863

EMC 2014/30/EU

- EN 55014-1:2017
- EN 55014-2:2015
- EN 61000-3-2:2014
- EN 61000-3-3:2013

ERP 2009/125/EC

- Commission Regulation (EU) 2015/1188
- With regard to eco-design requirements for local space heaters.

Markedsføres i Norge av:

- Beha Target AS Evjeløkka 3 1661 Rolvsøy
- **Telefon:** 82050050
- post@behatarget.no

FAQs

Q: Can I use the panel heater in a poorly insulated room?

A: It is recommended to use the panel heater in a well-insulated room for optimal performance and energy efficiency.

Q: How do I connect the panel heater to my WiFi network?

A: Please refer to the user manual for detailed instructions on connecting the panel heater to your WiFi network.

Documents / Resources

	<p>HomeLine HLHW-400 Built In WiFi Solution [pdf] Instruction Manual HLHW-400, HLHW-800, HLHW-400 Built In WiFi Solution, HLHW-400, Built In WiFi Solution, Wi Fi Solution, Solution</p>
--	--

References

- [User Manual](#)

Manuals+, Privacy Policy

This website is an independent publication and is neither affiliated with nor endorsed by any of the trademark owners. The "Bluetooth®" word mark and logos are registered trademarks owned by Bluetooth SIG, Inc. The "Wi-Fi®" word mark and logos are registered trademarks owned by the Wi-Fi Alliance. Any use of these marks on this website does not imply any affiliation with or endorsement.