



# hOmeLabs HME010231N Automatic Trash Can Instruction Manual

[Home](#) » [homelabs](#) » hOmeLabs HME010231N Automatic Trash Can Instruction Manual 

## Contents

- [1 hOmeLabs HME010231N Automatic Trash Can](#)
- [2 Product Information](#)
- [3 Product Usage Instructions](#)
- [4 Important Safety Instructions](#)
- [5 Parts Overview](#)
- [6 Operation](#)
- [7 How the Smart Retainer Ring Works](#)
- [8 Warranty](#)
- [9 Manufacturing Information](#)
- [10 Contact Us](#)
- [11 Documents / Resources](#)
  - [11.1 References](#)



**hOmeLabs HME010231N Automatic Trash Can**



## Product Information

The Automatic Trash Can by hOmELabs is available in two sizes: 13 or 21 gallons. The product model numbers are HME010231N and HME010233N. This appliance uses infrared (IR) technology with an Infrared Sensor on the Lid to sense movement. It operates on 4 C (LR14/AM2) alkaline batteries (not included).

## Product Usage Instructions

1. Ensure to read the entire user manual before using the appliance.
2. If you have any questions about the product, contact Customer Service at 1-(800)-898-3002 or visit [homelabs.com/help](http://homelabs.com/help).
3. In case of a malfunction or suspected defect, contact Customer Service and keep the defective product aside for further instruction.
4. Important Safety Instructions:
  - Always follow basic safety precautions to reduce the risk of electrical shock or injury.
  - Do not allow children or individuals with reduced capabilities to use the appliance without supervision or instruction.
  - Save these instructions and use the appliance for household purposes only.
5. Parts Overview:
  - The Trash Can consists of a Top Lid with Covers, Can Body, Manual Open Button, Manual Close Button, Battery Cover, Power Jack, Smart Retainer Ring, and Plastic Bracket.
6. Operation:
  - The Trash Can's Lid automatically opens when movement is detected within 6 inches of the Infrared Sensor on the Lid.
  - The Lid will close automatically after approximately 6 seconds when no more movement is detected.

- The Lid remains open as long as movement is detected within 6 inches of the Infrared Sensor zone.

## 7. Replacing Batteries:

1. Locate the Battery Cover on the bottom of the Trash Can and press both Battery Cover Tabs to remove it.
2. Dispose of the used batteries properly.
3. Insert 4 new C (LR14/AM2) alkaline batteries (not included) following the indicated inside the battery compartment.
4. Replace the Battery Cover.

HME010231N

HME010233N

Thank you for purchasing our appliance. Please be sure to read the entirety of this user manual carefully prior to using this appliance. If you have any questions regarding the use of this product, please call 1-(800)-898-3002. In the event this product malfunctions, or you believe it is defective, please contact Customer Service at [homelabs.com/help](http://homelabs.com/help), 1-(800)-898-3002 or [help@homelabs.com](mailto:help@homelabs.com) and hold onto the defective product (pending further instruction). A defective product should be clearly marked or stored where it cannot be used by mistake. Failure to keep the product in its original quality from the time of receipt may impede hOmeLabs's ability to correct any legitimate problem and may limit the extent to which hOmeLabs may provide recourse.

Congratulations

on bringing home your new appliance!

Don't forget to register your product at [homelabs.com/reg](http://homelabs.com/reg) for updates, coupons, and other relevant information.

Although greatly appreciated, product registration is not required to activate any warranty.

## Important Safety Instructions

When using your hOmeLabs Automatic Trash Can (appliance), basic safety precautions should always be followed to reduce the risk of electrical shock, and/or injury to persons. Incorrect operation due to ignoring instructions may cause harm or damage.

- Make sure there is enough room to operate the Trash Can without blocking the end of the Lid.
- Do not press or force the Lid of the Trash Can to close when it is open. Let it close by itself.
- Only use the hOmeLabs power adapter model HME010246N with an output of 5.9 V / 500 mA.
- To prevent battery leak that potentially causes damage to the electronic components, remove batteries if the unit is not intended to be used for a long time.
- Do not mix old and new batteries. Do not mix alkaline, standard (carbon-zinc), or rechargeable (ni-cad, ni-mh, etc) batteries.
- Only use batteries of the same or equivalent type as recommended in the "Battery Replacement" instructions.
- Do not recharge the non-rechargeable batteries.
- Never short-circuit the battery terminals.
- Avoid direct sunlight onto the infrared Sensor Ball.
- Ensure the Sensor Ball is kept clean for normal function.
- Do not use solvents or other chemicals to clean.
- Do not immerse the Lid Cover in water because it is equipped with electronic components. You can clean it with a damp cloth.
- Do not use the appliance for anything other than its intended use.
- This appliance is not intended for use by persons (including children) with reduced physical, sensory or mental capabilities, or lack of experience and knowledge unless they have been given supervision or instruction concerning use of the appliance by a person responsible for their safety. Children should be supervised to

ensure that they do not play with the appliance.

SAVE THESE INSTRUCTIONS  
For Household Use Only

Parts Overview

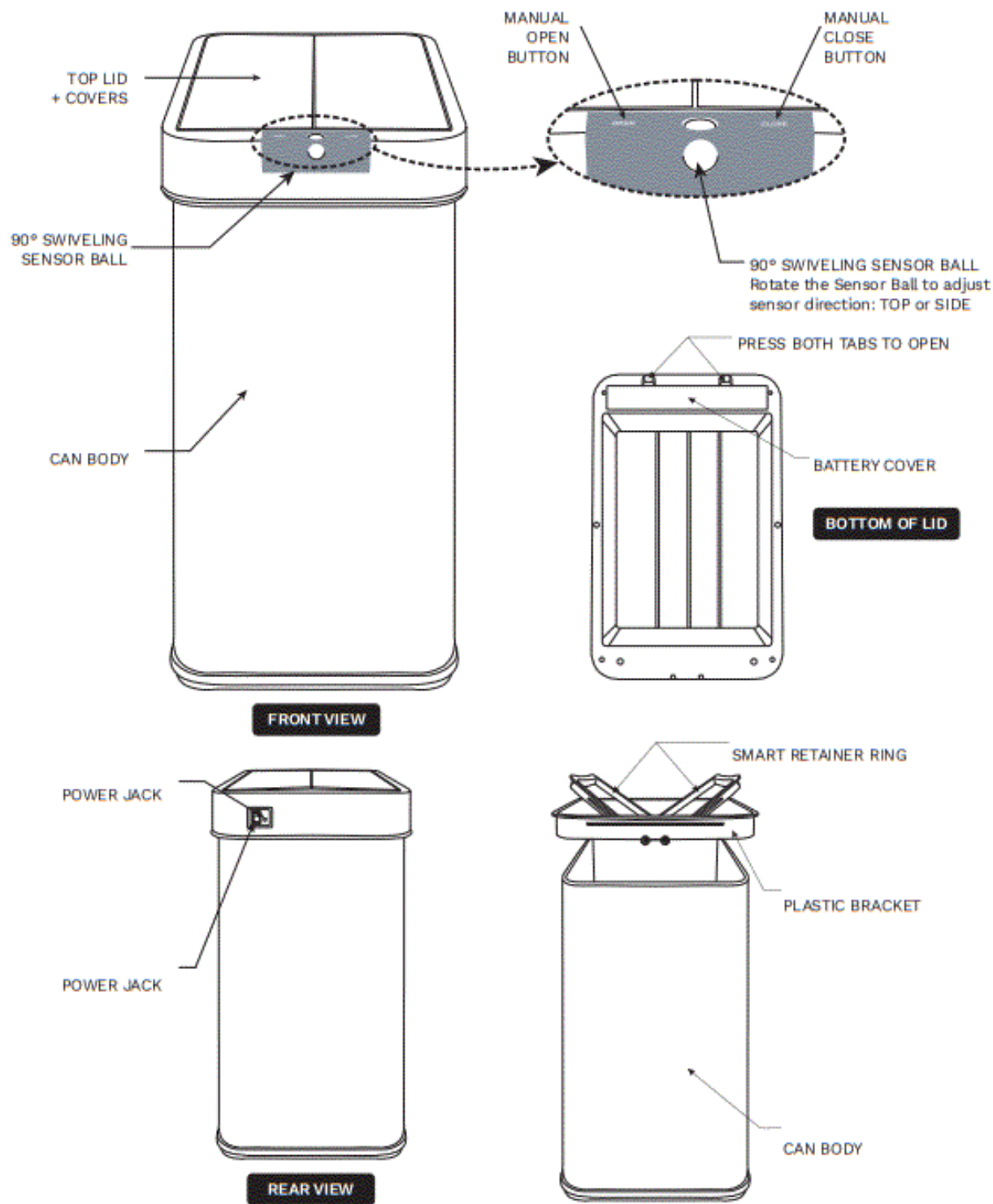

This Trash Can uses 4 “C” (LR14/AM2) alkaline batteries (not included)

Operation

## OPERATING INSTRUCTIONS

The hOmeLabs Touchless Trash Can uses infrared (IR) technology with an Infrared Sensor on the Lid to sense movement. When movement is detected, such as with a hand waving within 6 inches of the IR Sensor, the Lid will automatically open. When no more movement is detected, about 6 seconds after your hand moves away, the Lid will automatically close. The Lid remains open whenever movement is detected within 6 inches of the IR Sensor zone.

### TO REPLACE BATTERIES

1. Locate the Battery Cover on the bottom of the Trash Can (See > Page 7). Press both Battery Cover Tabs to remove the Battery Cover.
2. Remove the used batteries and dispose of them properly.
3. Insert 4 new “C” (LR14/AM2) alkaline batteries (not included) as indicated inside the battery compartment.
4. Replace the Battery Cover.

**NOTE:** Depending on battery make and capacity, 4 new “C” cell alkaline batteries should last for around 3 months.

## OPERATING INSTRUCTIONS

- Confirm you received all parts before using the Touchless Trash Can.
- Follow the “To Replace Batteries” steps to install 4 new batteries.
- Place your empty garbage bag inside the Can Body. Wrap the top of the bag over the Can Body.
  1. Insert the Plastic Bracket with its Smart Retainer Rings onto the Can Body, over the inserted garbage bag. Leave the Rings up. (See Figures 1–2)
  2. Pull up the garbage bag edges. Fold the bag edges inside the Can – over the Plastic Bracket and under the Rings. (See Figure 3)
  3. Fold down the Smart Retainer Rings to hold the bag in place. (See Figure 3)
  4. Once complete, place the Lid on top. The sensor and buttons should face the front of the Can Body. (See Figure 4)
- Adjust the Sensor Direction.
- Rotate the 90° swiveling Sensor Ball to select the sensor direction: TOP or SIDE.

**NOTE:** To ensure normal operation, always keep the Sensor Ball clean.
- Turn on the power switch located at the rear of the Lid Cover.
- A RED indicator light will flash once. It will then flash once every 5 seconds. The system is now activated and in Standby Mode.
- You may now open the Lid either automatically, by waving your hand about 6 inches from the Infrared Sensor or by pressing the “Open” button manually.

### TO OPEN / CLOSE

#### Automatically

- Wave your hand near the sensor (within 6 inches) to open the Lid.
- The Lid will close automatically about 6 seconds after no movement occurs.

#### Manually

- Press the “Open” or “Close” button on the Lid.

**NOTE:** If you press the “Open” button, the Lid will open and remain open for 6 minutes. It will then close automatically. To close before 6 minutes, press the “Close” button. The Trash Can will resume operating in

Automatic Mode (touchless).

- DO NOT PRESS THE LID! Always press the “Close” button to manually close the lid.

### TO SYNC LID COVERS

If only one Lid Cover lifts up, the gears inside are out of sync on the opposite Cover (that is not lifting).

**To adjust/sync them:**

- Flip the Lid to examine the gears.
- If 1 tooth is displaced when tilted: Click, level, and align the covers.
- If 2 teeth are displaced: Push the upper plate twice. You'll hear a clicking sound twice.
- Once the gears are synched, flip the Lid over and set it on the Trash Can.
- Test the touchless function by waving your hand about 6 inches away from the Sensor.

### ABOUT INDICATOR LIGHTS

- Standby Mode – indicator light will flash every 5 seconds
- Manual/Automatic Opening – all 6 indicator lights will turn red simultaneously
- Time to Change the Batteries – all 6 indicator lights will repeatedly flash together every second

### How the Smart Retainer Ring Works

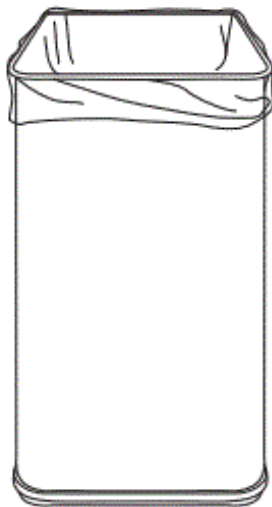

**STEP 1:**

Place the garbage bag inside the Can Body, then wrap the top of bag over the top.

**Figure 1**

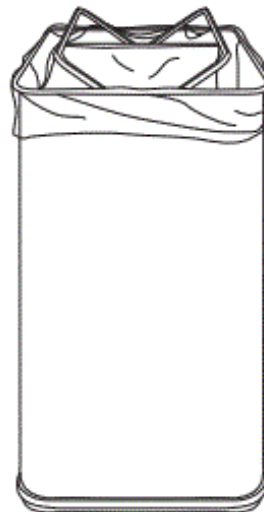

**STEP 2:**

Place the plastic bracket on the top of the Can Body.

**Figure 2**

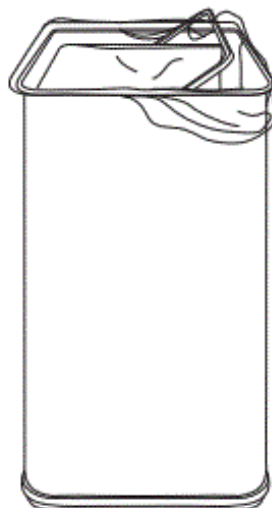

**STEP 3:**

Pull the top of the garbage bag up fold it inside the can, then put the smart rings down to hold the the bag inside the can in place.

**Figure 3**

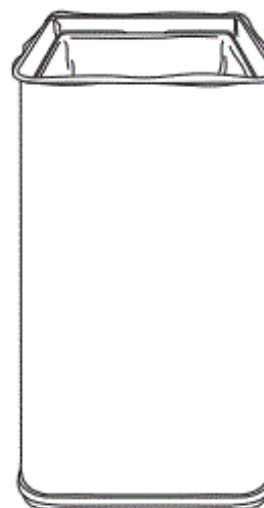

**STEP 4:**

The garbage bag should be set inside the can neatly, once complete place the Lid on top.

**Figure 4**

## Warranty

hOmeLabs offers a limited one-year warranty ("warranty period") on all of our products purchased new and unused from hOmeLabs Technologies, LLC or an authorized reseller, with original proof of purchase and where a defect has arisen, wholly or substantially, as a result of faulty manufacture, parts, or workmanship during the one-year warranty period. The warranty does not apply where damage is caused by other factors, including without limitation to (a) normal wear and tear; (b) abuse, mishandling, accident, or failure to follow operating instructions; (c) exposure to liquid or infiltration of foreign particles; (d) servicing or modifications of the product other than by hOmeLabs; (e) commercial or non-household use. The hOmeLabs warranty covers all costs related to restoring the proven defective product through repair or replacement of any defective part and necessary labor so that it conforms to its original specifications. A replacement product may be provided instead of repairing a defective product. hOmeLabs's exclusive obligation under this warranty is limited to such repair or replacement. A receipt indicating the purchase date is required for any claim, so please keep all receipts in a safe place. We recommend that you register your product on our website: [homelabs.com/reg](https://homelabs.com/reg). Although greatly appreciated, the product registration is not required to activate any warranty and product registration does not eliminate the need for the original proof of purchase. The warranty becomes void if attempts at repair are made by non-authorized third parties and/or if spare parts, other than those provided by hOmeLabs, are used. You may also arrange for service after the warranty expires at an additional cost. These are our general terms for warranty service, but we always urge our customers to reach out to us with any issue, regardless of warranty terms. If you have an issue with a hOmeLabs product, please contact us at 1-(800)-898 3002, and we will do our best to resolve it for you. This warranty gives you specific legal rights, and you may have other legal rights that vary from state to state, country to country, or province to province. The customer may assert any such rights at their sole discretion.

## Manufacturing Information

**This manual covers all items with these model numbers:**

- HME010231N
- HME010233N
- Rated Voltage/Frequency: 100–240 V ~ 50/60 Hz
- HME010231N Dimensions: 16.2"L x 10.3"W x 22.5"H
- HME010233N Dimensions: 16.2"L x 10.3"W x 33.5"H

**WARNING:** Keep all plastic bags away from children.

## Contact Us

- CHAT WITH US [homelabs.com/help](https://homelabs.com/help)
- CALL US 1-(800)-898-3002
- EMAIL US [help@homelabs.com](mailto:help@homelabs.com)

### For Household Use Only

Distributed by hOmeLabs™, LLC

350 Springfield Avenue, Suite #200, Summit, NJ 07901

1-(800)-898-3002

[help@homelabs.com](mailto:help@homelabs.com)

[homelabs.com/help](https://homelabs.com/help)

All rights reserved, hOmeLabs™.

Made in China.

## Documents / Resources

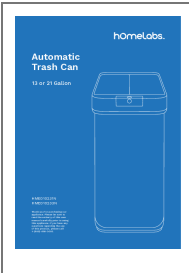
	<p><a href="#">hOmeLabs HME010231N Automatic Trash Can</a> [pdf] Instruction Manual HME010231N Automatic Trash Can, HME010231N, Automatic Trash Can, Trash Can, Can</p>
---	---

## References

- [🔗 Support – hOmeLabs](#)
- [User Manual](#)