



Homedics SS-8000 iSoundSpa Max Time Projection Sound Machine with Remote Control and Dock for iPod Instruction Manual and Warranty Information

[Home](#) » [Homedics](#) » **Homedics SS-8000 iSoundSpa Max Time Projection Sound Machine with Remote Control and Dock for iPod Instruction Manual and Warranty Information** 

HOMEDICS®

iSoundSpa™ Max

dock for iPod® | time projection | sound machine | remote control



SS-8000

**Instruction Manual and Warranty Information
1 year limited warranty**

Create your perfect sleep environment.

Thank you for purchasing iSoundSpa Max, the HoMedics ultimate dock for iPod and relaxation machine. This, like the entire HoMedics product line, is built with high-quality craftsmanship to provide you years of dependable service. We hope you will find it to be the finest product of its kind.

iSoundSpa Max helps create your perfect sleep environment. Fall asleep to any of the six calming sounds, then wake to iPod/iPhone, sounds, radio, or beep tone. iSoundSpa Max can also mask distractions to improve your concentration while you read, work or study.

Contents

- 1 **IMPORTANT SAFETY INSTRUCTIONS:**
- 2 **iSoundSpa Max Clock Radio Features**
- 3 **Before You Begin**
- 4 **Getting Started**
- 5 **Install/Replace Backup Battery**
- 6 **Battery Precautions**
- 7 **Charging your iPod/ iPhone™**
- 8 **Listening to Your iPod/iPhone**
- 9 **Listening to a non-docking iPod or other portable audio devices**
- 10 **Listening to the Radio**
- 11 **Listening to Nature Sounds**
- 12 **Adjusting Bass and Treble**
- 13 **Using Auto-Timer**
- 14 **Setting And Using The Alarms**
- 15 **Using the Remote Control**
- 16 **Maintenance**
- 17 **LIMITED ONE YEAR WARRANTY**
- 18 **Related Posts**

IMPORTANT SAFETY INSTRUCTIONS:

When using an electrical appliance, basic precautions should always be followed, including the following:
READ ALL INSTRUCTIONS BEFORE USING

DANGER – To reduce the risk of electric shock:

- Always unplug the appliance from the electrical outlet immediately after using and before cleaning.
- Do not reach for an appliance that has fallen into water. Unplug it immediately.
- Do not place or store appliance where it can fall or be pulled into a tub or sink. Do not place in or drop into water or other liquid.

WARNING – To reduce the risk of burns, fire, electric shock, or injury to persons:

- Close supervision is necessary when this appliance is used by or near children, invalids, or disabled persons.
- Use this appliance only for its intended use as described in this manual. Do not use attachments not recommended by HoMedics; specifically, any attachments not provided with the unit.
- Never operate this appliance if it has a damaged cord, plug, cable or housing. If it is not working properly, if it has been dropped or damaged, return it to Homedics Service Center for examination and repair.
- Keep cord away from heated surfaces.
- Never drop or insert any object into any opening.
- Do not operate where aerosol (spray) products are being used or where oxygen is being administered.
- Do not carry this appliance by power cord or use cord as handle.
- To disconnect, remove plug from outlet.
- This appliance is designed for indoor use only. Do not use outdoors.
- Only set on dry surfaces. Do not place on surface wet from water or cleaning solvents.

Caution: All servicing of this product must be performed by authorized HoMedics Service Personnel only.

SAVE THESE INSTRUCTIONS

Caution – Please read all instructions carefully before operating.

- Never leave the appliance unattended, especially if children are present.
- Never cover the appliance when it is in operation.
- This unit should not be used by children without adult supervision.
- Always keep the cord away from high temperature and fire.
- Do not lift, carry, hang, or pull the product by the power cord.
- If the adaptor sustains damage, you must stop using this product immediately and contact the HoMedics Service Center. (See the warranty section for the HoMedics address.)

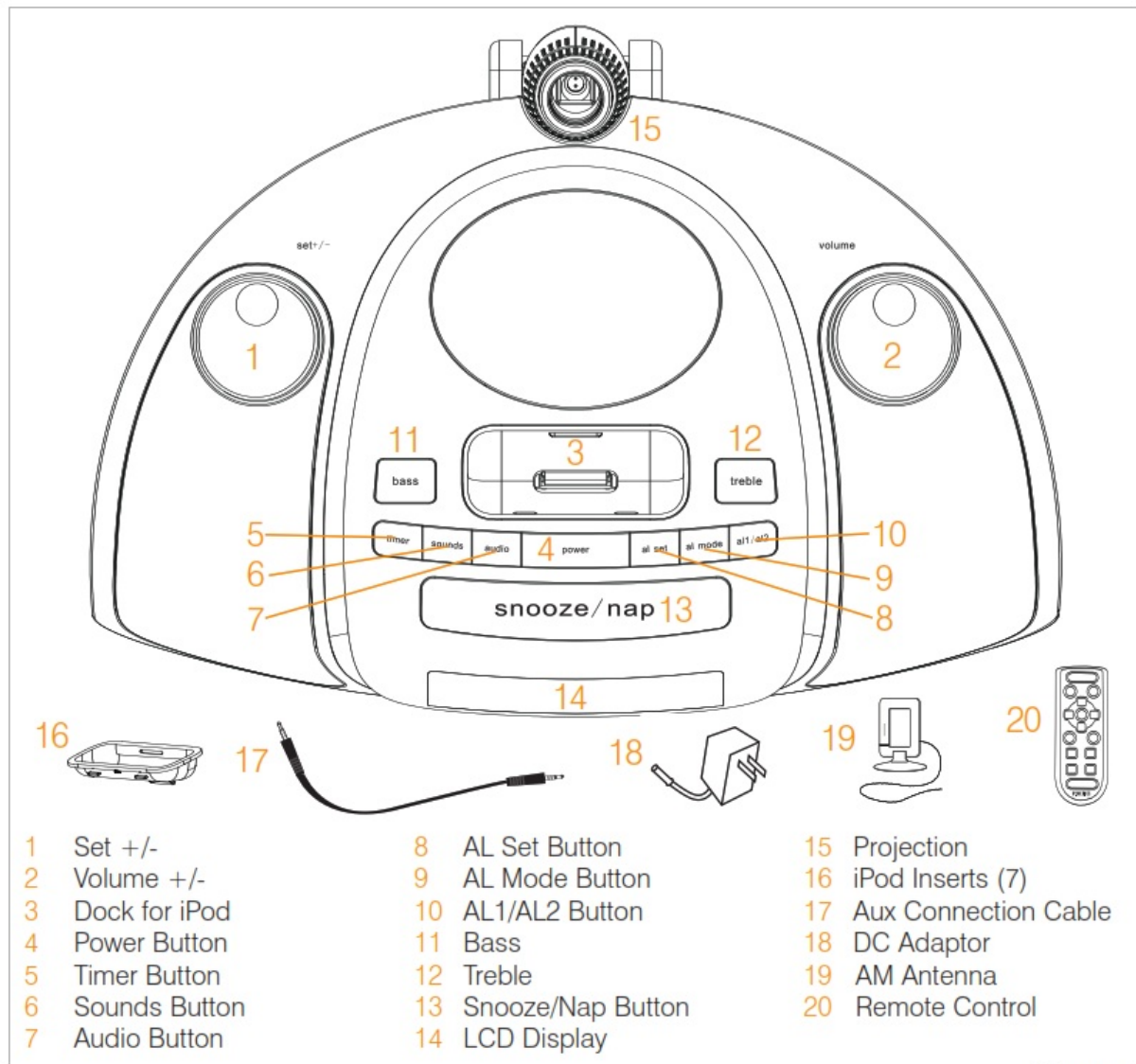

Figure 1

iSoundSpa Max Clock Radio Features

- 6 Nature Sounds: Night, Ocean, Brook, Sunrise, Rain and Water Fall
- Charging docking station for iPod
- Premium quality speakers plus subwoofer
- AM/FM radio with digital tuner
- Dual Alarm with Snooze
- Nap and Auto timer options: 15, 30, 45 or 60 minutes

- Four wake options – iPod, radio, beep or nature sound
- Easy-to-read clock with LCD display
- Bass and treble adjustment
- Projection feature projects time on the wall or ceiling
- Full function remote control

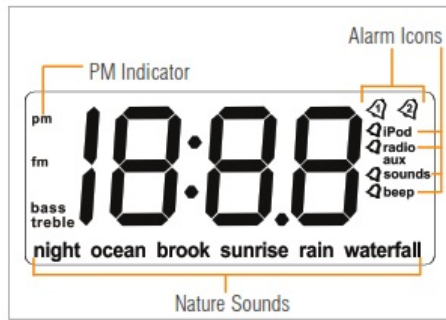

Figure 2

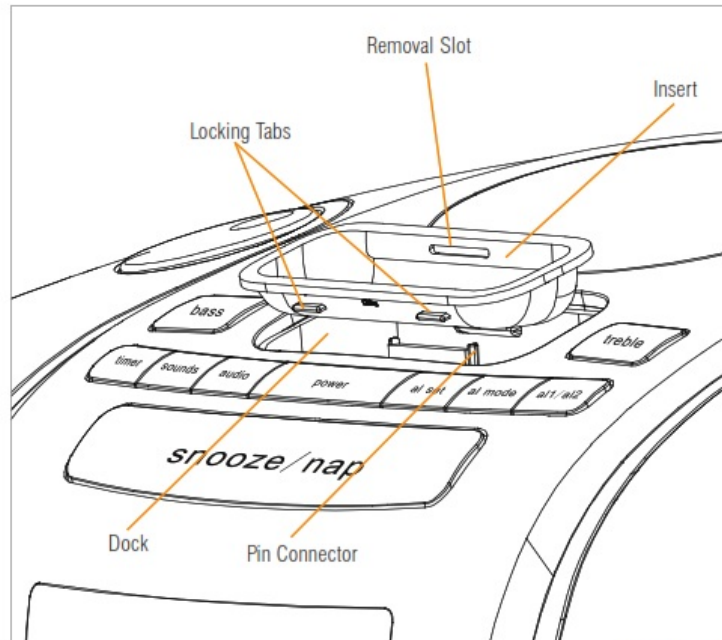

Figure 3

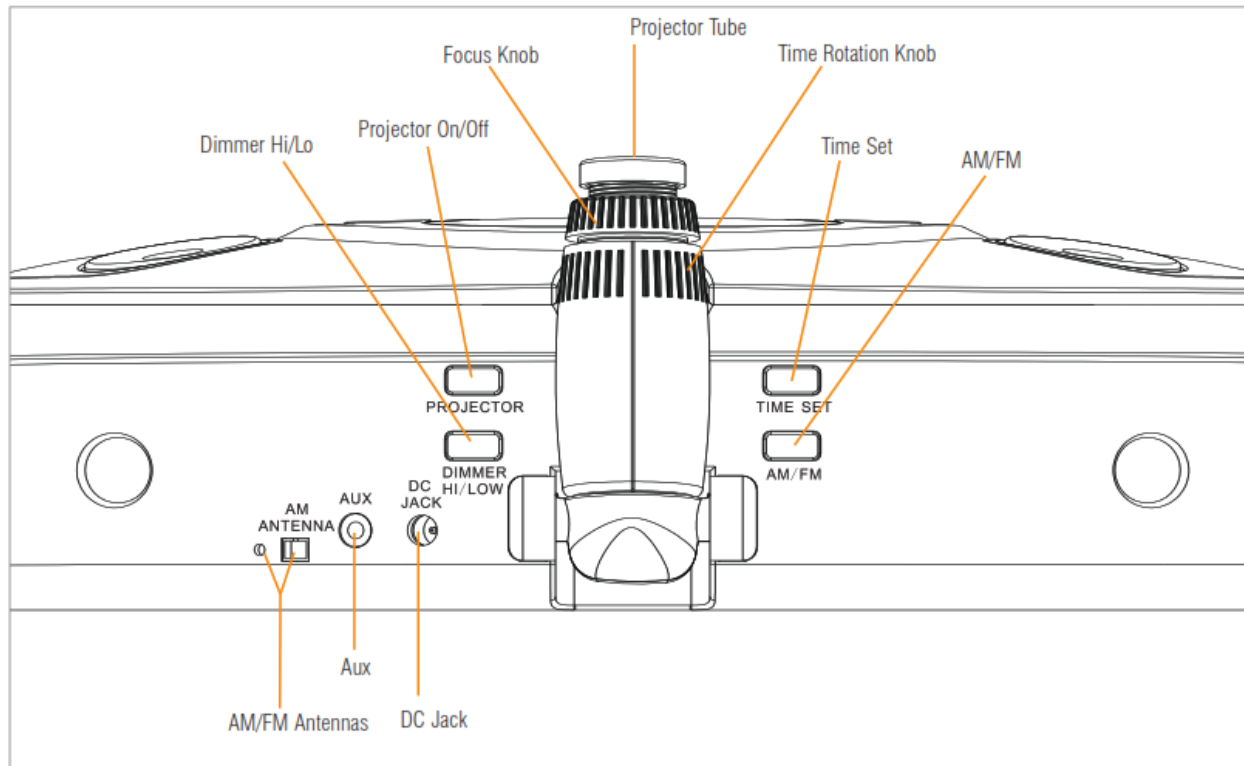

Figure 4

Before You Begin

The iSoundSpa Max uses a backup battery system to provide continuous alarm settings in the event of a power failure. Two “AA” batteries (included) must be inserted into the battery compartment if memory backup is desired.

When the backup batteries are installed: In the event of power outages or if the DC cord is accidentally disconnected, the LCD display will not be illuminated, but the current time and alarm settings will be temporarily maintained. As soon as the power supply returns, the LCD display will indicate the correct time.

Getting Started

Setting Clock Time

1. Press the TIME SET BUTTON located on the back of the unit (Fig. 4); hour digit will begin flashing. Turn the SET +/- KNOB until the current hour is displayed. Remember to set the correct AM or PM (an icon in the upper left of the time display is the PM INDICATOR; there is no AM indicator) (Fig. 2).
2. Press the TIME SET BUTTON again; minute digits will begin flashing. Turn the SET +/- KNOB until the current minute is displayed.
3. Press the TIME SET BUTTON again to exit the clock setting mode or after 5 seconds the display will stop flashing to indicate the time is set.

Install/Replace Backup Battery

1. Make sure the DC adaptor is connected. Otherwise, the time setting may be lost during battery replacement.
2. Open the battery compartment cover located on the bottom of the unit.
3. Insert two "AA" batteries, checking that the positive polarity follows the direction of the instructions inside the battery compartment.
4. Close the compartment cover.

Note: Batteries must be installed in order for time & alarm memory backup to operate. In the event of a power failure or disconnection, if the battery is not installed, the clock and alarm will need to be reset when power is restored.

Battery Precautions

- Use only the size and type of batteries specified.
- When installing batteries, observe proper +/- polarities. Incorrect installation of battery may cause damage to the unit.
- Do not mix different types of batteries together (e.g., alkaline with carbon-zinc or old batteries with new ones).
- If the unit is not going to be used for a long period of time, remove batteries to prevent damage due to possible battery leakage.
- Do not dispose of batteries in fire. Batteries may explode or leak.

Charging your iPod/ iPhone™

1. Select the correct insert for your particular iPod model from among the 7 different inserts included (Fig. 1). Each insert is labeled with the name and/or size of an iPod model. Place the selected insert in the docking area so that the iPod 30-pin connector passes through the opening in the insert (Fig. 3). iPhone inserts not included. You may contact HoMedics Consumer Relations at 1-800-466-3342 to order the correct insert for your iPod/iPhone.

Note: Make sure you are using the correct insert for your iPod/iPhone (see chart) and that it is properly docked

into the iSoundSpa Max. Failure to do so may damage your iPod/iPhone.

WARNING: INSERTS ARE DESIGNED FOR APPLE IPOD MUSIC PLAYERS ONLY. ATTEMPTING TO ATTACH OR FORCE ANY NON- IPOD MUSIC PLAYER INTO ANY OF THE ENCLOSED INSERTS WILL DAMAGE AND EVEN DESTROY YOUR DEVICE.

Insert Label	iPod Models
nano	iPod Nano
2G nano	iPod Nano 2nd Generation
mini	iPod Mini
10G-30G	3G iPod (10GB, 15GB, 20GB), 4G iPod (20GB), U2 iPod (20GB), iPod Photo (20GB,30GB), Color U2 iPod (20GB), Color Display (20GB)
30G Video	5G iPod with Video (30GB), U2 iPod with Video
40G-60G	3G iPod (30GB, 40GB), 4G iPod (40GB), Ipod Photo (40GB, 60GB), Color Display (60GB)
60G Video	5G iPod with video (60GB, 80GB)

2. Carefully place your iPod/iPhone into the docking area so that the 30-pin connector in the dock is fully connected to the 30-pin socket on the bottom of your iPod/iPhone. (The iPod/iPhone must not be in a case or “skin”). You will hear a “chirp”, indicating that your iPod is properly connected.

NOTE: When you dock your iPod/iPhone it recharges (until fully charged).

FOR IPHONE USERS ONLY:

Once properly connected, your iPhone will ask you if you’d like to turn on Airplane Mode. Select “Yes” (Fig. 5). When your iPhone is set to Airplane Mode, no cell phone, radio, Wi-Fi, or Bluetooth signals are emitted from iPhone. As a result, all incoming calls will be sent directly to voicemail.

NOTE: If iPhone is already in Airplane Mode you will just need to click “OK”.

Figure 5



3. To remove/replace an insert, first remove your iPod/iPhone, then place fingernail in slot on insert (Fig. 3) and gently pull up.

Important: The iPod Shuffle will NOT charge or dock. See Listening to a non-docking iPod (page 10)

Listening to Your iPod/iPhone

1. Press the POWER BUTTON (Fig. 1) on the iSoundSpa Max to turn it on.
2. Toggle through the AUDIO BUTTON (Fig. 1) to play the iPod/iPhone. The iPod ICON will appear on the LCD display in the upper right corner to indicate that the iPod mode has been selected (Fig. 2).
Note: When the iPod/iPhone is docked and in standby mode, it will automatically begin playing once the iPod mode is selected on the unit.
3. Press the PLAY/PAUSE button on your iPod/iPhone to pause play; press again to resume play.
4. Turn the VOLUME KNOB (Fig. 1) on the unit to adjust the system volume.
5. Press the ◀◀ or ▶▶ on your iPod/iPhone to go to the next or previous track.
6. To turn off the unit, press the POWER BUTTON. The iPod/iPhone will continue charging in the dock.

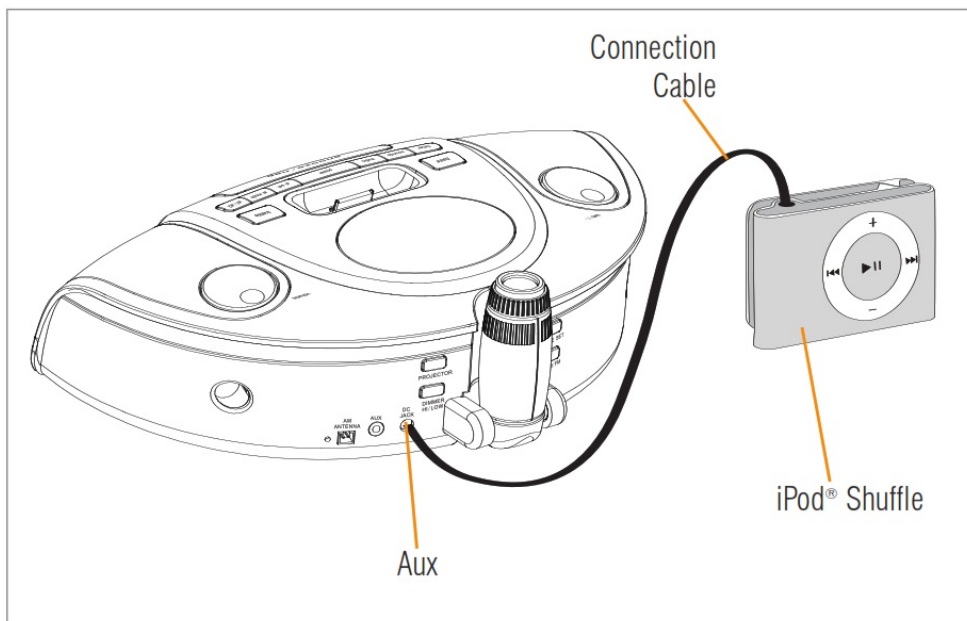

Figure 6

Listening to a non-docking iPod or other portable audio devices

If you are using an iPod without a docking port, other MP3 players, or other portable audio devices, you can play it through the iSoundSpa Max via the Aux Jack (Fig. 6) located on the back of the unit.

1. Plug one end of the Connection Cable (included) (Fig. 1) into the headphone or line-out jack on your MP3 device and the other end of the Connection Cable into the iSoundSpa Max Aux jack, located on the back of the unit (Fig. 6).
2. Press the POWER BUTTON (Fig. 1) on the unit to turn it on.
3. Toggle through the AUDIO BUTTON (Fig. 1) on the unit until you reach the auxiliary mode. The AUX ICON will appear on the right side of the LCD display to indicate that the auxiliary mode has been selected (Fig. 2).
4. Turn on and play your MP3 device.
5. Use the VOLUME KNOB (Fig. 1) on the unit to adjust the system volume.
Note: You may need to adjust the volume on your MP3 device also.
6. To turn off the unit, press the POWER BUTTON.
Note: You also need to turn off your MP3 device.

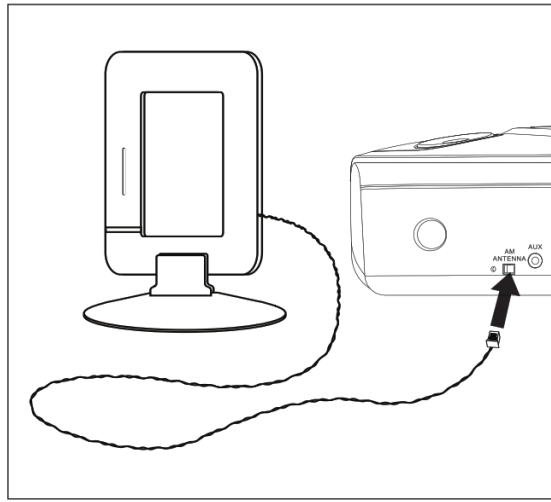

Figure 7

Listening to the Radio

Extend FM wire antenna fully for best FM reception (do not strip, alter or attach to other antennas). Snap the AM loop antenna into the base provided. Next, plug the AM loop antenna into the connector located on the back of the unit for best AM reception (Fig 7).

1. Press the POWER BUTTON (Fig. 1) on the unit to turn it on.
2. Toggle through the AUDIO BUTTON (Fig. 1) to play the radio. The RADIO ICON will appear on the right side of the LCD display to indicate that the radio is on (Fig. 2).
3. Press the AM/FM BUTTON (Fig. 4) located on the back of the unit to select AM or FM band. The FM ICON will appear on the left side of the LCD to indicate FM radio is selected; there is no AM indicator.
4. Turn the SET +/- KNOB (Fig. 1) on the unit to tune in the desired station.
5. Turn the VOLUME KNOB (Fig. 1) on the unit to adjust the system volume.
6. To turn off the unit, press the POWER BUTTON.

Listening to Nature Sounds

1. Press the POWER BUTTON (Fig. 1) on the unit to turn it on.
2. Toggle through the SOUND BUTTON (Fig. 1) on the unit until you reach the natural sound you wish to listen to. The SOUND ICON will appear on the lower bottom of the LCD to indicate which nature sound has been selected (Fig. 2).
3. Turn the VOLUME KNOB (Fig. 1) on the unit to adjust the system volume.
4. To turn off the nature sounds, press the POWER BUTTON to turn the unit off, or switch the audio mode by pressing the AUDIO BUTTON (Fig. 1).

Note: When the unit is turned on, it will always default to the last mode used.

Adjusting Bass and Treble

It is recommended that you adjust the bass & treble while listening to the iSoundSpa Max.

1. Press the BASS BUTTON (Fig. 1) on the unit. The BASS ICON will appear on the left side of the LCD (Fig. 2)

to indicate the bass is selected and bass level will appear on the LCD display.

2. While bass level appears on LCD display, turn the SET +/- KNOB (Fig. 1) on the unit to adjust the bass (from -8 to 8). After 5 seconds the BASS ICON and bass level will disappear to indicate the bass level is set.
3. Press the TREBLE BUTTON (Fig. 1) on the unit. The TREBLE ICON will appear on the left side of the LCD (Fig. 2) to indicate the treble is selected and the treble level will appear on the LCD display.
4. While treble level appears on LCD display, turn the SET +/- KNOB (Fig. 1) on the unit to adjust the treble (from -8 to 8). After 5 seconds the TREBLE ICON and treble level will disappear to indicate the treble level is set.

Using Auto-Timer

While listening to your iPod, the nature sounds, or the radio, you may set a timer so the unit will automatically turn off.

1. Toggle through the TIMER BUTTON (Fig. 1) until the time of your choice, 15, 30, 45, or 60 minutes, is shown on the LCD.
2. To cancel the timer, toggle through the TIMER BUTTON until OFF is shown on the LCD.

Setting And Using The Alarms

Setting Alarm1 or Alarm2 (Individually)

1. Toggle through the AL1/AL2 BUTTON (Fig.1) located on the top of the unit to AL1 or AL2. The AL1 BELL or AL2 BELL ICON will appear in the upper right corner on the LCD display to indicate which alarm is activated (Fig. 2).
2. Press the AL SET BUTTON (Fig. 1) twice; hour digits will begin flashing. Turn the SET +/- KNOB (Fig. 1) until the desired hour is displayed. Remember to set the correct AM or PM (an icon to the left of the time display is the PM INDICATOR; there is no AM indicator) (Fig. 2).
3. Press the AL SET BUTTON again; minute digits will begin flashing. Turn the SET +/- KNOB until the desired minute is displayed.
4. Press the AL SET BUTTON again to exit the alarm setting mode or after 5 seconds the display will stop flashing to indicate the alarm is set.

Note: You can press the AL SET BUTTON at any time to review the alarm setting.

5. Toggle through the AL MODE BUTTON (Fig. 1) until the WAKE MODE ICON appears on the right side of the LCD to indicate the wake mode of your choice: iPod, radio, sounds, or beep (Fig. 2).

Note: To wake to iPod/iPhone, your iPod/iPhone must be properly docked in the unit, or alarm will default to beep wake mode.

Note: When using the sound mode, the unit will set to the last sound you listened to. If you wish to change it, first, turn the power on, then press the sound you wish to wake to. Lastly, turn the power off.

6. When the alarm is sounding, press the POWER BUTTON on the unit to turn the alarm OFF (Fig. 1). The alarm will come on again the next day at the same time.
7. To stop the alarm from coming on the next day, toggle through the AL1/AL2 BUTTON located on the top of the unit until the AL1 & AL2 BELL ICONS disappear from the LCD display, indicating the alarm is disarmed.

Note: If the alarm sounds for 30 minutes continuously it will automatically turn off and reset to come on again at the same time the next day.

Setting Alarm1 and Alarm2 (Together)

1. Toggle through the AL1/AL2 BUTTON (Fig. 1) located on the top of the unit until BOTH AL1 & AL2 BELL ICONS appear on the LCD display to indicate both alarms are activated (Fig. 2).

Note: You cannot change the alarm time when BOTH are selected. If you need to change the alarm time for either alarm, follow step 1 under Setting Alarm 1 or Alarm 2 (Individually).

2. Toggle through the AL MODE BUTTON (Fig. 1) until the WAKE MODE ICON appears on the right side of the LCD to indicate the wake mode of your choice: iPod, radio, sounds, or beep (Fig. 2). Both AL1 & AL2 must wake to the same mode.

Note: To wake to iPod/iPhone, your iPod/iPhone must be properly docked in the unit, or alarm will default to beep wake mode.

Note: When using the sound mode, the unit will set to the last sound you listened to. If you wish to change it, first, turn the power on, then press the sound you wish to wake to. Lastly, turn the power off.

3. When the alarm is sounding, press the POWER BUTTON (Fig. 1) on the unit to turn the alarm OFF. The alarm will come on again the next day at the same time.
4. To stop the alarm from coming on the next day, toggle through the AL1/AL2 BUTTON (Fig. 1) located on the top of the unit until the AL1 & AL2 BELL ICONS disappear from the LCD display, indicating the alarms are disarmed.

Note: If one of the alarm users still needs their alarm set, you will need to toggle through the AL1/AL2 BUTTON located on top of the unit until the AL1 or AL2 BELL ICON appears the LCD to correspond to the alarm of their wake time.

Note: If the alarm sounds for 30 minutes continuously it will automatically turn off and reset to come on at the same time the next day.

Snooze Operation

1. Press the SNOOZE/NAP BUTTON (Fig. 1) on the unit while the alarm is sounding. The alarm will go off temporarily and will go on again in 9 minutes. You may use this feature until you turn the alarm off.

Note: To turn off the snooze function prior to the alarm activating, press the POWER BUTTON twice. The alarm will come on again the next day at the same time.

Nap Operation

The NAP TIMER FUNCTION will wake you after a nap of 15, 30, 45, or 60 minutes without the need to change your regular Alarm 1 or Alarm 2 settings.

1. If the system is playing, press the POWER BUTTON (Fig. 1) to off.
2. Toggle through the SNOOZE/NAP BUTTON (Fig. 1) until the corresponding time is shown on the LCD display.
3. Toggle through the AL MODE BUTTON (Fig. 1) until the WAKE MODE ICON appears on the right side of the LCD to indicate the wake mode of your choice: iPod, radio, sounds, or beep (Fig. 2).

Note: To wake to iPod/iPhone, your iPod/iPhone must be properly docked in the unit, or alarm will default to beep wake mode.

4. The alarm will sound to wake you up after the selected amount of minutes have passed.
5. To cancel the NAP TIMER, press the SNOOZE/NAP BUTTON until "OFF" appears on the LCD display to indicate the NAP function is disabled.

Dimmer Control

1. Press the DIMMER HI/LO BUTTON (Fig. 4) located on the back of the unit to adjust the backlight intensity of the LCD display.

Using the Projection Feature

1. To turn on the projection feature, press the PROJECTOR ON/OFF BUTTON (Fig. 4) located on the back of the unit. The time is now projected on the wall or ceiling.
2. The angle of the projector can be adjusted to angle on the ceiling or wall by moving the PROJECTOR TUBE (Fig. 4) forward or backward.
3. To turn the angle of the time that appears on the wall of ceiling, rotate the TIME ROTATION KNOB (Fig. 4) until you have reached your desired result.

Note: The TIME ROTATION KNOB will rotate up to 350 degrees.

4. To focus the time on the wall or ceiling rotate the FOCUS KNOB (Fig. 4) until you have reached your desired result.

Using the Remote Control

Install/Replace Remote Control Battery

One lithium battery is packaged with the remote. To begin using the remote, install the battery provided. When the remote stops operating or when the operating range is reduced, replace the battery with a new one.

1. Open the battery compartment cover located on the back of the remote.
2. Remove old battery from remote control.
3. Insert one 3-volt lithium battery, Model #: CR2025, checking that positive polarity faces towards you.
4. Close the compartment cover.

Use the remote to control the following functions of your iSoundSpa Max. (For best results, aim remote control toward the front of the unit.)

NOTE: Double-sided velcro included for mounting remote, if desired.

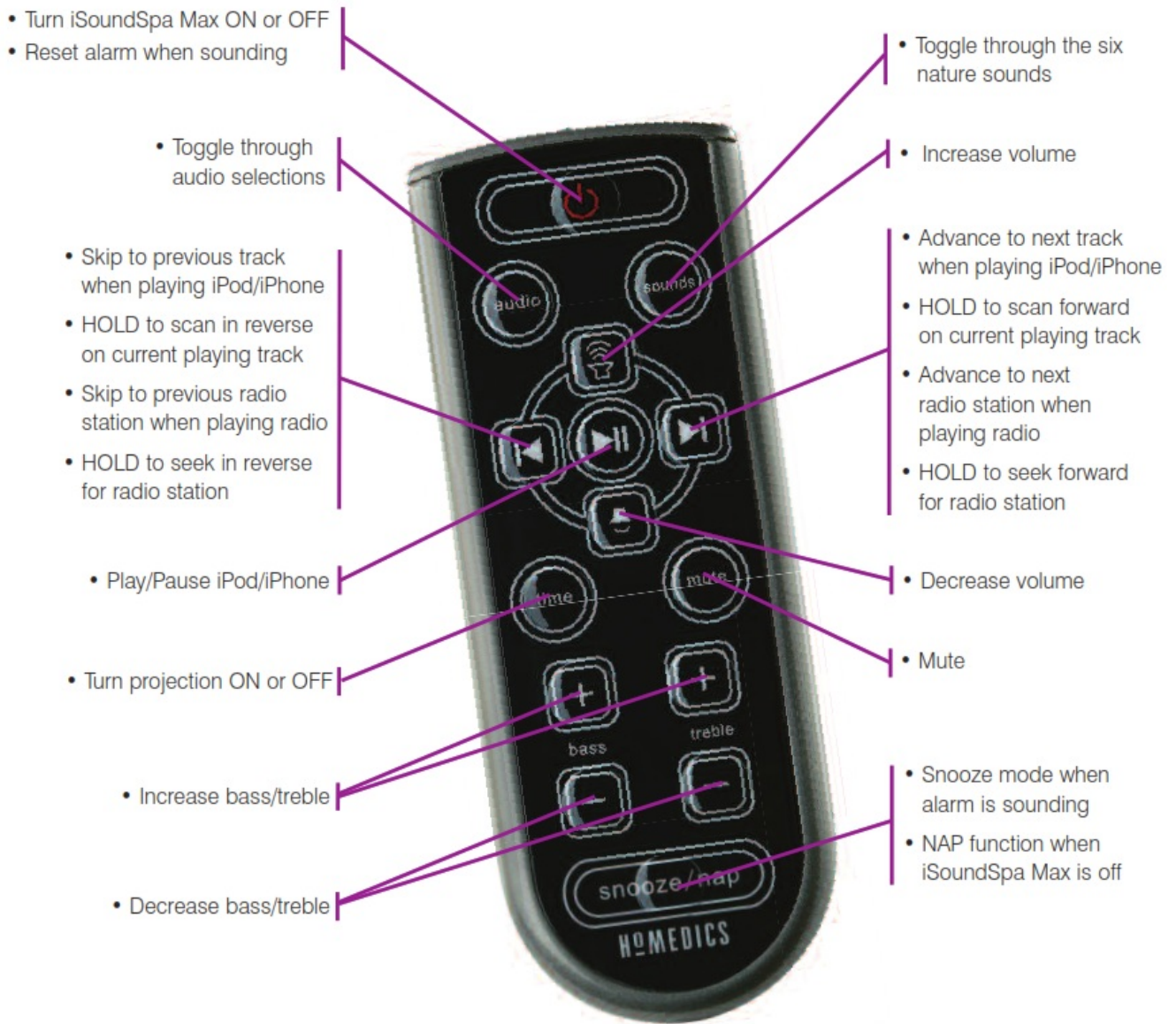

Maintenance

To Store

You may leave the unit on display, or you can store it in its box in a cool, dry place.

To Clean

Use only a soft dry cloth to clean the enclosure of the unit.

NEVER use liquids or abrasive cleaner to clean. Modifications not authorized by the manufacturer may void warranty.

Note: This equipment has been tested and found to comply with the limits for a Class B digital device, pursuant to Part 15 of the FCC Rules. These limits are designed to provide reasonable protection against harmful interference in a residential installation. This equipment generates, uses, and can radiate radio frequency energy and, if not installed and used in accordance with the instructions, may cause harmful interference to radio communications. However, there is no guarantee that interference will not occur in a particular installation. If this equipment does cause harmful interference to radio or television reception, which can be determined by turning the equipment off and on, the user is encouraged to try to correct the interference by one or more of the following measures:

- Reorient or relocate the receiving antenna.
- Increase the separation between the equipment and receiver.
- Connect the equipment into an outlet on a circuit different from that to which the receiver is connected.
- Consult the dealer or an experienced radio/TV technician for help

LIMITED ONE YEAR WARRANTY

HoMedics sells its products with the intent that they are free of defects in manufacture and workmanship for a period of one year from the date of original purchase, except as noted below. HoMedics warrants that its products will be free of defects in material and workmanship under normal use and service. This warranty extends only to consumers and does not extend to Retailers.

To obtain warranty service on your HoMedics product, mail the product and your dated sales receipt (as proof of purchase), postpaid, to the following address:

HoMedics Consumer Relations
Service Center Dept. 168
3000 Pontiac Trail
Commerce Township, MI 48390
No COD's will be accepted.

HoMedics does not authorize anyone, including, but not limited to, Retailers, the subsequent consumer purchaser of the product from a Retailer or remote purchasers, to obligate HoMedics in any way beyond the terms set forth herein. This warranty does not cover damage caused by misuse or abuse; accident; the attachment of any unauthorized accessory; alteration to the product; improper installation; unauthorized repairs or modifications; improper use of electrical/power supply; loss of power; dropped product; malfunction or damage of an operating part from failure to provide manufacturer's recommended maintenance; transportation damage; theft; neglect; vandalism; or environmental conditions; loss of use during the period the product is at a repair facility or otherwise awaiting parts or repair; or any other conditions whatsoever that are beyond the control of HoMedics.

This warranty is effective only if the product is purchased and operated in the country in which the product is purchased. A product that requires modifications or adoption to enable it to operate in any other country than the country for which it was designed, manufactured, approved, and/or authorized, or repair of products damaged by these modifications is not covered under this warranty.

THE WARRANTY PROVIDED HEREIN SHALL BE THE SOLE AND EXCLUSIVE WARRANTY. THERE SHALL BE NO OTHER WARRANTIES EXPRESS OR IMPLIED INCLUDING ANY IMPLIED WARRANTY OF MERCHANTABILITY OR FITNESS OR ANY OTHER OBLIGATION ON THE PART OF THE COMPANY WITH RESPECT TO PRODUCTS COVERED BY THIS WARRANTY. HOMEDICS SHALL HAVE NO LIABILITY FOR ANY INCIDENTAL, CONSEQUENTIAL, OR SPECIAL DAMAGES. IN NO EVENT SHALL THIS WARRANTY REQUIRE MORE THAN THE REPAIR OR REPLACEMENT OF ANY PART OR PARTS WHICH ARE FOUND TO BE DEFECTIVE WITHIN THE EFFECTIVE PERIOD OF THE WARRANTY. NO REFUNDS WILL BE GIVEN. IF REPLACEMENT PARTS FOR DEFECTIVE MATERIALS ARE NOT AVAILABLE, HOMEDICS RESERVES THE RIGHT TO MAKE PRODUCT SUBSTITUTIONS IN LIEU OF REPAIR OR REPLACEMENT.

This warranty does not extend to the purchase of opened, used, repaired, repackaged, and/or resealed products, including but not limited to sale of such products on Internet auction sites and/or sales of such products by surplus or bulk resellers. Any and all warranties or guarantees shall immediately cease and terminate as to any products or parts thereof which are repaired, replaced, altered, or modified, without the prior express and written consent of HoMedics.

This warranty provides you with specific legal rights. You may have additional rights which may vary from country to country. Because of individual country regulations, some of the above limitations and exclusions may not apply to you.

For more information regarding our product line in the USA, please visit: www.homedics.com

HoMedics Service Center
1.800.466.3342
8:30 – 5:00 p.m. (EST) M – F
Mail To:
HoMedics

Consumer Relations
Service Center Dept. 168
3000 Pontiac Trail
Commerce Township, MI 48390
e-mail: cservice@homedics.com

©2007 HoMedics, Inc. and its affiliated companies, all rights reserved.
HoMedics® is a registered trademark of HoMedics, Inc. and its affiliated companies.
iSoundSpa™ is a trademark of HoMedics, Inc. and its affiliated companies.
All rights reserved.
iPod®, iPod nano®, nano®, iPhone™ and the iPod® design are trademarks of Apple Inc.
IB-SS8000A

Homedics SS-8000 iSoundSpa Max Time Projection Sound Machine with Remote Control and Dock for iPod
Instruction Manual and Warranty Information – [Download \[optimized\]](#)
Homedics SS-8000 iSoundSpa Max Time Projection Sound Machine with Remote Control and Dock for iPod
Instruction Manual and Warranty Information – [Download](#)

Manuals+.