



Home2Link Nuki app for iOS or Android smartphones Installation Guide

[Home](#) » [Home2Link](#) » Home2Link Nuki app for iOS or Android smartphones Installation Guide 



Contents

- [1 Installation instructions Nuki Opener](#)
- [2 Installation](#)
- [3 Power supply](#)
- [4 Where to find the brand and model of the intercom](#)
- [5 Documents / Resources](#)
 - [5.1 References](#)
- [6 Related Posts](#)

Installation instructions Nuki Opener

The setup and administration of the Nuki Opener is done via the Nuki app for iOS or Android smartphones. Open the Nuki app and select “Manage my devices” from the menu, then choose the Nuki Opener. Follow the instructions in the Nuki app to install and configure the Nuki Opener.

The Nuki Opener has been designed to be compatible with the entire Nuki product range.

So if you already have a Smart Lock and a Nuki Bridge in use, you can connect your Opener to the same Bridge to control it remotely.

Installation

The Nuki Opener is connected using the screw terminals that are already present in the intercom. The corresponding installation instructions can be found in the Nuki app for iOS or Android smartphones. Please only use the wiring diagrams specified by us.

Only use the Nuki Opener with intercom systems with a maximum voltage of 50 V AC/DC and a maximum current

of 2 A.

The Nuki Opener can be glued or screwed to the wall. For installations with an adhesive pad, the surface must be even and free from grease, dust, and dirt. Alternatively, the Nuki Opener can be screwed on. You can either use the included screws and dowels, or other installation materials that are appropriate for the wall texture.

Power supply

The Nuki Opener is operated by four AAA batteries; no power is drawn from the building system. This prevents power theft and you can also install the Nuki Opener without your landlord's approval.

The batteries are included in the scope of delivery and are already inserted in the device. To replace the batteries, the cover of the Nuki Opener can be lifted off.

Alternatively, the Nuki Opener can be operated with 5 V using a micro USB cable (not included with delivery).

Where to find the brand and model of the intercom

The brand or manufacturer of your intercom system can usually be found on the outside of the housing. The corresponding model number can be found on the main board of your intercom system. Your intercom can be opened in a few simple steps so that you can find the model number.

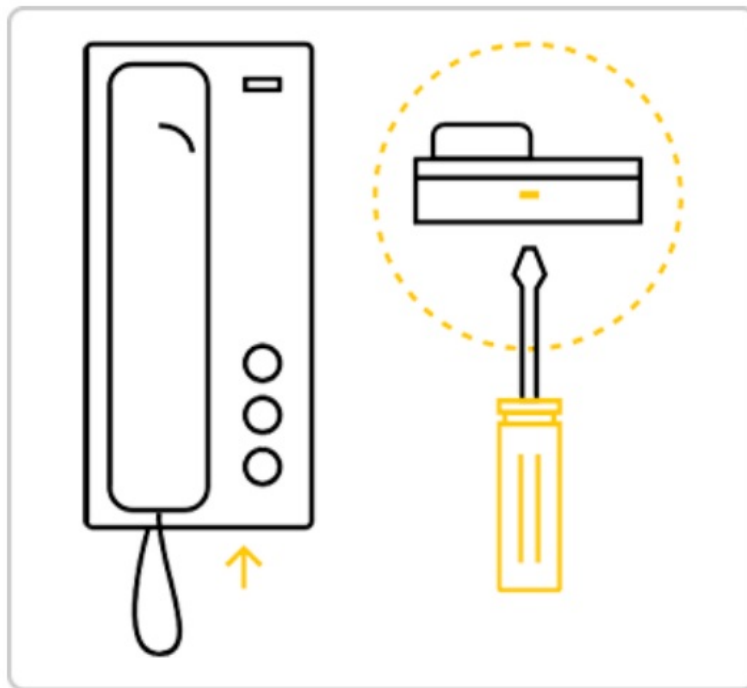

The housing of the intercom system is usually clipped or screwed on. First remove the screws.

If the housing is clipped on, press the enclosed screwdriver carefully into the hole on the bottom of the housing and lift the housing up. You can simply leave the handset hanging down.

Home2Link B.V.

Tingjetersweg 107 2031 ER HAARLEM Tel: (085) 029 05 78

Postbus 2103 2002 CC HAARLEM www.home2link.nl info@home2link.nl

Documents / Resources

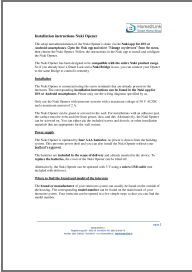
	<p>Home2Link Nuki app for iOS or Android smartphones [pdf] Installation Guide</p> <p>Home2Link, Nuki, app, iOS, Android, smartphones</p>
--	--

References

- info@home2link.nl
- [Home2Link | Home2Link is een Smart Home Shop voor huisautomatisering. Een Smart Home biedt Comfort, Gemak, Veiligheid en Energiebesparing. Met één systeem, één app op je Tablet of Smartphone, controle over je Smart Home.](#)