

# HOLSEM-A6 LED Display User Guide

[Home](#) » [HOLSEM](#) » HOLSEM-A6 LED Display User Guide 

## Contents

### 1 HOLSEM-A6 LED DISPLAY User Guide

- 1.1 Product Structure Diagram
- 1.2 Cautions
- 1.3 Security Warnings
- 1.4 Before the first use
- 1.5 Preparing for use
- 1.6 Use the appliance
- 1.7 Care and Maintenance
- 1.8 Technical Specifications
- 1.9 Troubleshooting
- 2 Documents / Resources
- 3 Related Posts

## HOLSEM-A6 LED DISPLAY User Guide

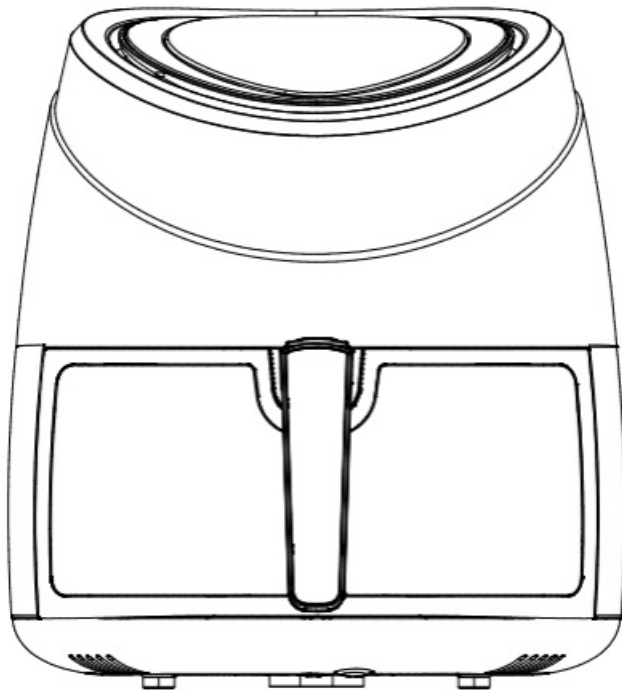

### Note:

Please read carefully the instruction manual before using the appliance. Keep the manual for reference in future.

Your easy and healthy cooking experience starts from here.

## Product Structure Diagram

1. Fry basket
2. Protective cover
3. Push-release button
4. Handle bar
5. Fry pot
6. Top cap
7. Control panel
8. Air inlet
9. Temperature increase button
10. Temperature decrease button
11. Mode selection button
12. ON/OFF button
13. Keep warm 2 hours bottom
14. Time increase button
15. Time decrease button
16. Air outlet
17. Power cable

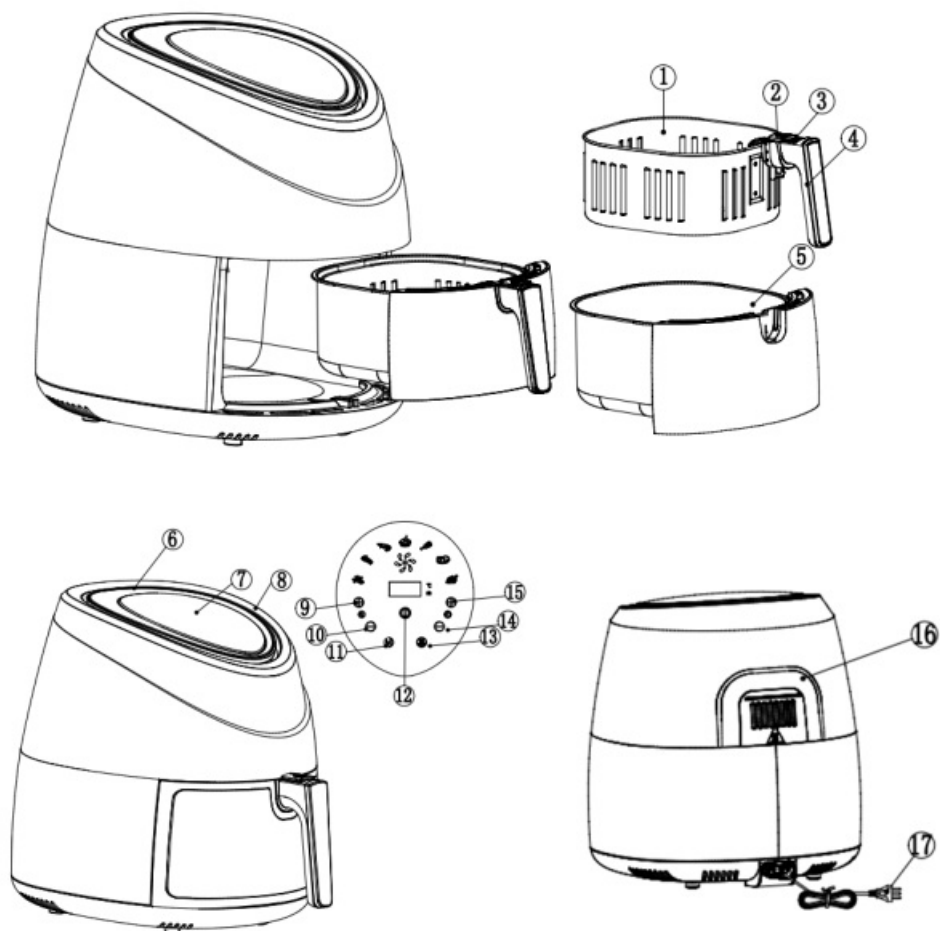

## **Cautions**

- Please carefully read the instruction manual, before using the appliance. Keep the manual for reference in future;
- Never fill the Fry Pot with oil, or it may cause a fire hazard;
- The appliance main body contains electronic elements and heating
- The appliance main body contains electronic elements and heating elements. Do not put it in water or wash by water;
- Product surfaces get hot when the appliance is operating. Do not touch the hot surfaces. Operate by using handle.
- Do not cover the air inlet and outlet during the operating process. Do not touch the inside of the appliance to avoid burns and scalds;
- High temperature air will flow out from the outlet when the appliance is in use. Please keep safety distance. Do not touch the hot surfaces, Do not get close to the air outlet. When pulling out the fry pot, please be careful of high temperature air.

## **Security Warnings**

- Do not use the AC power other than 120V to avoid electric shock, fire and other accident.
- Please only plug to an wall outlet above 15A. To ensure continued protection against risk of electric shock, connect to properly grounded power socket only.
- Please keep the plug clean and avoid accident.
- Do not damage, strongly pull or twist the power cord. Do not use it carry heavy loads, or transform it, let the cord hang over edge of table or counter. Do not touch hot surfaces, to avoid electric shock, fire and other accidents. Damaged power cord must be repaired by professional maintenance technicians.
- Please do not plug and unplug with wet hands, otherwise it may cause electric shock;
- Plug tightly, otherwise, it may cause electric shock, short circuit, smoking, sparking and other dangers;
- Do not immerse the appliance, main body, cord or plug in water or other liquid, to protect against electrical shock and malfunction.
- Do not place the appliance in the presence of explosive and /or flammable fumes.
- Do not place the appliance on or near the flammable material, such as tablecloths, curtains and others, to avoid fire hazard;
- Be sure to use on a heat resistant and even surface, keep the appliance at least 30cm away from the wall, furniture or other flammables;
- Do not use the appliance for other than intended use;
- Physical or mental disabled persons or those lack in knowledge of this item must be guided by persons who have experience with this appliance and who will be responsible for their safety.
- Do not allow children to play with the socket or plug to avoid electric shock.
- Keep the appliance away from children to avoid scalding, electric shock and/or other injuries; close supervision is necessary when the appliance is used by or near children;
- This appliances is intended for Household Use Only.

## **Before the first use**

1. Remove all packaging material.
2. Remove the stickers or labels from the appliance
3. Thoroughly clean the basket and the pan with hot water, some washing-up liquid and a non-abrasive sponge.
4. Wipe the inside and outside of the appliance with a moist cloth.

## Preparing for use

1. Place the appliance on a stable and flat surface.

Note: Do not place the appliance on non-heat-resistant surface. The appliance works with good air circulation so keep it away from hot surface, and any combustible materials.

2. Place the basket in the pan properly- you will hear click sound. Slide the pan back to the appliance.

**Note: This appliance works with hot air. Do not fill the pan with oil or frying fat.**

**Do not put anything on the top of the appliance. This disrupts the airflow and affects the hot air frying result.**

## Use the appliance

1. Put the mains plug in an earthed wall socket.
2. Click the ON/OFF button.
3. Click Temperature increase/decrease button to set proper temperature for cooking.
4. Click Timer Decrease Button to set 5 minutes for preheating. Click the ON/OFF button once more to start cooking. After this the device is ready for use.
5. When the time to 0, carefully pull the fry pot out of the appliance, place the ingredients inside the fry basket (Attention: do not exceed the maximum line), well connect the fry basket with fry pot, slide the pan back to the appliance.
  - a) Never use the pan without the basket in it.
  - b) Do not touch the pan during and some time after use, as it gets very hot. Only hold the pan by the handle.
6. Click the mode selection button to switch and choose appropriate cooking mode or click temperature increase/decrease button & time increase/decrease button to choose appropriate time & temperature.
7. Click the ON/OFF button once more to start cooking.
8. When you hear the timer beep, the set preparation time has elapsed. Pull the pot out of appliance and place it on a heat-resistant surface.
9. Check if the ingredients are ready. If the ingredients are not ready yet, simply slide the pan back into the appliance and set the timer to a few extra minutes.
10. If the ingredients ready, carefully pull out the pan, and press the basket release button and lift the basket out of pan to remove the ingredients. Do not turn the basket upside down with the pan still attached to it, as any excess oil that has collected on the bottom of the pan will leak onto the ingredients.
11. Empty the basket into a bowl or onto a plate. When a batch of ingredients is ready, the appliance is instantly ready for preparing another batch.

### Tips:

- Add some oil on the ingredients for a crispy result..
- Shaking ingredients halfway during the preparation time optimize the end result and can help prevent unevenly

fried ingredients. To shake the ingredients, pull the pan out of the appliance by the handle and shake it. Then slide the pan back into the appliance. Do not press the basket release button during shaking.

## Care and Maintenance

Note: Clean the appliance after every use.

1. Before cleaning, turn the timer to 0, unplug the appliance and waiting for the appliance to cool down. Don't touch the surface before it cools down.
2. Do not immerse the device in water or any other liquid. The device is not dishwasher proof.
3. Clean the surface of the fryer pot and basket with hot water, some dish washing liquid and a non-abrasive sponge.

*Tip: If dirt is stuck to the basket or the bottom of the pan, fill the pan with hot water with some washing liquid. Put the basket in the pan and let the pan and basket soak for about 10 minutes.*

4. Used damp cloth to wipe the surface of the fryer. Never use harsh and abrasive cleaners, metal kitchen utensils or abrasive cleaning materials, which damages the device.
5. If you do not plan to use the appliance for a long time, please clean it, and store it in a cool and dry place.

## Technical Specifications

### Specifications:

Rated Voltage: 220V~  
Rated frequency: 60Hz  
Rated power: 1800W  
Fry basket capacity: 5.5QT  
Net weight: 12lbs  
Adjustable temperature: 180-400°F  
Timer: 0-60min  
Product Size: 16.61\*13.11\*14.48inch

## Troubleshooting

Problem	Possible Cause	Solution
Does not work	● Power cord has not been inserted into the power socket	● Closely insert the power cord into the grounded power socket.
	● Did not set the cook mode	● Set the timer to desired cooking time, then the appliance able to connect with power.
	● Didn't click the ON/OFF button after select cook mode	● Click the ON/OFF button
Food is rare when time out	● Too much food in the basket	● Fry food in turns
	● Temperature set is too low	● Set to an appropriate temperature, re-fry food.
	● Cooking time is short	● Set an appropriate cooking time, re-fry food.
Did not fry food evenly	● Certain foods need to be shaken in the middle of cooking.	● In the middle of cooking process, pull the pot out and shake it to separate the overlapped food material, then push the pot back to continue.
Fried food is not crisp	● Some food materials have to be fried with oil	● Plush a thin layer of oil on the surface of the food first, then start to fry them.
Can not smoothly push the pot back to appliance	● The pot with too many food materials is too heavy	● The food material in the basket can not exceed the max. line.
	● The basket is not correctly placed in the pot.	● Press the basket into the pot.
	● Handle bar stuck	● Place the handle bar in horizontal position.
Smoking	● Frying oily food	● Normal phenomenon.
	● Fryer contain oil from last use	● Please clean the pot and basket after use.



#### Correct Disposal of this appliance:

This marking indicates that this appliance should not be disposed with other household wastes. To prevent possible harm to the environment or human health from uncontrolled waste disposal, recycle it responsibly to promote the sustainable reuse of material resources.



**HOLSEM**

#### Your Safe is Our Priority

Add: 1045 E. Valley Blvd. A112, San Gabriel, CA 91776, United States

Email: [customerservice@holsem.com](mailto:customerservice@holsem.com)

#### Documents / Resources

HOLSEM

**User Guide**

HOLSEM-A6 LED DISPLAY



[HOLSEM HOLSEM-A6 LED Display](#) [pdf] User Guide  
HOLSEM, HOLSEM-A6, LED Display