



HOLMAN WX1 Tap Timer and Wi-Fi Hub Setup Apps User Guide

[Home](#) » [Holman](#) » HOLMAN WX1 Tap Timer and Wi-Fi Hub Setup Apps User Guide 



For the #SMARTGARDENER



Contents

- [1 ADDING YOUR Wi-Fi HUB TO HOLMAN HOME USING AP MODE](#)
- [2 ADDING YOUR WX1 TAP TIMER AND Wi-Fi SOCKET TO HOLMAN HOME](#)
- [3 Documents / Resources](#)
 - [3.1 References](#)
- [4 Related Posts](#)

ADDING YOUR Wi-Fi HUB TO HOLMAN HOME USING AP MODE

1. Plug your Wi-Fi Hub into a power source near your Wi-Fi router
2. Open Holman Home and add a new device by tapping plus [a] on the HOME screen

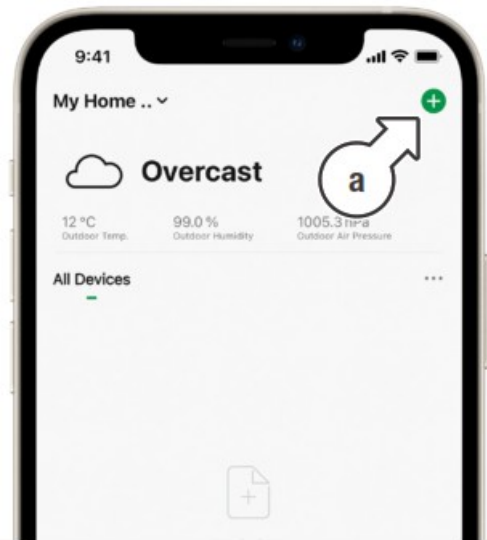

3. Tap **GARDEN WATERING** [b] and choose Wi-Fi HUB [c]



4. Enter your Wi-Fi network [d] and password [e], then tap NEXT [f]

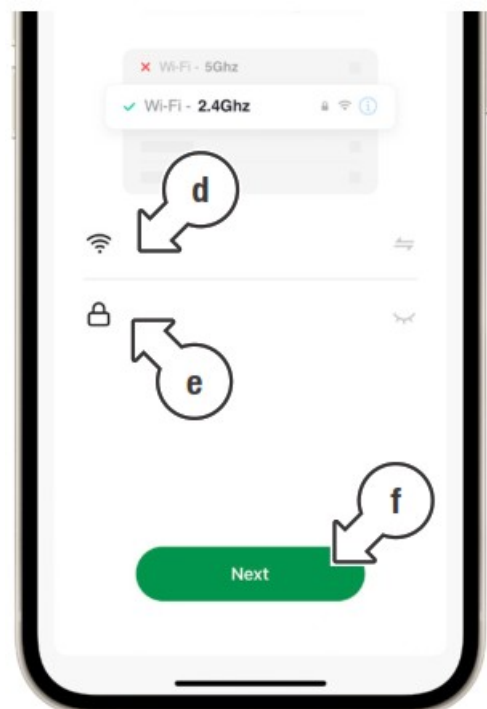

5. On the following screen, tap EZ MODE [g]
6. From the drop-down menu, tap AP MODE [h]

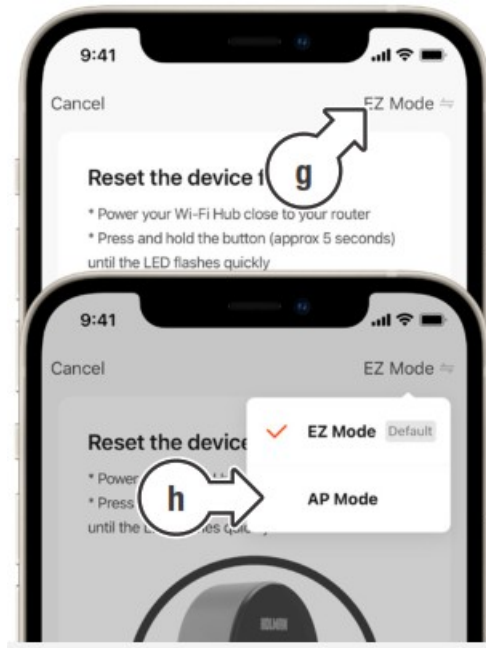

7. Reset the Wi-Fi Hub as per the instructions provided on-screen [i]
8. Once the Wi-Fi Hub is flashing accordingly, check the LED confirmation toggle [j] and tap NEXT [k]



The Wi-Fi Hub has three flashing modes:

- Fast flash
- Slow flash
- Slow long blink



9. On the following screen, tap GO TO CONNECT [l]

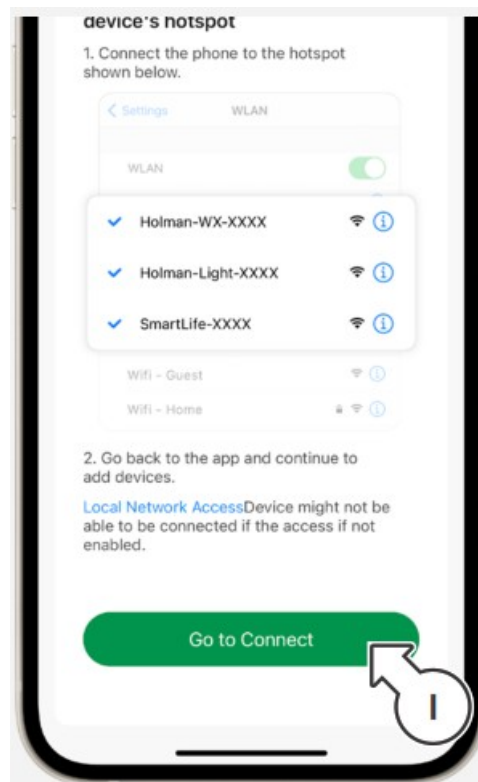

10.  apple iOS only: If redirected to SETTINGS, tap Wi-Fi [m]

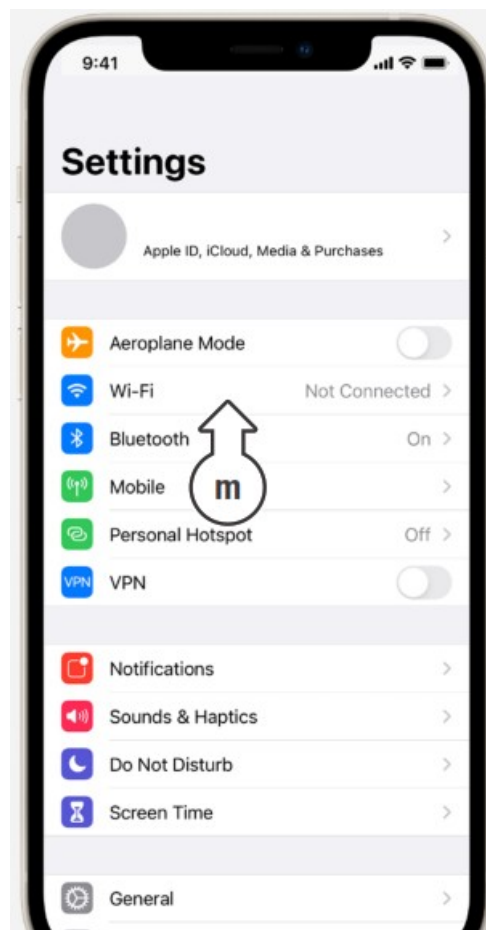

11.  apple iOS only: Tap Holman-WX-XXXX [n] and wait until the network is connected

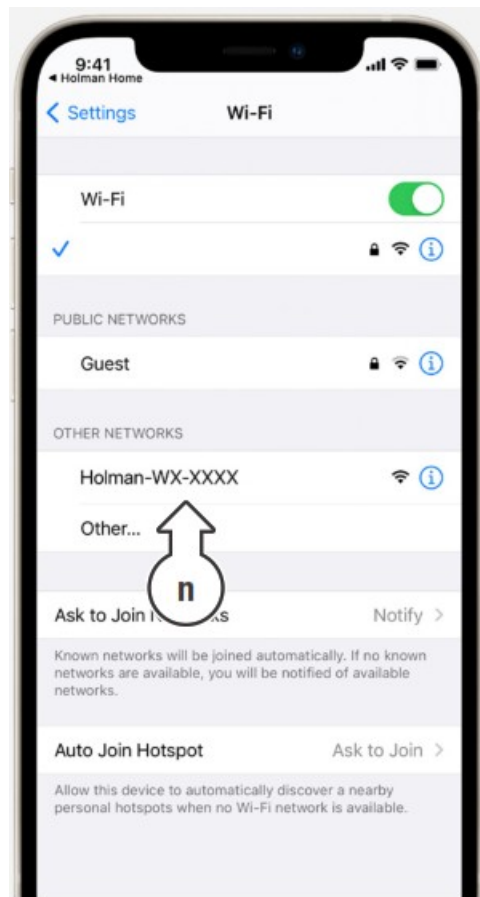

12.  android Android only: Tap the Holman-WX-XXXX [o] and wait until the network is connected

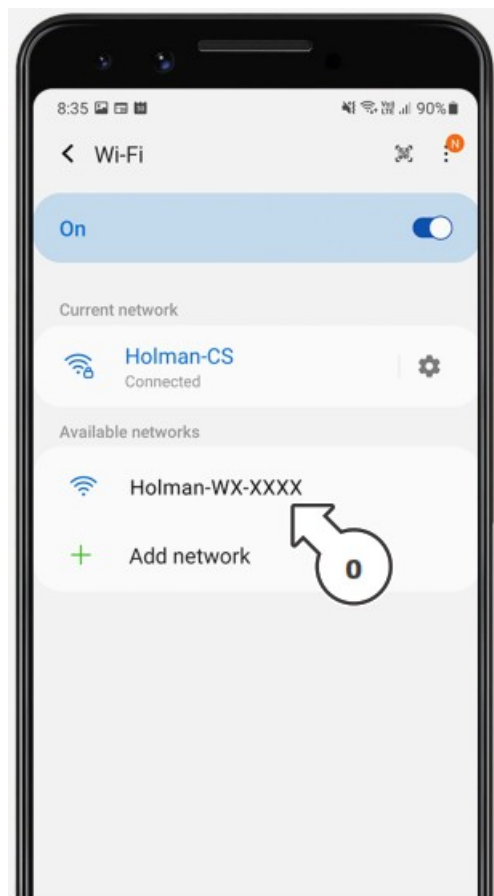

apple iOS or android Android: If the Holman-WX-XXXX network does not show in your Wi-Fi settings, try the following:



Disable Wi-Fi on your smartphone, wait a few moments and turn Wi-Fi back on



You may need to reset your Wi-Fi Hub again; Hold the button for approximately 5 seconds to change to fast-flash mode, then hold the button again for approx 5 seconds to change back to slow-flash mode



13. android Android only: Ignore messages such as “Connected without internet” and tap chevron-left in the Android nav bar to ignore[p]

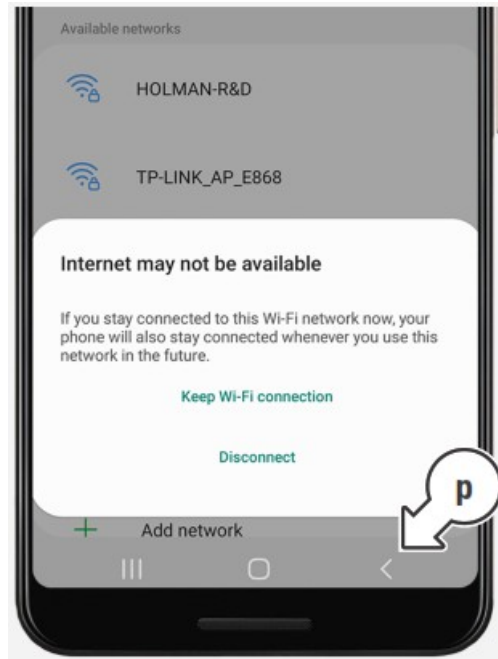

14. android Android only: Once **Holman-WX-XXXX** is the active network, return to Holman Home using by tapping the multi-screen icon [q]

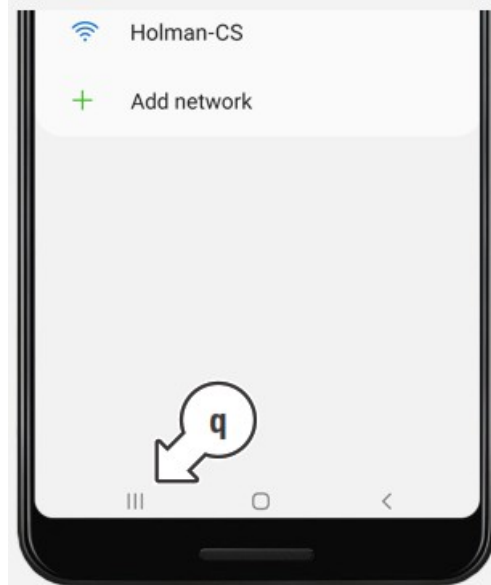

15. iOS only: Once **Holman-WX-XXXX** is the active network [r], return to Holman Home using by tapping the Holman Home shortcut [s]

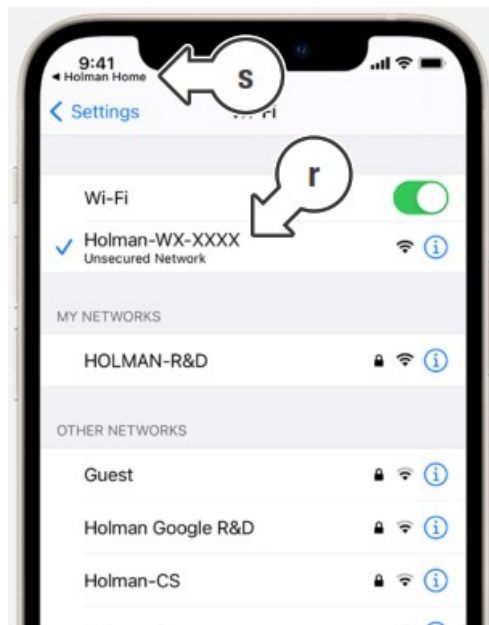

16. Wait while your **Wi-Fi Hub** is being added to **Holman Home** [t]

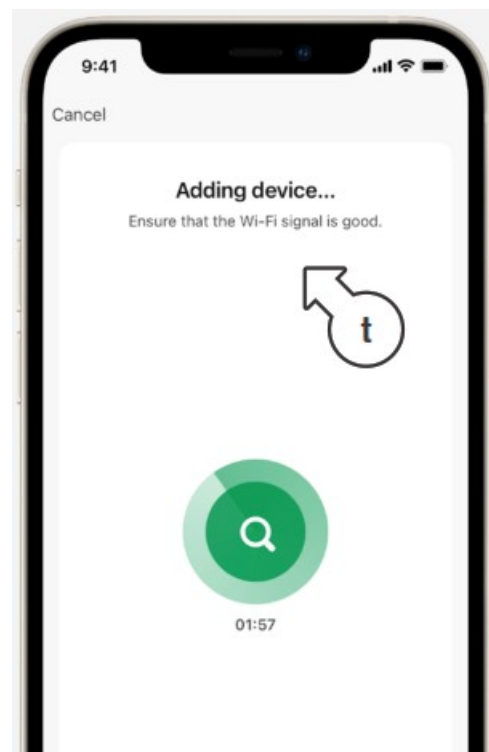

17. If your **Wi-Fi Hub** [u] connects successfully, tap **DONE** [v]



18. After confirming the connection, tap **ADD/VIEW DEVICES** [w] and follow the prompts to connect the **Wi-Fi Socket** and **WX1 Tap Timer**



If this method of connecting the **WX1 Tap Timer** and **Wi-Fi Socket** does not work, tap the back button [x] to go back to the **HOME** screen, and follow the next set of instructions for an alternative connection method

ADDING YOUR WX1 TAP TIMER AND Wi-Fi SOCKET TO HOLMAN HOME

1. Ensure your **WX1 Tap Timer** is close to your router and install 4× 1.5v AA alkaline batteries [a]
2. From the **HOME** screen tap plus [b] to add the **WX1 Tap Timer** and Wi-Fi Socket

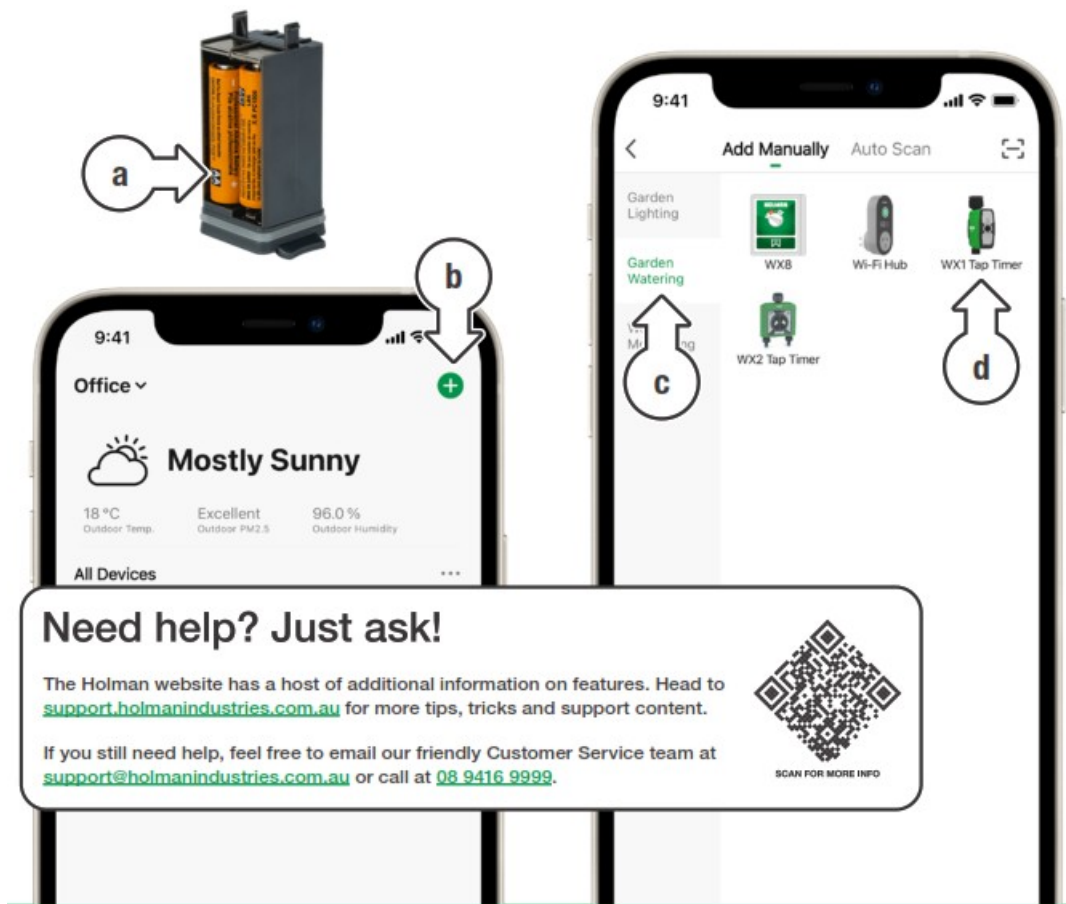

<https://support.holmanindustries.com.au/?=qr>

3. Tap **GARDEN WATERING** [c] and choose **WX1 Tap Timer** [d] When a **GATEWAY** [e] is requested, select **Wi-Fi HUB** [f]

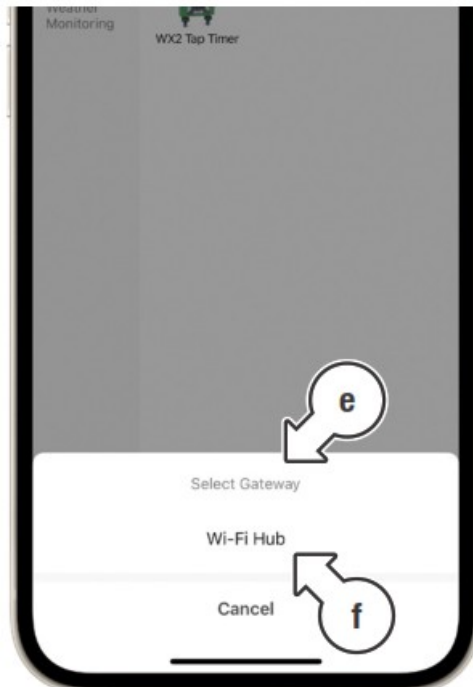

4. Reset the **WX1 Tap Timer** as per the instructions provided on-screen [g]
5. Once the **WX1 Tap Timer** is flashing accordingly, check the LED confirmation toggle [h] and tap **NEXT** [i]



If your **WX1 Tap Timer** fails to add to Holman **Home**, restart the app, and start the process again to add your **WX1 Tap Timer** and **Wi-Fi Socket**

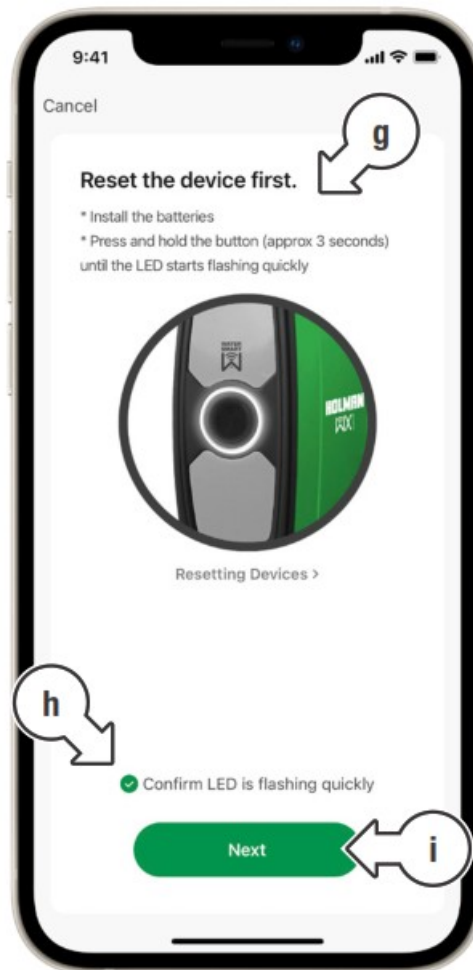

6. Wait until both the **WX1 Tap Timer** [j] and **Wi-Fi Socket** [k] have been added, then tap **DONE** [l]

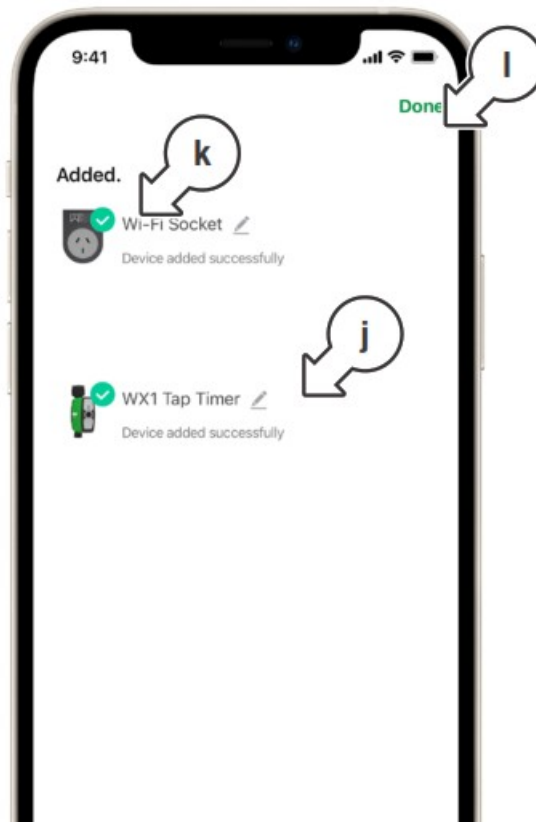

WX1 Setup Process Workaround



For additional help, visit <https://www.holmanindustries.com.au/>

Documents / Resources



[HOLMAN WX1 Tap Timer and Wi-Fi Hub Setup Apps](#) [pdf] User Guide
WX1, Tap Timer and Wi-Fi Hub Setup Apps

References

-  [Holman Industries - Irrigation, Garden Lights, Plumbing](#)