



**CLXRGB60  
Garden  
Light Wi-Fi  
Controller**



# HOLMAN CLXRGB60 Garden Light Wi-Fi Controller User Guide

[Home](#) » [Holman](#) » HOLMAN CLXRGB60 Garden Light Wi-Fi Controller User Guide 

## Contents

- [1 HOLMAN CLXRGB60 Garden Light Wi-Fi Controller](#)
- [2 Product Information](#)
- [3 Product Usage Instructions](#)
- [4 INTRODUCTION](#)
- [5 INITIAL SETUP](#)
- [6 BASIC APP INFORMATION](#)
- [7 CHOOSING SCENE DISPLAY](#)
- [8 DEVICE INFORMATION](#)
- [9 TROUBLESHOOTING](#)
- [10 Frequently Asked Questions](#)
- [11 Documents / Resources](#)
  - [11.1 References](#)

The HOLMAN logo is a green rounded rectangle with the word "HOLMAN" in white, bold, sans-serif capital letters.

**HOLMAN CLXRGB60 Garden Light Wi-Fi Controller**



## Product Information

### Specifications:

- **Model:** CLXRGB60
- **Manufacturer:** Holman Industries
- **Country of Origin:** Australia

## Product Usage Instructions

### Initial Setup:

1. Download Holman Home from the Apple App Store or Google Play Store on your mobile device.
2. Open Holman Home and tap on REGISTER.
3. Read and agree to the Privacy Policy.
4. Follow the prompts to register a Holman Home account with your email or mobile number.
5. Allow access to your location for weather information (optional).
6. Add devices by tapping ADD DEVICE and select GARDEN LIGHTING to pair your Garden Light Controller.
7. Follow the on-screen prompts to complete the Wi-Fi pairing process.

### Basic App Information:

1. After pairing, find your Garden Light Controller on the ALL DEVICES screen.
2. Tap on the controller for advanced lighting controls.
3. Use the controls to turn the light on/off, change color, adjust brightness, and set timers.

## Choosing Scene Display:

1. Tap on SCENE to open scene options.
2. Select from eight predefined scenes or customize one.
3. Edit scene name, picture, colors, flash mode, and intensity as desired.

## Device Information:

1. Access Device Information to change name, icon, and location settings.
2. View Virtual ID, IP and MAC Address, Device Time Zone, and Signal Strength under DEVICE INFORMATION.
3. Explore smart scenarios and automation options under TAP-TO-RUN AND AUTOMATION.

Some screens in this guide may differ slightly depending on your mobile device and Holman Home app version

Please read these instructions in full before proceeding with setup

Copyright © Holman Industries 2024

## Customer Service

[support@holmanindustries.com.au](mailto:support@holmanindustries.com.au) [www.holmanindustries.com.au](http://www.holmanindustries.com.au)

Reliance Worldwide Corporation (Aust.) Pty. Ltd.

27-28 Chapman Place  
Eagle Farm, QLD, Australia 4009



## INTRODUCTION

The CLXRGB60 Garden Light wifi Wi-Fi Controller allows anyone with a smartphone and Wi-Fi access to control their garden lights from anywhere on the globe.

### Connect your 4-Pin

Plug + Socket to your Wi-Fi Garden Light Controller to create stunning lighting displays or select from existing scenes to bring your garden to life. Adjust the colour, mood, intensity, brightness and display all from your smartphone. Find out more online at [www.holmanindustries.com.au/rgb-colour-60W-garden-light-wi-fi-controller](http://www.holmanindustries.com.au/rgb-colour-60W-garden-light-wi-fi-controller)

## INITIAL SETUP

1. Download Holman Home onto your mobile device via the apple  App Store or google-play  Google Play



2. Open Holman Home on your mobile device

You may be prompted to allow notifications—Holman Home will still work if you choose not to.

3. Tap REGISTER

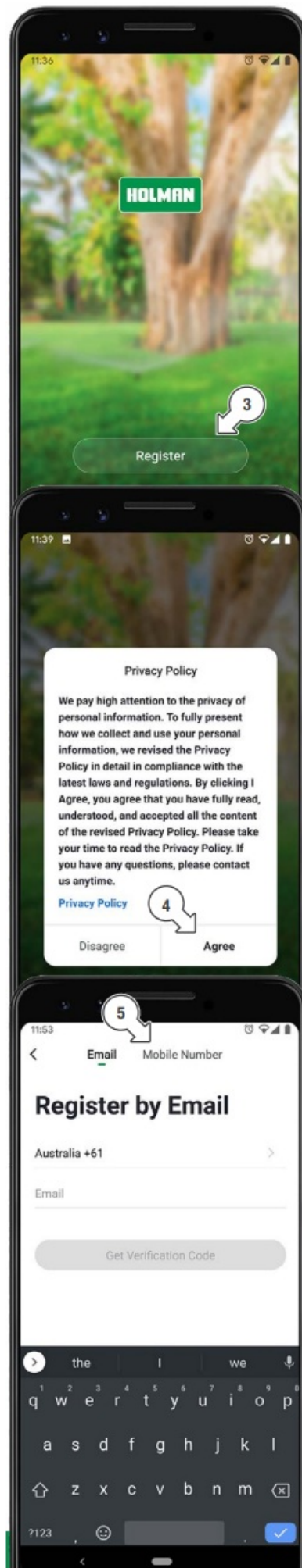

4. Read our Privacy Policy and tap AGREE if you wish to proceed

5. Follow the prompts to register a Holman Home account with your email or mobile number

When entering an email address ensure the country is correct as this may affect your ability to share control of your Garden Light Controller with other users

You may be prompted to allow Holman Home to access your location. This allows the app to show weather information. Holman Home will still work if you choose not to allow this

6. The home screen will appear and you are now able to add devices to Holman Home by tapping ADD DEVICE or plus

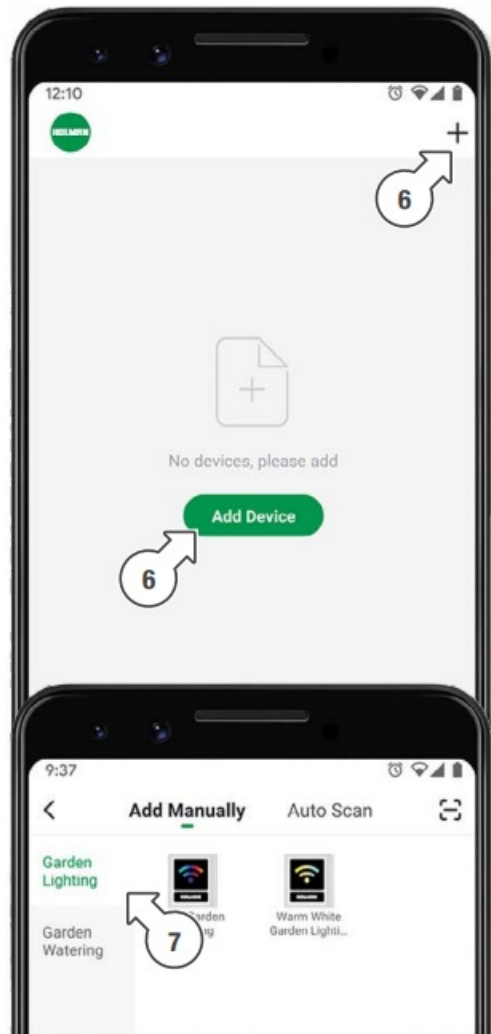

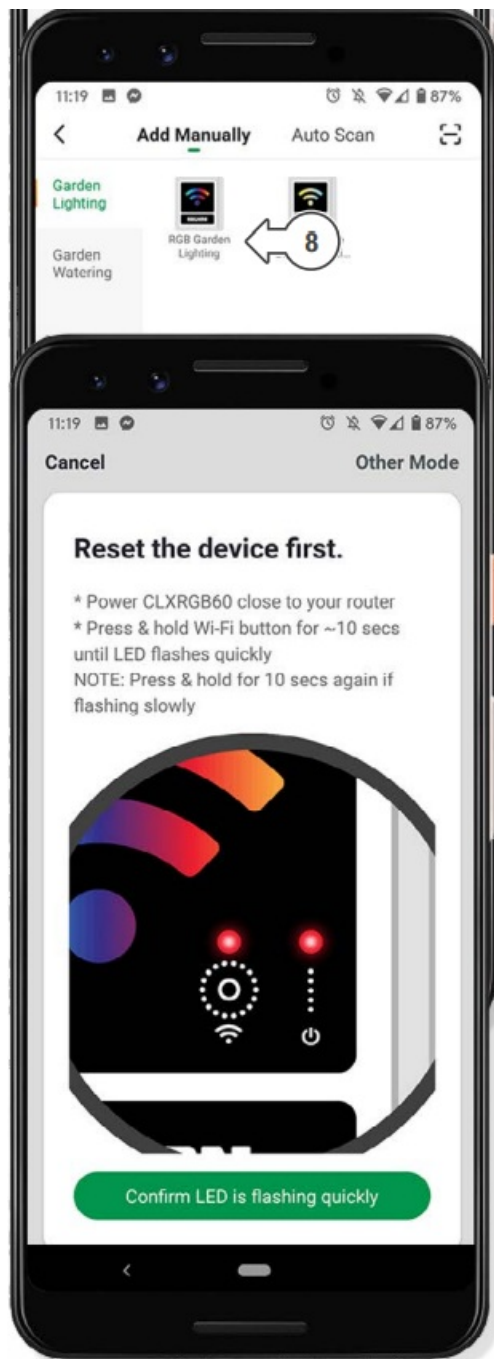



7. To find the Garden Light Controller, tap GARDEN LIGHTING
8. Tap the RGB GARDEN LIGHTING icon to begin pairing your Garden Light Controller
9. This begins the Wi-Fi pairing process with your Garden Light Controller. Follow the prompts on your mobile device to complete the pairing process

## BASIC APP INFORMATION

After completing the Wi-Fi pairing process, your Garden Light Controller will be available on the ALL DEVICES screen. Tap your Garden Light Controller for advanced lighting controls

1. Tap  at the bottom of the screen to turn the light on or off
2. When your garden lights are on it is possible to:
  1. Change the colour by using the scroll wheel
  2. Adjust the brightness of the light using the  slider

3. Adjust the intensity of the colour using  slider





4. Tap ON/OFF IN... to set a timer for the lights to stay on for a duration
5. Tap SCHEDULE to set on and off timers for the light

## CHOOSING SCENE DISPLAY

1. Tap SCENE as shown to open scene options
2. There are eight predefined scenes. The selected scene will have the image displayed in the middle of the screen





3. Using EDIT it is possible to:

1. Change the SCENE NAME,
2. change the scene picture by selecting the EDIT SCENE PIC,
3. add more colours to your display by tapping plus under the SCENE COLOUR,
4. change the flash mode by tapping the COLOUR FLASH MODE,
5. adjust the COLOUR FLASH or BREATH using the slider

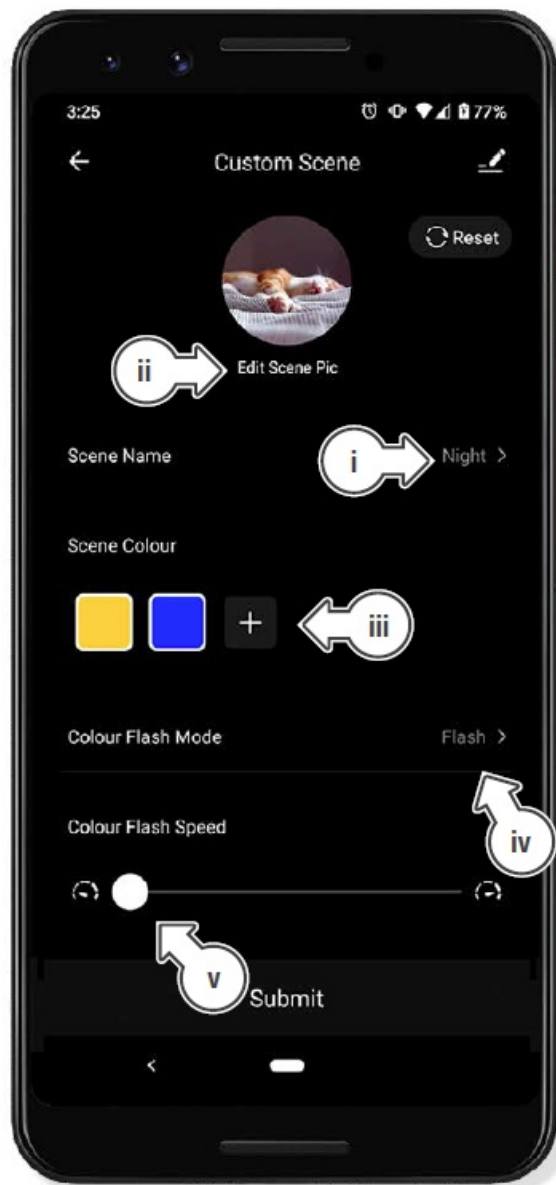

## DEVICE INFORMATION

1. Tap  as shown to display Device Information

From here you will be able to:



2. Change the name, icon and allocate a location on your Garden Light Controller
3. Choose DEVICE INFORMATION to see the Virtual ID, IP and MAC Address, Device Time Zone and Signal Strength
4. Select TAP-TO-RUN AND AUTOMATION for any smart scenarios you have created
5. Tap ALEXA or GOOGLE ASSISTANT for information on setting up these services
6. Toggle OFFLINE NOTIFICATION to be notified when your device has been offline for more than 30 minutes

7. Tap SHARE DEVICE to share control of your Garden Light Controller with a user outside your home. We recommend using the HOME MANAGEMENT function if you wish to share your Garden Light Controller with a user who lives in your home

All users will need to have a Holman Home account to be able to share devices

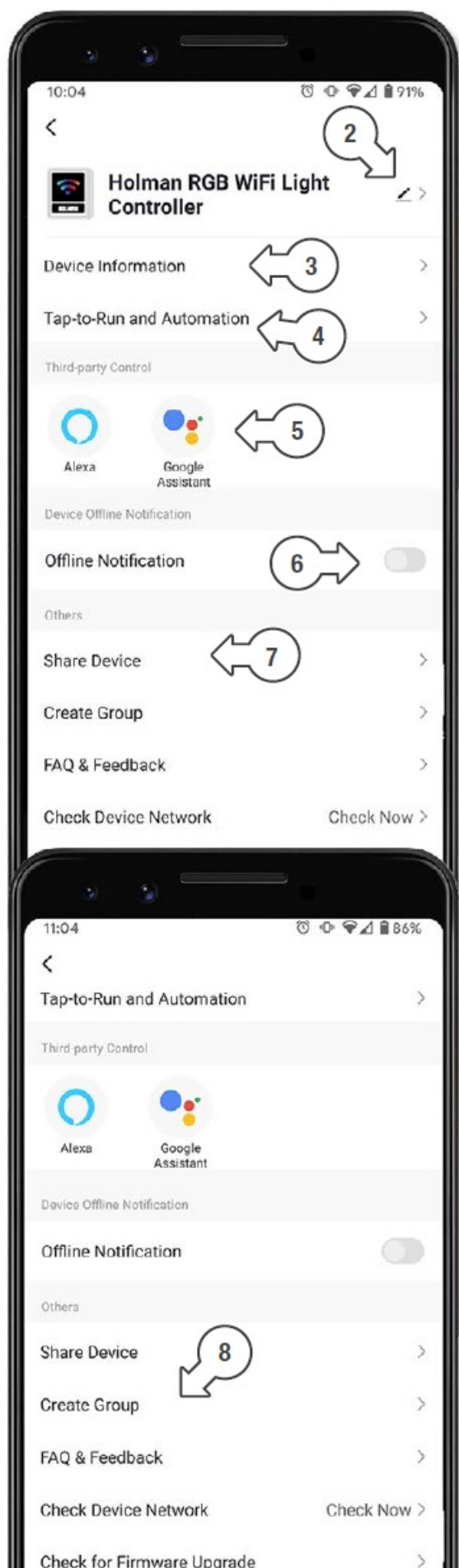

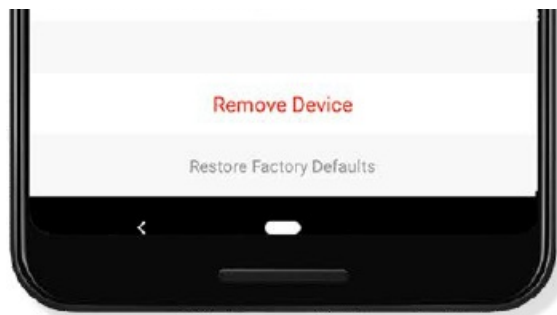

8. Tap CREATE GROUP to control multiple Garden Light Controllers

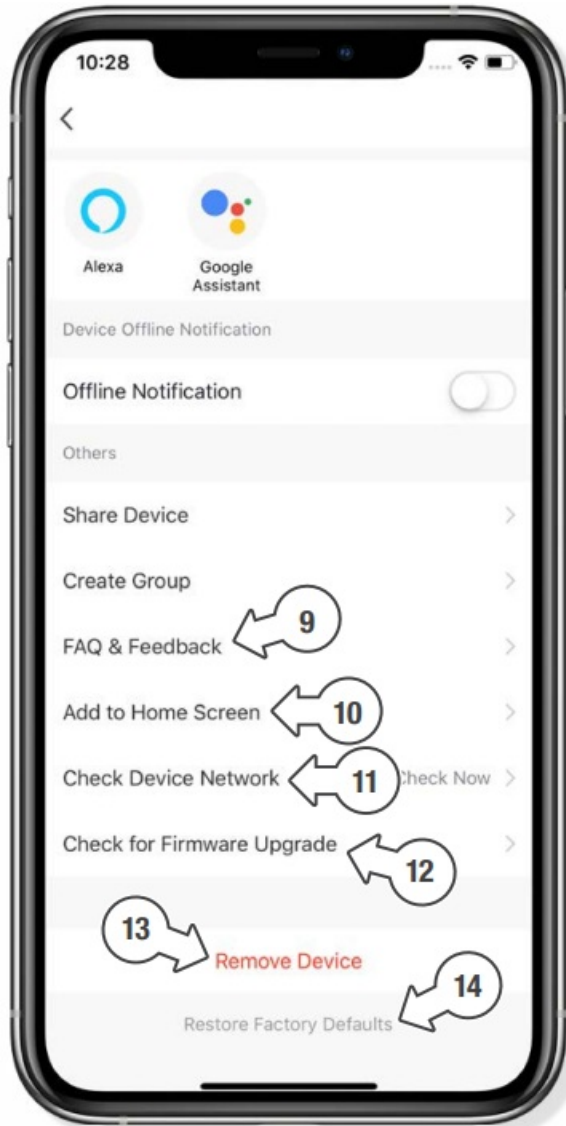

9. For support and fault reporting, tap FAQ & FEEDBACK
10. Add the device to your HOME SCREEN (  iOS only)
11. Tap CHECK DEVICE NETWORK to run a test on your Wi-Fi signal
12. Tap CHECK FOR FIRMWARE UPGRADE to ensure your Garden Light Controller has the latest firmware
13. Tap REMOVE DEVICE to remove your Garden Light Controller from Holman Home
14. Tap RESTORE FACTORY DEFAULTS to remove your Garden Light Controller from Holman Home and clear all settings back to factory defaults

## TROUBLESHOOTING

Symptom	Suggestion
<b>CLXRGB60 Controller cannot connect to Holman Home</b>	<ol style="list-style-type: none"> <li>When adding your <b>CLXRGB60</b> to <b>Holman Home</b>: <ul style="list-style-type: none"> <li>? Confirm your <b>CLXRGB60</b> is powered <b>ON</b></li> <li>? Confirm Wi-Fi <b>AP</b> on your <b>CLXRGB60</b> is flashing <b>RED</b></li> <li>? Confirm both your <b>CLXRGB60</b> and smartphone are within Wi-Fi range</li> <li>? Make sure the network functions of your Wi-Fi router and smartphone are unblocked; firewalls can block certain ports</li> <li>? Confirm your Wi-Fi network name (SSID) has been entered correctly, including spaces. Note this is case sensitive</li> <li>? Confirm your Wi-Fi network password has been entered correctly</li> <li>? Confirm your <b>CLXRGB60</b> is connected to a 2.4GHz Wi-Fi network (not 5GHz), enable the broadcast and do not allow the Wi-Fi network to be hidden</li> <li>? Confirm your Wi-Fi router encryption method is WPA2-PSK and authentication type is AES, or both are set to automatic</li> </ul> </li> <li>If the number of connected devices to the Wi-Fi has reached the amount limit (usually 16 or 50 devices), turn off other Wi-Fi devices and configure again</li> <li>If your Wi-Fi router enables the MAC address filter, remove the device from MAC filter list and make sure the Wi-Fi router is allowing your <b>CLXRGB60</b> to be connected</li> <li>Make sure that the Wi-Fi router has the DHCP service enabled. If it is not enabled, the address will be occupied</li> <li>Your Wi-Fi router may not be compatible with your <b>CLXRGB60</b>. It is recommended that you replace the Wi-Fi router and try again</li> </ol>
<b>No power LED light on</b>	No power. Try another power point to check—then contact our Customer Service team at 1300 176 188 or email <a href="mailto:support@holmanindustries.com.au">support@holmanindustries.com.au</a> for further assistance
<b>No/rapidly flashing/ odd colour Wi-Fi indicator LED light</b>	Possible lighting cable connection issue. If Wi-Fi LED stabilises when lighting cable is unplugged from controller, check cable connections along the light chain—starting with the first cable or tee connection from controller
<b>Buttons not responding</b>	Please contact our Customer Service team at 1300 176 188 or email <a href="mailto:support@holmanindustries.com.au">support@holmanindustries.com.au</a>



Thanks for being a  
#SMARTGARDENER

We really appreciate having you as a customer, and would like to say thank you for choosing us.

We recommend registering your new product on our website. This will ensure we have a copy of your purchase and activate an extended warranty.

Keep up to date with relevant product information and special offers available through our newsletter.



[www.holmanindustries.com.au/product-registration/](http://www.holmanindustries.com.au/product-registration/)

Thanks again for choosing Holman

For the #SMARTGARDENER



## Frequently Asked Questions

**Q: What should I do if my Garden Light Controller is not connecting to Wi-Fi?**

**A:** If you are facing connectivity issues, try resetting both your mobile device's Wi-Fi connection and the Garden Light Controller. Ensure you are within range of your Wi-Fi network and follow the pairing instructions carefully.

**Q: Can I control multiple Garden Light Controllers with one Holman Home account?**

**A:** Yes, you can control multiple controllers by adding them to your Holman Home account. Make sure to pair each controller individually following the setup process.

## Documents / Resources

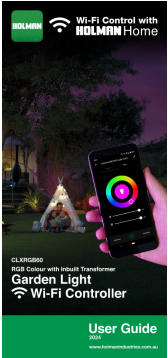
	<p><a href="#">HOLMAN CLXRGB60 Garden Light Wi-Fi Controller</a> [pdf] User Guide CLXRGB60 Garden Light Wi-Fi Controller, CLXRGB60, Garden Light Wi-Fi Controller, Wi-Fi Controller</p>
---	---

## References

- [HOLMAN Industries - Irrigation, Garden Lights, Plumbing](#)
- [HOLMAN Industries - Irrigation, Garden Lights, Plumbing](#)
- [User Manual](#)

### Manuals+, Privacy Policy

This website is an independent publication and is neither affiliated with nor endorsed by any of the trademark owners. The "Bluetooth®" word mark and logos are registered trademarks owned by Bluetooth SIG, Inc. The "Wi-Fi®" word mark and logos are registered trademarks owned by the Wi-Fi Alliance. Any use of these marks on this website does not imply any affiliation with or endorsement.