



# HOLLYLAND SYSCOM 1000T Full Duplex Wireless Intercom System User Manual

[Home](#) » [HOLLYLAND](#) » HOLLYLAND SYSCOM 1000T Full Duplex Wireless Intercom System User Manual 

## Contents

- 1 HOLLYLAND SYSCOM 1000T Full Duplex Wireless Intercom System
- 2 Product Usage Instructions
- 3 DESCRIPTION
- 4 KEY FEATURES
- 5 APPLICATIONS
- 6 PACKING LIST
- 7 STANDARD SETUP
- 8 PRODUCT INTERFACES
- 9 PRODUCT DISPLAY INTRODUCTION
- 10 BELDISPLATPAY INTRODUCTION CK MENU FUNCTION INTRODUCTION
- 11 INSTALLATION
- 12 PARAMETERS
- 13 FAQ
- 14 Documents / Resources
  - 14.1 References
- 15 Related Posts



**HOLLYLAND**

**HOLLYLAND SYSCOM 1000T Full Duplex Wireless Intercom System**



## Specifications

- **Communication Range:** 1000ft
- **Voice Quality:** Carrier-Grade
- **Frequency Bandwidth:** 1.9GHz
- **Communication Mode:** Full-Duplex Wireless
- **Simultaneous Beltpacks:** Up to 8
- **Compatible Connections:** Gooseneck Microphone, Speaker Call, 3.5mm Headset, 4-Pin Analog Audio
- **Battery Life:** Over 8 hours
- **Power Source:** Lithium Batteries (Beltpacks)

## Product Usage Instructions

### Setup

- Unpack the contents of the box and ensure all items are present according to the packing list provided.
- Connect the Base Station to power using the AC Power Cable.

### Beltpack Registration

- To register Beltpacks with the Base Station, use the USB Type-A Interface for cable connection between them.
- Follow the user manual for detailed instructions on registration and charging.

### Connecting External Devices

- The Base Station supports various external connections such as Gooseneck Microphones and Headsets.
- Ensure proper connections for seamless communication.

### Software Upgrade

- Both the Base Station and Beltpacks support PC software upgrades.

- Visit the official website for the latest software version and upgrade instructions.

## **Wireless TALLY Setup**

- Enable the Wireless TALLY feature for efficient communication during events.
- Refer to the user manual for setting up and utilizing this feature.

## **FAQ**

### **Q: How to extend the wireless communication range?**

- **A:** To increase the wireless communication range, consider using panel antennas instead of standard antennas.
- This can help enhance the signal strength and reduce interference in complex environments.

### **Q: Can I connect other intercom systems to SYSCOM 1000T?**

- **A:** Yes, you can connect external intercom systems to SYSCOM 1000T using standard 4-wire audio interfaces.
- This allows for expanding belt pack quantities and increasing communication range.

## **DESCRIPTION**

- Thank you for purchasing the Hollyland SYSCOM 1000T full-duplex wireless intercom system.
- With the DECT protocol technology, SYSCOM 1000T is widely used in the areas of studio, stage events, EFP, webcasting, filmmaking, etc.
- The transmission range of SYSCOM 1000T reaches up to 1000ft in a clean line of sight (LOS) with full-duplex wireless communication and carrier-grade voice quality.

## **KEY FEATURES**

- 1000ft Communication Range, Carrier-Grade Voice Quality
- 1.9GHz Frequency Bandwidth
- Full-Duplex Wireless Communication
- Up to 8 Beltpacks Communication Simultaneously (Base Station)
- Support Gooseneck Microphone, Speaker Call, 3.5mm Headset, and 4-Pin Analog Audio Connection (Base Station)
- Support External Connections with Other Intercom Systems
- Base Station and Beltpacks Support PC Software Upgrade
- Support Wireless TALLY
- Built-in lithium Batteries, with Longer than 8 Hours Run Time on a Full Charge (Beltpacks)
- Industrial Metal Case, Stable, and Reliable

## **APPLICATIONS**

- Filmmaking
- Live Broadcasting
- Corporate Events
- Production Crew Communication
- Stage Activities
- Emergency Dispatch
- Webcasting
- TV Station

## PACKING LIST

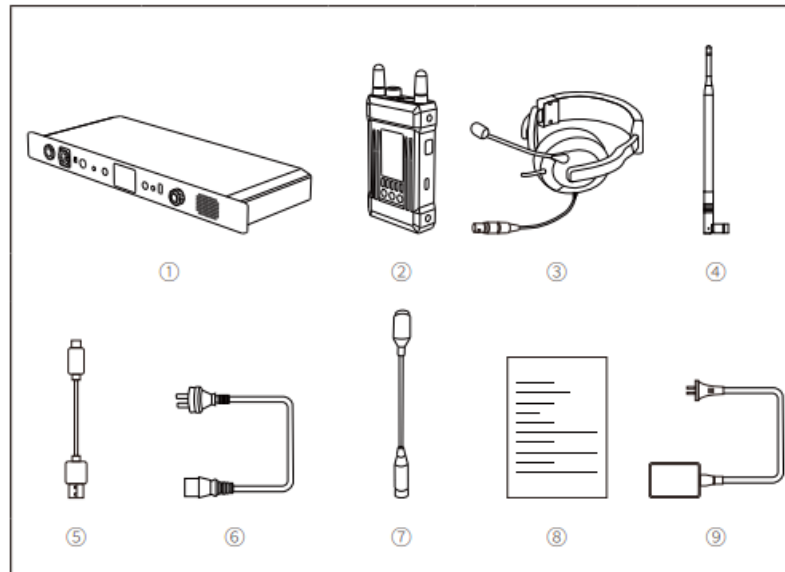

## SINGLE RECEIVER PACKING

1. **Base Station** x1
2. **Beltpack** x8
3. **Professional Dynamic LEMO Single-Ear Headset** x9
4. **1.9G High-Gain Base Station Antenna** x6
5. **USB Type-C Cable** x8
6. **AC Power Cable** x1
7. **3-Pin XLR Gooseneck Microphone** x1
8. **User Manual** x1
9. **Multi-Port USB Charger** x2

- The number of accessories is related to the configuration.
- The actual accessories number might be different in each case.

## OPTIONAL ACCESSORIES NOT INCLUDED IN THE STANDARD PACKING LIST

<b>Headset</b>	Professional Electret Single-Ear Headset Single-Ear Mobile Earphone Air Duct Earphone Over-Ear Headphones
<b>TALLY</b>	Tally Cable Adapt to Different Switcher External BI-Color Tally Lights and Extension Cable
<b>Antenna</b>	1.9G Dual-Polarized High-Gain Panel Antenna
<b>Power Adaptor</b>	D-TAP to 4-Pin XLR DC Cable
<b>Gooseneck Microphone</b>	Dynamic Gooseneck Microphone
<b>Installation Tool</b>	Belt-pack Cold Shoe
<b>Cascade Accessories</b>	4-Wire to 2-Wire Converter Ethernet to XLR Cable

## STANDARD SETUP

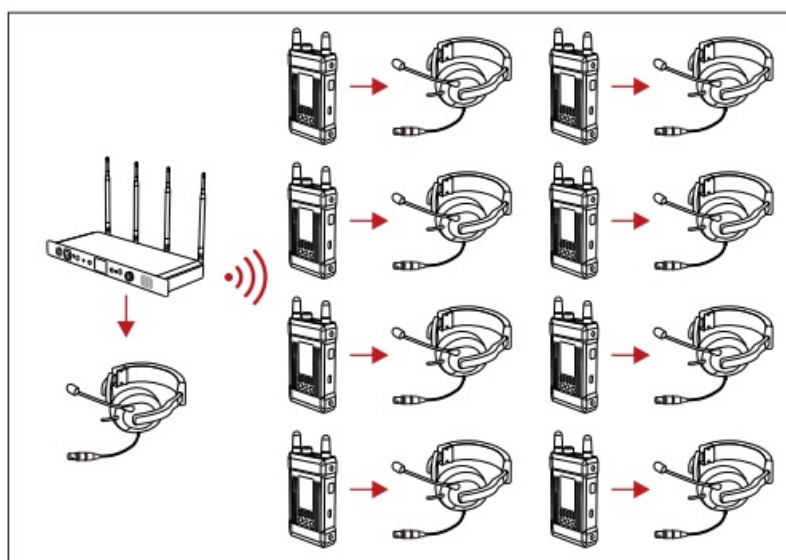

## TYPICAL SETUP USING THIRD PARTY EQUIPMENT

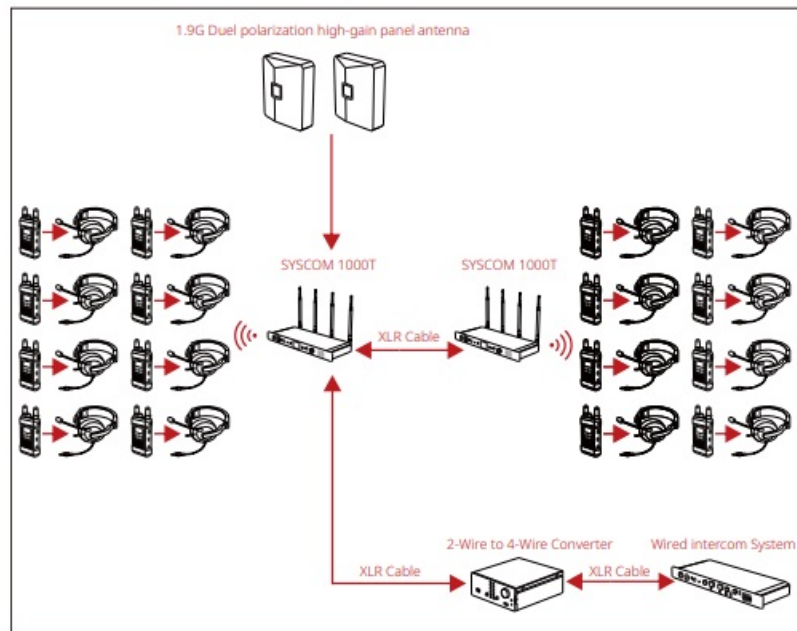

- SYSKOM 1000T with standard 4-wire audio interface, which can connect with a different type of intercom systems to increase the number of belt packs and also the wireless communication range.
- If the live environment is complex, you can enhance the anti-interference by changing the standard antennas to panel antennas.

## PRODUCT INTERFACES

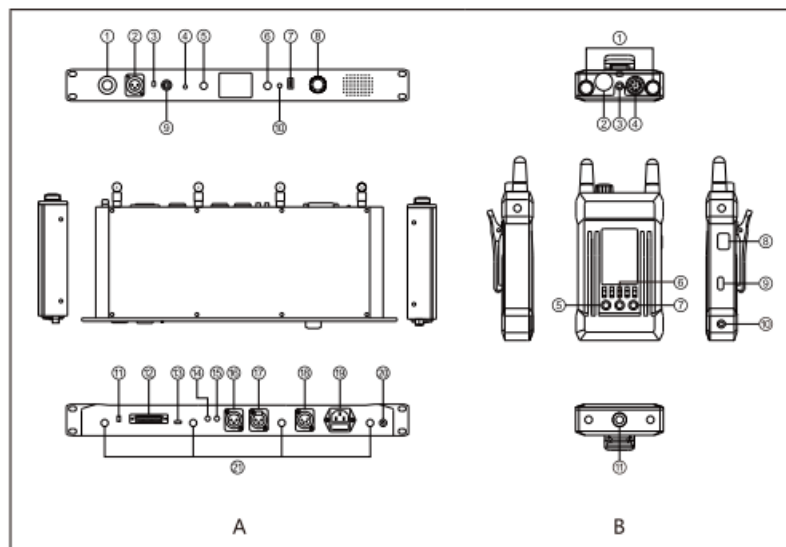

## BASE STATION

1. DC Power Supply
2. Gooseneck Microphone (3-pin XLR male)
3. Dynamic and Electronic Gooseneck Microphone Switch Button
4. 3.5mm Headphone Interface (US)
5. Base Station MIC MUTE Button
6. Beltpack MIC MUTE Button
7. USB Type-A Interface (for cable connection between the base station and belt pack for belt pack registration)

and charging)

8. Volume Control Knob
9. LEMO Headset Interface
10. Reserved Button
11. Dial Switch (TALLY mode selection)
12. TALLY Control Interface
13. USB Type-C Debugging Interface
14. Audio Input Control Knob
15. Audio Output Control Knob
16. Analog Audio Output Interface (3-pin XLR male)

#### • BASE STATION

17. Analog Audio Input Interface (3-pin XLR female)
18. DC Adaptor (4-pin XLR male)
19. AC Adaptor
20. Ground Pole
21. RF Antenna Interface

### BELTPACK

1. Antenna
2. Power and Volume Control Knob
3. 3.5mm Headphone Interface
4. LEMO Headset Interface
5. Up/Left Button
6. Menu/Confirm Button (long press to enter the menu /click to confirm)
7. Down/Right Button
8. Mute/Talk Switch Button (double click to mute/long press to talk)
9. Type-C USB Interface (for cable connection between the base station and belt pack for belt pack registration and charging)
10. 3-Segment 3.5mm TALLY Output Interface
11. 1/4 Screw Hole

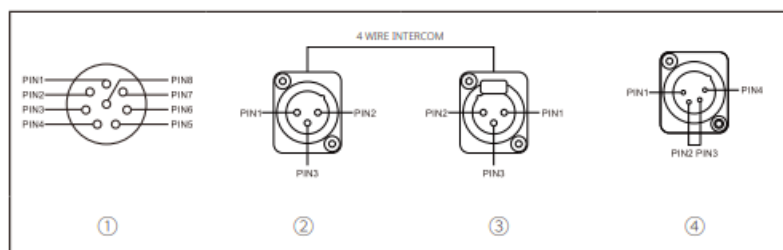

#### 1. LEMO HEADSET INTERFACES

- **PIN1:** GND
- **PIN2:** GND
- **PIN3:** SPK
- **PIN4:** SPK
- **PIN5:** MIC
- **PIN6:** MIC

- **PIN7:** NULL
- **PIN8:** NULL

## 2. AUDIO OUT INTERFACE

- **PIN1:** GND
- **PIN2:** AUDIO OUT +
- **PIN3:** AUDIO OUT –

## 3. AUDIO IN THE INTERFACE

- **PIN1:** GND
- **PIN2:** AUDIO IN +
- **PIN3:** AUDIO IN –

## 4. DC POWER SUPPLY

- **PIN1:** GND
- **PIN2:** NULL
- **PIN3:** NULL
- **PIN4:** POWER

## PRODUCT DISPLAY INTRODUCTION

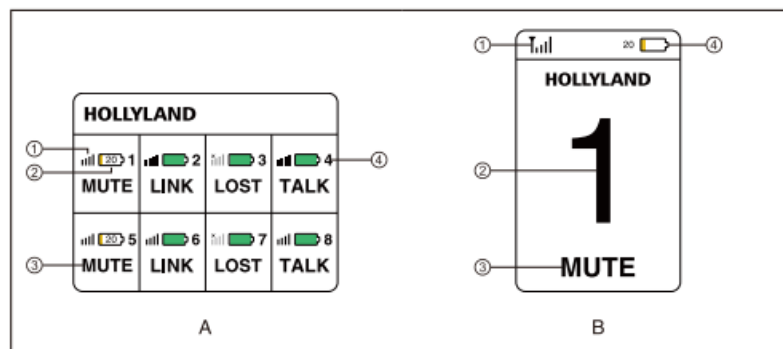

## BASE STATION

1. Beltpack Signal Strength
2. Beltpack Real-Time Battery Status (actual percentage will be displayed when the battery is lower than 20%)
3. Beltpack Current Status
4. Beltpack Number

## BELTPACK

1. Beltpack Signal Strength
2. Beltpack Number
3. Beltpack Current Status
4. Beltpack Real-Time Battery Status

## BELDISPLATPAY INTRODUCTION CK MENU FUNCTION INTRODUCTION



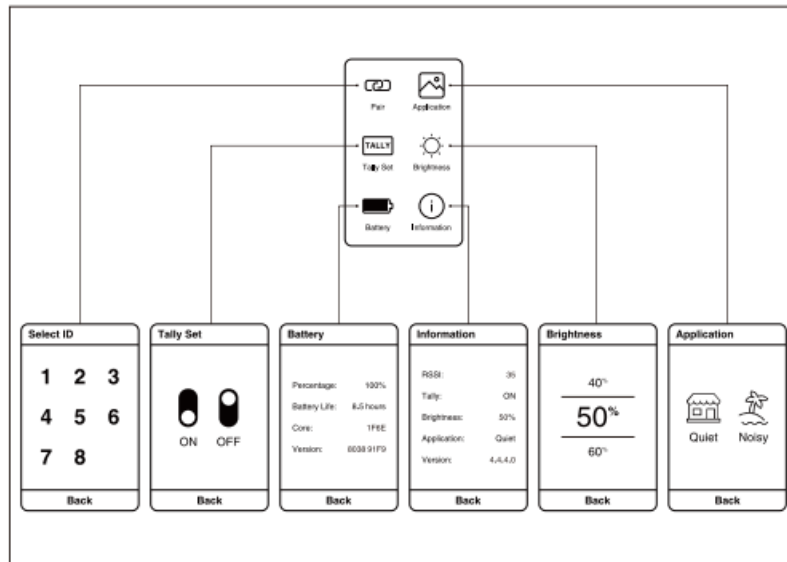

Long press the “OK” button for about three seconds to enter the root menu, select the menu, and press “OK” to enter the next level. Each menu feature is described as follows,

**1. Select “Pair” and press “OK” to enter the secondary menu of the registration feature**

- Select any ID from 1 to 8 then press “OK” to register the beltback. “Pairing will be displayed on the main interface of the belt pack and the base station. Unplug the USB cable after “Pairing Successful” is displayed on the screen of both of them.

**2. Select “Application” and press “OK” to enter the secondary menu of the scene mode configuration**

- Select “Quiet” and press “OK” when in a quiet environment
- Select “Noisy” and press “OK” when in a noisy environment

**3. Select “Tally Set” and press “OK” to enter the secondary menu of LCD Screen TALLY Display setup**

- Select “OFF” and press “OK” to turn off the TALLY display
- Select “ON” and press “OK” to turn on TALLY display

**4. Select “Brightness” and press “OK” to enter the secondary menu of Screen brightness adjustment**

- Press “Up” and “Down” to select the current appropriate brightness press “OK” to finish the setup

**5. Select “Battery” and press “OK” to enter the secondary menu of the battery information interface**

- Percentage” displays the current power percentage
- Battery Life” displays the current working status, battery remaining time
- Core” displays the current battery cell core version
- Version” displays the current firmware version

**6. Select “Information” and press “OK” to enter the secondary menu of system information inquiry**

- RSSI” displays the current wireless signal strength
- Tally” displays the current TALLY display setting status
- Brightness” displays the current screen brightness
- Application” displays the current scene mode setting
- Version” displays the current firmware version

**7. Select “Exit” and press “OK” to return to the root menu**

## INSTALLATION

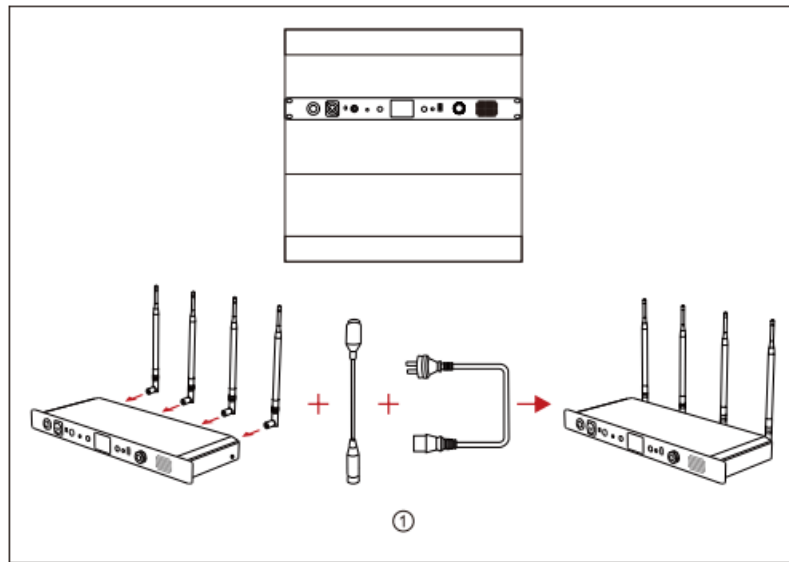

## 1. Base Station Installation

1. Install antennas as demonstrated
2. Plug in the gooseneck mic
3. Install the base station in the 1U cabinet

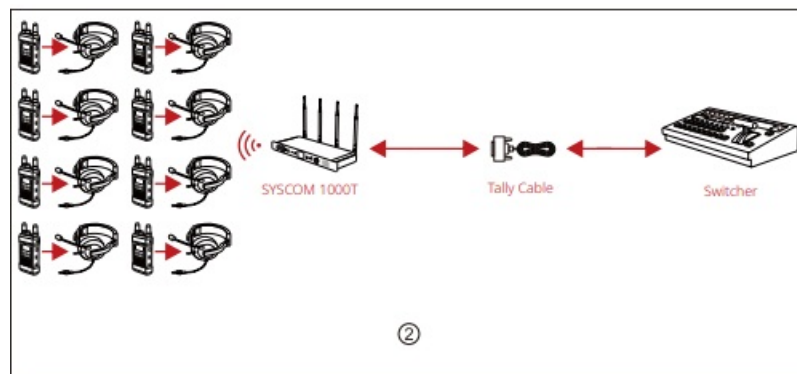

## 2. TALLY Function

1. The DB25 TALLY output interface is equipped on the back of the base station, and users can directly plug the TALLY convert cable into the TALLY input interface of the switcher.
  - When the switcher selects the on-call belt pack ID and clicks a different TALLY indicator button, the corresponding belt pack will be prompted by displaying a red light or a green light.

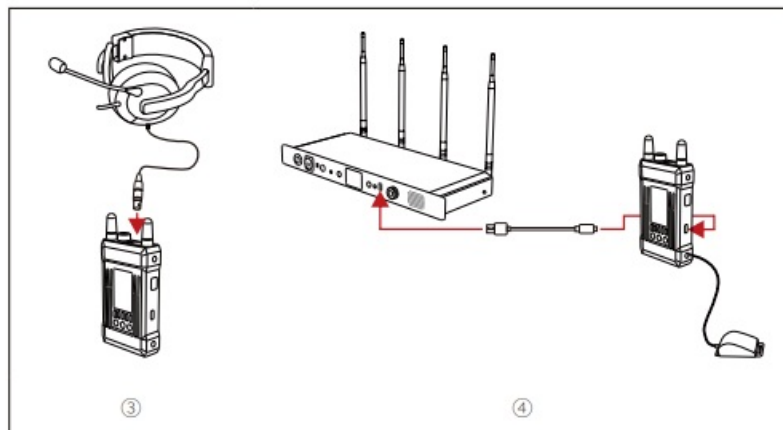

## 3. Beltpack Installation

1. Connect the headset as demonstrated.
2. Turn the power and volume control knob to turn on the belt pack.
3. When the status of the belt pack turns from “LOST” to “MUTE”, long-press the M-UTE/TALK” button on

the side of the belt pack to switch it to “TALK” mode to communicate. If the belt pack operator doesn’t want to talk with the base station, double-click the “MUTE/TALK” button on the side of the belt pack to switch to “MUTE” mode. The belt pack operator can still hear the base station and other connected belt packs under this mode.

4. Click the “MIC MUTE” button to mute all belt packs if the base station operator doesn’t want to hear all belt packs. When the indicator light is on, all belt packs are switched to “MUTE” mode. Under this mode, belt packs’ operators can hear the base station but they cannot talk to each other and the base station. If a belt pack operator wants to communicate with the base station, long-press the “MUTE/TALK” button on the side of the belt pack to call the base station. The “REMOTE MIC KILL” button on the base station will flash with a red light. Click the “REMOTE MIC KILL” button again to enable all belt packs to switch back to “TALK” mode.

#### **4. Beltpack Installation**

- The default setting of the mic is dynamic mic. Users can choose different types of mics based on different applications. Long-press the menu button to enter the interface of the mic setting and change the mic type to electret.
- Due to the noise differences in different applications, it may need some white noise to have a better hearing experience. The background noise level can be adjusted by changing the “Application” in the root menu.

#### **5. Repairing**

- If any beltpack ID is lost while using the system resulting in incorrect operation or other reasons, connect the base station and the beltpack through the standard USB type-C data cable. Enter the pairing menu and select a master station vacancy ID for reregistering the beltpack. “Pairing...” will appear on the main interface of the base station and the beltpack. Wait until “Pairing Successful” is displayed on the screen of both the base station and the beltpack before unplugging the cable. The beltpack will then be ready to use again.

## **PARAMETERS**

	Base Station	Beitpack
<b>Interfaces</b>	4 Antenna Interfaces  AC Type Power Base AC Input 4-Pin XLR Male DC Input 3.5mm Headset Interface  8-Pin LEMO Female Headset Interface  3-Pin XLR Female Goose Mic Interface  3-Pin XLR Female Audio in 3-Pin XLR Male Audio out DB25 Female TALLY Input Interface  USB Type-A Interface USB Type-C Interface	2 Antenna Interfaces 3.5mm Headset Interface  8-pin LEMO Female Headset Interface  3.5mm TALLY out Interface USB Type-C Interface
<b>Power Supply Mode</b>	10~20V DC Input;  100V~240V AC Input	4000mAh Polymer Lithium Battery
<b>Frequency Response</b>	300Hz to 4KHz	300Hz to 4KHz
<b>Signal-to-Noise Ratio</b>	> 50dB	> 50dB
<b>Distortion</b>	<2	<2
<b>Transmission Range</b>	300m Between Beltpack and Base Station	300m Between Beltpack and Base Station
<b>Frequency Bandwidth</b>	1.9GHz	1.9GHz
<b>Modulation Mode</b>	GFSK	GFSK
<b>Transmission Power</b>	Maximum 24dBm	Maximum 24dBm
<b>Receiver Sensitivity</b>	-93dBm	-93dBm
<b>Bandwidth</b>	1.728MHz	1.728MHz
<b>Power Consumption</b>	<6W	<2W
<b>Dimension</b>	(L*W*H): 483*175*45mm	(L*W*H): 120*71*25mm
<b>Net Weight</b>	Around 2900g	Around 300g
<b>Temperature Range</b>	0 ~ +45°C (Working Status)  -20 ~ +60°C (Storage Condition)	0 ~ +40°C (Working Status)  -20 ~ 60°C (Storage Condition)

## Safety Note

Do not place your belt packs on heating equipment, cooking equipment, or high-pressure containers (such as microwave ovens, induction cookers, electric ovens, heaters, pressure cookers, water heaters, gas stoves, etc.) to prevent the battery from overheating and exploding. The charger, data cable, and battery from the original box must be used. Chargers, data cables, or batteries that are not certified by the manufacturer or not from the original

box may cause electric shock, fire, explosion, or other hazards.

## **FAQ**

### **Poor Audio Quality**

1. First, confirm whether the beltpack antennas are correctly installed and tightened. If there is no improvement, replace the antennas.
2. Ensure the beltpack and the base station are in the transmission range and there is no obstacle between the main station and the beltpack.
3. Check if the volume of the beltpack is too low and turn it to a comfortable level.
4. Due to the difference in impedance and setting bias, we generally don't recommend customers to use their own 4-stage 3.5mm headset. If the sound quality is poor, replace the headset.

### **Base Station Cannot Display Beltpack Information**

1. First, confirm whether the beltpack antennas are correctly installed and tightened. If there is no improvement, replace the antennas.
2. Check the status of the Beltpack. If "LOST" appears on the beltpack screen, make sure that the beltpack is within the transmission range from the base station.
3. Check the status of the beltpack. If it is displayed as "NULL", it means that the beltpack information is lost due to incorrect operation, and it needs to be reregistered.

### **No Sound between the Base Station and Beltpack**

1. Confirm if the "REMOTE MIC KILL" button on the base Station is on. If the red light is on, click on it to turn it off.
2. Check the current status on the beltpack screen. If it's on "MUTE", long press the "MUTE/TALK" button on the side to switch it to "TALK".
3. Check if the headset functions well and if you wear the headset and mic properly. (correct way: put the headset on the head with the mic less than 10cm from your mouth)

### **TALLY Function Unavailable**

1. Confirm that the type of the switcher is correct. The TALLY interface definition is not unified on most switchers, so it will cause TALLY dysfunction.
2. Due to various types of switchers, the high-level value will work when pushing the level switch to "High" on the TALLY signal universal converter; the low-level value will work when pushing the level switch to "Low" on the TALLY signal universal converter.
3. Confirm the ID of the belt packs, and check if the TALLY converter connects with the USB Type-A interface on the base station correctly.
4. The beltpack only supports external TALLY light. Confirm if the beltpack connects to an external TALLY correctly.
5. DB25 interface and tally indicator wiring relation table

Channel	Program	Preview	GND
TALLY 1	PIN1	PIN14	PIN13
TALLY 2	PIN2	PIN15	
TALLY 3	PIN3	PIN16	
TALLY 4	PIN4	PIN17	
TALLY 5	PIN5	PIN18	
TALLY 6	PIN6	PIN19	
TALLY 7	PIN7	PIN20	
TALLY 8	PIN8	PIN21	

- **Hollyland User Group**
- **HollylandTech**
- **HollylandTech**
- **HollylandTech**
- [support@hollyland-tech.com](mailto:support@hollyland-tech.com)
- [www.hollyland-tech.com](http://www.hollyland-tech.com)
- **Shenzhen Hollyland Technology Co., Ltd.**
- **8F, 5D Building, Skyworth Innovation Valley, Tangtou, Shiyan, Baoan District Shenzhen, China.**
- For the latest and detailed user guide, please download it from the official website: [www.hollyland-tech.com/support/Download](http://www.hollyland-tech.com/support/Download)

## Documents / Resources

 <b>SYSCOM 1000T</b> <small>User Manual</small> <small>10112</small> <small>For the latest and detailed user guide, please download it from the official website: <a href="http://www.hollyland-tech.com/support/Download">www.hollyland-tech.com/support/Download</a></small>	<a href="#">HOLLYLAND SYSCOM 1000T Full Duplex Wireless Intercom System</a> [pdf] User Manual SYSCOM 1000T Full Duplex Wireless Intercom System, SYSCOM 1000T, Full Duplex Wireless Intercom System, Duplex Wireless Intercom System, Wireless Intercom System, Intercom System, System
---	--

## References

-  [Hollyland - Wireless Video Transmitter, Intercom, Microphone](#)
- [User Manual](#)

[Manuals+](#), [Privacy Policy](#)

This website is an independent publication and is neither affiliated with nor endorsed by any of the trademark owners. The "Bluetooth®" word mark and logos are registered trademarks owned by Bluetooth SIG, Inc. The "Wi-Fi®" word mark and logos are registered trademarks owned by the Wi-Fi Alliance. Any use of these marks on this website does not imply any affiliation with or endorsement.