



**Solidcom SE Pro**

**Quick Guide**

**V1.0**

## **Contents** [ [hide](#) ]

[1 Foreword](#)

[2 Overview](#)

[3 Operations](#)

[4 Specifications](#)

[5 Disclaimer](#)

[6 Documents / Resources](#)

[6.1 References](#)

## **Foreword**

Thank you for choosing the Solidcom SE Pro for on-site communication. If you have never used a wireless intercom system before, then you are about to experience one of the most exciting products in the industry. This Quick Guide will show you how to get started with the product.

Please read this Quick Guide carefully. We wish you a pleasant experience. To obtain Quick Guide information in other languages, please scan the QR code below.

## **Configuration**

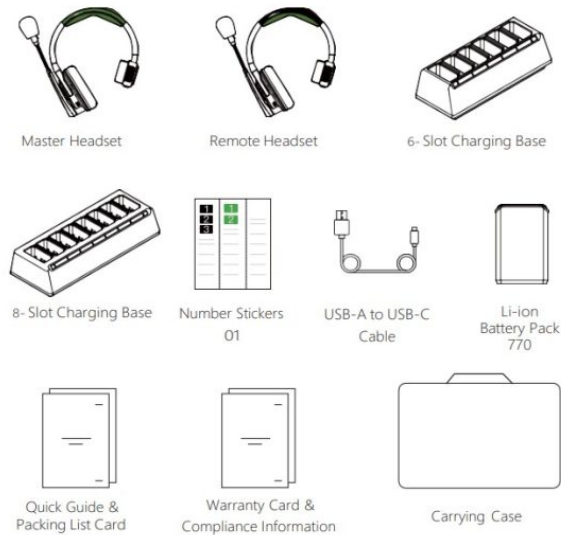

**Note:** The quantity of the items depends on the product configuration detailed on the packing list card.

## Overview

### Indicator Introduction

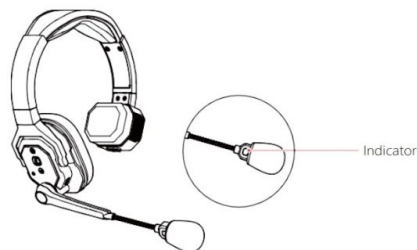

1. Disconnected\*: slowly flashing green light
2. Pairing: rapidly flashing green light
3. TALK Status: solid green light
4. MUTE Status: solid red light
5. Low Battery: slowly flashing red light
6. USB-C Charging
  - A. Charging While Powered On: slowly flashing yellow light for 3s before returning to the former light
  - B. Charging While Powered Off: slowly flashing yellow light
7. USB-C Fully Charged: solid yellow light
8. Upgrading: alternately flashing red and green light

### Notification Sound Introduction

1. Low Battery: low battery level
2. Ding: maximum volume
3. Tick: mic boom in position of mic on or off
4. Connected: device connected
5. Disconnected: device disconnected
6. Unmuted: mic on
7. Muted: mic off

\* While disconnected, the remote headset shows slowly flashing green light while the master headset shows solid green light.

## Operations

1. Installing and removing the battery

Place the battery into the battery compartment for installation.

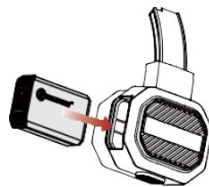

Press the battery compartment button to pop out the battery for removal.

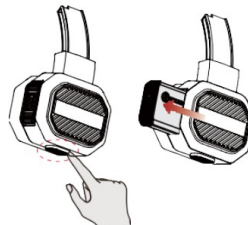

2. Turning on the device and confirming connection

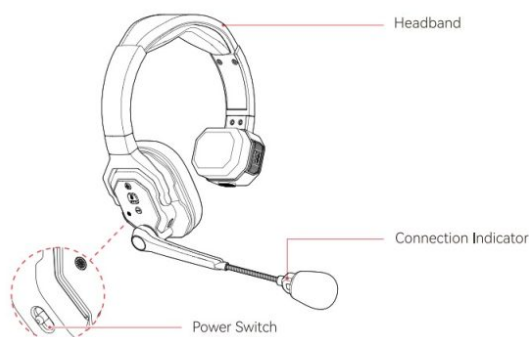

1. Toggle the power switch to turn on the headsets.
2. The indicator light changing from flashing green to solid green indicates successful connection.
3. The master headset has a brown headband while the remote headset has a black

headband.

## Turning on the microphone

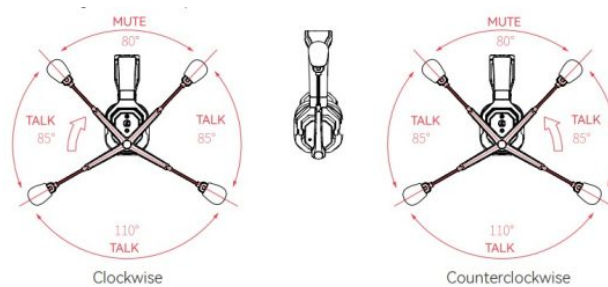

## Beginning your work

### Headset Pairing

All remote headsets are prepared with the master headset at the factory, so they are ready to use upon poweron. Pairing is only necessary when adding new headsets to an existing system. Ensure that the master headset and all remote headsets are powered on while pairing.

1. Long press the volume + button on both the master and remote headsets for 5s and the indicator lights will flash rapidly.
2. The indicator lights turning solid indicates successful connection.
3. One master headset can connect to up to seven remote headsets.



## Specifications

Product Name	Full-Duplex Wireless Intercom System
LOS Range	1,100ft (350m)
Operating Frequency	1.9 GHz (DECT)
Modulation Mode	GFSK
Transmit Power	< 20dBm (100mW) (Only for CE)

Receiver Sensitivity	< -90 dBm
Battery Capacity	770 mAH (2.926Wh)
Charging Time	< 3 hours
Frequency Response	150 Hz – 7 kHz ( $\pm 10$ dB)
SNR	71 $\pm$ 2dB @94dB SPL, 1 kHz
Distortion	< 1% @94dB SPL, 150 Hz – 7 kHz
Microphone Type	Electret
Maximum Input SPL	> 115dB SPL
Output SPL	98dB SPL (@94dB SPL, 1kHz)
Environmental Noise Reduction	> 20dB (from all directions)
Weight	rc- 185.2g (with battery)
Temperature	0 – 45°C (working) -10 – 60°C (storage)

**Note:** Due to differences in various countries and regions, there may be variations in the operating frequency and wireless transmit power of the product.

Product Name	6-Slot Charging Base	8-Slot Charging Base
Port	USB-C Port; Charging Contacts	
Dimensions	119.3 x 57.6 x 34.6mm (4.7 x 2.3 x 1.4in.)	154.5 x 57.6 x 34.6mm (6.1 x 2.3 x 1.4in.)
Weight	91.1g	121.6g
Charging Power	5. 10W	
Power Supply	4.75 – 5.25V	

Charging Current	380mA/Slot	
Charging Time	< 3 hours (6 batteries)	< 4 hours (8 batteries)
Temperature	0 – 45°C working) -20 – 60°C (storage)	

## Disclaimer







### Safety Precautions

Do not place the device near or inside heating devices (including but not limited to microwave ovens, induction cookers, electric ovens, electric heaters, pressure cookers, water heaters, and gas stoves) to prevent the battery from overheating and exploding.

Use the original charger, data cables, and batteries provided with the product. Using unauthorized or incompatible chargers, data cables, or batteries may cause electric shock, fire, explosion, or other dangers.

### Support

If you encounter any problems in using the product or need any help, please contact Hollyland Support Team via the following ways:

	Hollyland User Group
	HollylandTech
	HollylandTech
	HollylandTech
	<a href="mailto:support@hollyland.com">support@hollyland.com</a>
	<a href="http://www.hollyland.com">www.hollyland.com</a>

### Statement:

All copyrights belong to Shenzhen Hollyland Technology Co., Ltd. Without the written approval of Shenzhen Hollyland Technology Co., Ltd., no organization or individual may

copy or reproduce part or all of any written or illustrative content and disseminate it in any form.

**Trademark Statement:**

All the trademarks are owned by Shenzhen Hollyland Technology Co., Ltd.

Note:

Due to product version upgrades or other reasons, this Quick Guide will be updated from time to time. Unless otherwise agreed, this document is provided as a guide for use only. All representations, information, and recommendations in this document do not constitute warranties of any kind, express or implied.





Manufacturer: Shenzhen Hollyland Technology Co., Ltd.

Address: 8F, 5D Building, Skyworth Innovation Valley, Tangtou Road, Shiyan Street, Baoan District, Shenzhen, 518108, China

MADE IN CHINA

## Documents / Resources

  	<a href="#">HOLLYLAND SE Pro Solidcom Wireless Intercom Systems [pdf]</a> User Guide  SE Pro, SE Pro Solidcom Wireless Intercom Systems, Solidcom Wireless Intercom Systems, Wireless Intercom Systems, Intercom Systems
--	--

## References

- [User Manual](#)

## Leave a comment

Your email address will not be published. Required fields are marked \*

Comment \*

Name

Email

Website

☐ Save my name, email, and website in this browser for the next time I comment.

Post Comment

Search:

e.g. whirlpool wrf535swhz

Search

Manuals+ | Upload | Deep Search | Privacy Policy | @manuals.plus | YouTube

This website is an independent publication and is neither affiliated with nor endorsed by any of the trademark owners. The "Bluetooth®" word mark and logos are registered trademarks owned by Bluetooth SIG, Inc. The "Wi-Fi®" word mark and logos are registered trademarks owned by the Wi-Fi Alliance. Any use of these marks on this website does not imply any affiliation with or endorsement.