



HOLLYLAND C1 HUB8S Intercom Headset System User Guide

[Home](#) » [HOLLYLAND](#) » HOLLYLAND C1 HUB8S Intercom Headset System User Guide 

Contents

- 1 [HOLLYLAND C1 HUB8S Intercom Headset System](#)
- 2 [Introduction](#)
- 3 [Packing List](#)
- 4 [Product Interfaces](#)
- 5 [Headset Interfaces](#)
- 6 [Charging Case Interfaces](#)
- 7 [Quick Start Guide](#)
- 8 [Headset Status Indicator](#)
- 9 [Cascade Connections](#)
- 10 [HUB Display Interfaces](#)
- 11 [HUB Settings](#)
- 12 [Check Group Settings on HUB](#)
- 13 [Parameters](#)
- 14 [Safety Precautions](#)
- 15 [FCC Requirement](#)
- 16 [Documents / Resources](#)
 - 16.1 [References](#)
- 17 [Related Posts](#)



HOLLYLAND C1 HUB8S Intercom Headset System



Introduction

Thank you for purchasing Hollyland Full-duplex Wireless Intercom System. The Solidcom C1 HUB8S includes eight single-sided remote wireless headsets along with eight rechargeable batteries, a charger, a HUB base with a wired headset, and accessories. It is a full-duplex wireless DECT intercom system engineered to provide clear audio and all-day wearing comfort in a true-wireless design with no belt-pack required. The system operates in the 1.9GHz band, providing a reliable transmission range up to 1000ft (350m) radius (LOS). This Quick Guide will guide you through the installation and use of the equipment.

Packing List

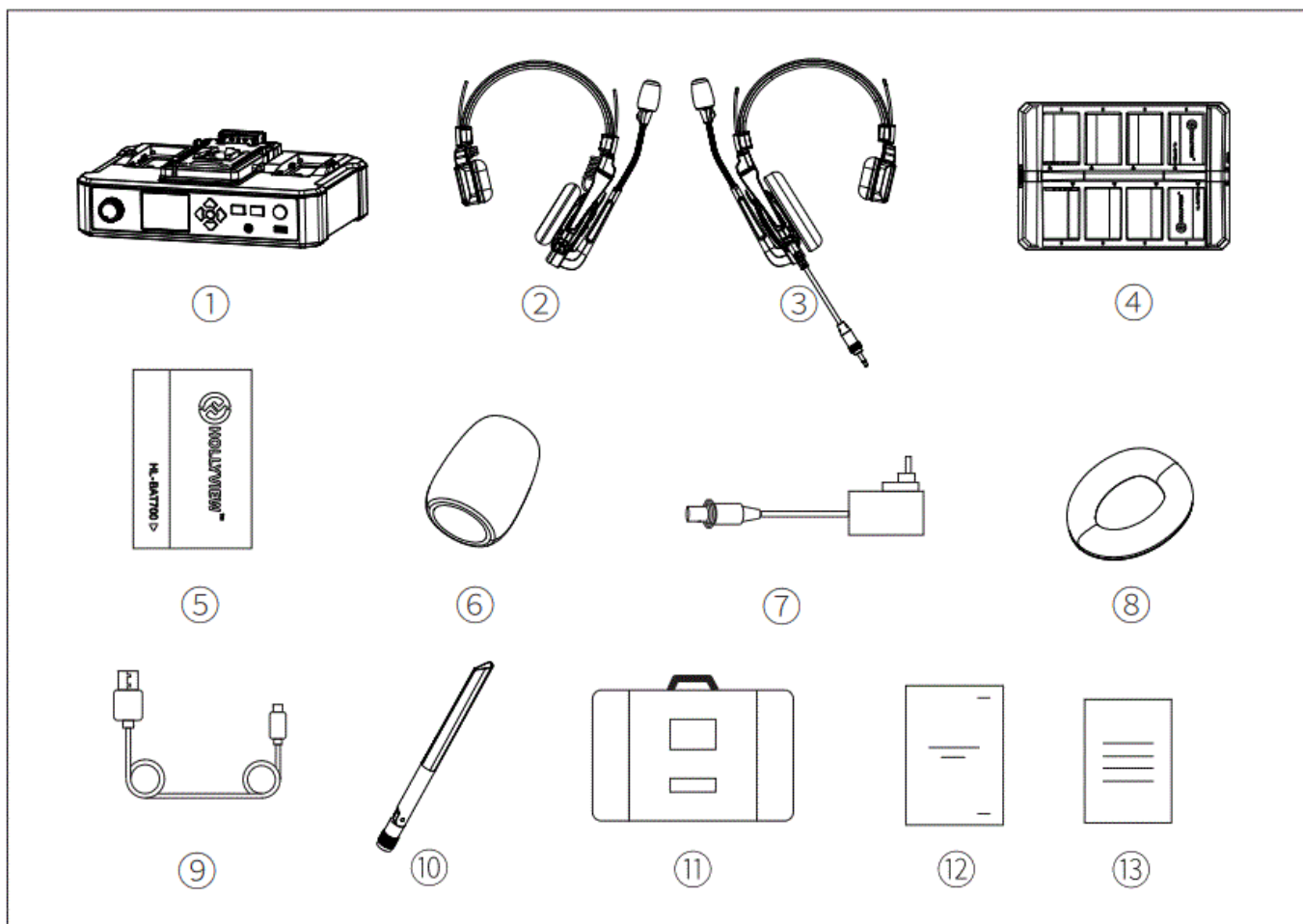

Solidcom C1 – HUB8S Headset Intercom Package

1. **HUB Base:** x1
2. **Remote Headset (with blue nameplate):** x8
3. **3.5mm HUB Headset (with red nameplate):** x1
4. **Charging Case:** x1
5. **Battery:** x16
6. **Microphone Cushion:** X9
7. **12V/2A DC Adapter:** X2
8. **Over-ear Cushion:** X9
9. **High-gain Antennas:** x4
10. **Storage Case:** x1
11. **Quick Guide:** x1
12. **Warranty Card:** x1

Note: The amount of the items listed above depends on the edition.

Product Interfaces

HUB Base Interfaces

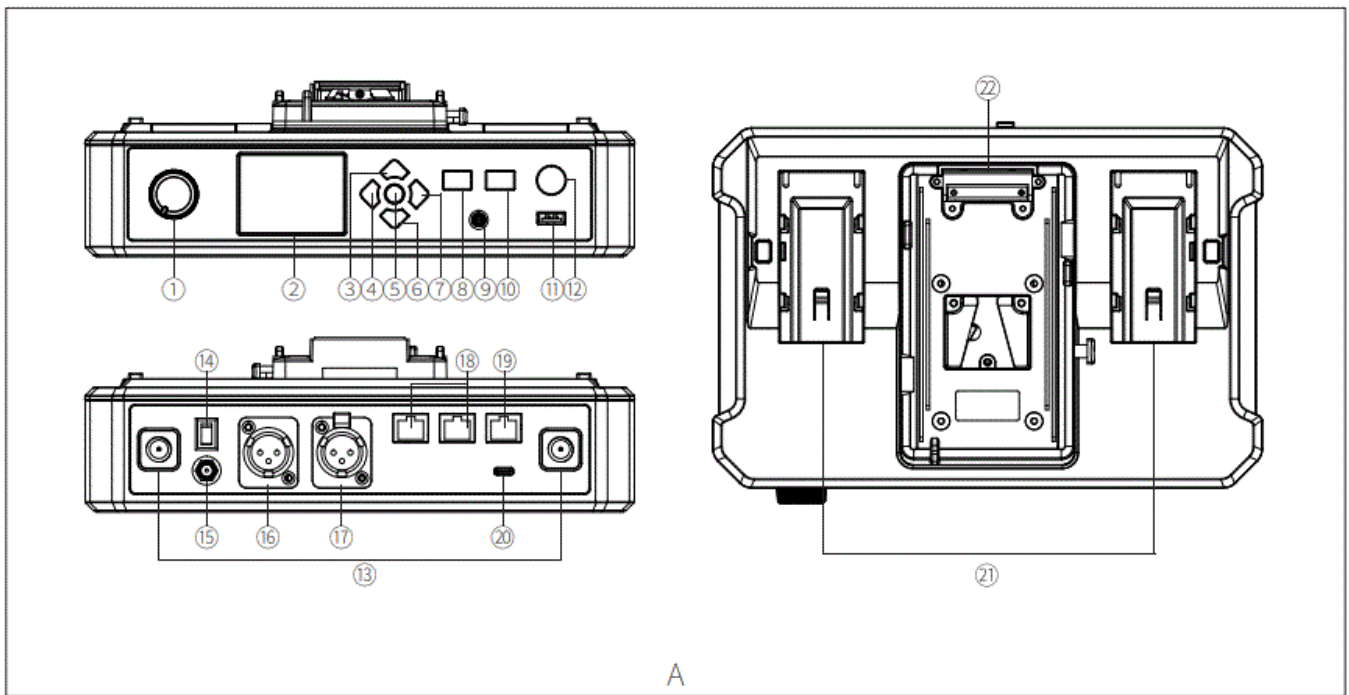

A

1. HUB Headset Volume Knob
2. Display
3. UP Arrow Key
4. LEFT Arrow Key
5. Menu/Confirm Button – Long press to enter the main menu/press once to confirm
6. DOWN Arrow Key
7. RIGHT Arrow Key
8. Join/Exit Group A Button for the 3.5mm HUB Headset The indicator turns off when the HUB Headset exit Group AS Conversation, and turns on in orange after joining in
9. 3.5mm Headphone Jack
10. Join/Exit Group B Button for the 3.5mm HUB Headset The indicator turns off when the HUB Headset exit Group Bs conversation, and turns on in orange after joining in
11. USB Interface
12. ANNOUNCE Button – Press and hold the button while making an ANNOUNCE, release the button when finished
13. RF Antenna Interface
14. Power Switch
15. DC Power Interface
16. PGM Audio Input Interface
17. D2-wire Audio Input & Output Interface
18. RJ45 Network Port
19. 4-wire Audio Input & Output Interface (RJ45 network socket)
20. UAC Interface
21. NP-F Battery Bay
22. V-Mount/G-Mount Battery Plate (Subject to the actual product you purchased)

Headset Interfaces

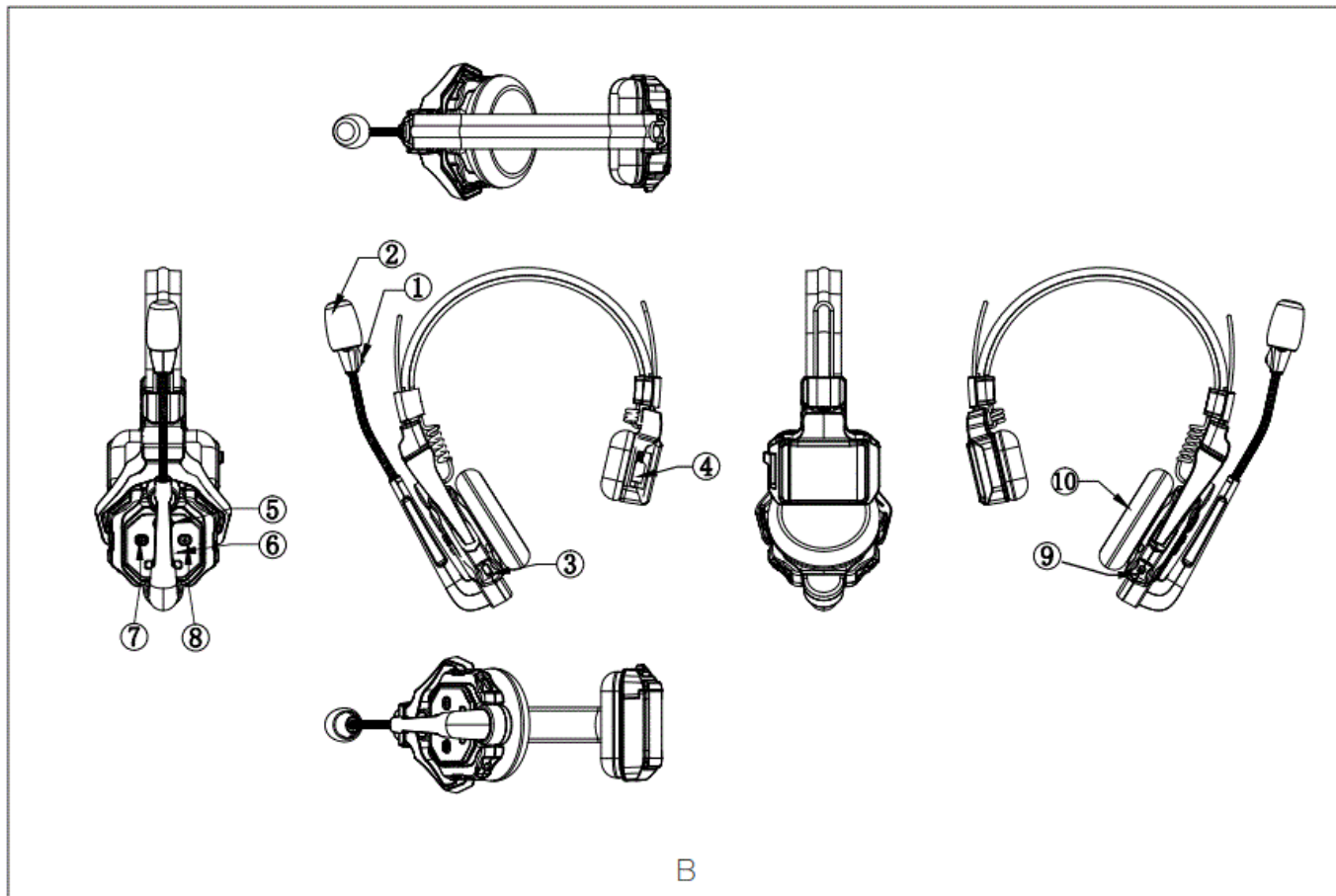

1. Power/Connection Indicator
2. Microphone
3. USB Type-C Interface For firmware upgrade, and headset pairing
4. Battery Compartment
5. Volume + Button
6. Volume – Button
7. A Button – Lights up when joining Group A, turns off when exited Group A; Long press for 5 seconds to pair
8. **B** Button – Lights up when joining Group B, turns off when exiting Group B
9. Power Button
10. Speaker

Charging Case Interfaces

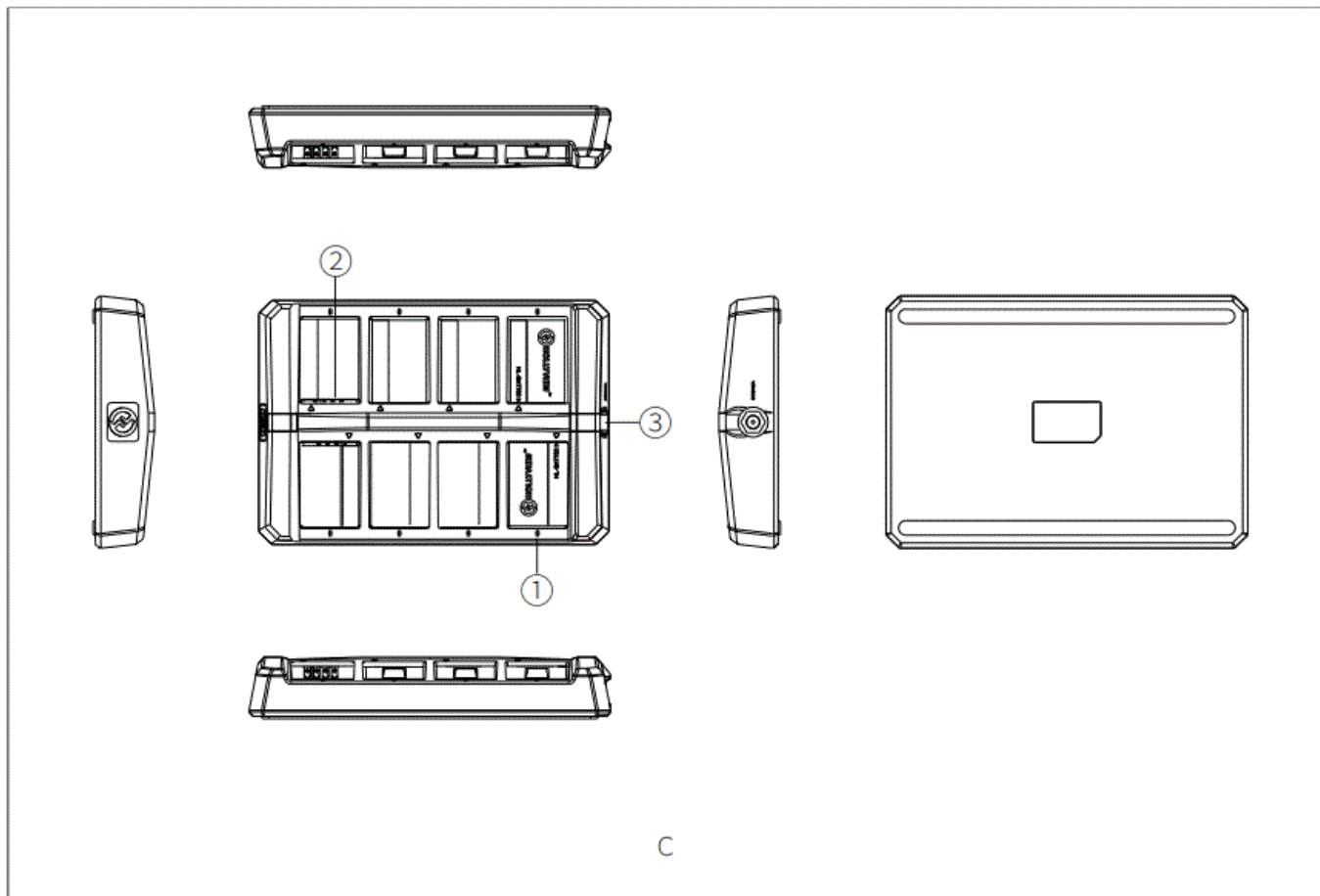

1. Charging Indicator

- **Orange:** charging in progress
- **Green:** Fully charged

2. Charging Contact

3. DC Charging Interface

Quick Start Guide

Set Up HUB Base

Install the HUB antennas

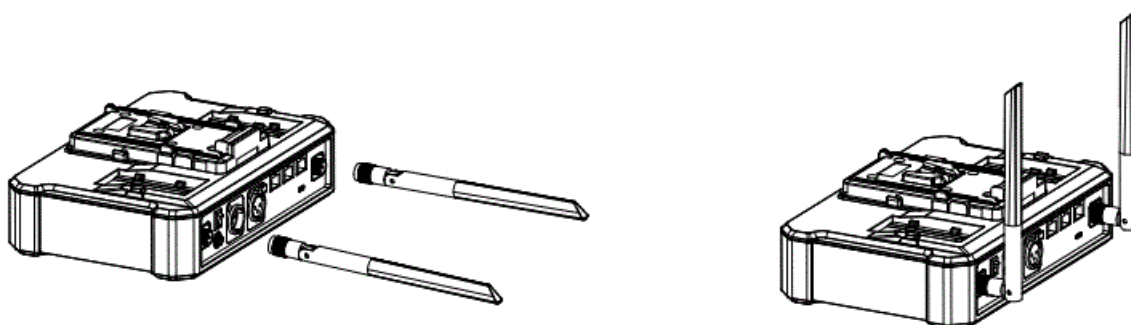

Power Up HUB Base

- Connect the 12V/2A DC Adapter to the HUB base.
- Press the Power Switch to turn on.

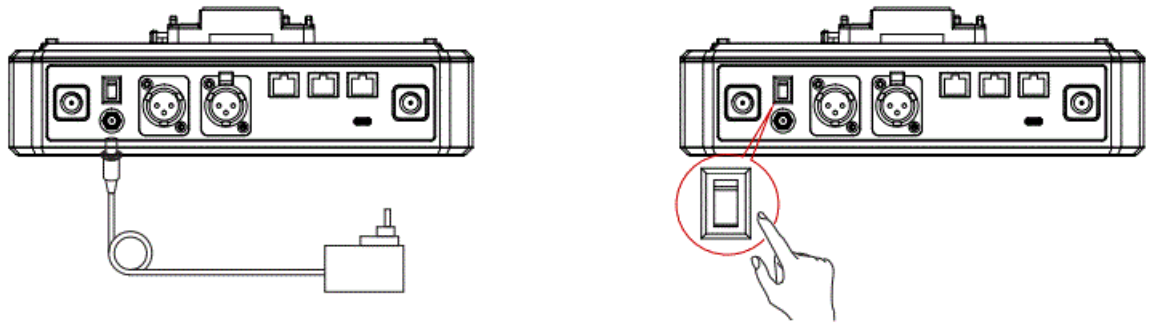

Note: The HUB Base can be powered using an NP-F battery, V-Mount/G-Mount battery, or DC power supply.

Install Headset Battery

Step 1: Slide the battery compartment cover lock

Step 2: Open the cover

Step 3: Place the battery into the compartment and close the battery cover

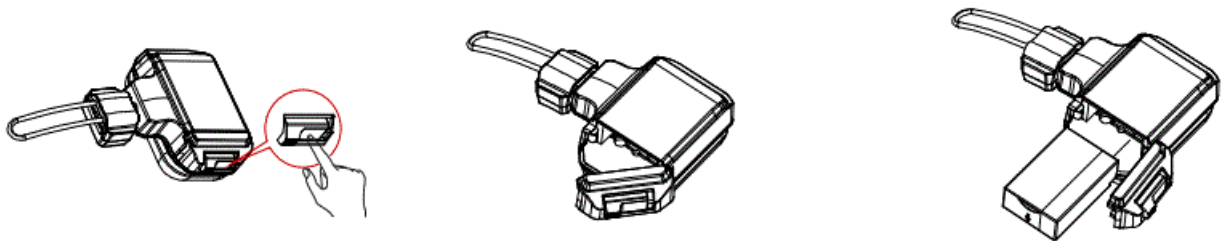

Turn On Headset

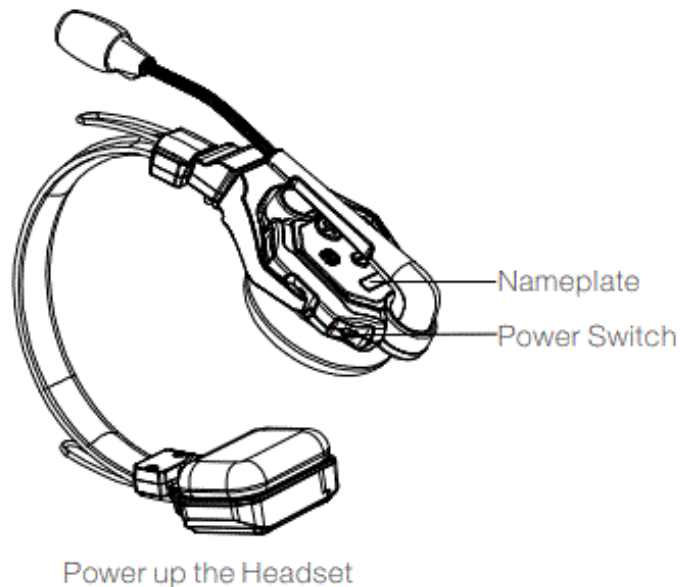

Note: The indicator light stops flashing and turns to static green when the HUB Base and the Remote Headset(s) are successfully connected.

Mute/Unmute Microphone

Mute/Unmute the headset's microphone by moving the mic boom up/down

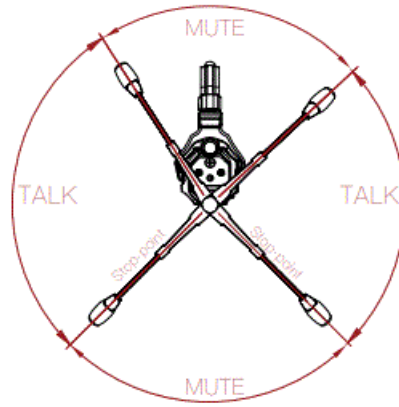

1. Move the mic boom up to the MUTE position that makes a CLICK sound, and the HUB Base's interface displays "MUTE" corresponding to the headset status.
2. Move the mic boom down to the TALK position that makes a CLICK sound, and the HUB Base's interface displays "TALK" corresponding to the headset status.

The device is now ready for use.

HUB Base Main Display Interfaces

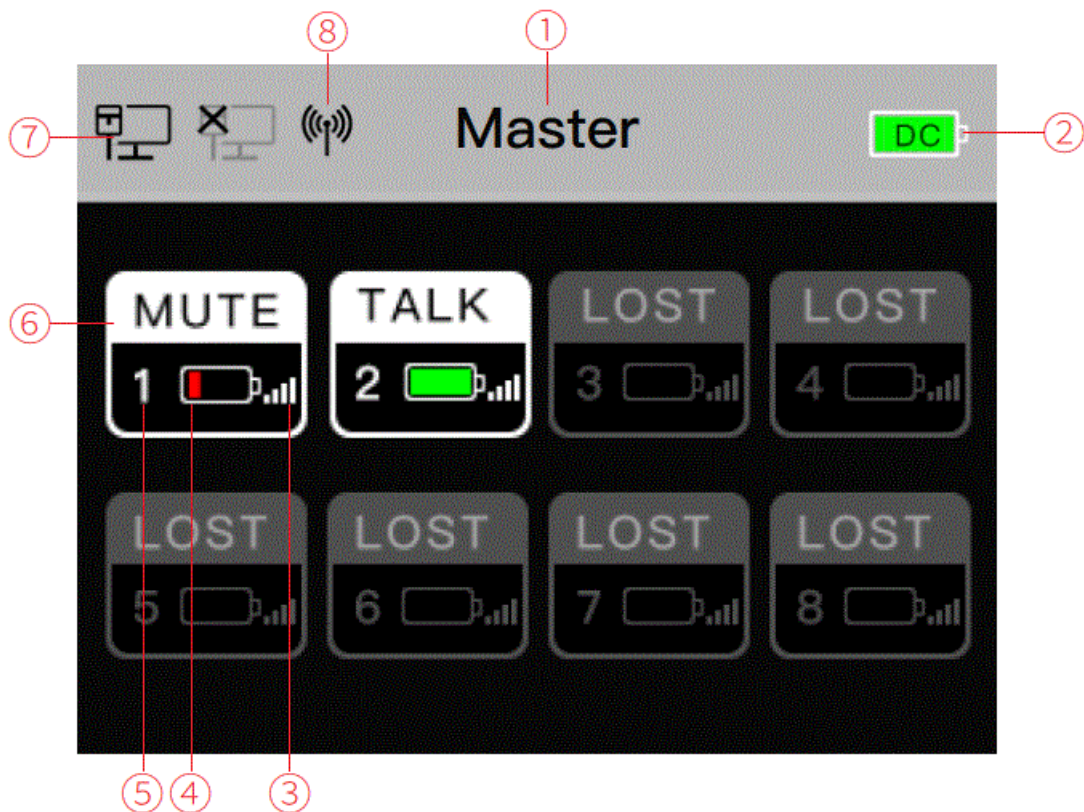

1. HUB Base configuration – Master/Slave
2. HUB Base battery level
3. Headset signal strength
4. Headset battery level – turns red in low battery
5. Headset number
6. Headset status

1. TALK: Headset is active to hear and talk
 2. MUTE: Headset is muted to hear only
 3. LOST: Headset lost connection with HUB Base
7. Network connection status
 8. WiFi status

Headset Status Indicator

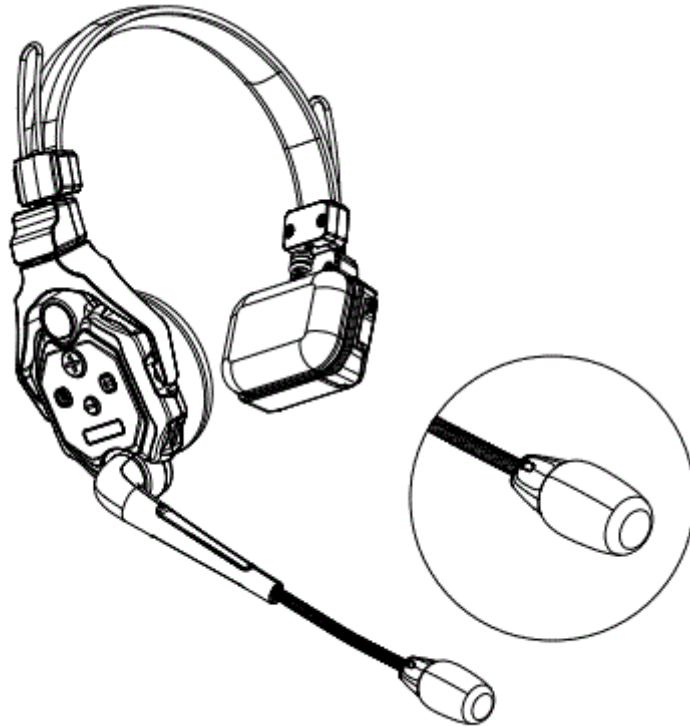

1. **FLASH GREEN:** Headset disconnected
2. **STATIC GREEN:** Headset connection successful
3. **FLASH RED:** Low battery, please change the battery

Pairing Operation

The HUB Base and Remote Headsets that come in one system package will auto pair up right out of box. Manual pairing is only required when there is a need for adding or changing headset or HUB base to the system.

Connect the HUB Base and the Headset with a USB-C Cable.

Pairing requires a USB-C cable. Connect one end to the USB interface on the HUB Base's front panel, and the other end to the USB-C interface of the headset. The HUB Base screen will display the Select Number interface. Locate the designed headset number with the arrow keys, and press the round Menu/Confirm Button to complete number setting and pairing.

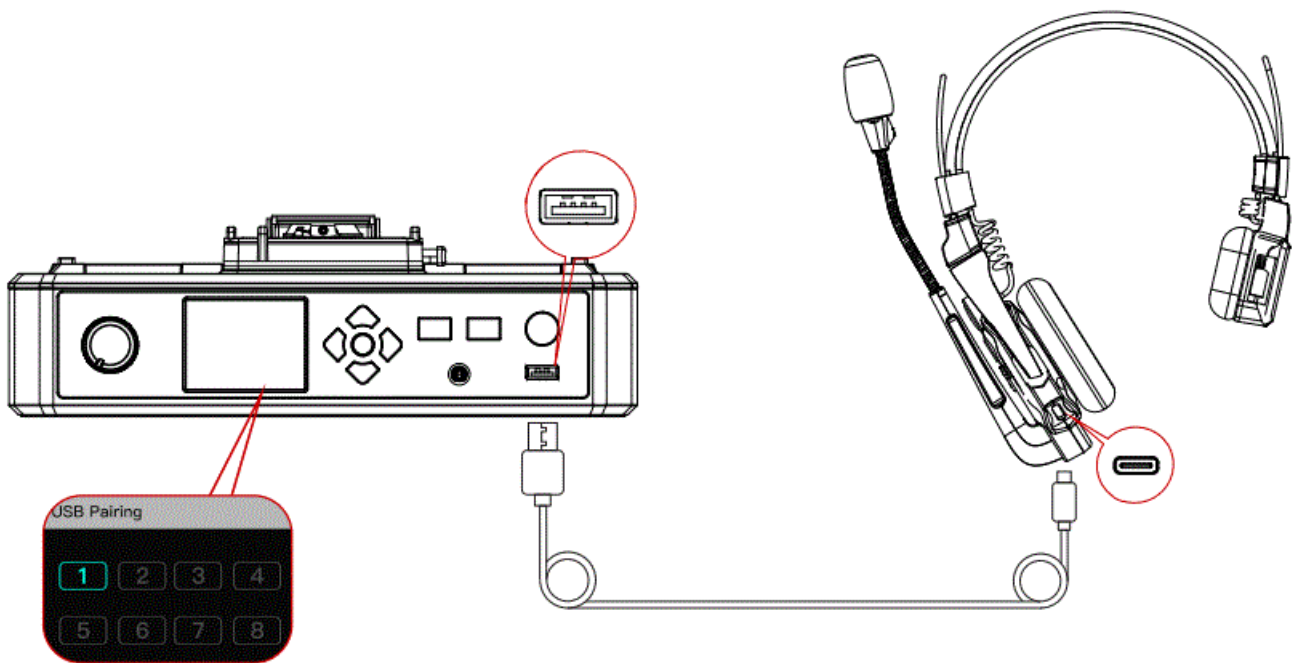

Headset(s) Number Setting via HUB Base

When repairing and numbering the headset, be sure to turn on all the headsets to avoid selecting duplicate numbers, which may lead to connection failure with other headsets. In case of the wrong numbering of a headset, simply connect it to the HUB with the USB cable and operate the pairing and numbering process again.

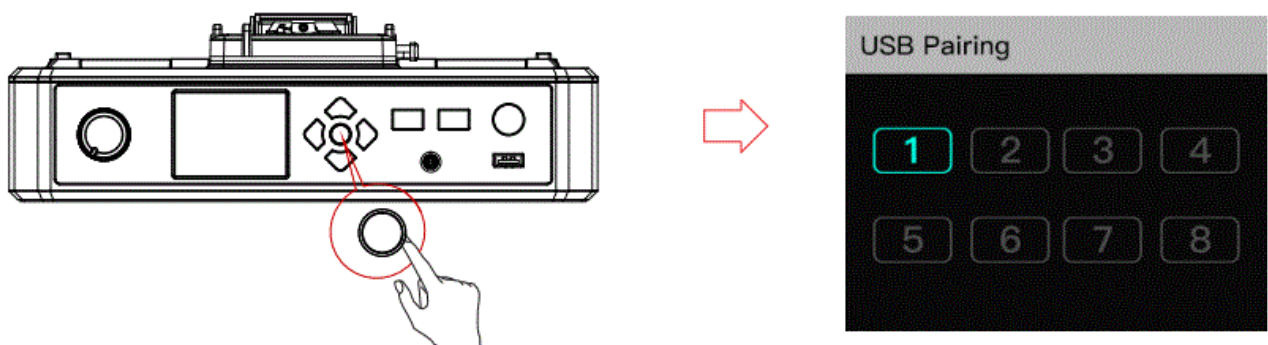

Cascade Connections

Multiple sets can be cascaded to expand the number of headsets. The Solidcom C1 HUB Base supports two cascading methods, 4-wire analog and IP digital signal cascading. 4-wire analog mode is generally used in cascading connections of 2 sets, and the IP digital signal cascade for 3 sets. If more than 3 sets are cascaded, it is recommended.

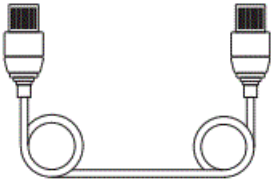
Standard Network Cable	Cable Spec	Max. Length
	CAT 5e CAT 6e	300m

Two Systems Cascade via 4-Wire Interface

Use a standard network cable to connect two HUB bases through the 4W interface. The network cable is generally up to 300 meters long

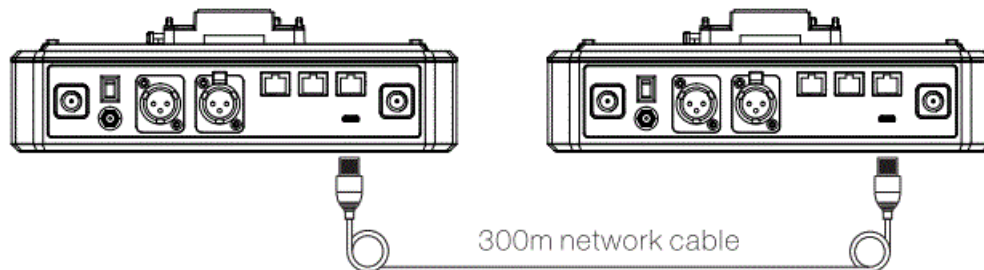

4 Wire Settings

After connecting the two systems with the network cable, configure each HUB Base's line sequence by entering "4 Wire Settings" and selecting "Line sequence switching". Set the first HUB Base to "Standard mode" and the second HUB Base to "Cross mode".

HUB Display Interfaces

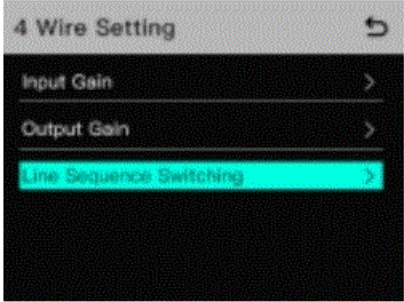
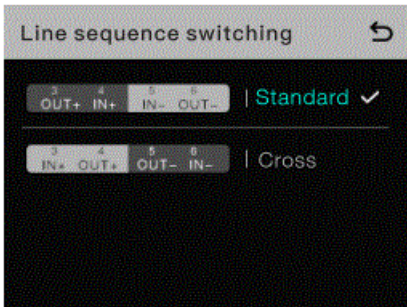
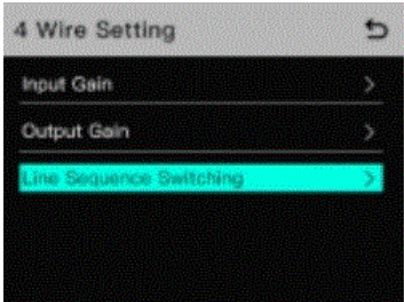
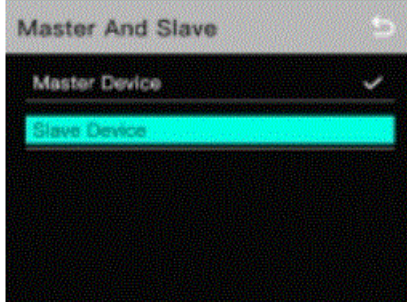
HUB ①	Enter “4 Wire” menu, and select “Line sequence switching”	Set to “Standard mode”
4 Wire Settings		
HUB ②	Enter “4 Wire” menu, and select “Line sequence switching”	Set to “Cross mode”
4 Wire Settings		

Two Systems Cascade via IP Network

Use a standard network cable to connect the two systems through the RJ45 network port. Either one of the two RJ45 network ports on the HUB works. The network cable is generally up to 300 meters long.

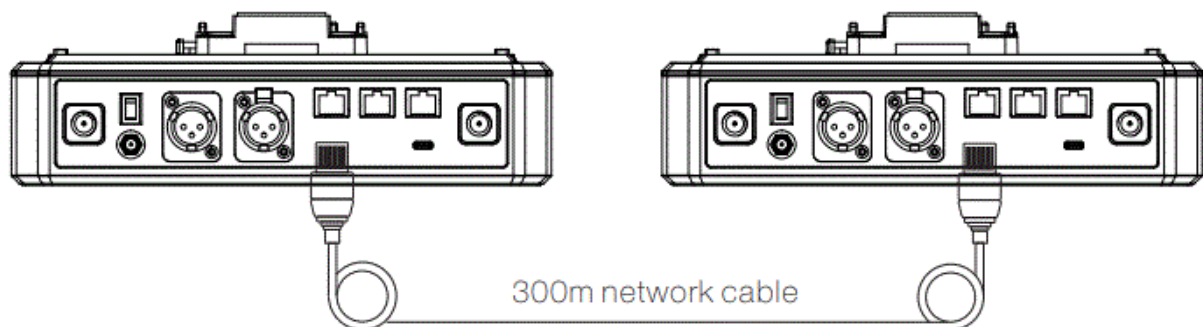

HUB Settings

After connecting the two systems with the network cable, configure each HUB Base’s basic settings as Master or Slave device. Generally, the first system is set as Master Device, and the second one as Slave Device. In this case, you need to turn OFF the “Obtain IP address automatically” under “Network” settings on both the HUB Bases.

HUB Display Interfaces

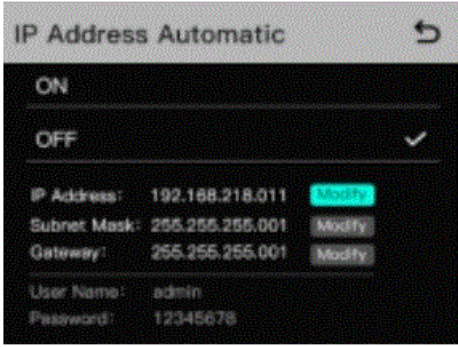
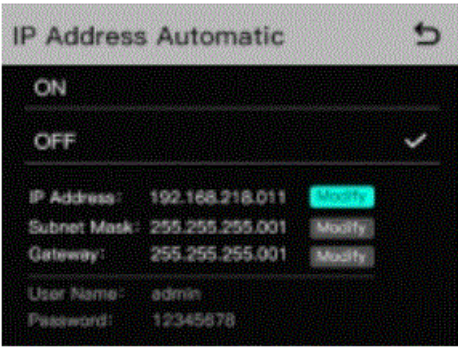
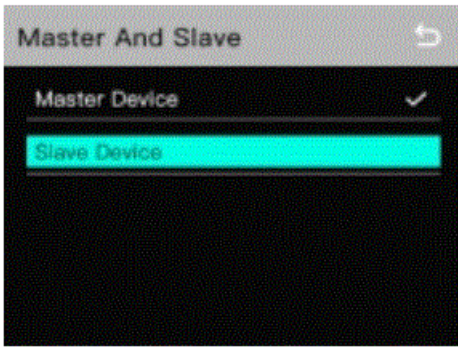
HUB ①	Enter "Network" menu, and set the "Obtain IP address automatically" to OFF	Enter "Master and Slave" menu, and select "Master Device"
Network Settings		
HUB ②	Enter "Network" menu, and set the "Obtain IP address automatically" to OFF	Enter "Master and Slave" menu, and select "Slave Device"
Network Settings		
	Tap "Scan" to enter. The screen will display the Master Device's IP address. Use the Arrow Key to locate the IP address, and press Confirm.	

Three Systems Cascade via IP Network Cascade Connection Method

When cascading three systems, it is recommended to use the IP network connection. Set the first system's HUB to Master Device and the second and third HUBs to Slave Device.

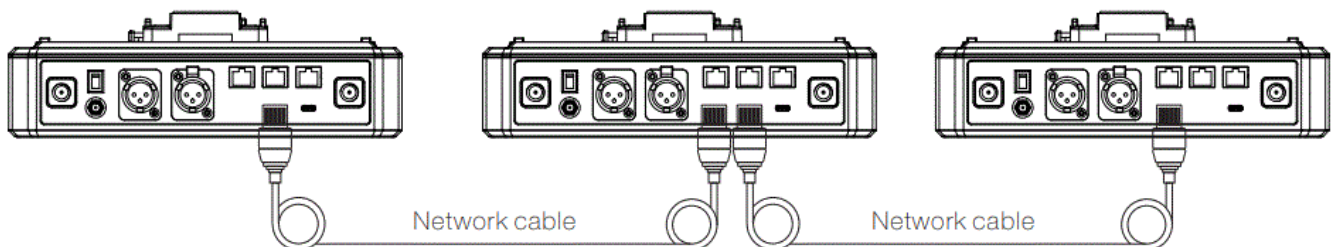

Group Settings

The HUB Base supports A and B grouping settings. You can view the system's current group setting by entering the Group menu on the HUB. To operate group settings, connect the computer and the HUB via the RJ45 interface using the network cable, and enter the Group settings menu. Or download the Solidcom APP on the mobile phone and connect to the HUB through WiFi to access the Group settings menu.

Check Group Settings on HUB

Viewing method:

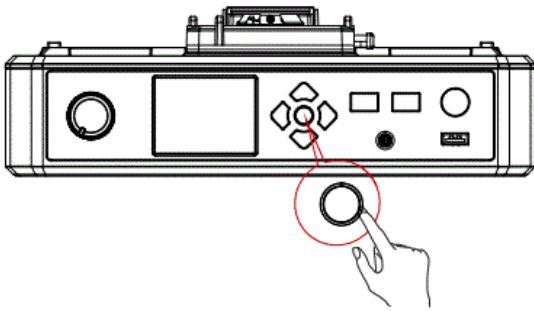

Long press the Menu/Confirm Button to enter the Group settings menu

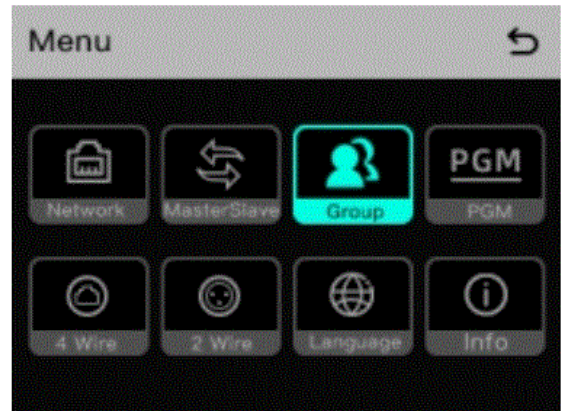

HUB Display Interfaces

Operate Grouping via Computer

Enter the “Network” menu on the HUB, and select “Wired network settings” to view the HUB’s default IP Address, User Name and Password. Use a network cable to connect the computer and the HUB via the RJ45 network port. Set the IP address of the computer as [192.168.218.xxx], and the default IP address of the HUB as [192.168.218.10]

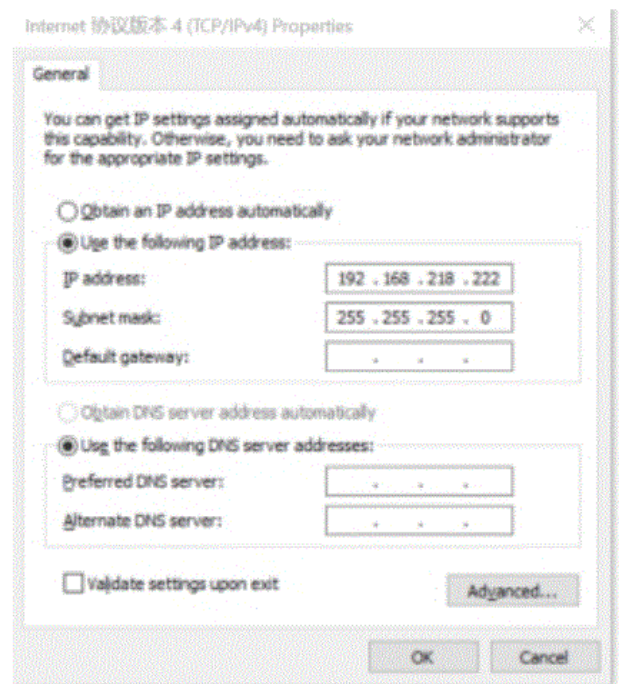
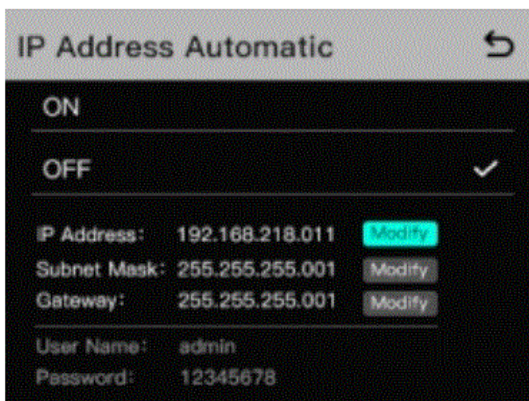

Open the browser on the computer and visit <http://192.168.218.10> to enter the configuration page of the HUB.

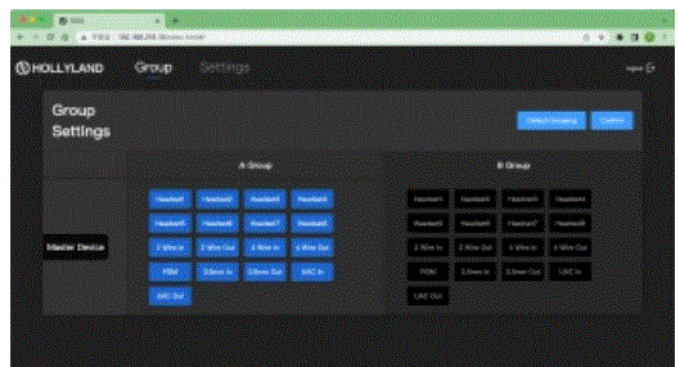
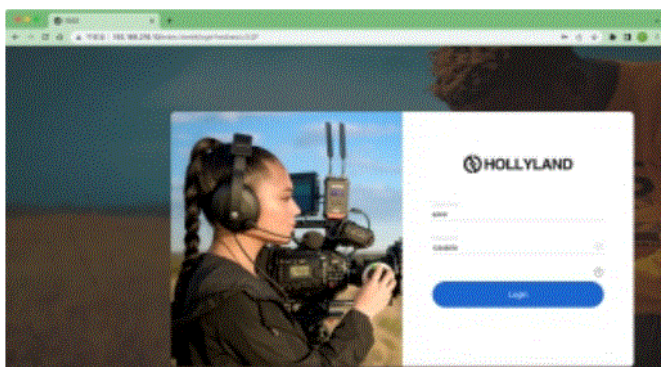

A & B Group Buttons on Headset(s)

After entering Group setting on the HUB, the A and B Buttons on the connected headset will light up. The button light status indicates which group the headset has joined. Press the A or B Button on the headset to Join/Enter the corresponding group.

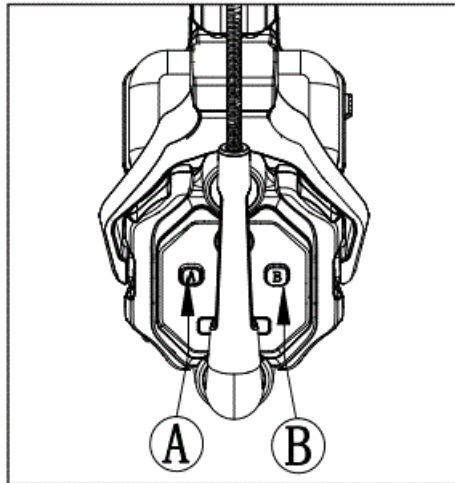

A and B Button Light Status	Status
Light ON	When the A or B Button lights ON, it indicates the headset has joined the corresponding group and can converse with the other headset(s) in the same group.
Light OFF	When the A or B Button lights OFF, it indicates the headset has exited the corresponding group.

Parameters

Range	350m (1000ft) Line-of-Sight
Frequency Information	Frequency band: 1.9GHz DECT (varies by country and region) Modulation mode: GFSK Transmit power: <21dBm (125.9mW) (varies by country and region) Receiving sensitivity: <-90dBm
Transmission Latency	35ms
Battery Capacity	700mAh (2.66Wh) Li-Ion battery
Headset Runtime	Remote headset: ≈10h
Charging Time	≈2.5h
Frequency Response	150Hz~7kHz
Signal-to-Noise Ratio	55dB
Distortion	1
Microphone Type	Electret
Maximum Input Sound Pressure Level	Electret
Output Sound Pressure Level	Typical 98±3dBSPL(at94dBSPL1kHz)
HUB Base Net weight	≈1300g (antennas excluded)
Net Weight	≈170g (batteries included)
Temperature Range	Working status: 0~+45°C Storage status: -20~+60°C

Note: The frequency band and transmit power varies by country and region.

Safety Precautions

Do not place the headsets near or inside heating devices (including but not limited to microwave ovens, induction, cookers, electric ovens, electric heaters, pressure cookers, water heaters, gas stoves) to prevent the battery from overheating and exploding. Never use non-original charging cases, cables and batteries with the product. The use of non-original spare parts may cause electric shock, fire, explosion or other dangers.

Support

If you encounter any problems in using the product or need any help, please contact Hollyland Support Team via the following ways: If encounter any problems in using the product or need any help, please follow these ways to get more technical support:



Hollyland Products User Group



Hollyland Tech



Hollyland Tech



Support@hollyland-tech.com

www.hollyland-tech.com



Statement:

All copyrights belong to Shenzhen Hollyland Technology Co.,LTD.

Trademark Statement:

Without the written approval of Shenzhen Hollyland Technology Co, LTD, no organization or individual may copy or reproduce part or all of the content of the text without authorization, and may not disseminate it in any form. All representations, information, and recommendations in this document do not constitute warranties of any kind, express or implied.

Note:

Due to product version upgrades or other reasons, this quick guide will be updated from time to time. Unless otherwise agreed, this document is provided as a guide for use only. All representations, information, and recommendations in this document do not constitute warranties of any kind, express or implied.

FCC Requirement

Any changes or modifications not expressly approved by the party responsible for compliance could void the user's authority to operate the equipment. This device complies with Part 15 of the FCC Rules. Operation is subject to the following two conditions:

1. this device may not cause harmful interference.
2. this device must accept any interference received, including interference that may cause undesired operation.

FCC Radiation Exposure Statement:

The device has been tested and comply with FCC SAR limits.

Note: This equipment has been tested and found to comply with the limits for a Class B digital device, pursuant to Part 15 of the FCC Rules. These limits are designed to provide reasonable protection against harmful interference in a residential installation. This equipment generates, uses, and can radiate radio frequency energy, and if not installed and used in accordance with the instructions, may cause harmful interference to radio communications. However, there is no guarantee that interference will not occur in a particular installation. If this equipment does cause harmful interference to radio or television reception, which can be determined by turning the equipment off and on, the user is encouraged to try to correct the interference by one or more of the following measures:

- Reorient or relocate the receiving antenna.
- Increase the separation between the equipment and receiver.
- Connect the equipment into an outlet on a circuit different from that to which the receiver is connected.
- Consult the dealer or an experienced radio/TV technician for help.

Documents / Resources

 <p>Hollyland Solidcom C1 HUB8S Quick Guide v1.0.0</p>	<p>HOLLYLAND C1 HUB8S Intercom Headset System [pdf] User Guide C1 HUB8S, Intercom Headset System, Headset System, Intercom Headset, C1 HUB8S, Headset</p>
---	---

References

-  [Hollyland - Wireless Video Transmitter, Intercom, Microphone](#)

Manuals+.