

hohem iSteady Mobile Plus 3 Axis Smartphone Gimbal User Manual

Specifications

- Model: iSteady Mobile+
- Axis: 3-axis
- Compatibility: Smartphones with screen sizes up to 6.7 inches
- Charging Method: USB-C charging cable (5V-2A adapter recommended)
- Battery Status: 4 LED lights (100% fully charged), 3 LED lights(75%), 2 LED lights (50%), 1 LED light (25%)
- Power Button: Used for reverse charging smartphones
- App Compatibility: Hohem Joy (iOS 11.0 or later, Android 6.0 or later)

Contents

- [1 Product Usage Instructions](#)
- [2 Product List](#)
- [3 Introduction](#)
- [4 Battery and Charging](#)
- [5 Download the Hohem Joy App](#)
- [6 First Use](#)
- [7 Vertical Mode](#)
- [8 Quick Switch to Portrait Mode](#)
- [9 Magnetic Fill Light *Item included only in the kit](#)
- [10 Buttons and Gimbal Modes](#)
- [11 App Features](#)
- [12 Auto Calibration and Firmware Update](#)
- [13 FAQs](#)
- [14 Product Specification](#)
- [15 Warning & Disclaimer](#)
- [16 Warranty Terms](#)
- [17 Product Hazardous Substances Content Table](#)
- [18 Documents / Resources](#)
 - [18.1 References](#)
- [19 Related Posts](#)

Product Usage Instructions

Product List

Before using this product, please carefully check that all the following items are included in the product package. In case that any item is found missing, please contact Hohem customer service or the local distributor.

- iSteady Mobile+

- Magnetic Fill Light (included only in the kit)
- Tripod
- Storage Bag
- Type C Charging Cable
- Warranty Card
- Quick Start Guide

Introduction

The iSteady Mobile+ is a 3-axis smartphone gimbal designed to stabilize your smartphone while capturing videos or photos. It features a magnetic fill light (included only in the kit), magnetic contact roll motor, pan motor, 1/4 inch extension screw hole, handle with a built-in battery, mode indicator, zoom/focus slider, Bluetooth indicator, joystick, mode button, ON/OFF (shutter button), tilt motor, balancing knob, rotatable phone holder, trigger, USB output, and Type-C input.

Battery and Charging

Before use, please ensure that iSteady Mobile+ has sufficient battery power.

Charging Method: To charge the iSteady Mobile+, connect a USB adapter (5V-2A recommended) into the charging port with the provided USB-C charging cable.

Battery Display: Tap the power button to check the battery status. Flickering indicates charging, 4 LED lights on means it is fully charged, 3 LED lights on indicates 75% battery, 2 LED lights on indicates 50% battery, and 1 LED light on indicates 25% battery.

Reverse Charging: For Android smartphones, use the provided USB-C to USB-C cable. For iOS smartphones, use a USB-C to Lightning cable (not included).

Power Button

Tips: When the gimbal is powered off, press the power button once to start reverse charging your smartphone.

Download the Hohem Joy App

Download the Hohem Joy app from the App Store or Google Play by scanning the provided QR code or searching for "Hohem Joy". The app requires iOS 11.0 or later for Apple devices and Android 6.0 or later for Android devices.

First Use

Mounting your mobile phone:

- For smartphones with screens up to 6.1 inches (e.g., iPhone 15), pull the phone clamp and mount the phone. Push the phone to the rightmost position close to the motor. Loosen the knob, slide the arm to balance the gimbal, and then tighten the knob.
- For smartphones with screens larger than 6.1 inches (e.g., iPhone 15 Pro Max), mount the phone almost at level with the ground. It is recommended to remove bulky phone cases before installation.

Powering on the gimbal:

- In horizontal mode, long press the power button to power on.
- In vertical mode, do not rotate the phone clamp while the gimbal is powered on. Loosen the knob, slide the arm to the leftmost position, tighten the knob, and then rotate the phone clamp 90 degrees. Pull the phone clamp and mount the phone. Adjust the phone up or down to roughly balance the gimbal. Make sure the phone is roughly balanced, and then long press the power button to power on.

Quick Switch to Portrait Mode

After switching to portrait mode, the joystick will only control the phone to rotate left and right.

FAQ

1. **Q: Can I use a USB-C to Lightning cable for reverse charging with Android smartphones?**

A: No, reverse charging with Android smartphones requires a USB-C to USB-C cable.

2. **Q: How do I check the battery status of iSteady Mobile+?**

A: Tap the power button to check the battery status. The number of LED lights indicates the battery level.

3. **Q: Can I use a bulky phone case with iSteady Mobile+?**

A: It is recommended to remove bulky phone cases before mounting your phone on the gimbal.

4. **Q: What is the maximum screen size supported by iSteady Mobile+?**

A: iSteady Mobile+ supports smartphones with screen sizes up to 6.7 inches.

Product List

Before using this product, please carefully check that all the following items are included in the product package. In case that any item is found missing, please contact Hohem customer service or the local distributor.



iSteady Mobile+



Magnetic Fill Light
*Item included only in the kit



Tripod

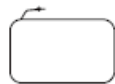

Storage Bag



Type C Charging Cable



Warranty Card



Quick Start Guide

Introduction

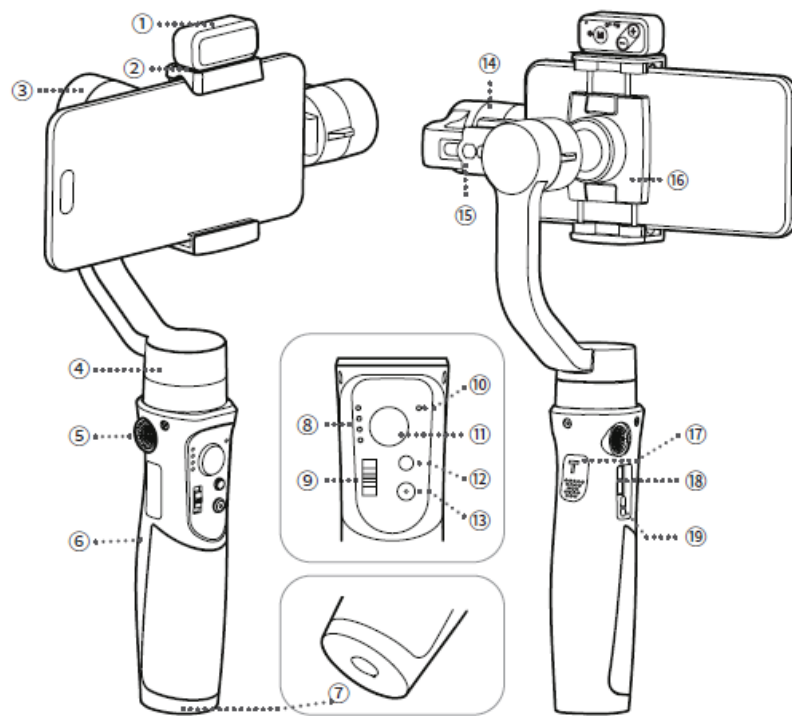

1. Magnetic Fill Light *Item included only in the kit
2. Magnetic Contact
3. Roll Motor
4. Pan Motor
5. 1/4 Inch Extension Screw Hole
6. Handle (Battery inside)
7. 1/4 Inch Extension Screw Hole
8. Mode Indicator
9. Zoom/Focus Slider
10. Bluetooth Indicator
11. Joystick
12. Mode Button
13. ON/OFF (Shutter button)
14. Tilt Motor
15. Balancing Knob
16. Rotatable Phone Holder
17. Trigger
18. USB Output
19. Type-C Input

Battery and Charging

Before use, please ensure that iSteady Mobile+ has sufficient battery power.

Charging Method: To charge the iSteady Mobile+, connect a USB adapter (not included choose a 5V-2A adapter for better results) into the charging port with the provided USB-C charging cable.

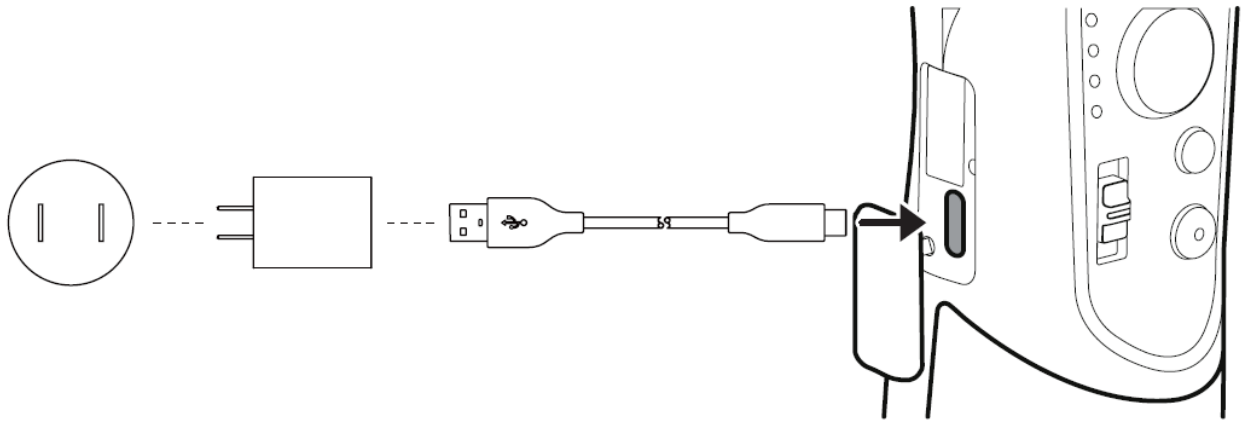

Battery Display: Tap the power button to check the battery status.

Flickering: Charging

- 4 LED lights on: 100%, fully charged
- 3 LED lights on: 75%
- 2 LED lights on: 50%
- 1 LED light on: 25%

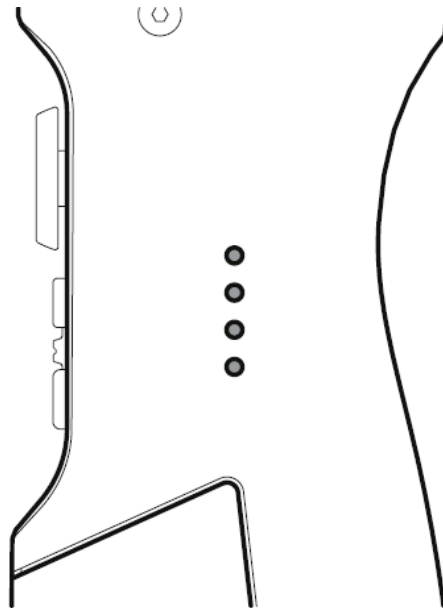

Reverse Charging (DC out charging for smartphones)

Android: Charging with the provided USB-C to USB-C cable.

iOS: Charging with USB-C to Lightning cable (Not Included).

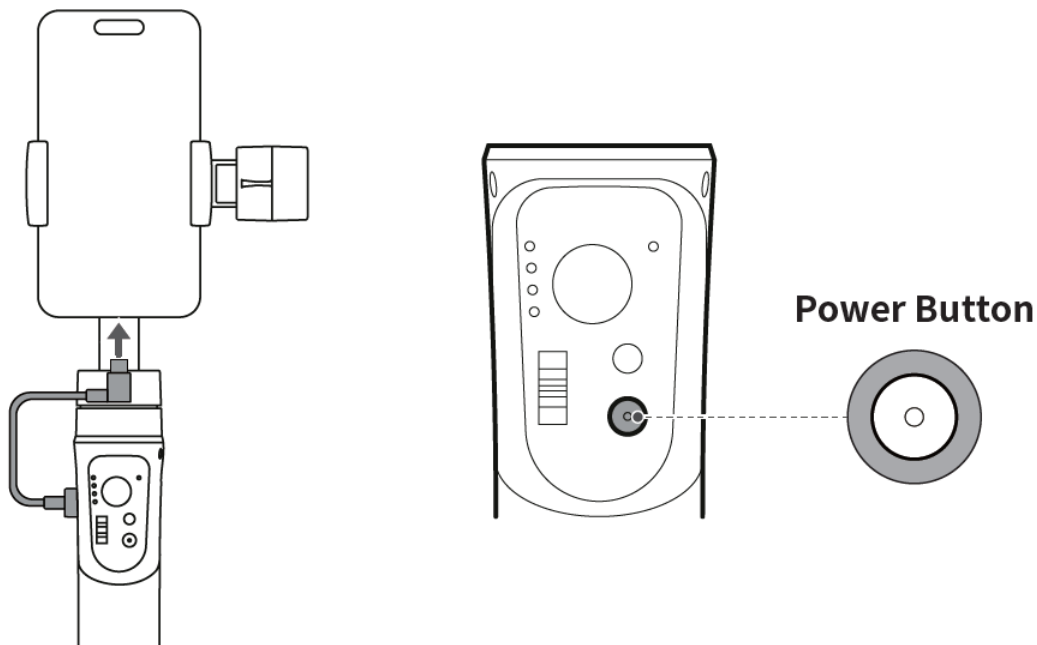

Tips

When the gimbal is powered off, press the power button once to start reverse charging your smartphone.

Download the Hohem Joy App



Scan the QR code or search “Hohem Joy” in App Store or Google Play to download.

- The app Hohem Joy requires iOS 11.0 or later, Android 6.0 or later.
- Items marked “*” are optional accessories which are sold separately.
- Mount your mobile phone before powering on the iSteady Mobile+.
- If no mobile phone is detected or the motor is overloaded because the phone is not balanced well, the gimbal will shut down after a warning beeping.

First Use

- Smartphone screens with 6.7 inches and above, such as iPhone 15 Pro Max, should be mounted almost at level with the ground.
- If your phone case is bulky, it's recommended to remove it before installation.

Horizontal Mode

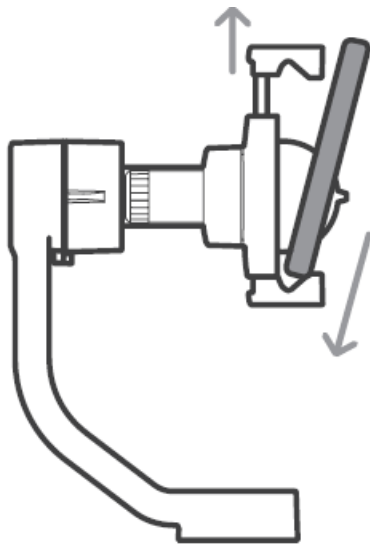

1. Pull the phone clamp and mount the phone.

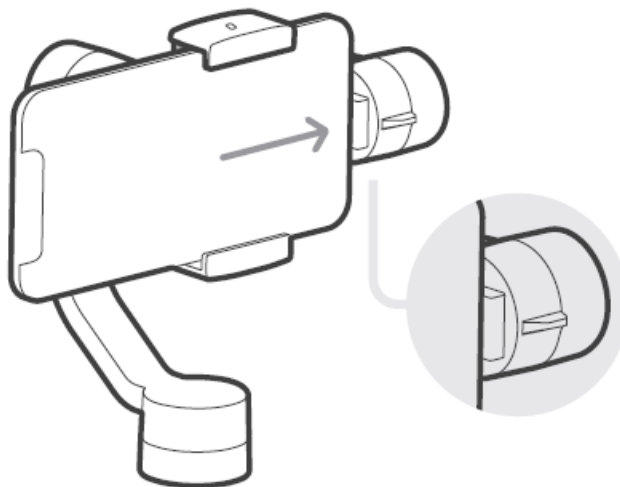

2. Push the phone to the right most to close to the motor.

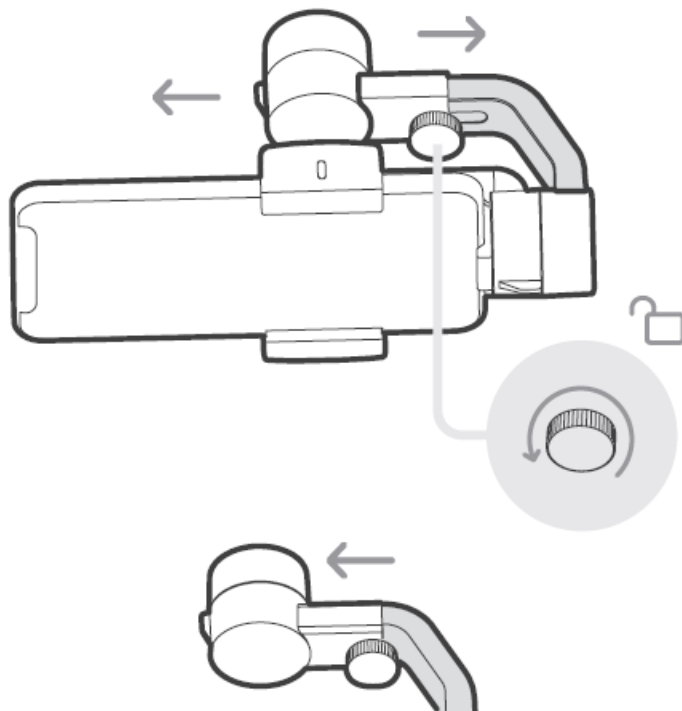

Left

Small phone e.g. iPhone 15(6.1 inches)

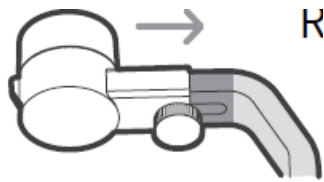

Right

Large phone e.g. iPhone 15 Pro Max (6.7 inches)

3. Loosen the knob, and slide the arm to balance the gimbal.

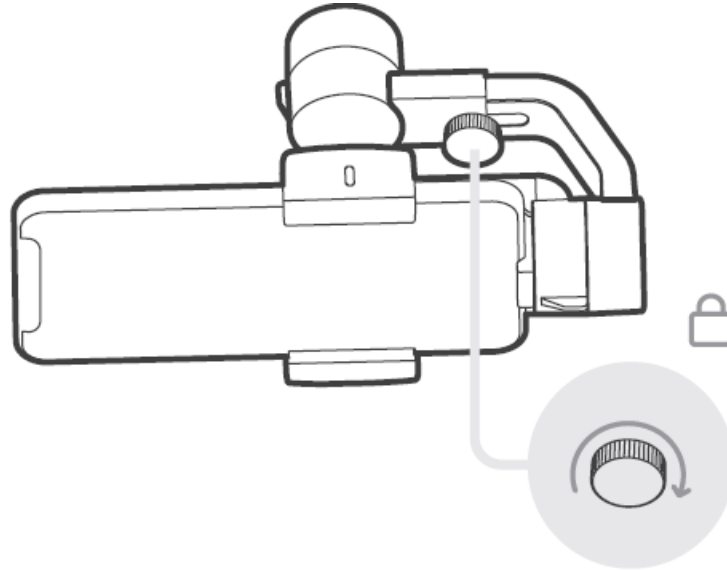

4. Tighten the knob.

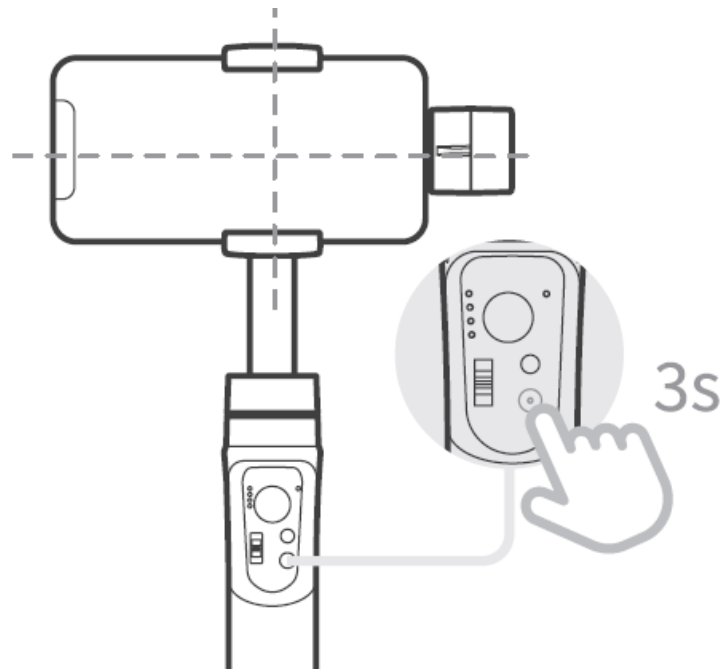

1. Long press the power button to power on.

Vertical Mode

Do not rotate the phone clamp while the gimbal is powered on.

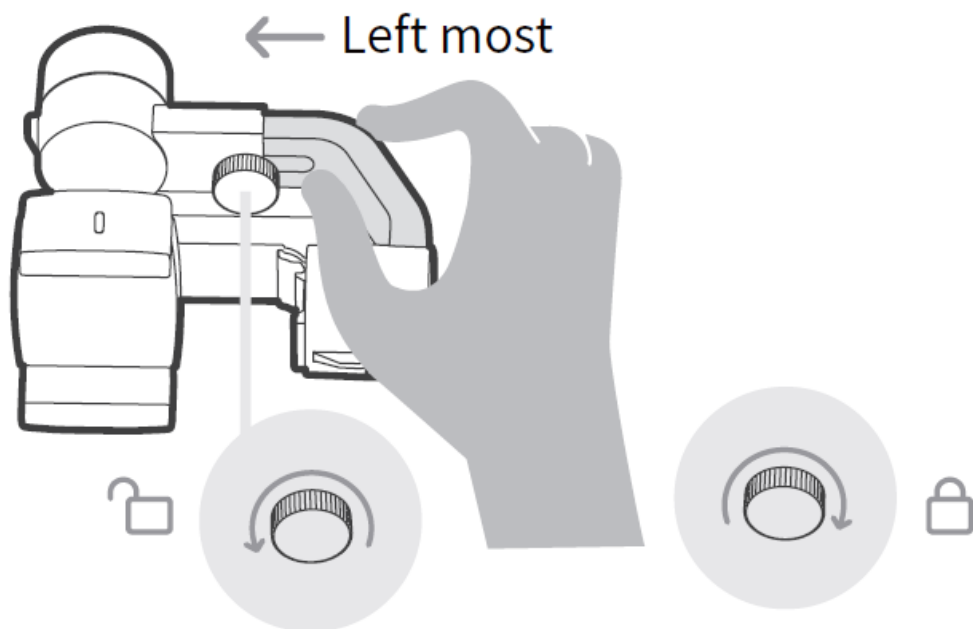

1. Loosen the knob, slide the arm to the leftmost and tighten the knob.

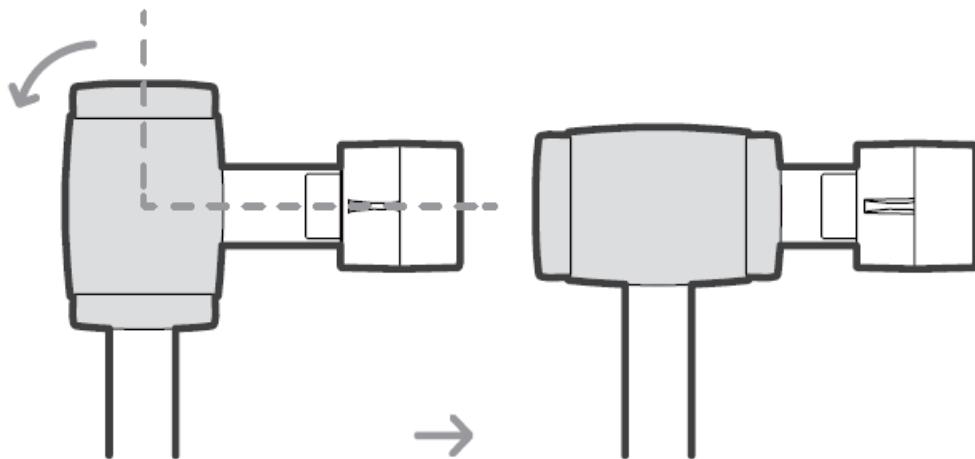

2. Rotate the phone clamp 90 degrees

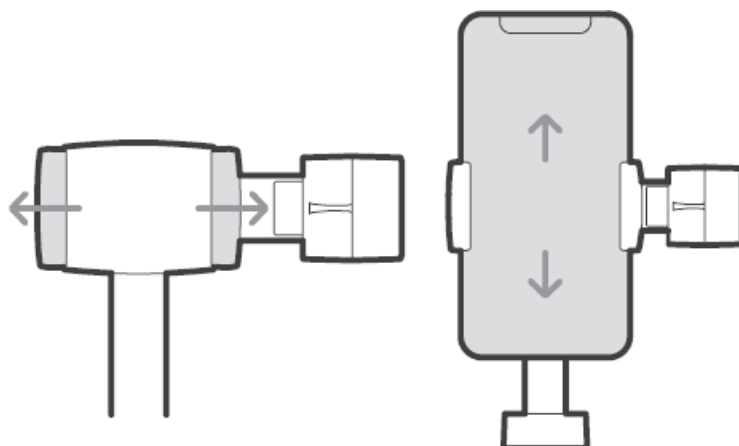

3. Pull the phone clamp and mount the phone. Adjust the phone up or down to roughly balance the gimbal.

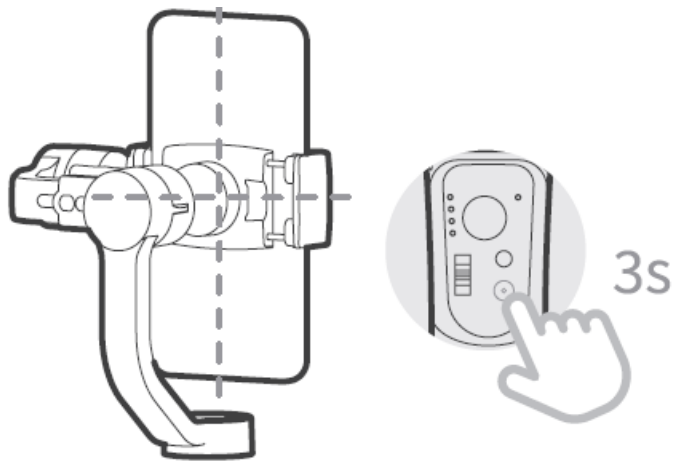

4. Make the phone roughly balance, and long press the power button to power on.

Quick Switch to Portrait Mode

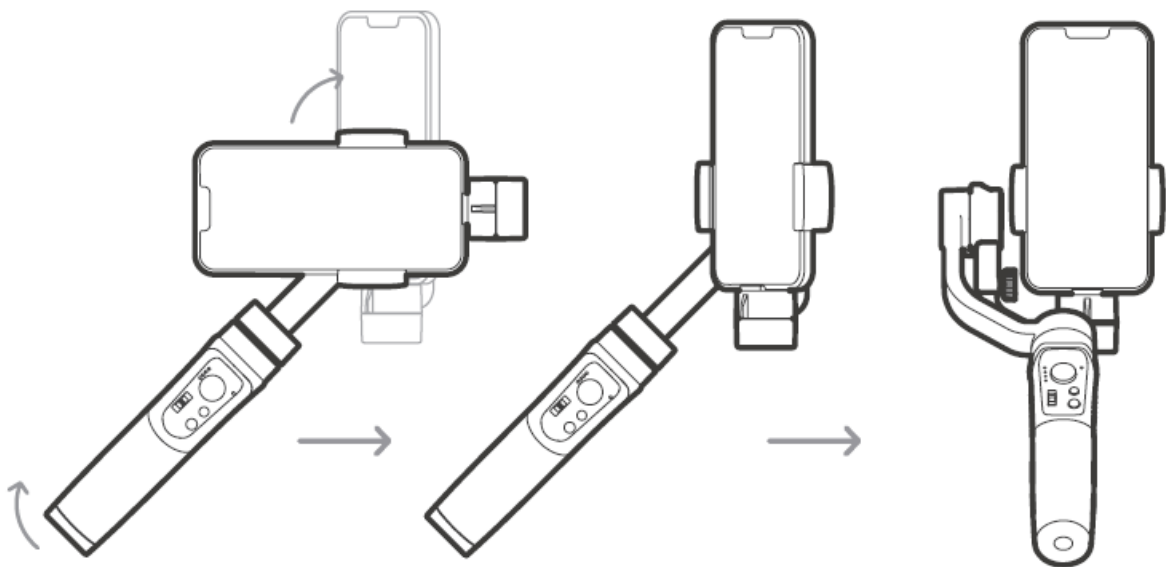

- After you switch to the portrait mode, the joystick only control the phone to rotate left and right.

The following do not support quick switch:

1. In POV mode
2. When the handle is perpendicular
3. When the app setting of left/right joystick is roll



Scan the QR code to watch the tutorials.

Ultra-Wide-Angle Shot

1. Ultra-Wide-Angle Shot, switch to this mode by pressing the trigger four times and the roll motor will be in front of the phone screen for capturing unobstructed views.
2. Default Mode, no obstruction in front of the phone screen.

Ultra-Wide-Angle Shot is only supported to switch while shooting horizontally.

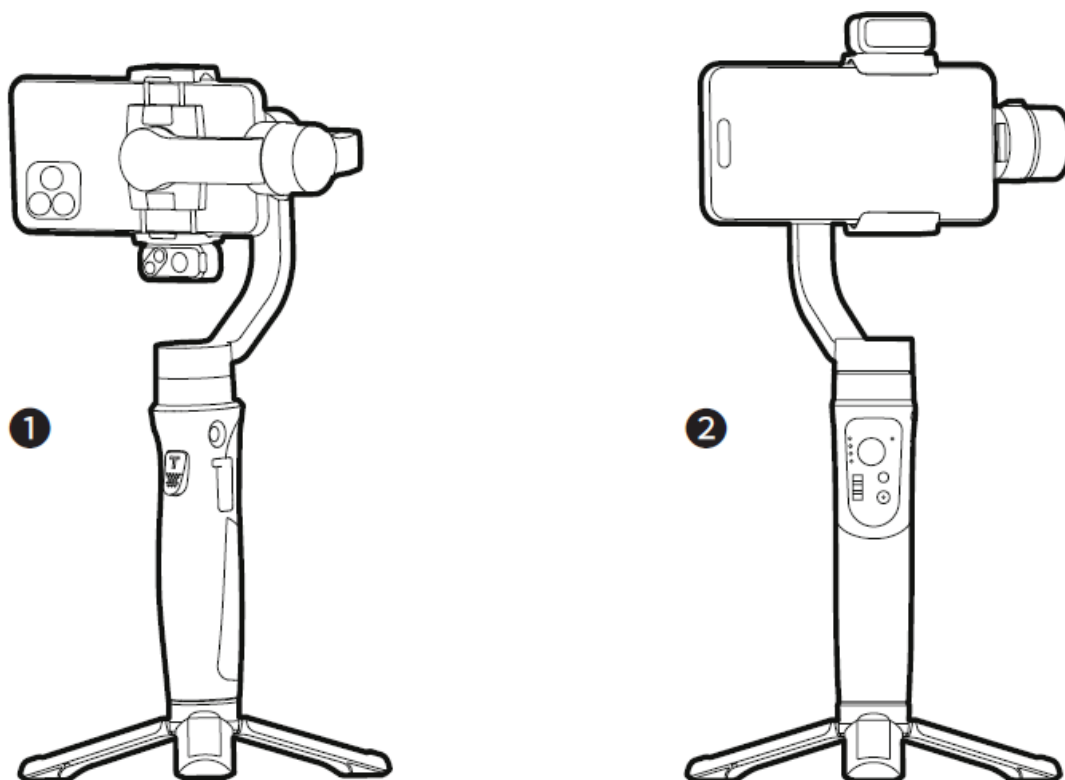

Magnetic Fill Light *Item included only in the kit

Magnetic Attachment

Position the fill light near the magnetic contact ("hohem" logo upward). The magnet on the fill light will automatically attract and attach to the gimbal.

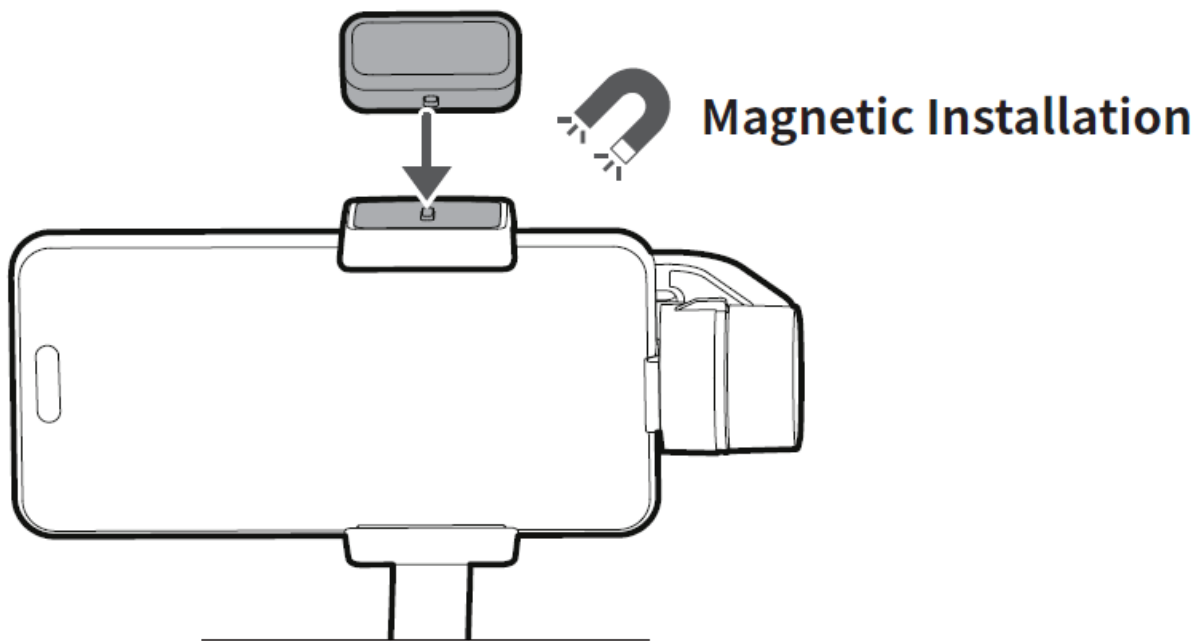

Operation

Cold Light / Warm Light / Natural White Light (10-Level Adjustable Brightness)

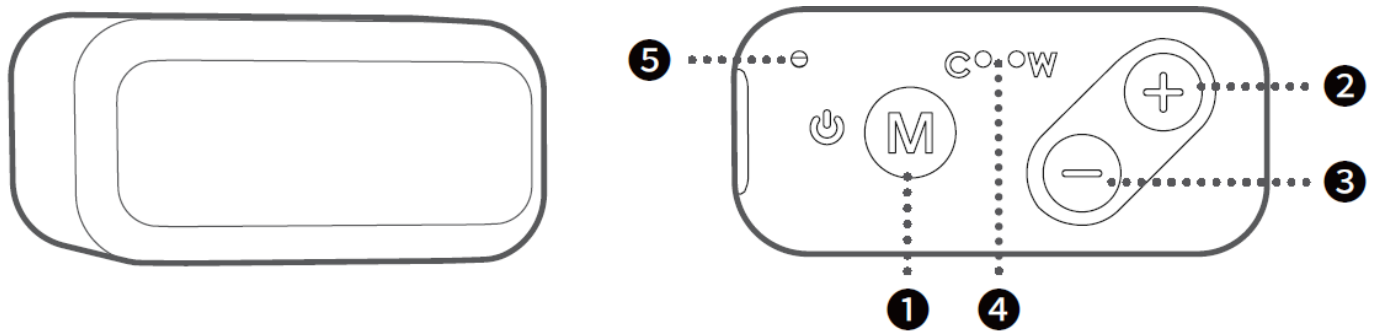

1. **M Button (Turn on/off fill light) Press and hold for 3s:** Turn on/off the fill light

Press once: Cold/warm/natural the white light switch

2. Plus "+" Button

Single press to increase brightness in ten levels

3. Minus "-" Button

Single press to decrease brightness in ten levels

4. Fill Light Indicator

("C" is short for cold; "W" is short for warm.)

C indicator lighting alone: Cold light in use

W indicator lighting alone: Warm light in use

C&W indicators both lighting: Natural white light in use

5. **Power Indicator Flashing red:** Charging Solid red: Fully Charged

Buttons and Gimbal Modes

Buttons and Indicators

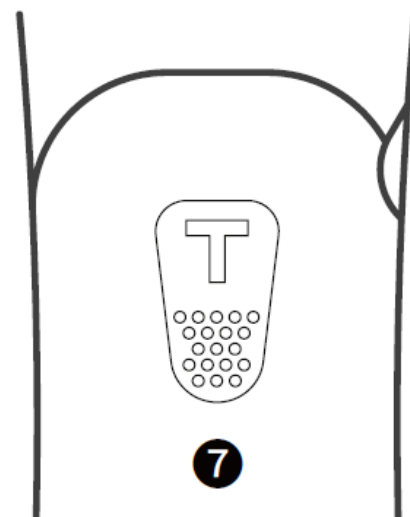
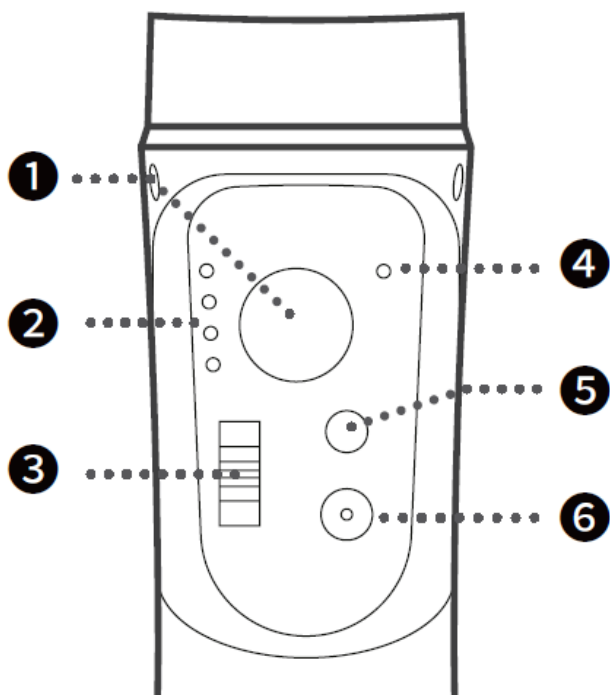

1. Joystick

Push Up/Down: Tilt Control

Push Left/Right: Pan Control

2. Mode Indicator

PF: Pan Follow

PTF: Pan & Tilt Follow

L: All Locked

POV: All Follow & Inception

3. Zoom Slider

(Available in the Hohem Joy / Android 10.0 or later, please ensure the Bluetooth pairing.)

Push up: Zoom in **Push down:** Zoom out

4. Bluetooth Indicator

Soild green: Gimbal is connected with phone Bluetooth

Soild red: Gimbal abnormality

Flashing red: a.Low battery (auto shutdown)

b. Overload (beep warning)

Blinks yellow and green alternately: Remote* Pairing

Blinks yellow: Remote control under operation

Remote control is non standard purchase. For remote control pairing and instructions please see the user manual of remote control or FAQs.

5. Mode Button

Single press: Switch between gimbal modes

Triple press: 600° Auto inception (press mode button to stop the rotation) Press five times: Auto calibration

6. Power Button/ Shutter Button

Press and hold: Power on/off

Single press: Take a photo and start/end video(Please ensure Bluetooth is connected.)

Double press: Switch photo/video modes(Only available in the Hohem Joy / Android 10.0 or later, please ensure the Bluetooth pairing.)

Triple press: Switch front/rear cameras(Only available in the Hohem Joy / Android 10.0 or later, please ensure the Bluetooth pairing.)

7. Trigger Button

Press on: Sport mode

Press once, and then press and hold L All locked

Double press: Recenter the gimbal

Press 4 times: Switch to Ultra-Wide-Angle Shot

Gimbal Modes

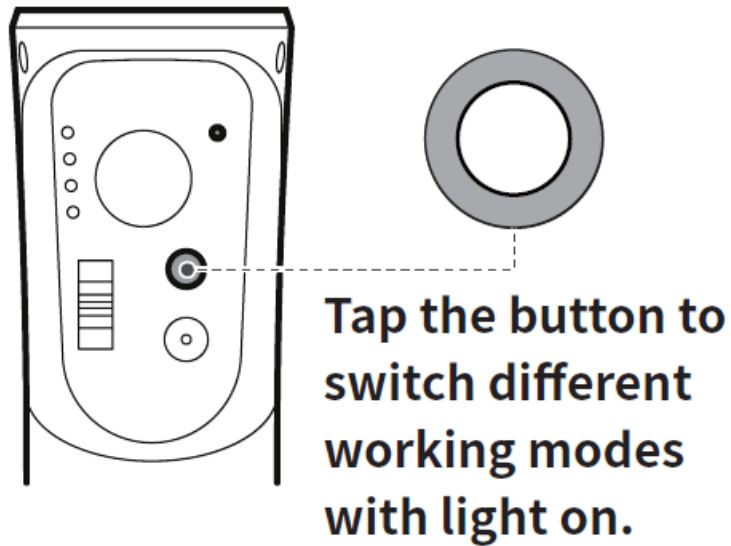

Scan the QR code to watch the tutorials.

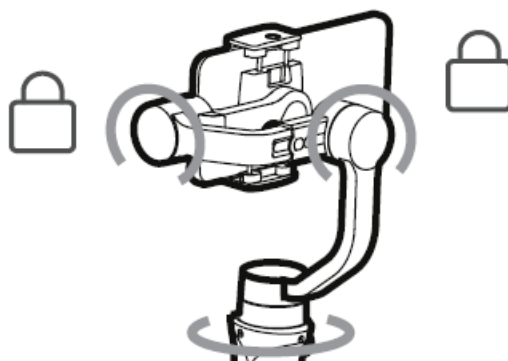

PF (Pan Follow)

Default mode, tilt & roll axis both locked, camera is able to move to left or right smoothly.

PTF (Pan & Tilt Follow)

Roll axis locked, camera is able to move to left/right, and tilt up/down.

L (All Locked)

The camera stays in its current orientation.

POV (All Follow & Inception)

All Follow – Tilt axis, roll axis and pan axis all follow the movement of the gimbal. Inception – Hold the gimbal horizontally and push joystick to left or right.

Hohem Joy App**Bluetooth Connection**

1. Power on iSteady Mobile+
2. Turn on Bluetooth on the Mobile Phone
3. Launch the app Hohem Joy and follow the prompts to connect to iSteady Mobile+.

App Features

1. Exposure Settings
2. Resolution/Frame Rate
3. Smart Tracking
4. Parameter Setting
5. Home
6. Focus/Zoom
7. Flash
8. Beauty & Filters
9. Gesture Control
10. Front/Rear
11. Moment Templates

For more details on the “Hohem Joy” app features, please visit the official website of Hohem (www.hohem.com) and watch iSteady Mobile+ video tutorials. Scan the QR code to watch the tutorials.

Auto Calibration and Firmware Update**Calibration Reasons and How to Calibrate**

Auto calibration could reduce drift or slight deviation caused by nearby magnetic interference or human error.

1. Place gimbal on a flat surface using a tripod.
2. Double press the trigger button to recenter the gimbal.
3. Press mode button five times to start the auto calibration. Please do not touch the gimbal during calibration.

4. Two beeps indicate that the calibration is completed, the gimbal will recenter and automatically return to normal operation.

If the gimbal is not placed on a flat surface for calibration (e.g. hand-held calibration in the car), it may cause calibration failure.

When the calibration fails, the gimbal will make a beep sound, all 4 mode lights flash and enter the sleep mode. Single press any button (except the joystick) to wake up the gimbal and follow the above steps to try again.

Firmware Update

You will be prompted in the app Hohem Joy if a new firmware update is available. Follow the on-screen instructions in the app to update the firmware.

FAQs

Why does the gimbal automatically power off?

The gimbal will automatically power off if no phone is installed or the phone is not properly balanced (causing motor overload). You will hear a beep sound as a warning before it shuts down. Make sure to install and balance the phone correctly before turning on the gimbal (see the First Use section for details)

② How can I connect my phone's Bluetooth to the gimbal while the app can't find the device?

Clear the Bluetooth connection and try reconnecting:

Push the zoom lever upwards and simultaneously long-press the M button for 5s. When the Bluetooth indicator flashes green five times, it means the Bluetooth connection has been cleared. You can then follow the Bluetooth connection steps to connect again.

③ How do I connect the remote controller?

*The remote controller is an optional accessory and needs to be purchased separately.

Switch the remote to "OFF". Press the M button seven times to enter the remote controller pairing mode (at this point, the Bluetooth indicator will alternate between yellow and green). Switch the remote to "ON," and it will automatically connect to the gimbal. When you press buttons on the remote controller, and the gimbal's Bluetooth indicator flashes yellow, it indicates a successful pairing.

Exit the remote controller pairing: Press the mode button once.

Clear the remote controller pairing: Double-press the M button while in the remote controller pairing.

Product Specification

Warning & Disclaimer

Thank you for purchasing Hohem iSteady Mobile+. By using this product, you hereby signify that you have read this disclaimer and warning carefully. In addition, you understand and agree to abide by the terms and conditions herein. You acknowledge that you are solely responsible for your own conduct while interacting with this product, and for any consequences thereof. You agree to use this product only for purposes that are proper and in accordance with all applicable laws, rules, and regulations, and all terms, precautions, practices, policies and guidelines Hohem has made and may make available. Hohem accepts no liability for damage, injury, or any legal responsibility incurred directly or indirectly from the use of this product. The user shall observe safe and lawful practices including, but not limited to, those set forth in this document. This document and all other collateral documents are subject to change at the sole discretion of Hohem. For up-to-date product information, visit www.hohem.com and click on the product page for this product.

CALL CENTER -Toll Free**UNITED STATES:** +1(888)9658512 Mon-Fri: 9:00AM-5:00PM(EST)**UNITED KINGDOM:** +44(0)808 2737578 Mon-Fri: 2:00PM-10:00PM(GMT +0)**CANADA:** +1(855)758-8939 Mon-Fri: 9:00AM-5:00PM(EST)**BRAZIL:** +55 (0)800 5911897 Mon-Fri: 10:00AM-6:00PM(GMT -3)

Hohem Technology Co., Ltd

Email: service@hohem.com**Website:** www.hohem.com**Manufacturer:** Hohem Technology Co., Ltd

Connect us at Facebook

Warranty Terms

1. Customers are entitled to replacement service in case of quality deficits or functional disorders found in the product within seven (7) calendar days of receiving a product. But ensure the commodity and package with no damage, and we will offer a brand new replacement after confirming the product's problem is not related to artificial damage.
2. The warranty service is subject to normal use.
3. The valid warranty period is 12 months counting from the date of selling under normal use. Accessories are excluded from the warranty service.
4. This warranty service DOES NOT cover accidental or artificial damages (including but not limited to) caused by unauthorized modification, disassembly, incorrect use and operation.
5. Please keep and offer the warranty card for claiming the warranty service.

Warranty Card

- User Name
- Contact No.
- Address
- Purchase Date
- Prod. Serial No.
- Failure Cause
- Service Record

Product Hazardous Substances Content Table

Part Name	Hazardous Substances					
	Lead (Pb)	Mercury (Hg)	Cadmium (Cd)	Hexavalent Chromium (Cr(VI))	Polybrominated Biphenyls (PBB)	Polybrominated diphenyl ethers (PBDE)
Shell						
PCBA						
Data Cables						
Other Components						
<p>This table is prepared in accordance with the provision of SJ/T 11364.</p> <p>“ ”: Indicated that the content of such hazardous substance in all the homogeneous materials of such component is within the limits specified in GB/T 26572.</p>						

When all relevant parts of the electrical and electronic products sold in China are marked with identification of the environmental protection use period, it means the period refers to the normal conditions of use, such as temperature, humidity, normal using the product will not cause serious environmental pollution or damage to the personal property with serious term

Scan the QR code to access the tutorial

Documents / Resources

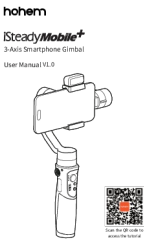
	<p>hohem iSteady Mobile Plus 3 Axis Smartphone Gimbal [pdf] User Manual</p> <p>iSteady Mobile Plus 3 Axis Smartphone Gimbal, iSteady Mobile, Plus 3 Axis Smartphone Gimbal, 3 Axis Smartphone Gimbal, Axis Smartphone Gimbal, Smartphone Gimbal</p>
---	---

References

- [Hohem iSteady Mobile Plus 3 Axis Smartphone Gimbal](#) [pdf] User Manual - hohem -
- [Hohem iSteady Mobile Plus 3 Axis Smartphone Gimbal](#) [pdf] User Manual - hohem -
- [User Manual](#)