

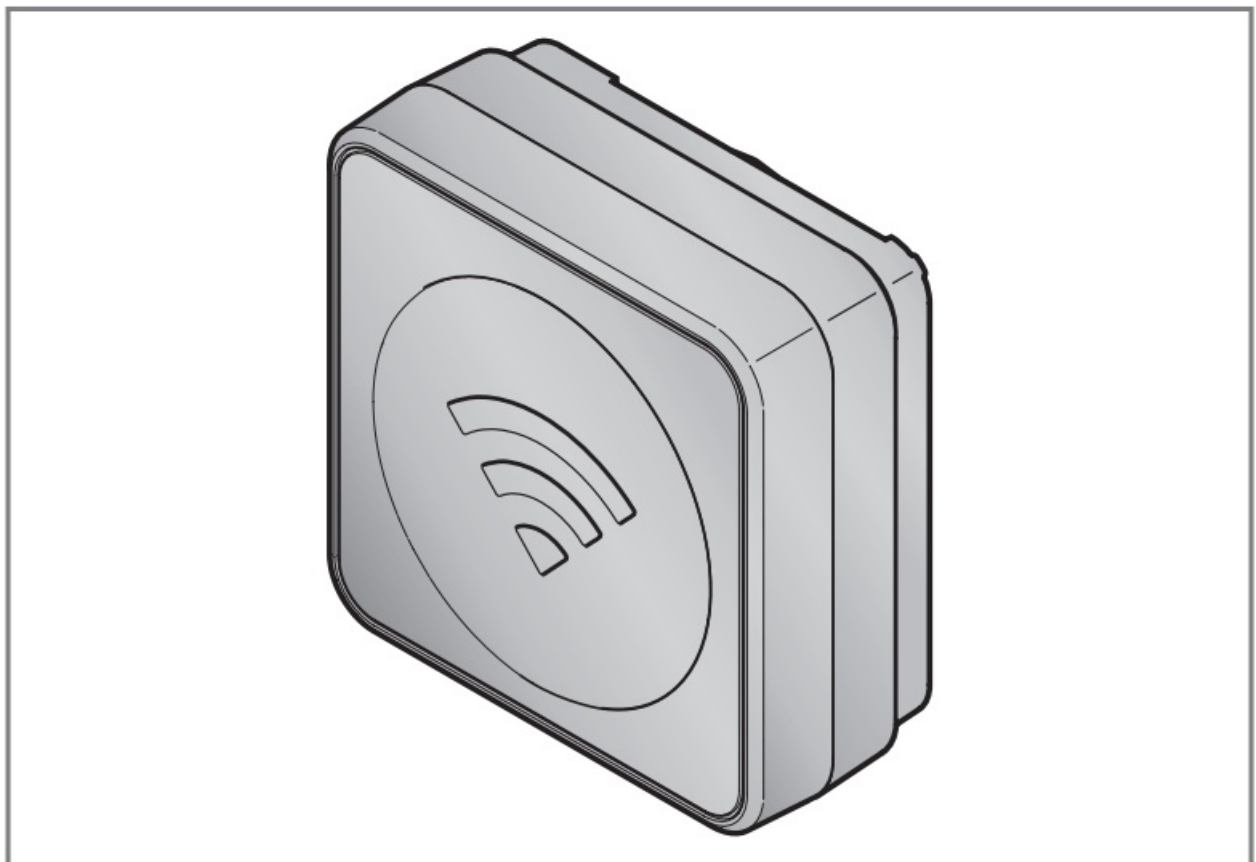

HOERMANN WLAN Wi-Fi Gateway for Operator Control Regardless of Location User Guide

[Home](#) » [HOERMANN](#) » HOERMANN WLAN Wi-Fi Gateway for Operator Control Regardless of Location User
Guide 



Contents

1 Instructions for fitting and operating

1.1 WLAN gateway

1.2 1 About these instructions

1.3 2 Safety instructions

1.3.1 2.1 Intended use

1.3.2 2.2 Symbols used

1.3.3 2.3 Safety instructions for operation

1.3.4 2.4 Data protection notice

1.4 3 Scope of delivery

1.5 4 Product description (see figure [1])

1.6 5 Fitting and installation (see figure [2])

1.7 6 Home application (App)

1.7.1 6.1 System requirements

1.8 7 Initial start-up

1.8.1 7.1 Home App set up

1.8.2 7.2 Setting up other services

1.9 8 Reset

1.10 9 Status display

1.10.1 9.1 Definition of flash frequencies

1.11 10 Cleaning

1.12 11 Disposal

1.13 12 Technical data

1.14 13 Legal notices

1.15 14 EU Declaration of Conformity

1.16 15 UK Declaration of Conformity

2 Documents / Resources

2.1 References

3 Related Posts

Instructions for fitting and operating

WLAN gateway

4553232 B0 / 03-2023

HÖRMANN

1 About these instructions

These instructions are divided into a text section and an illustrated section. The instructions contain important information on the product, and especially safety instructions and warnings.

- Read through the instructions carefully.
- Keep these instructions in a safe place.

NOTICE

Observe all specifications, standards and safety regulations applicable at the location where the WiFi gateway is installed.

Dissemination as well as duplication of this document and the use and communication of its content are prohibited unless explicitly permitted. Noncompliance will result in damage compensation obligations. All rights reserved in the event of patent, utility model or design model registration. Subject to changes.

2 Safety instructions

2.1 Intended use

The WiFi gateway is a transmitter for controlling operators and barriers. In conjunction with the Apple HomeKit and / or a voice assistant, the WiFi gateway can control door travel.

You will find the compatibility overview at:



www.hoermann-docs.com/229817

Other types of application are prohibited. The manufacturer is not liable for damage caused by improper use or incorrect operation.

2.2 Symbols used



The Works with Apple HomeKit word mark and logos are registered trademarks of Apple Inc. and are used by Hörmann KG Verkaufsgesellschaft under licence. Other trademarks and brand names are the property of their respective owners.



The Wi-Fi-CERTIFIED™ logo is a certification mark of the Wi-Fi Alliance® and is used by Hörmann KG Verkaufsgesellschaft under licence. Other trademarks and brand names are the property of their respective owners.



Google is a brand of Google LLC.

Amazon, Alexa and all other corresponding logos are brands of Amazon.com, Inc. or its associated companies.

2.3 Safety instructions for operation

To avoid putting the operational safety of the system at risk, a cyber security analysis of the connected IT components must be performed by the user before initial start-up.



WARNING

Risk of injury during intended or unintended door run

- Make sure that the WiFi gateway is kept away from children!
- Make sure that the WiFi gateway is only used by people who have been instructed on how the remote-control system functions.
- Automation or control of an automatic door system without view of the door is permitted if a photocell has been installed on the door in addition to the standard power limit.
- Drive or walk through the door openings only when the door is in the OPEN end-of-travel position.
- Never stand in the door's area of travel.
- Ensure that the remote-controlled operation of devices does not result in danger to persons or objects or that these risks are covered by safety equipment.
- Observe the manufacturer information for the remote-controlled devices.

ATTENTION

External voltage at the connecting terminals

External voltage at the connecting terminals will destroy the electronics.

- Do not apply any mains voltage (230 / 240 V AC) to the connecting terminals.

Functional impairment caused by effects of the environment

High temperatures, water and dirt impair the function of the WiFi gateway. Protect the device from the following factors:

- Direct sunlight
- Moisture
- Dust

2.4 Data protection notice

When remotely operating the gateway, the product master data and the switching processes are transmitted to the Hörmann portal.

Observe the data protection notices on the portal or in the app.

3 Scope of delivery

- WLAN gateway
- Brief instructions
- Fitting accessories
- System cable (1 × 2 m)
- HomeKit code

Optional: HCP adapter

4 Product description (see figure [1])

- | | |
|---------------------------------|------------------------|
| (1) WiFi gateway housing | (2) WiFi symbol, white |
| (3) Connection socket (BUS) | (4) Seal (cable) |
| (5) Reset button | (6) Green LED |
| (7) Seal (WiFi gateway housing) | |

5 Fitting and installation (see figure [2])

The choice of the fitting location affects the range.

- Prior to fitting, verify that the WiFi signal can reach the selected fitting site.
- Make sure that your smartphone has at least two bars.
 - Determine the best orientation, by trial and error, if required.

When fitting the WiFi gateway, make sure that the fitting location

- is protected from direct rain.
- is protected from direct sunlight.
- is on the north side of your system, if possible, and not on the weather side.
- is far away from eaves.
- the recommended minimum distance from your repeater/ router is maintained.

NOTICE

Remove the set up code after outdoor fitting. Keep the set up code in a safe place.

6 Home application (App)

The communication between the iPhone, iPad or iPod touch and the HomeKit-capable WiFi gateway is secured by the HomeKit technology.

Your garage door operators / entrance gate operators or barrier systems can be controlled with the Home App. In addition to controlling your door or your barrier system, the app shows you the door / barrier position.

NOTICE

Please note that not every service is available in every country.

6.1 System requirements

Access from home

iOS device	Software version
iPhone, iPad or iPod touch	From iOS 11.3

iCloud remote access

iOS device	Software version
HomePod, Apple TV	From tvOS 11.3
iPad	From iOS 11.3

7 Initial start-up

7.1 Home App set up

Before setting up the device, confirm the following:

- The device is connected to the operator, the WiFi symbol flashes 6 ×
- The iPhone is connected to the WiFi router

A BUS scan may be required depending on the operator type. Please see the operator or barrier instructions for information.

7.1.1 Adding devices

1. Open the Home app.
2. Select **Add device**.
3. Follow the steps in the user interface.
4. Coupling the Home app with the WLAN may take up to 1 minute.

NOTICE

The WiFi gateway is already connected to a voice assistant.

- Press and hold the reset button for 5 seconds until the WiFi symbol flashes quickly and then goes out. Release the Reset button. The device is in WAC mode as soon as the LED flashes 6 ×.

7.1.2 Additional applications

You can also actuate the WiFi gateway while on the go. To do so, you need:

- HomePod from tvOS 11.3
- Apple TV from tvOS 11.3
- iPad from iOS 11.3

7.2 Setting up other services

To set up the voice control via the Google Home app, Google Assistant or the Amazon Alexa app, follow the instructions for the corresponding services.

1. Register at: <https://cd.hoermann.com>
2. Press and hold the reset button for 2 seconds to set up.
3. Wait until the LED flashes 2 x. The device is now in set up mode.
4. Follow the instructions in the user interface.
5. Activate the Google service / Amazon Skill Hörmann door

a. The PIN required for the Google service can be found in your Hörmann Cloud user account. This is assigned individually for each Hörmann gateway.

8 Reset

There are two different options for resetting the device:

1. Resetting the WiFi connection

- Open the housing.
- Press the Reset button.
- Keep the reset button pressed until the WiFi symbol flashes quickly.
- Release the Reset button.
- The WiFi connection is reset.

2. Resetting to the factory setting

- Open the housing.
- Press the Reset button.
- Keep the reset button pressed until the WiFi symbol flashes very quickly and then goes out.
- The device has now been reset to the factory setting.
- Remove the device from the Home app.

NOTICE

If the reset button is released prematurely, the device reset is aborted. The WiFi connection or the device is not reset to the factory setting.

9 Status display

The white WiFi symbol identifies notes and errors.

Display type	Interval	Note / error
Continuously illuminated	—	Connection established to WLAN router
Flashes slowly with pause	1 ×	Connection established to operator
	2 ×	Set up mode started (Onboarding)
	3 ×	No connection established to WLAN router
	4 ×	Poor WiFi connection
	5 ×	Identifying
	6 ×	WAC-mode
	7 ×	HCP error

9.1 Definition of flash frequencies

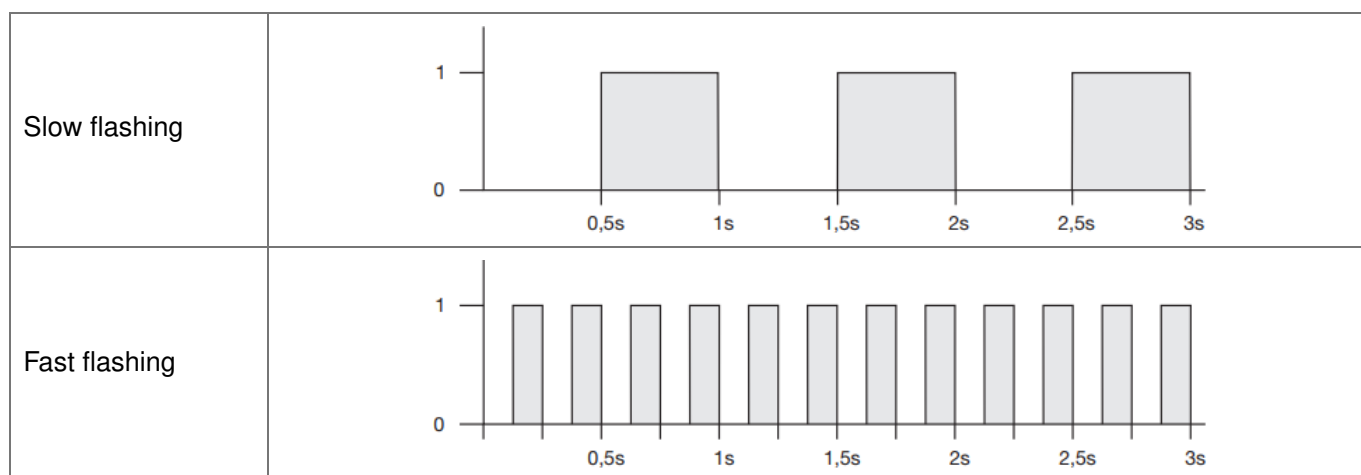

10 Cleaning

ATTENTION
Damage to the WiFi gateway through improper cleaning <ul style="list-style-type: none"> Only clean the WiFi gateway with a clean and soft cloth.

NOTICE

Regular use of disinfectants can cause damage to the WiFi gateway.

11 Disposal



Dispose of the packaging sorted by materials



Electrical and electronic devices must be returned to the appropriate recycling facilities.

12 Technical data

Model	WLAN gateway
Frequency	2,400 – 2,483.5 MHz
Transmitting power	Max. 100 mW (EIRP)
Power supply	24 V DC
Perm. ambient temperature	–20 °C to +60 °C
Maximum humidity	93%, non-condensing
Protection category	IP 24
Connection cable	2 m
Dimensions (W × H × D)	80 × 80 × 35 mm

13 Legal notices

© 2019 Apple Inc. All rights reserved. Apple, the Apple-Logo, Apple TV, Apple Watch, iPad, iPad Air, iPad Mini, iPhone, iPod, iPod touch, iTunes, Mac and Siri are all brands of Apple Inc., registered in the USA and in other countries. HomeKit, HomePod, MultiTouch and tvOS are brands of Apple Inc.

Electronic accessories were developed for connection to an iPod touch, iPhone or iPad and certified by the developer accordingly with the Works with Apple HomeKit logo. These accessories meet Apple performance standards. Apple is not responsible for the operation of this device or compliance with the safety and authority standards.

The Wi-Fi-CERTIFIED™ logo is a certification mark of the Wi-Fi Alliance®.

Amazon, Alexa and all other corresponding logos are brands of [Amazon.com](https://www.amazon.com), Inc. or its associated companies.

Google is a brand of Google LLC.

14 EU Declaration of Conformity

Manufacturer Hörmann KG Verkaufsgesellschaft
Address Upheider Weg 94-98
33803 Steinhagen
Germany



The manufacturer above herewith declares under his sole responsibility that the product

Device	WLAN gateway
Model	WLAN gateway
Intended use	Transmitter for controlling operators and barriers
Transmitting frequency band	2,400 – 2,483.5 MHz
Radiant power	Max. 100 mW (EIRP)

conforms to the respective essential requirements of the directives listed below with intended use, on the basis of its style and type in the version marketed by us:

2014/53/EU (RED)	EU Directive for Radio Equipment
2015/863/EU (RoHS)	Restriction of the use of certain hazardous substances

Applied standards and specifications

EN 62368-1:2014 + AC:2015 + A11:2017	Product safety (Article 3.1(a) of 2014/53/EU)
EN 62311:2008	Health (Article 3.1(a) of 2014/53/EU)
EN 301489-1 V2.2.3	Electromagnetic compatibility (Article 3.1(b) of 2014/53/EU)
EN 301489-17 V3.2.2 (draft)	
EN 300328 V2.2.2	Efficient use of the radio spectrum (Article 3.2 of 2014/53/EU)
EN IEC 63000:2018	Restriction of the use of certain hazardous substances

Any modification made to the device without our express permission and approval shall render this declaration null and void.

Steinhagen, 14.06.2021



Axel Becker,
Management

15 UK Declaration of Conformity

Manufacturer Hörmann UK Ltd.
Address Gee Road
Coalville
LE67 4JW
GB-Leicestershire



The manufacturer above herewith declares under his sole responsibility that the product

Device	WLAN gateway
Model	WLAN gateway
Intended use	Transmitter for controlling operators and barriers
Transmitting frequency band	2400...2483.5 MHz
Radiated power	Max. 100 mW (EIRP)

conforms to the respective essential requirements of the UK regulations listed below with intended use, on the basis of its style and type in the version marketed by us:

2017 No. 1206	UK Radio Equipment Regulations 2017
2012 No. 3032	UK Restriction of the use of certain Hazardous Substances 2012

Applied standards and specifications

EN 62368-1:2014 + AC:2015 + A11:2017	Product safety (Article 6.1(a) of 2017 No. 1206)
EN 62311:2008	Health (Article 6.1(a) of 2017 No. 1206)
EN 301489-1 V2.2.3	Electromagnetic compatibility (Article 6.1(b) of 2017 No. 1206)
EN 301489-17 V3.2.2 (draft)	
EN 300328 V2.2.2	Efficient use of the radio spectrum (Article 6.2 of 2017 No. 1206)
EN IEC 63000:2018	Restriction of the use of certain hazardous substances

Any modification made to this device without our express permission and approval shall render this declaration null and void.

Coalville, 14.06.2021



Wolfgang Gorner
Managing Director

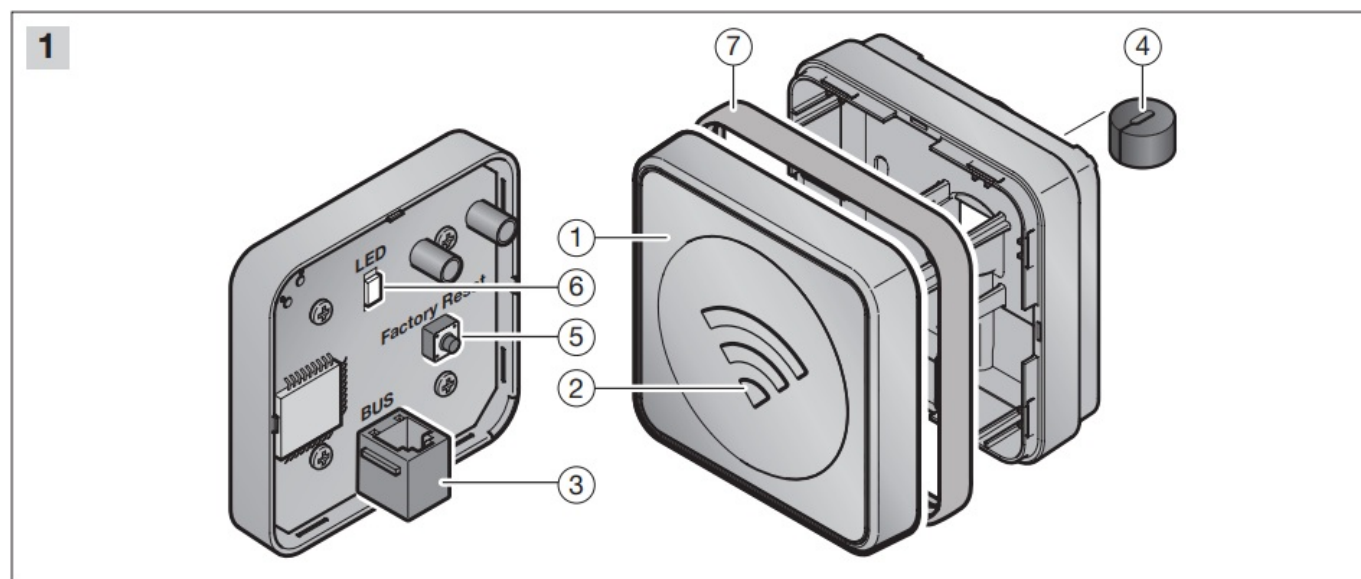

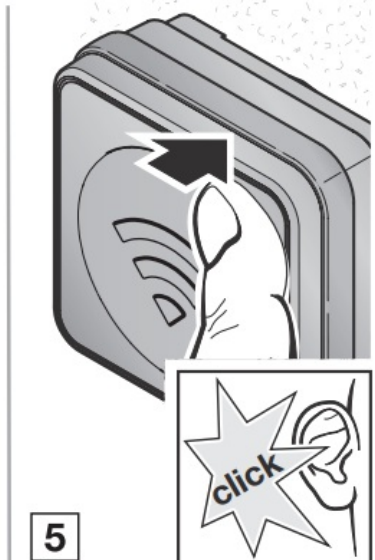
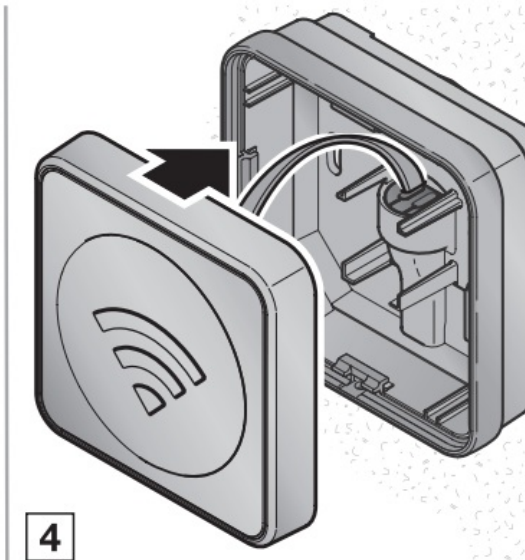
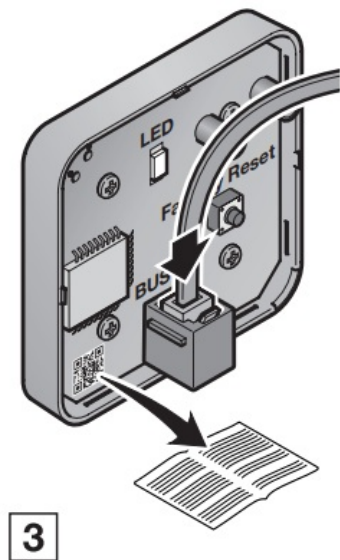
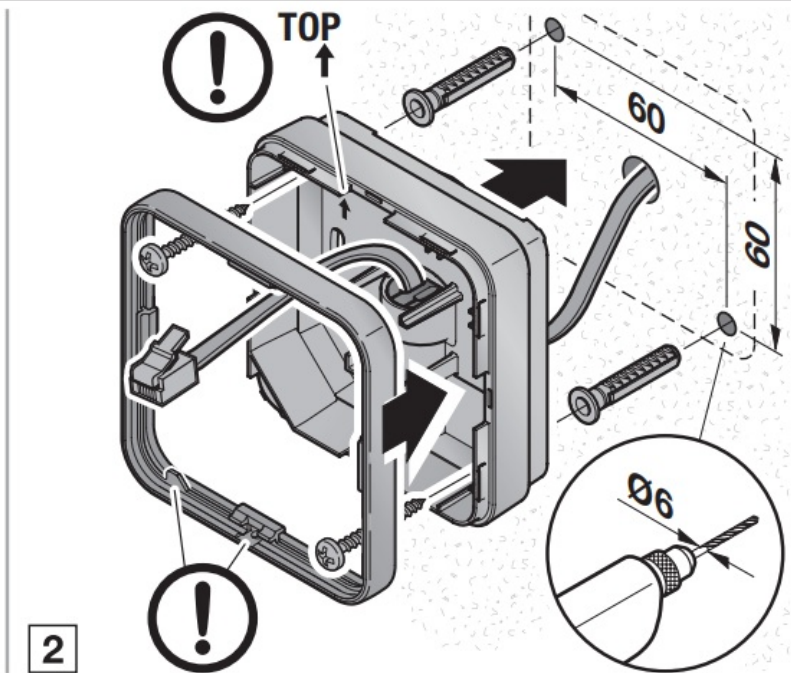
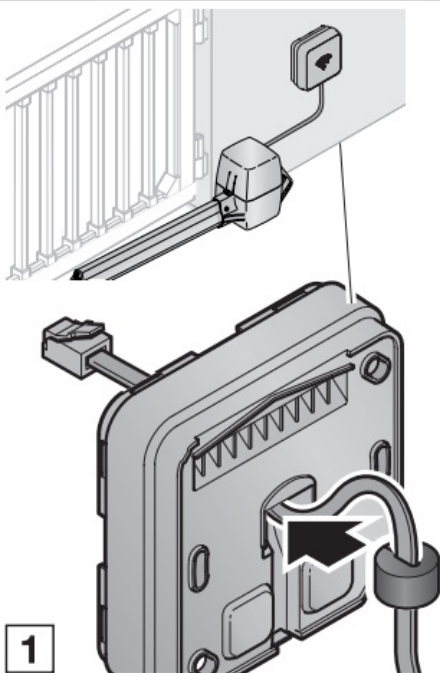

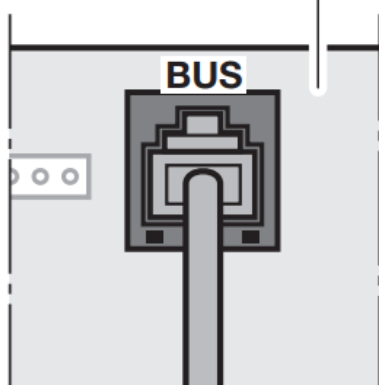
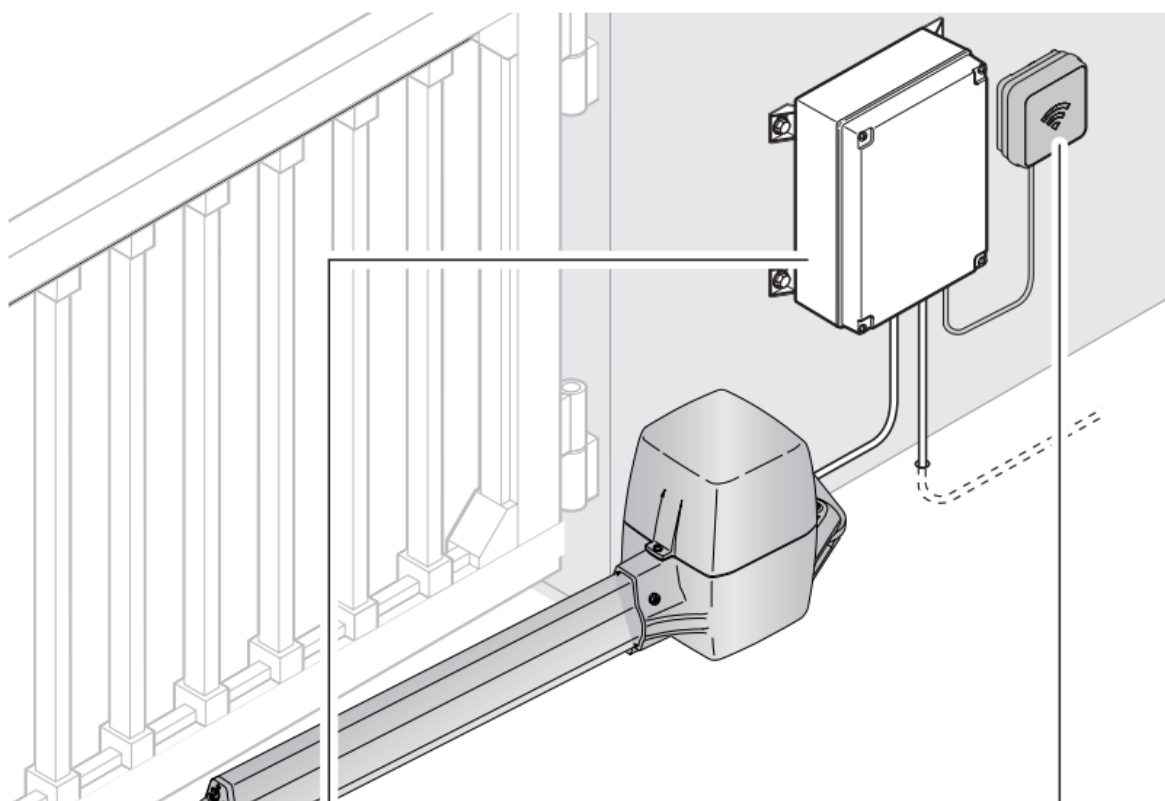

1

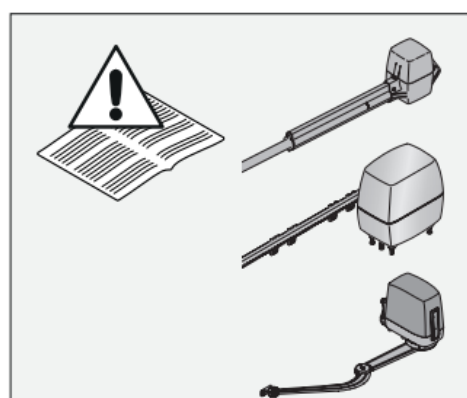
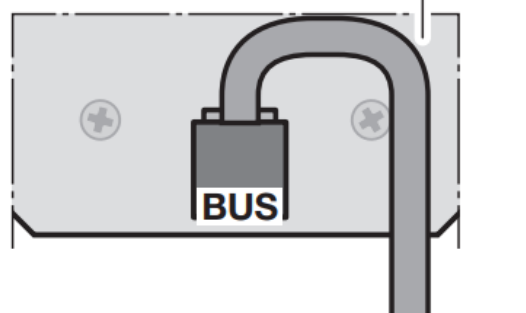

6

1. RotaMatic
- LineaMatic
- VersaMatic

WLAN – Gateway

Hörmann KG Verkaufsgesellschaft
Upheider Weg 94-98
33803 Steinhagen
Deutschland



4553232 B0

Documents / Resources

 <small>Artikelnummer: WLAN-Gateway-230803 EAN: 4008888 230803 Hersteller: Hörmann KG Produktionsland: Deutschland HÖRMANN</small>	<p>HÖRMANN WLAN Wi-Fi Gateway for Operator Control Regardless of Location [pdf] User Guide</p> <p>WLAN Wi-Fi Gateway for Operator Control Regardless of Location, WLAN, Wi-Fi Gateway for Operator Control Regardless of Location, Gateway for Operator Control Regardless of Location, Operator Control Regardless of Location, Control Regardless of Location, Regardless of Location, Location</p>
--	---

References

- [Amazon.com](#)
- [HOE-WM-2c Pantone](#)
- [hoermann-docs.com/229817](#)
- [hoermann-docs.com/230803](#)
- [hoermann-docs.com/231683](#)
- [hoermann-docs.com/231684](#)
- [hoermann-docs.com/233627](#)
- [hoermann-docs.com/240736](#)
- [Hörmann Voice Assistant](#)
- [Tore, Türen, Zargen und Antriebe | Hoermann](#)
- [User Manual](#)

