

HÖRMANN
5203948-1 Finger
Scan FSmini 2k
Fingerprint
Scanner

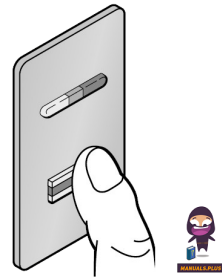

HOERMANN 5203948-1 Finger Scan FSmini 2k Fingerprint Scanner Instruction Manual

[Home](#) » [HOERMANN](#) » HOERMANN 5203948-1 Finger Scan FSmini 2k Fingerprint Scanner Instruction Manual 

Contents

- 1 [HOERMANN 5203948-1 Finger Scan FSmini 2k Fingerprint Scanner](#)
- 2 [Product Information](#)
- 3 [Product Usage Instructions](#)
- 4 [FAQ](#)
- 5 [Safety instructions](#)
- 6 [Product Description](#)
- 7 [Programming](#)
- 8 [Operation](#)
- 9 [Blocking period](#)
- 10 [Notes on the illustrated section](#)
- 11 [LED display](#)
- 12 [Cleaning](#)
- 13 [Documents / Resources](#)
 - 13.1 [References](#)
- 14 [Related Posts](#)

HÖRMANN

HOERMANN 5203948-1 Finger Scan FSmini 2k Fingerprint Scanner

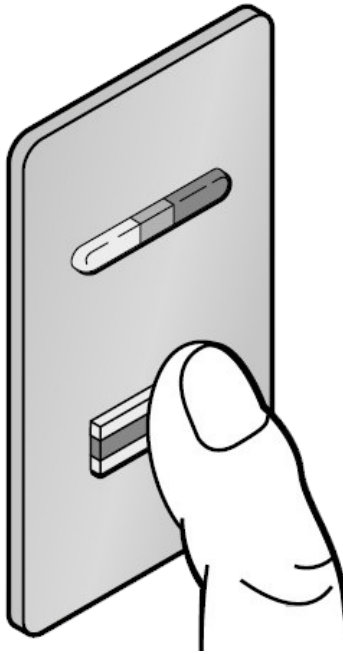

Product Information

Specifications

- **Product Name:** Finger-scan FSmini 2k
- **Compatibility:** Works with the accompanying mobile app
- **Power Source:** CR 3V 2025 battery
- **LED Indicators:** Red (RD) for error, Blue (BL) for successful recognition

Product Usage Instructions

Safety Instructions

Before using the Finger-scan FSmini 2k, please read and follow all safety instructions mentioned in the manual.

Product Description

The Finger-scan FSmini 2k is a fingerprint reader that can be controlled using the mobile app. It features buttons for various functions such as enrollment, deletion, and operation.

Getting Started

Insert a CR 3V 2025 battery into the device to power it on. Follow the instructions in the manual to initialize the device.

Programming

Use the buttons on the device to program fingerprints for access. Follow the steps outlined in the manual to enroll fingerprints successfully.

Operation

To use the Finger-scan FSmini 2k, place your finger on the sensor area and wait for the LED indicator to show successful recognition.

Lockout Time

If there are multiple failed attempts, a lockout time will be initiated to prevent further access attempts. Refer to the manual for specific lockout durations.

Cleaning

Regularly clean the fingerprint sensor area and device surface using a soft, dry cloth to maintain optimal performance.

FAQ

Q: What should I do if the device does not recognize my fingerprint?

A: Make sure your finger is clean and properly placed on the sensor. You may need to reprogram your fingerprint following the instructions provided.

Q: How do I change the battery of the device?

A: Refer to the manual for detailed instructions on changing the battery of the Finger-scan FSmini 2k.

Dissemination as well as duplication of this document and the use and communication of its content are prohibited unless explicitly permitted.

Noncompliance will result in damage compensation obligations. All rights reserved in the event of patent, utility model or design model registration. Subject to changes.

Dear Customer,

We thank you for choosing a quality product from our company.

About these instructions

These instructions contain important information on the product.

- Read through these instructions carefully and thoroughly.
- Observe the notices. Please pay particular attention to the safety instructions and warnings.
- Keep these instructions in a safe place for later reference.
- These instructions must be available to the product user at all times.

Safety instructions

Intended use

Use the FSmini 2k finger-scan with app to operate entrance doors and entrance door accessories.

Other types of application are prohibited. The manufacturer is not liable for damage caused by improper use or incorrect operation.

Safety instructions for operation

DANGER

Risk of deadly electric shock from mains voltage

Contact with the mains voltage presents the danger of a deadly electric shock.

- Commission a qualified electrician for electrical connections.
- Make sure that the on-site electrical installation conforms to the protective regulations (100 – 240 V AC, 50 / 60 Hz).
- If the device is permanently connected to the mains voltage, you must install an all-pole mains isolator switch with corresponding pre-fuse.

- Disconnect the decoder unit from the mains supply before any work. Safeguard the system against being switched on again without authorisation.

WARNING

Risk of injury during door travel

People can be injured by the door movement while you are operating the finger-scan.

- Do not allow children to handle finger-scans. Only persons who have been instructed in the operation of the remote-controlled system may use the finger-scan.
- If the door has only 1 safety device, only operate the finger-scan with visual contact to the door.
- Drive or walk through the door openings of remote-controlled systems only when the door is in the Open end-of-travel position.
- Never stand in the door's area of travel.

CAUTION

Danger through unintended activation of devices

The remote control might accidentally switch on devices or start machines.

- Ensure that the remote-controlled operation of devices does not result in danger to persons or objects. Prevent these risks with safety equipment.
- Observe the manufacturer information for remote-controlled devices.
- Prevent machines from being activated unintentionally.

ATTENTION

Damage caused by sharp items or metal objects

Damage to the surface of the finger sensor may lead to malfunctions.

- Do not touch the finger sensor with sharp items or metal objects, e.g. rings.

Product Description

remote

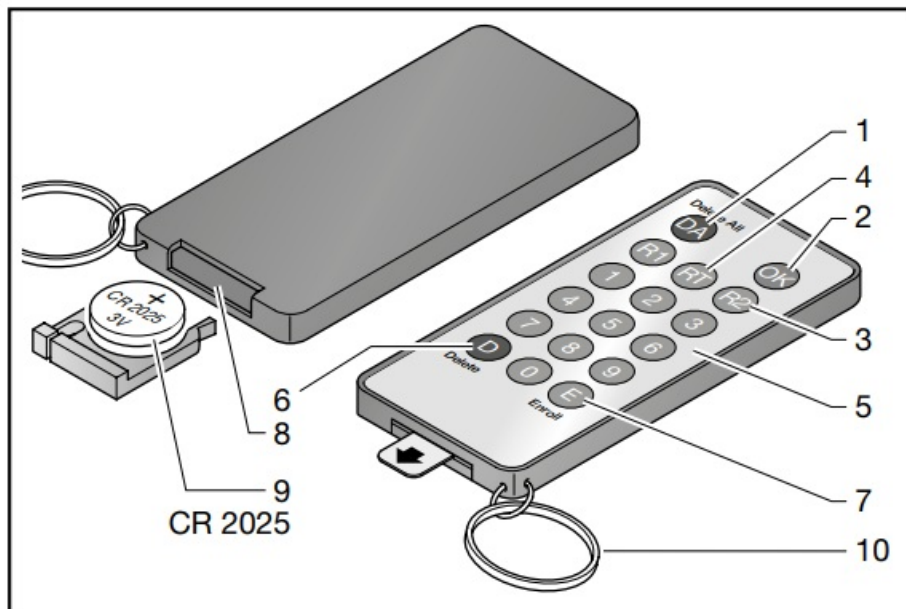

1. DA button (delete all)
2. OK button
3. R1 / R2 button
4. RT button
5. Numerical keys
6. D button (delete)
7. E button (enrol)
8. Battery compartment
9. 3 V battery, type: CR2025
10. Keyring

Initial start-up

During initial operation of the finger scan, the red and green LEDs and the blue LED (in the background) on the reader are continuously illuminated. The unit has reached ideal operating temperature after a warm-up phase of approximately 1 minute. Next, program the master finger.

Programming

During programming, swipe your finger quickly and evenly across the sensor and apply light pressure. You can program 3 master fingers and 250 finger templates.

Teaching in fingers 3 – 6 × provides the best recognition rates. Each programmed finger occupies one of 250 available memory locations.

NOTE:

Master fingers can never be user fingers.

Operation

As soon as the fingerprints have been taught in, you can use the reader. The red and green LEDs are turned off. The blue LED in the background is continuously illuminated.

- Swipe your finger over the sensor.

The following signals are output after the fingerprint checking is complete:

Fingerprint	Signalling	Explanation
Finger is recognised.	The green LED is illuminated as long as the relay is active.	An impulse to open the garage door or entrance door is output.
The finger will not be recognised.	The red LED is illuminated briefly.	Access denied

After several unsuccessful attempts, the system activates a blocking period.

Blocking period

If you swipe an unprogrammed finger over the sensor 4 × in succession, the device is blocked for a limited period of time. The blocking period depends on the number of incorrect attempts:

Blocking interval	Incorrect attempts	Blocking period
1. Blocking	4	1 minute
2. Blocking	6	5 minutes
3. Blocking	8	30 minutes
4. Blocking	10	60 minutes

Unblocking the device

If the device is locked, it is possible to unlock it with a master finger or user finger before the regular blocking period expires. The device then switches to normal operation.

Reset

A reset deletes all fingerprints and resets the finger-scan to its delivery condition. Disconnect the app before a reset.

There is a risk of locking yourself out.

Notes on the illustrated section

View	Description
A1	Finger guidance
A2	Teaching in the master finger
A3	Teaching in fingers (video) QR code
B	After 4 incorrect entries, a blocking period occurs (see chap. 9).
C	Reset: delete

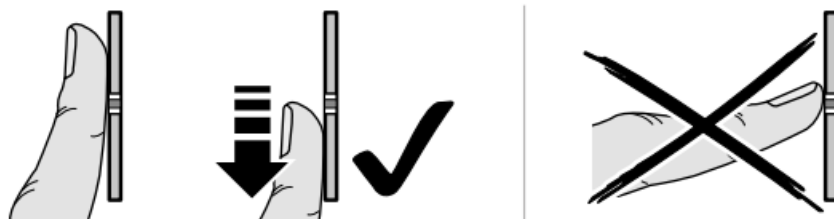
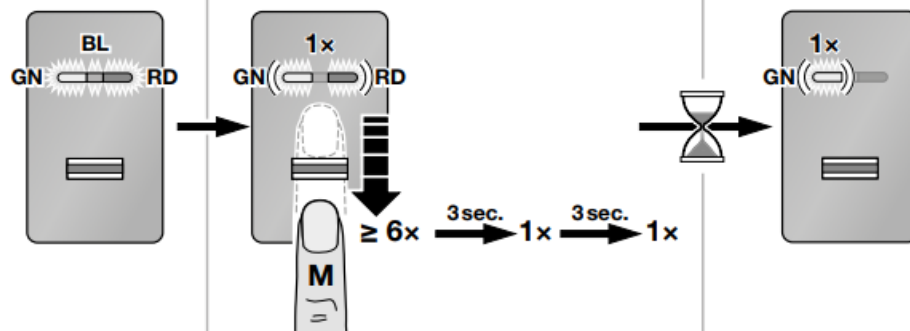
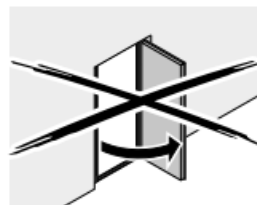
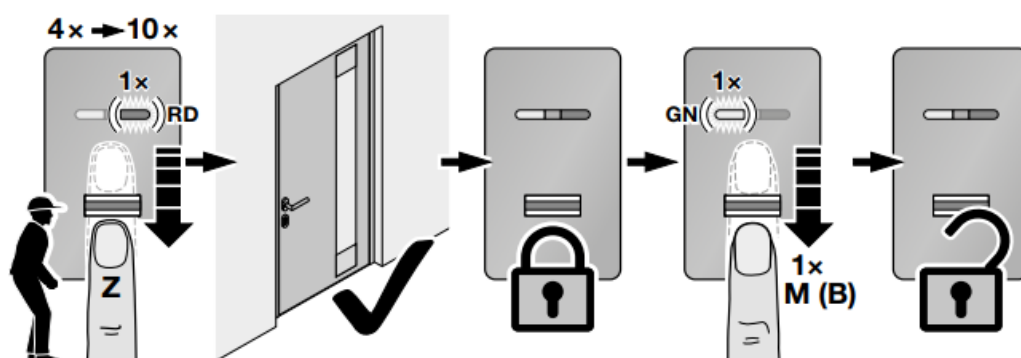
A1**A2****A3****B****4x → 10x**

C

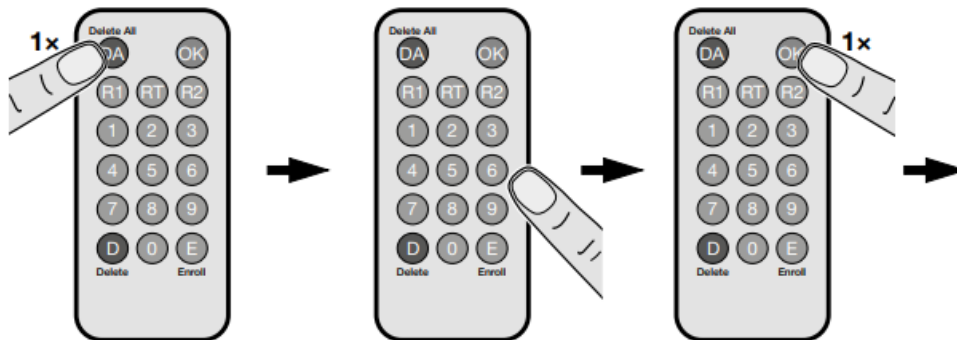
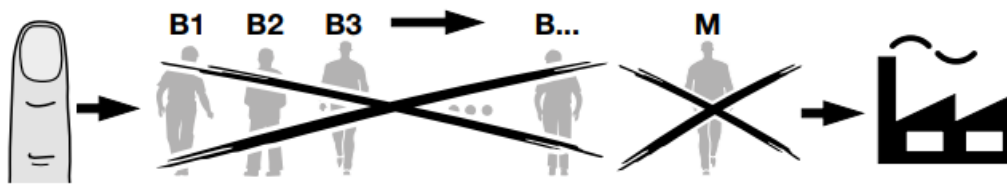

a)  2 7 0 9 6 3

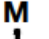
b)  X X X X X X

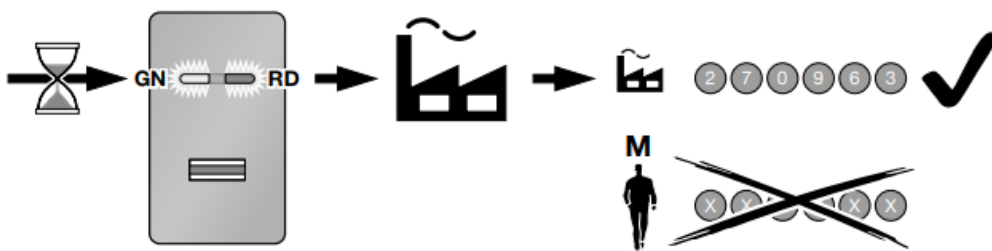

LED display

Signalling on the reader

LED	Status	Function
Red (RD)	Illuminated briefly	Finger is not recognised
		Incorrect teach-in
	Continuously illuminated	delivery condition
Green (GN)	Illuminated as long as the relay is active	Finger is recognised
	Illuminated briefly	Pressing a button on the hand transmitter
	Continuously illuminated	delivery condition
Blue (BL)	Continuously illuminated	Operation

Cleaning

ATTENTION

Damage to the reader through improper cleaning

- Clean the reader only with a clean, damp cloth and clear water.
- Use warm water together with a neutral, non-abrasive cleaning agent (household detergent, pH value°7) if more heavily soiled.
- The device must be cleaned regularly to ensure reliable operation.

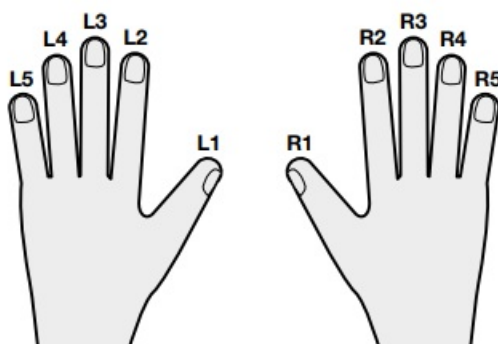

Typ	Name	Finger	Relais	
			1	2
M1			—	—
M2			—	—
M3			—	—
M4			—	—
M5			—	—
M6			—	—
M7			—	—
M8			—	—
M9			—	—
B1				
B2				
B3				
B4				
B5				
B6				
B7				
B8				
B9				
...				
B250				

Documents / Resources

	<p>HOERMANN 5203948-1 Finger Scan FSmini 2k Fingerprint Scanner [pdf] Instruction Manual 5203948-1, 5203948-1 Finger Scan FSmini 2k Fingerprint Scanner, Finger Scan FSmini 2k Fingerprint Scanner, FSmini 2k Fingerprint Scanner, Fingerprint Scanner, Scanner</p>
---	---

References

- [User Manual](#)

