



**1621SL Outer**  
**1621 SL Motor**



# HOBBYWING 1621SL Outer 1621 SL Motor User Manual

[Home](#) » [HOBBYWING](#) » HOBBYWING 1621SL Outer 1621 SL Motor User Manual 

## Contents

- [1 HOBBYWING 1621SL Outer 1621 SL Motor](#)
- [2 Product Usage Instructions](#)
- [3 Installation & Connection](#)
- [4 FAQ](#)
- [5 Product Information](#)
- [6 Warnings](#)
- [7 Specifications](#)
- [8 Installation & Connection](#)
- [9 Gearing](#)
- [10 Documents / Resources](#)
  - [10.1 References](#)
- [11 Related Posts](#)



HOBBYWING 1621SL Outer 1621 SL Motor



## Specifications

- **Model:** QUICRUN Outer 1621SL
- **KV:** 3500KV
- **Lipo Cells:** 2-3S
- **No-load Current:** 0.6
- **Max. Output Power (W):** 39.1
- **Current @ Max. Output Power(A):** 9.52
- **Diameter/Length:**  $\geq 15.8\text{mm}$ (0.62) L=21mm(0.83)
- **Shaft Diameter/Length:** 2.0mm/9mm
- **Poles:** 12
- **Weight:** 16.7g
- **Applications:** 1/24 Crawler

## Product Usage Instructions

### Installation & Connection

#### Installation of the Motor:

There are 6 motor mounting holes in the M2 specification with a depth of 1.8mm. Before installing the motor, ensure the specifications are appropriate to avoid damage due to excessive length. The motor has three types of mounting hole spacing: 9mm, 10mm, and 12.5mm. Refer to the motor outline drawing for details.

#### How to Connect the Motor to an ESC:

No specific wire sequence requirement for the motor and ESC connection. The A/B/C wires of the motor and ESC can be connected at will. If motor rotation is opposite, exchange any two wires or adjust the Motor Rotation parameter of the ESC.

#### Inspection:

Prior to powering on the ESC, check motor installation and all connections' order.

## Gearing

Selecting a reasonable gear ratio is crucial to prevent damage. Consider the following when choosing gear ratio: operating temperature of the motor.

## FAQ

- **Q: What should I do if the motor rotation is opposite?**
  - A: You can exchange any two wires between the motor and ESC, adjust the Motor Rotation parameter on the ESC.
- **Q: How many mounting hole spacings does the motor have?**
  - A: The motor has three mounting hole spacings: 9mm, 10mm, and 12.5mm.

## Product Information

Thank you for purchasing this HOBBYWING product! Improper use may cause damage to the product and related devices. We strongly recommend reading through this user manual before use and strictly abide by the specified operating procedures. We shall not be liable for any liability arising from the use of this product, including but not limited to reimbursement for incidental or indirect losses. We do not assume any responsibility caused by unauthorized modification of the product. We have the right to change the product design, appearance, performance and use requirements without notice

## Warnings

- Read the manuals of all the items being used in the build. Ensure gearing, setup, and overall installation is correct and reasonable.
- All connections must be made correctly . You may lose control, or run into major issues caused by incorrect, bad, weak, or poor connections.
- Never apply full throttle if the pinion is not installed. Due to the extremely high RPMs without load, the motor may get damaged.
- Stop usage if the motor exceeds 100°C/212°F, high temperature will damage the motor and cause the rotor to weaken

## Specifications

Model	KV	Lip o C ells	No-l oad Curr ent	Max. O utput P ower ( W)	Current @ Max. Outp ut Power(A )	Diameter/L ength	Shaft Diam eter/ Lengt h	Pol es	Wei ght	Applicati ons
QUICRUN Outer 1621SL	350 0KV	2-3 S	0.6	39.1	9.52	φ=15.8mm( 0.62") L=21mm(0. 83")	2.0mm/9m m	12	16.7 g	1/24 Cra wler

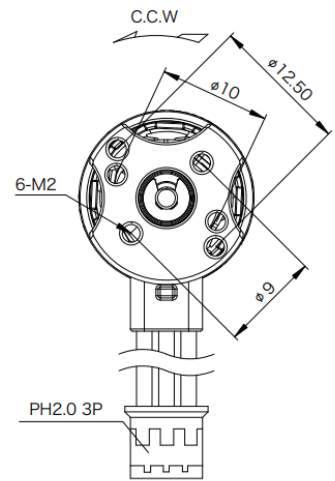
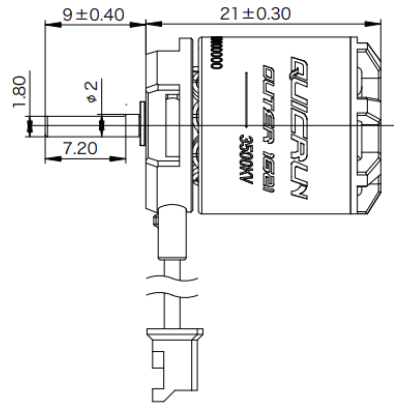
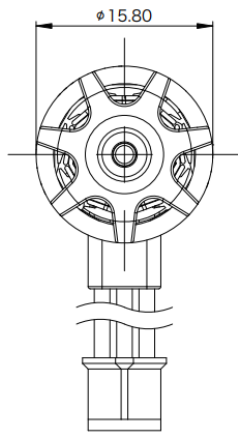

## Installation & Connection

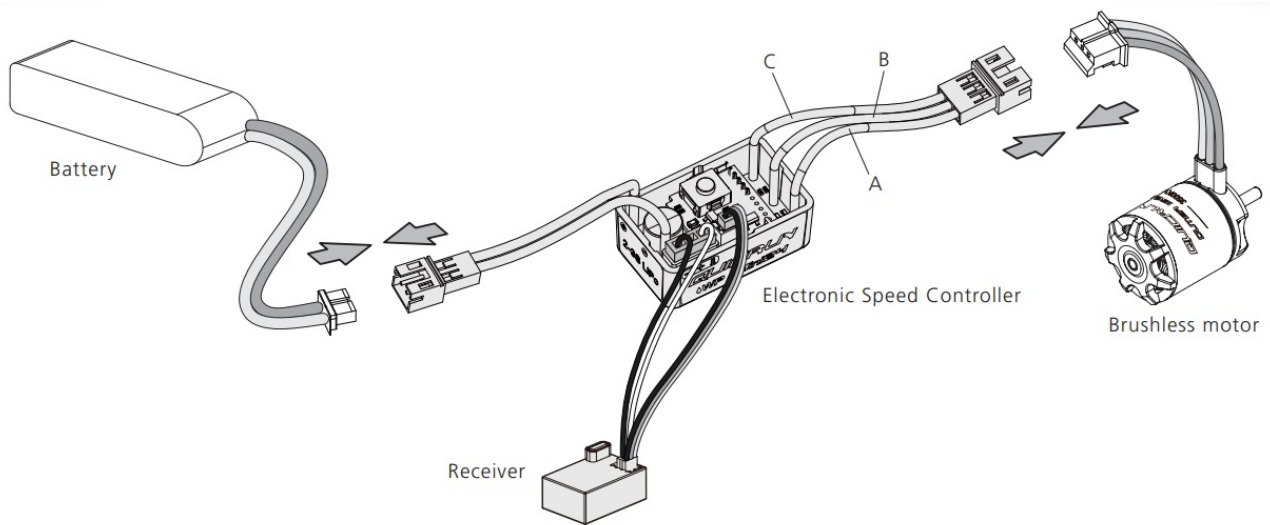

### Installation of the motor

There are 6 motor mounting holes in the M2 specification, and the mounting holes are 1.8mm in depth, before installing the motor on the vehicle, please carefully confirm whether the specifications of the screws are appropriate, as not to damage the motor due to excessive length. There are three types of mounting hole spacing for the motor, one group is 9mm, one group is 10mm, and one group is 12.5mm. Refer to the motor outline drawing for details.

### How to Connect the Motor to an ESC

There is no specific wire sequence requirement for the connection between the motor and the ESC, the # A/# B/# C three wires of the motor and ESC can be connected at will, if the motor rotation in the opposite direction, you can exchange any two wires, or set the "Motor Rotation" parameter of the esc.

### Inspection

Before powering on the ESC, please check the motor installation and the order of all connections

### Gearing

Reasonable selection of gear ratio is very important. Improper gear ratio may cause damage. You can select the

gear ratio according to the following points!

1. The operating temperature of the motor temperature should not exceed 100 degrees Celsius (212 degrees Fahrenheit) in operation. High temperature may cause the magnets to get demagnetized, the coil to melt and short circuit and the ESC to get damaged. A suitable gearing ratio can effectively prevent the motor from overheating.
2. The principle of selecting gear ratio To avoid the possible damage to the ESC and motor caused by the overheating, please start with a small pinion/a big FDR and check the motor temperature regularly. If the motor and ESC temperature always stays at a low level during the running, you can change a larger pinion/a lower FDR and also check the motor temperature regularly to ensure that the new gearing is suitable for your vehicle, local weather, and track condition. (Note: For the safety of electric devices, please check the ESC and motor temperature regularly.)

SHENZHEN HOBBYWING TECHNOLOGY Co., LTD. · 101-402 Building 4, Yaseen Chuangxin Hi-tech Industrial Park, 8 Chengxin Road, Baolong Industrial Town, Longgang District, Shenzhen, China

## Documents / Resources

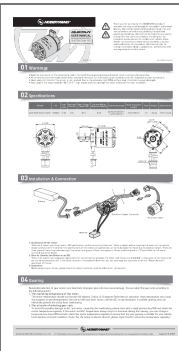
	<p><a href="#">HOBBYWING 1621SL Outer 1621 SL Motor</a> [pdf] User Manual</p> <p>1621SL, 3500KV, 1621SL Outer 1621 SL Motor, 1621SL, Outer 1621 SL Motor, 1621 SL Motor, SL Motor, Motor</p>
--	--

## References

- [User Manual](#)

[Manuals+](#), [Privacy Policy](#)

This website is an independent publication and is neither affiliated with nor endorsed by any of the trademark owners. The "Bluetooth®" word mark and logos are registered trademarks owned by Bluetooth SIG, Inc. The "Wi-Fi®" word mark and logos are registered trademarks owned by the Wi-Fi Alliance. Any use of these marks on this website does not imply any affiliation with or endorsement.