



hobbydrone 2 IN 1 Repeater Better Wireless Range Instruction Manual

[Home](#) » [hobbydrone](#) » hobbydrone 2 IN 1 Repeater Better Wireless Range Instruction Manual 

Contents

- [1 hobbydrone 2 IN 1 Repeater Better Wireless Range](#)
- [2 Product Usage Instructions](#)
- [3 Specs](#)
- [4 How to use](#)
- [5 Documents / Resources](#)
 - [5.1 References](#)
- [6 Related Posts](#)

hobbydrone

hobbydrone 2 IN 1 Repeater Better Wireless Range



Specifications:

- Voltage input: 2-6S Lipo
- RC IN Protocol: SBUS/CRSF, auto detection
- Video: 1.2G to 5.8G
- 5.8G VTX: 1.2W 48CH

Product Usage Instructions

Radio System:

1. Solder the receiver with duppond cable, plug the receiver to the repeater.
2. Plug the ELRS/CRSF TX module to the repeater.
3. Bind the radio with receiver on repeater.
4. Bind the ELRS/CRSF TX module on repeater with drone receiver.

Video System:

1. Set the 1.2G VRX to match the CH on drones.

How to Change the CH:

- Hold the button for 2 seconds to enter setting mode. Press the button to change CH. If there is no button control for 3 seconds, the VRX will save and exit the setting mode.
- For stock antenna, it is suggested to use CH4/5/6/8 for the best range.

VTX Setting:

Set the 5.8G VTX to match with the Goggles or ground station.

FAQ:

- **How do I change the VTX settings?**

To change VTX settings, follow these steps:

1. Hold the button for 3 seconds to enter setting mode.
2. In setting mode, short press the button to change the band.
3. Hold the button for 3 seconds to enter CH setting mode, then short press the button to change the channel.
4. To adjust power settings, hold the button for 3 seconds. A short bar on LED will indicate power levels – 1 bar for 200mW, 2 bars for 800mW, and 3 bars for 1200mW.

2 IN 1 Repeater Manual**Specs**

- Voltage input: 2-6S Lipo
- RC IN Protocol: SBUS/CRSF, auto detection
- Video: 1.2G to 5.8G
- 5.8G VTX: 1.2W 48CH

How to use**Radio System:**

1. Solder the receiver with despond cable, plug the receiver to the repeater
2. Plug the ELRS/CRSF TX module to the repeater
3. Bind the radio with receiver on repeater
4. bind the ELRS/CRSF TX module on repeater with drone receiver

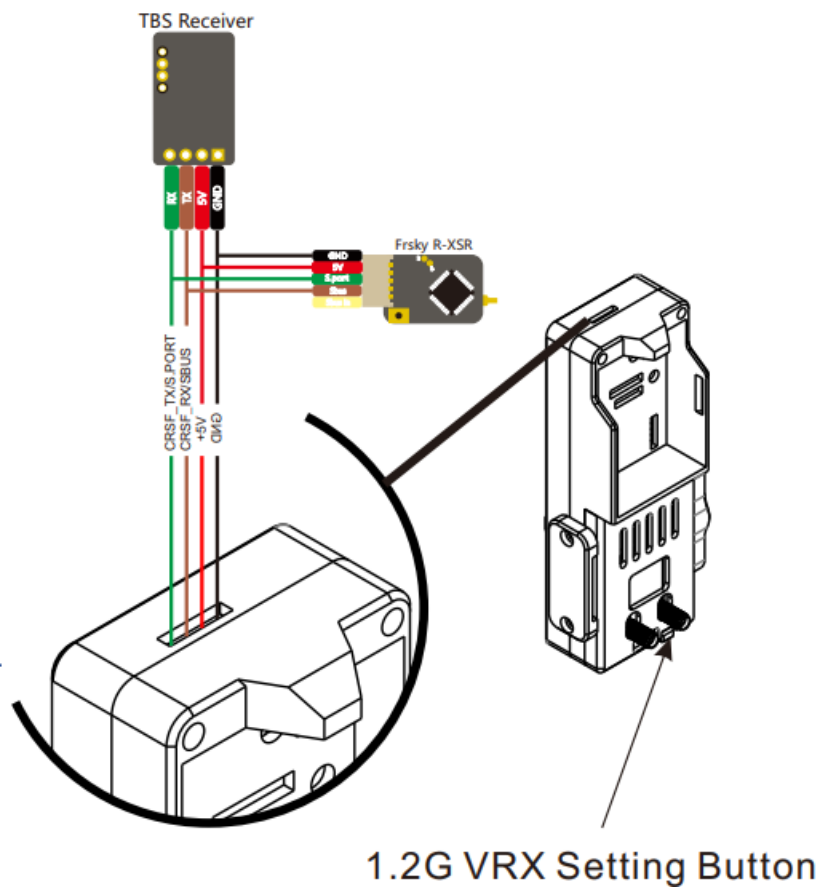

Video System:

1. Set the 1.2G VRX to matched the CH on drones How to change the CH: Hold the button for 2s to in to setting mode, press the button to change CH, no button control for 3s,the vrx will save and quit the setting mode

For stock antenna, its suggest to use at CH4/5/6/8 to get best range.

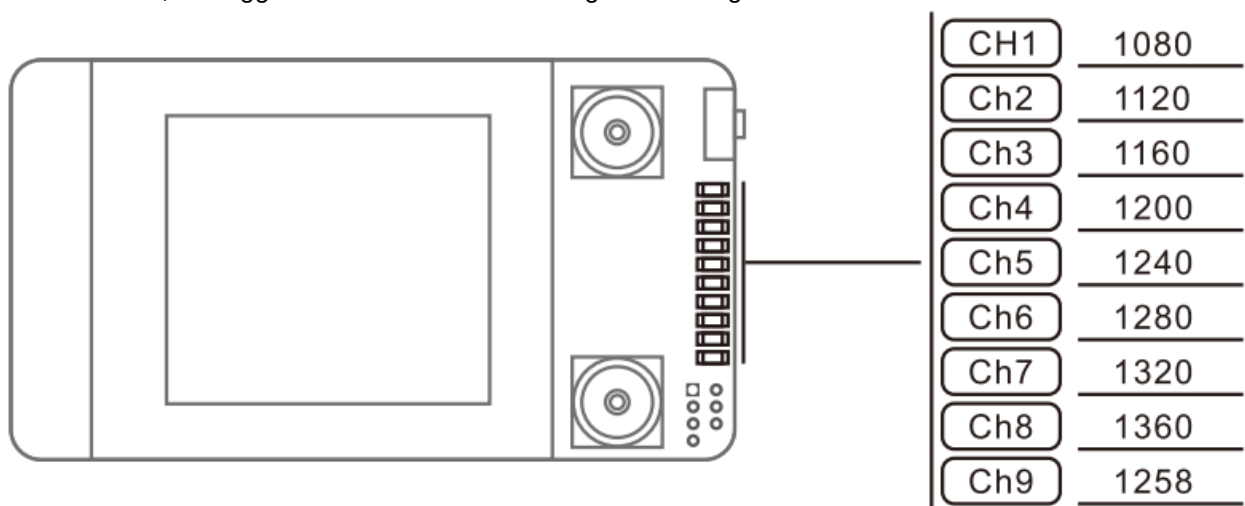

VTX Setting

Set the 5.8G VTX to matched with the Goggles or ground station

| Band | Channel | | | | | | | |
|------------|---------|------|------|------|------|------|------|------|
| | 1 | 2 | 3 | 4 | 5 | 6 | 7 | 8 |
| Band A | 5865 | 5845 | 5825 | 5805 | 5785 | 5765 | 5745 | 5725 |
| Band B | 573 | 5752 | 5771 | 5790 | 5809 | 5828 | 5847 | 5866 |
| Band E | 5705 | 5685 | 5665 | 5645 | 5885 | 5905 | 5925 | 5945 |
| Airwave/FS | 5740 | 5760 | 5780 | 5800 | 5820 | 5840 | 5860 | 5880 |
| Race Band | 5658 | 5695 | 5732 | 5769 | 5806 | 5843 | 5880 | 5917 |
| L Band | 5362 | 5399 | 5436 | 5473 | 5510 | 5547 | 5584 | 5621 |

1. Hold button 3 seconds into setting mode.
2. In setting mode. short press the button to change band.
3. Then hold button 3 seconds into CH setting mode, short press button to change CH.
4. Hold button 3 second to get into Power setting mode, there is short bar on LED, short press to switch power, 1 bar means 200mW, 2 bar means 800mW, 3 bar means 1200mW.

Documents / Resources

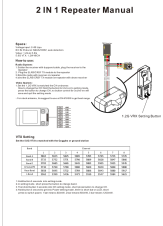
| | |
|---|---|
|  | <p>hobbydrone 2 IN 1 Repeater Better Wireless Range [pdf] Instruction Manual 2 IN 1 Repeater Better Wireless Range, Better Wireless Range, Wireless Range</p> |
|---|---|

References

- [User Manual](#)

[Manuals+](#), [Privacy Policy](#)

This website is an independent publication and is neither affiliated with nor endorsed by any of the trademark owners. The "Bluetooth®" word mark and logos are registered trademarks owned by Bluetooth SIG, Inc. The "Wi-Fi®" word mark and logos are registered trademarks owned by the Wi-Fi Alliance. Any use of these marks on this website does not imply any affiliation with or endorsement.