



# HMW32 High Bay Microwave Motion Sensor Instruction Manual

[Home](#) » [HMW](#) » HMW32 High Bay Microwave Motion Sensor Instruction Manual 

## Contents

- 1 [HMW32 High Bay Microwave Motion Sensor Instruction Manual](#)
  - 1.1 [Technical Specifications](#)
  - 1.2 [Installation](#)
  - 1.3 [Rotary Switch Settings](#)
  - 1.4 [Functions](#)
    - 1.4.1 [Daylight Harvest \(Daylight Regulating\)](#)
    - 1.4.2 [Lux Off Function](#)
    - 1.4.3 [Ambient Daylight Threshold](#)
    - 1.4.4 [8H Manual ON Mode For LED Lamp](#)
  - 1.5 [Wiring Diagram](#)
  - 1.6 [Detection Pattern](#)
  - 1.7 [Trouble Shooting](#)
  - 1.8 [Description of the Button Functions \(remote control HRC-11\)](#)
- 2 [Documents / Resources](#)
  - 2.1 [References](#)
- 3 [Related Posts](#)

## HMW32 High Bay Microwave Motion Sensor Instruction Manual

Installation and Instruction Manual

HIGH BAY MICROWAVE MOTION SENSOR

HMW32

Technical Specifications

**HYTRONIK**®

Product type	High bay microwave motion sensor (daylight harvest)
Operating voltage	220~240VAC 50/60Hz
Rated load (max.)	Capacitive: 800VA Resistive: 1000W
Power consumption	< 0.5W
Detection angle	360°
Detection area (max.)	Installation Height : 20m (forklift) 15m (person) Diameter (Ø) :20m
Detection range	10% / 50% / 70% / 100%
Hold time	2s / 30s / 1min / 5min / 10min / 15min / 20min / 30min
Stand-by time	0s / 10s / 1min / 5min / 10min / 30min / 1h / +∞
Stand-by dimming level	10% / 20% / 30% / 50%
Daylight threshold	50 ~ 500Lux, Disable
Warming up time	20s
Operating temperature	-20°C ~ +50°C
IP rating	IP65

## Installation

### ⚠ Warnings:

1. Installation of the sensor involves connecting it to the mains supply. This work must be carried out by a specialist in accordance with electrotechnical regulations.
2. Disconnect supply before installing.

### A. Ceiling mount

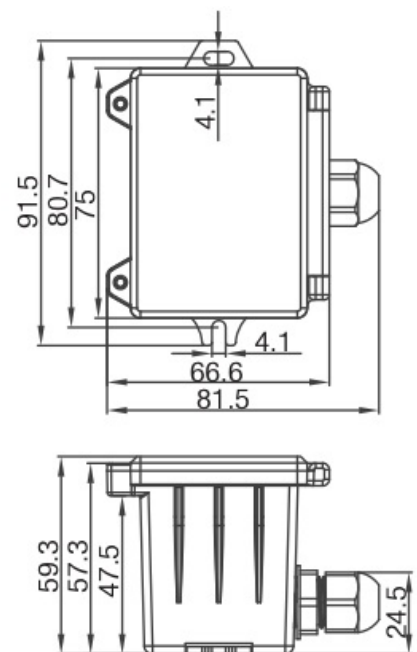
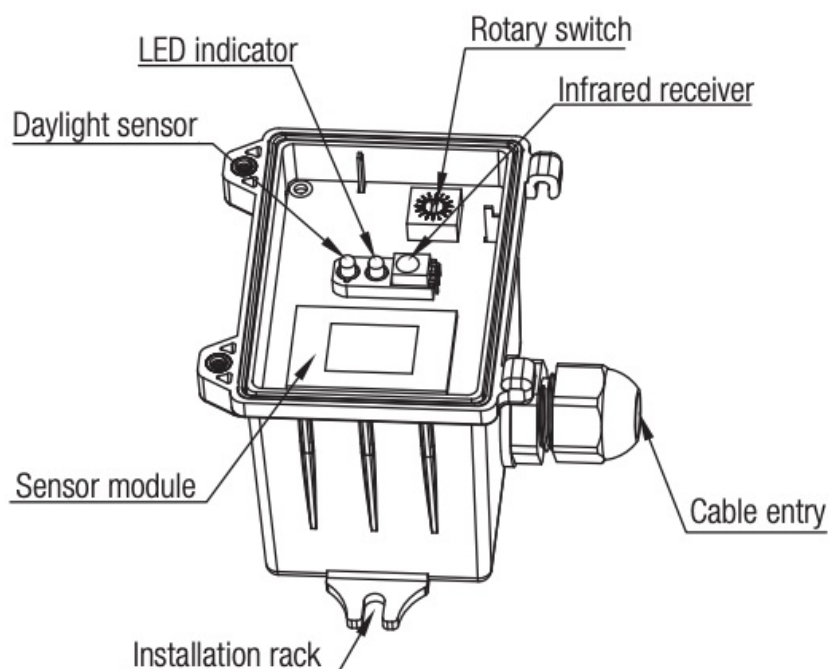

### B. Screw to the Luminaire by conduit

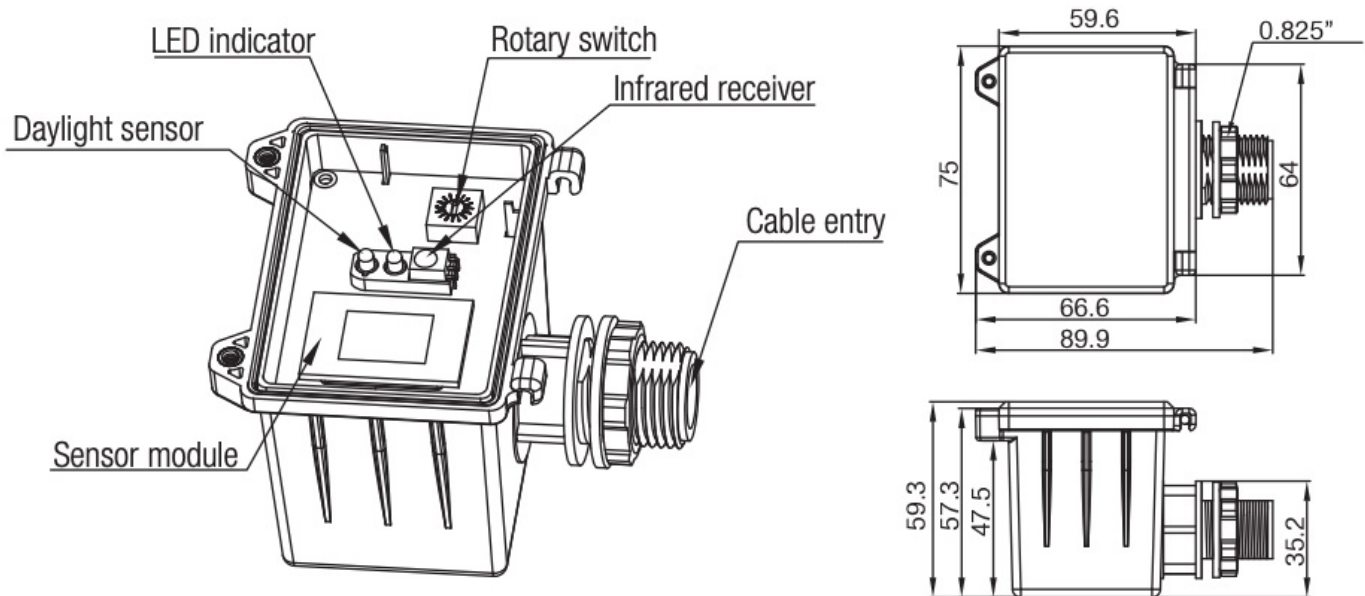

**C. Attach to the shade by clamp**

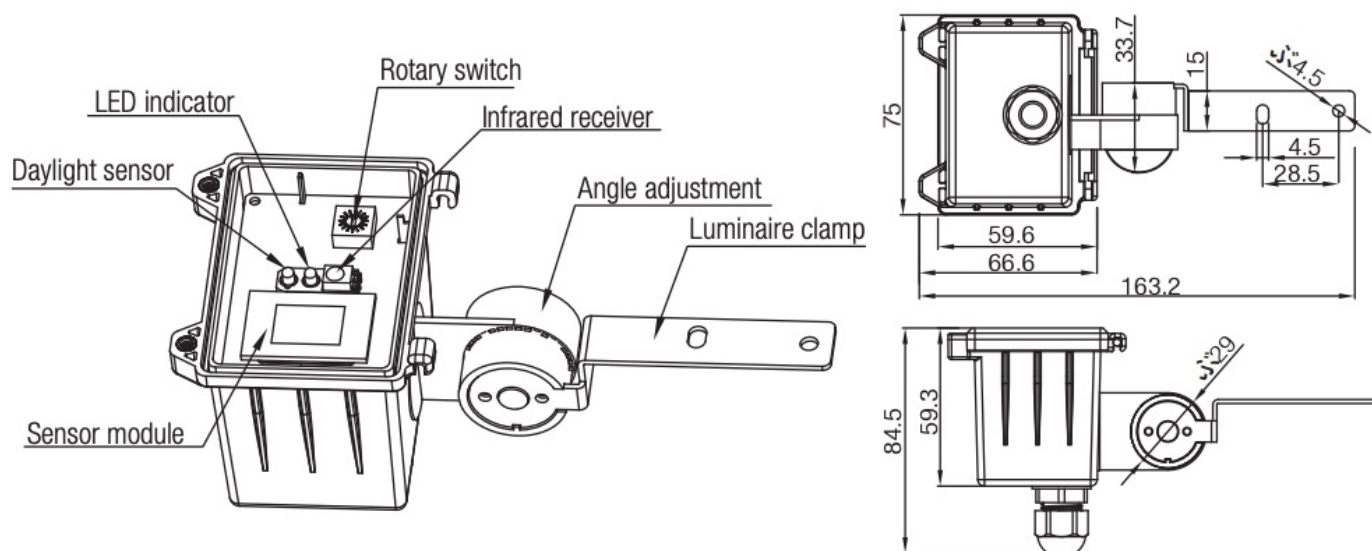

**Rotary Switch Settings**

A rotary switch is built inside the sensor for scene selection / fast programming. Total 16 channels available :



Rotary switch preset (Please see the location in 2. Installation)

Channel	Detection range	Hold time	Stand-by time	Stand-by dimming level	Daylight threshold
0	100%	5s	10s	10%	Disable
1	100%	1min	5min	10%	50Lux
2	100%	5min	10min	10%	50Lux
3	100%	5min	+∞	10%	75Lux
4	100%	5min	+∞	10%	100Lux
5	100%	5min	+∞	30%	200Lux
6	100%	10min	30min	10%	50Lux
7	100%	10min	+∞	10%	75Lux
8	100%	10min	+∞	10%	100Lux
9	100%	10min	+∞	30%	200Lux
A	100%	20min	1h	10%	100Lux
B	100%	20min	+∞	30%	200Lux
C	100%	30min	+∞	10%	100Lux
D	100%	30min	+∞	30%	200Lux
E	100%	30min	+∞	50%	400Lux
F	100%	5s	10s	10%	100Lux

Note: settings can also be changed by remote control HRC-11. The last action controls.

## Functions

### Daylight Harvest (Daylight Regulating)

Daylight sensor measures the available surrounding natural light, calculates how much electrical light is needed to reach the total lux expected. The demand is given to the LED driver by 1-10V signal, so as to deliver the needed amount of electric light.

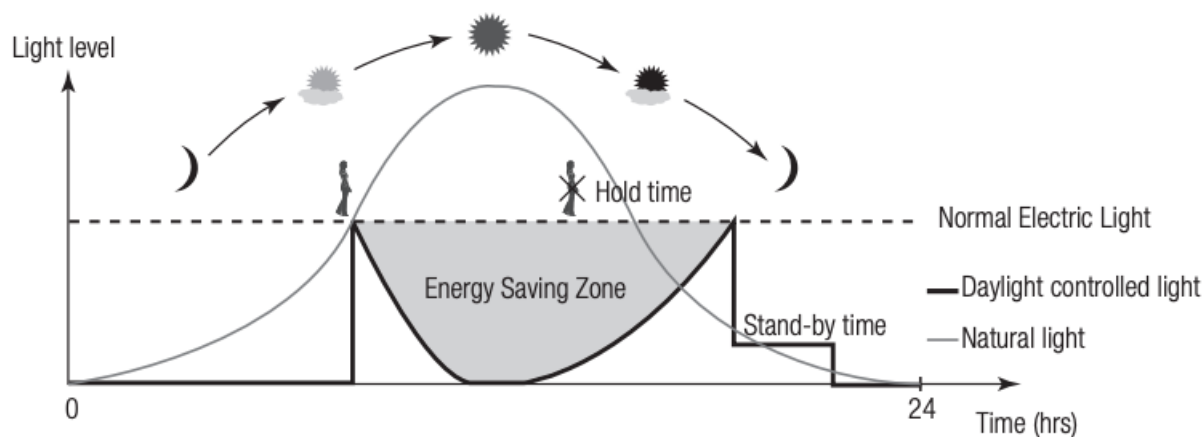

Note: by pressing the “Sensor off” button on the remote control, the sensor occupancy function is disabled. The target lux level for daylight harvest function can be adjusted by “Brightness +/-” buttons.

### Lux Off Function

The built-in daylight sensor can read ambient natural light and switch off the fixture automatically whenever artificial light is unneeded (natural light lux level exceeds daylight threshold). Note: if the stand-by time is preset at

“+∞”, the fixture never switches off even when natural light is sufficient.

### Ambient Daylight Threshold

Switch the power supply to the sensor two times within 2 seconds, the ambient lux level is sampled and set as the new daylight threshold. Both the settings on rotary switch and the ambient lux level sampled can overwrite each other. This feature enables the daylight sensor to be commissioned to the environment in which it is installed. The last adjustment remains in memory.

### 8H Manual ON Mode For LED Lamp

Turn off/on the power supply three times within 3 seconds, the light will be turned on for 8 hours, even there is no motion detected, then go back to sensor mode automatically. Note: this 8H manual on mode can be cancelled by turning off/on the power supply one time within 1 second.

### Wiring Diagram

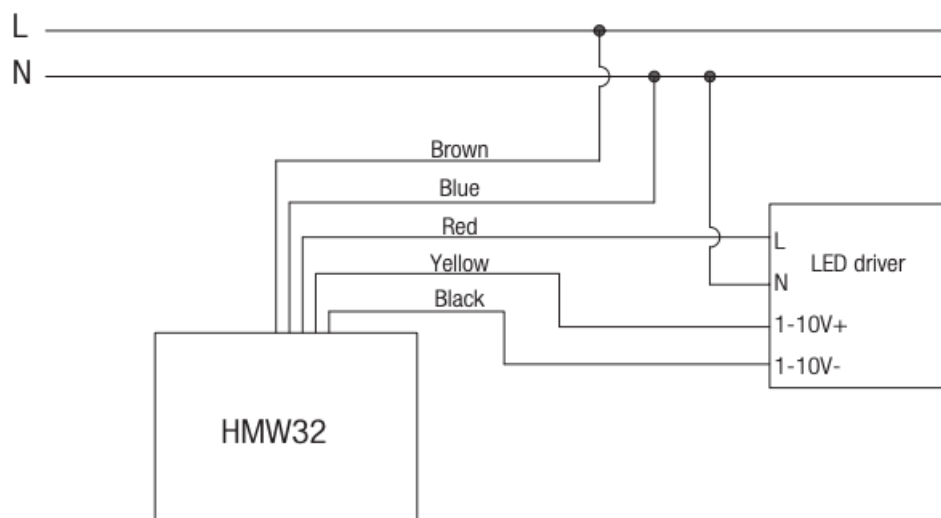

—————*This product should be installed by a qualified electrician.*

### Detection Pattern

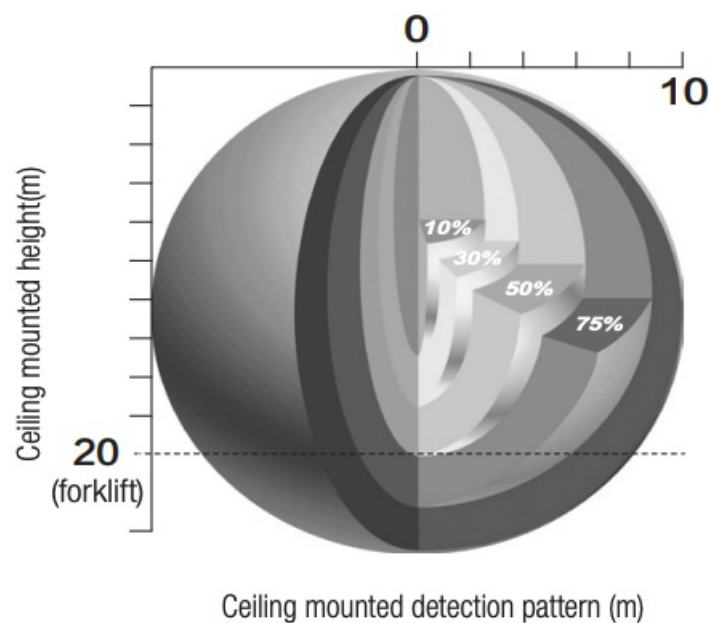

\* For single person walking across, the detection range is reduced by 1/3.

## Trouble Shooting

MALFUNCTION CAUSE REMEDY	CAUSE	REMEDY
The fixture does not light up	Incorrect daylight threshold setting	Adjust daylight threshold setting
	Faulty fixture	Replace fixture
	No power supply	Check power to sensor
	Detection zone not targeted	Check detection area setting
The fixture is always on	Continued movement in the detection zone	Check detection area setting
The fixture is on when it should not	Sudden change in temperature due to weather (wind, rain, snow) or air expelled from fans, open windows	Adjust zone, change installation site

## Description of the Button Functions (remote control HRC-11)

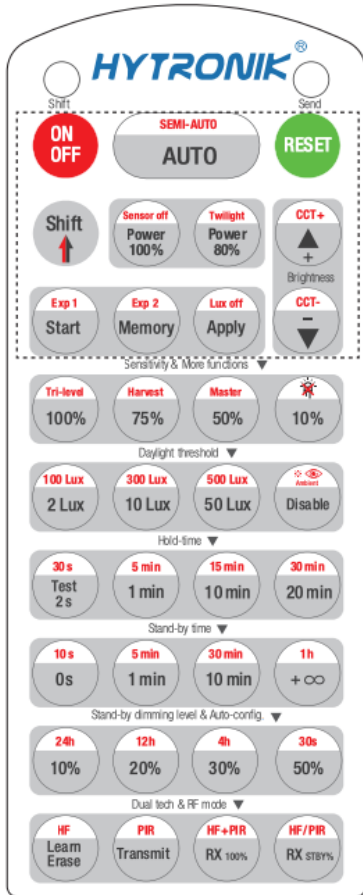

HRC-11

	Press button "ON/OFF" to select permanent ON or permanent OFF mode. * Press button "AUTO" / "RESET" to exit this mode.
	Press button "RESET", perform DIP Switch/Rotary Switch settings. The default settings are: Auto mode; Detection range 100%; Hold-time 5min; Daylight sensor 100lux; Standby time +∞; Standby dimming level 10%;
	Press button "Shift", the LED on the top left corner is on to indicate mode selection. All values / settings in RED are valid for 20 seconds.
<b>AUTO</b>	Press button "AUTO" to initiate automatic mode. The sensor starts working and all settings remain as before the light is switched ON/OFF;
<b>SEMI-AUTO</b>	This key is not applicable on this product.
<b>Power 100% 80%</b>	Press buttons in zone "Power out" to select the light output at 80% (at initial 10,000 hours) or 100%.
<b>Sensor off</b>	1. Press button "Shift", the red LED on. 2. Press button "Sensor off", the function of movement detection is disabled, the function of photocell is also disabled.
<b>Twilight</b>	To exit from "Sensor off" mode, press button "AUTO"/"RESET".  <i>Note: the function of "Twilight" is disabled.</i>
	Press these two buttons to adjust the light output brightness and set a new target lux level. The daylight sensor can measure ambient daylight level and ignore the LED light, so as to calculate how much artificial light is needed to maintain the target lux level.
<b>CCT+ CCT-</b>	This key is not applicable on this product.
<b>Start</b> <b>Memory</b> <b>Apply</b>	1. Press button "Start" to program. 2. Select the buttons in "Detection range", "Daylight threshold", "Hold-time", "Stand-by time", "Stand-by dimming level" to set all parameters. 3. Press button "Memory" to save all the settings programmed in the remote control. 4. Press button "Apply" to set the settings to each sensor unit(s).  <i>For example, to set detection range 100%, daylight threshold Disable, hold-time 5min, stand-by time +∞, stand-by dimming level 30%, the steps should be: Press button "Start", button "100%", "Disable", "Shift", "5min", "Shift", "+∞", "30%", "Memory". By pointing to the sensor unit(s) and pressing "Apply", all settings are passed on the sensor(s).</i>
<b>Lux off</b>	This key is not applicable on this product.
<b>Exp 1</b> <b>Exp 2</b>	"Exp" refer to Expansion, these two buttons are reserved functions and pending future development.

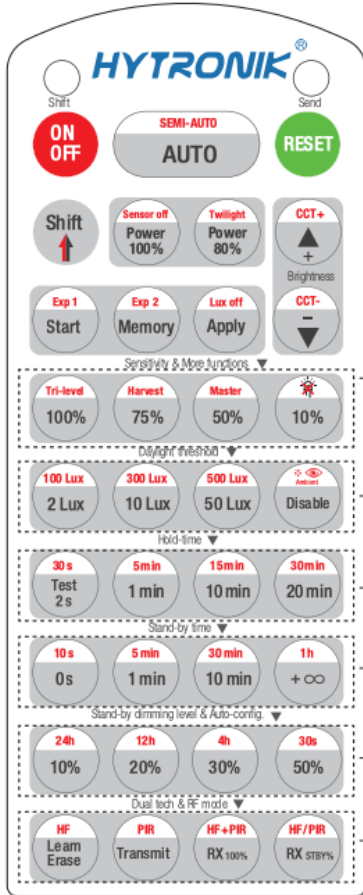

HRC-11

Sensitivity & More functions	
100% 75% 50% 10%	In AUTO modes, press buttons in zone "Detection range" to set detection range at 100%/75%/50%/10%.
<b>Tri-level Harvest</b>	1. Press button "Shift", the red LED on. 2. Press buttons "Tri-level" or "Daylight harvest" to shift between Tri-level control mode and Daylight harvest mode.
<b>Master</b>	This key is not applicable on this product.
Daylight threshold	
2 Lux 100 Lux 10 Lux 300 Lux 50 Lux 500 Lux Disable	Press buttons in zone "Daylight threshold" to set daylight sensor at 2Lux/ 10Lux / 50Lux / 100Lux / 300Lux/500Lux / Disable. <i>Note: To set daylight sensor at 100Lux / 300Lux/500Lux , press "Shift" button first.</i>
<b>Ambient</b>	1. Press button "Shift", the red LED on. 2. Press button "Ambient", the surrounding lux level is sampled and set as daylight threshold / target Lux level.
Hold-time mode	
Test 2s 30s 1min 5min 10min 15min 20min 30min	In AUTO modes, press buttons in zone "hold-time" to set the hold-time at 2s / 30s / 1min / 5min / 10min / 15min / 20min / 30min. <i>Note: 1. To set hold-time at 30s / 5min / 15min / 30min, press "Shift" button first. 2. 2s is for testing purpose only, stand-by period and daylight sensor settings are disabled in this mode.</i> *To exit from Test mode, press button "RESET" or any button in "Hold-time".
Stand-by time mode	
0s 10s 1min 5min 10min 30min +∞ 1h	Press buttons in zone "stand-by time" to set the stand-by period at 0s / 10s / 1min / 5min / 10min / 30min / 1h / +∞. <i>Note: 1. To set stand-by-time at 10s/ 5min / 30min / 1h, press "Shift" button first. 2. "0s" means on/off control; 3. "+∞" means bi-level control, the fixture is 100% on when there is motion detected, and remains at the stand-by dimming level when no presence after motion hold-time. Only when the stand-by time is set in "+∞" and the ambient lux level is below the target lux level, the lux will auto-on.</i>
Stand-by dimming level & Auto-config.	
10% 20% 30% 50%	Press the button in zone "stand-by dimming level" to set the stand-by dimming level at 10% / 20% / 30% / 50%.
24h 12h 4h 30s	1. Press button "Shift", the red LED on. 2. Select a time period and the sensor will do light level measurement and determine/save the lowest light level (commission line) with 100% light on, so as to set the target lux level automatically. <i>Note: 1. Make sure the light level measurement covers the night time. 2. The fixture will go into sensor mode after the measurement, all sensor setting remain unchanged.</i>
Dual tech & RF mode	
Learn Erase	This key is not applicable on this product.
Transmit	This key is not applicable on this product.
HF PIR HF+PIR HF/PIR	This key is not applicable on this product.



---

## Documents / Resources

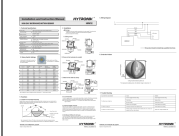

[HMW HMW32 High Bay Microwave Motion Sensor](#) [pdf] Instruction Manual  
HMW32 High Bay Microwave Motion Sensor, HMW32, High Bay Microwave Motion Sensor, Microwave Motion Sensor, Motion Sensor, Sensor

## References

- [User Manual](#)