

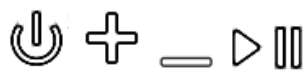

# Hiwill HW210 Sound Bars User Manual

[Home](#) » [Hiwill](#) » Hiwill HW210 Sound Bars User Manual 

## Hiwill HW210 Sound Bars User Manual



## Contents

- 1 ACCESSORIES LIST
- 2 CONNECT TO SUBWOOFER
- 3 CONNECT TO THE TV VIA ARC
- 4 CONNECT TO THE TV VIA OPTICAL/AUX
- 5 CONTROL PANEL
- 6 PLACEMENT OPTIONS
- 7 WALL MOUNT INSTALLATION
- 8 SPECIFICATIONS
- 9 SAFETY INSTRUCTIONS
- 10 PROPER DISPOSAL INSTRUCTIONS
- 11 FCC REGULATORY COMPLIANCE
- 12 Documents / Resources
  - 12.1 References
- 13 Related Posts

## ACCESSORIES LIST

Subwoofer

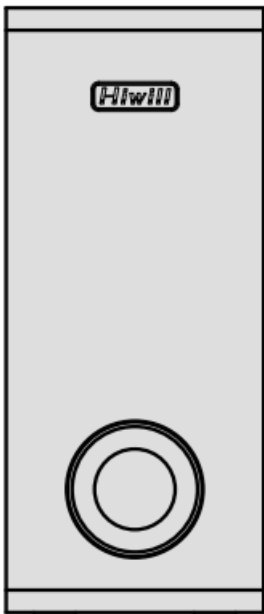

Sound bar

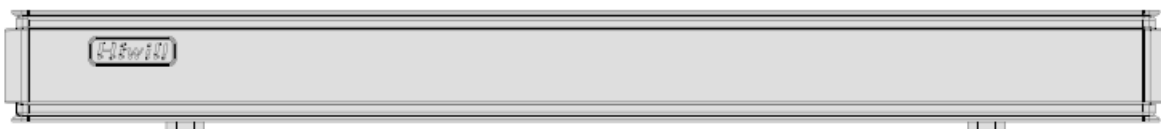

Power Adaptor



Stereo 3.5mm to 3.5mm Audio Cable

HDMI Cable

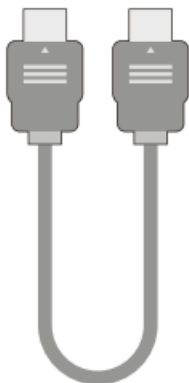

HDMI Adaptor

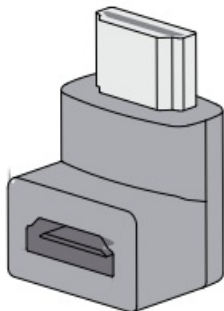

Digital Optical

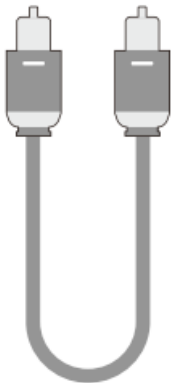

Remote Control



Batteries

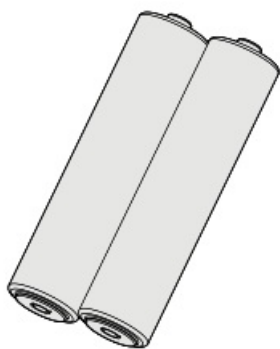

Wall Mounted Kit



Wall Bracket

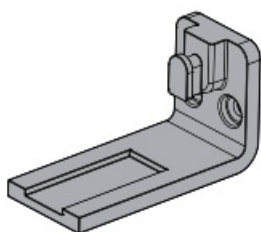

User Manual

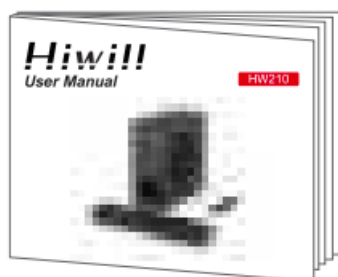

## CONNECT TO SUBWOOFER

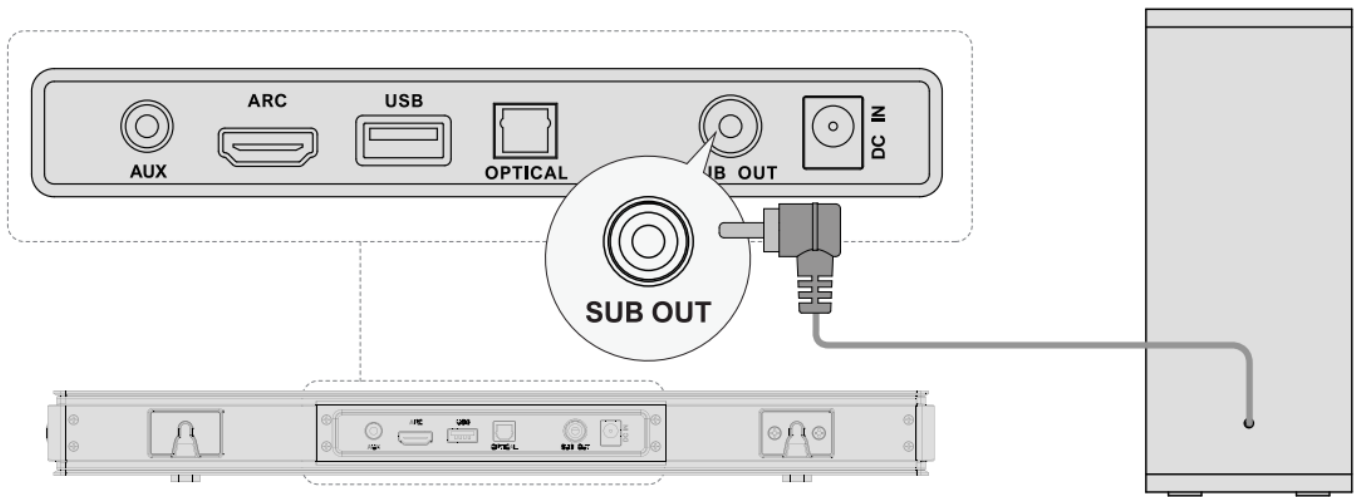

## CONNECT TO THE TV VIA ARC

**Step 1:** Connect one end of the HDMI cable to the ARC/eARC port on the back of your TV.

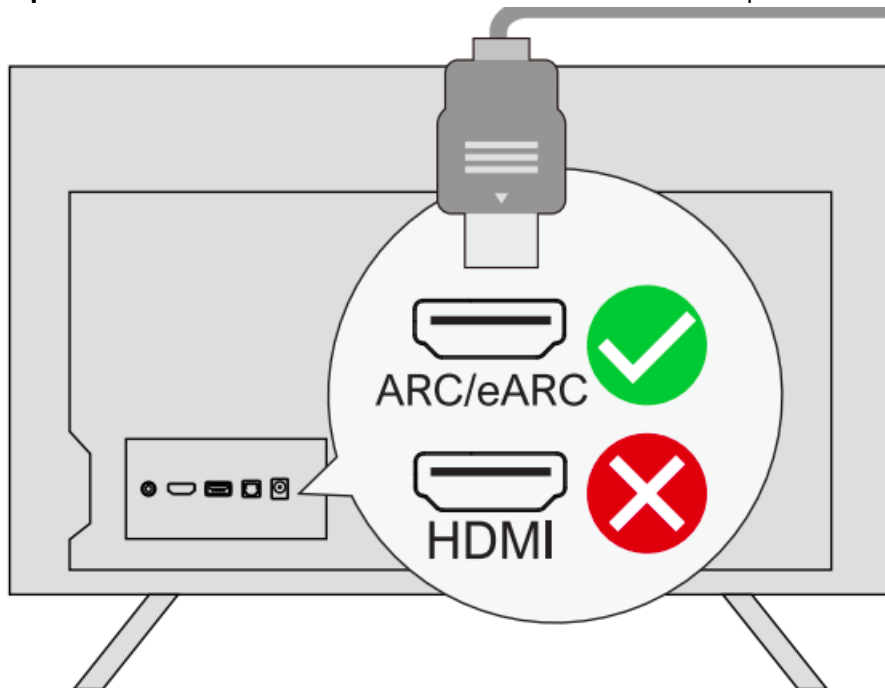

**Step 2:** Then connect the other end into the HDMI ARC port of the sound bar

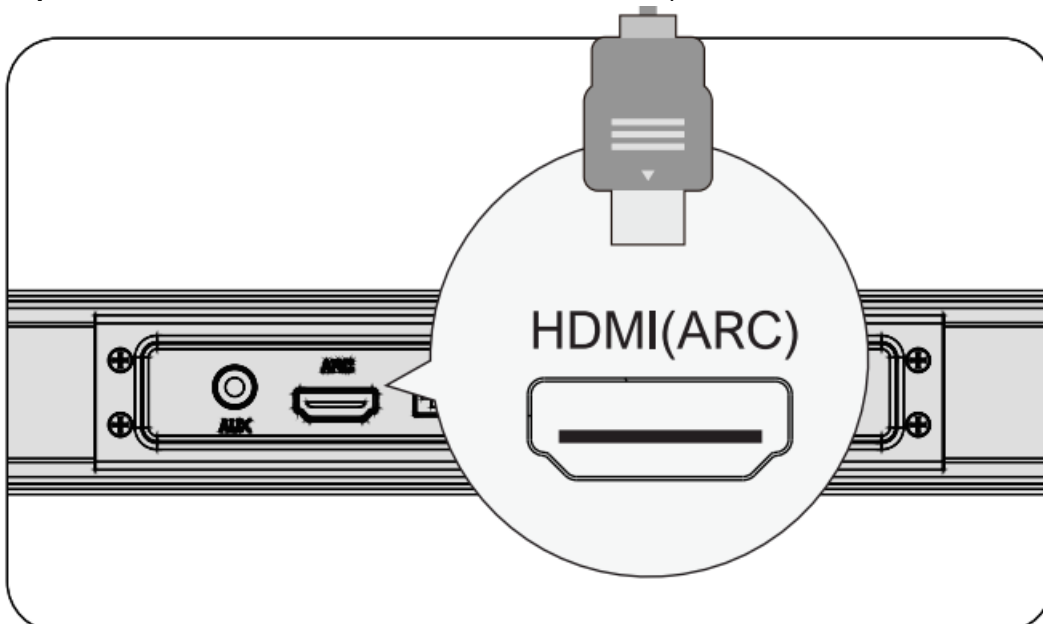

**Step 3:** Press “ARC” button on the remote control to select “ARC” input.

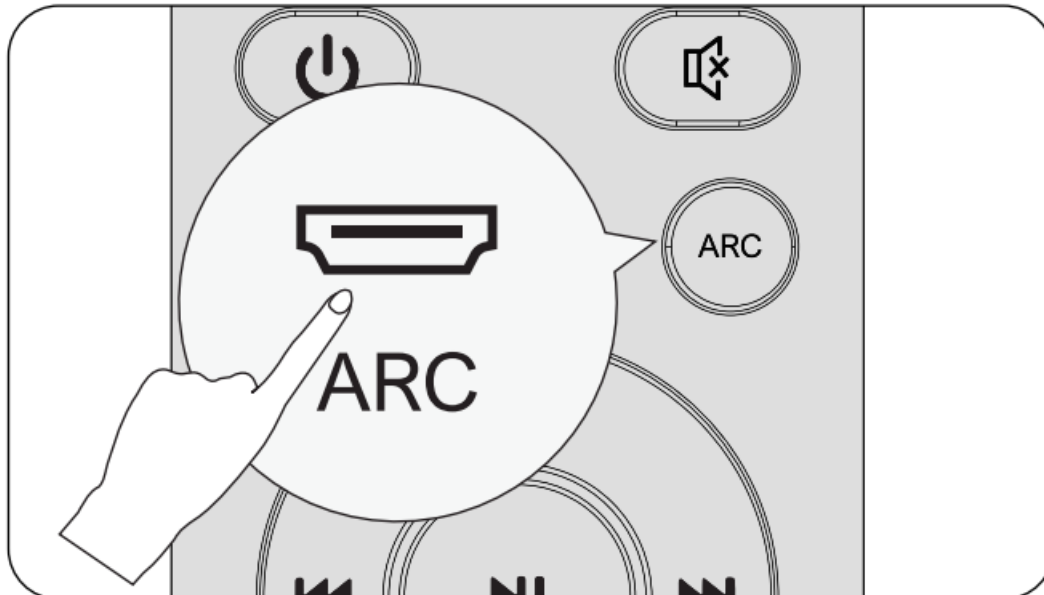

If there is no sound, try setting the TV audio output to PCM: TV Settings> Home > Settings > Sound Digital Audio Output > PCM

**Note:** Please turn on the “CEC” function on your TV. When ARC is connected, your TV remote control can control the sound bar and TV simultaneously. **1** Turn on **2** off Adjust the volume.

## CONNECT TO THE TV VIA OPTICAL/AUX

### OPTION 1: OPTICAL

1. Make sure the TV's port is OPTICAL OUT, connect both sides of the cable to OPTICAL, for both the TV and the sound bar.
2. Make sure the optical plug is inserted correctly as it shows in the picture. Do not insert the plug upside down and break the optical-

**Note:** If audio is playing from the internal TV speakers, mute or minimize the TV volume.

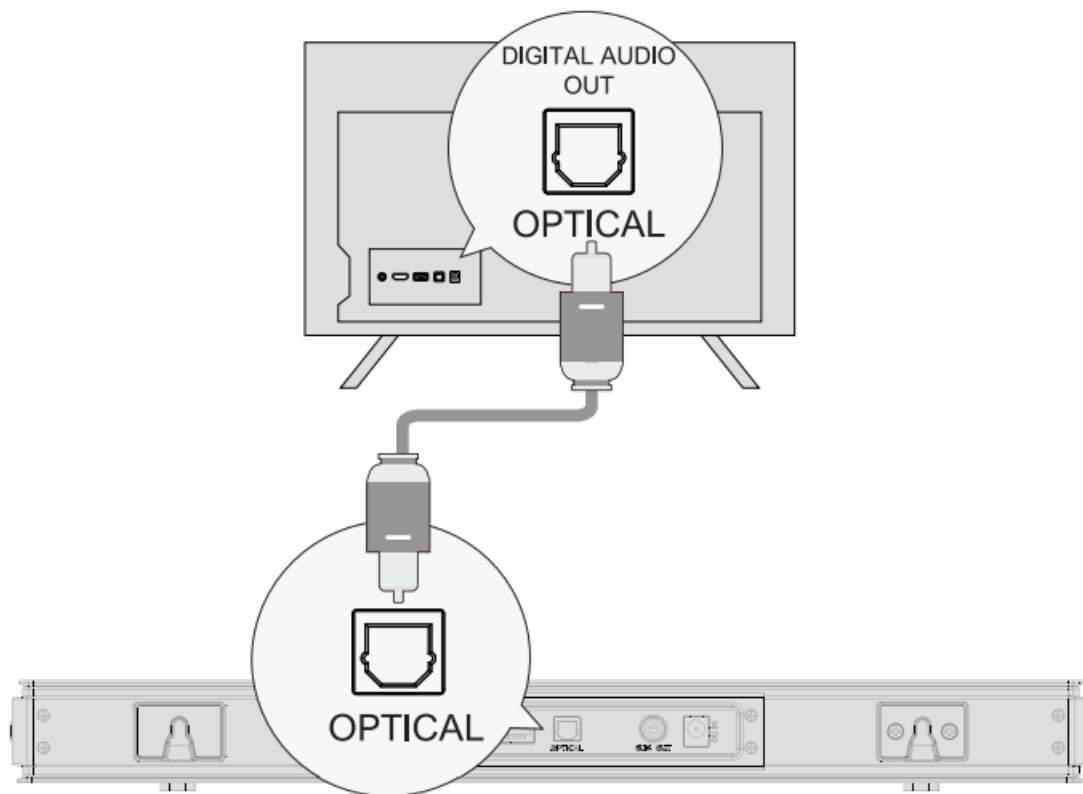

## OPTION 2: AUX

1. Connect the 3.5mm to 3.5mm Audio Cable to your TV's AUDIO OUT port.
2. Not support AUDIO IN port on TV

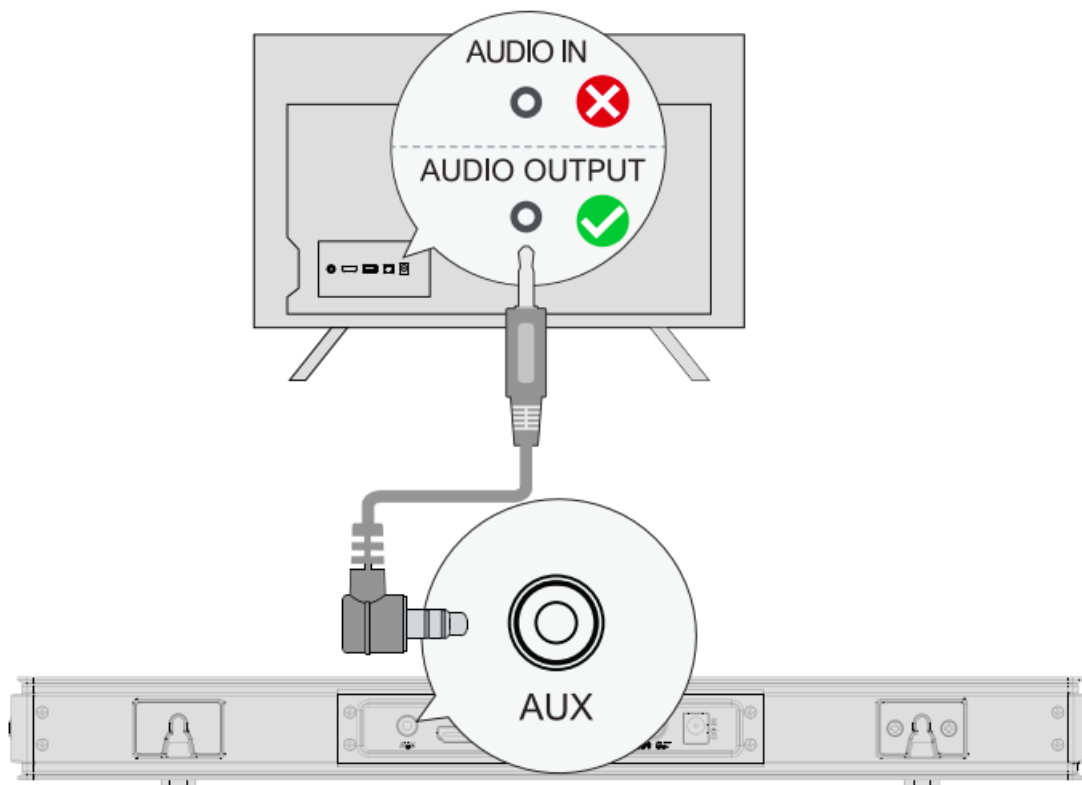

**Note:** Please remember to unplug the AUX cable from TV and Sound bar when you want to switch to other mode,

## CONNECT TO BLUETOOTH

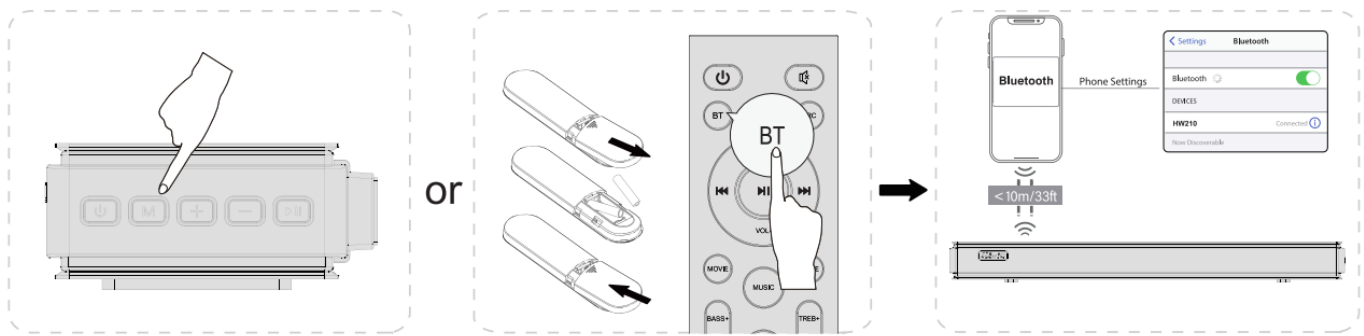

1. Press the “M” button on the sound bar or “BT” button on the remote control to enter Bluetooth pairing mode.
2. Open your phone’s Bluetooth settings, find and select “HW210” to connect the sound bar. **Note:** If it’s already in the Bluetooth mode and connected, hold the “M” button on the sound bar or “BT” button on the remote control for 3 seconds to disconnect the current device and connect to a new device manually on your mobile phone/PC/TV.

## CONTROL PANEL

1. “”: Power Button Press to power on/ Hold for 3 seconds to power off.
2. M”: Input Mode Press to switch channels: ARC-OPT(OPTICAL)-BT-AUX-USB. Hold for 3 seconds to disconnect the current device and connect to a new device manually on your mobile phone/PC/TV (BT ID: HW210).
3. “+”: Volume Up
4. “-”: Volume Down
5. “”: Play/Pause

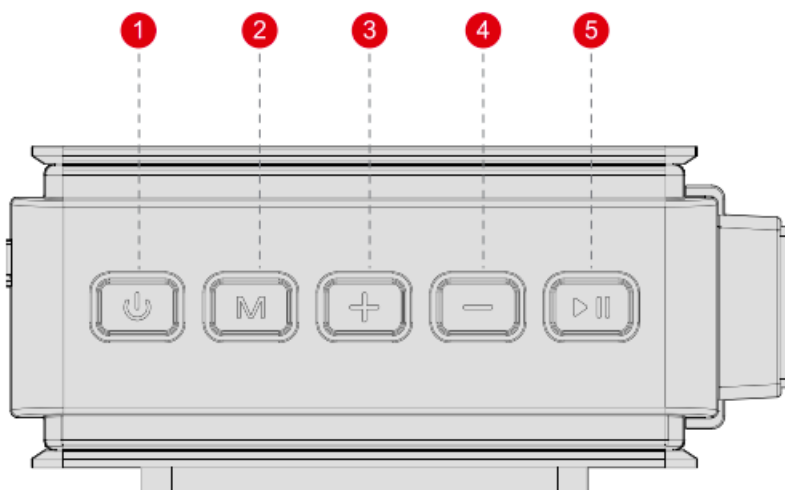

## CONTROL PANEL



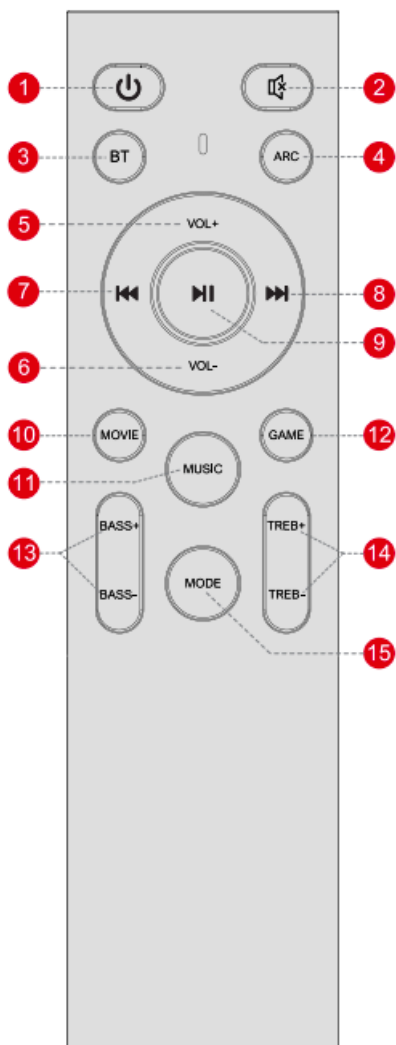

1. “**⏻**”: **Power Button**

Press to power on/Hold for 3 seconds to power off.

2. **ARC**

Press to switch to ARC channel.

3. “VOL+”: **Volume Up**

4. “VOL-” **Volume Down**

5. “⏮”: **Previous**

For BT and USB mode only: Skip to previous track.

6. “⏭”: **Next**

For BT and USB mode only: Skip to next track.

7. “⏮”: **Play/Pause**

For BT and USB mode only.

USB mode: Hold for 3 seconds to switch between single loop playback and list loop playback.

8. **MOVIE**

Press to switch to MOVIE mode, the display will show: “E”.

9. **GAME**

Press to switch to GAME mode, the display will show, “292”.

10. **MUSIC**

Press to switch to MUSIC mode, the display will show: “ER 3”.

11. **BASS**

Press to adjust bass level

## 12. TREB

Press to adjust treble level.

## 13. MODE

Press to switch to BT, ARC, OPT, AUX channel.

## PLACEMENT OPTIONS

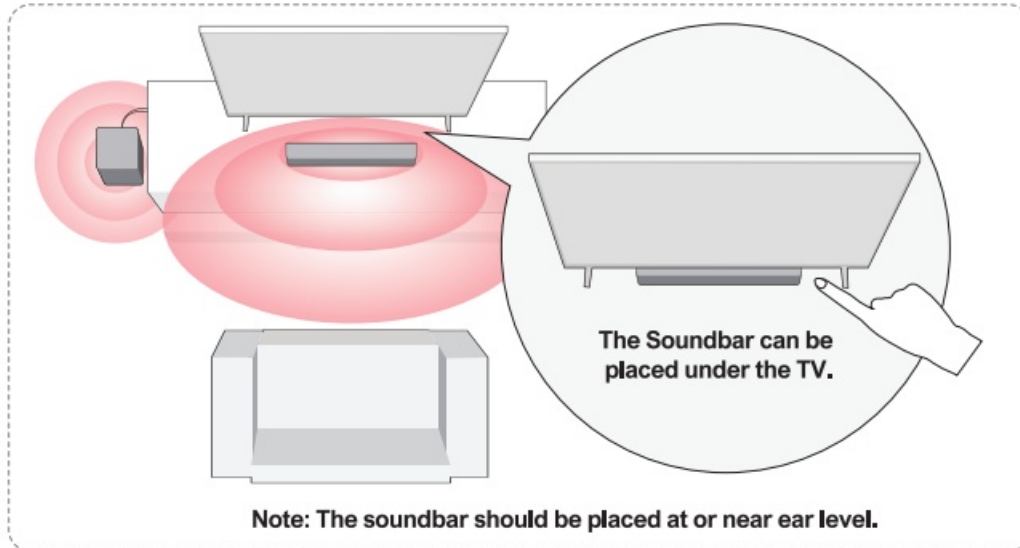

## WALL MOUNT INSTALLATION

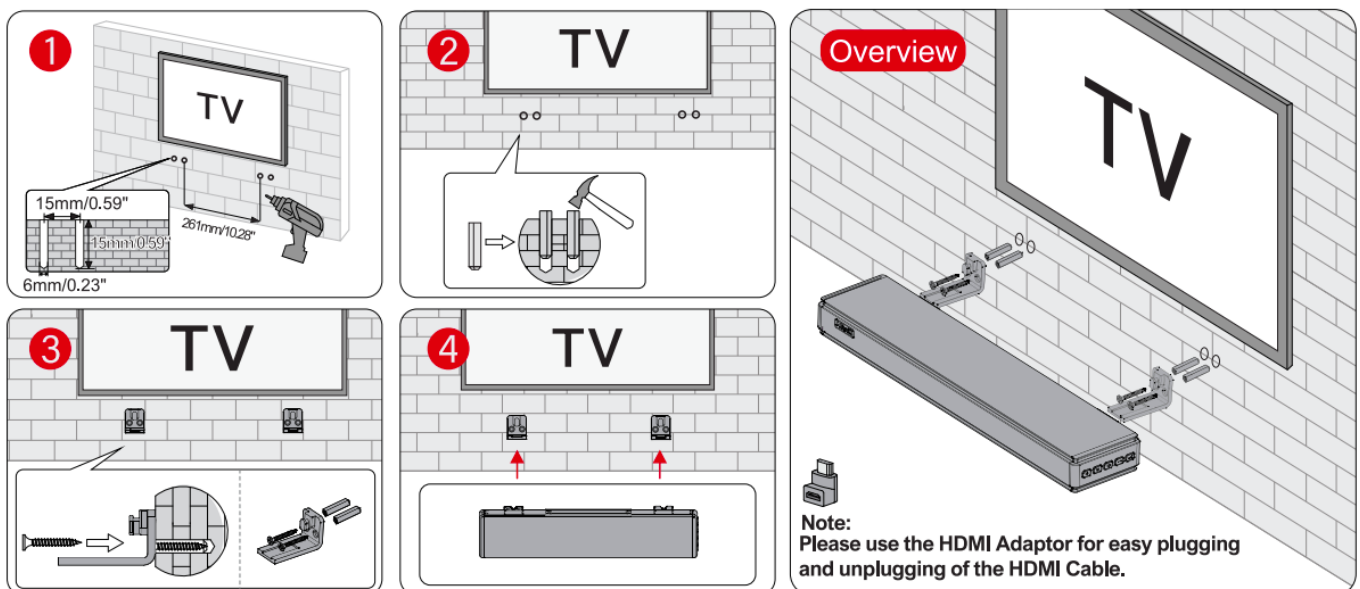

## SPECIFICATIONS

## SAFETY INSTRUCTIONS

**Please read this user manual carefully and save it for future reference.**

Do not make unauthorized alterations to the product, doing so may compromise safety, regulatory compliance, system performance, and may void the warranty. • Avoid dropping.

- Do not disassemble.

- Do not submerge in water.
- Avoid extreme temperatures.
- Do not use the device outdoors during thunderstorms.
- Use original or certified cables.
- Do not place dangerous items on top of this device (e.g. liquid filled objects, lit candles).
- Clean with a dry, soft lint-free cloth. Do not use any corrosive cleaner or oil.
- To avoid hearing damage, do not listen for extended periods at high volume.
- The ideal operating temperature for this product and its accessories is between 41°F/5°C and 95°F/35°C.
- The adapter should be installed near the device and should be easily accessible.
- Do not use this product in environments of extreme heat or cold. Never expose this device to strong sunshine or wet environments.

## PROPER DISPOSAL INSTRUCTIONS

- This mark shown on the product or its packaging, indicates that this product should not be disposed of with other household waste at the end of its working life.



-  To prevent possible harm to the environment or human health from uncontrolled waste disposal, please separate this from other types of wastes and recycle it responsibly to promote the sustainable reuse of material resources.

### Waste Electrical & Electronic Equipment

- Household user should contact either the retailer where they purchased this product, or their local government office, for details of where and how they can take this item for environmentally safe recycling.
  - Business users should contact their suppliers and check the terms and conditions of the purchase contract.
- This product should not be mixed with other commercial wastes for disposal.

## FCC REGULATORY COMPLIANCE

**NOTE:** This equipment has been tested and found to comply with the limits for a Class B digital device, pursuant to part 15 of the FCC Rules. These limits are designed to provide reasonable protection against harmful interference in a residential installation.

This equipment generates uses and can radiate radio frequency energy and, if not installed and used in accordance with the instructions, may cause harmful interference to radio communications.

However, there is no guarantee that interference will not occur in a particular installation. If this equipment does cause harmful interference to radio or television reception, which can be determined by turning the equipment off and on, the user is encouraged to try to correct the interference by one or more of the following measures:

- Reorient or relocate the receiving antenna.
- Increase the separation between the equipment and the receiver.
- Connect the equipment to an outlet on a circuit different from that to which the receiver is connected. – Consult the dealer or an experienced radio / TV technician for help.

Any changes or modifications not expressly approved by the party responsible for compliance could void the user's authority to operate the equipment.

This device complies with Part 15 of the FCC Rules. Operation is subject to the following two conditions:

- (1) This device may not cause harmful interference.
- (2) This device must accept any interference received, including interference that may cause undesired operation. This equipment complies with FCC radiation exposure limits set forth for an uncontrolled environment. This equipment should be installed and operated with a minimum distance of 20cm between the radiator & your body. This transmitter must not be co-located or operating in conjunction with any other antenna or transmitter.

**Model Number:** HW210

**Product Name:** HW210

**Power Supply:** DC 24V 2.5A

**FCC ID:** 2BCYG-HW210HW310 **MADE IN CHINA**

**Manufacturer:** Dongguan Chenxing Design  
Technology Co., Ltd

**Address:** Room 305, No. 5 Lunching West Road, Qingxi Town, Dongguan City, Guangdong Province We hope you never have the need, but if you do, our service is friendly and hassle-free as below.



[Hiwill-audio@outlook.com](mailto:Hiwill-audio@outlook.com)



**RoHS**

***Hiwill***

## Documents / Resources

 <p>User Manual</p>	<p><a href="#">Hiwill HW210 Sound Bars</a> [pdf] User Manual HW210 Sound Bars, HW210, Sound Bars, Bars</p>
--	--

## References

- [User Manual](#)

