



# HIOS CLC Series DC Screwdrivers Controller Instruction Manual

[Home](#) » [HIOS](#) » HIOS CLC Series DC Screwdrivers Controller Instruction Manual 

## Contents

- [1 HIOS CLC Series DC Screwdrivers Controller Instruction Manual](#)
- [2 Important Safety Instructions](#)
- [3 Handling](#)
- [4 INSTRUCTIONS.](#)
- [5 Accessories](#)
- [6 Compatible Screwdrivers \(Including OPC/SS Type](#)
- [7 CLC-45](#)
- [8 CLC-60](#)
- [9 Attach the Mounting Bracket](#)
- [10 Specifications](#)
- [11 Read More About This Manual & Download PDF:](#)
- [12 Documents / Resources](#)
  - [12.1 References](#)

# HIOS CLC Series DC Screwdrivers Controller Instruction Manual



## Important Safety Instructions

Before using this machine, read this section and follow the instructions to properly use this machine.

### Installation

- The unit should be used in a temperature and humidity-controlled room. Keep the unit away from a place with poor ventilation, in dust or metal pieces.
- Do not place any objects on the
- The place to install the unit should be vibration-free and the unit should be securely fixed. If the unit is installed on the wall or on a high place, make sure to use the attached Mounting Bracket to fix it securely.
- Do not install the unit close to high voltage

### Handling

- Install a leakage breaker and safety breaker on the input power source and connect the ground to use the
- Connect to a power source of the specified
- Do not use with other drivers or devices except the models listed in this operation
- If the protection circuit works due to overheat, stop operation immediately, pull the power plug from the outlet and send it back to your HIOS distributor for repair.
- The unit may automatically stop in use when the protection circuit works due to overcurrent. Turn off the power switch once and turn it on in 5 seconds for restart. If the unit stops while in screw fastening, make sure to check the torque of the fastened screw.
- Do not disassemble or modify the
- Do not drop the power supply or subject it to violent
- Do not drag the unit by its driver cord or AC. Keep the cords away from foreign objects, oil or something sharp.
- Make sure to grasp the plug section to disconnect the AC cord from the
- Turn the unit off and disconnect the AC cord from the outlet when the unit is not in
- IMPORTANT SAFETY INSTRUCTIONS-SAVE THESE
- DANGER-TO REDUCE THE RISK OF FIRE OR ELECTRIC CAREFULLY FOLLOW THESE

INSTRUCTIONS.

Accessories



	Mounting Bracket	Screw
CLC-45	1pc	1pc
CLC-60/CLC-80	2pcs	4pcs

AC Cord (1.8m)

Parts and Their Functions

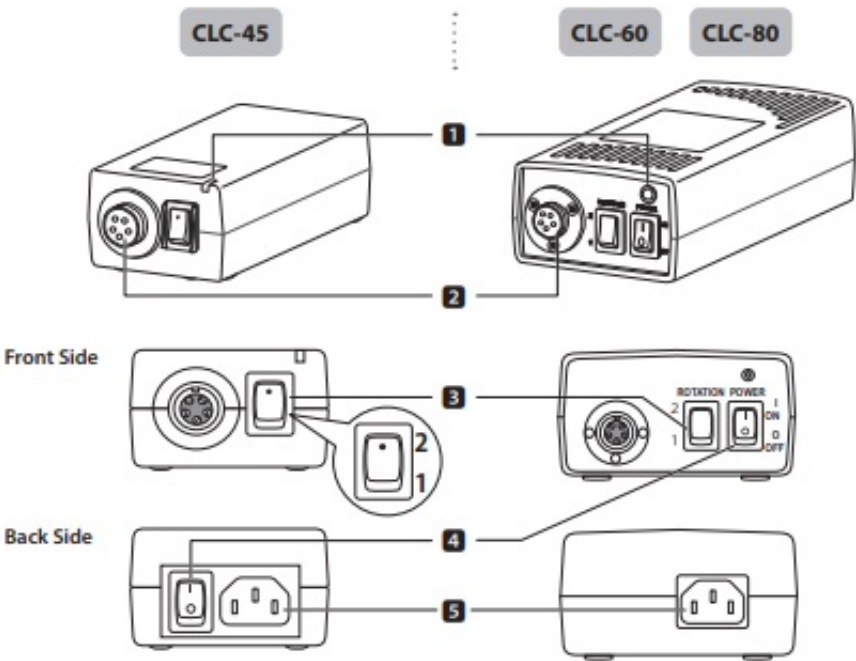

1. **Power Indicator:** Lights up when the power switch is turned ON.
2. **Connector for the Screwdriver:** Connect the screwdriver cord.
3. **DC Output Switch:** 2 (HI: DC30V) / 1 (LOW: DC20V)

- **Power Switch:** Turns the power ON or
- **Connector for AC Cord:** Connect the power

Compatible Screwdrivers (Including OPC/SS Type)

CLC-45

Series                      Model

CL	CL-2000/CL-3000/CL-4000/CL-6000/CL-6500
SS	SS-2000/SS-3000/SS-4000/SS-6500
$\alpha$	$\alpha$ -4500/ $\alpha$ -5000

### CLC-60

Series

Model

CL	CL-2000/CL-3000/CL-4000/CL-6000/CL-6500/CL-7000
SS	SS-2000/SS-3000/SS-4000/SS-6500/SS-7000
$\alpha$	$\alpha$ -4500/ $\alpha$ -5000/ $\alpha$ -6500

### CLC-80

Series

Model

CL	CL-9000NL
----	-----------

### Attach the Mounting Bracket

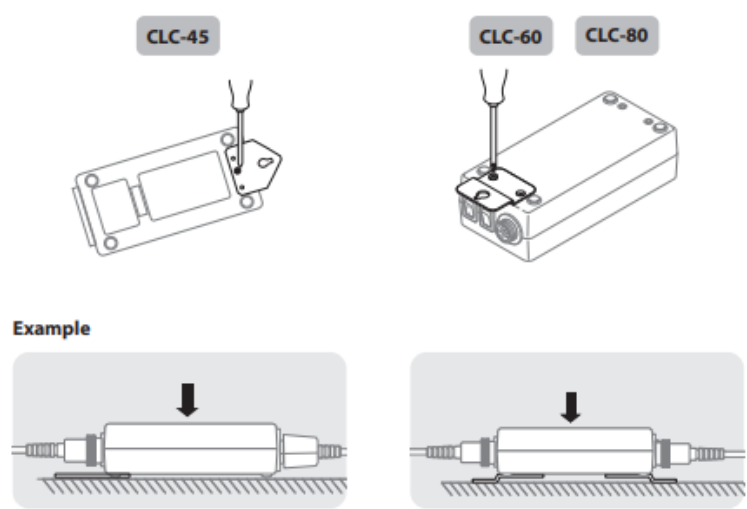

### Specifications

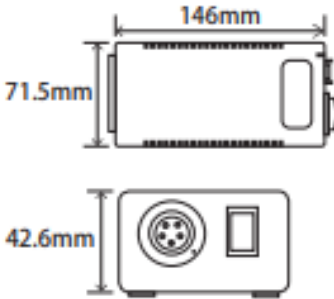
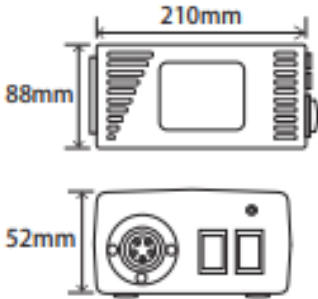
Model Name		CLC-45	CLC-60
Primary Side	Input Voltage	AC100-240V (47-63Hz)	
	Power Consumption	45-78VA Fuse capacity: 3.15A/250V (Built-in)	40-65VA Fuse capacity: 5A/250V (Built-in)
Secondary Output Voltage		HI(2): DC30V / LOW(1): DC20V (2-step switchable)	
External Dimensions			
Weight		330g	715g
Number of Connectable Screwdrivers		1 unit	

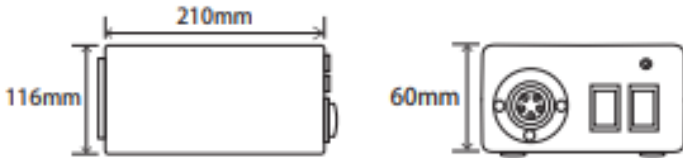
Model Name		CLC-80	
Primary Side	Input Voltage	AC100-240V (47-63Hz)	
	Power Consumption	T5A/250V	
Secondary Output Voltage		HI(2): DC30V / LOW(1): DC20V (2-step switchable)	
External Dimensions			
Weight		1.4kg	
Number of Connectable Screwdrivers		1 unit	

**HIOS Inc.**

1-35-1 Oshiage, Sumida-ku Tokyo, Japan

***Read More About This Manual & Download PDF:***

**Documents / Resources**

