



[Home](#) » [HINKLEY](#) » **HINKLEY 15540 Aura Path Light Installation Guide** 

Contents [hide](#)

[1 HINKLEY 15540 Aura Path Light](#)

[2 Specifications](#)

[3 Product Usage Instructions](#)

[4 AURA PATH LIGHT](#)

[5 LED replacement](#)

[6 Typical Ground Stake Mounting](#)

[7 LED replacement](#)

[8 FAQs](#)

[9 Documents / Resources](#)

[9.1 References](#)

HINKLEY

HINKLEY 15540 Aura Path Light



Specifications

- Product: HINKLEY AURA PATH LIGHT
- Item No: 15540
- Designed for use with Hinkley-approved 12-volt landscape systems.

Product Usage Instructions

1. Find a clear area in which you can work.
2. Unpack the fixture and glass from the carton.
3. Carefully review instructions before assembly.

SAVE THESE INSTRUCTIONS

Note: This Luminaire is designed for use with Hinkley-approved 12-volt landscape systems.

4. Connection to other systems may cause premature Failure or unintended operation.

AURA PATH LIGHT

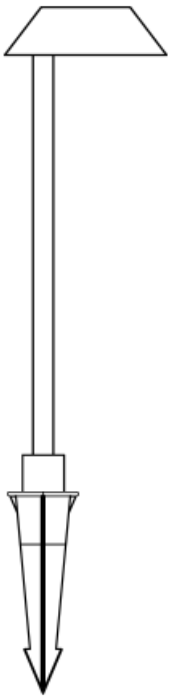

LED replacement

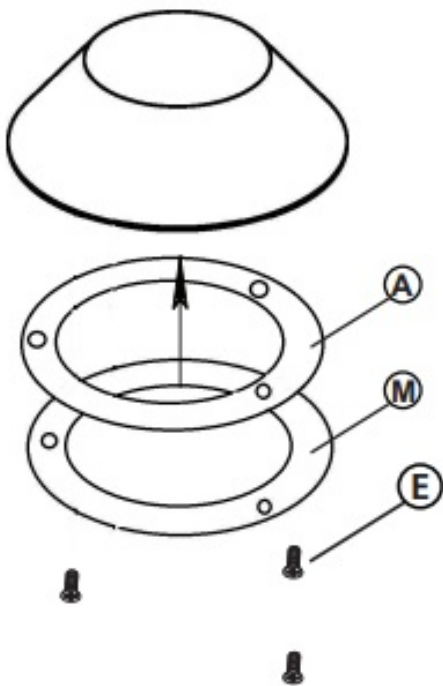

Typical Ground Stake Mounting

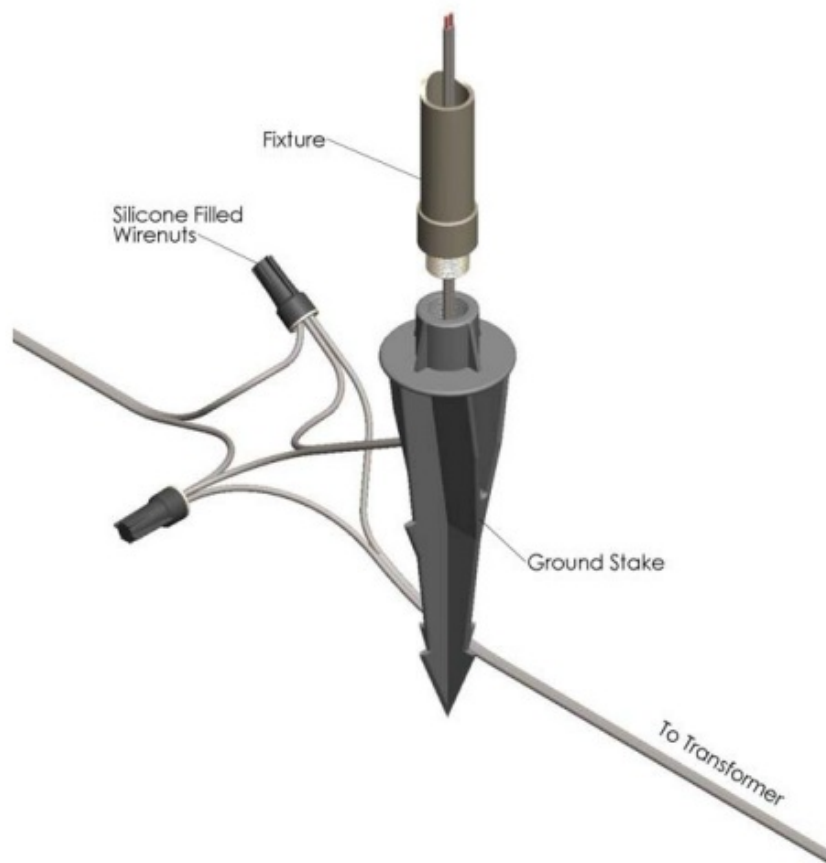

LUMINAIRE MOUNTING: (for typical ground stake mounting)

1. To prevent electrical shock, disconnect the transformer from the electrical supply before installation or service.
2. Run wire from the Luminaire through the mounting hole in the top of the ground stake.
3. Attach the Luminaire to the ground stake by threading it into the mounting hole in the stake until it fits snugly against the bottom of the stem.
4. Place a stake in the desired position and insert it into the ground until the flange of the stake is flush with the ground.
5. Strip the two wire leads from the Luminaire and connect to the main supply wire using the provided silicone-filled wirenut.
6. Silicone-filled nuts are intended for one-time use. Wire Nut Capacity -2 pcs 18 AWG 2 pcs 12 AWG

The main low-voltage cable from the Luminaire is to be:

1. Protected by routing near the luminaire or fitting, or next to a building a structure

such as a house or deck.

2. The main secondary wire is intended for shallow burial, less than 6 inches (15.2cm) – to connect to the main low-voltage cable 3.
3. Have the length cut off so that it is connected to a connector within 6 inches (15.2cm) from a building structure, a luminaire or fitting.

LED replacement

1. Power of fixtures
2. Remove acyclic ring (A) and middle ring (M) using screws (E)
3. Remove stem screws
4. Remove the failed LED
5. Replace the failed LED with a new LED
6. Replace stem screws
7. Next re-secure acyclic ring (A) and middle ring (M) using screws (E)
8. Restore power to the fixture

HINKLEY 33000 Pin Oak Parkway, Avon Lake, OH
44012 800.446.5539 / 440.653.5500 hinkley.com

FAQS

Q: Can this product be used with systems other than Hinkley Approved 12-volt landscape systems?

A: No, connecting this product to other systems may cause premature failure or unintended operation.

Documents / Resources

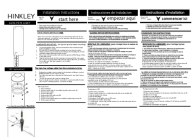

[HINKLEY 15540 Aura Path Light \[pdf\]](#) Installation Guide

15540 Aura Path Light, 15540, Aura Path Light, Path
Light

References

- [H HINKLEY](#)
- [User Manual](#)

■ [HINKLEY](#) ♦ [15540](#), [15540 Aura Path Light](#), [Aura Path Light](#), [HINKLEY](#), [Path Light](#)

[Previous Post](#)

[HINKLEY 903352FCW-NWA 52 inch Metro Indoor Fan Instruction Manual](#)

[Next Post](#)

[HINKLEY 15542OZ Lakehouse Path Light Installation Guide](#)

Leave a comment

Your email address will not be published. Required fields are marked *

Comment *

Name

Email

Website

☐ Save my name, email, and website in this browser for the next time I comment.

Post Comment

[Manuals+](#), [Privacy Policy](#) | [@manuals.plus](#) | [YouTube](#)

This website is an independent publication and is neither affiliated with nor endorsed by any of the trademark owners. The "Bluetooth®" word mark and logos are registered trademarks owned by Bluetooth SIG, Inc. The "Wi-Fi®" word mark and logos are registered trademarks owned by the Wi-Fi Alliance. Any use of these marks on this website does not imply any affiliation with or endorsement.