



HINKLEY 1518CD-LL Atlantis Cedar Linear LED Path Light Instruction Manual

[Home](#) » [HINKLEY](#) » HINKLEY 1518CD-LL Atlantis Cedar Linear LED Path Light Instruction Manual 

HINKLEY

Installation Instructions

Family: Atlantis

Item No. 1518CD -LL

Contents

- [1 1518CD-LL Atlantis Cedar Linear LED Path Light](#)
- [2 Cedar Maintenance for CD finish](#)
- [3 Glass and Bulb Installation](#)
- [4 Documents / Resources](#)
- [5 Related Posts](#)

1518CD-LL Atlantis Cedar Linear LED Path Light

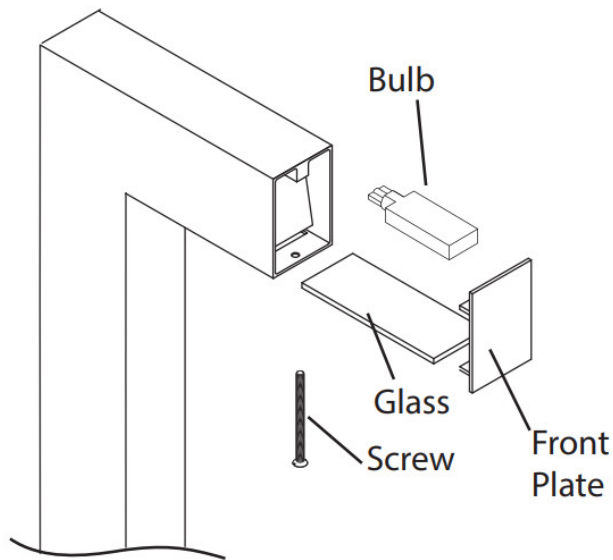

Note: cedar finish requires different care. Please use the below instructions for cedar maintenance.

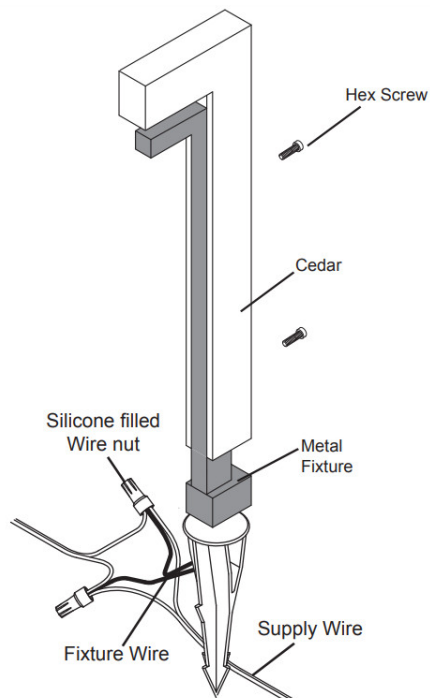

Cedar Maintenance for CD finish

Note: A thin clear coat, non-UV inhibiting lacquer was applied at the factory to minimize naturally occurring color change prior to installation. You may maintain the wood in any means typical for a cedar deck.

In order to maintain the cedar, remove the cedar from the fixture.

1. Unscrew the two hex screws from the back of the fixture
2. Slide the cedar up and off of the metal fixture.

Glass and Bulb Installation

1. With a Phillips screw driver, remove flat head screw on the underside of the fixture.
2. Remove the front plate.
3. Insert the bulb into the socket.
4. Slide the glass in the glass track at the back of the fixture.

5. Once the glass is in place, re-assemble the front plate and screw.

Luminaire Mounting

(For typical ground spike mounting)

1. To prevent electrical shock, disconnect the transformer from the electrical supply before installation or service.
2. Run wire from luminaire through mounting hole in the top of the ground spike.
3. Attach luminaire to ground spike by threading to mounting hole in spike and locking it in place.
4. Place spike in desired position and insert into ground until the angle of spike is flush with ground.
5. Strip the two wire leads from the luminaire and connect to the main supply wire using the provided silicone filled wire nut.

Note: Wire is to be protected by routing in close proximity to the luminaire or fitting or next to a building structure such as a house or deck. Wiring should be buried a maximum of 6 inches (15.2 cm) in order to connect to main supply wire. The main supply wire must have its length cut off within 6 inches (15.2 cm) from a building structure, a luminaire or fitting.

Bulb specifications	
Power	1.5W
Lumens	150
Voltage	12V/DC
CRI	90+
Temperature	2700 K

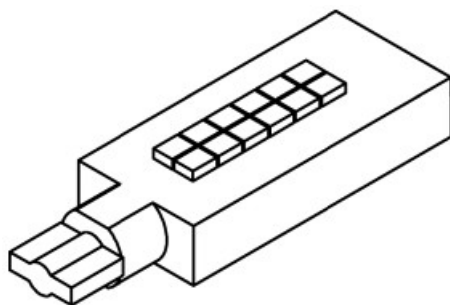

HINKLEY

33000 Pin Oak Parkway
Avon Lake, OH 44012
(p)800.446.5539 / (f) 440.653.5555
www.hinkley.com

Documents / Resources

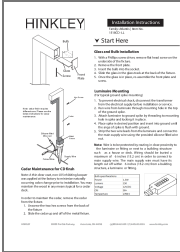

[HINKLEY 1518CD-LL Atlantis Cedar Linear LED Path Light](#) [pdf] Instruction Manual
1518CD-LL Atlantis Cedar Linear LED Path Light, 1518CD-LL, Atlantis Cedar Linear LED Path
Light, Cedar Linear LED Path Light, LED Path Light, Path Light, Light