

HILTI
HILTI SPN 622 (02)
Cordless Nibbler



HILTI SPN 622 (02) Cordless Nibbler Installation Guide

[Home](#) » [HILTI](#) » HILTI SPN 622 (02) Cordless Nibbler Installation Guide 

Contents

- 1 [HILTI SPN 622 \(02\) Cordless Nibbler](#)
- 2 [Product Information](#)
- 3 [Product Usage Instructions](#)
- 4 [Information about the operating instructions](#)
- 5 [Explanation of symbols](#)
- 6 [Safety](#)
- 7 [Description](#)
- 8 [Status indicators of the Liion battery](#)
- 9 [Technical data](#)
- 10 [Accessory tools](#)
- 11 [Installing the accessory tool](#)
- 12 [Care and maintenance](#)
- 13 [Checking die, punch guide and wear plate](#)
- 14 [Transport and storage of cordless tools and batteries](#)
- 15 [Troubleshooting](#)
- 16 [Disposal](#)
- 17 [Documents / Resources](#)
 - 17.1 [References](#)
- 18 [Related Posts](#)



HILTI SPN 622 (02) Cordless Nibbler



Specifications:

- Model: SPN 622 (02)
- Language: English

Product Information

The SPN 622 (02) is a professional-grade product designed for trained and authorized personnel. It is equipped with various safety features to ensure safe operation.

Product Usage Instructions

Safety Precautions:

Before using the product, familiarize yourself with all safety warnings provided in the manual. Failure to do so may result in electric shock, fire, or serious injury.

Operating Instructions:

Follow the detailed operating instructions provided in the manual to ensure proper usage of the product. Always adhere to the intended use guidelines to prevent hazards.

Symbol Explanation:

Pay attention to the symbols used in the operating instructions and illustrations. Symbols like DANGER, WARNING, and CAUTION indicate different levels of potential hazards.

Product Care:

Avoid dropping the product or using it in ways not specified in the manual. Always handle the Li-ion battery with care and ensure it is not damaged.

NFC Technology:

The product supports near-field communication (NFC) technology compatible with iOS and Android platforms. Ensure compatibility for enhanced functionality.

FAQ:

- **Q: Who is permitted to operate the product?**

A: Only trained and authorized personnel should operate, service, and maintain the product due to potential hazards.



- **Q: What do the symbols like DANGER, WARNING, and CAUTION indicate?**

A: These symbols alert users to different levels of potential hazards associated with handling or using the

product.

Information about the operating instructions

About these operating instructions

- **Warning!** Read and understand all accompanying documentation, including but not limited to instructions, safety warnings, illustrations, and specifications provided with this product. Familiarize yourself with all the instructions, safety warnings, illustrations, specifications, components, and functions of the product before use. Failure to do so may result in electric shock, fire, and/or serious injury. Save all warnings and instructions for future reference.
-  products are designed for professional users and only trained, authorized personnel are permitted to operate, service and maintain the products. This personnel must be specifically informed about the possible hazards. The product and its ancillary equipment can present hazards if used incorrectly by untrained personnel or if used not in accordance with the intended use.
- The accompanying documentation corresponds to the current state of the art at the time of printing. Please always check for the latest version on the product's page on Hilti's website. To do this, follow the link or scan the QR code in this documentation, marked with the symbol .
- Ensure that these operating instructions are with the product when it is given to other persons.

Explanation of symbols

Warnings

Warnings alert persons to hazards that occur when handling or using the product.

The following signal words are used:



DANGER
DANGER !

- Draws attention to imminent danger that will lead to serious personal injury or fatality.



WARNING
WARNING !

- Draws attention to a potential threat of danger that can lead to serious injury or fatality.









CAUTION
CAUTION !

- Draws attention to a potentially dangerous situation that could lead to personal injury or damage to the equipment or other property.



Symbols in the operating instructions

The following symbols are used in these operating instructions:

	Comply with the operating instructions
	Instructions for use and other useful information
	Dealing with recyclable materials
	Do not dispose of electric equipment and batteries as household waste
	Hilti Li-ion battery
	Hilti charger

Symbols in illustrations

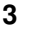







The following symbols are used in illustrations:

	These numbers refer to the illustrations at the beginning of these operating instructions.
	The numbering reflects the sequence of operations shown in the illustrations and may deviate from the steps described in the text.
	Item reference numbers are used in the overview illustration and refer to the numbers used in the key in the product overview section.
	These characters are intended to specifically draw your attention to certain points when handling the product.

Product-dependent symbols

Symbols on the product

The following symbols can be used on the product:

	The product supports near-field communication (NFC) technology compatible with iOS and Android platforms.
	Wear eye protection
	Always work with both hands.
	Direct current (DC)
Li-Ion	Li-ion battery
	Never use the battery as a striking tool.
	Do not drop the battery. Never use a battery that has suffered an impact or is damaged in any other way.
	Hilti Li-ion battery type series used. Observe the information given in the section headed Intended use .
	If applied on the product, the product has been certified by this certification body for the US and Canadian markets according to the applicable standards.

Safety

General power tool safety warnings

WARNING

Read all safety warnings, instructions, illustrations and specifications provided with this power tool. Failure to follow all instructions listed below may result in electric shock, fire and/or serious injury. Save all warnings and instructions for future reference. The term “power tool” in the warnings refers to your mains-operated (corded) power tool or battery-operated (cordless) power tool.

Work area safety

- Keep work area clean and well lit. Cluttered or dark areas invite accidents.
- Do not operate power tools in explosive atmospheres, such as in the presence of flammable liquids, gases or dust. Power tools create sparks which may ignite the dust or fumes.
- Keep children and bystanders away while operating a power tool. Distractions can cause you to lose control.

Electrical safety

- Power tool plugs must match the outlet. Never modify the plug in any way. Do not use any adapter plugs with earthed (grounded) power tools. Unmodified plugs and matching outlets will reduce risk of electric shock.
- Avoid body contact with earthed or grounded surfaces, such as pipes, radiators, ranges and refrigerators. There is an increased risk of electric shock if your body is earthed or grounded.
- Do not expose power tools to rain or wet conditions. Water entering a power tool will increase the risk of electric shock.
- Do not abuse the cord. Never use the cord for carrying, pulling or unplugging the power tool. Keep cord away from heat, oil, sharp edges or moving parts. Damaged or entangled cords increase the risk of electric shock.
- When operating a power tool outdoors, use an extension cord suitable for outdoor use. Use of a cord suitable for outdoor use reduces the risk of electric shock.
- If operating a power tool in a damp location is unavoidable, use a residual current device (RCD) protected supply. Use of an RCD reduces the risk of electric shock.

Personal safety

- Stay alert, watch what you are doing and use common sense when operating a power tool. Do not use a power tool while you are tired or under the influence of drugs, alcohol or medication. A moment of inattention while operating power tools may result in serious personal injury.
- Use personal protective equipment. Always wear eye protection. Protective equipment such as a dust mask, non-skid safety shoes, hard hat or hearing protection used for appropriate conditions will reduce personal injuries.
- Prevent unintentional starting. Ensure the switch is in the off-position before connecting to power source and/or battery pack, picking up or carrying the tool. Carrying power tools with your finger on the switch or energizing power tools that have the switch on invites accidents.
- Remove any adjusting key or wrench before turning the power tool on. A wrench or a key left attached to a rotating part of the power tool may result in personal injury.
- Do not overreach. Keep proper footing and balance at all times. This enables better control of the power tool in unexpected situations.
- Dress properly. Do not wear loose clothing or jewellery. Keep your hair and clothing away from moving parts. Loose clothes, jewellery or long hair can be caught in moving parts.
- If devices are provided for the connection of dust extraction and collection facilities, ensure these are connected and properly used. Use of dust collection can reduce dust-related hazards.
- Do not let familiarity gained from frequent use of tools allow you to become complacent and ignore tool safety principles. A careless action can cause severe injury within a fraction of a second.

Power tool use and care

- Do not force the power tool. Use the correct power tool for your application. The correct power tool will do the job better and safer at the rate for which it was designed.
- Do not use the power tool if the switch does not turn it on and off. Any power tool that cannot be controlled with the switch is dangerous and must be repaired.
- Disconnect the plug from the power source and/or remove the battery pack, if detachable, from the power tool before making any adjustments, changing accessories, or storing power tools. Such preventive safety measures reduce the risk of starting the power tool accidentally.
- Store idle power tools out of the reach of children and do not allow persons unfamiliar with the power tool or these instructions to operate the power tool. Power tools are dangerous in the hands of untrained users.
- Maintain power tools and accessories. Check for misalignment or binding of moving parts, breakage of parts and any other condition that may affect the power tool's operation. If damaged, have the power tool repaired before use. Many accidents are caused by poorly maintained power tools.
- Keep cutting tools sharp and clean. Properly maintained cutting tools with sharp cutting edges are less likely to bind and are easier to control.
- Use the power tool, accessories and tool bits etc. in accordance with these instructions, taking into account the working conditions and the work to be performed. Use of the power tool for operations different from those intended could result in a hazardous situation.
- Keep handles and grasping surfaces dry, clean and free from oil and grease. Slippery handles and grasping surfaces do not allow for safe handling and control of the tool in unexpected situations.

Battery tool use and care

- Recharge only with the charger specified by the manufacturer. A charger that is suitable for one type of battery pack may create a risk of fire when used with another battery pack.
- Use power tools only with specifically designated battery packs. Use of any other battery packs may create a risk of injury and fire.
- When battery pack is not in use, keep it away from other metal objects, like paper clips, coins, keys, nails, screws or other small metal objects, that can make a connection from one terminal to another. Shorting the battery terminals together may cause burns or a fire.
- Under abusive conditions, liquid may be ejected from the battery; avoid contact. If contact accidentally occurs, flush with water. If liquid contacts eyes, additionally seek medical help. Liquid ejected from the battery may cause irritation or burns.
- Do not use a battery pack or tool that is damaged or modified. Damaged or modified batteries may exhibit unpredictable behaviour resulting in fire, explosion or risk of injury.
- Do not expose a battery pack or tool to fire or excessive temperature. Exposure to fire or temperature above 130° C (265 °F) may cause explosion.
- Follow all charging instructions and do not charge the battery pack or tool outside the temperature range specified in the instructions. Charging improperly or at temperatures outside the specified range may damage the battery and increase the risk of fire.

Service

- Have your power tool serviced by a qualified repair person using only identical replacement parts. This will ensure that the safety of the power tool is maintained.
- Never service damaged battery packs. Service of battery packs should only be performed by the manufacturer or authorized service providers.

Additional safety instructions

Personal safety

- Use the product and accessories only when they are in perfect working order.
- Never tamper with or modify the product or accessories in any way.
- Dust produced by grinding, sanding, cutting and drilling can contain dangerous chemicals. Some examples are: lead or lead-based paints; brick, concrete and other masonry products, natural stone and other products containing silicates; certain types of wood, such as oak, beech and chemically treated wood; asbestos or materials that contain asbestos. Determine the exposure of the operator and bystanders by means of the hazard classification of the materials to be worked. Implement the necessary measures to restrict exposure to a safe level, for example by the use of a dust collection system or by the wearing of suitable respiratory protection. The general measures for reducing exposure include:
 - working in an area that is well ventilated,
 - avoidance of prolonged contact with dust,
 - directing dust away from the face and body,

- wearing protective clothing and washing exposed areas of the skin with water and soap.
- Wear protective gloves when working with the product. The accessory tool runs hot when in use and there is a risk of burn injury. The cut edges and metal swarf are sharp-edged and there is a risk of cut injuries.
- Wear protective gloves also when changing the accessory tool. Touching the accessory tool presents a risk of injury (cuts or burns).
- Take frequent breaks and do physical exercises to improve the blood circulation in your fingers. High vibration during long periods of work can lead to disorders of the blood vessels and nervous system in the fingers, hands and wrists.
- Wear eye protection, a hard hat and ear protection while the product is in use.
- Switch the product on only after you have brought it to the working position.
- Wait until the product has come to a complete stop before you lay it down.
- Do not work overhead with the product.
- Risk of injury by falling tools and/or accessories. Before starting work, check that the battery and installed accessories are secure.
- Do not secure a belt hook to this power tool.
- Keep the air vents clear at all times. Risk of burn injuries due to blocked air vents!

Electrical safety

- Have dirtied or dusty products that are used frequently for working on conductive materials checked at regular intervals by Hilti Service. Dust, especially dust from conductive materials, or dampness on the surface of the product can, under unfavorable conditions, lead to electric shock.
- Clean the ventilation slots on the power tool at regular intervals. The motor's fan will draw dust inside the housing and an excessive accumulation of metal dust may cause electrical hazards.
- Before beginning work, check the working area (e.g. using a metal detector) to ensure that no concealed electric cables or gas and water pipes are present. External metal parts of the product can become live, for example if you inadvertently damage electric wiring.
- Do not attempt to cut workpieces that could be electrically live.

Work area safety

- Keep the work area clean and tidy. Metal swarf is sharp and can scratch the floor surface. Careful handling and use of electric tools
- Make sure that there is no swarf or dirt on the product. When working, make sure that no swarf makes its way into the area of the on/off switch. The swarf could block the on/off switch, rendering it impossible to switch the product off.

Careful handling and use of batteries

- Comply with the following safety instructions for the safe handling and use of Li-ion batteries. Failure to comply can lead to skin irritation, severe corrosive injury, chemical burns, fire and/or explosion.
- Use only batteries that are in perfect working order.
- Treat batteries with care in order to avoid damage and prevent leakage of fluids that are extremely harmful to health!

- Do not under any circumstances modify or tamper with batteries!
- Do not disassemble, crush or incinerate batteries and do not subject them to temperatures over 80 °C (176 °F).
- Never use or charge a battery that has suffered an impact or been damaged in any other way. Check your batteries regularly for signs of damage.
- Never use recycled or repaired batteries.
- Never use the battery or a battery-operated power tool as a striking tool.
- Never expose batteries to the direct rays of the sun, elevated temperature, sparking, or open flame. This can lead to explosions.
- Do not touch the battery poles with your fingers, tools, jewelry, or other electrically conductive objects. This can damage the battery and also cause material damage and personal injury.
- Keep batteries away from rain, moisture and liquids. Penetrating moisture can cause short circuits, electric shock, burns, fire and explosions.
- Use only chargers and power tools approved for the specific battery type. Read and follow the relevant operating instructions.
- Do not use or store the battery in explosive environments.
- If the battery is too hot to touch, it may be defective. Put the battery in a place where it is clearly visible and where there is no risk of fire, at an adequate distance from flammable materials. Allow the battery to cool down. If it is still too hot to touch after an hour, the battery is faulty. Consult Hilti Service or read the document entitled "Instructions on safety and use for Hilti Li-ion batteries".

Observe the special guidelines applicable to the transport, storage and use of lithium-ion batteries.

Read the instructions on safety and use of Hilti Li-ion batteries that you can access by scanning the QR code at the end of these operating instructions.

Description

Product overview

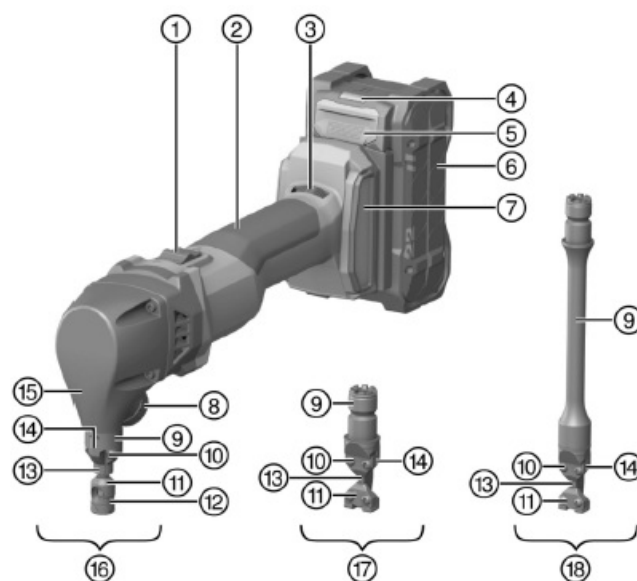

1. Lockable on/off switch
2. Grip
3. Adjusting knob for speed

4. Battery status indicator
5. Battery release button
6. Battery
7. Dust filter
8. Indexing pin
9. Die carrier
10. Securing screws
11. Die
12. Cover ring
13. Punch
14. Punch guide
15. Casing
16. Accessory tool, SPN-CN
17. Accessory tool, SPN-RN
18. Accessory tool, SPN-RL

Intended use

The product described is a hand-held cordless nibbler. It is designed for cutting sheet-like workpieces out of punchable materials such as steel, aluminum, non-ferrous metal and plastic, for nibbling straight or curved outside edges and cut-outs and for nibbling along marked lines of cut. The nibbling process produces distortion-free cut edges. Other applications are possible as well, depending on the accessory tool used.

- SPN-CN: This accessory tool is also designed for cutting pipes, nibbling corrugated metal and nibbling with a template. The hollow round punch enables the nibbler to be rotated about its own axis so that nibbling can proceed in any direction.
- SPN-RN and SPN-RL: These accessory tools are also designed for cutting sheet metal profiles such as trapezoidal sheet metal, corrugated sheet metal, box-section sheet metal and angled moldings.
- For this product, use only Hilti Nuron lithium-ion batteries of the B 22 series. For optimum performance, Hilti recommends the batteries stated in the table at the end of these operating instructions for this product.
- For these batteries, use only Hilti chargers of the type series stated in the table at the end of these operating instructions.

Items supplied

Nibbler, Torx wrench, operating instructions

- To help ensure safe and reliable operation, use only genuine Hilti spare parts and consumables. Spare parts, consumables and accessories approved by Hilti for use with the product can be found at your local Hilti Store or online at: www.hilti.group
- Before being dispatched, the product was tested to ensure that it is in full working order. The workpiece used in testing might have left tiny scratches in the surface of the housing.

Temperature-dependent motor protection

The temperature-dependent motor protection system monitors current input and motor temperature and thus prevents the power tool over heating. If the motor is overloaded through application of excessive working pressure, the product's performance drops noticeably or it might stall completely. If the product stalls or slows significantly due to overloading, relieve the pressure applied to the product and then allow it to run under no load

for approx. 30 seconds.

Status indicators of the Liion battery

Hilti Nuron Li-ion batteries can indicate state of charge, fault messages and the battery's state of health.

Indicators for state of charge and fault messages

WARNING

Risk of injury by a falling battery!

- If the release button is pressed with a battery inserted in the product, subsequently check that the battery is correctly re-engaged and secure.

Short-press the release button of the battery to get whichever of the following status indications is applicable at the time. State of charge and, if applicable, faults are indicated constantly as long as the connected product is switched on.

Status	Meaning
Four (4) LEDs show constantly green	State of charge: 100 % to 71 %
Three (3) LEDs show constantly green	State of charge: 70 % to 51 %
Two (2) LEDs show constantly green	State of charge: 50 % to 26 %
One (1) LED shows constantly green	State of charge: 25 % to 10 %
One (1) LED slow-flashes green	State of charge: < 10 %
One (1) LED quick-flashes green	The Li-ion battery is completely discharged. Recharge the battery.If the LED again starts quick-flashing after the battery has been charged, consult Hilti Service.
One (1) LED quick-flashes yellow	The Li-ion battery or the product in which it is inserted is overloaded, too hot or too cold, or experiencing some other fault. Bring the product and the battery to the recommended working temperature and do not overload the product when it is in use.If the message persists, consult Hilti Service.
One (1) LED shows yellow	The Li-ion battery and the product in which it is inserted are not compatible. Consult Hilti Service.
One (1) LED quick-flashes red	The Li-ion battery is locked and cannot be used. Consult Hilti Service.

Indicators showing the battery's state of health

To check the battery's state of health, press the release button and hold it down for longer than three seconds. The system does not detect a potential malfunction of the battery due to misuse, for example battery dropped or pierced, external heat damage, etc.

Status	Meaning
All LEDs show in sequence, followed by one (1) LED showing constantly green.	The battery can remain in use.
All LEDs show in sequence, followed by one (1) LED quick-flashing yellow.	The check to ascertain the battery's state of health did not complete. Repeat the procedure, or consult Hilti Service.
All LEDs show in sequence, followed by one (1) LED showing constantly red.	If a connected product can still be used, the remaining battery capacity is below 50 %. If a connected product can no longer be used, the battery has reached the end of its useful life and has to be replaced. Consult Hilti Service.

Technical data

The nibbler comes with the SPNCN, SPNRN or SPNRL accessory tool as standard. The individual accessory tools are also available as optional accessories and are compatible with every as-delivered version of the power tool.

	SPN 6-22		
	SPNCN	SPNRN	SPNRL
Product generation	02	02	02
Rated voltage	21.6 V	21.6 V	21.6 V
Weight without battery	2 kg (4 lb)	2 kg (4 lb)	2.2 kg (4.9 lb)
Stroke rate at idle speed	620 /min ... 1,370 /min	620 /min ... 1,370 /min	620 /min ... 1,370 /min
Starting hole diameter	17 mm (0.7 in)	24 mm (0.9 in)	24 mm (0.9 in)
Smallest radius for curved cut- outs	4.0 mm (0.16 in)	•/•	•/•
Radius	•/•	50 mm (2.0 in)	50 mm (2.0 in)
Cutting track width	8.0 mm (0.31 in)	5.0 mm (0.20 in)	5.0 mm (0.20 in)
Permissible steel thickness, steel up to 400 N/mm ²	2.0 mm / 14 ga(0.08 in / 14 ga)	2.0 mm / 14 ga(0.08 in / 14 ga)	2.0 mm / 14 ga(0.08 in / 14 ga)
Permissible steel thickness, steel up to 600 N/mm ²	1.5 mm / 16 ga(0.06 in / 16 ga)	1.5 mm / 16 ga(0.06 in / 16 ga)	1.5 mm / 16 ga(0.06 in / 16 ga)
Permissible steel thickness, steel up to 800 N/mm ²	1.0 mm / 20 ga(0.04 in / 20 ga)	1.0 mm / 20 ga(0.04 in / 20 ga)	1.0 mm / 20 ga(0.04 in / 20 ga)
Permissible material thickness, aluminum up to 250 N/mm ²	2.5 mm / 10 ga(0.10 in / 10 ga)	3.0 mm / 9 ga(0.12 in / 9 ga)	3.0 mm / 9 ga(0.12 in / 9 ga)

Battery

Battery operating voltage	21.6 V
Weight, battery	See the end of these operating instructions
Ambient temperature for operation	−17 °C ... 60 °C (1 °F ... 140 °F)
Storage temperature	−20 °C ... 40 °C (−4 °F ... 104 °F)
Battery charging starting temperature	−10 °C ... 45 °C (14 °F ... 113 °F)

Preparations at the workplace

WARNING

Risk of injury by inadvertent starting!

- Before inserting the battery, make sure that the product is switched off.
- Remove the battery before making any adjustments to the power tool or before changing accessories.

Observe the safety instructions and warnings in this documentation and on the product.

Charging the battery

1. Before charging the battery, read the operating instructions for the charger.
2. Make sure that the contacts on the battery and the contacts on the charger are clean and dry.
3. Use an approved charger to charge the battery.

Inserting the battery

WARNING

Risk of injury by short circuit or falling battery!

- Before inserting the battery, make sure that the contacts on the battery and the contacts on the product are free of foreign matter.
- Make sure that the battery always engages correctly.
 1. Charge the battery fully before using it for the first time.
 2. Push the battery into the product until it engages with an audible click.
 3. Check that the battery is seated securely.

Removing the battery

1. Press the battery release button.
2. Remove the battery from the product.

Fall arrest

WARNING

Risk of injury by falling tool and/or accessory!

- Use only the Hilti tool tether recommended for your product.
- Prior to each use, always check the attachment point of the tool tether for possible damage.
- Comply with the national regulations for working at heights.

As drop arrester for this product, use only a combination of the Hilti retaining strap #2293133 and the Hilti tool tether #2261970.

- Secure the retaining strap to the installation openings for accessories. Check that it holds securely.
- Secure one carabiner of the tool tether to the retaining strap and secure the second carabiner to a load-bearing structure. Check that both carabiners hold securely.

- Comply with the operating instructions of the Hilti retaining strap and those of the Hilti tool tether.

Accessory tools

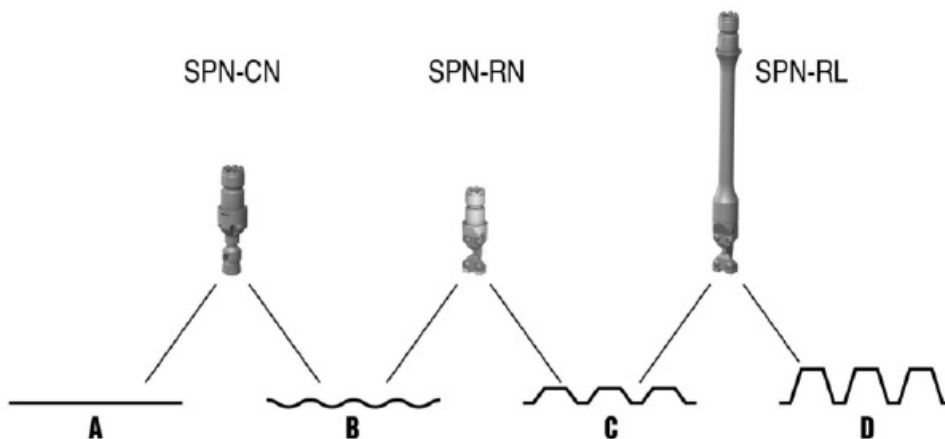

See the illustration for the correct combination of accessory tool and material to be worked.

Explanation of the materials to be worked:

- A: Flat sheet metal
- B: Corrugated sheet metal
- C: Trapezoidal sheet metal (profile depth max. 85 mm)
- D: Trapezoidal sheet metal (profile depth max. 162 mm)

To make burr-free cuts in sheet metal up to 1 mm thick with the SPNRN and SPNRL accessory tools, the P1 die can be used. The smaller cutting clearance reduces the tendency for burrs to form along the cut.

Installing the accessory tool

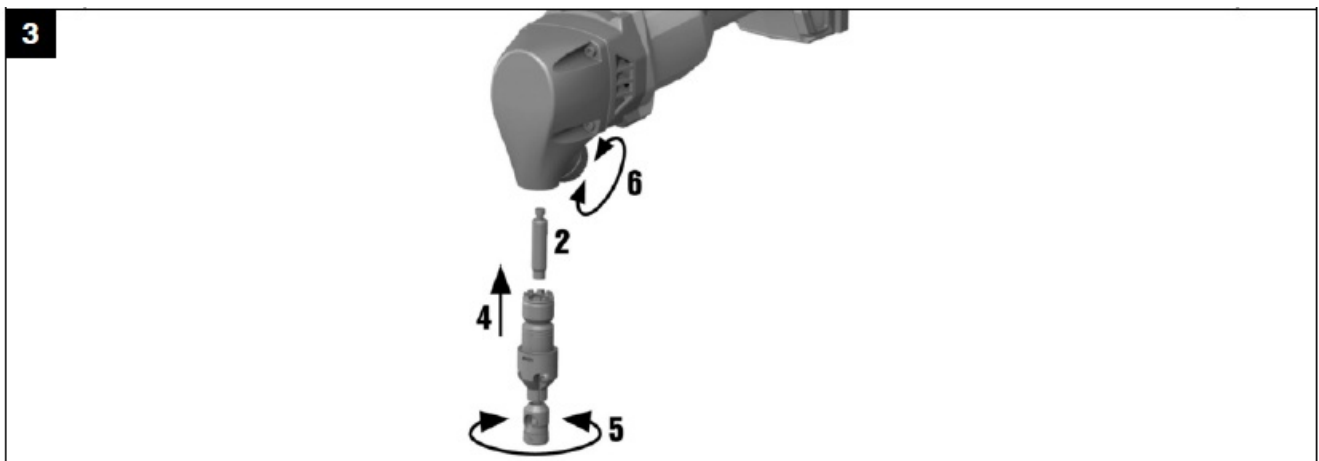

CAUTION

Risk of injury!

The accessory tool may be hot and/or have sharp edges.

- Wear protective gloves when changing the accessory tool.
- Never lay down a hot accessory tool on a flammable surface.

1. Grease the punch guide.
2. Engage the punch in the groove of the pushrod.
3. Hold the accessory tool with the cutting direction facing forward.
4. With the cutting direction facing forward, insert the accessory tool into the housing.
5. Then turn the accessory tool to the desired cutting direction.
6. Turn the indexing pin clockwise and tighten it until hand-tight.
 - Make sure there is no gap between the housing and the die carrier.

Setting the cutting direction

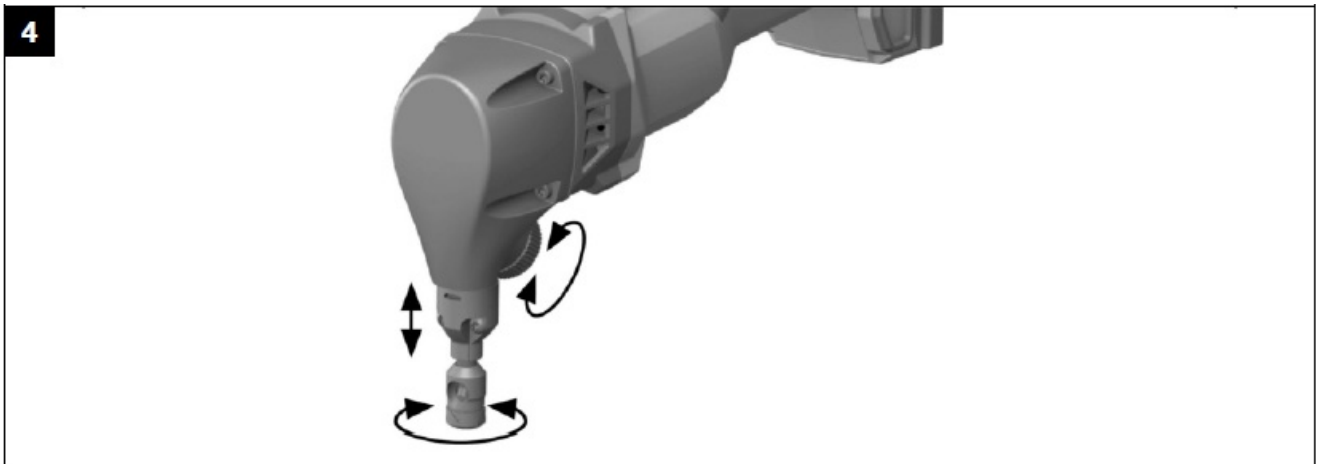

If necessary, the cutting direction can be turned right or left in steps of 45°. This makes cutting profiled sheets easier and it also enables you to set the nibbler for right-hand or left-hand operation.

1. Back off the indexing pin about three full turns counter-clockwise until it no longer indexes.
2. Pull the accessory tool slightly out of the housing and turn it in the desired direction.
 - There are eight possible indexed positions.
3. With the accessory tool in the desired indexed position, press it back into the housing.
4. Turn the indexing pin clockwise and tighten it until hand-tight.
 - Make sure there is no gap between the housing and the die carrier.

Removing the accessory tool

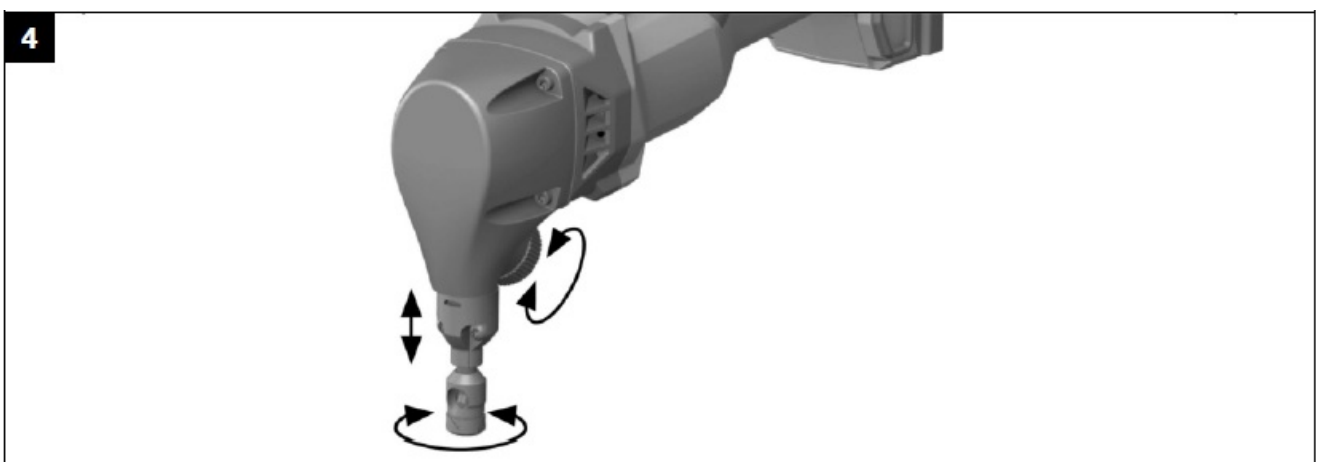

CAUTION

Risk of injury!

The accessory tool may be hot and/or have sharp edges.

- Wear protective gloves when changing the accessory tool.
- Never lay down a hot accessory tool on a flammable surface.
 1. Back off the indexing pin six full turns counter-clockwise.
 2. Remove the accessory tool from the housing.

Adjusting the stroke rate

- Set the stroke rate by turning the adjusting knob for motor speed.

Operation

Observe the safety instructions and warnings in this documentation and on the product.

Switching on

1. Press the rear section of the on/off switch.
2. Slide the on/off switch forward.
 - The motor runs.
3. Lock the on/off switch.

Cutting

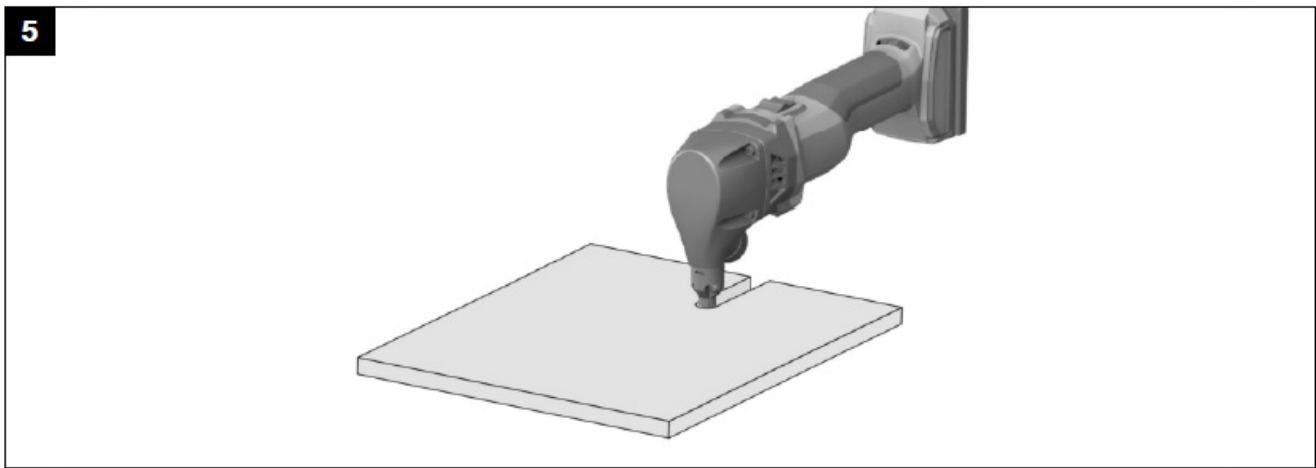

WARNING

Caution

Nibbler overloaded due to blunt accessory tools.

- At regular intervals, check the cutting edge of the punch for wear. Change the punch in good time to minimize the load on the nibbler.
 1. Lightly coat the intended line of the cut with oil to extend the usable life of the punch and improve the result of the cutting operation.
 2. Switch the tool on.
 3. Wait until the tool reaches full speed and bring the nibbler into contact with the workpiece.

- When making a cut-out in a sheet, first cut a starting hole of appropriate size for the accessory tool you are going to use.
4. Cut along the desired line of cut.
 5. When you reach the end of the cut, switch the product off. If the line of cut ends in the workpiece, with the product still switched on pull it a few millimeters back along the line of the cut before switching it off.

Do not lay the nibbler down in the swarf before it has come to a complete stop. Pieces of swarf could be sucked in by the motor.

Cutting with template

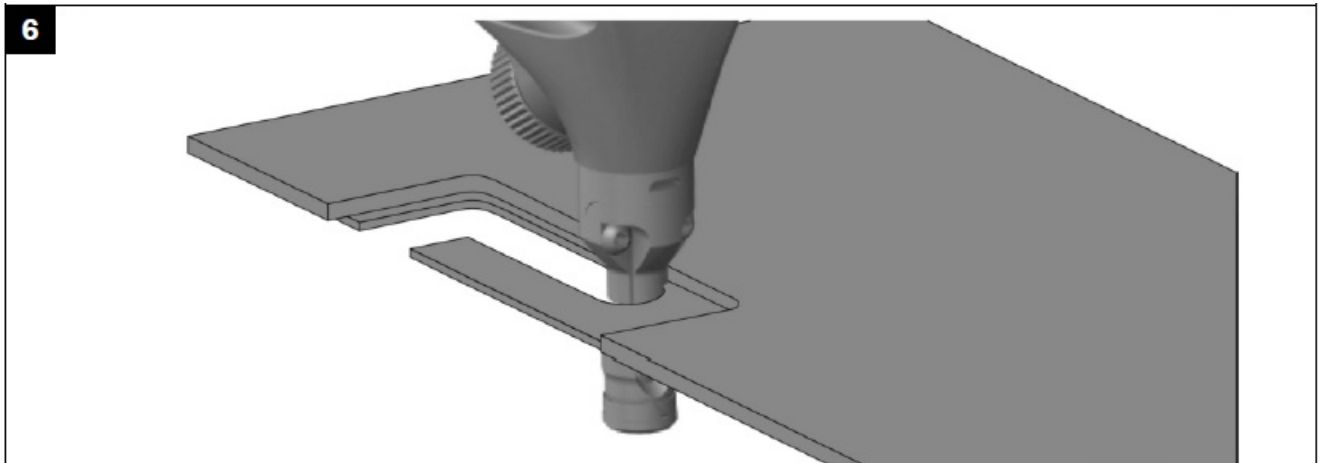

Option: SPNCN

The requirements for cutting with a template are as follows:

- The template must be 5 7 mm thick.
- The contour of the template must be 2.5 mm distant from the contour of the cut.
- Note that the minimum radius is 4 mm. Accordingly, the minimum radius of the template is 6.5 mm.
- Guide the nibbler in such a way that the outside edge of the punch guide is always in contact with the template.

Switching off

- Press the rear section of the on/off switch.
- The on/off switch jumps into the off position and the motor stops.

Optional accessories

Installing the swarf bag



Option: SPNCN

A swarf bag can be installed to catch the pieces of swarf produced by the cutting operation so that they cannot scatter.

1. Squeeze the two ends of the spring in the swarf bag together.
2. Hook the spring round the bottom end of the die and release the ends of the spring.
3. Check that the spring and the swarf bag are correctly seated and secure.

Care and maintenance

WARNING

Risk of injury with battery inserted !

- Always remove the battery before carrying out care and maintenance tasks!

Care of the product

- Carefully remove stubborn dirt.
- Carefully clean the air vents, if present, with a dry, soft brush.
- Use only a slightly damp cloth to clean the housing. Do not use cleaning agents containing silicone as these can attack the plastic parts.
- Use a dry, clean cloth to clean the contacts of the product.

Care of the Li-ion batteries

- Never use a battery with clogged air vents. Clean the air vents carefully using a dry, soft brush.
- Avoid unnecessary exposure of the battery to dust and dirt. Never expose the battery to high levels of moisture (e.g. by being dipped in water or left in the rain).

If a battery has been soaked by moisture, treat it as a damaged battery. Isolate it in a non-flammable container and consult Hilti Service.

- Keep the battery free of extraneous oil and grease. Do not permit dust or dirt to accumulate unnecessarily on the battery. Clean the battery with a dry, soft brush or a clean, dry cloth. Do not use cleaning agents containing silicone as these can attack the plastic parts.

Do not touch the contacts of the battery and do not remove the factory-applied grease from the contacts.

- Use only a slightly damp cloth to clean the housing. Do not use cleaning agents containing silicone as these can attack the plastic parts.

Maintenance

- Check all visible parts and controls for signs of damage at regular intervals and make sure that they all function correctly.
- Do not use the product if signs of damage are found or if parts malfunction. Immediately have the product repaired by Hilti Service.
- After cleaning and maintenance, install all guards and protective devices and check that they are in full working order.

To help ensure safe and reliable operation, use only genuine Hilti spare parts and consumables.

Spare parts, consumables and accessories approved by Hilti for use with your product can be found at your Hilti Store or online at: www.hilti.group

Changing the punch



When changing the punch, also check for wear of the die, punch guide and wear plate (not SPN-CN) and change these components as well, if they are worn.

1. Remove the accessory tool. 10
2. Remove the worn punch from the accessory tool.
3. Grease the new punch and also the punch guide in the accessory tool.
4. If the following equipment exists, also take this action:

Option: SPNRL

- Insert the pushrod extension between the pushrod and the punch and grease it.

5. Install the accessory tool. 10

Changing the die

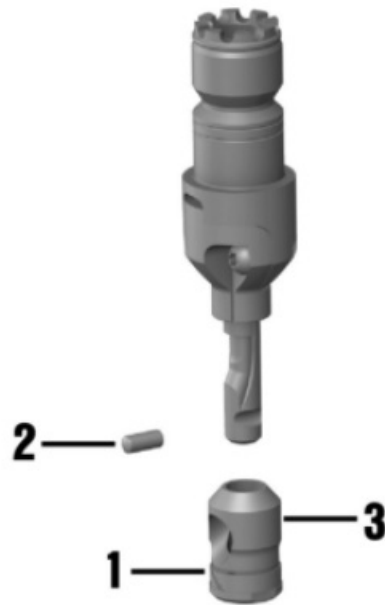

Option: SPNCN

1. Push the cover ring up and out of the groove.
2. Use a suitable punch to push the straight pin out of the hole.
3. Disengage the die from the carrier pin.
4. Position the new die on the carrier pin.
5. Reinstall the straight pin.
6. Push the cover ring down into the groove and check that it is correctly seated.

Changing the punch guide

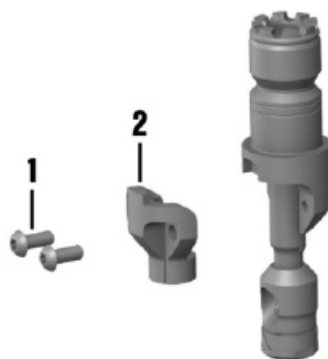

Option: SPNCN

CAUTION

Risk of damage to product and cutting tools!

- Clean the threads before installing the securing screws.
- Always use the new securing screws supplied and tighten the screws to the specified tightening torque.
 1. Remove the die.
 2. Remove the securing screws.

3. Lift off the punch guide.
4. Place the new punch guide in position.
5. Insert the securing screws and tighten them to the specified torque.

Technical data	
Tightening torque	3 Nm (2 ftlb _f)

6. Reinstall the die.

Checking die, punch guide and wear plate

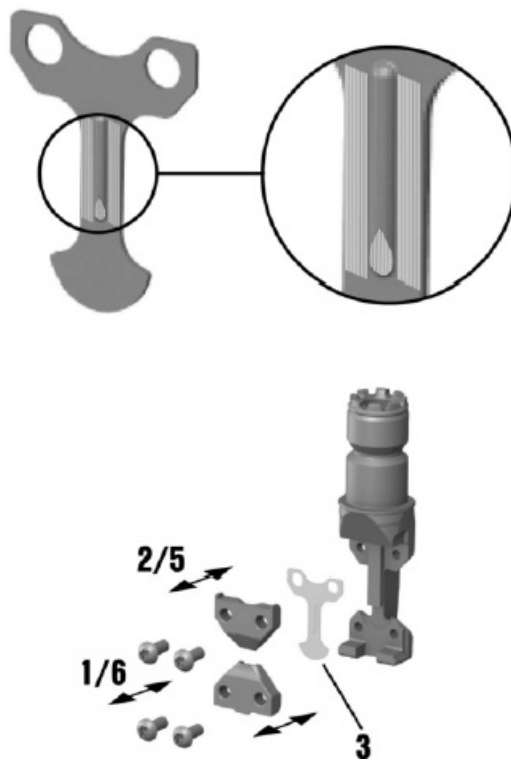

Option: SPNRN
OR SPNRL

CAUTION

Risk of damage to product and cutting tools!

- Clean the threads before installing the securing screws.
- Always use the new securing screws supplied and tighten the screws to the specified tightening torque.
 1. Remove the securing screws.
 2. Remove the punch guide and the die.
 3. Check the wear plate for signs of wear.

Result

If clear signs of wear are visible:

- Remove the wear plate and install a new replacement.
4. Clean the contact surfaces of the die bearing.

5. Use the pins to center the punch guide and the die.
6. Reinstall the securing screws and tighten until hand-tight.
7. Grease the guide surfaces of the punch guide.
8. Tighten the securing screws to the specified torque in diagonally opposite sequence.

Technical data	
Tightening torque	3 Nm (2 ftlb _f)

Transport and storage of cordless tools and batteries

Transport

CAUTION

Accidental starting during transport !

- Always transport your products with the batteries removed!
- Remove the battery/batteries.
- Never transport batteries loose and unprotected. During transport, batteries should be protected from excessive shock and vibration and isolated from any conductive materials or other batteries that may come in contact with the terminals and cause a short circuit. Comply with the locally applicable regulations for transporting batteries.
- Do not send batteries through the mail. Consult your shipper for instructions on how to ship undamaged batteries.
- Prior to each use and before and after prolonged transport, check the product and the batteries for damage.

Storage

WARNING

Accidental damage caused by defective or leaking batteries !

- Always store your products with the batteries removed!
- Store the product and the batteries in a cool and dry place. Comply with the temperature limits stated in the technical data.
- Do not store batteries on the charger. Always remove the battery from the charger when the charging operation has completed.
- Never leave batteries in direct sunlight, on sources of heat, or behind glass.
- Store the product and batteries where they cannot be accessed by children or unauthorized persons.
- Prior to each use and before and after prolonged storage, check the product and the batteries for damage.

Troubleshooting

Trouble or fault	Possible cause	Action to be taken
The battery runs down more quickly than usual.	Very low ambient temperature.	<ul style="list-style-type: none"> Allow the battery to warm up slowly to room temperature.
The battery does not engage with an audible click.	The retaining lug on the battery is dirty.	<ul style="list-style-type: none"> Clean the retaining lug and re-insert the battery.

Trouble or fault	Possible cause	Action to be taken
The product or battery gets very hot.	Electrical fault	<ul style="list-style-type: none"> Switch the product off immediately, remove the battery, keep it under observation, allow it to cool down and contact Hilti Service.
Product does not develop full power.	A battery with inadequate capacity was used.	<ul style="list-style-type: none"> Use a battery with adequate capacity.
Diminishing cutting performance	Punch worn	<ul style="list-style-type: none"> Change the punch.
The motor has no braking effect.	Battery is discharged.	<ul style="list-style-type: none"> Change the battery and charge the empty battery.
	Product is momentarily overloaded.	<ul style="list-style-type: none"> Switch the product off and then on again.
LEDs of the battery show nothing	Battery defective.	<ul style="list-style-type: none"> Contact Hilti Service.

Disposal

WARNING

Risk of injury due to incorrect disposal!

Health hazards due to escaping gases or liquids.

- DO NOT send batteries through the mail!
- Cover the terminals with a non-conductive material (such as electrical tape) to prevent short circuiting.
- Dispose of your battery out of the reach of children.

- Dispose of the battery at your Hilti Store, or consult your local governmental garbage disposal or public health and safety resources for disposal instructions.



Most of the materials from which Hilti products are manufactured can be recycled. The materials must be correctly separated before they can be recycled. In many countries, your old tools, machines or appliances can be returned to Hilti for recycling. Ask Hilti Service or your Hilti sales representative for further information.



- Do not dispose of power tools, electronic equipment or batteries as household waste!

Manufacturer's warranty

- Please contact your local Hilti representative if you have questions about the warranty conditions.

Further information

For more information on operation, technology, environment and recycling, follow this link: qr.hilti.com/manual/?id=2331867

This link is also to be found in these operating instructions in the form of a QR code, indicated by the symbol



NURON

B 22-55(01)	0,56 kg	1.23 lb
B 22-85(01)	0,77 kg	1.70 lb
B22-110(01)	0,92 kg	2.03 lb
B 22-170 (01)	1,34 kg	2.95 lb
B 22-255 (01)	1,87 kg	4.12 lb

C4-22
CS-22
C8-22

- Hilti Corporation
- LI-9494 Schaan
- Tel.: +423 234 21 11
- Fax: +423 234 29 65
- www.hilti.group



Documents / Resources

	<p>HILTI SPN 622 (02) Cordless Nibbler [pdf] Installation Guide 622 02, 2331867, SPN 6 22 02 Cordless Nibbler, SPN 6 22 02, Cordless Nibbler, Nibbler</p>
---	---

References

- [🇨🇦 HILTI Country selector](#)
- [User Manual](#)

Manuals+, Privacy Policy

This website is an independent publication and is neither affiliated with nor endorsed by any of the trademark owners. The "Bluetooth®" word mark and logos are registered trademarks owned by Bluetooth SIG, Inc. The "Wi-Fi®" word mark and logos are registered trademarks owned by the Wi-Fi Alliance. Any use of these marks on this website does not imply any affiliation with or endorsement.