

**Contents** [ [hide](#) ]

[1 HILTI MFP-SA Fixed Point Compact](#)

[2 Specifications](#)

[3 Installation Instructions](#)

[4 FAQ](#)

[5 Documents / Resources](#)

[5.1 References](#)



## HILTI MFP-SA Fixed Point Compact



### Introduction

This document provides detailed instructions for the installation of the Hilti MFP-SA M20 system, including necessary components and steps.

### Components

- MFP-SA M20 #2460490
- M12×25 Bolt #2184553
- MFP-PC 73-78 to 318-326

A

B

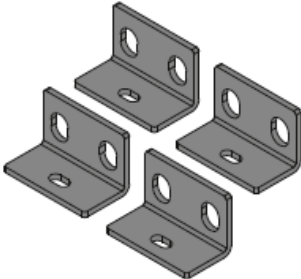

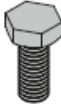

MFP-SA M20  
#2460490

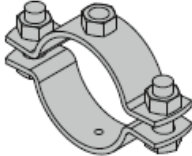

M12×25  
#2184553



MFP-PC  
73-78 to 318-326



en All other parts in the design other than MFP-SA and MFP-PC, should be calculated separately!

Specifications

Component	Specification
MFP-SA M20	#2460490
M12×25 Bolt	#2184553
MFP-PC	73-78 to 318-326

Installation Instructions

1. Measure the length (L) and calculate X as  $L + 60$  mm.
2. Position the MFP-PC clamp on the pipe.

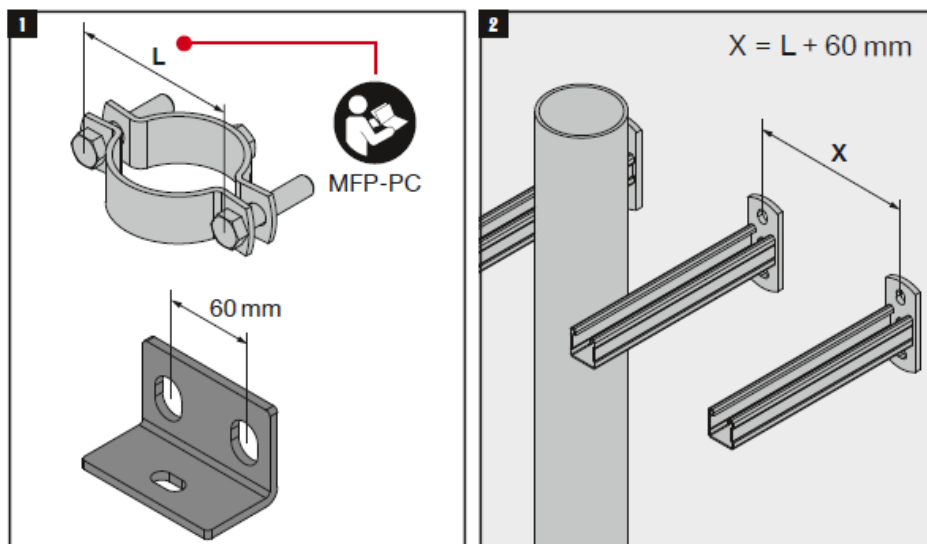

3. Attach the MFP-SA M20 bracket to the structure using the M12×25 bolt.
4. Ensure the bracket is securely fastened.

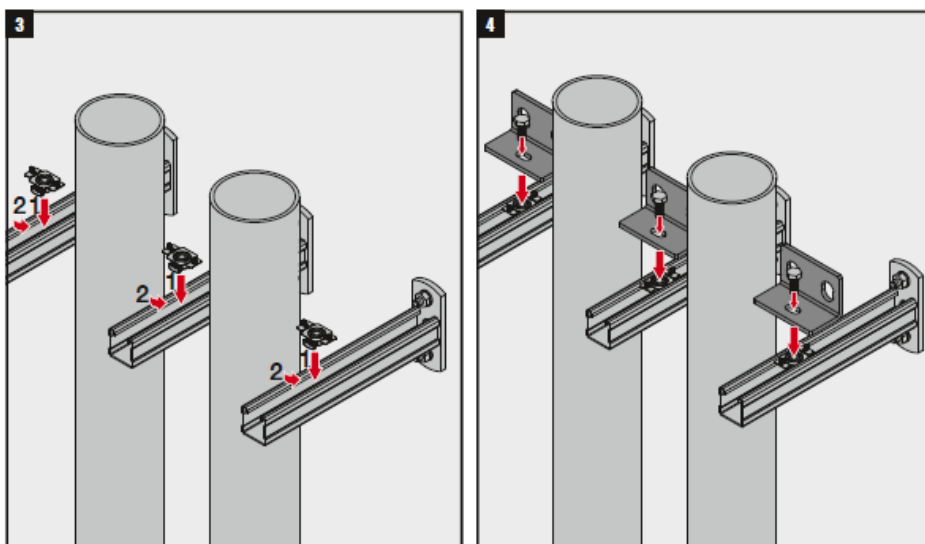

5. Align the components as shown in the diagrams.
6. Tighten all bolts to the specified torque.

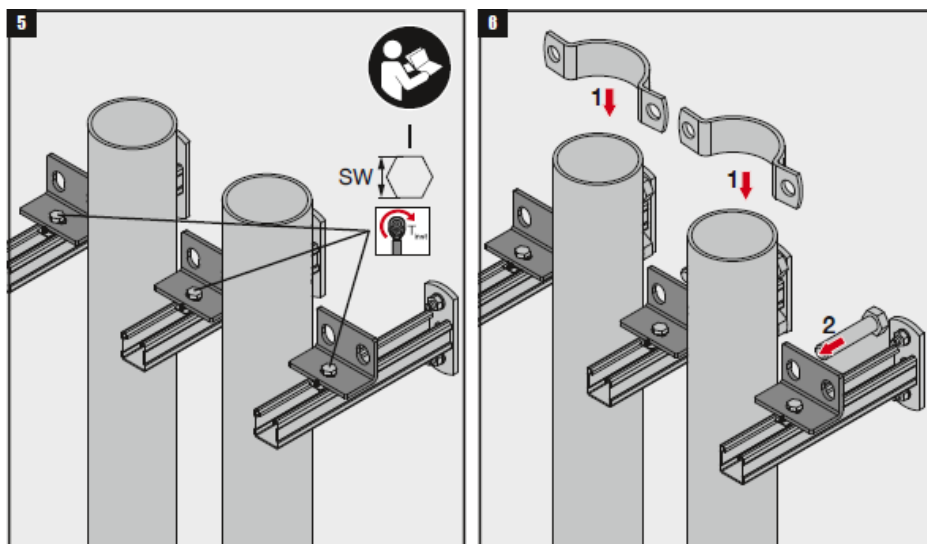

7. Verify the installation is secure and stable.

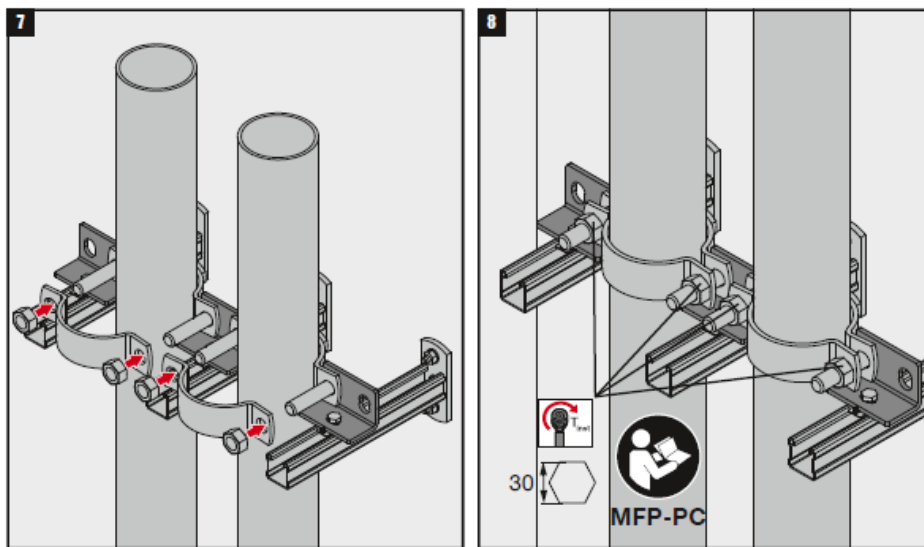

## Important Notes

All other parts in the design, other than MFP-SA and MFP-PC, should be calculated separately.

## Diagrams

The diagrams illustrate the step-by-step installation process, showing the correct positioning and alignment of components.

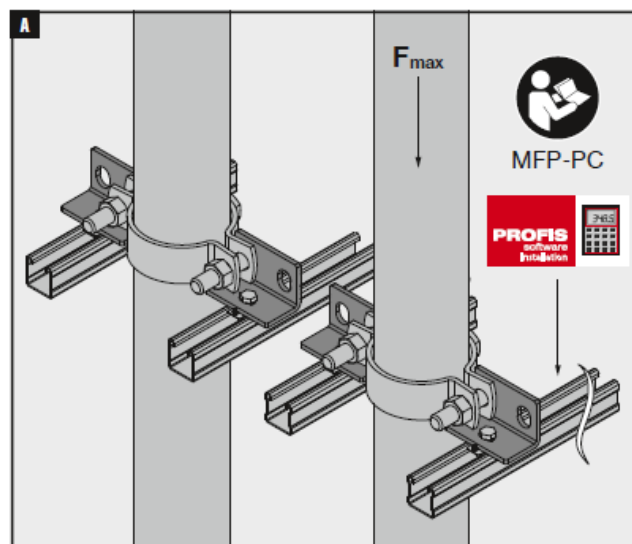

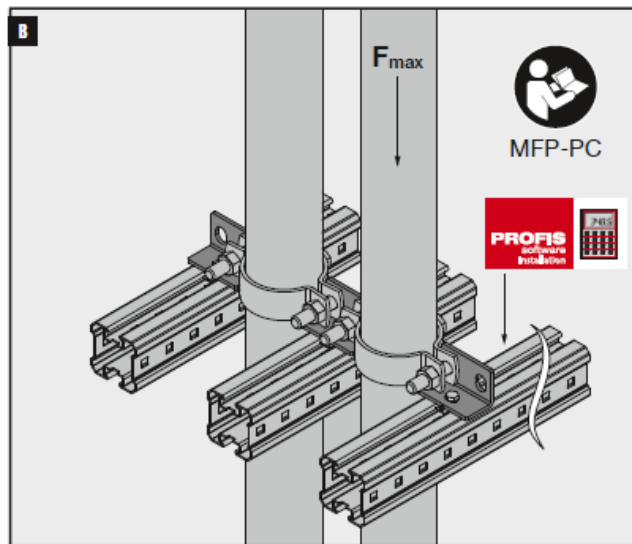

## FAQ

- **What is the purpose of the MFP-PC?**

The MFP-PC is used to clamp the pipe securely in place.

- **How do I calculate the correct length for installation?**

Calculate X as the length (L) plus 60 mm.

- **Are there any additional parts required?**

All other parts must be calculated separately as per the design requirements.

## Documents / Resources

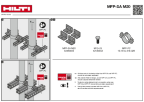
	<p><a href="#">HILTI MFP-SA Fixed Point Compact [pdf]</a> Installation Guide</p> <p>MFP-SA M20, MFP-PC 73-78, 318-326, MFP-SA Fixed Point Compact, MFP-SA, Fixed Point Compact, Point Compact, Compact</p>
---	--

## References

- [User Manual](#)

■ HILTI

🔑 318-326, compact, Fixed Point Compact, HILTI, MFP-PC 73-78, MFP-SA, MFP-SA Fixed Point Compact, MFP-SA M20, Point Compact

# Leave a comment

Your email address will not be published. Required fields are marked \*

Comment \*

Name

Email

Website

☐ Save my name, email, and website in this browser for the next time I comment.

**Post Comment**

**Search:**

e.g. whirlpool wrf535swhz

**Search**

[Manuals+](#) | [Upload](#) | [Deep Search](#) | [Privacy Policy](#) | [@manuals.plus](#) | [YouTube](#)

This website is an independent publication and is neither affiliated with nor endorsed by any of the trademark owners. The "Bluetooth®" word mark and logos are registered trademarks owned by Bluetooth SIG, Inc. The "Wi-Fi®" word mark and logos are registered trademarks owned by the Wi-Fi Alliance. Any use of these marks on this website does not imply any affiliation with or endorsement.