

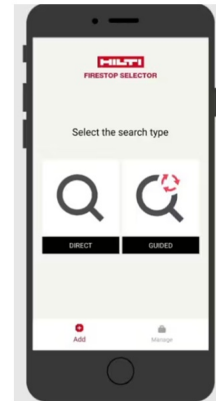

HILTI Firestop
Selector App



HILTI Firestop Selector App User Guide

[Home](#) » [HILTI](#) » HILTI Firestop Selector App User Guide 

Contents

- [1 HILTI Firestop Selector App](#)
- [2 Product Usage Instructions](#)
- [3 LOG IN AND SETTINGS](#)
- [4 FIRESTOP SELECTOR HOMEPAGE NAVIGATION](#)
- [5 FAQ](#)
- [6 Documents / Resources](#)
 - [6.1 References](#)
- [7 Related Posts](#)



HILTI Firestop Selector App

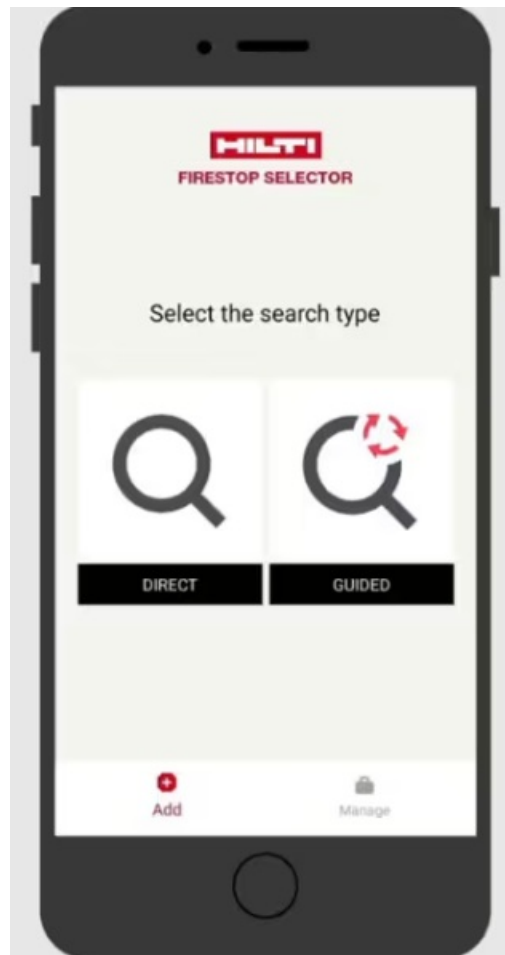

Specifications

- Product Name: Firestop Selector on HCP 2.0
- Version: Update | November 2024
- Platform: HCP 2.0

Product Usage Instructions

Firestop Selector Homepage Navigation

The homepage offers various navigation options:

- Waffle menu
- Guided Search
- Direct Search
- Advanced Search Help
- Settings
- Banner highlighting the mobile app for web users
- Links & QR codes to download the mobile app

Navigating Search Results

After conducting a search, navigate through the results using the following features:

- Grid & list views
- Reset filters and additional filters

- Select Manage Solutions to save selected solutions to a project
- Use filters for advanced search
- Sort results based on preferences
- Select preferred product or solution
- Download files or select Preview for more information

LOG IN AND SETTINGS

- Visit the Firestop Selector using the QR code
- Or direct link : <https://firestop.hilti.com/>



- Select your country and language (a pop-up should appear)
-

The screenshot shows the Hilti Firestop Selector website. At the top, the Hilti logo is on the left and 'CONTACT' is on the right. The main content area has two columns: 'Log in' and 'Register'. The 'Log in' column has fields for 'E-mail address' and 'Password', a 'LOG IN' button, and a link for 'Forgot password?'. The 'Register' column has a 'GET STARTED NOW' button. A 'SELECT COUNTRY AND LANGUAGE' pop-up is overlaid on the bottom left. It contains the text: 'The Firestop selector provides support for the following countries and languages. Kindly choose your required country and language.' Below this are two dropdown menus: 'Country' (set to 'United States') and 'Language' (set to 'English'). A 'Continue' button is at the bottom right of the pop-up.

On your first visit, you will be asked to accept an End-user agreement (EUA) for your profile country

- When you first visit the HCP2 Dashboard, you may be asked to provide additional information to confirm your profile country (to then provide you the applicable EUA)

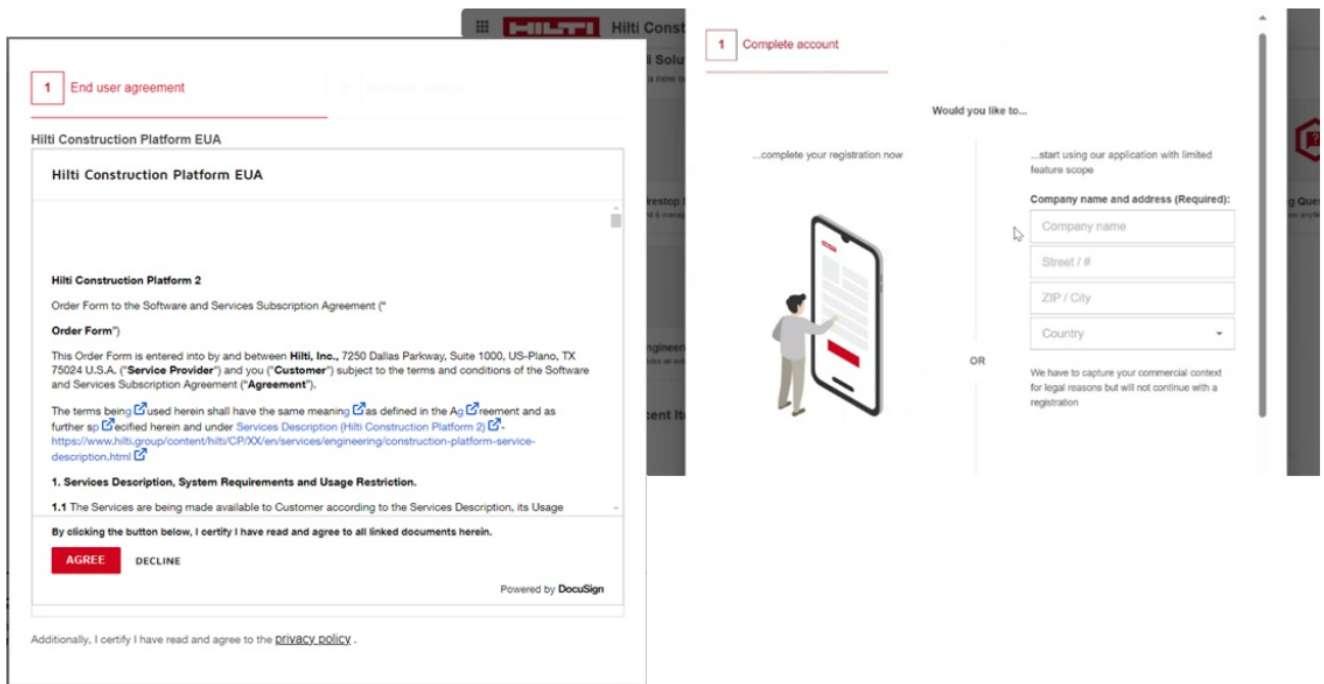

CREATE LOCALIZATION SETTINGS BY SELECTING YOUR TIMEZONE AND UNITS, ACCESS END-USER AGREEMENT (EUA)

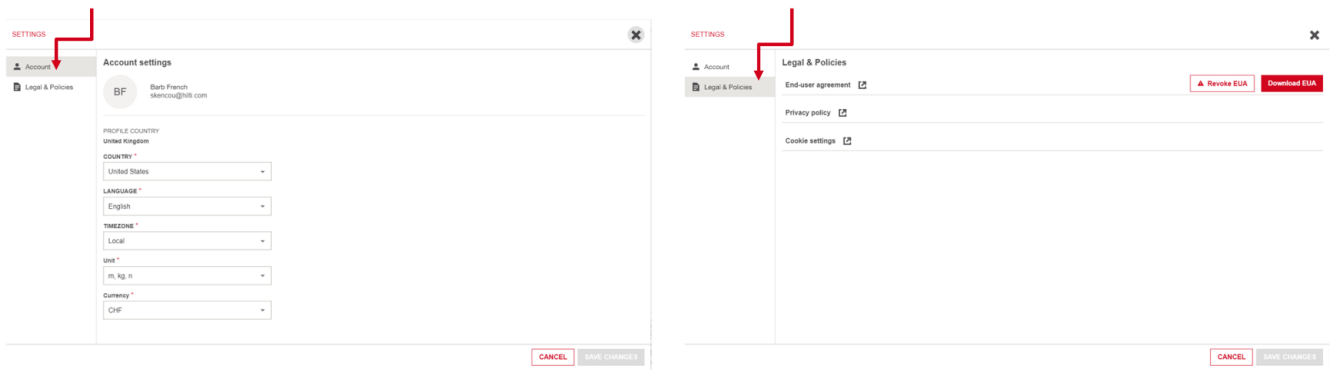

FIRESTOP SELECTOR HOMEPAGE NAVIGATION

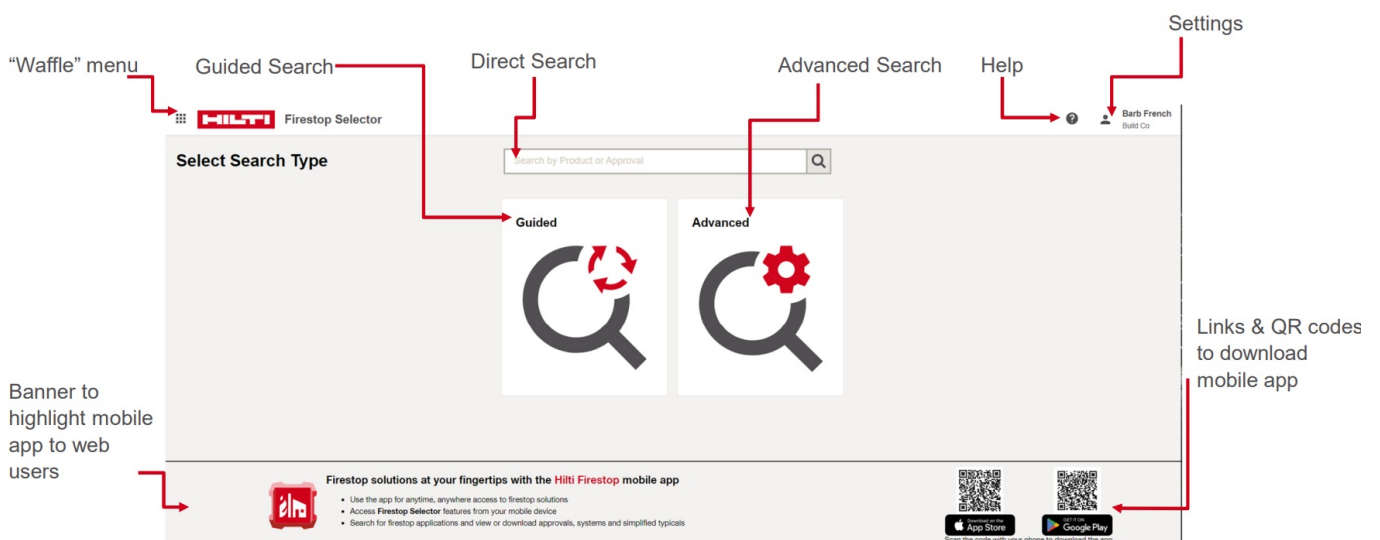

NAVIGATING SEARCH RESULTS

Firestop Selector

Search Summary: Search by Product or Approval

Application Type: Select the value | F Rating: Select the value

Filter solutions: Use the drop down lists to find solutions that match your application

Grid & list views

Reset filters

Additional filters

Select "Manage Solutions" to save selected solutions to a project

Use filters to conduct advanced search

Sort results

Select preferred product

Select solution

Download files

Select "Preview" for more information

Products: FS-ONE MAX, CFS-CD U, CFS-CD P, CFS-CD M, CFS-CD MD P, CFS-CD MD M, CFS-MSL

Solutions: WL-5028, C-AJ-1155, WL-1054

System UL, System DWG, System Trade

NAVIGATING "PREVIEW" PAGE & "MANAGE SOLUTIONS" POP-UP

Firestop Selector

Search Summary: Search by Product or Approval

Application Type: Select the value | F Rating: Select the value

Filter solutions: Use the drop down lists to find solutions that match your application

Grid & list views

Reset filters

Additional filters

Select "Manage Solutions" to save selected solutions to a project

Use filters to conduct advanced search

Sort results

Select preferred product

Select solution

Download files

Select "Preview" for more information

Products: FS-ONE MAX, CFS-CD U, CFS-CD P, CFS-CD M, CFS-CD MD P, CFS-CD MD M, CFS-MSL

Solutions: WL-5028, C-AJ-1155, WL-1054

System UL, System DWG, System Trade

MANAGE SOLUTIONS

Selected items:

WL-5028

- 1 Hour or 2 Hour
- Max. 4" steel, max. 2" copper, conduit or EMT pipe with max. 1/2" AB/PVC insulation

✓ System UL ✓ System DWG ✓ System Trade

Log in to access full capabilities:

- ✓ Create and manage projects
- ✓ Store solutions in the cloud
- ✓ Companion mobile applications
- ✓ Submittal Generator

Log in / Register

Save solution to projects or drafts

Log in or register to proceed

ACCESS SAVED FIRESTOP SOLUTIONS BY LOGGING IN OR REGISTERING

Firestop Selector

Search Summary: Search by Product or Approval

Application Type: Select the value | F Rating: Select the value

Filter solutions: Use the drop down lists to find solutions that match your application

Grid & list views

Reset filters

Additional filters

Select "Manage Solutions" to save selected solutions to a project

Use filters to conduct advanced search

Sort results

Select preferred product

Select solution

Download files

Select "Preview" for more information

Products: FS-ONE MAX, CFS-CD U, CFS-CD P, CFS-CD M, CFS-CD MD P, CFS-CD MD M, CFS-MSL

Solutions: WL-5028, C-AJ-1155, WL-1054

System UL, System DWG, System Trade

Log In Using Existing HCP Email & Password

Log In

E-mail address

Required Password

Required

LOG IN

Forgot password?

If New, Complete Registration

Register

Create an account to gain 24/7 access to:

- Unlock exclusive discounts and pricing
- Shop Hilti's latest innovations
- Create orders and quotes
- Process repairs and get detailed tracking updates
- Access invoices and make payments

GET STARTED NOW

For any registration issues, please contact Hilti Customer Service at 1-800-879-8000 (US) or 1-800-363-4458 (CA)

OPTIONS TO GENERATE SUBMITTAL FROM SELECTOR

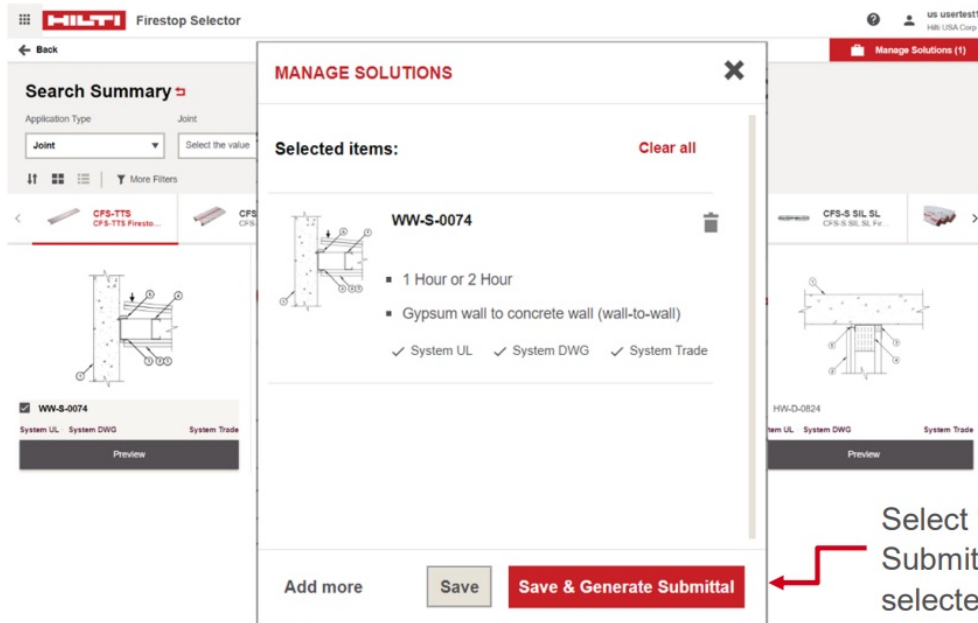

NAVIGATING SAVE & CREATING NEW PROJECTS (WITHIN THE FIRESTOP SELECTOR)

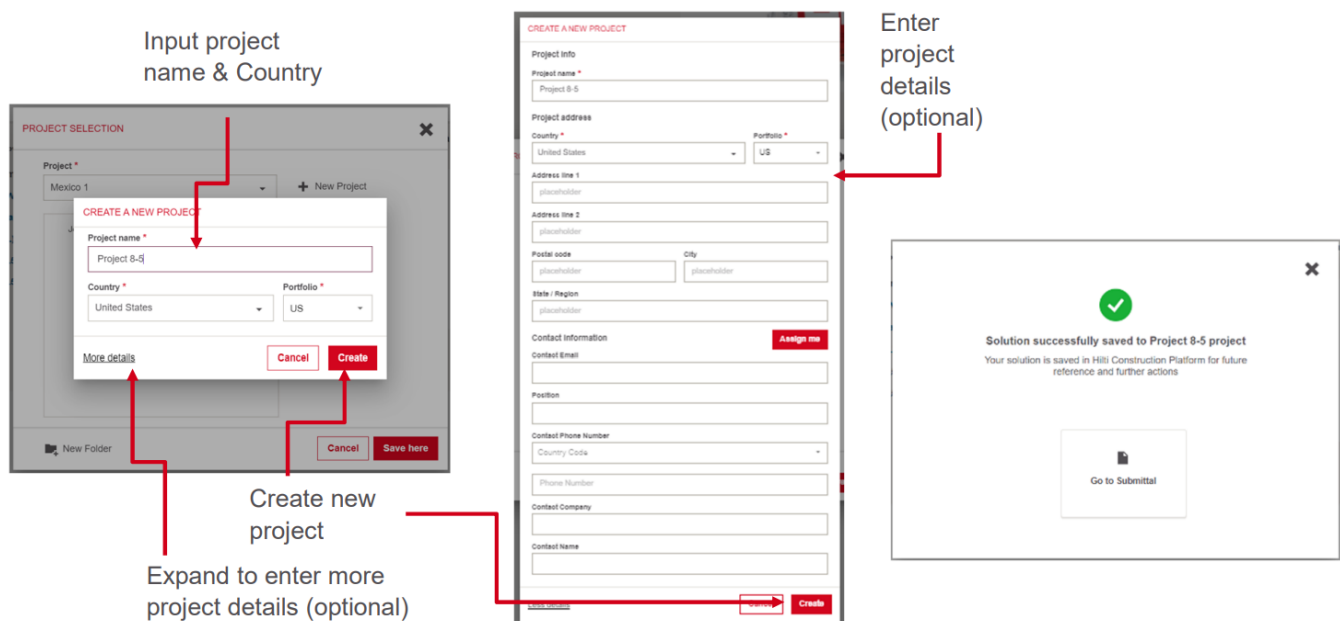

NAVIGATING SUBMITTAL GENERATOR

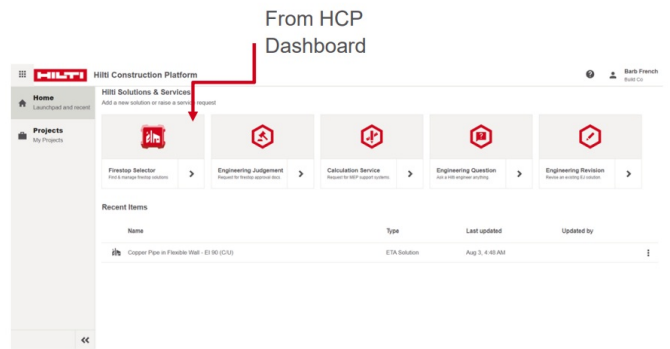
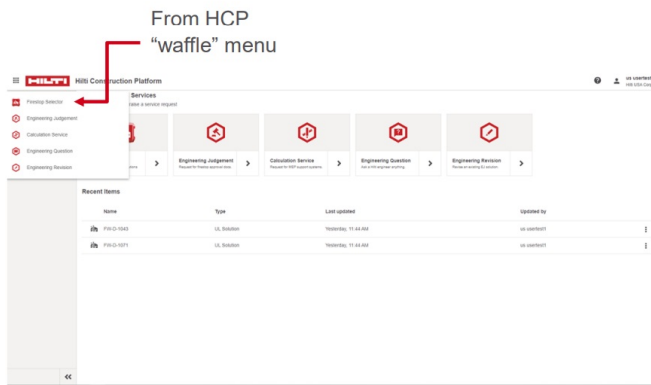

ADDING SOLUTIONS DIRECTLY TO PROJECTS OR FOLDERS

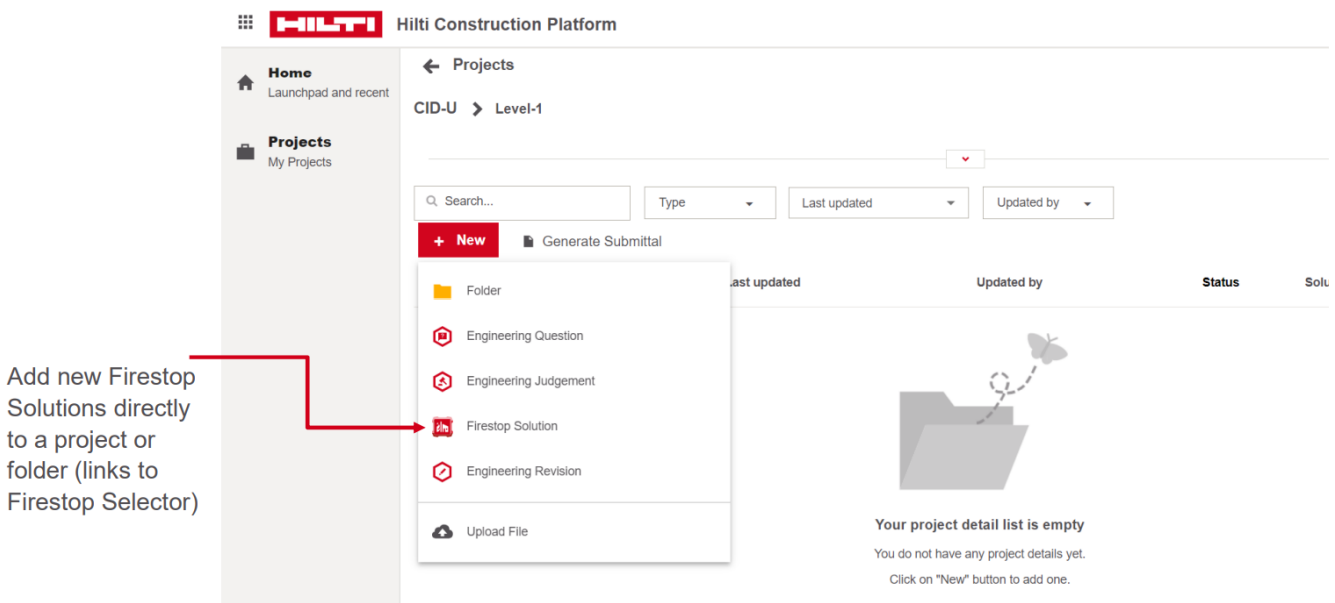

OPTIONS TO GENERATE SUBMITTAL FROM HCP PROJECTS

HILTI-Firestop-Selector-App- (17)

FIRESTOP SELECTOR MOBILE APP FOR HCP 2.0

DOWNLOAD THE NEW FIRESTOP SELECTOR & EJ MOBILE APP FOR IOS OR ANDROID!

- Hilti Firestop Selector Mobile –Android App: <https://play.google.com/store/apps/details?id=com.hilti.mobile.firestopselector>
- Hilti Firestop Selector Mobile –IOS App: <https://apps.apple.com/us/app/hilti-firestop-selector/id1663231816>

HILTI-Firestop-Selector-App- (18)

HILTI-Firestop-Selector-App- (19)

HILTI FIRESTOP SELECTOR MOBILE APP FEATURE NAVIGATION

HILTI-Firestop-Selector-App- (20)

HILTI-Firestop-Selector-App- (21)

HILTI-Firestop-Selector-App- (22)



UPDATES TO SEARCH PAGE & RESULTS IN HCP 2.0 MOBILE APP

Old App

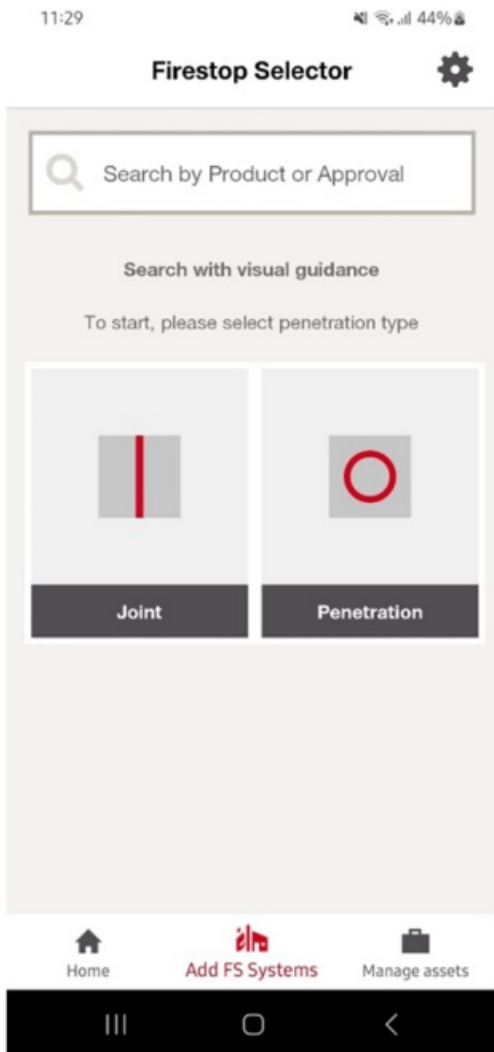

NEW App

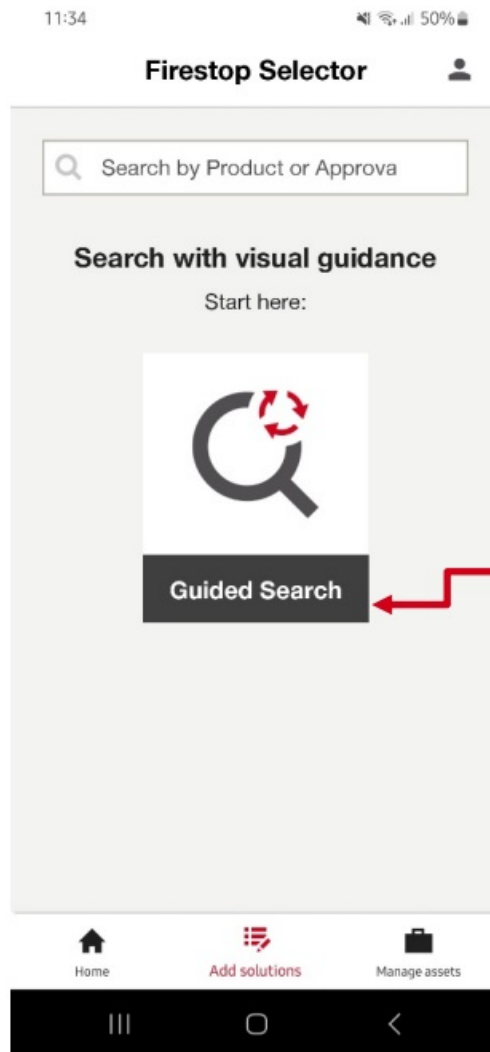

Search page
now begins
with "Guided
Search" button

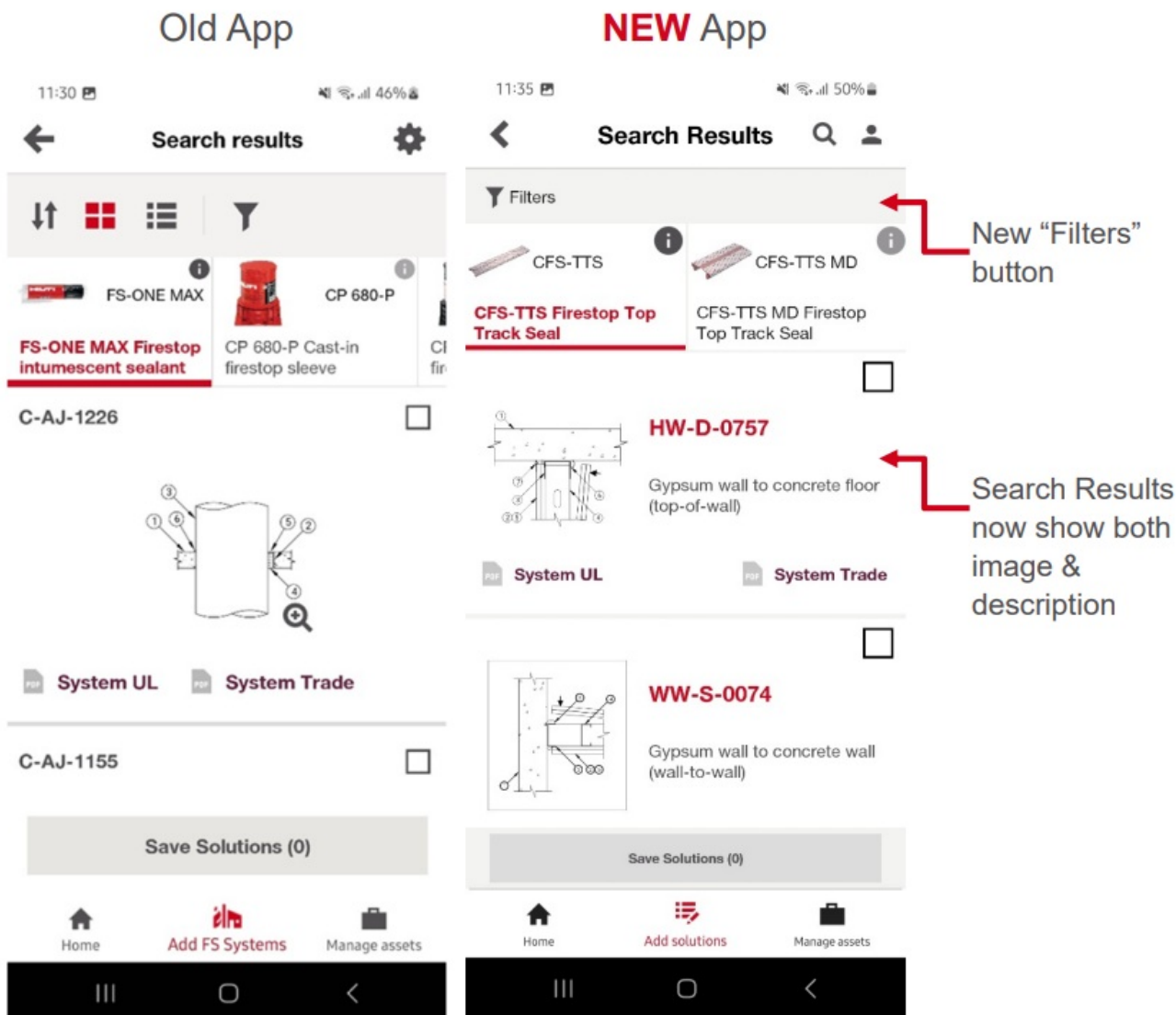

UPDATES TO SECONDARY FILTERS & PROJECTS IN HCP 2.0 MOBILE APP

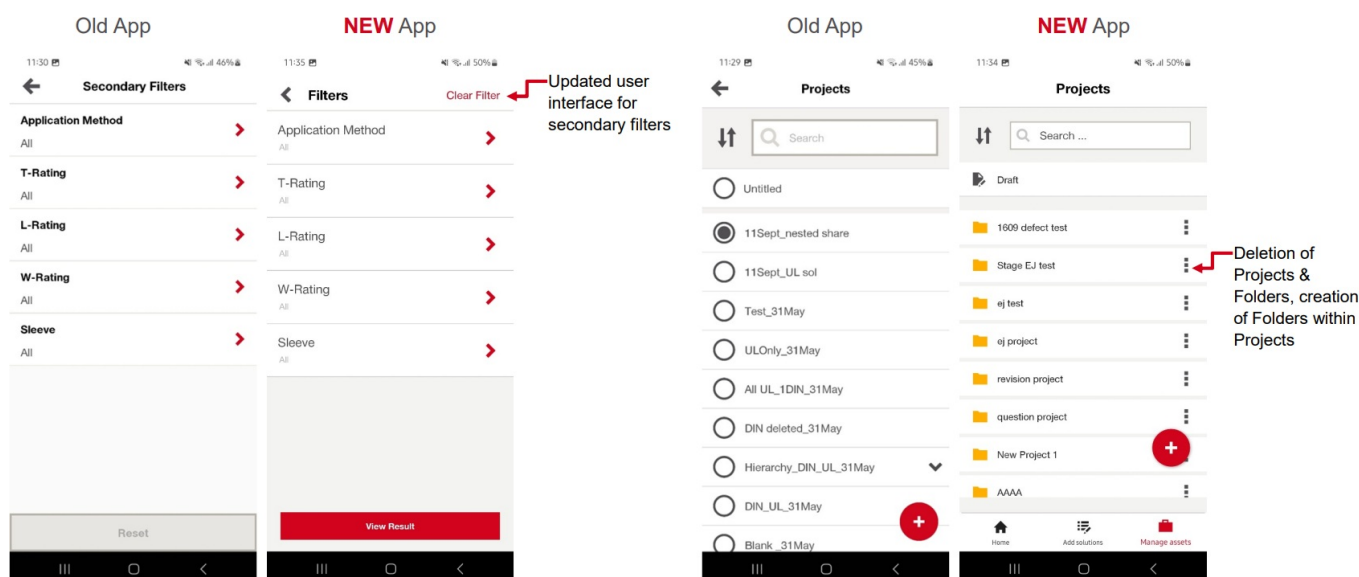

THANK YOU

Customer User Guide for Firestop Selector on HCP 2.0 Update | November 2024

FAQ

Q: How do I access saved firestop solutions?

A: You can access saved firestop solutions by logging in with your existing HCP email and password. If you are a new user, complete the registration process.

Q: How can I generate a submittal from the selector?

A: To generate a submittal, go to Manage Solutions in the FSS Search Results and select Save & Generate Submittal to save selected solutions to a project.

Documents / Resources

	HILTI Firestop Selector App [pdf] User Guide Firestop Selector App, App
---	--

References

-  [Firestop](#)
- [User Manual](#)

[Manuals+](#), [Privacy Policy](#)

This website is an independent publication and is neither affiliated with nor endorsed by any of the trademark owners. The "Bluetooth®" word mark and logos are registered trademarks owned by Bluetooth SIG, Inc. The "Wi-Fi®" word mark and logos are registered trademarks owned by the Wi-Fi Alliance. Any use of these marks on this website does not imply any affiliation with or endorsement.