



HIKVISION UD21052B Face Recognition Terminal User Guide

[Home](#) » [Hikvision](#) » HIKVISION UD21052B Face Recognition Terminal User Guide 

Contents

- [1 HIKVISION UD21052B Face Recognition Terminal](#)
- [2 Appearance](#)
- [3 Installation](#)
- [4 Wiring \(Normal\)](#)
- [5 Quick Operation](#)
- [6 Add Face Picture](#)
- [7 Tips When Collecting/Comparing Face Picture](#)
- [8 FCC Information](#)
- [9 Documents / Resources](#)
 - [9.1 References](#)
- [10 Related Posts](#)



HIKVISION UD21052B Face Recognition Terminal



Appearance

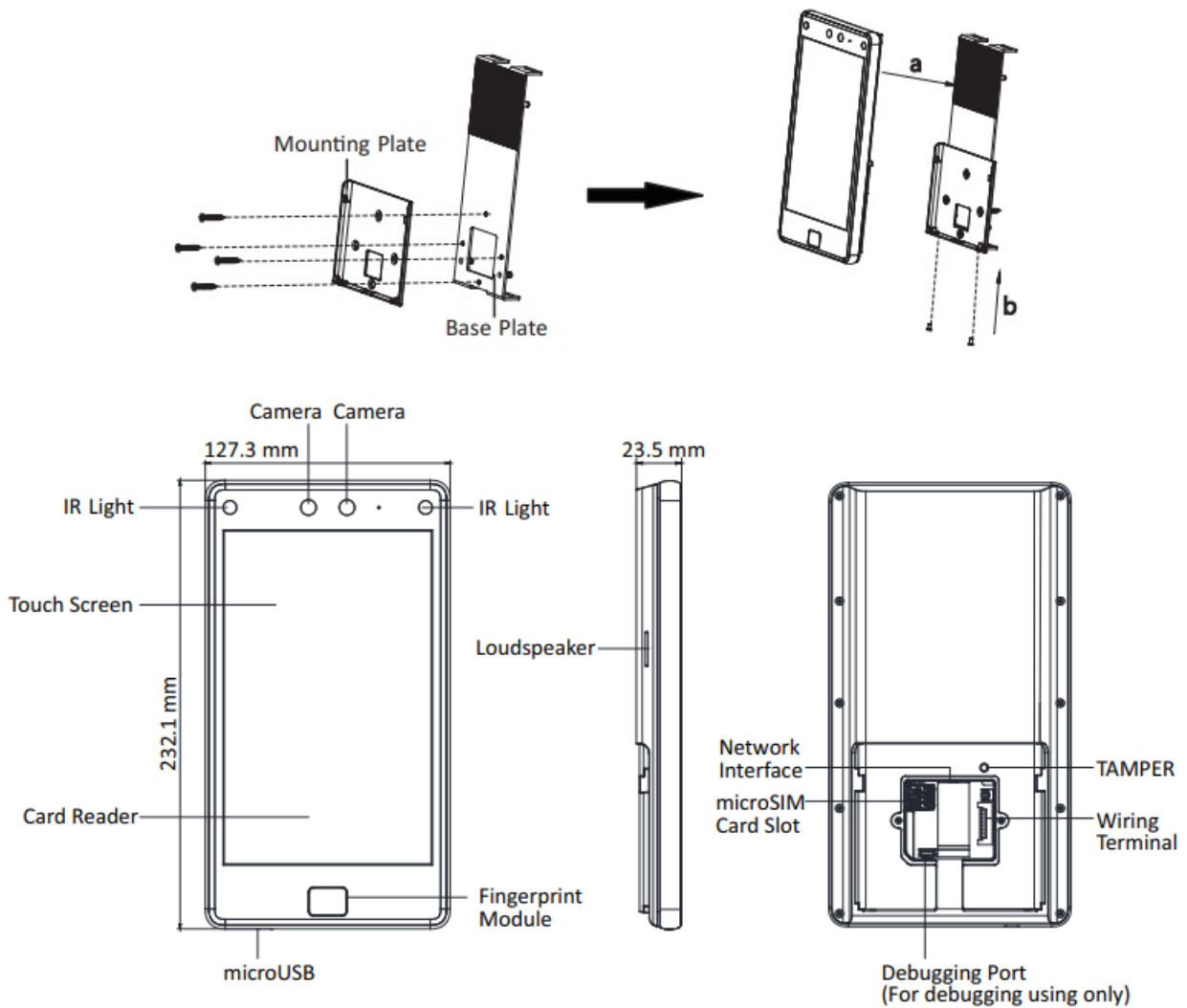

Installation

Installed on Environment

1. Avoid backlight, direct sunlight, and indirect sunlight.

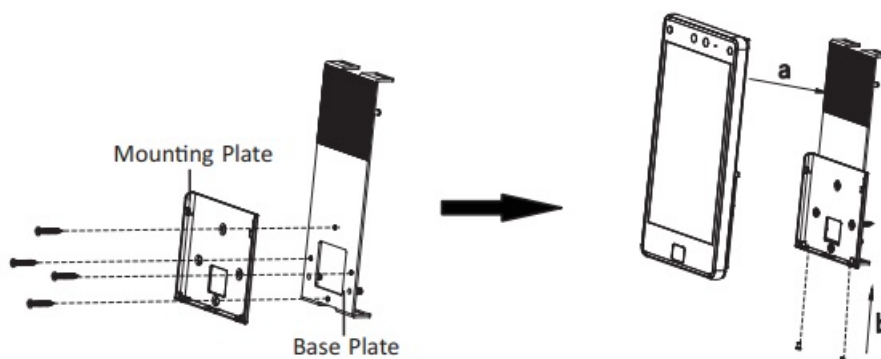

2. For better recognition, there should be light source in or near the installation environment.

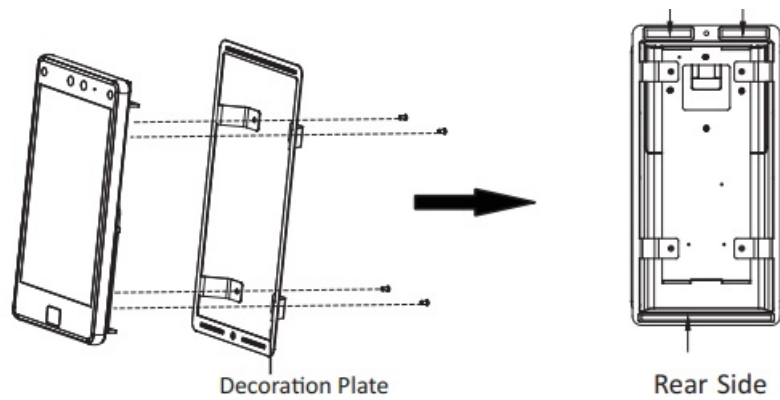

3. If you have to install the device outdoors, you should install a protective shield(optional) for the device.

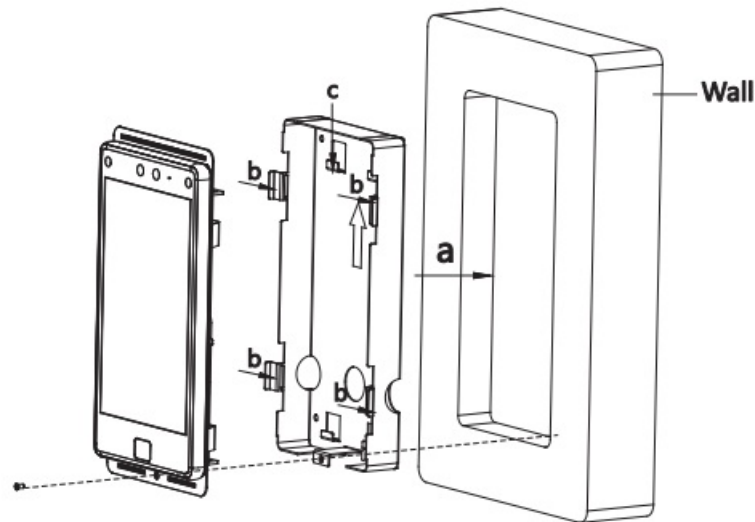
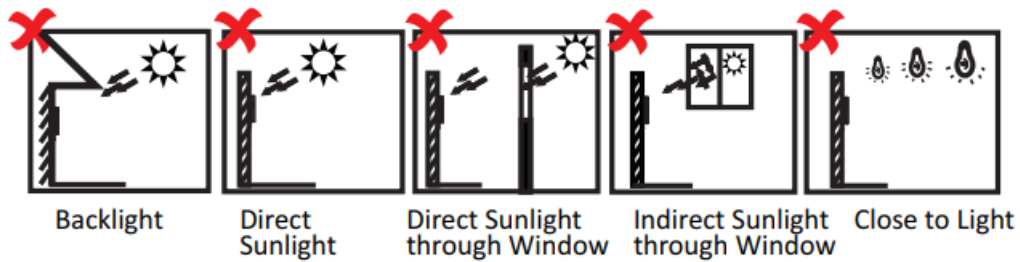

1. Secure the mounting plate on the base plate with 4 screws.

Remove the sponge tape on the base plate and secure the device on the mounting plate with 2 screws.

2. Secure the decoration plate on the base plate with 4 screws. Stick 3 waterproof membranes on the decoration plate as shown below. Route the cable through the cable hole of the plates, and connect to external device's cables.

3. Dig a hole (242 mm × 114 mm × 30.5 mm) on the wall. Place a gang box in the hole (a), and remove the 4 mounting ears with tool (b).

Secure the combination and the gang box with 1 screw (c).

4. The gang box is optional. You should purchase it separately.

5. The waterproof membranes is used only in the flush mounting.

6. For surface mounting, see the user manual.

Wiring (Normal)

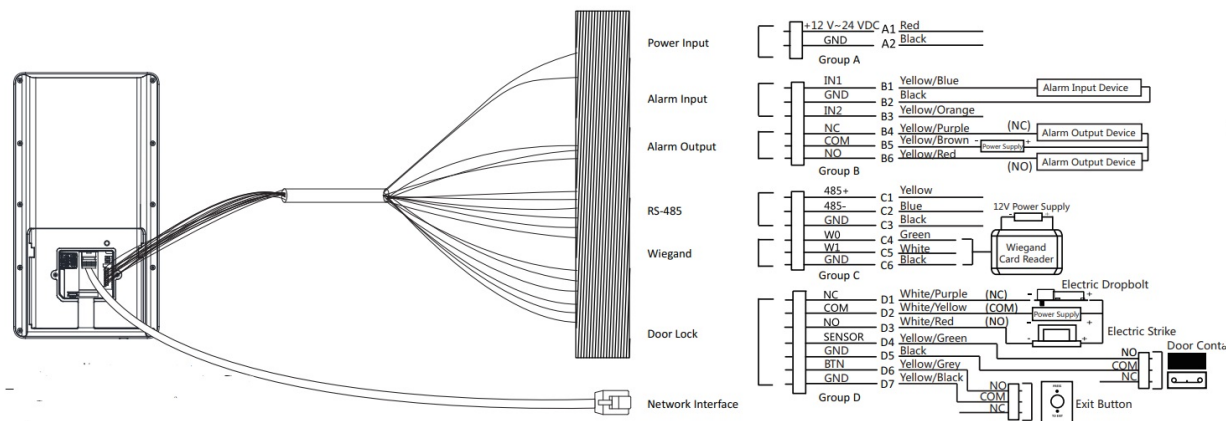

Use only power supplies listed in the user instructions:

Model	Manufacture	Standard
ADS-26FSG-12 12024EPG	Shenzhen Honor Electronic Co.,Ltd	PG
MSA-C2000IC12.0-24P-DE	MOSO Technology Co.,Ltd	PDE
ADS-26FSG-12 12024EPB	Shenzhen Honor Electronic Co.,Ltd	PB
ADS-26FSG-12 12024EPCU/EPC	Shenzhen Honor Electronic Co.,Ltd	PCU
ADS-26FSG-12 12024EPI-01	Shenzhen Honor Electronic Co.,Ltd	PI
ADS-26FSG-12 12024EPBR	Shenzhen Honor Electronic Co.,Ltd	PBR

- When connecting door contact and exit button, the device and the RS-485 card reader should use the same common ground connection. The Wiegand terminal here is a Wiegand input terminal. You should set the device's
- Wiegand direction to "input". If you should connect to an access controller, you should set the Wiegand direction to "Output". For details, see the user manual.
- The suggested external power supply for door lock is 12 V, 1 A.
- The suggested external power supply for Wiegand card reader is 12 V, 1 A.
- For wiring the fire system, see the user manual. Do not wire the device to the electric supply directly.
- If the device supports PoE, the network interface supports power supply by PoE.
- If the device supports power supply by PoE and the network interface is connected, do not wire the power input terminal.

Wiring (With Secure Door Control Unit)

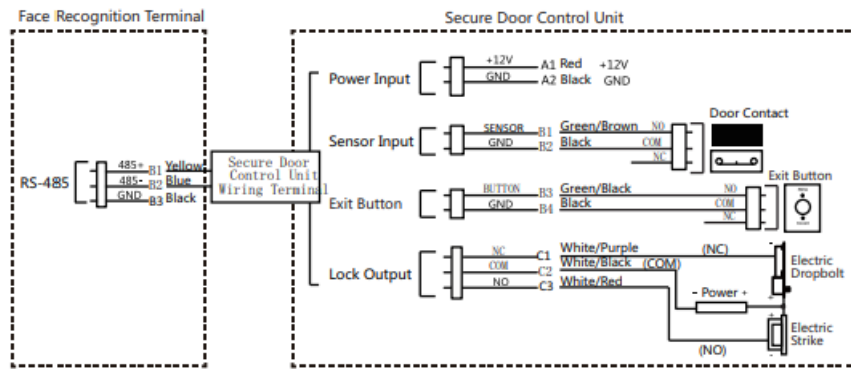

Quick Operation

Activation

Power on and wire the network cable after installation. you should activate the device before the first login. If the device is not activated yet, it will enter the Activate Device page after powering on.

Steps:

1. Create a password and confirm the password.
2. Tap Activate to activate the device. For other activation methods, see the device user manual.
 - We highly recommend you to create a strong password of your own choosing (using a minimum of 8 characters, including at least three kinds of following categories: upper case letters, lower case letters, numbers, and special characters) in order to increase the security of your product. And we recommend you change your password regularly, especially in the high security System, changing the password monthly or weekly can better protect your product.

Set Application Mode

After activation, you should select an application mode. Select Indoor or Others from the drop-down list and tap OK. If you install the device indoors near the window or the face recognition function is not working well, select Others.

Set Language

Select a language from the drop-down list.

Set Network Parameters

Wired Network:

If enable DHCP, the system will assign the IP address and other parameters automatically. If disable DHCP, you should manually set the IP address and other parameters.

Wi-Fi:

- Select a Wi-Fi and enter the Wi-Fi's password.
- Or tap Add Wi-Fi and enter the Wi-Fi's name and password.
- If you select Wired Network, make sure the device has connected to a network.

Link to Mobile Client

Download and install the mobile client. Use the scan QR code function of the mobile client and scan the QR code on the device to link the device to the mobile client. Set Administrator

Steps:

1. Enter the administrator's name and tap Next.
2. Select a credential to add. You can select face, fingerprint, or card.
3. Tap OK.

Add Face Picture

1. Use finger to hold the screen surface for 3s and slide to right/left and enter the activation password to enter the Home page.
2. Enter the User Management page, tap + to enter the Add User page.
3. Set the user parameters according to actual needs. Only the device with the fingerprint module support the finger print related functions.
4. Tap Face and add the face information according to the instructions. You can view the captured picture on the screen, Make sure the face picture is in good quality and size. For details about the tips and positions when collecting or comparing the face picture, see the contents on the right.
5. If the picture is in good condition, tap the 2 Or tap the to take another face picture.
6. Tap the save icon to save the settings. Go back to the initial page to start authentication. For other authentication methods, see the device user manual. User other authentication methods if the device is affected by the light or other items.
 1. **N Matching:** The device will compare the captured face picture with the ones in the database.
 2. **Matching:** The device will compare the captured face picture with the user linked face picture.

Tips When Collecting/Comparing Face Picture

Expression

- Keep your expression naturally when collecting or comparing face pictures, just like the expression in the picture on the right.
- Do not wear hat, sunglasses, or other accessories that can affect the facial recognition function.
- Do not make your hair cover your eyes, ears, etc. and heavy makeup is not allowed.

Posture

In order to get a good quality and accurate face picture, position your face looking at the camera when collecting or comparing face picture



Size

Make sure your face is in the middle of the collecting window.

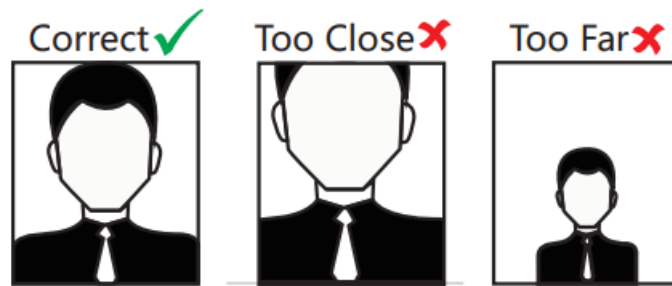

Regulatory Information

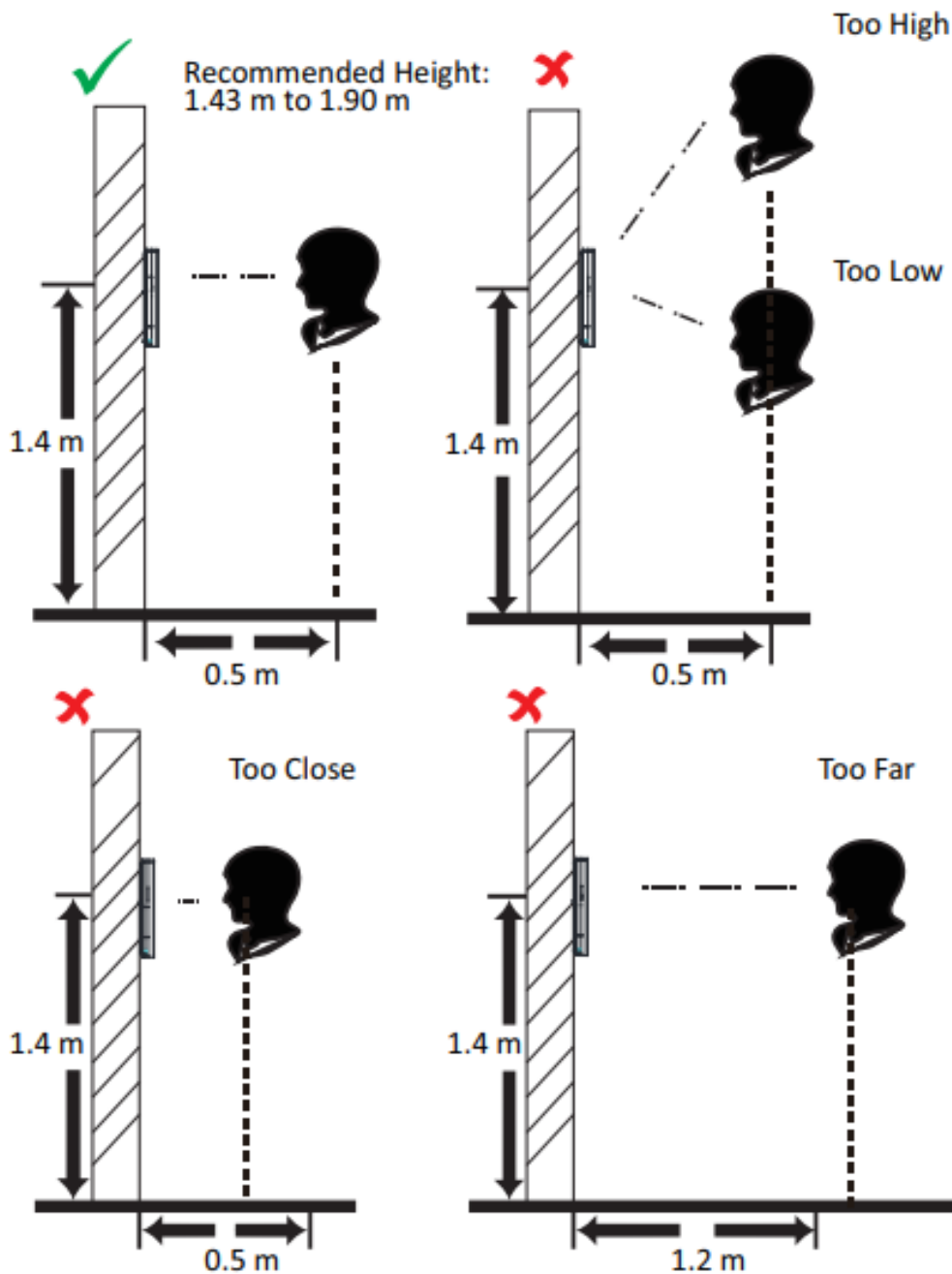

FCC Information

Please take attention that changes or modifications not expressly approved by the party responsible for compliance pursuant to part 15 of the FCC Rules. These limits are designed to provide reasonable protection against harmful interference in a residential installation. This equipment generates, uses, and can radiate radio frequency energy and, if not installed and used in accordance with the instructions, may

cause narrow interference to radio communications. However, there is no guarantee that interference will not occur in a particular installation. If this is found to comply with the limits for a Class B digital device, the equipment may be operated without restrictions. If the equipment does not meet the limits, the user is encouraged to try to correct the interference by one or more of the following measures:

- Reorient or relocate the receiving antenna.
- Increase the separation between the equipment and the receiver.
- Consult the dealer or an experienced radio/TV technician for help.
- This equipment should be installed and operated with a minimum distance of 20cm between the radiator and the receiver to which it is connected.

Conditions

This device complies with part 15 of the FCC Rules. Operation is subject to the following two conditions:

1. This device must not cause interference.
2. This device must accept any interference received, including interference that may cause undesired operation.

Documents / Resources

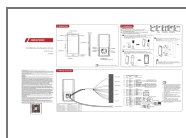

[HIKVISION UD21052B Face Recognition Terminal](#) [pdf] User Guide
K1T680DFW, 2ADTD-K1T680DFW, 2ADTDK1T680DFW, UD21052B Face Recognition Terminal, Recognition Terminal, Terminal

References

- [Hikvision US | The world's largest video surveillance manufacturer |](#)
- [HOME](#)