



HIKVISION DS-PHA64-P2 AX Hybrid User Guide

[Home](#) » [Hikvision](#) » HIKVISION DS-PHA64-P2 AX Hybrid User Guide 

Contents

- [1 HIKVISION DS-PHA64-P2 AX Hybrid](#)
- [2 Diagram References](#)
 - [2.1 Installation and Wiring](#)
- [3 Set-Up](#)
- [4 Specification](#)
- [5 Disclaimer](#)
- [6 FCC Information](#)
- [7 INSTALLATION CAUTION](#)
- [8 Battery Caution](#)
- [9 Documents / Resources](#)
- [10 Related Posts](#)

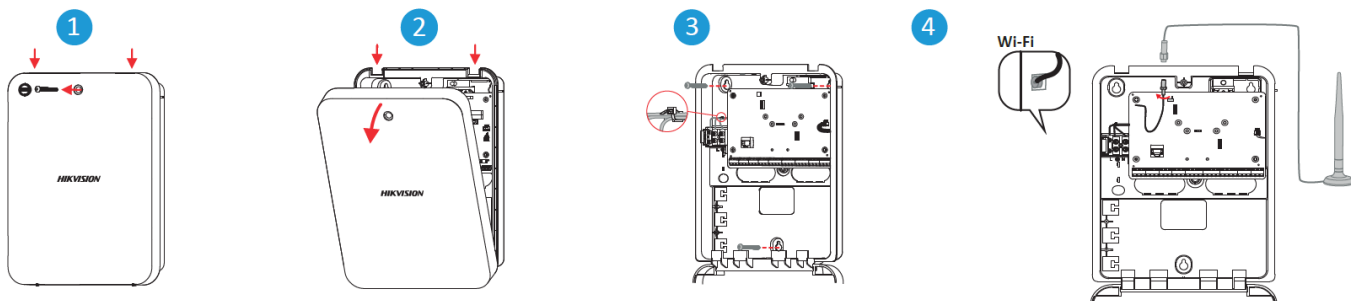
HIKVISION®

HIKVISION DS-PHA64-P2 AX Hybrid

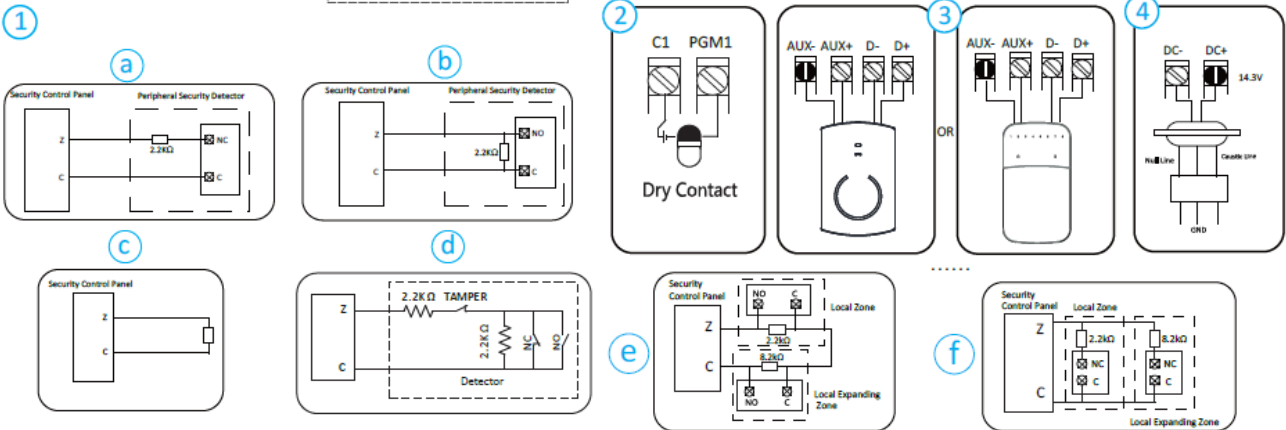
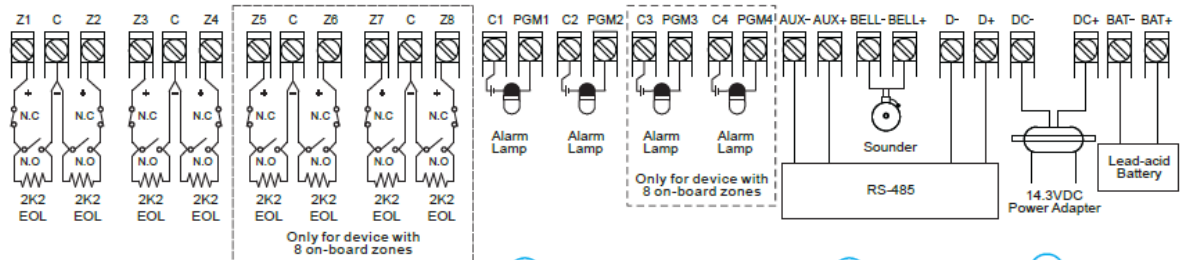
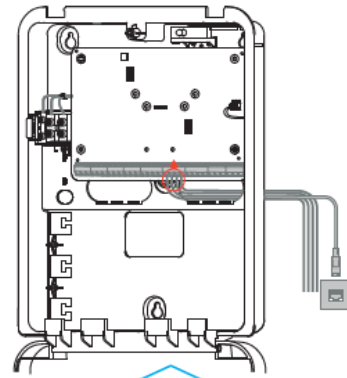
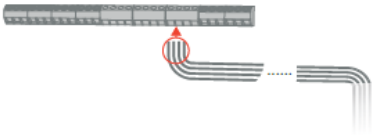


Diagram References

Installation and Wiring



Peripherals/Power Supply Wiring



- 1-3. Install the device.
- 4 Wire Wi-Fi antenna.

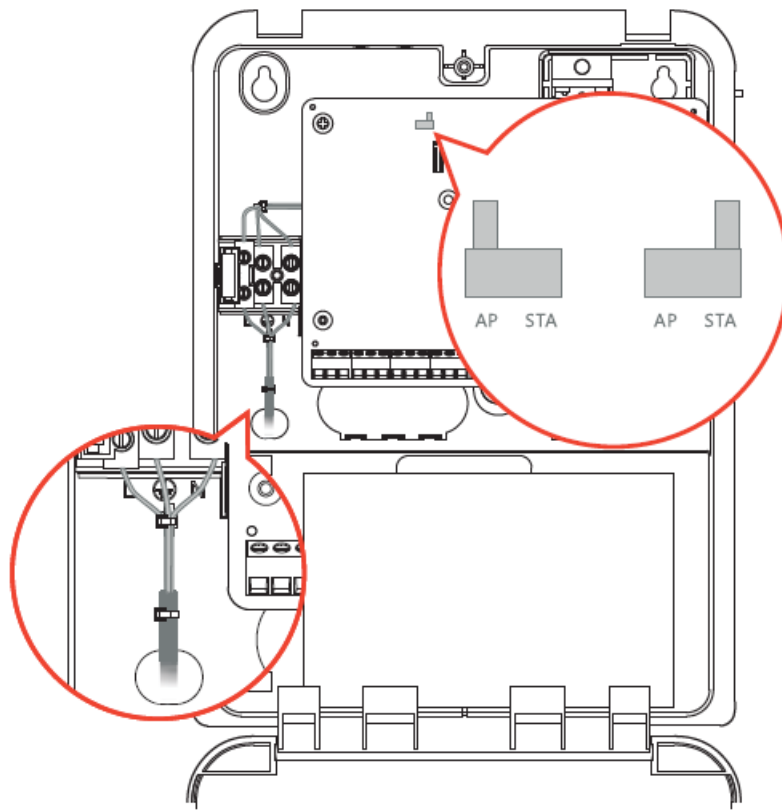
Note: Power down the control panel before wiring accessories and peripherals.

Peripherals/Power Supply Wiring

1. Alarm Input Wiring
 - a. NC Detector
 - b. NO Detector
 - c. Unoccupied Zone
 - d. Tamper-proof
 - e. Dual-Zone Series Connection
 - f. Dual-Zone Parallel Connection

5. Close and lock the case of the control panel.

Set-Up



Note: After the user connects the power cord according to the figure, fix it with a cable tie to avoid the cable falling off due to external force, causing a short circuit and other dangers.

Set up via Web Client

For more activation methods ,refer to the User Manual.

Default IP Address

Mobile browser(AP mode):192.168.8.1

1. Enter the device IP address in the web browser.
2. Create a password for admin account to activate the device.

Reset

After the device is started, hold the reset button for 10 seconds to reset the device.
The reset indicator will flash 3 times.

Specification

Model		DS-PHA64-P2	DS-PHA64-W4P2
Device connection	Detector	UP to 64 (8 on-board, 56 wired/wireless)	
	Relay output	Up to 64 (4 on-board, 60 wired/wireless)	
	RS-485 wireless receiver	Up to 7	
	Sounder	1 wired sounders (on-board connection) 2 wireless sounders	
	Keyfob	8	
Alarm input	Area	8	
Function	Network camera	N/A	4
Protocol	Protocol	ISAPI, DC09, ISUP, CSV-IP, EZVIZ	
Wi-Fi/AP	Standard	N/A	802.11b/g/n
User	User	Installer: 1; Administrator: 1; Maintenance: 1 Operator: 45	
	Tag/Card	12	
Others	Operation temperature	-10 °C to 55 °C (-4 °F to 122 °F)	
	Operation humidity	10% to 90% (No condensing)	
	Dimension (W × H × D)	310 mm (12.2") × 225 mm (8.6") × 95 mm (3.7")	
	Weight	1.15 kg	1.17 kg

Note

The 868 Mhz wireless sounder can be enrolled to the hybrid control panel via the wireless receiver that is at the address of 9.

Fuse Cutout: rated voltage 250 V, rated current 6 A.

Mains supply cables need to meet IEC 60332 or UL certification.

AUX+ output interface: DC12 V, 1000 mA.

BELL+ output interface: DC12 V, 500 mA.

Allowed batteries specifications:

rated voltage 12 V, capacity 7Ah, Min. charging current ≥ 1 A, flame class of shell V-0.

©2021 Hangzhou Hikvision Digital Technology Co., Ltd. All rights reserved.

About this Manual

The Manual includes instructions for using and managing the Product. Pictures, charts, images and all other information hereinafter are for description and explanation only. The information contained in the Manual is subject to change, without notice, due to firmware updates or other reasons. Please find the latest version of this Manual at the Hikvision website(<https://www.hikvision.com/>).

Please use this Manual with the guidance and assistance of professionals trained in supporting the Product. and other Hikvision's trademarks and logos are the properties of Hikvision in various jurisdictions. Other trademarks and logos mentioned are the properties of their respective owners.

Disclaimer

TO THE MAXIMUM EXTENT PERMITTED BY APPLICABLE LAW, THIS MANUAL AND THE PRODUCT

DESCRIBED, WITH ITS HARDWARE, SOFTWARE AND FIRMWARE, ARE PROVIDED “AS IS” AND “WITH ALL FAULTS AND ERRORS”. HIKVISION MAKES NO WARRANTIES, EXPRESS OR IMPLIED, INCLUDING WITHOUT LIMITATION, MERCHANTABILITY, SATISFACTORY QUALITY, OR FITNESS FOR A PARTICULAR PURPOSE. THE USE OF THE PRODUCT BY YOU IS AT YOUR OWN RISK. IN NO EVENT WILL HIKVISION BE LIABLE TO YOU FOR ANY SPECIAL, CONSEQUENTIAL, INCIDENTAL, OR INDIRECT DAMAGES, INCLUDING, AMONG OTHERS, DAMAGES FOR LOSS OF BUSINESS PROFITS, BUSINESS INTERRUPTION, OR LOSS OF DATA, CORRUPTION OF SYSTEMS, OR LOSS OF DOCUMENTATION, WHETHER BASED ON BREACH OF CONTRACT, TORT (INCLUDING NEGLIGENCE), PRODUCT LIABILITY, OR OTHERWISE, IN CONNECTION WITH THE USE OF THE PRODUCT, EVEN IF HIKVISION HAS BEEN ADVISED OF THE POSSIBILITY OF SUCH DAMAGES OR LOSS. YOU ACKNOWLEDGE THAT THE NATURE OF THE INTERNET PROVIDES FOR INHERENT SECURITY RISKS, AND HIKVISION SHALL NOT TAKE ANY RESPONSIBILITIES FOR ABNORMAL OPERATION, PRIVACY LEAKAGE OR OTHER DAMAGES RESULTING FROM CYBER-ATTACK, HACKER ATTACK, VIRUS INFECTION, OR OTHER INTERNET SECURITY RISKS; HOWEVER, HIKVISION WILL PROVIDE TIMELY TECHNICAL SUPPORT IF REQUIRED. YOU AGREE TO USE THIS PRODUCT IN COMPLIANCE WITH ALL APPLICABLE LAWS, AND YOU ARE SOLELY RESPONSIBLE FOR ENSURING THAT YOUR USE CONFORMS TO THE APPLICABLE LAW. ESPECIALLY, YOU ARE RESPONSIBLE, FOR USING THIS PRODUCT IN A MANNER THAT DOES NOT INFRINGE ON THE RIGHTS OF THIRD PARTIES, INCLUDING WITHOUT LIMITATION, RIGHTS OF PUBLICITY, INTELLECTUAL PROPERTY RIGHTS, OR DATA PROTECTION AND OTHER PRIVACY RIGHTS. YOU SHALL NOT USE THIS PRODUCT FOR ANY PROHIBITED END-USES, INCLUDING THE DEVELOPMENT OR PRODUCTION OF WEAPONS OF MASS DESTRUCTION, THE DEVELOPMENT OR PRODUCTION OF CHEMICAL OR BIOLOGICAL WEAPONS, ANY ACTIVITIES IN THE CONTEXT RELATED TO ANY NUCLEAR EXPLOSIVE OR UNSAFE NUCLEAR FUEL-CYCLE, OR IN SUPPORT OF HUMAN RIGHTS ABUSES. IN THE EVENT OF ANY CONFLICTS BETWEEN THIS MANUAL AND THE APPLICABLE LAW, THE LATER PREVAILS.



2012/19/EU (WEEE directive): Products marked with this symbol cannot be disposed of as unsorted municipal waste in the European Union. For proper recycling, return this product to your local supplier upon the purchase of equivalent new equipment, or dispose of it at designated collection points. For more information see: www.recyclethis.info



2006/66/EC (battery directive): This product contains a battery that cannot be disposed of as unsorted municipal waste in the European Union. See the product documentation for specific battery information. The battery is marked with this symbol, which may include lettering to indicate cadmium (Cd), lead (Pb), or mercury (Hg). For proper recycling, return the battery to your supplier or to a designated collection point. For more information see: www.recyclethis.info



This product and – if applicable – the supplied accessories too are marked with “CE” and comply therefore with the applicable harmonized European standards listed under the RE Directive 2014/53/EU, the EMC Directive 2014/30/EU, the LVD Directive 2014/35/EU, the RoHS Directive 2011/65/EU

FCC Information

Please take attention that changes or modification not expressly approved by the party responsible for compliance could void the user’s authority to operate the equipment.

FCC compliance: This equipment has been tested and found to comply with the limits for a Class B digital device, pursuant to part 15 of the FCC Rules. These limits are designed to provide reasonable protection against harmful interference in a residential installation. This equipment generates, uses and can radiate radio frequency energy and, if not installed and used in accordance with the instructions, may cause harmful interference to radio communications. However, there is no guarantee that interference will not occur in a particular installation. If this equipment does cause harmful interference to radio or television reception, which can be determined by turning the equipment off and on, the user is encouraged to try to correct the interference by one or more of the following measures:

- Reorient or relocate the receiving antenna.
- Increase the separation between the equipment and receiver.
- Connect the equipment into an outlet on a circuit different from that to which the receiver is connected.
- Consult the dealer or an experienced radio/TV technician for help.

This equipment should be installed and operated with a minimum distance 20cm between the radiator and your body.

FCC Conditions

This device complies with part 15 of the FCC Rules. Operation is subject to the following two conditions:

1. This device may not cause harmful interference.
2. This device must accept any interference received, including interference that may cause undesired operation

INSTALLATION CAUTION

1. The additional force shall be equal to three times the weight of the equipment but not less than 50N. The equipment and its associated mounting means shall remain secure during the installation. After the installation, the equipment, including any associated mounting plate, shall not be damaged.
2. Install the equipment according to the instructions in this manual.
3. To prevent injury, this equipment must be securely attached to the floor/wall in accordance with the installation instructions.

CAUTION

- indicates hazardous live and the external wiring connected to the terminals requires installation by an instructed person.
- This equipment is suitable for mounting on concrete or another non-combustible surface only. Copper or copper wire cannot be exposed at the electrical terminal.
- In the use of the product, you must be in strict compliance with the electrical safety regulations of the nation and region.
- **CAUTION:** To reduce the risk of fire, replace only with the same type and rating of fuse.
- A readily accessible disconnect device shall be incorporated external to the equipment, rated 6A.
- An all-pole mains switch shall be incorporated in the electrical installation of the building.
- Ensure correct wiring of the terminals for connection to an AC mains supply.
- The equipment has been designed when required, modified for connection to an IT power distribution system.
- No naked flame sources, such as lighted candles, should be placed on the equipment.
- The serial port of the equipment is used for debugging only.
- Keep downward when moving or using the equipment.

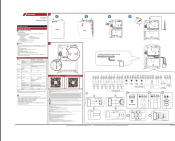
Battery Caution

1. This equipment is not suitable for use in locations where children are likely to be present.
2. **CAUTION:** Risk of explosion if the battery is replaced by an incorrect type.
3. Improper replacement of the battery with an incorrect type may defeat a safeguard (for example, in the case of some lithium battery types).

4. Do not dispose of the battery into fire or a hot oven, or mechanically crush or cut the battery, which may result in an explosion.
5. Do not leave the battery in an extremely high temperature surrounding environment, which may result in an explosion or the leakage of flammable liquid or gas.
6. Do not subject the battery to extremely low air pressure, which may result in an explosion or the leakage of flammable liquid or gas.
7. Dispose of used batteries according to the instructions.

Hangzhou Hikvision Digital Technology CO.,Ltd.
No.555 Qianmo Road, Binjiang District, Hangzhou 310052, China

Documents / Resources

	<p>HIKVISION DS-PHA64-P2 AX Hybrid [pdf] User Guide CP04016405132, 2ADTD-CP04016405132, 2ADTDCP04016405132, DS-PHA64-P2 AX Hybrid , DS-PHA64-W4P2 AX Hybrid, AX Hybrid</p>
---	---

[Manuals+](#).