



HiKOKI R 36DB Cordless Brush Cutter Instruction Manual

[Home](#) » [HiKOKI](#) » HiKOKI R 36DB Cordless Brush Cutter Instruction Manual 

HiKOKI

**R 36DB
Instruction Manual**

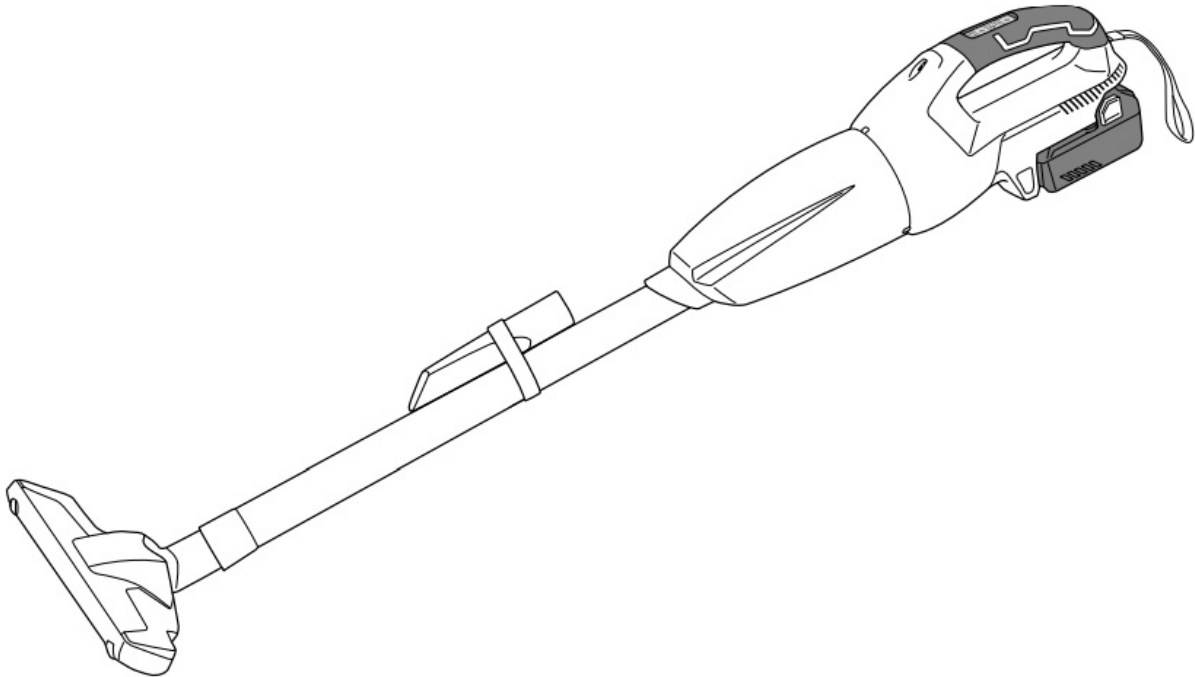

1

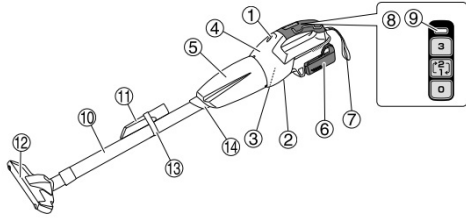

2

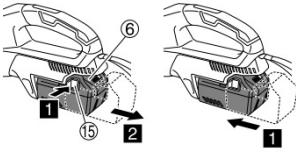

3

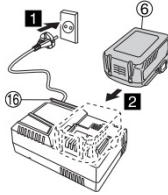

4

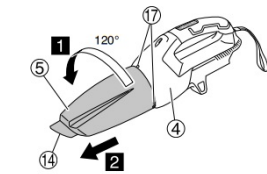

5

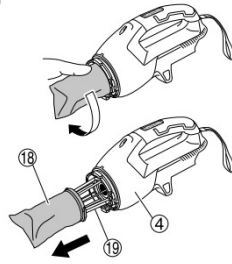

6

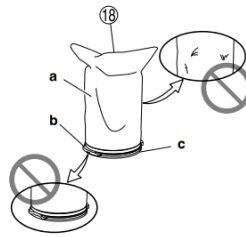

7

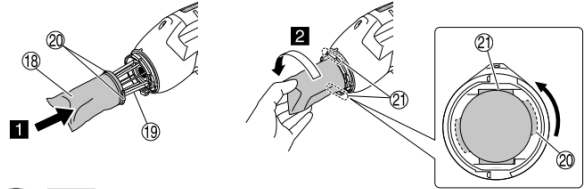

8

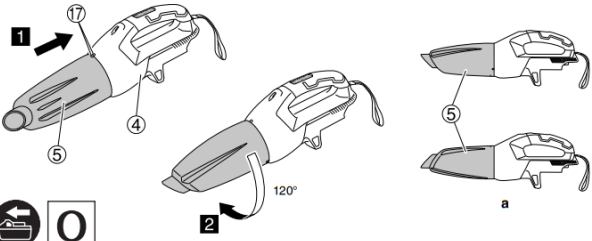

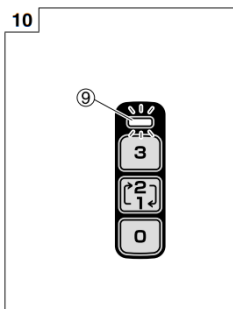
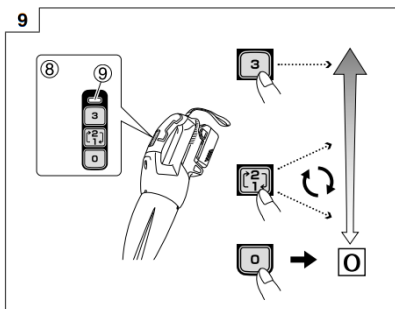

11

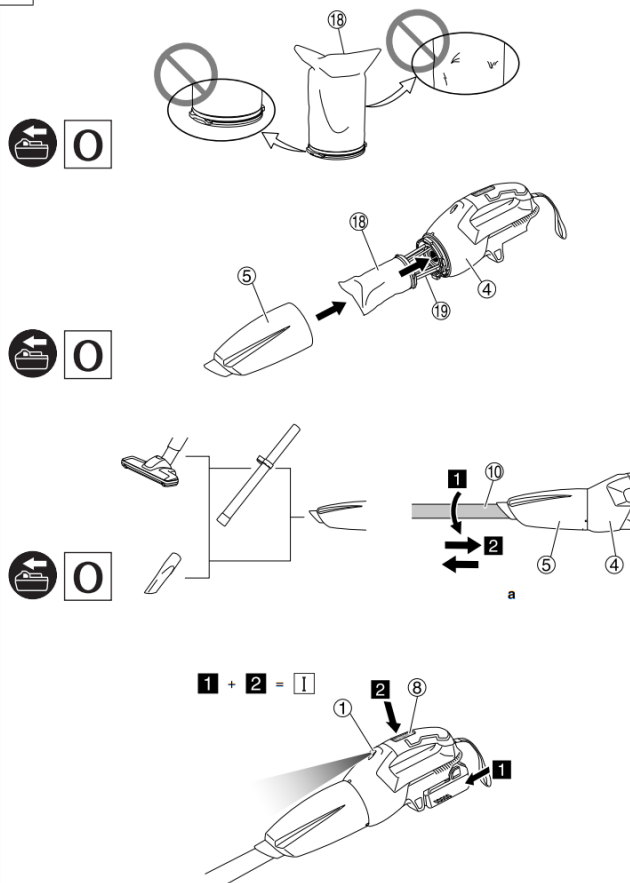

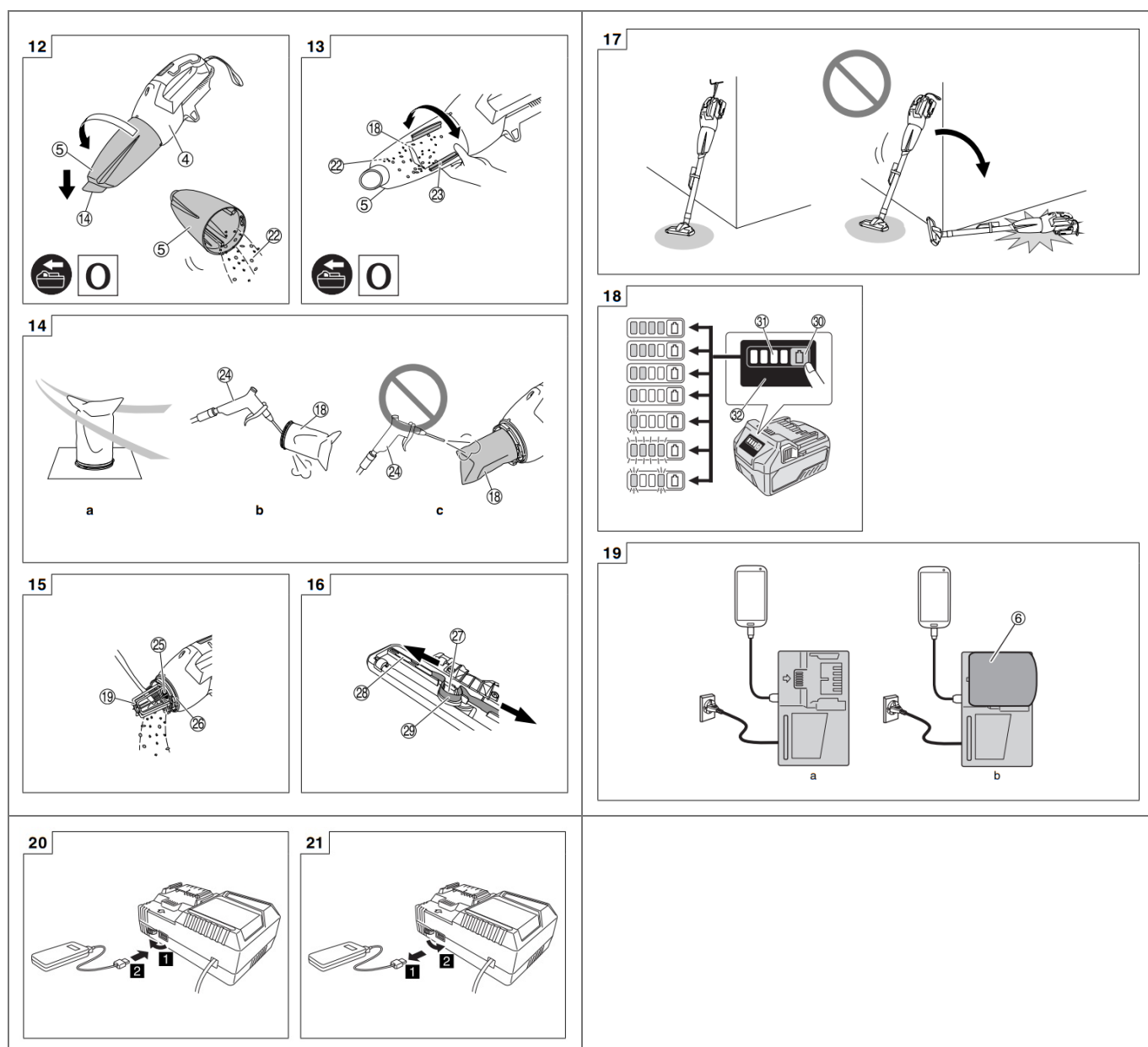

(Original Instructions)

Contents

- [1 SAFETY PRECAUTIONS FOR THE CORDLESS CLEANER](#)
- [2 ADDITIONAL SAFETY WARNINGS](#)
- [3 SPECIFICATIONS](#)
- [4 MOUNTING AND OPERATION](#)
- [5 MAINTENANCE AND INSPECTION](#)
- [6 TROUBLESHOOTING](#)
- [7 Documents / Resources](#)
- [8 Related Posts](#)

SAFETY PRECAUTIONS FOR THE CORDLESS CLEANER

○ In order to prevent accidents, such as fires, electric shock, and injuries, be sure to follow the “Safety Precautions” stated below.

○ Before use, read all of the “Safety Precautions” and use the appliance correctly according to the instructions.

○ Be sure to keep this instructions manual in a place where it can be consulted by the user at any time.

WARNING

1. Keep the workplace clean. A littered place or workbench may cause accidents.
2. Pay attention to the situation around the workplace as well. Make the workplace bright enough. Do not use the appliance in places with inflammable liquid or gas.
3. Keep children away. Do not let other persons than the operator touch the cleaner or the cord. Keep persons other than the operator away from the workplace.
4. Use the cleaner suitable for the work. Use the appliance only for the specified applications.
5. Do not handle the power cord roughly.
 - Do not carry the charger with only the power cord or pull the plug from the socket while holding the power cord.
 - Keep the power cord away from heat, oil, and sharp corners.
6. The cleaner should be maintained carefully. Replacement of accessories should follow the instructions manual. Regularly check the power cord of the charger and ask your local retailer or authorized servicing agent for repairs in the event of it being damaged. If an extension cord is used, check it periodically, and when damaged, replace it.
7. In the following cases, switch off the cleaner and disconnect the battery from the cleaner: The cleaner is not used or it is sent for repair. Accessories, such as an extension pipe and a filter, are replaced. The danger is expected.
8. Avoid sudden starting. Do not carry the appliance which is connected to the power supply with your finger placed on the switch. Confirm that the switch is off before inserting the battery.
9. Do the work with enough care. When you use the cleaner, pay attention to the handling method, how to do the work, the surrounding situation, etc., and perform the operation in a cautious manner.
10. Check for any damaged parts.
 - Before use, check for any damages in the protective cover or other parts and confirm whether the appliance operates normally and performs specified functions.
 - Check for any abnormalities in all places that may affect the operation, the position adjustment and clamping state of movable portions, damaged parts, or attachment state.
 - Replacement and repair of damaged protective cover and other parts should follow the provisions of the handling instructions. If there are no such provisions in the manual, please request a repair from your local retailer or authorized servicing agent.
 - If the switch fails, please request a repair from your local retailer or authorized servicing agent. Avoid using the cleaner which cannot be started or stopped by the switch.
11. Contact the specialty store for the repair of the cleaner.
 - Since this cleaner conforms to the corresponding safety standard, do not modify it.
 - Be sure to request a repair from your local retailer or authorized servicing agent. Self-repair may cause accidents or injuries.
12. This appliance can be used by children aged from 8 years and above and persons with reduced physical, sensory or mental capabilities or lack of experience and knowledge if they have been given supervision or instruction concerning the use of the appliance in a safe way and understand the hazards involved. Children shall not play with the appliance. Cleaning and user maintenance shall not be made by children without supervision.

PRECAUTIONS FOR USE OF THE CORDLESS CLEANER

The precautions common to the cleaners have been described. For the cleaners for electric tools, follow further

precautions described below:

WARNING

1. Prevent the appliance from sucking in the following:
 - O Liquids (e.g., water, oil) or damp debris.
 - O Generated spark during metal grinding or cutting.
 - O High-temperature things, such as a lighted cigarette.
 - O Inflammable substances (gasoline, thinner, benzene, kerosene, paint, etc.), explosive substances (nitroglycerine, etc.), combustible substances (aluminum, zinc, magnesium, titanium, red phosphorus, yellow phosphorus, celluloid, etc.)
 - O Sharp things, such as nails, razors, or glass.
 - O Solidification materials, such as cement powder and toner, and conductive fine dust, such as metal powder and carbon powder.
2. Set the filter correctly before use. Do not use the appliance without the filter or with it set in the wrong position, or do not use a torn filter. May cause failures, such as motor burnout.
3. Do not use the appliance with its suction opening, air inlet or exhaust opening obstructed. The temperature of the motor may rise abnormally, causing troubles such as deformation of parts or motor burnout.
4. Do not operate the appliance when its intake port or flooring nozzle, etc. is clogged with foreign matter. The temperature of the motor may rise abnormally, causing troubles such as deformation of parts or motor burnout.
5. Do not give a strong shock to the switch panel or break it. It may lead to trouble.
6. Do not look directly into the light. Such actions could result in eye injury. Wipe off any dirt or grime attached to the lens of the LED light with a soft cloth, being careful not to scratch the lens. Scratches on the lens of the LED light can result in decreased brightness.
7. When you drop or bump the appliance accidentally, check for breakage, crack, or deformation in the appliance. Breakage, crack or deformation may cause injuries.
8. When the appliance is out of condition or emits abnormal sound during use, immediately turn off the switch and request repair from your local retailer or authorized servicing agent. If you continue to use the appliance as it is, it may lead to injuries.
9. This appliance is only used indoors. Never use it outdoors. Do not use it in the rain. Keep away from water or oil. Malfunction may result as this appliance is not waterproof.

ADDITIONAL SAFETY WARNINGS

1. Always charge the battery at a temperature of 0°C-40°C. A temperature of less than 0°C will result in overcharging which is dangerous. The battery cannot be charged at a temperature higher than 40°C. The most suitable temperature for charging is that of 20°C-25°C.
2. Do not use the charger continuously. When one charging is completed, leave the charger for about 15 minutes before the next charging of the battery.
3. Do not allow foreign matter to enter the hole for connecting the rechargeable battery.
4. Never disassemble the rechargeable battery and charger.
5. Never short-circuit the rechargeable battery. Shortcircuiting the battery will cause a great electric current and overheating. It results in burn or damage to the battery.
6. Do not dispose of the battery in fire. If the battery is burnt, it may explode.
7. Bring the battery to the shop from which it was purchased as soon as the post-charging battery life becomes

too short for practical use. Do not dispose of the exhausted battery.

8. Do not insert objects into the air ventilation slots of the charger. Inserting metal objects or inflammable into the charger air ventilation slots will result in electrical shock hazards or damaged chargers.
9. When using this unit continuously, the unit may overheat, leading to damage to the motor and switch. Therefore, whenever the housing becomes hot, give the tool a break for a while.
10. Make sure that the battery is installed firmly. If it is at all lost it could come off and cause an accident.
11. Do not use the product if the tool or the battery terminals (battery mount) are deformed. Installing the battery could cause a short circuit that could result in smoke emission or ignition.
12. Keep the tool's terminals (battery mount) free of swarf and dust.
 - Prior to use, make sure that swarf and dust have not collected in the area of the terminals.
 - During use, try to avoid swarf or dust on the tool from falling on the battery.
 - When suspending operation or after use, do not leave the tool in an area where it may be exposed to falling swarf or dust. Doing so could cause a short circuit that could result in smoke emission or ignition.
13. Always use the tool and battery at temperatures between -5°C and 40°C.

CAUTION ON LITHIUM-ION BATTERY

To extend the lifetime, the lithium-ion battery equips with the protection function to stop the output. In the cases of 1 to 3 described below, when using this product, even if it is switched on, the motor may stop. This is not the trouble but the result of the protection function.

1. When the battery power remaining runs out, the motor stops. In such a case, charge it up immediately.
 2. If the tool is overloaded, the motor may stop. In this case, switch the tool off and eliminate the causes of overloading. After that, you can use it again.
 3. If the battery is overheated under overload work, the battery power may stop. In this case, stop using the battery and let the battery cool. After that, you can use it again.
- Furthermore, please heed the following warning and caution.

WARNING In order to prevent any battery leakage, heat generation, smoke emission, explosion, and ignition beforehand, please be sure to heed the following precautions.

1. Make sure that the swarf and dust do not collect on the battery.
 - During work makes sure that swarf and dust do not fall on the battery.
 - Make sure that any swarf and dust falling on the power tool during work do not collect on the battery.
 - Do not store an unused battery in a location exposed to swarf and dust.
 - Before storing a battery, remove any swarf and dust that may adhere to it, and do not store it together with metal parts (screws, nails, etc.).
2. Do not pierce the battery with a sharp object such as a nail, strike with a hammer, step on, throw or subject the battery to severe physical shock.
3. Do not use an apparently damaged or deformed battery.
4. Do not use the battery for a purpose other than those specified.
5. If the battery charging fails to complete even when a specified recharging time has elapsed, immediately stop further recharging.
6. Do not put or subject the battery to high temperatures or high pressure such as into a microwave oven, dryer, or high-pressure container.
7. Keep away from fire immediately when leakage or foul odor are detected.

8. Do not use in a location where strong static electricity generates.
9. If there is battery leakage, foul odor, heat generated, discolored or deformed, or in any way appears abnormal during use, recharging, or storage, immediately remove it from the equipment or battery charger, and stop using.
10. Do not immerse the battery or allow any fluids to flow inside. Conductive liquid ingress, such as water, can cause damage resulting in fire or explosion. Store your battery in a cool, dry place, away from combustible and flammable items. Corrosive gas atmospheres must be avoided.

CAUTION

1. If liquid leaking from the battery gets into your eyes, do not rub your eyes and wash them well with fresh clean water such as tap water and contact a doctor immediately. If left untreated, the liquid may cause eye problems.
2. If liquid leaks onto your skin or clothes, wash well with clean water such as tap water immediately. There is a possibility that this can cause skin irritation.
3. If you find rust, foul odor, overheating, discolor, deformation, and/or other irregularities when using the battery for the first time, do not use it and return it to your supplier or vendor.

WARNING If a conductive foreign matter enters the terminal of the lithium-ion battery, the battery may be shorted, causing a fire. When storing the lithium-ion battery, obey surely the rules of following contents.

○ Do not place conductive debris, nail, and wires such as iron wire and copper wire in the storage case.

○ To prevent shorting from occurring, load the battery in the tool or insert securely the battery cover for storing until the ventilator is not seen.

REGARDING LITHIUM-ION BATTERY TRANSPORTATION

When transporting a lithium-ion battery, please observe the following precautions.

WARNING Notify the transporting company that a package contains a lithium-ion battery, inform the company of its power output, and follow the instructions of the transportation company when arranging transport.

○ Lithium-ion batteries that exceed a power output of 100 Wh are considered to be in the freight classification of Dangerous Goods and will require special application procedures.

○ For transportation abroad, you must comply with international law and the rules and regulations of the destination country.

○ If the BSL36B18 is installed in the power tool, the power output will exceed 100 Wh and the unit will be classified as Dangerous Goods for freight classification.

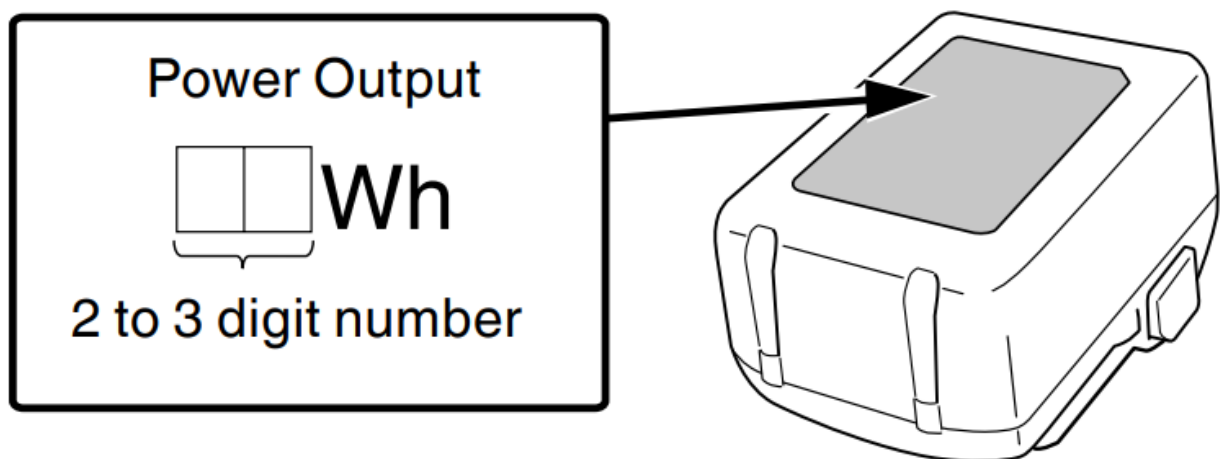

USB DEVICE CONNECTION PRECAUTIONS (UC18YSL3)

When an unexpected problem occurs, the data in a USB device connected to this product may be corrupted or lost. Always make sure to back up any data contained in the USB device prior to use with this product. Please be

aware that our company accepts absolutely no responsibility for any data stored in a USB device that is corrupted or lost, nor for any damage that may occur to a connected device.

WARNING

○ Prior to use, check the connecting USB cable for any defect or damage. Using a defective or damaged USB cable can cause smoke emission or ignition.

○ When the product is not being used, cover the USB port with the rubber cover. The buildup of dust etc. in the USB port can cause smoke emission or ignition.

NOTE

○ There may be an occasional pause during USB recharging.

○ When a USB device is not being charged, remove the USB device from the charger. Failure to do so may not only reduce the battery life of a USB device but may also result in unexpected accidents.

○ It may not be possible to charge some USB devices, depending on the type of device.





NAMES OF PARTS (Fig. 1-Fig. 21)





1	LED light	17	Protruding mark
2	Nameplate	18	Filter
3	Motor	19	Filter holder
4	Housing	20	Projection
5	Dust Case	21	Housing grooves
6	Battery	22	Dust
7	Strap	23	Dust Removal Blades (3 pcs) (Fixed to the inside of the dust case)
8	Switch panel	24	Air gun
9	Indicator Lamp	25	Fan filter

10	Extension Pipe	26	Also, clean the dust on the rail
11	Crevice Nozzle	27	Notch
12	Flooring Nozzle	28	Groove of rail
13	Nozzle Holder	29	Blade
14	Intake port	30	Remaining battery indicator switch
15	Latch	31	Remaining battery indicator lamp
16	Charge indicator lamp	32	Display panel





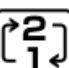
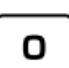

SYMBOLS

WARNING The following show symbols used for the machine. Be sure that you understand their meaning before use.

	R36DB: Cordless Cleaner
	To the reduce the riskthe of injury, the user must read the instruction manual.
	Only EU countries Do not dispose of electric tools together with household waste material! In observance of European Directive 2012/19/EU on waste electrical and electronic equipment and its implementation in accordance with national law, electric tools that have reached the end of their life must be collected separately and returned to an environmentally compatible recycling facility.
	Warning
	Switching ON

     	Switching OFF
	Disconnect the battery
	Prohibited action
	HIGH mode
	MID/LOW mode
	OFF button

Battery

	Lights ; The battery remaining power is over 75%
	Lights ; The battery's remaining power is 50%-75%.
	Lights ; The battery's remaining power is 25%-50%.
	Lights ; The battery remaining power is less than 25%
	Blinks ; The battery's remaining power is nearly empty. Recharge the battery soonest possible.
	Blinks ; Output suspended due to high temperature. Remove the battery from the tool and allow it to fully cool down.
	Blinks ; Output suspended due to failure or malfunction. The problem may be the battery so please contact your dealer.

STANDARD ACCESSORIES

In addition to the main unit (1 unit), the package contains the accessories listed on page 219. Battery and battery charger are not included with this product.

Standard accessories are subject to change without notice.

APPLICATIONS

0 Light-duty vacuuming of dry surfaces

SPECIFICATIONS

1. Power tool

Item/ Model		R36DB
Voltage		36 V
Application		Dry-type
Continuous operating time (Battery: using BSL36A18)	3 (HIGH)	Approx. 15 min
	2 (MID)	Approx. 30 min
	1 (LOW)	Approx. 60 min
Suction Work Rate		3 (HIGH) : Approx.155 W 2 (MID) : Approx. 65 W 1 (LOW) : Approx. 35 W
Dust collecting capacity		560 mL
Battery available for this tool'		Multi volt battery
Dimensions (W x D x H)		476 mm x 112 mm x 169 mm
Weight"		1.6 kg (BSL36A18) 1.9 kg (BSL36B18)

* Existing batteries (BSL3660/3626X/3626/3625/3620 BSL18.... and BSL14.... series) cannot be used with this tool.

** According to EPTA-Procedure 01/2014 The weight does not include accessories. NOTE Due to HiKOKI's continuing program of research and development, the specifications herein are subject to change without prior notice.

2. Battery (sold separately)

Model	BSL36A18
Voltage	36 V / 18 V (Automatic Switching')
Battery capacity	2.5 Ah/ 5.0 Ah (Automatic Switching')
Available cordless products"	Multi volt series, 18 V product
Available charger	Sliding charger for lithium-ion batteries

* The tool itself will automatically switch over.

** Please see our general catalog for details.

CHARGING

Before using the power tool, charge the battery as follows.

1. Connect the charger's power cord to the receptacle. When connecting the plug of the charger to a receptacle, the charge indicator lamp will blink in red (At 1- second intervals).
2. Insert the battery into the charger. Firmly insert the battery into the charger as shown in Fig. 3 (on page 2).
3. Charging

When inserting a battery into the charger, the charge indicator lamp will blink in blue. When the battery becomes fully recharged, the charge indicator lamp will light up in green. (See Table 1)

(1) Charge indicator lamp indication The indications of the charge indicator lamp will be as shown in Table 1, according to the condition of the charger or the rechargeable battery.

Table 1

Indications of the charge indicator lamp				
Charge indicator lamp (RED / BLUE / GREEN / PURPLE)	Before charging	Blinks (RED)	Lights for 0.5 seconds. Does not light for 0.5 seconds. (off for 0.5 seconds) ■■■■■	Plugged into power source
	While charging	Blinks (BLUE)	Lights for 0.5 seconds. Does not light for 1 second. (off for 1 second) ■■■■■	Battery capacity at less than 50%
		Blinks (BLUE)	Lights for 1 second. Does not light for 0.5 seconds. (off for 0.5 seconds) ■■■■■	Battery capacity at less than 80%
		Lights (BLUE)	Lights continuously ■■■■■	Battery capacity at more than 80%
	Charging complete	Lights (GREEN)	Lights continuously ■■■■■ (Continuous buzzer sound: about 6 seconds)	
	Overheat standby	Blinks (RED)	Lights for 0.3 seconds. Does not light for 0.3 seconds. (off for 0.3 seconds) ■■■■■	
	Charging impossible	Flickers (PURPLE)	Lights for 0.1 seconds. Does not light for 0.1 seconds. (off for 0.1 seconds) ■■■■■ (Intermittent buzzer sound: about 2 seconds)	Malfunction in the battery or the charger

(2) Regarding the temperatures and charging time of the rechargeable battery The temperatures and charging time will become as shown in Table 2.

Table 2

Charger			UC18YSL3				
Battery	Type of battery		Li-ion				
	Temperatures at which the battery can be recharged		0°C–50°C				
	Charging voltage	V	14.4		18		
	Charging time, approx. (At 20°C)	min	BSL14xx series		BSL18xx series		Multi volt series
			(4 cells)	(8 cells)	(5 cells)	(10 cells)	(10 cells)
			BSL1415S : 15 BSL1415 : 15 BSL1415X : 15 BSL1420 : 20 BSL1425 : 25 BSL1430C : 30	BSL1430 : 20 BSL1440 : 26 BSL1450 : 32 BSL1460 : 38	BSL1815S : 15 BSL1815 : 15 BSL1815X : 15 BSL1820 : 20 BSL1820M : 20 BSL1825 : 25 BSL1830C : 30 BSL1850C : 32	BSL1830 : 20 BSL1840 : 26 BSL1850 : 32 BSL1860 : 38	BSL36A18 : 32 BSL36B18 : 52
USB	Charging voltage	V	5				
	Charging current	A	2				

NOTE

The recharging time may vary according to the ambient temperature and power source voltage.

4. Disconnect the charger's power cord from the receptacle.

5. Hold the charger firmly and pull out the battery.

NOTE

Be sure to pull out the battery from the charger after use, and then keep it.

Regarding electric discharge in case of new batteries, etc.

As the internal chemical substance of new batteries and batteries that have not been used for an extended period is not activated, the electric discharge might be low when using them the first and second time. This is a temporary phenomenon, and the normal time required for recharging will be restored by recharging the batteries 2-3 times.

How to make the batteries perform longer.

1. Recharge the batteries before they become completely exhausted. When you feel that the power of the tool becomes weaker, stop using the tool and recharge its battery. If you continue to use the tool and exhaust the electric current, the battery may be damaged and its life will become shorter.
2. Avoid recharging at high temperatures. A rechargeable battery will be hot immediately after use. If such a battery is recharged immediately after use, its internal chemical substance will deteriorate, and the battery life will be shortened. Leave the battery and recharge it after it has cooled for a while.

CAUTION

○ If the battery is charged while it is heated because it has been left for a long time in a location subject to direct sunlight or because the battery has just been used, the charge indicator lamp of the charger lights for 0.3 seconds, does not light for 0.3 seconds (off for 0.3 seconds). In such a case, first, let the battery cool, then start charging.

○ When the charge indicator lamp flickers (at 0.2-second intervals), check for and take out any foreign objects in the charger's battery connector. If there are no foreign objects, it is probable that the battery or charger is malfunctioning. Take it to your authorized Service Center.

MOUNTING AND OPERATION

Action	Figure	Page
Removing and inserting the battery (sold separately)	2	2
Charging	3	2
Dismounting the dust case	4	2
Dismounting the filter	5	2
Check the filter''	6	3
Mounting the filter'2	7	3
Mounting the dust case*3	8	3
Switch operation%	9	4
How to use	11	5
Emptying the dust case*6	12	6
Effectively removing dust '7	13	6
Remaining battery indicator	18	7
Charging a USB device from an electrical outlet	19-a	7
Charging a USB device and battery from an electrical outlet	19-b	7
How to recharge a USB device	20	8
When charging of USB device is completed	21	8
Selecting accessories	—	220

1. a. Filter free of debris and dust
b. The rubber did not deteriorate
c. Connector free of damage
2. If the filter is not properly fitted, dirt or grime can enter the fan unit and cause damage or malfunction.
3. The dust case can also be installed with the nozzle facing upwards. (Fig. 8-a)
- 4.

Mode	Continuous operating time
	BSL36A18
3 (HIGH)	Approx. 15 min
2 (MID)	Approx. 30 min
1 (LOW)	Approx. 60 min

* Continuous operating time will vary according to battery condition. Please use the table as a guideline.

NOTE

O To suppress noise when using the appliance, switch to 1 mode.

- When using 3 mode on certain surfaces, the suction force may make the action feel heavy. If this occurs, switch to 2 or 1 mode instead.
- 5. When attaching the nozzle or extension pipe, insert as you twist in the direction indicated by the arrow. Twist in the direction indicated by the arrow when detaching as well. (Fig. 11-a) Twisting in the opposite direction could result in detaching the dust case from the housing.
- 6. **NOTE**
 - Point the intake port downward as dust can spill when removing the dust case.
 - If the suction does not recover after disposing the dust, clean the filter. (See “Cleaning the filter” on page 15.)
- 7. The appliance has a built-in mechanism for scraping off dust attached to the filter when removing the dust case. To even more effectively scrape off the dust, repeatedly turn the dust case back and forth (2 to 3 times or more). Holding the unit so that the dust case does not detach from the housing, slightly and repeatedly turn the dust case in the indicated directions.

THE INDICATOR LAMP (Fig. 10)

Notice about filter cleaning If the filter becomes clogged and suction power decreases, the indicator lamp will flash. And the main unit will make a pulsing sound. However, this is not a sign of fault. If this happens, promptly empty the dust case and clean the filter. (See Fig. 12, Fig. 13, and “MAINTENANCE AND INSPECTION” on page 15.)

Notice about intake port blockage

If the intake port becomes blocked during use—for example while vacuuming carpets – the main unit will make a pulsing sound, and the indicator lamp will flash. However, this is not a sign of fault. Clear the blockage from the intake port if this happens.

NOTE If running continuously when the filter becomes clogged or the intake port becomes blocked, the appliance will stop running by temperature protection of the motor.

MAINTENANCE AND INSPECTION

WARNING

- For inspection and maintenance, be sure to turn off the switch and disconnect the battery.
- Do not work with wet hands. May cause electric shock or injuries.

1. Cleaning the filter

If the vacuuming efficiency is poor even when the dust case has been emptied, remove the filter and wash it in cold or warm water. (The water should not be hot to the touch.) After washing, dry out of direct sunlight. (Fig. 14-a) Alternatively, blow off any debris attached to the filter from the inside toward the outside with an air gun or something similar. (Fig. 14-b) Air pressure: General pressure (about 0.6 MPa)

NOTE

- Do not wash the filter in a washing machine.
- Do not wash the filter in hot water or dry it by fire.
- Do not detach the fan filter and the filter holder.
- Do not use an air gun or similar tool to clean the filter, fan filter, or the appliance itself. (Fig. 14-c) Doing so could push dirt into the appliance and cause malfunction.

2. Cleaning the fan filter

If there is dust on the fan filter, hold the cleaner with the fan filter pointing downwards to keep dust from entering the motor and lightly clean with a small brush such as a used toothbrush. Do not brush vigorously. (Fig. 15)

3. Inspecting the flooring nozzle

Inspect the flooring nozzle to confirm that its blade is not dislodged. If the blade is dislodged, press it in until it catches on the projection. Using with the blade dislodged may cause stains. When replacing the blade, insert it starting from the notch in the rail, and thread it along the groove. Ensure there is no sagging throughout. (Fig. 16)

4. Inspecting the mounting screws

Regularly inspect all mounting screws and ensure that they are properly tightened. Should any of the screws be loose, retighten them immediately. Failure to do so could result in serious hazards.

5. Maintenance of the motor

The motor unit winding is the very “heart” of the power tool. Exercise due care to ensure the winding does not become damaged and/or wet with oil or water.

6. Inspection of terminals (tool and battery)

Check to make sure that swarf and dust have not been collected on the terminals. On occasion check prior, during, and after the operation.

CAUTION Remove any swarf or dust which may have collected on the terminals. Failure to do so may result in malfunction.

7. Cleaning of the outside When the tool is stained, wipe with a soft dry cloth or a cloth moistened with soapy water. Do not use chloric solvents, gasoline, or paint thinner, as they melt plastics.

8. Storage Store the power tool and the battery in a place in which the temperature is less than 40°C and out of reach of children. When storing the appliance in a vertical position, hook the strap to a hanger.

NOTE

○ Do not store it in a location where children can easily reach or take out the appliance.

○ Do not store in a damp location or in an area exposed to rainfall.

○ Do not store in direct sunlight or in a location where temperatures may suddenly change

○ Do not store in a location with volatile materials that could ignite or explode.

○ Do not stand the appliance against a wall without using the strap to fix it in place. (Fig. 17) Failure to do so may result in damage from a fall.

○ Storing lithium-ion batteries. Make sure the lithium-ion batteries have been fully charged before storing them. Prolonged storage (3 months or more) of batteries with a low charge may result in performance deterioration, significantly reducing battery usage time or rendering the batteries incapable of holding a charge. However, significantly reduced battery usage time may be recovered by repeatedly charging and using the batteries two to five times. If the battery usage time is extremely short despite repeated charging and use, consider the batteries dead and purchase new batteries.

CAUTION

In the operation and maintenance of power tools, the safety regulations, and standards prescribed in each country must be observed.

Important notice on the batteries for the HiKOKI cordless power tools

Please always use one of our designated genuine batteries. We cannot guarantee the safety and performance of our cordless power tool when used with batteries other than those designated by us, or when the battery is disassembled and modified (such as disassembly and replacement of cells or other internal parts).

GUARANTEE

We guarantee HiKOKI Power Tools in accordance with statutory/country-specific regulations. This guarantee does not cover defects or damage due to misuse, abuse, or normal wear and tear. In case of a complaint, please send the Power Tool, undismantled, with the GUARANTEE CERTIFICATE found at the end of this Handling instruction,

to a HiKOKI Authorized Service Center.

TROUBLESHOOTING

Use the inspections in the table below if the tool does not operate normally. If this does not remedy the problem, consult your dealer or the HiKOKI Authorized Service Center.

1. Power tool

Symptom	Possible cause	Remedy
The tool doesn't run	No remaining battery power	Charge the battery.
Tool suddenly stopped	Fan clogged with dust, causing overload	Contact the place of purchase and arrange for dismantling and cleaning.
	The battery is overheated.	Let the battery cool down.
	The motor is overheated.	Dispose of the dust and clean the filter. And then let the motor cool down.
Poor suction	The dust case is full.	Dispose of the dust.
	The nozzle is plugged.	Remove the obstruction.
	The nozzle or extension pipe is loose.	Firmly tighten the unit.
	Nozzle or extension pipe is cracked or damaged.	Exchange the unit with a new one.
	The filter is clogged.	Turn the dust case and scrape off dust with a dust removal blade, or remove the filter and lightly strike it or wash with water.
Exhaust or the main unit is hot	The motor is overheating because the dust case is full, or the filter is clogged.	Dispose of the dust. Or else, clean the filter.
Abnormal noise/foul odor	Filter is not properly installed, resulting in foreign matter getting into the motor.	Remove the dust case, point the intake port downward and gently shake to remove foreign matter and dust. Should abnormal noise/foul odor persist, the motor may be damaged? Immediately discontinue use and arrange for repairs.
The battery cannot be installed	Attempting to install a battery other than that specified for the tool.	Please install a multi-volt type battery.

2. Charger

Symptom	Possible cause	Remedy
The charge indicator lamp rapidly flickers purple, and battery charging doesn't begin.	The battery is not inserted all the way.	Insert the battery firmly.
	There is foreign matter in the battery terminal or where the battery is attached.	Remove the foreign matter.
The charge indicator lamp blinks red, and battery charging doesn't begin.	The battery is not inserted all the way.	Insert the battery firmly.
	The battery is overheated.	If left alone, the battery will automatically begin charging if its temperature decreases, but this may reduce battery life. It is recommended that the battery be cooled in a well-ventilated location away from direct sunlight before charging it.
Battery usage time is short even though the battery is fully charged.	The battery's life is depleted.	Replace the battery with a new one.
The battery takes a long time to charge.	The temperature of the battery, the charger, or the surrounding environment is extremely low.	Charge the battery indoors or in another warmer environment.
	The charger's vents are blocked, causing its internal components to overheat.	Avoid blocking the vents.
	The cooling fan is not running.	Contact a HiKOKI Authorized Service Center for repairs.
The USB power lamp has switched off and the USB device has stopped charging.	The battery's capacity has become low.	Replace the battery with one that has capacity remaining.
		Plug the charger's power plug into an electric socket.
The USB power lamp does not switch off even though the USB device has finished charging.	The USB power lamp lights up green to indicate that USB charging is possible.	This is not a malfunction.
It is unclear what the charging status of a USB device is, or whether its charging is complete.	The USB power lamp does not switch off even when charging is complete.	Examine the USB device that is charging to confirm its charging status.
The charging of a USB device pauses midway.	The charger was plugged into an electrical socket while the USB device was being charged using the battery as the power source.	This is not a malfunction. The charger pauses USB charging for about 5 seconds when it is differentiating between power sources.
	A battery was inserted into the charger while the USB device was being charged using a power socket as the power source.	

Charging of the USB device pauses midway when the battery and the USB device are being charged at the same time.	The battery has become fully charged.	This is not a malfunction. The charger pauses USB charging for about 5 seconds while it checks whether the battery has successfully completed charging.
Charging of the USB device doesn't start when the battery and the USB device are being charged at the same time.	The remaining battery capacity is extremely low.	This is not a malfunction. When the battery capacity reaches a certain level, USB charging automatically begins.

EC DECLARATION OF CONFORMITY

We declare under our sole responsibility that Cordless Cleaner, identified by type and specific identification code *1), is in conformity with all relevant requirements of the directives *2) and standards *3). Technical file at *4) – See below.

The European Standard Manager at the representative office in Europe is authorized to compile the technical file. The declaration is applicable to the product affixed CE marking.

1. R36DB C362756S
2. 2014/35/EU, 2014/30/EU, 2011/65/EU
3. EN60335-1:2012+A11:2014
EN60335-2-2:2010+A1:2013
EN60335-2-29:2004+A2:2010
EN55014-1:2006+A1:2009+A2:2011
EN55014-2:1997+A1:2001+A2:2008
4. Representative office in Europe

Hikoki Power Tools Deutschland GmbH

Siemensring 34, 47877 Willich, Germany

Head office in Japan

Koki Holdings Co., Ltd.

Shinagawa Intercity Tower A, 15-1, Konan 2-chome, Minato-ku, Tokyo, Japan

31. 5.2022 Akihisa Yahagi European Standard Manager



31. 5. 2022

A Nakagawa

A. Nakagawa
Corporate Officer

Koki Holdings Co., Ltd.

205 Code No. C99745571 G Printed in China

Documents / Resources

HIKOKI

R 36DB



1. Safety Precautions
2. Operation
3. Maintenance
4. Troubleshooting
5. Specifications
6. Accessories
7. Warranty
8. Contact Information

[HiKOKI R 36DB Cordless Brush Cutter](#) [pdf] Instruction Manual

R 36DB, Cordless Brush Cutter, R 36DB Cordless Brush Cutter