



HiKOKI Dust Extractor System for Rotary Hammer Instruction Manual

[Home](#) » [HiKOKI](#) » HiKOKI Dust Extractor System for Rotary Hammer Instruction Manual 

HiKOKI Dust Extractor System for Rotary Hammer Instruction Manual



Contents

1 Handling instructions

1.1 GENERAL POWER TOOL SAFETY WARNINGS

2 DUST EXTRACTOR SYSTEM SAFETY WARNINGS

3 NAMES OF PARTS (Fig. 1–Fig. 20)

4 OPTIONAL ACCESSORIES (sold separately)

5 APPLICATIONS

6 SPECIFICATIONS

7 HOW TO USE

8 MAINTENANCE AND INSPECTION

9 TROUBLESHOOTING

10 Documents / Resources

10.1 References

11 Related Posts

Handling instructions

GENERAL POWER TOOL SAFETY WARNINGS

WARNING

Read all safety warnings, instructions, illustrations and specifications provided with this power tool. Failure to follow all instructions listed below may result in electric shock, fire and/or serious injury.

Save all warnings and instructions for future reference.

The term “power tool” in the warnings refers to your mainsoperated (corded) power tool or battery-operated (cordless) power tool.

1. Work area safety

1. a) Keep work area clean and well lit. Cluttered or dark areas invite accidents.
2. b) Do not operate power tools in explosive atmospheres, such as in the presence of flammable liquids, gases or dust. Power tools create sparks which may ignite the dust or fumes.
3. c) Keep children and bystanders away while operating a power tool.
Distractions can cause you to lose control.

2. Electrical safety

- a) Power tool plugs must match the outlet. Never modify the plug in any way. Do not use any adapter plugs with earthed (grounded) power tools. nmodified plugs and matching outlets will reduce risk of electric shock.
- b) Avoid body contact with earthed or grounded surfaces, such as pipes, radiators, ranges and refrigerators. There is an increased risk of electric shock if your body is earthed or grounded.
- c) Do not expose power tools to rain or wet conditions. Water entering a power tool will increase the risk of electric shock.
- d) Do not abuse the cord. Never use the cord for carrying, pulling or unplugging the power tool. Keep cord away from heat, oil, sharp edges or moving parts. Damaged or entangled cords increase the risk of electric shock. e) When operating a power tool outdoors, use an extension cord suitable for outdoor use.

Use of a cord suitable for outdoor use reduces the risk of electric shock.

- **f)** If operating a power tool in a damp location is unavoidable, use a residual current device (RCD) protected supply. Use of an RCD reduces the risk of electric shock.

3. Personal safety

1. **a)** Stay alert, watch what you are doing and use common sense when operating a power tool.
Do not use a power tool while you are tired or under the influence of drugs, alcohol or medication.
A moment of inattention while operating power tools may result in serious personal injury.
2. **b)** Use personal protective equipment. Always wear eye protection. Protective equipment such as a dust mask, non-skid safety shoes, hard hat or hearing protection used for appropriate conditions will reduce personal injuries.
3. **c)** Prevent unintentional starting. Ensure the switch is in the off -position before connecting to power source and/or battery pack, picking up or carrying the tool. Carrying power tools with your finger on the switch or energising power tools that have the switch on invites accidents.
4. **d)** Remove any adjusting key or wrench before turning the power tool on. A wrench or a key left attached to a rotating part of the power tool may result in personal injury.
5. **e)** Do not overreach. Keep proper footing and balance at all times. This enables better control of the power tool in unexpected situations.
6. **f)** Dress properly. Do not wear loose clothing or jewellery. Keep your hair and clothing away from moving parts. Loose clothes, jewellery or long hair can be caught in moving parts.
7. **g)** If devices are provided for the connection of dust extraction and collection facilities, ensure these are connected and properly used. Use of dust collection can reduce dust-related hazards.
8. **h)** Do not let familiarity gained from frequent use of tools allow you to become complacent and ignore tool safety principles. A careless action can cause severe injury within a fraction of a second.

4. Power tool use and care

- **a)** Do not force the power tool. Use the correct power tool for your application. The correct power tool will do the job better and safer at the rate for which it was designed.
- **b)** Do not use the power tool if the switch does not turn it on and off . Any power tool that cannot be controlled with the switch is dangerous and must be repaired.
- **c)** Disconnect the plug from the power source and/ or remove the battery pack, if detachable, from the power tool before making any adjustments, changing accessories, or storing power tools. Such preventive safety measures reduce the risk of starting the power tool accidentally.
- **d)** Store idle power tools out of the reach of children and do not allow persons unfamiliar with the power tool or these instructions to operate the power tool.
Power tools are dangerous in the hands of untrained users.
- **e)** Maintain power tools and accessories. Check for misalignment or binding of moving parts, breakage of parts and any other condition that may affect the power tool's operation. If damaged, have the power tool repaired before use.
Many accidents are caused by poorly maintained power tools.
- **f)** Keep cutting tools sharp and clean. Properly maintained cutting tools with sharp cutting edges are less likely to bind and are easier to control.
- **g)** Use the power tool, accessories and tool bits etc. in accordance with these instructions, taking into account the working conditions and the work to be performed. Use of the power tool for operations different from those intended could result in a hazardous situation.
- **h)** Keep handles and grasping surfaces dry, clean

and free from oil and grease.

Slippery handles and grasping surfaces do not allow for safe handling and control of the tool in unexpected situations.

5. Battery tool use and care

- **a)** Recharge only with the charger specified by the manufacturer.
A charger that is suitable for one type of battery pack may create a risk of fire when used with another battery pack.
- **b)** Use power tools only with specifically designated battery packs. Use of any other battery packs may create a risk of injury and fire.
- **c)** When battery pack is not in use, keep it away from other metal objects, like paper clips, coins, keys, nails, screws or other small metal objects, that can make a connection from one terminal to another. Shorting the battery terminals together may cause burns or a fire.
- **d)** Under abusive conditions, liquid may be ejected from the battery; avoid contact. If contact accidentally occurs, flush with water. If liquid contacts eyes, additionally seek medical help. Liquid ejected from the battery may cause irritation or burns.
- **e)** Do not use a battery pack or tool that is damaged or modified. Damaged or modified batteries may exhibit unpredictable behaviour resulting in fire, explosion or risk of injury.
- **f)** Do not expose a battery pack or tool to fire or excessive temperature. Exposure to fire or temperature above 130°C may cause explosion.
- **g)** Follow all charging instructions and do not charge the battery pack or tool outside the temperature range specified in the instructions. Charging improperly or at temperatures outside the specified range may damage the battery and increase the risk of fire.

6. Service

- **a)** Have your power tool serviced by a qualified repair person using only identical replacement parts. This will ensure that the safety of the power tool is maintained.
- **b)** Never service damaged battery packs. Service of battery packs should only be performed by the manufacturer or authorized service providers.

PRECAUTION

Keep children and infirm persons away.

When not in use, tools should be stored out of reach of children and infirm persons.

DUST EXTRACTOR SYSTEM SAFETY WARNINGS

1. Before using the rotary hammer, be sure to read its instruction manual carefully.
2. Do not use the tool for any purposes other than those specified.
3. Follow the instruction manual when attaching the dust extractor system to the rotary hammer, and when cleaning the dust extractor system, changing its filter, etc.
4. Use only the accessories and attachments that are specified in this instruction manual and our company's catalogs.
5. Substances such as silica and asbestos are harmful to the human body. Perform anti-dust measures when

working with materials that contain such substances.

6. Wear safety goggles and a dust mask.
7. If any tools or equipment are accidentally dropped or bumped, carefully inspect them to make sure there is no damage, cracks, or deformation. Using tools or equipment with damage, cracks, or deformation may result in injury.

NAMES OF PARTS (Fig. 1–Fig. 20)

1. Nozzle
2. Dust housing
3. Depth adjustment button
4. Slider
5. Nozzle adjustment button
6. Dust box
7. Dust box latch (both side)
8. Filter (internal)
9. Tool bit (drill bit)
10. Battery
11. Dust extractor system rail
12. Rail slot
13. Dust box cover
14. Cyclone chamber
15. Filter chamber
16. Latch (Filter cover)
17. Cylindrical protrusion
18. Round cavity
19. Nozzle seal
20. Notch in nozzle seal
21. Bump on nozzle seal
22. Groove in brush cap
23. C-ring

SYMBOLS

WARNING

The following show symbols used for the machine. Be sure that you understand their meaning before use.

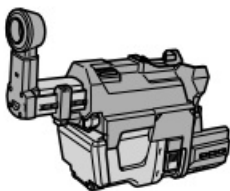

• Dust Extractor System



- To reduce the risk of injury, user must read instruction manual.



- Only for EU countries Do not dispose of electric tools together with household waste material!
In observance of European Directive 2012/19/EU on waste electrical and electronic equipment and its implementation in accordance with national law, electric tools that have reached the end of their life must be collected separately and returned to an environmentally compatible recycling facility.



- Direct current
- V: Rated voltage



- If the power tool is cordless, remove the tool's battery. If the power tool uses a cord, disconnect the tool's plug.



- Switching ON



- Switching OFF



- Disconnect the drilling tool



- Warning



- Prohibited action

OPTIONAL ACCESSORIES (sold separately)

- Filter Replace the filter about once every 100 times the dust extractor system becomes full. Code No. 379717

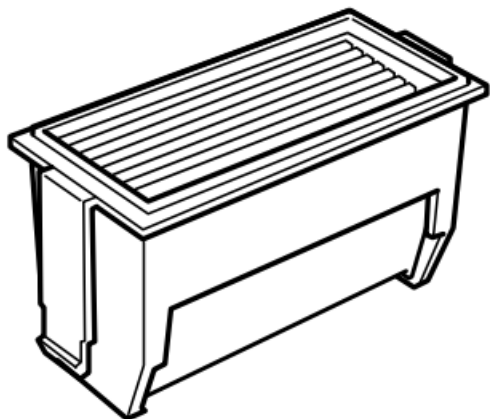

- Dust box Code No. 379714

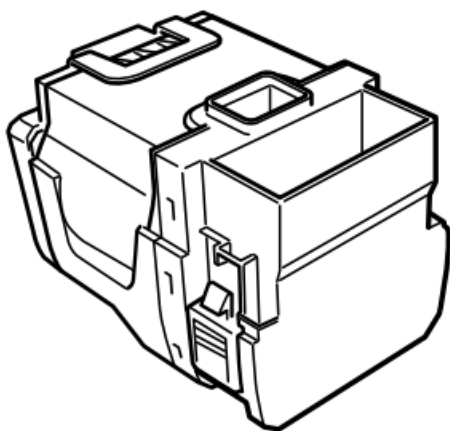

- Nozzle seal Replace this part if it becomes cracked or damaged, or if it loses its elasticity. Code No. 3

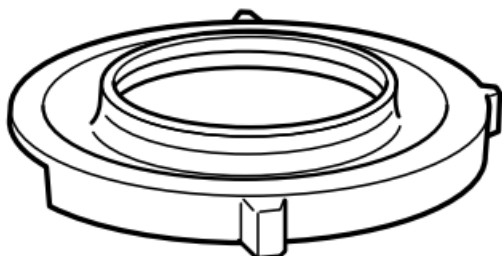

- Brush cap Replace this part if the bristles are falling out or becoming shorter from friction. Code No. 370496

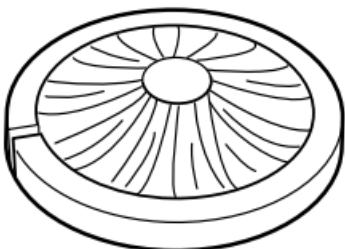

- Deltagon bit (SDS plus shank)



- Drill bit (SDS plus shank)

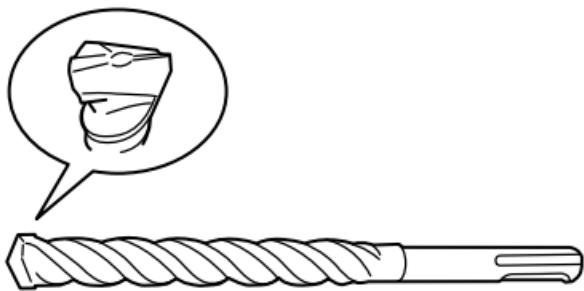

Optional accessories are subject to change without notice.

APPLICATIONS

Dust extractor system specialized for drilling concrete, for use with the following HiKOKI rotary hammers: DH3628DA / DH3628DC / DH1826DA / DH1826DC

For details regarding the latest available rotary hammers, check our general catalogue and othormation.

NOTE

This dust extractor system is only to be used for drilling concrete.

SPECIFICATIONS

Model	Dust Extractor System	
Supported models	DH3628DA DH1826DA	DH3628DC DH1826DC
Dust box capacity	0.45 L	
Max. stroke	100 mm	
Max. hole-drilling depth	85 mm	
Diameter of drill	4.3–20 mm	
Max. length of drill (effective length)	100 mm or shorter	
Dimensions (W x H x D)	105 × 243 × 366 mm	105 × 243 × 399 mm
Weight	1.0 kg	1.0 kg

HOW TO USE

Attaching and removing the dust extractor system **WARNING**

- When attaching, removing, or adjusting the dust extractor system, in order to prevent an unlikely accident, be sure to turn off the tool's switch, and remove the tool's battery and tool bit. (Fig. 2)
- Make sure the dust extractor system is fully attached. If not fully attached, the dust extractor system could come loose and result in injury.

Insert the tool rail slot into the dust extractor system rail, and push in until a click is heard. (Fig. 3)

3

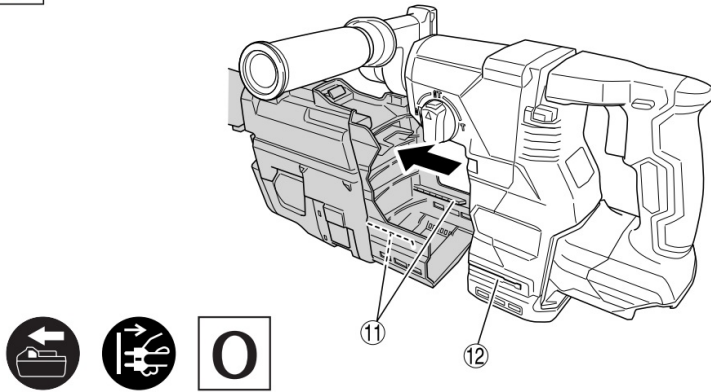

Removing the dust extractor system> Hold the handle with one hand, and press the button while gripping the dust extractor system slider in your other hand to remove it. (Fig. 4)

4

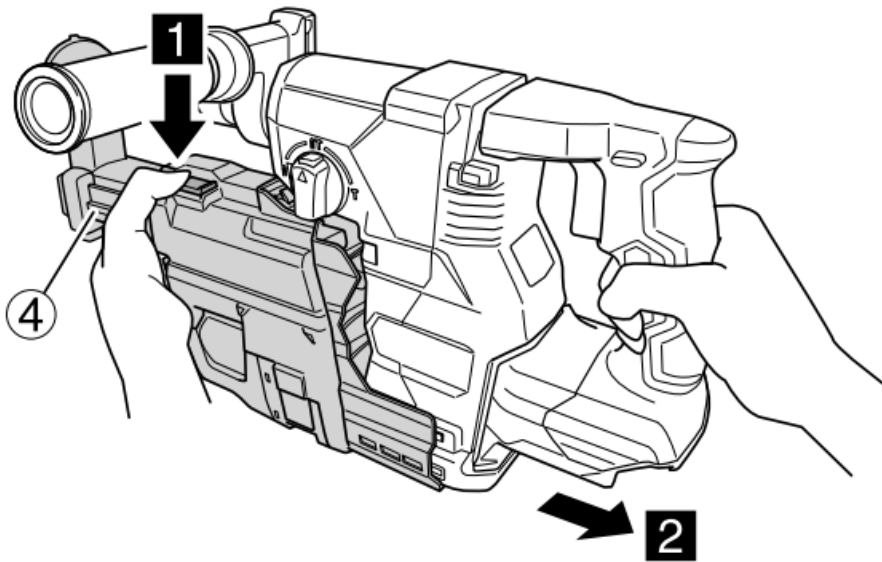

Adjusting the nozzle position

NOTE

If the nozzle position adjustment button is pressed to release the lock while the nozzle is in any position other than fully extended, the nozzle may pop outward.

1. Press the nozzle position adjustment button and ensure that the nozzle is in the fully extended position. (Fig. 5)

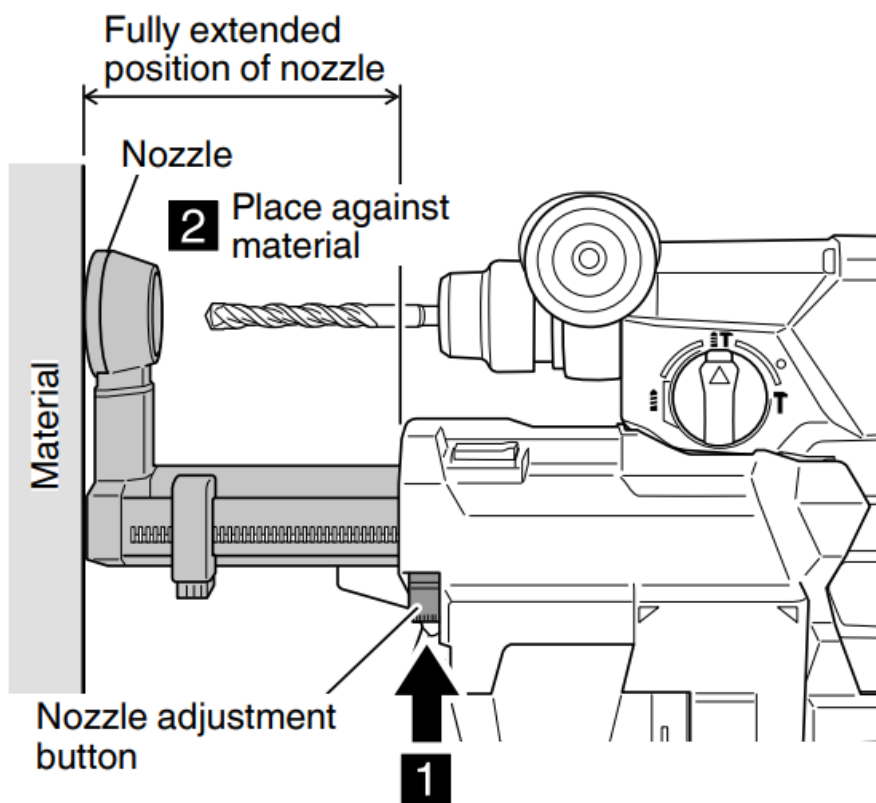

Fig. 5

2. While holding the tool in a way so that the switch does not get pressed, place the nozzle against the material to be drilled. (Fig. 5)
3. While pushing the nozzle adjustment button in the direction of the arrow, press the tool toward the material, allowing the nozzle position to shorten until it reaches the position where the drill bit comes into contact with the material. (Fig. 6)

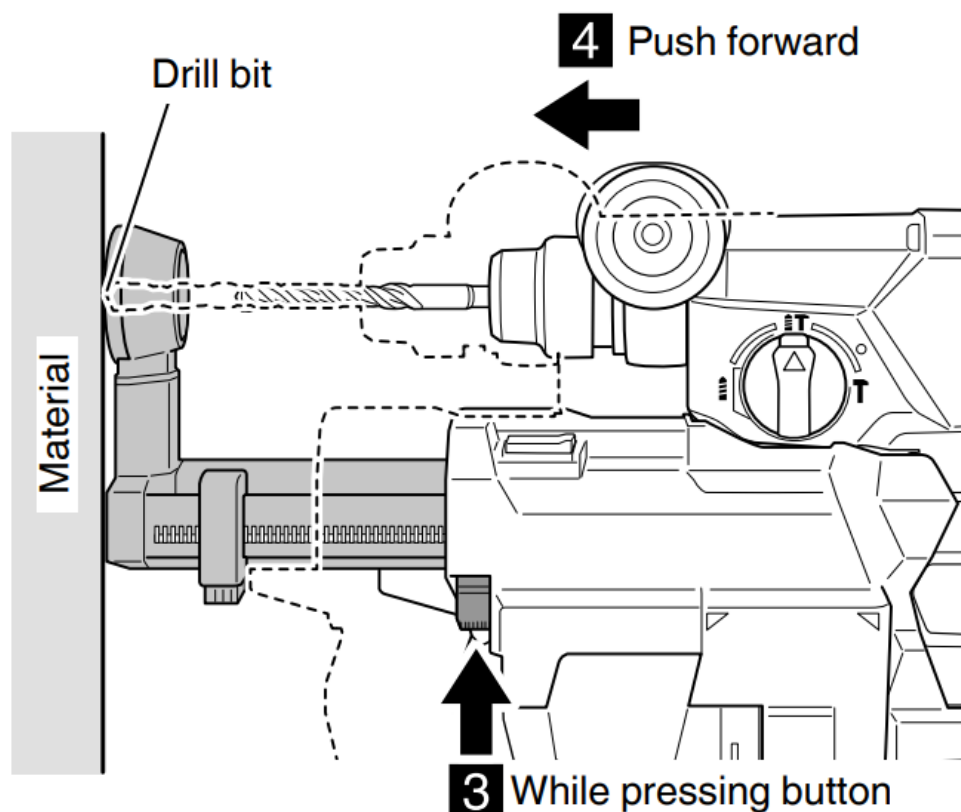

Fig. 6

NOTE

If the nozzle position is shortened before the nozzle adjustment button is pressed, the nozzle won't be locked in position even if the nozzle adjustment button lock is released.

4. Release the nozzle adjustment button to lock the position of the nozzle. (Fig. 7)

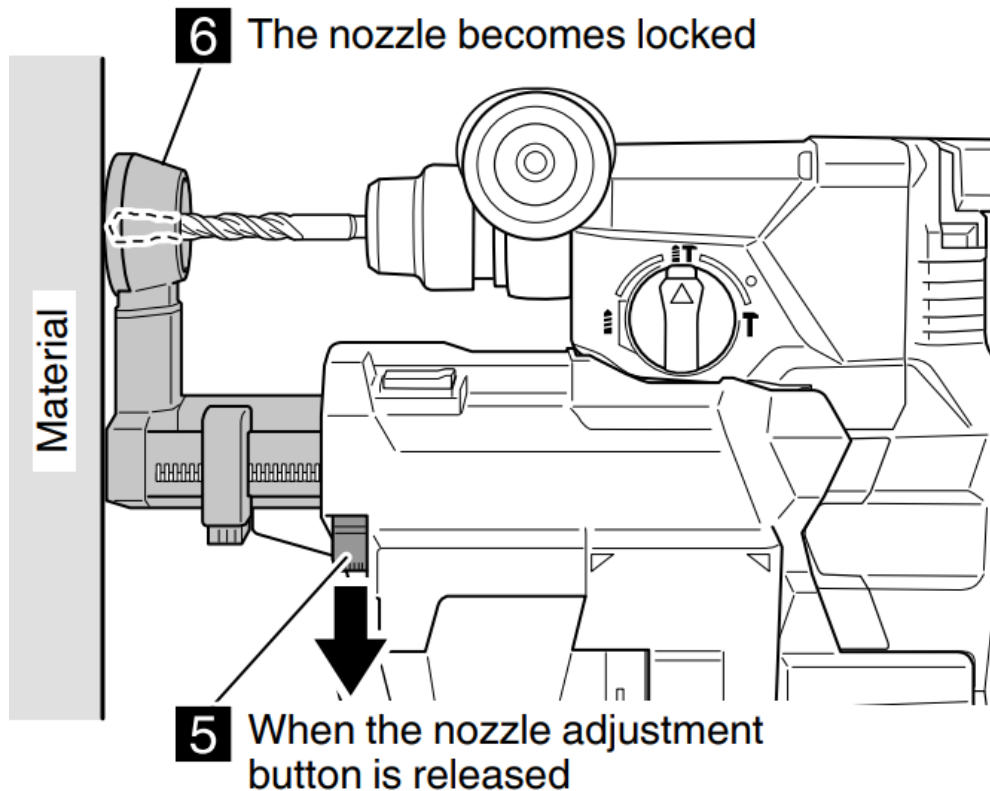

Fig. 7

Adjust the drilling depth

NOTE

- The maximum drilling depth when using the dust extractor system is 85 mm.
- The dust extractor system can be used with drill bits with diameters of 4.3–20 mm and effective lengths of 50–100 mm. If using a drill bit with a diameter of greater than 20 mm, remove the dust extractor system.

Press the depth adjustment button in the direction of the arrow to release the lock, move the nozzle to set the stroke equal to the depth that you want to drill, and release the depth adjustment button to lock the position. (Fig. 8)

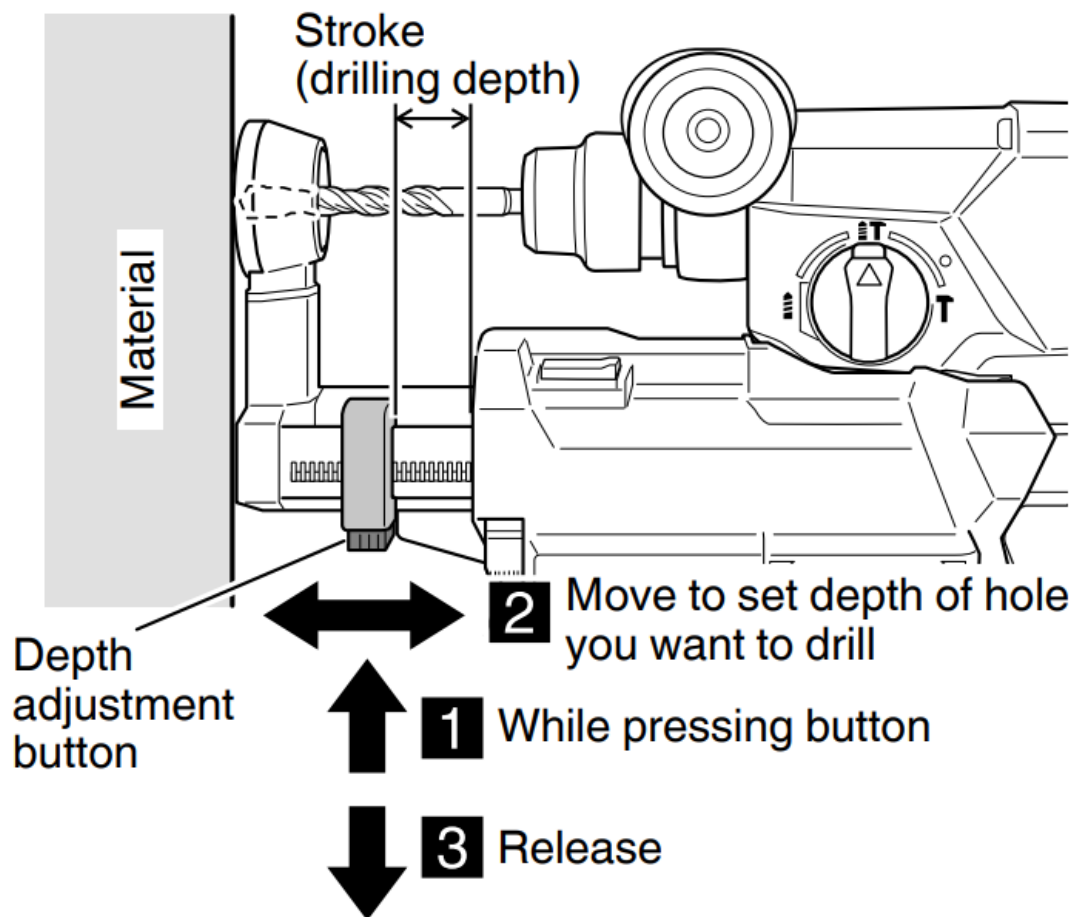

Fig. 8

When the end of the nozzle and the tip of the drill bit are aligned, the distance that the nozzle can move is drilling depth. (Fig. 9)

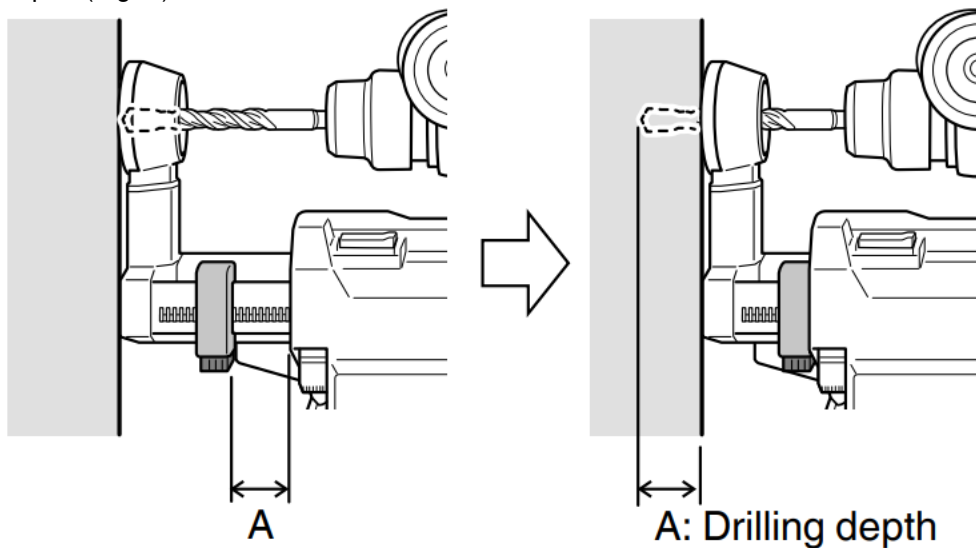

Fig. 9

Drilling NOTE

- The dust extractor system is only to be used when drilling concrete. Do not use it while drilling metal or wood.
- Do not use the dust extractor system with wet concrete or in a wet environment. Doing so may result in a

1. Grasp the nozzle with your hand and pull it back slightly, and align the tip of the drill bit with the spot to be drilled. (Fig. 10)

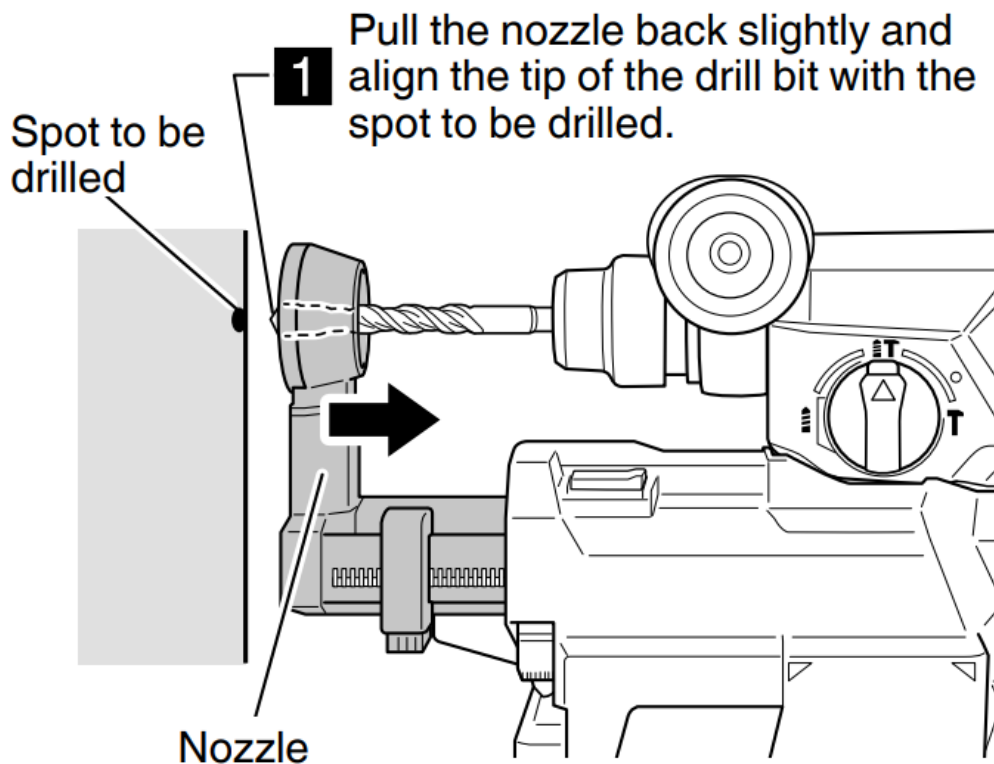

Fig. 10

2. Release the nozzle and allow it to make firm contact with the surface of the concrete. (Fig. 11)

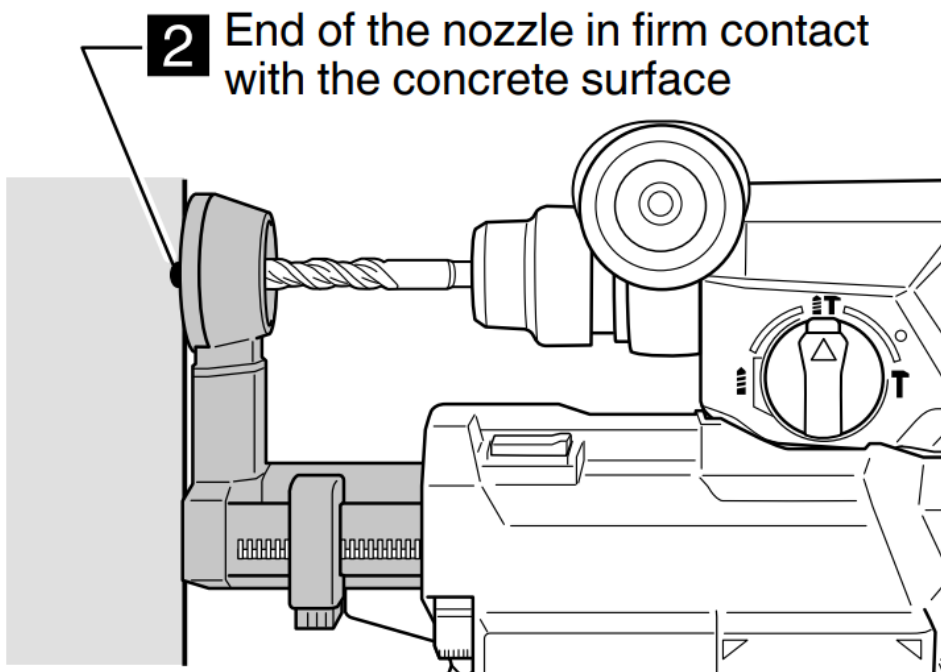

Fig. 11

NOTE

If the nozzle is raised off the surface, the dust extraction performance declines.

3. With the end of the nozzle still in firm contact with the surface of the concrete, proceed with drilling. (Fig. 12)

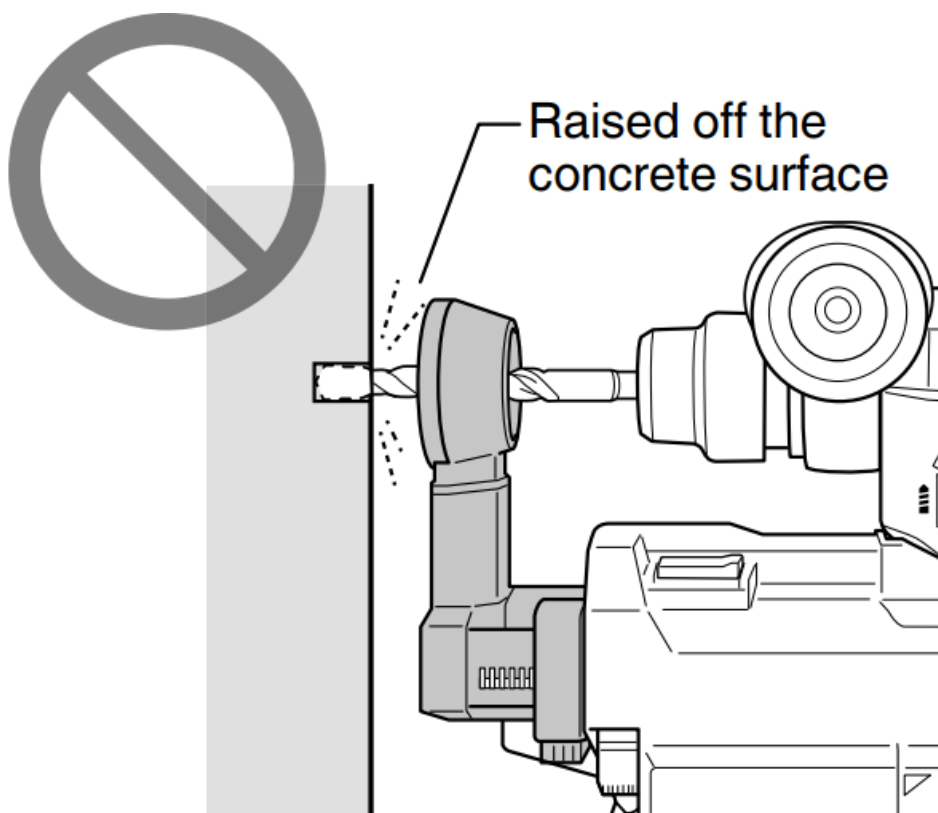
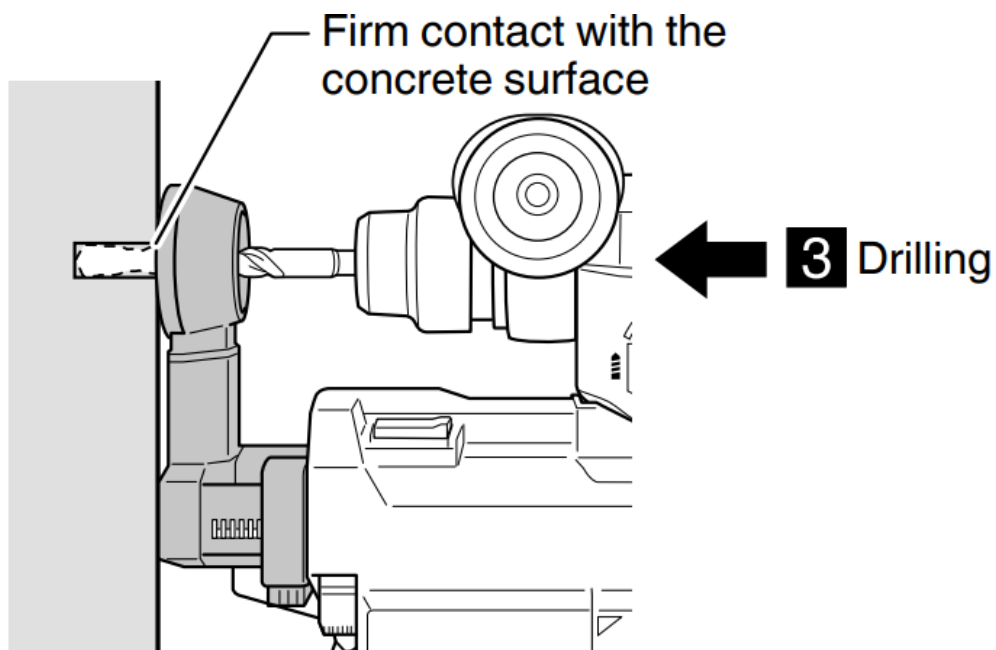

Fig. 12

Emptying the dust

If too much dust is collected in the dust box, the dust extraction performance declines. Additionally, if the dust box is full, dust may leak out of the dust extractor system. Inspect the dust extractor system regularly, and dispose of the dust before it becomes full.

WARNING

When emptying the dust, in order to prevent an unlikely accident, be sure to turn off the tool's switch and remove the rechargeable battery from the tool body

CAUTION

Wear a dust mask.

1. Detach the dust box (Fig. 13)

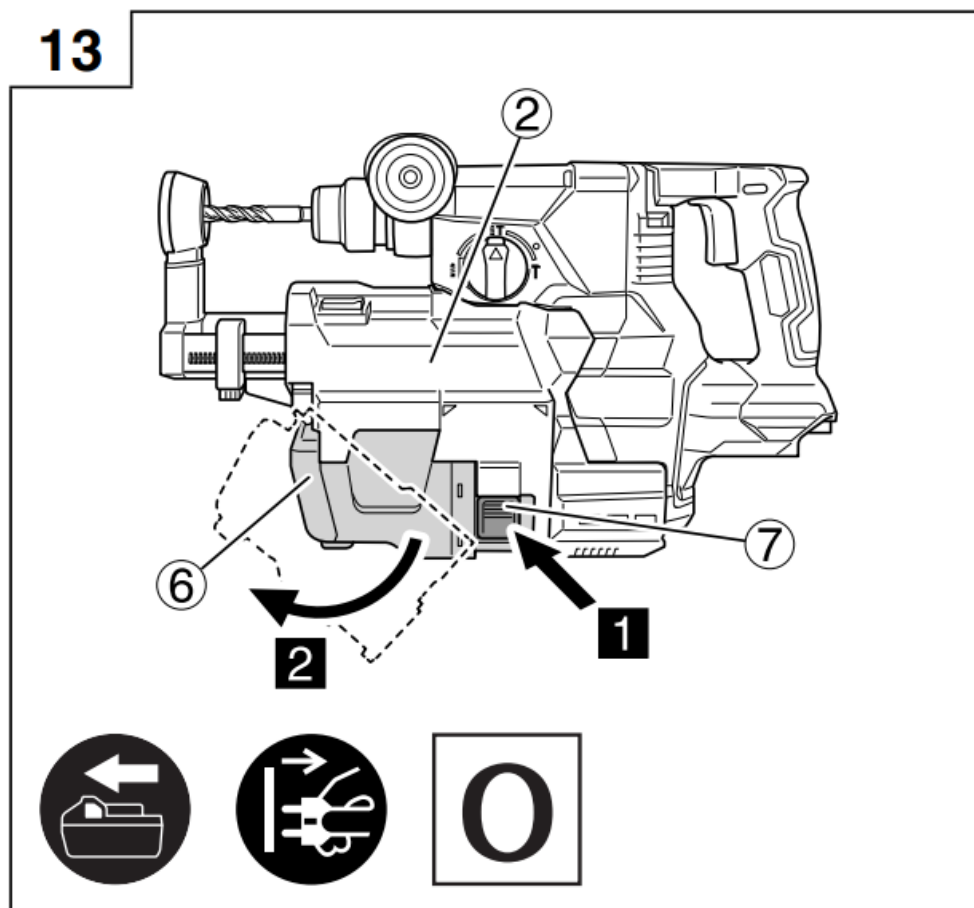

2. Clean out the dust in the cyclone chamber (Fig. 14)

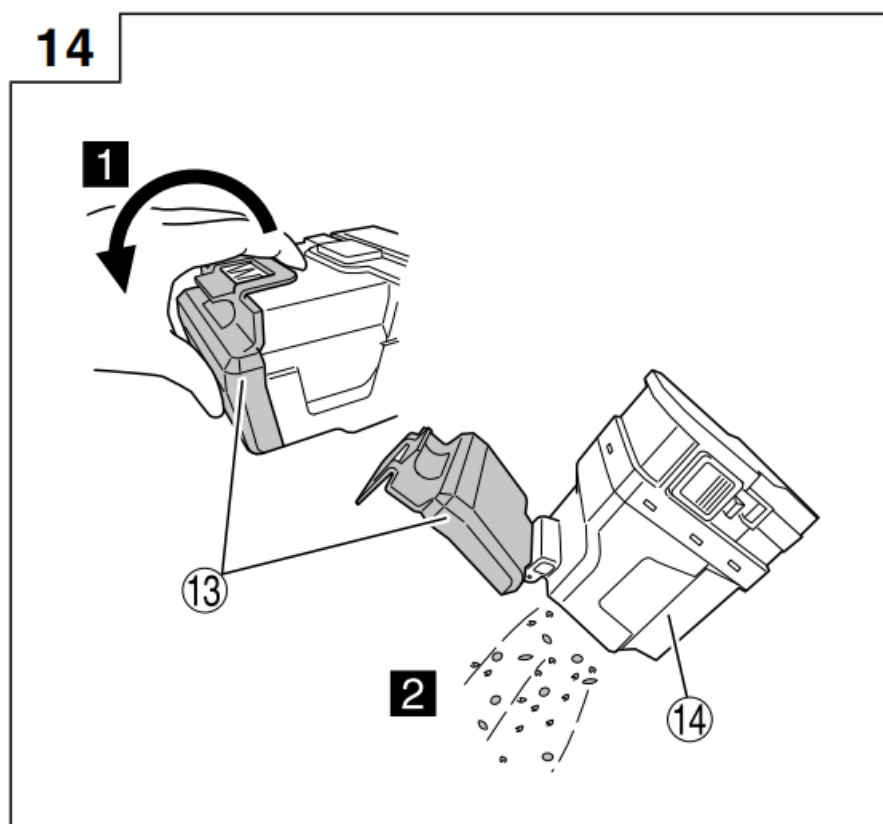

3. Clean out the dust in the filter chamber (Fig. 15)

15

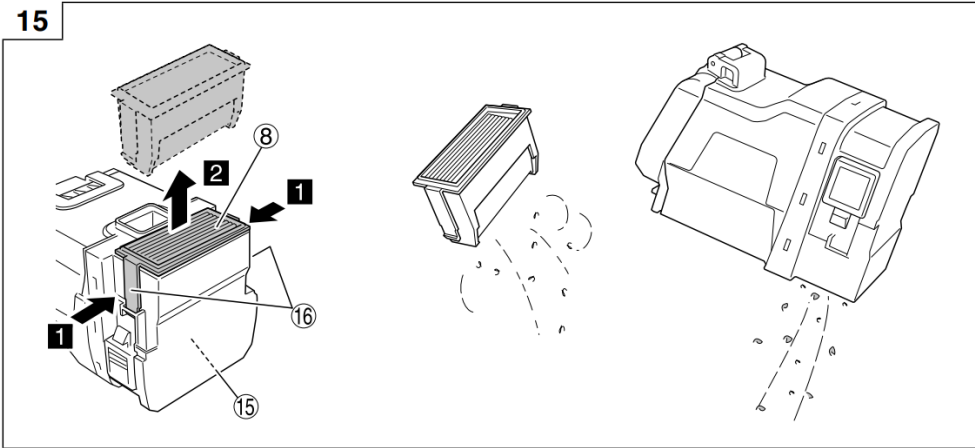

In addition, clean off all dust attached to the surface of the fi lter

NOTE

Do not directly touch the fi lter with a hard brush or similar tool, or blast the backside of the fi lter with compressed air.

Also, do not wash the fi lter with water. Doing so may scratch the fi lter and/or shorten its life.

4. Make sure the fi lter is positioned correctly. (Fig. 16)

16

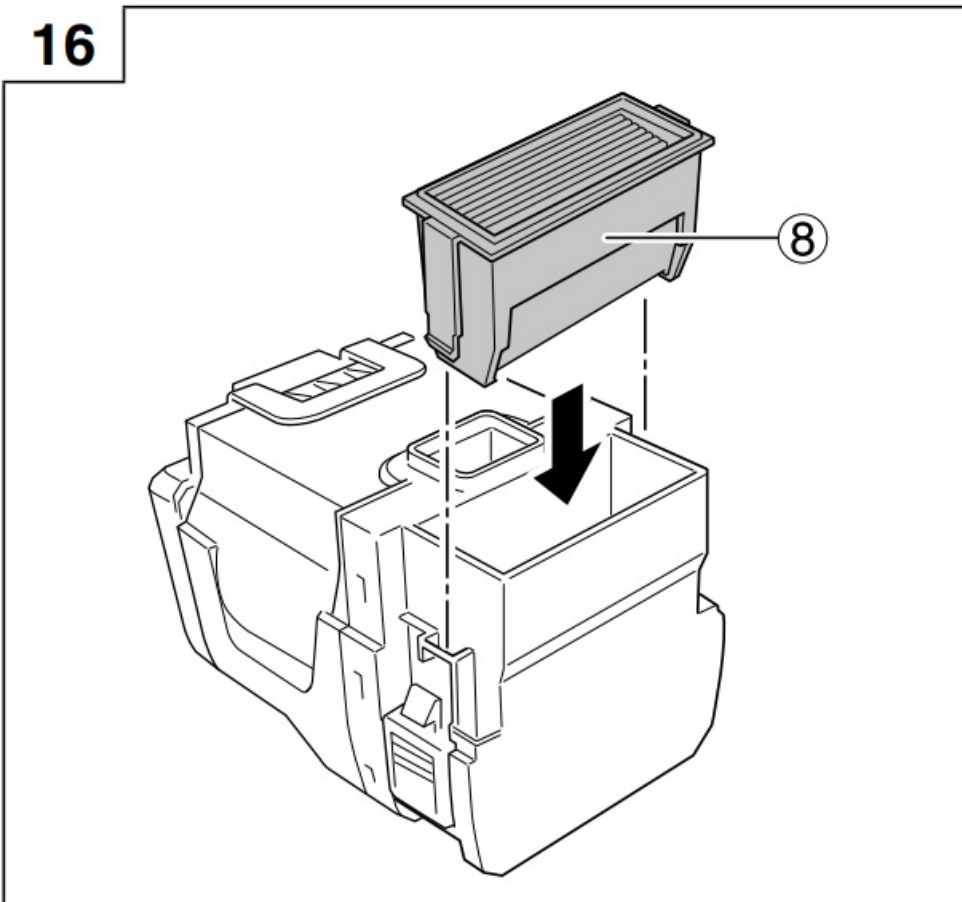

5. Attach the dust box to the dust housing. (Fig. 17)

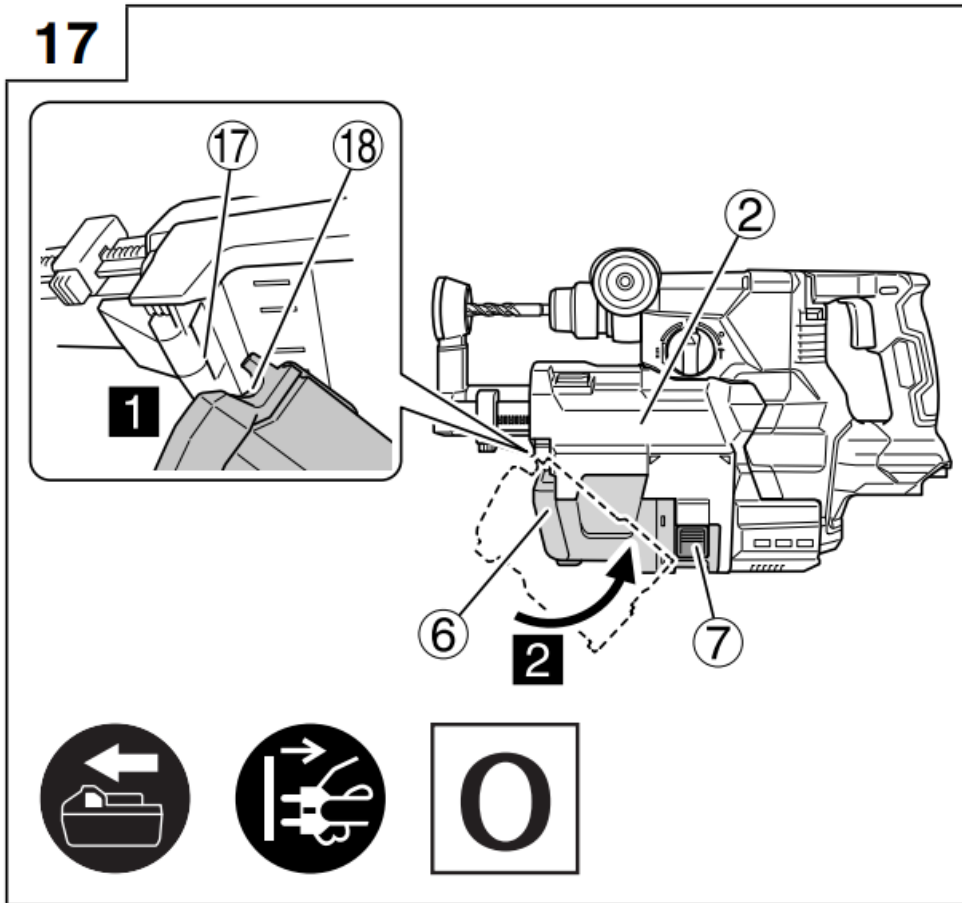
17**NOTE**

Make sure there is no dust attached to the latch before fitting the latch.
Check to confirm that the latches on both sides are securely engaged after attaching.
Failure to do so may result in the dust box falling off during use.

MAINTENANCE AND INSPECTION**WARNING**

When performing inspections or maintenance, be sure to turn off the tool's switch and remove the dust extractor system from the tool body

Inspecting the body of the dust extractor system

Regularly inspect the places where the various parts of the dust extractor system fit together to make sure there is no rattling or loose parts.

If the dust extractor system is used while parts of it are loose, there is a risk of injury or other accidents. If there is anything abnormal with the dust extractor system, consult the HIKOKI Authorized Service Center

Cleaning on the outside

When the power tool is stained, wipe with a soft dry cloth or a cloth moistened with soapy water. Do not use chloric solvents, gasoline or paint thinner, for they melt plastics.

Replacing the nozzle seal and brush cap

As the nozzle seal and brush cap wear out, the dust extracting performance declines.
If the nozzle seal or brush cap is worn out, replace it with a new one.

(a) Replacing the nozzle seal (Fig. 18)

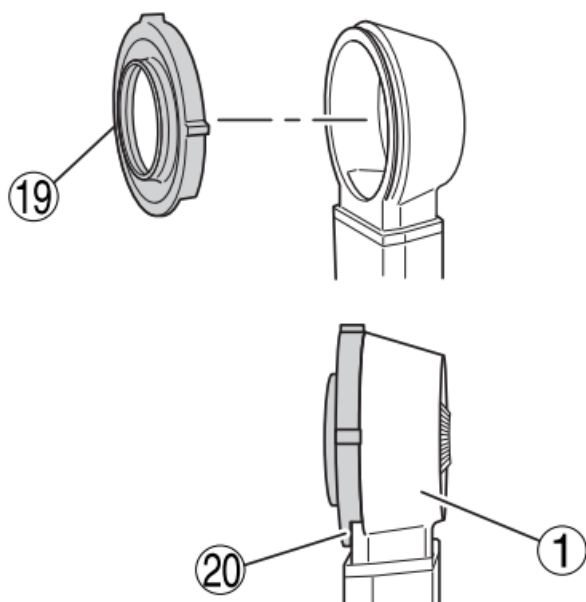
18

1. Remove the nozzle seal as shown in the figure.
2. Attach a new nozzle seal. Align the nozzle seal so that its notch fits onto the outer shape of the nozzle.

(b) Replacing the brush cap (Fig. 19)

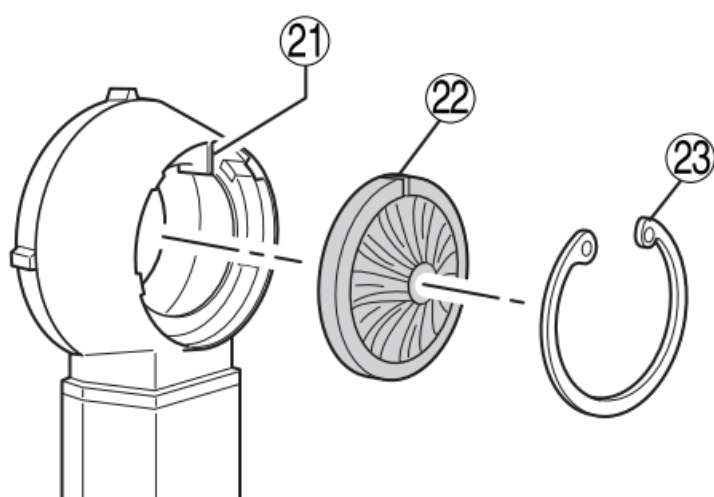
19

1. Use pliers or a similar tool remove the C-ring, and replace the brush cap with a new one.
2. Align the groove of the new brush cap with the bump on the nozzle and fit them together.
3. Reattach the C-ring in its original position, making sure that it is secure and won't fall off.

Storage

- Store the power tool in a place in which the temperature is less than 50°C and out of reach of children.
- When storing the dust extractor system, press the nozzle adjustment button to put the nozzle in the fully extended position. If unable to store with the nozzle fully extended, the nozzle can be shortened to about half its size (Fig. 20).

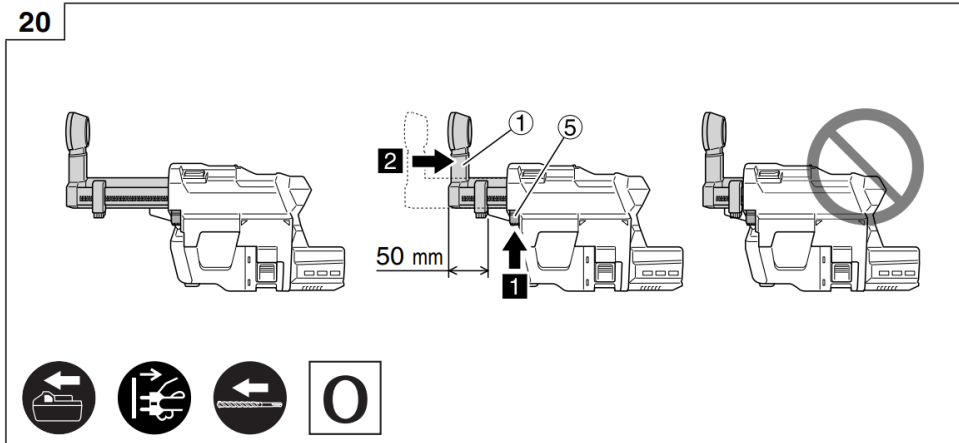

Keeping the nozzle fully contracted inside the dust extractor system may result in its pressing force becoming weaker.

- If the nozzle doesn't return to the fully extended position, pull it outward with your hand. Repeatedly extending and contracting it will help it recover.

CAUTION

In the operation and maintenance of power tools, the safety regulations and standards prescribed in each country must be observed

GUARANTEE

We guarantee Hikoki Power Tools in accordance with statutory/country specific regulation. This guarantee does not cover defects or damage due to misuse, abuse, or normal wear and tear. In case of complaint, please send the Power Tool, undismantled, with the GUARANTEE CERTIFICATE found at the end of this Handling instruction, to a HiKOKI Authorized Service Center

NOTE

Due to Shikoku's continuing program of research and development, the specifications herein are subject to change without prior notice

TROUBLESHOOTING

Use the inspections in the table below if the tool does not operate normally. If this does not remedy the problem, consult your dealer or the HiKOKI Authorized Service Center

Symptom	Possible cause	Remedy
The dust extraction performance has declined, or dust is leaking out of the dust extractor system.	The dust box is full.	Empty the dust from the dust box and clean the dust box.
	The filter box is clogged.	Clean the filter.Or, replace the filter with a new one.
	The filter, brush cap, or nozzle seal is cracked, damaged, or worn out.	Replace it with a new one.
The position of the nozzle won't lock.	<p>The following incorrect steps were performed:</p> <ol style="list-style-type: none"> 1. The nozzle was set to the desired position 2. The nozzle adjustment button was pressed 	<p>Perform the following steps:</p> <ol style="list-style-type: none"> 1. While pressing and holding the nozzle adjustment button... 2. Set the nozzle to the desired position 3. Release the nozzle adjustment button

HIKOKI

Documents / Resources

	<p>HiKOKI Dust Extractor System for Rotary Hammer [pdf] Instruction Manual Dust Extractor System for Rotary Hammer, Extractor System for Rotary Hammer, Rotary Hammer, Hammer</p>
---	---

References

- [User Manual](#)

[Manuals+.](#) [Privacy Policy](#)

This website is an independent publication and is neither affiliated with nor endorsed by any of the trademark owners. The "Bluetooth®" word mark and logos are registered trademarks owned by Bluetooth SIG, Inc. The "Wi-Fi®" word mark and logos are registered trademarks owned by the Wi-Fi Alliance. Any use of these marks on this website does not imply any affiliation with or endorsement.