

# HIKOKI D13VB3 Corded Drilling Machine Instruction Manual

[Home](#) » [HiKOKI](#) » HIKOKI D13VB3 Corded Drilling Machine Instruction Manual 

## Contents

- 1 HIKOKI D13VB3 Corded Drilling Machine
- 2 GENERAL POWER TOOL SAFETY
- 3 DRILL SAFETY WARNINGS
- 4 ADDITIONAL SAFETY WARNINGS
- 5 SYMBOLS
- 6 STANDARD ACCESSORIES
- 7 APPLICATIONS
- 8 SPECIFICATIONS
- 9 MOUNTING AND OPERATION
- 10 MAINTENANCE AND INSPECTION
- 11 GUARANTEE
- 12 GUARANTEE CERTIFICATE
- 13 EC DECLARATION OF CONFORMITY
- 14 Documents / Resources
- 15 Related Posts

# **HiKOKI**

**HIKOKI D13VB3 Corded Drilling Machine**

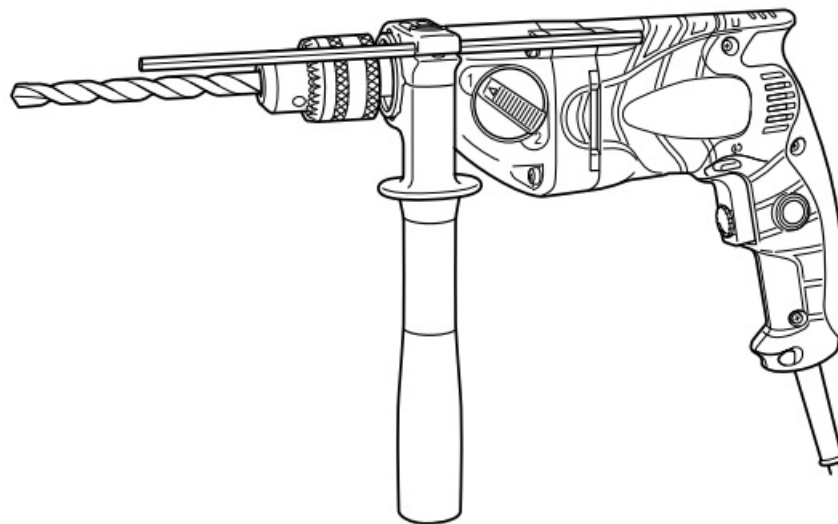

## GENERAL POWER TOOL SAFETY

### WARNING

Read all safety warnings, instructions, illustrations and specifications provided with this power tool. Failure to follow all instructions listed below may result in electric shock, fire and/or serious injury. Save all warnings and instructions for future reference. The term “power tool” in the warnings refers to your mains-operated (corded) power tool or battery-operated (cordless) power tool.

#### 1. Work area safety

- Keep work area clean and well lit.  
Cluttered or dark areas invite accidents.
- Do not operate power tools in explosive atmospheres, such as in the presence of flammable liquids, gases or dust.  
Power tools create sparks which may ignite the dust or fumes.
- Keep children and bystanders away while operating a power tool.  
Distractions can cause you to lose control.

#### 2. Electrical safety

- Power tool plugs must match the outlet. Never modify the plug in any way. Do not use any adapter plugs with earthed (grounded) power tools.  
Unmodified plugs and matching outlets will reduce risk of electric shock.
- Avoid body contact with earthed or grounded surfaces, such as pipes, radiators, ranges and refrigerators.  
There is an increased risk of electric shock if your body is earthed or grounded.
- Do not expose power tools to rain or wet conditions.  
Water entering a power tool will increase the risk of electric shock.
- Do not abuse the cord. Never use the cord for carrying, pulling or unplugging the power tool. Keep cord away from heat, oil, sharp edges or moving parts.  
Damaged or entangled cords increase the risk of electric shock.
- When operating a power tool outdoors, use an extension cord suitable for outdoor use.  
Use of a cord suitable for outdoor use reduces the risk of electric shock.
- If operating a power tool in a damp location is unavoidable, use a residual current device (RCD) protected supply.  
Use of an RCD reduces the risk of electric shock.

#### 3. Personal safety

- Stay alert, watch what you are doing and use common sense when operating a power tool. Do not use a power tool while you are tired or under the influence of drugs, alcohol or medication.  
A moment of inattention while operating power tools may result in serious personal injury.
- Use personal protective equipment. Always wear eye protection.  
Protective equipment such as a dust mask, non-skid safety shoes, hard hat or hearing protection used for appropriate conditions will reduce personal injuries.
- Prevent unintentional starting. Ensure the switch is in the off -position before connecting to power source and/or battery pack, picking up or carrying the tool.  
Carrying power tools with your fi nger on the switch or energising power tools that have the switch on invites accidents.
- Remove any adjusting key or wrench before turning the power tool on.  
A wrench or a key left attached to a rotating part of the power tool may result in personal injury.
- Do not overreach. Keep proper footing and balance at all times.  
This enables better control of the power tool in unexpected situations.
- Dress properly. Do not wear loose clothing or jewellery. Keep your hair and clothing away from moving parts.  
Loose clothes, jewellery or long hair can be caught in moving parts.
- If devices are provided for the connection of dust extraction and collection facilities, ensure these are connected and properly used.  
Use of dust collection can reduce dust-related hazards.
- Do not let familiarity gained from frequent use of tools allow you to become complacent and ignore tool safety principles.  
A careless action can cause severe injury within a fraction of a second.

#### **4. Power tool use and care**

- Do not force the power tool. Use the correct power tool for your application.  
The correct power tool will do the job better and safer at the rate for which it was designed.
- Do not use the power tool if the switch does not turn it on and off .  
Any power tool that cannot be controlled with the switch is dangerous and must be repaired.
- Disconnect the plug from the power source and/or remove the battery pack, if detachable, from the power tool before making any adjustments, changing accessories, or storing power tools. Such preventive safety measures reduce the risk of starting the power tool accidentally.
- Store idle power tools out of the reach of children and do not allow persons unfamiliar with the power tool or these instructions to operate the power tool.  
Power tools are dangerous in the hands of untrained users.
- Maintain power tools and accessories. Check for misalignment or binding of moving parts, breakage of parts and any other condition that may affect the power tool's operation. If damaged, have the power tool repaired before use.  
Many accidents are caused by poorly maintained power tools.
- Keep cutting tools sharp and clean.  
Properly maintained cutting tools with sharp cutting edges are less likely to bind and are easier to control.
- Use the power tool, accessories and tool bits etc. in accordance with these instructions, taking into account the working conditions and the work to be performed.  
Use of the power tool for operations diff erent from those intended could result in a hazardous situation.

- Keep handles and grasping surfaces dry, clean and free from oil and grease.

Slippery handles and grasping surfaces do not allow for safe handling and control of the tool in unexpected situations.

## 5. Service

Have your power tool serviced by a qualified repair person using only identical replacement parts.

This will ensure that the safety of the power tool is maintained.

## PRECAUTION

Keep children and infirm persons away. When not in use, tools should be stored out of reach of children and infirm persons.

## DRILL SAFETY WARNINGS

### Safety instructions for all operations

- Use the auxiliary handle(s).  
Loss of control can cause personal injury.
- Hold the power tool by insulated gripping surfaces, when performing an operation where the cutting accessory may contact hidden wiring or its own cord. Cutting accessory contacting a “live” wire may make exposed metal parts of the power tool “live” and could give the operator an electric shock.

### Safety instructions when using long drill bits

- Never operate at higher speed than the maximum speed rating of the drill bit.  
At higher speeds, the bit is likely to bend if allowed to rotate freely without contacting the workpiece, resulting in personal injury.
- Always start drilling at low speed and with the bit tip in contact with the workpiece.  
At higher speeds, the bit is likely to bend if allowed to rotate freely without contacting the workpiece, resulting in personal injury.
- Apply pressure only in direct line with the bit and do not apply excessive pressure.  
Bits can bend causing breakage or loss of control, resulting in personal injury.

## ADDITIONAL SAFETY WARNINGS

1. Make sure to securely hold the tool during operation. Failure to do so can result in accidents or injuries. (Fig. 9)
2. Ensure that the power source to be utilized conforms to the power requirements specified on the product nameplate.
3. Ensure that the power switch is in the OFF position.  
If the plug is connected to a receptacle while the power switch is in the ON position, the power tool will start operating immediately, which could cause a serious accident.
4. When the work area is removed from the power source, use an extension cord of sufficient thickness and rated capacity. The extension cord should be kept as short as practicable.
5. Hold the drill and side handle securely with both hands when using.
6. Do not wear gloves made of stuff liable to roll up such as cotton, wool, cloth or string, etc.
7. Prior to drilling into walls, ceilings or floors, ensure there are no electric cables or conduits inside.

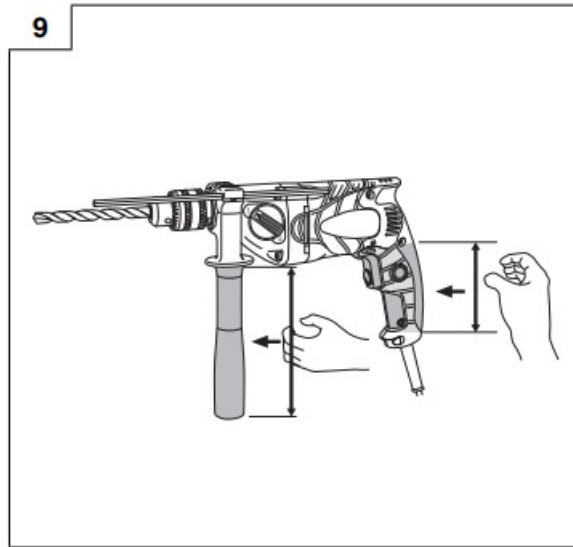

## 8. Drilling

- When drilling, start the drill slowly, and gradually increasing speed as you drill.
- Always apply pressure in a straight line with the bit. Use enough pressure to keep drilling, but do not push hard enough to stall the motor or deflect the bit.
- To minimize stalling or breaking through the material, reduce pressure on drill and ease the bit through the last part of the hole.
- If the drill stalls, release the trigger immediately, remove the bit from the work and start again. Do not click the trigger on and off in an attempt to start a stalled drill.
- This can damage the drill.
- The larger the drill bit diameter, the larger the reactive force on your arm.
- Be careful not to lose control of the drill because of this reactive force.
- To maintain firm control, establish a good foothold, use side handle, hold the drill tightly with both hands, and ensure that the drill is vertical to the material being drilled.
- Precautions on boring

The drill bit may become overheated during operation; however, it is sufficiently operable. Do not cool the drill bit in water or oil.

- Caution concerning immediately after use Immediately after use, while it is still revolving, if the Drill is placed on a location where considerable ground chips and dust have accumulated, dust may occasionally be absorbed into the drill mechanism. Always pay attention to this undesirable possibility.

- **Slip clutch mechanism**

This unit contains a slip clutch that causes the gears between the motor and drill bit to slip when an excessive load is suddenly applied. The slip clutch protects the unit from a large violent reaction the load might cause.

- **CAUTION**

- If the slip clutch triggers and stops the drill bit rotation, quickly turn off the power switch.
- Do not operate the unit in a way that frequently triggers the slip clutch.

## 9. RCD

The use of a residual current device with a rated residual current of 30 mA or less at all times is recommended.

## SYMBOLS

### WARNING

The following show symbols used for the machine. Be sure that you understand their meaning before use.

- D13VB3: Drill
- To reduce the risk of injury, user must read instruction manual.
- Only for EU countries

Do not dispose of electric tools together with household waste material!

In observance of European Directive

2012/19/EU on waste electrical and electronic equipment and its implementation in accordance with national law, electric tools that have reached the end of their life must be collected separately and returned to an environmentally compatible recycling facility.

- Rated voltage
- Power Input
- No-load speed
- Switching ON
- Switching OFF
- On / Off switch lock-on
- Change rotation speed – High speed
- Change rotation speed – Low speed
- Clockwise rotation
- Counterclockwise rotation
- Disconnect mains plug from electrical outlet
- Class II tool

## STANDARD ACCESSORIES

In addition to the main unit (1 unit), the package contains the accessories listed in the below.

1. Chuck wrench (Spec. only for keyed chuck) .....1
2. Side handle .....1
3. Depth gauge .....1

Standard accessories are subject to change without notice.

## APPLICATIONS

Boring holes in metal, wood and plastic.

## SPECIFICATIONS

Voltage*1		(110 V, 220 V, 230 V, 240 V)	
Power input		790 W*1	
Speed range		1	2
No load speed	Forward rotation	0 – 1000 min-1	0 – 3000 min-1
	Reverse rotation	0 – 600 min-1	0 – 1800 min-1
Capacity	Steel	13 mm	8 mm
	Wood	40 mm	25 mm
Weight*2		2.5 kg	

1. Be sure to check the nameplate on product as it is subject to change by areas.
2. Weight: According to EPTA-Procedure 01/2014

#### NOTE

Due to HiKOKI's continuing program of research and development, the specifications herein are subject to change without prior notice.

## MOUNTING AND OPERATION

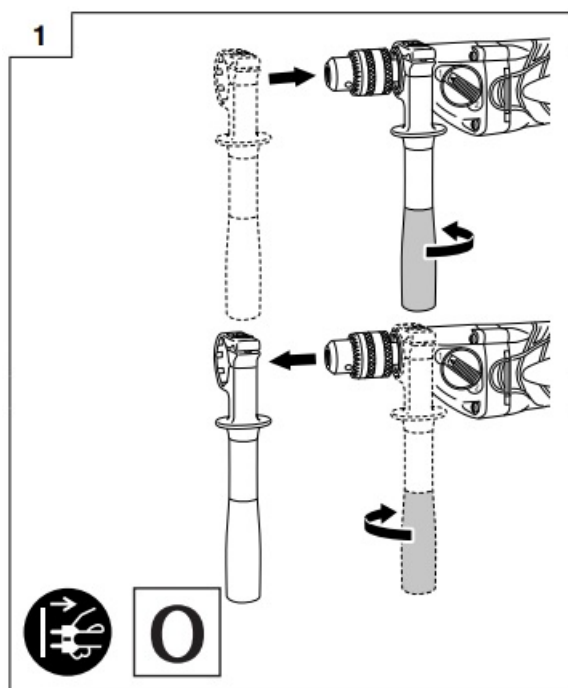

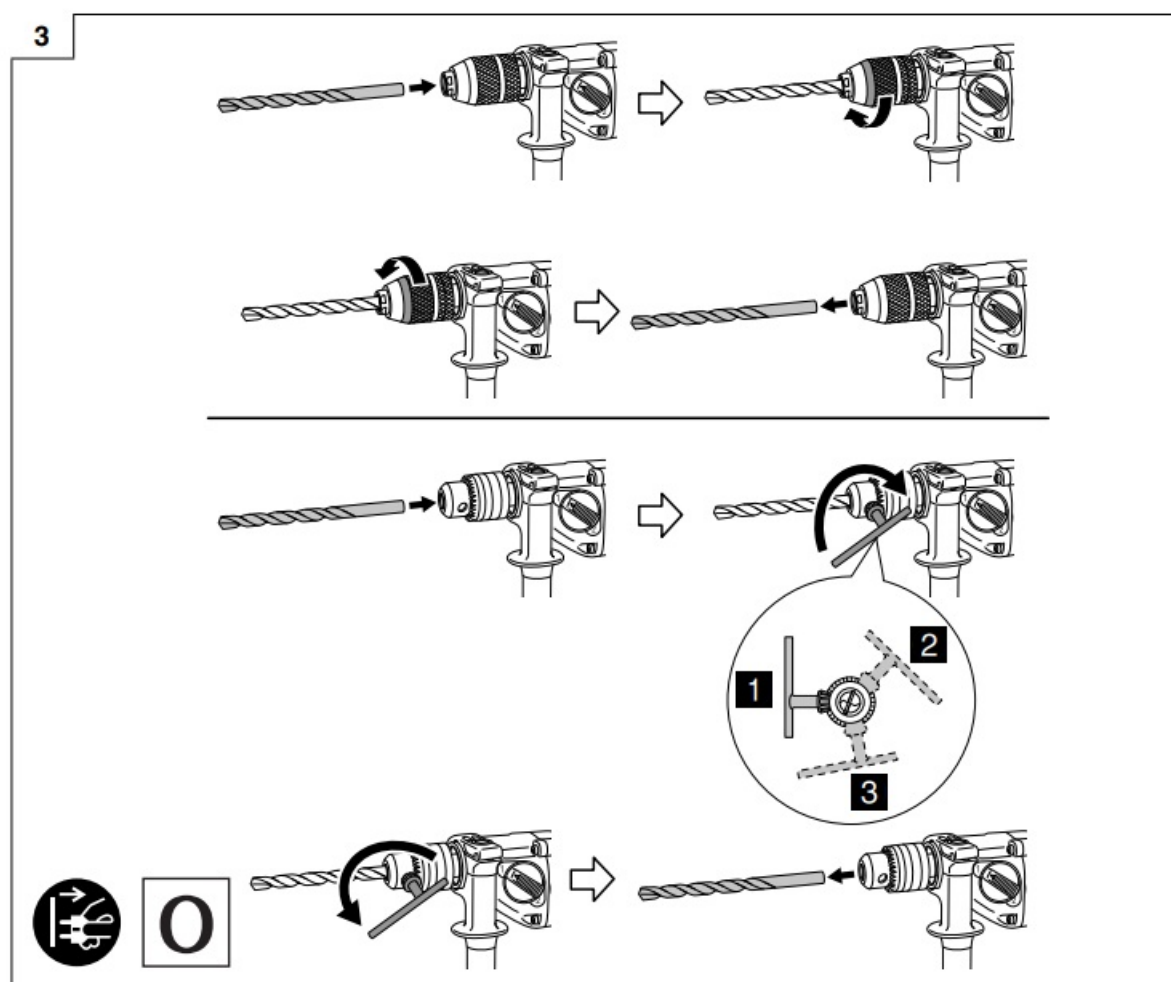
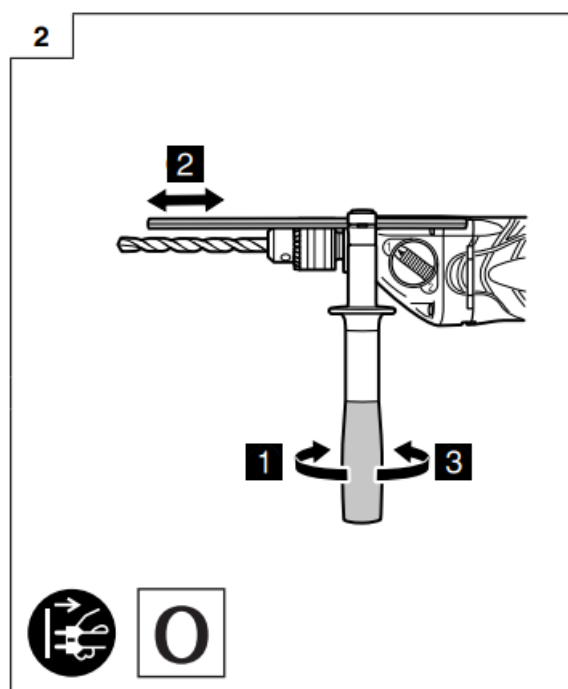

4

**O**

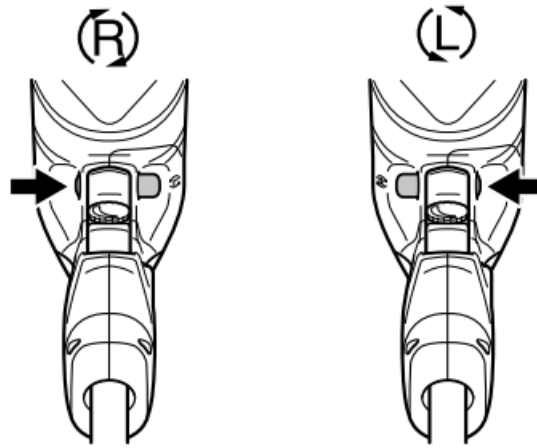

5

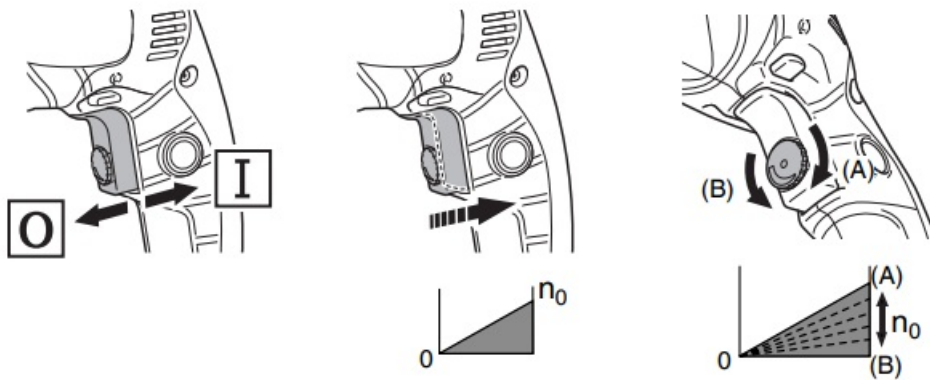

6

$$1 + 2 = \text{Lock } \mathbf{I}$$

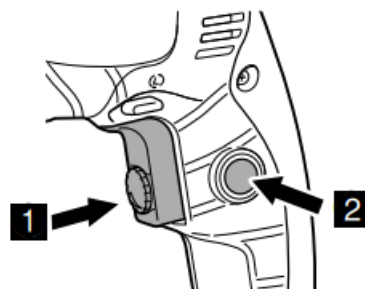

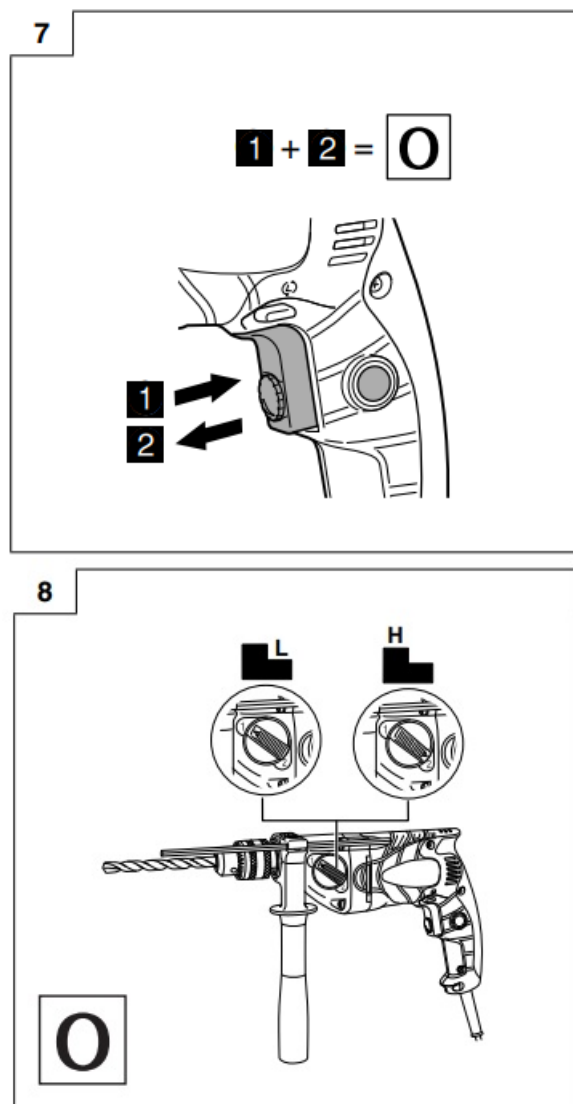

Action	Figure	Page
Fixing and removing side handle	1	92
Using depth gauge	2	92
Mounting and dismounting of the bit*1	3	92
Selecting rotation direction	4	93
Switch operation*2	5	93
Locking-on the switch	6	93
Releasing the switch	7	93
Change rotation speed	8	94
Selecting accessories	—	95

## 1. Selecting the appropriate drill bit

- When boring metal or plastic  
Use an ordinary metalworking drill bit.
- When boring wood  
Use ordinary woodworking drill bit.

However, when drilling 6.5 mm or smaller holes, use a metalworking drill bit.

## **2. CAUTION**

If the L-side of push button is pressed for reverse bit rotation, the stopper cannot be used.

## **MAINTENANCE AND INSPECTION**

### **1. Inspecting the drill bits**

Since use of an abraded drill bits will cause motor malfunctioning and degraded efficiency, replace the drill bits with a new one or resharpening without delay when abrasion is noted.

### **2. Inspecting the mounting screws**

Regularly inspect all mounting screws and ensure that they are properly tightened. Should any of the screws be loose, retighten them immediately. Failure to do so could result in serious hazard.

### **3. Maintenance of the motor**

The motor unit winding is the very “heart” of the power tool. Exercise due care to ensure the winding does not become damaged and/or wet with oil or water.

### **4. Inspecting the carbon brushes**

For your continued safety and electrical shock protection, carbon brush inspection and replacement on this tool should ONLY be performed by a HiKOKI Authorized Service Center.

### **5. Replacing supply cord**

If the replacement of the supply cord is necessary, it has to be done by HiKOKI Authorized Service Center to avoid a safety hazard.

## **CAUTION**

In the operation and maintenance of power tools, the safety regulations and standards prescribed in each country must be observed.

## **GUARANTEE**

We guarantee HiKOKI Power Tools in accordance with statutory/country specific regulation. This guarantee does not cover defects or damage due to misuse, abuse, or normal wear and tear. In case of complaint, please send the Power Tool, undismantled, with the GUARANTEE CERTIFICATE found at the end of this Handling instruction, to a HiKOKI Authorized Service Center.

## **IMPORTANT**

Correct connection of the plug

The wires of the main lead are coloured in accordance with the following code:

- Blue: — Neutral
- Brown: — Live

As the colours of the wires in the main lead of this tool may not correspond with the coloured markings identifying the terminals in your plug proceed as follows:

The wire coloured blue must be connected to the terminal marked with the letter N or coloured black. The wire coloured brown must be connected to the terminal marked with the letter L or coloured red. Neither core must be connected to the earth terminal.

## **NOTE:**

This requirement is provided according to BRITISH STANDARD 2769: 1984.

Therefore, the letter code and colour code may not be applicable to other markets except The United Kingdom.

Information concerning airborne noise and vibration The measured values were determined according to EN62841 and declared in accordance with ISO 4871.

Measured A-weighted sound power level: 91 dB (A) Measured A-weighted sound pressure level: 80 dB (A)

Uncertainty KpA: 3 dB (A)

Wear ear protection.

Drilling into metal: Vibration emission value ah, D = 3.6 m/s<sup>2</sup> Uncertainty K = 1.5 m/s<sup>2</sup>

The declared vibration total value and the declared noise emission value have been measured in accordance with a standard test method and may be used for comparing one tool with another. They may also be used in a preliminary assessment of exposure.

## **WARNING**

The vibration and noise emission during actual use of the power tool can differ from the declared total value depending on the ways in which the tool is used especially what kind of workpiece is processed; and Identify safety measures to protect the operator that are based on an estimation of exposure in the actual conditions of use (taking account of all parts of the operating cycle such as the times when the tool is switched off and when it is running idle in addition to the trigger time).

## **NOTE**

Due to HiKOKI's continuing program of research and development, the specifications herein are subject to change without prior notice.

## **GUARANTEE CERTIFICATE**

1. Model No.
2. Serial No.
3. Date of Purchase
4. Customer Name and Address
5. Dealer Name and Address (Please stamp dealer name and address)

### **Hikoki Power Tools (U.K.) Ltd.**

Precedent Drive, Rooksley, Milton Keynes, MK 13, 8PJ, United Kingdom

**Tel:** +44 1908 660663

**Fax:** +44 1908 606642

**URL:** <http://www.hikoki-powertools.uk>

## **EC DECLARATION OF CONFORMITY**

We declare under our sole responsibility that Drill, identified by type and specific identification code \*1), is in conformity with all relevant requirements of the directives \*2) and standards \*3). Technical file at \*4) – See below. The European Standard Manager at the representative office in Europe is authorized to compile the technical file.

The declaration is applicable to the product affixed CE marking.

## **Documents / Resources**

HIKOKI

0 12400



0

0

## [HIKOKI D13VB3 Corded Drilling Machine](#) [pdf] Instruction Manual D13VB3, Corded Drilling Machine, D13VB3 Corded Drilling Machine, Drilling Machine