



higi T71 Type C Wireless Transmitter User Guide

[Home](#) » [higi](#) » [higi T71 Type C Wireless Transmitter User Guide](#) 



TYPE-C
wireless transmitter

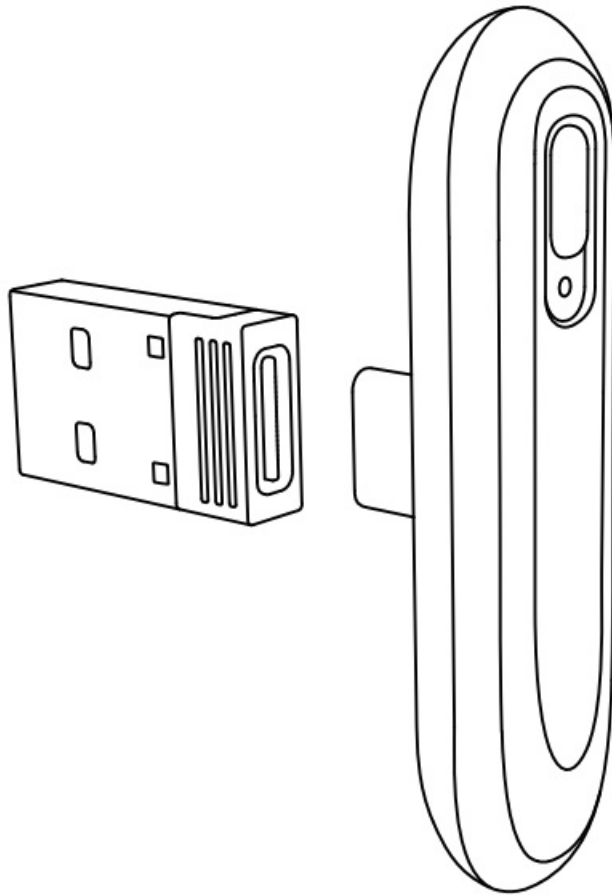

(For you to use this product better, please read and keep this manual)

Contents

- [1 Technical index:](#)
- [2 Launch mode display:](#)
- [3 Documents / Resources](#)
- [4 Related Posts](#)

Technical index:

Model: TYPE-C wireless transmitter

- Wireless input: digital audio signal 1KHz, OdBFS
- Wireless output: digital audio signal 1 KHz, OdBFS
- Working current; <40mA
- Frequency range: 2400MHZ-2483.5MHZ
- Frequency response: 20Hz-20kHz
- S/N ratio: >90dB
- Total harmonic distortion: <0.1%
- Audio decoding: SBC
- Transmission distance 10m

Function usage:

This product is in transmit mode, same as wireless device (wireless headset)Connect, you can listen to wireless music.

Through the USB adapter, you can connect the computer/TV/radio/MP3 audio is sent to the wireless headset/stereo.

A: Plug the device into the TYPE-C port for power supply (such as game consoles and mobile phones)Electrical port), the device will automatically turn on, and the blue light in the connection status is on and Flashes quickly.

B: Please place this product and wireless equipment (such as wireless headphones) in the 10M range Inside.

C: After the product is successfully paired and connected, the wireless connection status blue light keeps on.If it is not the wireless device you want to connect to, you can short press on the device Function key, switch to the next wireless device (such as wireless headset)

Note:

1. Different wireless devices (such as wireless headsets) use different schemes and protocols, so the search connection time will be different.
2. If the pairing connection fails or cannot be connected for a long time, you can re-pair and connect after shutting down.
3. This product has a wireless device switching function. In the environment of multiple wireless devices (such as wireless headsets), you can switch paired devices by short pressing the button.
4. This machine can be used by plugging in the USB port through the USB adapter (such as the TV computer USB port)

Launch mode display:

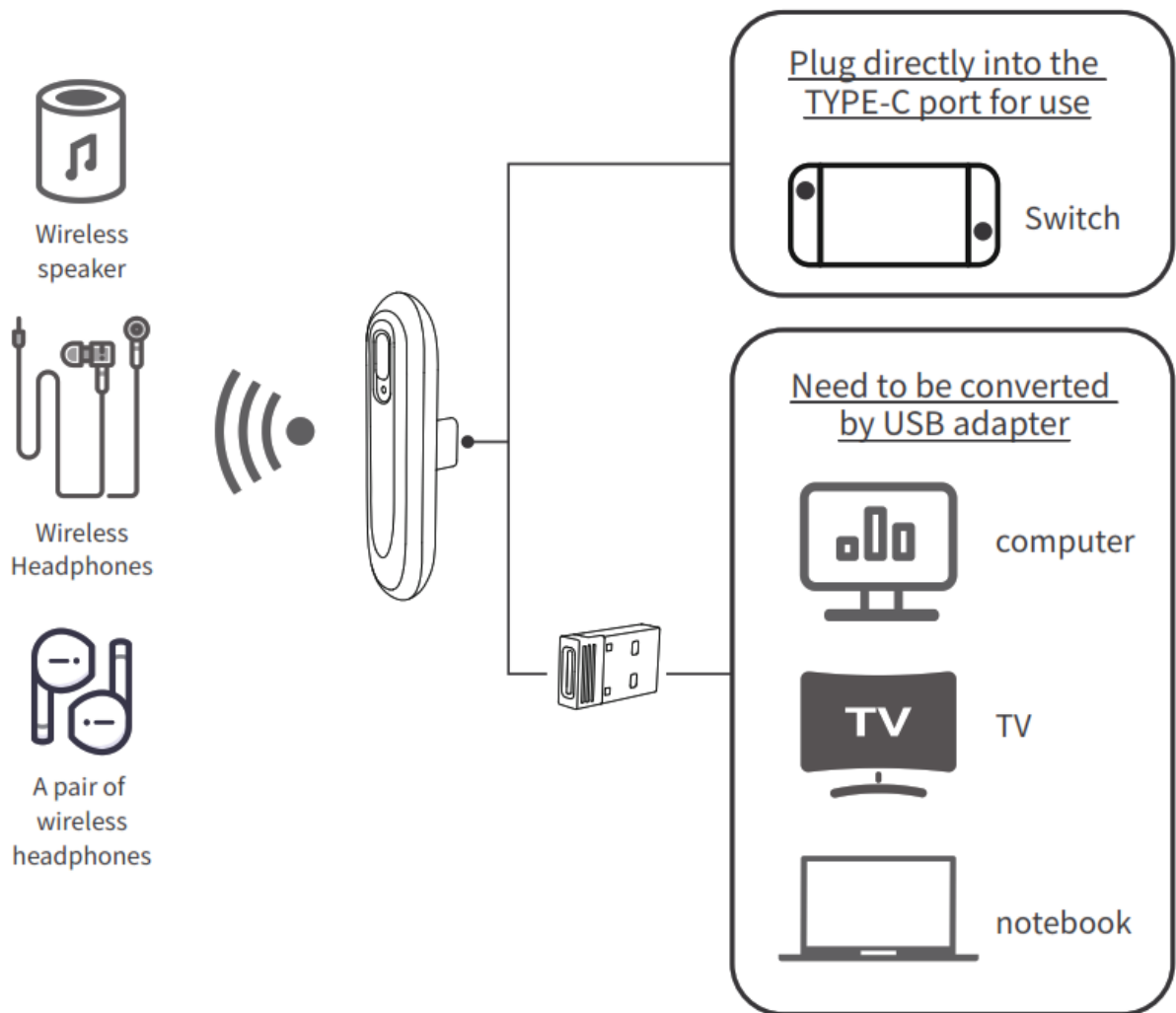

This device complies with part 15 of the FCC Rules. Operation is subject to the following two conditions: (1) This device may not cause harmful interference, and (2) this device must accept any interference received, including interference that may cause undesired operation.

Any Changes or modifications not expressly approved by the party responsible for compliance could void the user's authority to operate the equipment.

Note: This equipment has been tested and found to comply with the limits for a Class B digital device, pursuant to part 15 of the FCC Rules. These limits are designed to provide reasonable protection against harmful interference in a residential installation. This equipment generates uses and can radiate radio frequency energy and, if not installed and used in accordance with the instructions, may cause harmful interference to radio communications. However, there is no guarantee that interference will not occur in a particular installation. If this equipment does cause harmful interference to radio or television reception, which can be determined by turning the equipment off and on, the user is encouraged to try to correct the interference by one or more of the following measures:

- Reorient or relocate the receiving antenna.
- Increase the separation between the equipment and receiver.
- Connect the equipment into an outlet on a circuit different from that to which the receiver is connected.
- Consult the dealer or an experienced radio/TV technician for help.

Documents / Resources

	<p>higi T71 Type C Wireless Transmitter [pdf] User Guide</p> <p>T71, 2A8VR-T71, 2A8VRT71, Type C Wireless Transmitter, Type C, Wireless Transmitter, Transmitter, Type C Transmitter, T71 Type C Wireless Transmitter, T71 Wireless Transmitter, T71 Transmitter</p>
---	--