

HighPoint Rocket 1120 NVMe HBA Controller Installation Guide

[Home](#) » [HighPoint](#) » HighPoint Rocket 1120 NVMe HBA Controller Installation Guide 

HighPoint Rocket 1120 NVMe HBA Controller Installation Guide

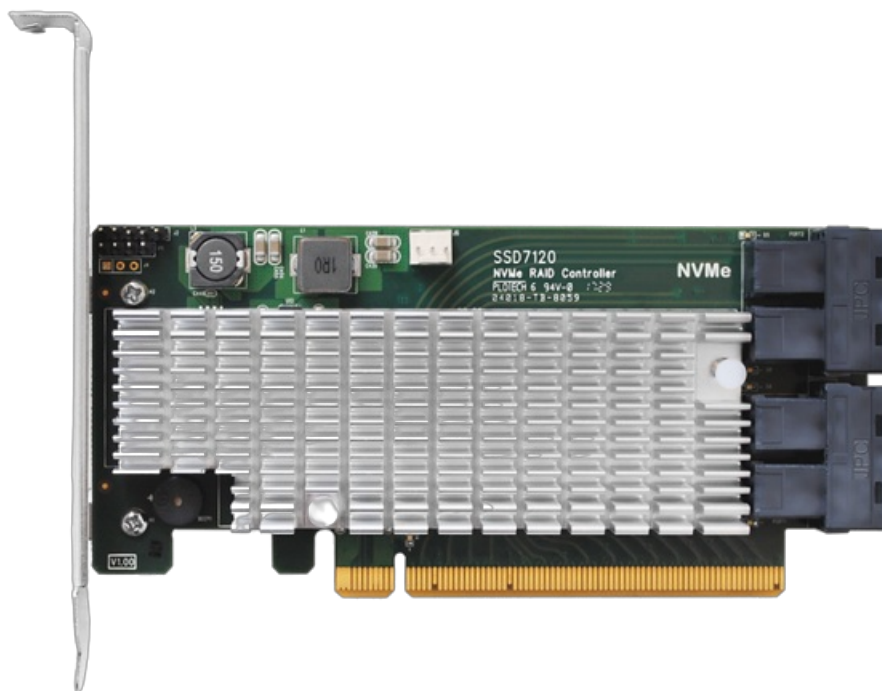

Contents

- [1 System Requirements](#)
- [2 R1120 Hardware Overview](#)
- [3 Customer Support](#)
- [4 Documents / Resources](#)
 - [4.1 References](#)
- [5 Related Posts](#)

System Requirements

PC Requirements

- System with a free PCIe 3.0 (or 4.0) x16 slot
- Windows 11, 10 / Server 2022, 2019, 2016, Microsoft Hyper-V
- RHEL/Debian/Ubuntu/Fedora/Proxmox/Xenserver (Linux kernel 3.10 and later)
- macOS 10.13.6 ~ macOS 13.x
- FreeBSD 12.1 and later

R1120 Kit Contents

- R1120 Controller Card
- Quick Installation Guide

R1120 Hardware Overview

Front View

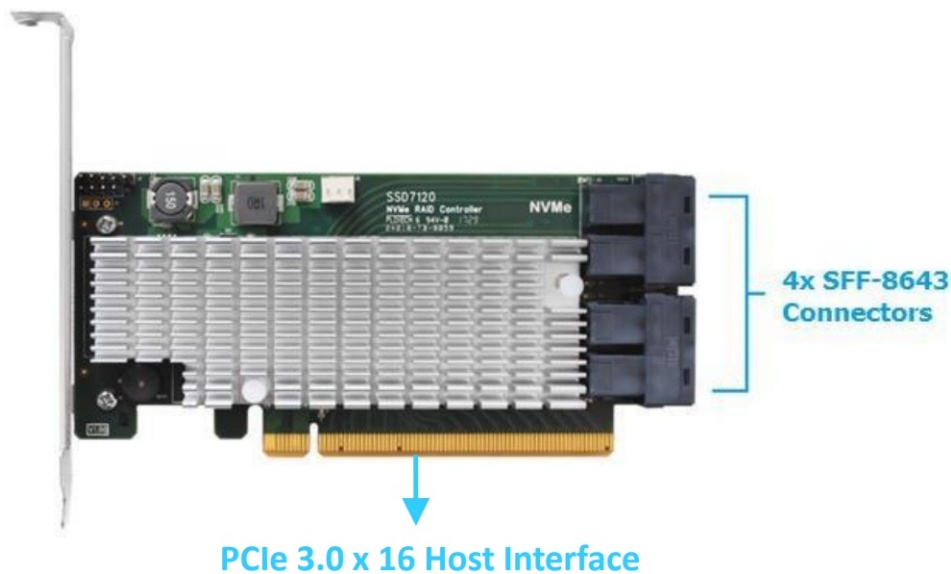

R1120 Hardware Installation

Step 1: Remove your system cover.

Step 2: Insert the R1120 card into an open PCIe 3.0/4.0 x16 slot on the motherboard.

Step 3: After you have inserted the R1120 card, you can connect the SFF-8643 cables.

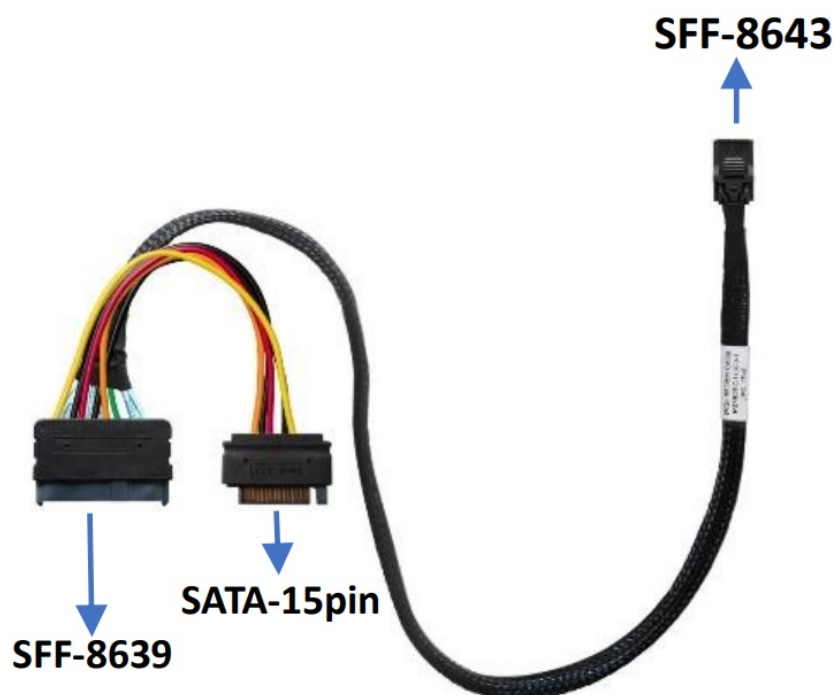

Step 4: Shown above is an SFF-8643 to U.2 SFF-8639 cable with a 15- pin SATA power connector. Connect the R1120 to the NVMe SSD's using the appropriate SFF-8643 cables. The SFF-8639 port should be connected to the NVMe SSD's U.2 port. The 15 pin SATA power connector should be connected the system's power supply.

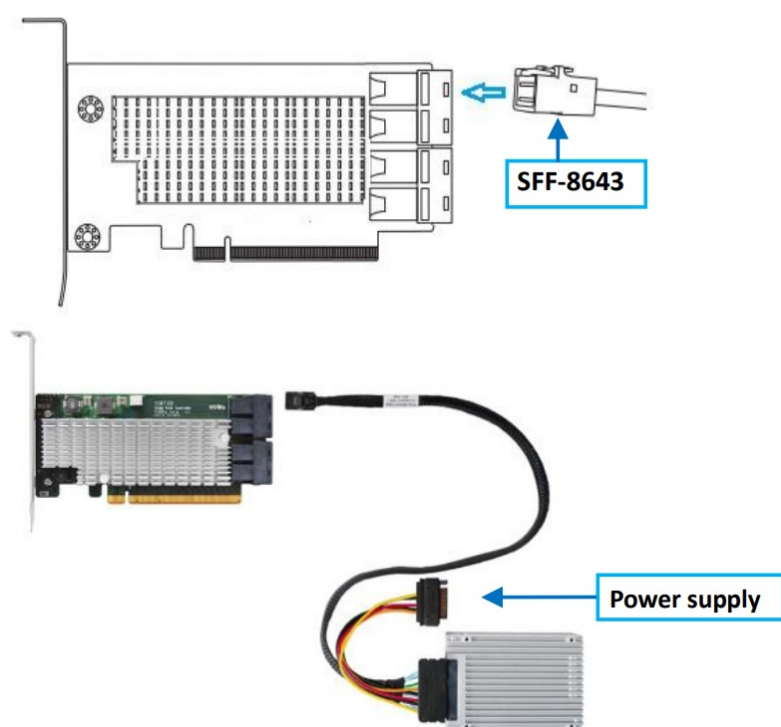

Step 5: Close the system cover and power up the system.

Note: Please make sure the cables are securely connected to the R1120's device ports and the NVMe SSDs or backplane. Loose connections can lead to a variety of problems including instability, slower than expected performance and dropped disks.

Resources

We recommend visiting the R1120 Series Product Page for the latest documentation.

Document Downloads:

<https://www.highpoint-tech.com/hba-gen3-nvme-u2>

Customer Support

If you encounter any problems while utilizing the R1120, or have any questions about this or any other HighPoint Technologies, Inc. product, feel free to contact our Customer Support Department.

Web Support:

<https://www.highpoint-tech.com/support-and-services>

HighPoint Technologies, Inc. websites:





<https://www.highpoint-tech.com>

© Copyright 2022 HighPoint Technologies, Inc. All rights reserved

Documents / Resources

 <p>Rocket 1120 (R1120) 6x U.2 Port (x2 PCIe 3.0x4 NVMe) HBA</p> <p>Quick Installation Guide V1.00 1</p>	<p>HighPoint Rocket 1120 NVMe HBA Controller [pdf] Installation Guide Rocket 1120 NVMe HBA Controller, Rocket 1120, NVMe HBA Controller, HBA Controller, Controller</p>
--	---

References

-  [Home | HighPoint Technology Inc.](#)
-  [Home | HighPoint Technology Inc.](#)
-  [HBA Gen3 U.2 | HighPoint-tech.com](#)
-  [Support and Services | HighPoint Technologies, Inc.](#)