



# HIF-NICS Subwoofer System ZRX111P User Manual

[Home](#) » [HIF-NICS](#) » HIF-NICS Subwoofer System ZRX111P User Manual 

## HIF-NICS Subwoofer System ZRX111P User Manual



### Contents

- [1 SAFETY INSTRUCTIONS](#)
- [2 POWER RATING](#)
- [3 SPECIFICATIONS](#)
- [4 CONNECTION TO MONO AMPLIFIER](#)
- [5 CONNECTION TO 2-CHANNEL AMPLIFIER](#)
- [6 DIMENSIONS](#)
- [7 INSTALLATION](#)
- [8 Documents / Resources](#)
- [9 Related Posts](#)

## SAFETY INSTRUCTIONS

Ensure that your subwoofer enclosure will not get loose during the drive and hurt someone in the passenger cabin. It is recommended, that you mount the subwoofer enclosure with suitable belts or any other mounting solutions in the trunk area. Please ensure not to damage any serial components of your vehicle (air bags, wires, gas tank etc.) during the installation of your sound system by drilling or any other operations.

Please ensure by any means the correct polarity of all connections. Faulty installed and connected devices may get damage the vehicle and the device permanently.

Please check in any case the operation guide or wiring manual of your amplifier which you'd like to use for the soundsystem.

Never connect the speaker terminals with the 12 Volt power supply, otherwise the speakers may get damaged.

## POWER RATING

HiFonics subwoofer enclosures are designed for high bass levels. Anyhow it is possible, that unsatisfying sound characteristics could be caused by too low or too high amplifier power. In certain circumstances this even can cause a damage to the loudspeakers.

It is recommended to choose rather a more powerful amplifier (ca. 15-20% more Watts RMS than the max. RMS power rating of the woofer) and to use the amplifier not at the maximum output level (low distortion factor, good sound characteristics). A weaker amplifier at the maximum level causes worse sound characteristics due to the higher distortion factor.

Never crank up the output volume of your amplifier to the maximum level or run the amplifier into the clipping range. If the sound is distorted and not clean, turn back the level until the distortions disappear.

HiFonics subwoofer enclosures have no integrated limiter or clipper, which is limiting the level upwards.

Overamplified bass peaks leads inevitably to a burn out of the voice coil of the woofer. A burn out of the voice coil, caused by clipping/overamping is not covered by the usual warranty

## SPECIFICATIONS

ZRX111P

**Subwoofer** :28 cm (11")

**Voice Coil**: Ø 64 mm

**Power Rating**: 150 Watts RMS

300 Watts max.

**Impedance**: 2 + 2 Ohms

**Frequency Range**: 20 – 150 Hz

**Dimensions**: Ø 360 x 145 mm

## CONNECTION TO MONO AMPLIFIER

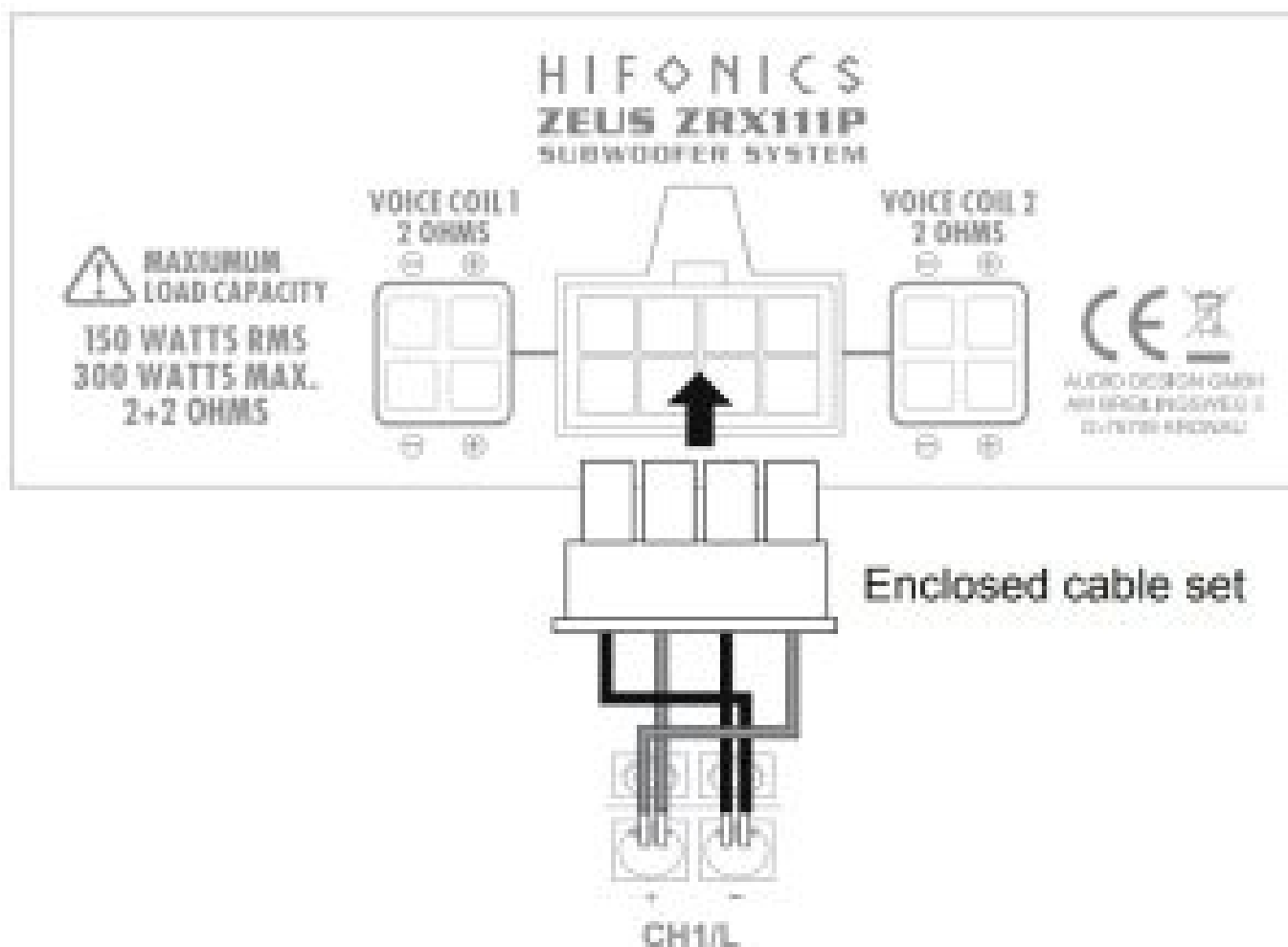

Connect the four cable ends accordingly to the loudspeaker outputs of the amplifier.



Recommended output power of the amplifier:  
120 – 180 watts RMS at 1 ohm impedance

## CONNECTION TO 2-CHANNEL AMPLIFIER

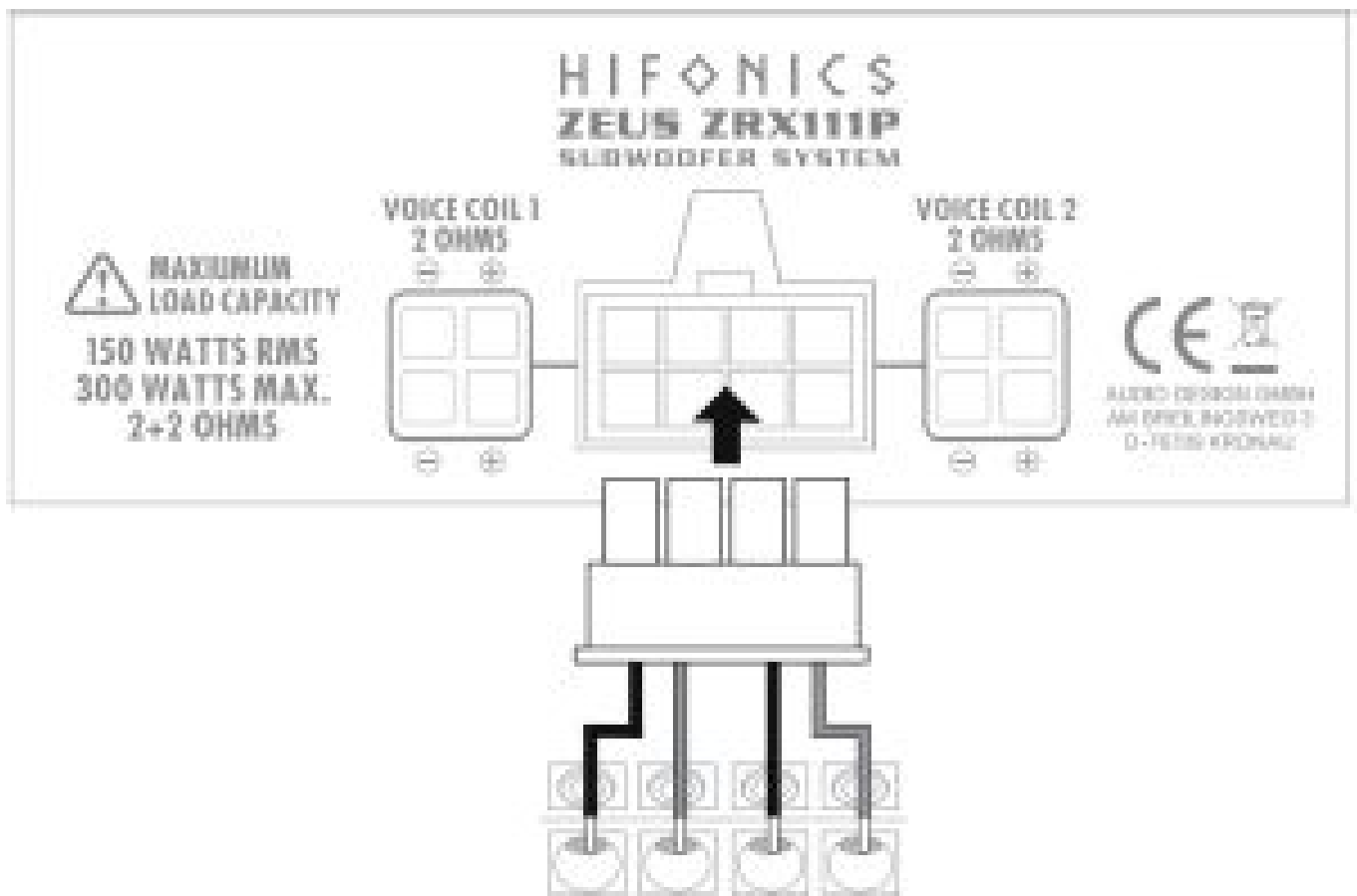

Connect the two cable ends of VOICE COIL 1 accordingly to the loudspeaker output CH1/L of the amplifier  
 Connect the two cable ends of VOICE COIL 2 accordingly to the loudspeaker outputs CH2/R of the amplifier.



Recommended output power of the amplifier:  
 2 x 60 – 90 watts RMS each at 2 ohms impedance

## DIMENSIONS

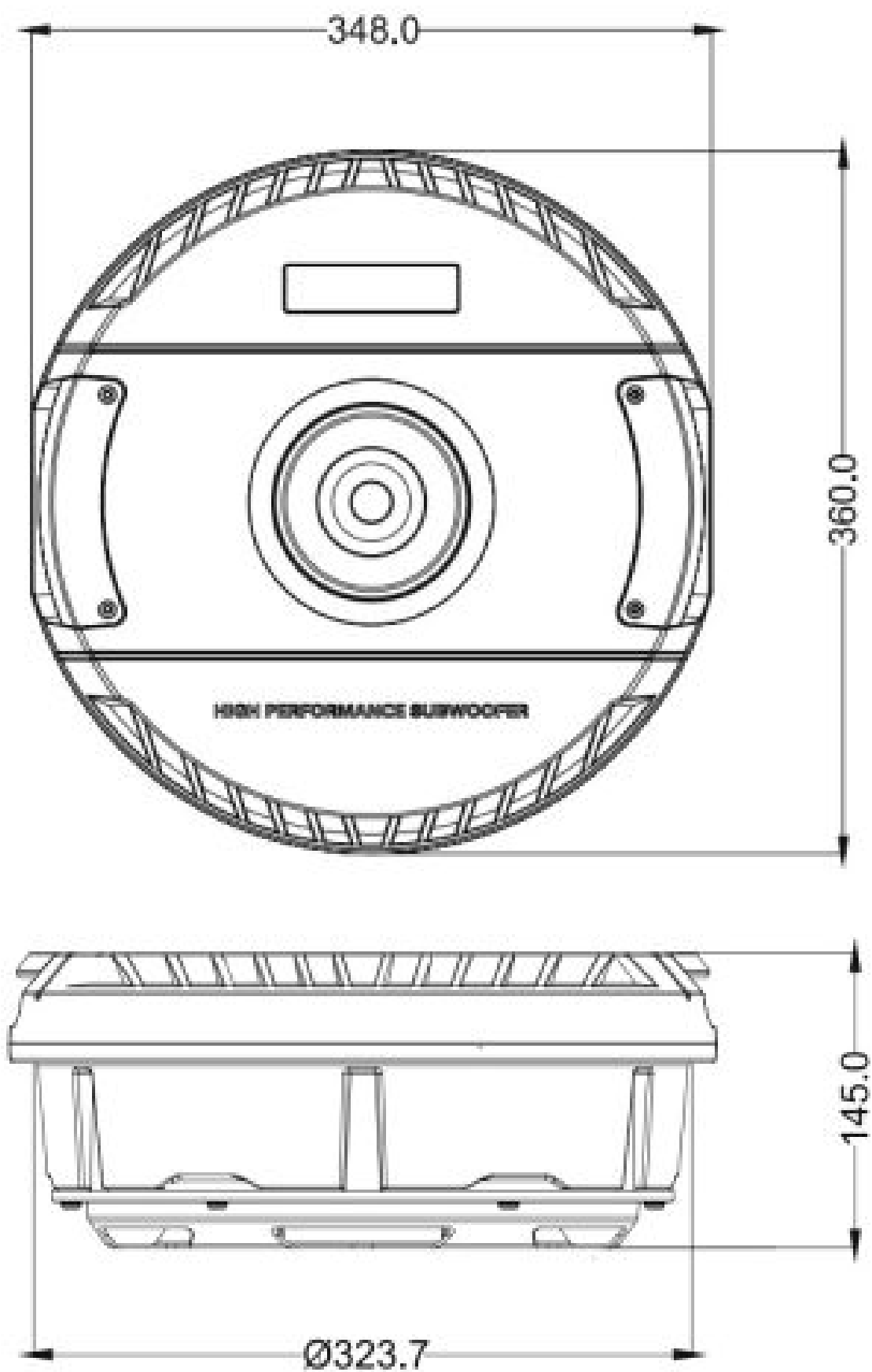

## INSTALLATION

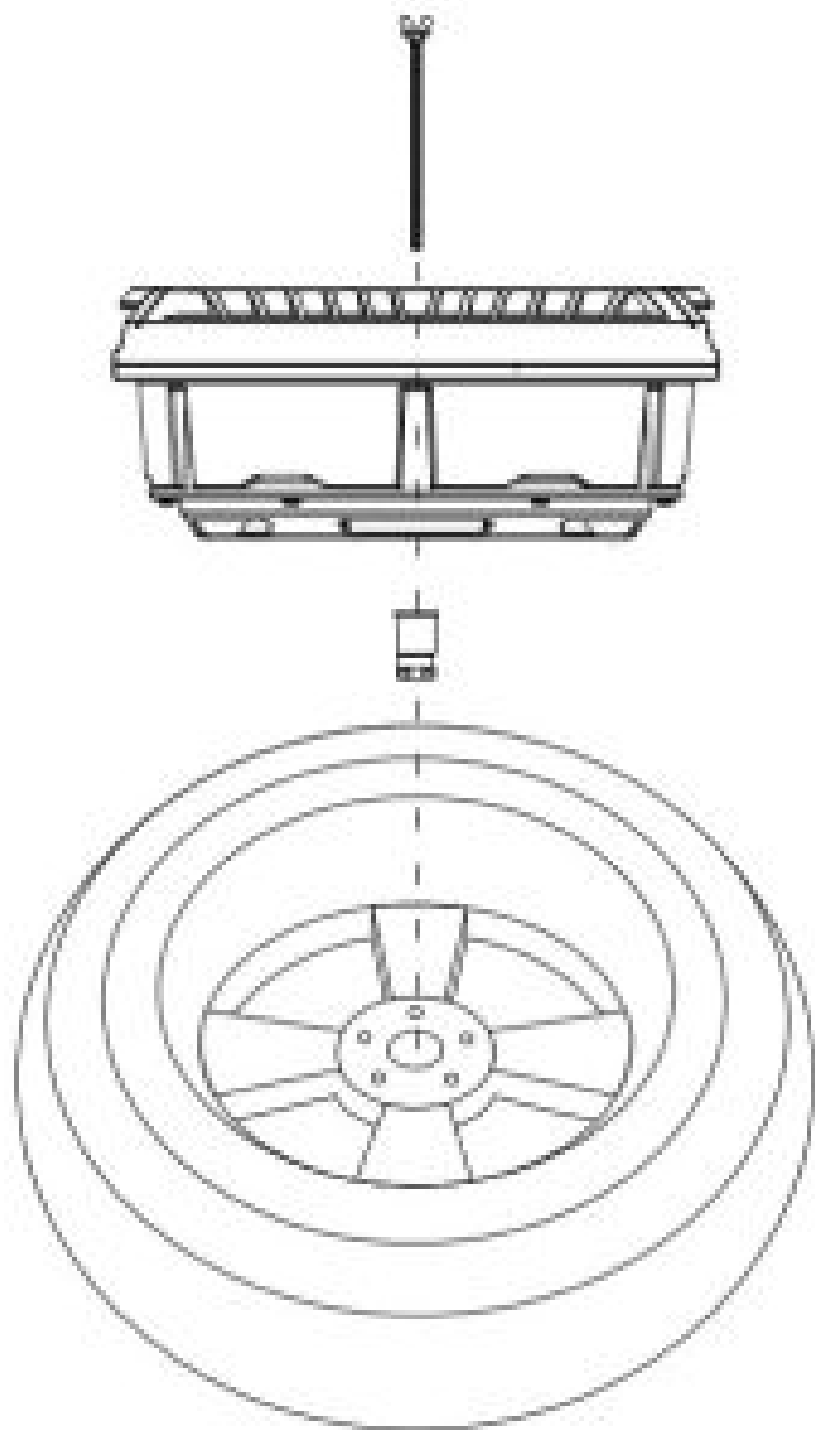

HIFONICS  
*Zeus*  
S E R I E S



Audio Design GmbH  
Am Breilingsweg 3 · D-76709 Kronau/Germany  
Tel. **+49 7253 – 9465-0** · Fax **+49 7253 – 946510**  
[www.audiodesign.de](http://www.audiodesign.de) – [www.hifonics.de](http://www.hifonics.de)  
© Audio Design GmbH, All Rights Reserved



## Documents / Resources

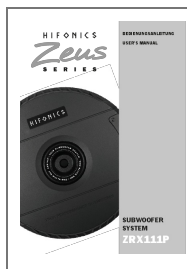

[HIF-NICS Subwoofer System ZRX111P](#) [pdf] User Manual  
HIF-NICS, Subwoofer System, ZRX111P, Zeus Series