

HEXCORE W800 Wireless Mechanical keyboard



HEXCORE W800 Wireless Mechanical keyboard User Guide

[Home](#) » [hexcore](#) » HEXCORE W800 Wireless Mechanical keyboard User Guide 📖

Contents

- 1 [HEXCORE W800 Wireless Mechanical keyboard](#)
- 2 [Online User Manual](#)
- 3 [Wired Connection](#)
- 4 [Bluetooth Connection](#)
- 5 [Switch Host](#)
- 6 [Backlight Control](#)
- 7 [Install desktop APP](#)
- 8 [Declaration of RoHS 2.0 Compliance](#)
- 9 [FCC Regulatory Compliance](#)
- 10 [Documents / Resources](#)
 - 10.1 [References](#)
- 11 [Related Posts](#)

HEXCORE

HEXCORE W800 Wireless Mechanical keyboard



Online User Manual

- Please scan the QR code below to get more information in the online user manual.

- <https://service.hexcore.xyz>



Wired Connection

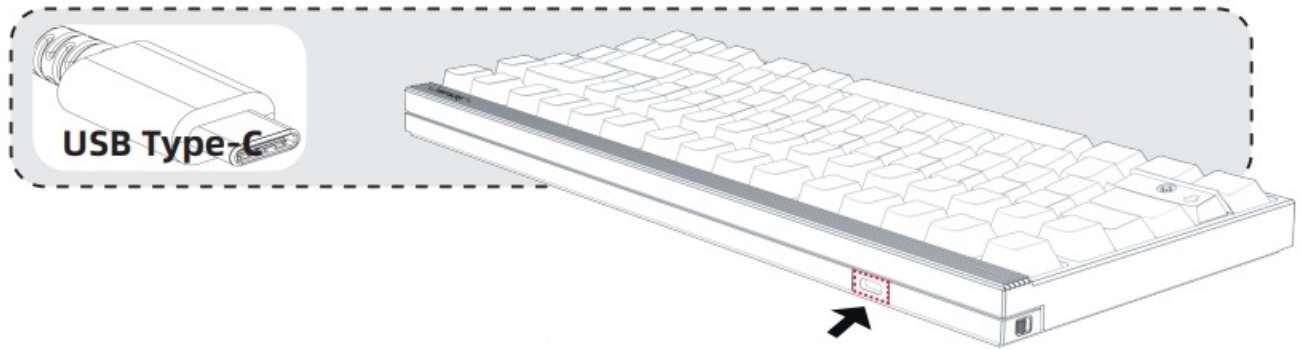

- Connect the keyboard to the computer through Type-C data cable

2.4G Connection

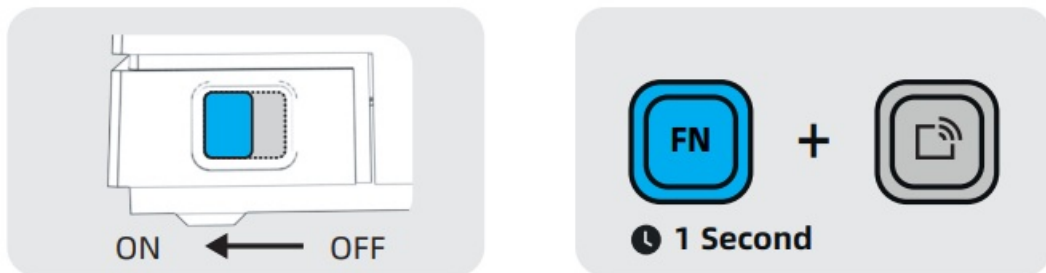

- Turn on the wireless switch

2.4G Switch



- Switch between multiple paired 2.4G USB receivers

2.4G Pair

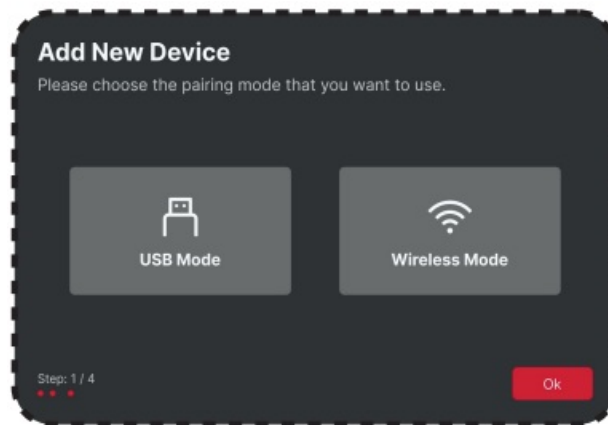

- Use HEXCORE-LINK to paired more 2.4G USB receivers

Bluetooth Connection

- Turn on the wireless switch
- Hold down FN +  for 5 seconds to turn on the Bluetooth broadcast

Note: Blink red light means the keyboard is ready for pairing. The keyboard broadcast will last 1 minute.



- Turn on the Bluetooth of the computer and connect the keyboard.

Switch Host

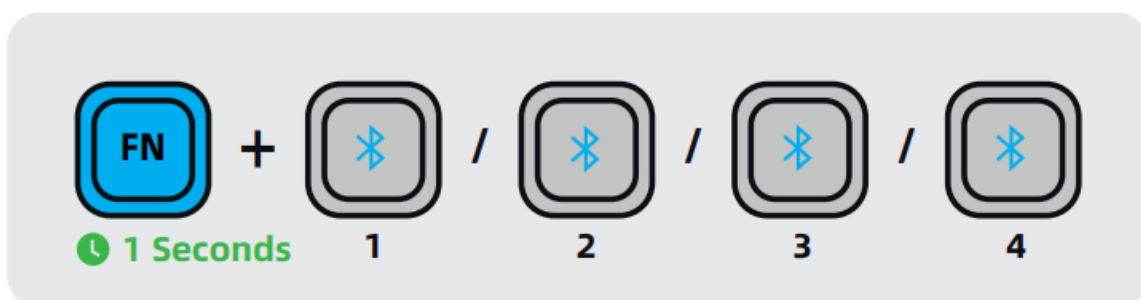

- Switch between multiple paired Bluetooth host

Note: When you press the switch host keys, the green light will slowly blink.

Backlight Control



Turn ON and OFF backlight



Increase backlight brightness



Switch backlight effect



Decrease backlight brightness

Install desktop APP

- Enhance your keyboard with HEXCORE-LINK

HEXCORE-LINK

- <https://www.hexcore.xyz/hexcore-link>

In addition to optimizing the keyboard for your operating system, hex-core-link lets you customize the keyboard to fit your needs and personal style—create shortcuts, reassign key functions, create a macro app, light system, enable (and disable) keys, display battery warnings, and much more.

Declaration of RoHS 2.0 Compliance

We're determined to reduce the impact we have on the environment and take responsibility for the earth we live on. So this document allows us to formally declare that the PA3109, manufactured by Taicang Zhigengniao Information Technology Co., Ltd, fully complies with the European Parliament's RoHS 2.0 Directive 2011/65/EU, for all the following substances:

1. Lead(Pb)
2. Mercury(Hg)
3. Cadmium(Cd)
4. Hexavalent Chromium(Cr(VI))
5. Polybrominated biphenyl(PBB)
6. Polybrominated diphenyl ether(PBDE)
7. Di(2-ethylhexyl) phthalate(DEHP)
8. Dibutyl phthalate(DBP)
9. Benzyl butyl phthalate(BBP)
10. Diisobutyl phthalate(DIBP)

Our compliance is witnessed by written declaration from our suppliers. This confirms that any potential trace contamination levels of the substances listed above are below the maximum level set by EU 2011/65/EU, or are exempt due to their application.

FCC Regulatory Compliance

This equipment complies with FCC RF radiation exposure limits set forth for an uncontrolled environment. This device complies with part 15 of the FCC rules. Operation is subject to the following two conditions:

1. This device may not cause harmful interference.
2. This device must accept any interference received, including interference that may cause undesired operation.

FCC Part 15.21 information for the user

You are cautioned that changes or modifications not expressly approved by the party responsible for compliance could void your authority to operate the equipment.

FCC 15b devices(15.105)

This equipment has been tested and found to comply with the limits for a Class B digital device, under part 15 of the FCC rules. These limits are designed to provide reasonable protection against harmful interference in a residential installation. This equipment generates, uses, and can radiate radio frequency energy and, if not installed and used per the instructions, may cause harmful interference to radio communications. However, there is no guarantee that interference will not occur in a particular installation. If this equipment does cause harmful interference to radio or television reception, which can be determined by turning the equipment off and on, the user is encouraged to try to correct the interference by one or more of the following measures:

- Reorient or relocate the receiving antenna.
- Increase the separation between the equipment and the receiver.
- Connect the equipment to an outlet on a circuit different from that to which the receiver is connected.
- Consult the dealer or an experienced radio/TV technician for help



Taicang Zhigengniao Information Technology Co., Ltd. Address: University Science Park, No. 20 Jianxiong Road, Taicang City, Suzhou, Jiangsu Province, P. R. China Official website: www.hexcore.xyz

- www.hexcore.xyz

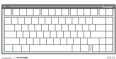
Documents / Resources

	HEXCORE W800 Wireless Mechanical keyboard [pdf] User Guide 2AT6R-W800, 2AT6RW800, W800 Wireless Mechanical keyboard, W800, Wireless Mechanical keyboard, Mechanical keyboard, keyboard
---	--

References

-  [HEXCORE Service - HEXCORE](#)
-  hexcore.xyz/hexcore-link
- [User Manual](#)

[Manuals+](#), [Privacy Policy](#)

This website is an independent publication and is neither affiliated with nor endorsed by any of the trademark owners. The "Bluetooth®" word mark and logos are registered trademarks owned by Bluetooth SIG, Inc. The "Wi-Fi®" word mark and logos are registered trademarks owned by the Wi-Fi Alliance. Any use of these marks on this website does not imply any affiliation with or endorsement.