



HEXBUG 68124TX2G4 Black Window Science and Learning Toy Instruction Manual

[Home](#) » [HEXBUG](#) » HEXBUG 68124TX2G4 Black Window Science and Learning Toy Instruction Manual 



Contents

- [1 68124TX2G4 Black Window Science and Learning Toy](#)
- [2 HOW TO PAIR REMOTE](#)
- [3 Documents / Resources](#)
 - [3.1 References](#)

68124TX2G4 Black Window Science and Learning Toy

CABLE CAN ONLY INSERT ONE WAY. DO NOT FORCE IN.

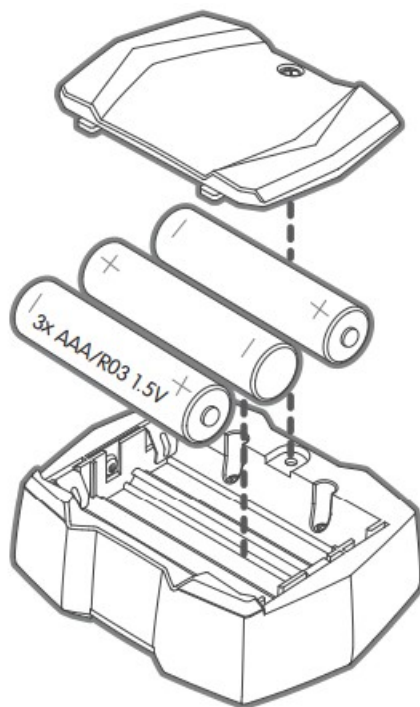

OPEN DOOR TO INSTALL & REMOVE BATTERIES.

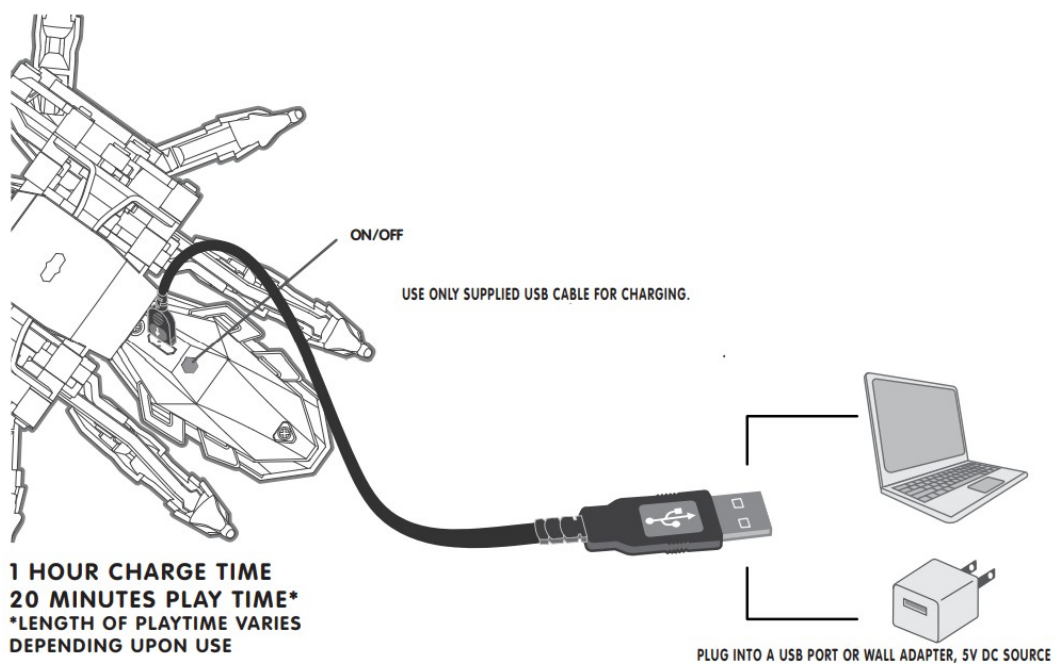

HOW TO PAIR REMOTE

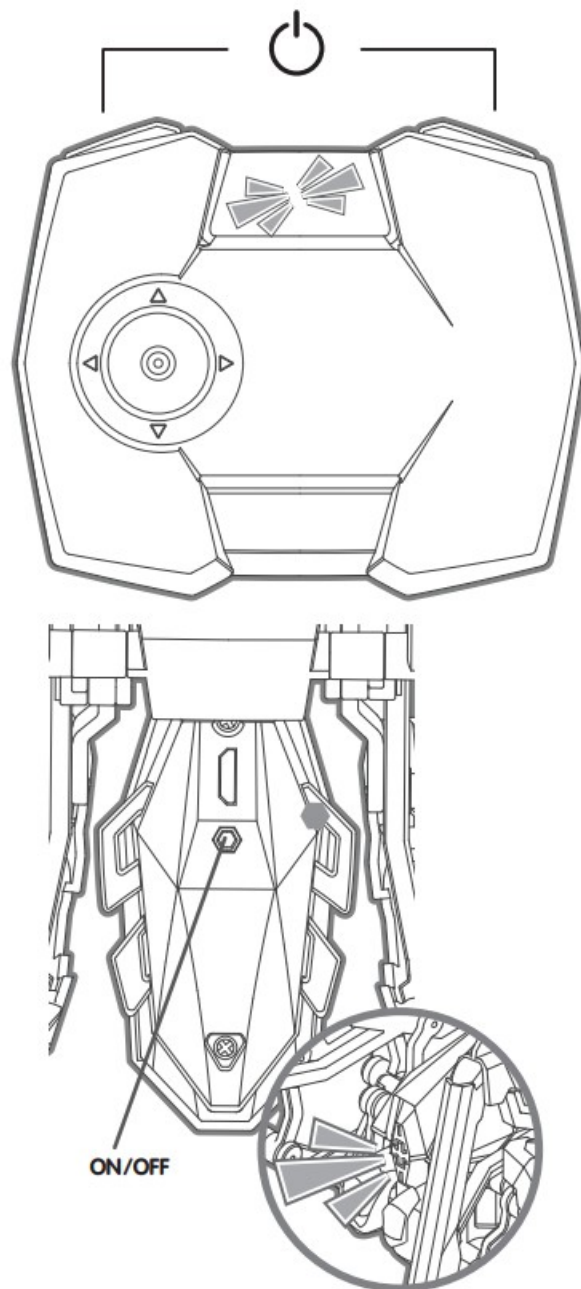

1. Turn on the remote by pressing one of the triggers on top. A light will blink when activated.
2. Turn on the Black Widow™ by pressing and holding the power button on the bottom. A light will blink quickly when ready to pair.
3. When the remote is paired, all lights will be solid.

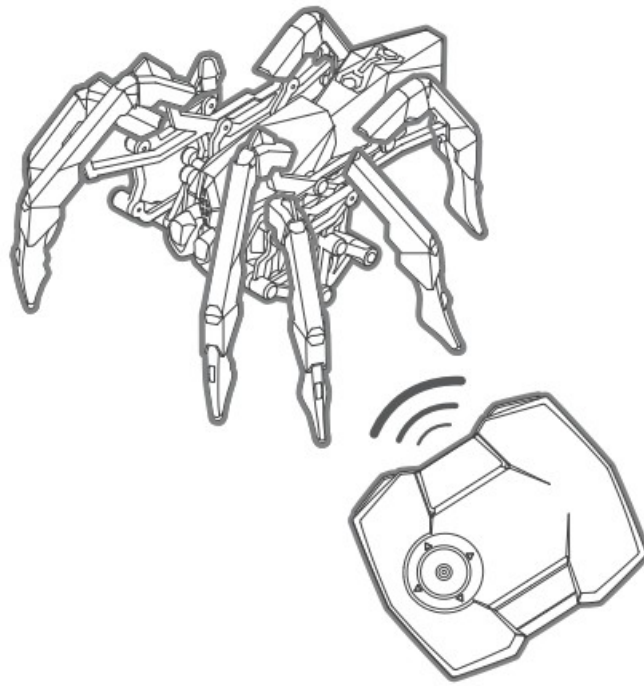

After the Black Widow™ is inactive for 2 minutes, it'll turn off. After 2 minutes of inactivity or holding the right trigger for over 2 seconds, the remote will turn off.

To play, turn on the remote with the triggers and then Black Widow™ with the power button.

THE ANALOG STICK GIVES YOU PROPORTIONAL CONTROL.

<p>TO GO SLOW, MOVE THE ANALOG STICK PART OF THE WAY IN ANY DIRECTION.</p>	<p>TO GO FAST, MOVE THE ANALOG STICK FULLY IN ANY DIRECTION.</p>

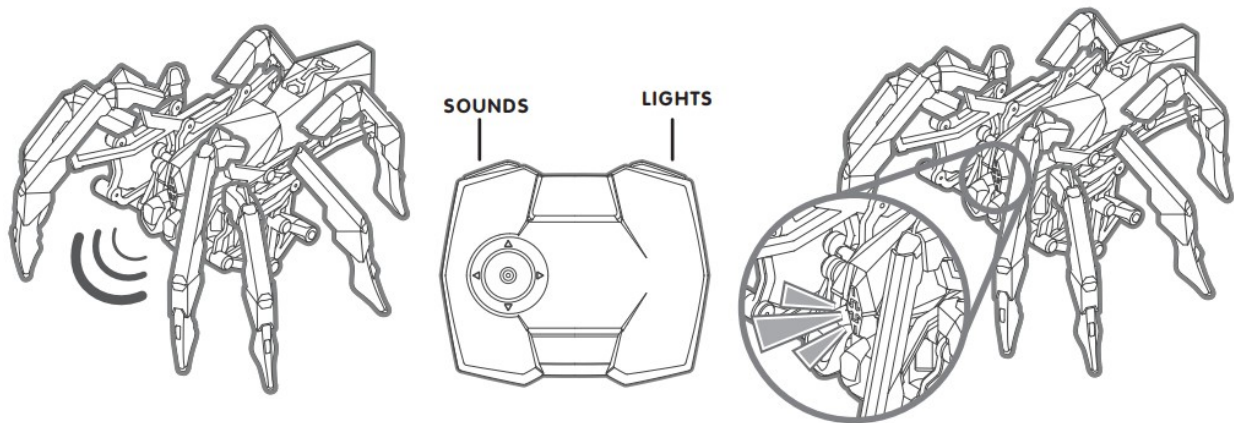
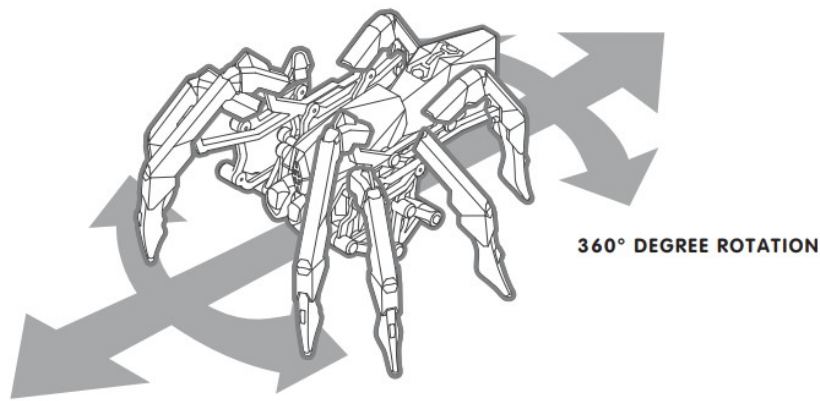

Requires 1 x LiPo & 3 x 1.5 V, AAA(R03) batteries (INCLUDED). Batteries or battery packs must be removed for recycling and proper disposal. When this product has reached the end of its useful life, it should not be disposed of with other household waste. EU legislation for Electrical and Electronic Equipment and Batteries, requires these to be separately collected so that they can be treated using the best available recovery and recycling techniques. This will minimize the impact on the environment and human health from soil and water contamination by any hazardous substances, decrease the resources required to make new products and avoid using up landfill space. Please do your part by keeping this product out of the municipal waste stream! The “wheelie bin” symbol means that it should be collected as “waste electrical and electronic equipment”. You can return an old product to your retailer when you buy a similar new one. For other options, please contact your local council.

HOW TO INSTALL BATTERIES:

1. Open the battery door with a screwdriver.
2. If used batteries are present, remove these batteries from the unit by pulling up on one end of each battery. DO NOT remove or install batteries using sharp or metal tools.
3. Install new batteries as shown in the polarity diagram (+/-) inside the battery compartment.
4. Replace battery door securely.
5. Check your local laws and regulations for correct recycling and/or battery disposal.

BATTERY SAFETY INFORMATION:

Batteries are small objects. Replacement of batteries must be done by adults. Follow the polarity (+/-) diagram in the battery compartment. Promptly remove dead batteries from the toy. Dispose of used batteries properly. Remove batteries for prolonged storage. Only batteries of the same or equivalent type as recommended are to be used. DO NOT incinerate used batteries. DO NOT dispose of batteries in fire, as batteries may explode or leak. DO NOT mix old and new batteries or types of batteries (i.e. alkaline/standard/rechargeable). Using rechargeable batteries is not recommended due to possible reduced performance. Rechargeable batteries are only to be

charged under adult supervision. Replaceable-rechargeable batteries are to be removed from the toy before being charged. DO NOT recharge non-rechargeable batteries. DO NOT short-circuit the supply terminals.

FCC STATEMENT: This device complies with Part 15 of the FCC rules. Operation is subject to the following two conditions: (1) This device may not cause harmful interference, and (2) This device must accept any interference received, including interference that may cause undesired operation. This equipment has been tested and found to comply with the limits for Class B digital devices pursuant to Part 15 of the FCC rules. These limits are designed to provide reasonable protection against harmful interference to radio communications. This equipment generates, uses and can radiate radio frequency energy and, if not installed and used in accordance with the instruction, may cause harmful interference to radio communication. However, there is no guarantee that interference will not occur in a particular installation.

If this toy does cause interference to radio or television reception (you can check this by turning the toy off and on while listening for the interference), one or more of the following measures may be useful:

- Reorient or relocate the receiving antenna
- Increase the separation between the toy and the radio or the TV
- Consult the dealer or an experienced TV-radio technician for help.

NOTE: Changes, adjustments or modifications to this unit, including but not limited to, replacement of any transmitter component (crystal, semiconductor, etc) could result in a violation of FCC rules under part 15 and/or 95 and must be expressly approved by Spin Master Ltd or they could void the user's authority to operate the equipment. Spin Master Inc., PMB #10053, 300 International Drive, Suite 100, Williamsville, NY 14221. To contact the responsible party please visit fcc.spinmaster.com

CAN ICES-3(B)/NMB-3(B)

CANADIAN Class B statement: This device contains licence-exempt transmitter(s)/receiver(s) that comply with Innovation, Science and Economic Development Canada's licence-exempt RSS(s). Operation is subject to the following two conditions:

1. This device may not cause interference.
2. This device must accept any interference, including interference that may cause undesired operation of the device.

Frequency Band(s): 2 400 MHz – 2 483.5 MHz / Maximum radio frequency power transmitted: < 10dBm

Retain this information, addresses and phone numbers for future reference.

Black Widow™ contains batteries that are non-replaceable.

The transformer, power supply or battery charger used with the electric toy shall be regularly examined for damage to the supply cord, plug, enclosure or other parts, and in the event of damage, it shall not be used until the damage has been repaired.



WARNING: CHOKING HAZARD – Small parts. Not suitable for children under three years. DO NOT put in nose or mouth.



This toy is only to be connected to Class II equipment bearing the symbol
Spin Master International B.V. hereby declares that the radio equipment type HEXBUG® BLACK WIDOW™ is in compliance with Directive 2014/53/EU. The full text of the EU declaration of conformity is available at the following internet address:

<http://doc.spinmaster.com>



1x LiPo & 3x AAA (R03) Batteries Included



HEXBUG.COM

HEXBUG.CA



TM &© Spin Master Inc. Spin Master Ltd., 225 King Street West, Toronto ON M5V 3M2 Canada
Spin Master Inc., PMB #10053, 300 International Drive, Suite 100, Williamsville, NY 14221
Spin Master International B.V., Kingsfordweg 151, 1043 GR Amsterdam, NL
Spin Master Australia Pty Ltd, Level 9, 205 Pacific Hwy, St Leonards, NSW 2065; ☎ 1800 316 982
Spin Master Toys UK Ltd. Boston House, Boston Drive, Bourne End, Buckinghamshire, SL8 5YS, UK



WWW.SPINMASTER.COM

Patents.spinmaster.com

MADE IN CHINA

Toy Imported by: Spin Master México,
S.A. de C.V., Av. Insurgentes Sur No.1070 8th floor,
Colonia Insurgentes San Borja,
Mayor Benito Juárez, C.P. 03100,
Mexico City. R.F.C. SMM050627V48
T68124_0001/0002/0003_20145185/20145186/20145187_GML_IS_R7



Documents / Resources

	<p>HEXBUG 68124TX2G4 Black Window Science and Learning Toy [pdf] Instruction Manual 68124TX2G4, PQN68124TX2G4, 68124TX2G4 Black Window Science and Learning Toy, Black Window Science and Learning Toy, Window Science and Learning Toy, Science and Learning Toy, Learning Toy, Toy</p>
---	--

References

- doc.spinmaster.com
- patents.spinmaster.com
- SPINMASTER.COM

- [User Manual](#)

[Manuals+](#), [Privacy Policy](#)

This website is an independent publication and is neither affiliated with nor endorsed by any of the trademark owners. The "Bluetooth®" word mark and logos are registered trademarks owned by Bluetooth SIG, Inc. The "Wi-Fi®" word mark and logos are registered trademarks owned by the Wi-Fi Alliance. Any use of these marks on this website does not imply any affiliation with or endorsement.