



## Hercules DJ Control Inpulse 200 Instruction Manual

[Home](#) » [Hercules](#) » Hercules DJ Control Inpulse 200 Instruction Manual 

### Hercules DJ Control Inpulse 200 Instruction Manual



#### Contents

- 1 Install the DJ equipment
- 2 Prepare DJUCED and DJControl Inpulse 200
- 3 Follow lights to set the BPM with the tempo fader
- 4 Follow lights to align the beats with the jog-wheel
- 5 Make a smooth transition with the crossfader
- 6 Find next song with Intelligent Music Assistant (IMA)
- 7 Further use of the Intelligent Music Assistant (IMA)
- 8 DJ Academy (if you are connected to the internet)
- 9 Documents / Resources
  - 9.1 References
- 10 Related Posts

### Install the DJ equipment

#### CONNECT

- The computer to the power outlet

- DJControl Inpulse 200 to the computer via USB
- Speakers to DJControl Inpulse 200 master output
- Headphones to DJControl Inpulse 200 headphones' output (on front panel of DJControl Inpulse 200)

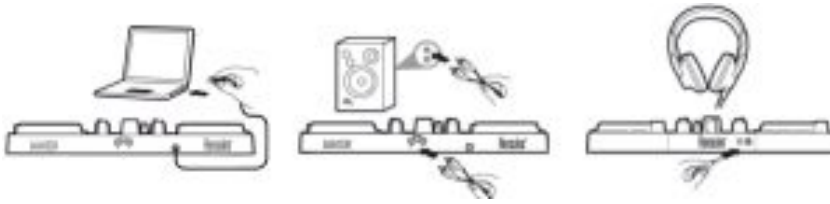

## INSTALL

- Download DJUCED <https://www.djuced.com>
- Install DJUCED on the computer.
- Copy your songs on the computer, for example on Windows or macOS Music folder

## Prepare DJUCED and DJControl Inpulse 200

### PREPARE DJUCED

- Run DJUCED.
- To add your songs in DJUCED, browse in Library > Explorer, and the folder, for example Music.
- Add your own tracks, analyze them in DJUCED:
  - Select the songs (shift + mouse).
  - Right-click: BPM > Analyze.
- In DJUCED Song Library > Demo Songs,
  - Load House Loop 1 on deck 1.
  - Load House Loop 2 on deck 2.

### PREPARE DJCONTROL IMPULSE 200

- Check the BEATMATCH GUIDE key on the DJControl Inpulse 200 is lit up.



- Move the tempo faders on deck 1 & deck 2 to the central position: a green LED will light up.
- Set both volume faders to 75%.
- Set Filter, Low, High, Gain, Headphones, and Master rotary knobs to mid position.
- Set the crossfader fully to the left to hear deck 1 on master output.

## Follow lights to set the BPM with the tempo fader

- Press Play on deck 1.
- A red light alongside the tempo fader on Deck 2 shows the direction to drag the fader, to set Deck 2's track to the same BPM.
- Move the tempo fader up or down, in the direction of the red light.
- If the direction of the red light changes, move the fader slowly in the opposite direction.
- When the red lights on the up/down fader blink, stop moving the tempo fader.
- Both red lights off: the BPM is set.

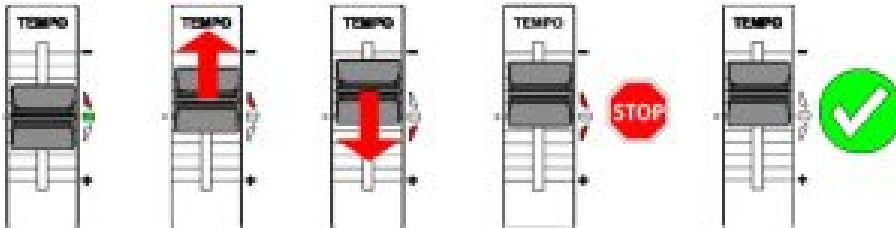

**DJUCED shows the same BPM on deck 1 and deck 2: TEMPO-MATCH**

### Follow lights to align the beats with the jog-wheel

- Press Play on deck 2.
- A red light below the jog wheel on deck 2 shows the direction to turn the wheel, to align deck 2's beats with deck 1's beats.
- Turn the wheel in the direction of the red light.
- If the direction of the red light changes, turn the wheel slowly in the opposite direction.
- As soon as the red lights on the left and right go off, stop: the beats are aligned.

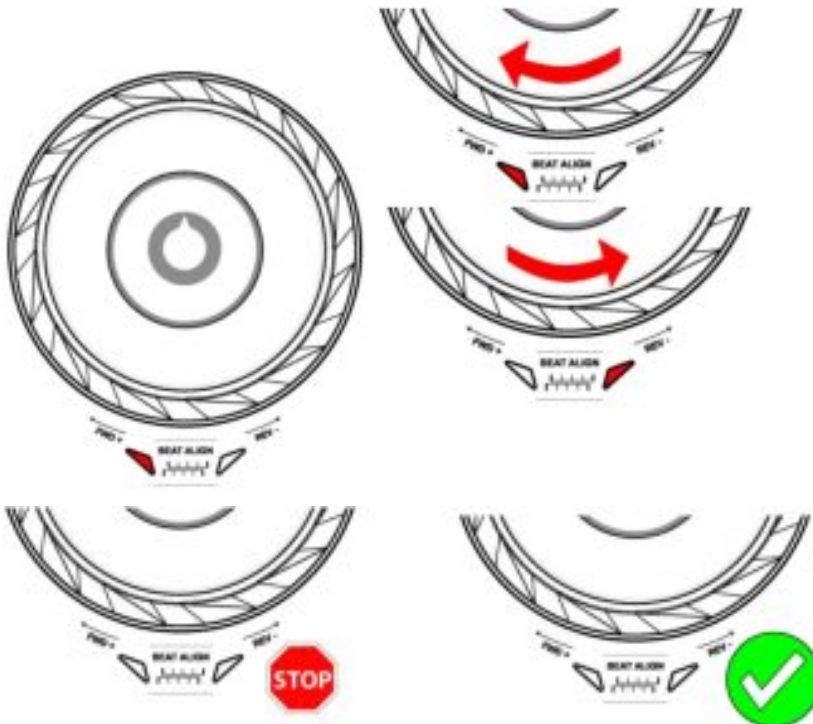

**DJUCED waveforms show beat-grids for both tracks are aligned: BEATMATCH**

### Make a smooth transition with the crossfader

## FROM LEFT (DECK 1) TO CENTER

- Move the crossfader gradually from left (Deck 1) to the central position.
- When the crossfader reaches the center, you hear both tracks mixed together.
- Pause a few seconds when the crossfader reaches the center: both tracks are synchronized with beats playing together.

## FROM CENTER TO RIGHT (DECK 2)

- Move the crossfader gradually from the center to the right.
- When the fader is all the way to the right, the transition is complete: you did a smooth transition from deck 1 to deck 2.

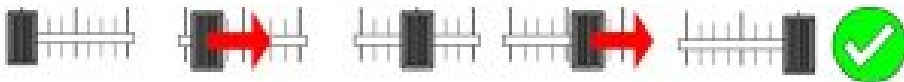

DJs may add effects, such as a filter, over one song during the transition, but it is not necessary if both tracks are in a key that is compatible, such as House Loop 1 and House Loop 2.

## Find next song with Intelligent Music Assistant (IMA)

- Press the Play/Pause button to stop the playback on deck 1.
- Press the Assistant key once, below the Browser rotary button.
- The Assistant key and the base around the Browser light up.
- DJUCED browser shows a list of tracks, selected by the Assistant.
- IMA selects tracks with a key, BPM and energy that fit with the song currently playing.
- Move through the list on the Browser Cap.
- Press left LOAD key to load the track on deck 1.

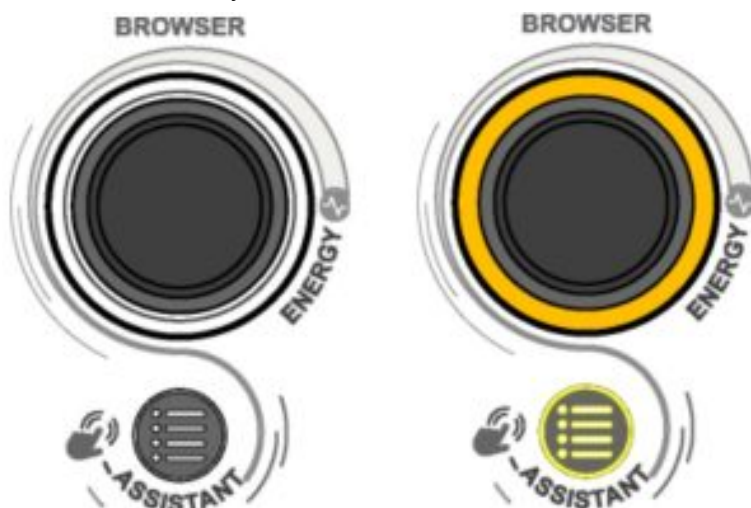

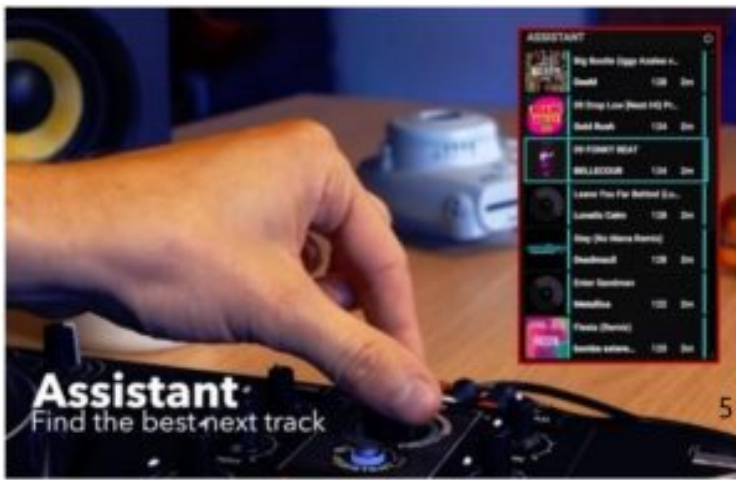

## Further use of the Intelligent Music Assistant (IMA)

### SELECT ENERGY

Energy is song danceability, from cool to hot.

- Select Energy for the assistant suggestions, from cool (dark blue) to hot (red): hold the Assistant key down + turn the Browser Cap.
  - The color of the ring at the base of the Browser knob reflects the requested energy.
  - If the library has tracks at this energy, with keys and BPMs that fit your current master track, these will be added to the list in Assistant.



### CLOSE THE ASSISTANT

- To close the IMA and the Assistant list, press the Browser button.

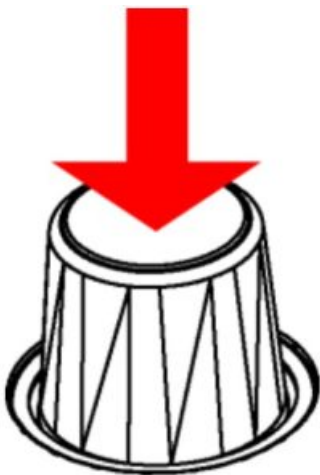

- The back lights on the Assistant key and the ring at the base of the Browser will be switched off.



## DJ Academy (if you are connected to the internet)

### CALL THE DJ ACADEMY

- In DJUCED, on the right of the browser, you can see a smiley wearing a graduation hat.
- Click on it to call the DJ Academy video tutorials in DJUCED.



### BROWSE THE ACADEMY

- The DJ Academy lets you select the lessons you are looking for.
- Select 02 Beatmatch, and play “How to Use the Pitch Fader” to revise usage of the tempo fader (step 3 in this demo).



DJ Academy in DJUCED = first DJ software with video lessons embedded in the DJ software.

HOW TO USE  
Hercules DJCONTROL IMPULSE 200



INTRODUCTION	2
INSTALLATION	3
UNINSTALLATION	10
UPDATES	10
SOFTWARE	10
CONTROLS	10
SETTINGS	10
FAQ	10
INDEX	10
APPENDIX	10
CONTACT	10

[Hercules Hercules DJ Control Impulse 200](#) [pdf] Instruction Manual  
Hercules, DJ, Control, Impulse, 200

## References

- [DJUCED – Free DJ Software for Professionals](#)
- [DJUCED – Free DJ Software for Professionals](#)