

# HERCULES HCB043 20V Brushless Compact Router Owner's Manual

[Home](#) » [Hercules](#) » **HERCULES HCB043 20V Brushless Compact Router Owner's Manual** 

**HERCULES HCB043 20V Brushless Compact Router**

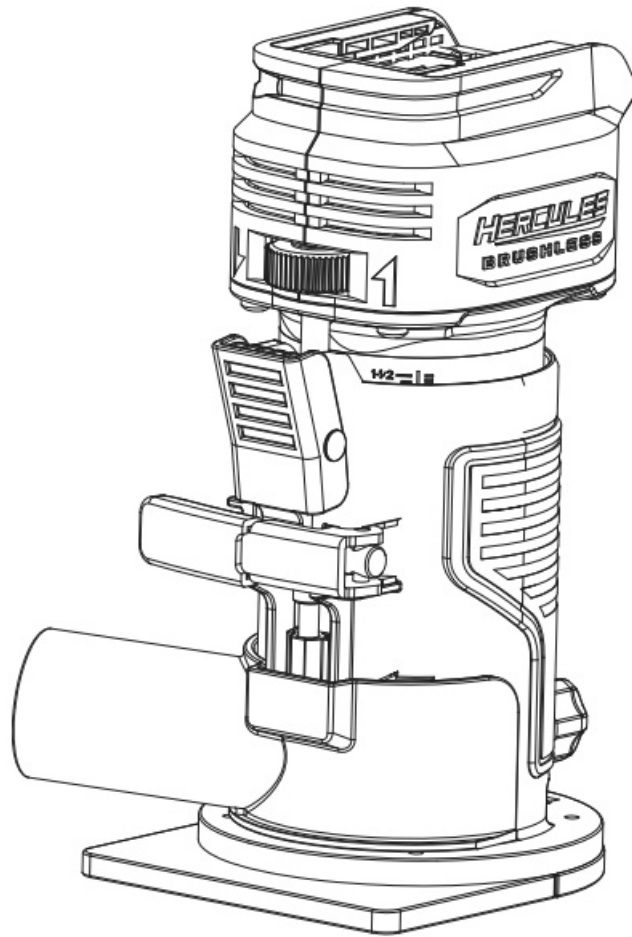

## Contents

- 1 Important Information
- 2 IMPORTANT SAFETY INFORMATION
- 3 SPECIFICATIONS
- 4 FUNCTIONAL DESCRIPTION
- 5 SETUP – BEFORE USE
- 6 OPERATION
- 7 MAINTENANCE AND SERVICING
- 8 Troubleshooting
- 9 5-YEAR LIMITED WARRANTY
- 10 Customer Support
- 11 Documents / Resources
  - 11.1 References
- 12 Related Posts

## Important Information



**WARNING:** To prevent serious injury, User must read and understand Owner's Manual. SAVE THIS MANUAL.

When unpacking, make sure that the product is intact and undamaged.

If any parts are missing or broken, please call 1-888-866-5797 as soon as possible. Reference 59615.

## IMPORTANT SAFETY INFORMATION

## General Power Tool Safety Warnings

**⚠WARNING** Read all safety warnings, instructions, illustrations and specifications provided with this power tool.

Failure to follow all instructions listed below may result in electric shock, fire and/or serious injury.

Save all warnings and instructions for future reference.

The term “power tool” in the warnings refers to your mains-operated (corded) power tool or battery-operated (cordless) power tool.

### Work area safety

1. Keep work area clean and well lit. Cluttered or dark areas invite accidents.
2. Do not operate power tools in explosive atmospheres, such as in the presence of flammable liquids, gases or dust. Power tools create sparks which may ignite the dust or fumes.
3. Keep children and bystanders away while operating a power tool. Distractions can cause you to lose control.

### Electrical safety

1. Power tool plugs must match the outlet. Never modify the plug in any way. Do not use any adapter plugs with earthed (grounded) power tools. Unmodified plugs and matching outlets will reduce risk of electric shock.
2. Avoid body contact with earthed or grounded surfaces, such as pipes, radiators, ranges and refrigerators.  
There is an increased risk of electric shock if your body is earthed or grounded.
3. Do not expose power tools to rain or wet conditions. Water entering a power tool will increase the risk of electric shock.
4. Do not abuse the cord. Never use the cord for carrying, pulling or unplugging the power tool. Keep cord away from heat, oil, sharp edges or moving parts. Damaged or entangled cords increase the risk of electric shock.
5. When operating a power tool outdoors, use an extension cord suitable for outdoor use. Use of a cord suitable for outdoor use reduces the risk of electric shock.
6. If operating a power tool in a damp location is unavoidable, use a ground fault circuit interrupter (GFCI) protected supply. Use of a GFCI reduces the risk of electric shock.

### Personal safety

1. Stay alert, watch what you are doing and use common sense when operating a power tool. Do not use a power tool while you are tired or under the influence of drugs, alcohol or medication. A moment of inattention while operating power tools may result in serious personal injury.
2. Use personal protective equipment. Always wear eye protection. Protective equipment such as dust mask, non-skid safety shoes, hard hat, or hearing protection used for appropriate conditions will reduce personal injuries.
3. Prevent unintentional starting. Ensure the switch is in the off-position before connecting to power source and/or battery pack, picking up or carrying the tool. Carrying power tools with your finger on the switch or energizing power tools that have the switch on invites accidents.
4. Remove any adjusting key or wrench before turning the power tool on. A wrench or a key left attached to a rotating part of the power tool may result in personal injury.
5. Do not overreach. Keep proper footing and balance at all times. This enables better control of the power tool in

unexpected situations.

6. Dress properly. Do not wear loose clothing or jewelry. Keep your hair, clothing and gloves away from moving parts. Loose clothes, jewelry or long hair can be caught in moving parts.
7. If devices are provided for the connection of dust extraction and collection facilities, ensure these are connected and properly used. Use of dust collection can reduce dust-related hazards.
8. Do not let familiarity gained from frequent use of tools allow you to become complacent and ignore tool safety principles. A careless action can cause severe injury within a fraction of a second.
9. Only use safety equipment that has been approved by an appropriate standards agency. Unapproved safety equipment may not provide adequate protection. Eye protection must be ANSI-approved and breathing protection must be NIOSH-approved for the specific hazards in the work area.
10. Avoid unintentional starting. Prepare to begin work before turning on the tool.
11. Do not lay the tool down until it has come to a complete stop. Moving parts can grab the surface and pull the tool out of your control.
12. When using a handheld power tool, maintain a firm grip on the tool with both hands to resist starting torque.
13. Do not depress the spindle lock when starting or during operation.
14. Do not leave the tool unattended when the Battery Pack is connected. Turn off the tool, and remove the Battery Pack before leaving.
15. This product is not a toy. Keep it out of reach of children.
16. People with pacemakers should consult their physician(s) before use. Electromagnetic fields in close proximity to heart pacemaker could cause pacemaker interference or pacemaker failure.
17. The warnings, precautions, and instructions discussed in this instruction manual cannot cover all possible conditions and situations that may occur. It must be understood by the operator that common sense and caution are factors which cannot be built into this product, but must be supplied by the operator.

## **Power tool use and care**

1. Do not force the power tool. Use the correct power tool for your application. The correct power tool will do the job better and safer at the rate for which it was designed.
2. Do not use the power tool if the Trigger does not turn it on and off. Any power tool that cannot be controlled with the Trigger is dangerous and must be repaired.
3. Disconnect the plug from the power source and/ or remove the battery pack, if detachable, from the power tool before making any adjustments, changing accessories, or storing power tools. Such preventive safety measures reduce the risk of starting the power tool accidentally.
4. Store idle power tools out of the reach of children and do not allow persons unfamiliar with the power tool or these instructions to operate the power tool. Power tools are dangerous in the hands of untrained users.
5. Maintain power tools and accessories. Check for misalignment or binding of moving parts, breakage of parts and any other condition that may affect the power tool's operation. If damaged, have the power tool repaired before use. Many accidents are caused by poorly maintained power tools.
6. Keep cutting tools sharp and clean. Properly maintained cutting tools with sharp cutting edges are less likely to bind and are easier to control.
7. Use the power tool, accessories and tool bits etc. in accordance with these instructions, taking into account the working conditions and the work to be performed. Use of the power tool for operations different from those intended could result in a hazardous situation.
8. Keep handles and grasping surfaces dry, clean and free from oil and grease. Slippery handles and grasping

surfaces do not allow for safe handling and control of the tool in unexpected situations.

## **Service**

1. Have your power tool serviced by a qualified repair person using only identical replacement parts. This will ensure that the safety of the power tool is maintained.
2. Never service damaged BATTERY packs. Service of BATTERY packs should only be performed by the manufacturer or authorized service providers.
3. Maintain labels and nameplates on the tool. These carry important safety information. If unreadable or missing, contact Harbor Freight Tools for a replacement.

## **Battery tool use and care**

1. Prevent unintentional starting. Ensure the switch is in the off-position before connecting to battery pack, picking up or carrying the power tool. Carrying the power tool with your finger on the switch or energizing power tool that have the switch on invites accidents.
2. Disconnect the battery pack from the power tool before making any adjustments, changing accessories, or storing power tool. Such preventive safety measures reduce the risk of starting the power tool accidentally.
3. Recharge only with the charger specified by the manufacturer. A charger that is suitable for one type of battery pack may create a risk of fire when used with another battery pack.
4. Use power tools only with specifically designated battery packs. Use of any other battery packs may create a risk of injury and fire.
5. When battery pack is not in use, keep it away from other metal objects, like paper clips, coins, keys, nails, screws or other small metal objects, that can make a connection from one terminal to another. Shorting the battery terminals together may cause burns or a fire.
6. Under abusive conditions, liquid may be ejected from the battery; avoid contact. If contact accidentally occurs, flush with water. If liquid contacts eyes, additionally seek medical help. Liquid ejected from the battery may cause irritation or burns.
7. Do not use a battery pack or power tool that is damaged or modified. Damaged or modified batteries may exhibit unpredictable behavior resulting in fire, explosion or risk of injury.
8. Do not expose a battery pack or power tool to fire or excessive temperature. Exposure to fire or temperature above 140°F may cause explosion.
9. Follow all charging instructions and do not charge the battery pack or power tool outside of the temperature range specified in the instructions. Charging improperly or at temperatures outside of the specified range may damage the battery and increase the risk of fire.
10. Have servicing performed by a qualified repair person using only identical replacement parts. This will ensure that the safety of the product is maintained.
11. Do not modify or attempt to repair the power tool or the battery pack except as indicated in the instructions for use and care.
12.  The battery Charger gets hot during use. The Charger's heat can build up to unsafe levels and create a fire hazard if it does not receive adequate ventilation, due to an electrical fault, or if it is used in a hot environment. Do not place the Charger on a flammable surface. Do not obstruct any vents on the Charger. Especially avoid placing the Charger on carpets and rugs; they are not only flammable, but they also obstruct

vents under the Charger. Place the Charger on a stable, solid, nonflammable surface (such as a stable metal workbench or concrete floor) at least 1 foot away from all flammable objects, such as drapes or walls. Keep a fire extinguisher and a smoke detector in the area. Frequently monitor the Charger and Battery Pack while charging.

### **Safety instructions for routers**

1. Hold power tool by insulated gripping surfaces, because the cutter may contact its own cord. Cutting a "live" wire may make exposed metal parts of the power tool "live" and shock the operator.
2. Use clamps or another practical way to secure and support the workpiece to a stable platform. Holding the work by hand or against your body leaves it unstable and may lead to loss of control.
3. Let bit cool before touching, changing or adjusting it. Bits heat up dramatically while in use, and can burn you.
4. Verify that the work surface has no hidden utility lines before cutting.

### **Lithium Battery Safety Warnings**



LITHIUM BATTERIES STORE A LARGE AMOUNT OF ENERGY AND WILL VENT FIRE OR EXPLODE IF MISTREATED:

1. Keep Battery Pack dry.
2. DO NOT DO ANY OF THE FOLLOWING TO THE BATTERY PACK:
  - Open,
  - Drop,
  - Short-circuit,
  - Puncture,
  - Incinerate, or
  - Expose to temperatures greater than 140°F.
3. Charge Battery Pack only according to its Charger's instructions.
4. Inspect Battery Pack before every use; do not use or charge if damaged.

### **Vibration Safety**

This tool vibrates during use.

Repeated or long-term exposure to vibration may cause temporary or permanent physical injury, particularly to the hands, arms and shoulders.

To reduce the risk of vibration-related injury:

1. Anyone using vibrating tools regularly or for an extended period should first be examined by a doctor and then have regular medical check-ups to ensure medical problems are not being caused or worsened from use. Pregnant women or people who have impaired blood circulation to the hand, past hand injuries, nervous system disorders, diabetes, or Raynaud's Disease should not use this tool. If you feel any symptoms related to vibration (such as tingling, numbness, and white or blue fingers), seek medical advice as soon as possible.
2. Do not smoke during use. Nicotine reduces the blood supply to the hands and fingers, increasing the risk of vibration-related injury.
3. Wear suitable gloves to reduce the vibration effects on the user.

4. Use tools with the lowest vibration when there is a choice.
5. Include vibration-free periods each day of work.
6. Grip tool as lightly as possible (while still keeping safe control of it). Let the tool do the work.
7. To reduce vibration, maintain the tool as explained in this manual. If any abnormal vibration occurs, stop use immediately.

## Grounding

**Note:** Extension cords must not be used with this item's Charger.

## Warning Symbols and Definitions



This is the safety alert symbol. It is used to alert you to potential personal injury hazards. Obey all safety messages that follow this symbol to avoid possible injury or death.

### **DANGER**

Indicates a hazardous situation which, if not avoided, will result in death or serious injury.

### **WARNING**

Indicates a hazardous situation which, if not avoided, could result in death or serious injury.







### **CAUTION**

Indicates a hazardous situation which, if not avoided, could result in minor or moderate injury.

### **NOTICE**

Addresses practices not related to personal injury.

## Symbology

<b>V</b>	Volts
	Direct Current
<b>A</b>	Amperes
n0 xxxx/min.	No Load Revolutions per Minute (RPM)
	WARNING marking concerning Risk of Eye Injury. Wear ANSI-approved safety goggles with side shields.
	Read the manual before set-up and/or use.
	WARNING marking concerning Risk of Fire. Do not cover Charger ventilation ducts. Charge on fireproof surface only.
	WARNING marking concerning Risk of Electric Shock. Properly connect Charger's power cord to appropriate outlet.
	WARNING marking concerning Risk of Explosion. Do not puncture, short, or open battery packs and do not charge damaged battery packs.

## SPECIFICATIONS

Battery Type	Hercules 20 V Li-ion 57373 (sold separately)
Charger Type	Hercules 20V/12V Li-ion 56559 (sold separately)
Electrical Rating	20VDC
No Load Speed	n0: 10000 – 30000/min
Collet Size	1/4" Shank Diameter
Max. Plunge Depth	1-1/2"

## FUNCTIONAL DESCRIPTION



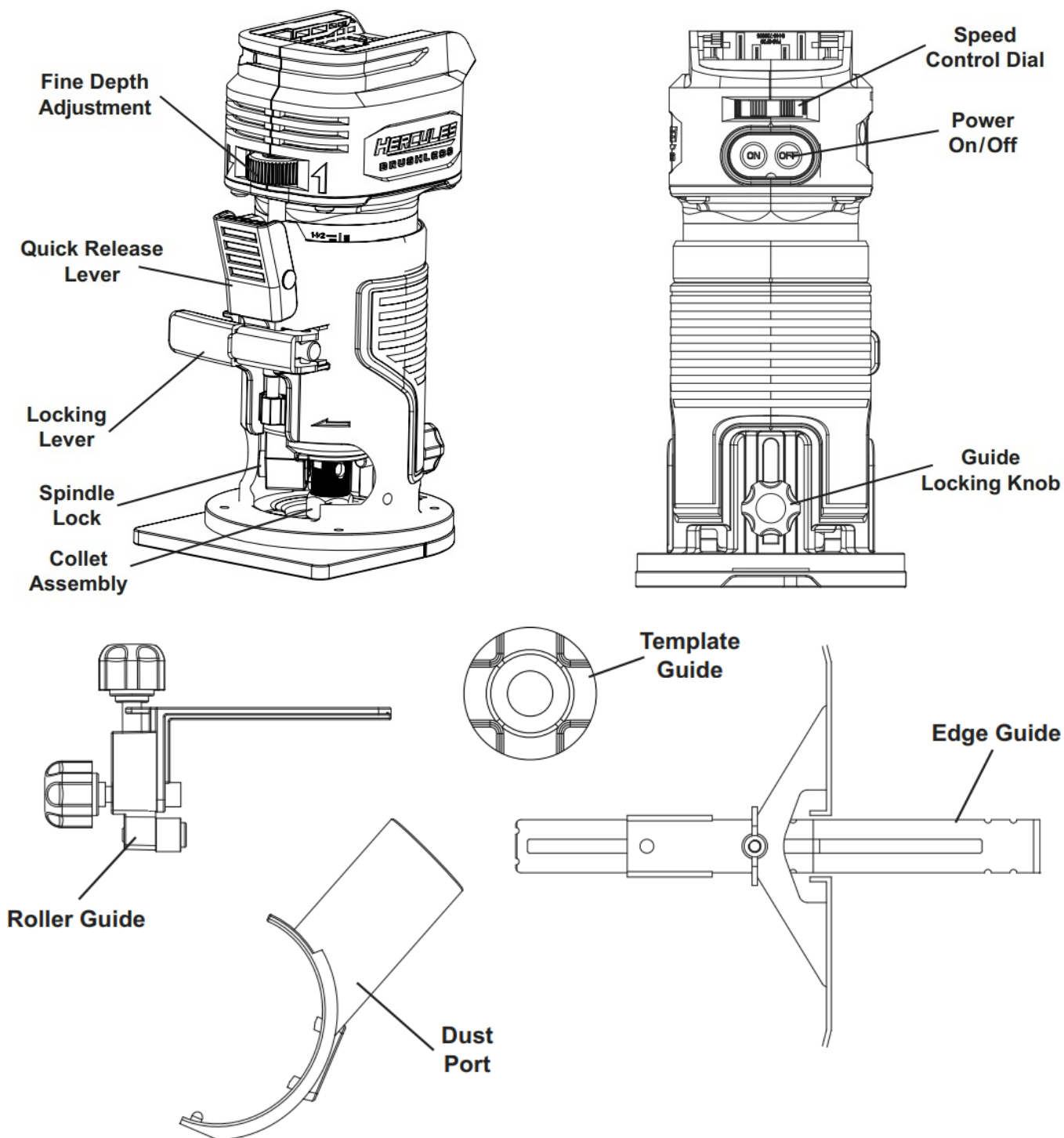

## SETUP – BEFORE USE

**!** Read the ENTIRE IMPORTANT SAFETY INFORMATION section at the beginning of this manual including all text under subheadings therein before set up or use.

**⚠ WARNING** TO PREVENT SERIOUS INJURY FROM ACCIDENTAL OPERATION: Turn Power “OFF” and remove the Battery Pack before performing any procedure in this section.

### Assembly

#### Edge Guide Installation

1. Assemble the Edge Guide using the locking screw and wing nut with its washer and lock washer.

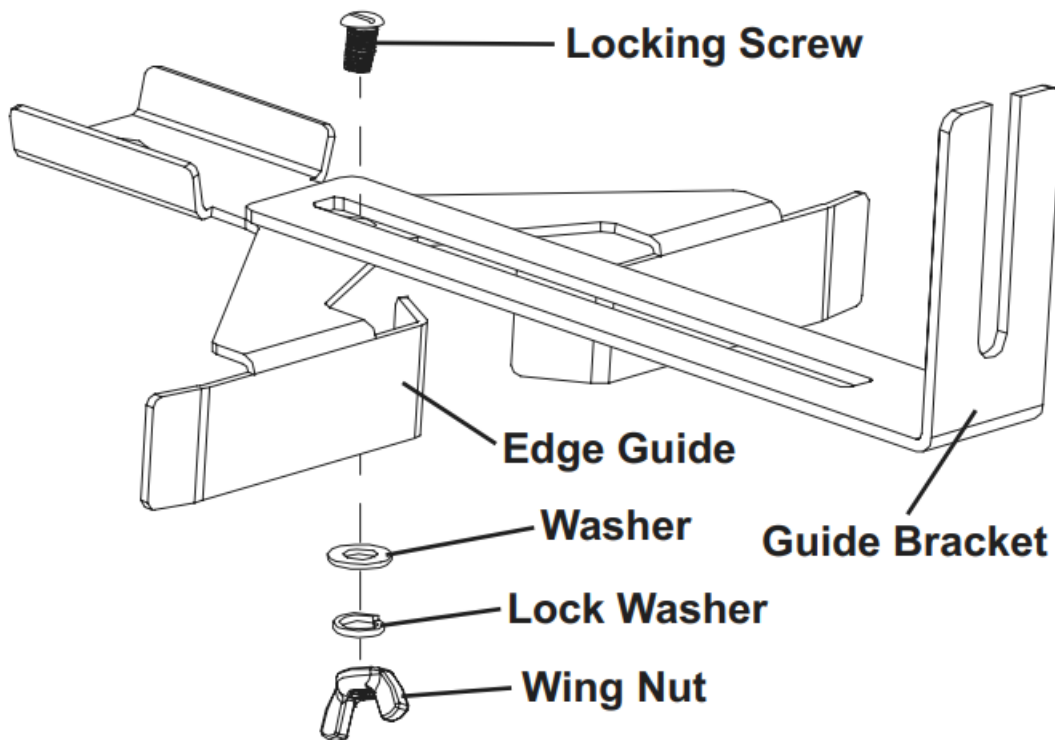

2. Loosen the Guide Locking Knob. The short end of the Edge Guide should slide underneath the Guide Locking Knob. Align the Edge Guide to the mounting position of the Base Plate and insert it to the desired working height.

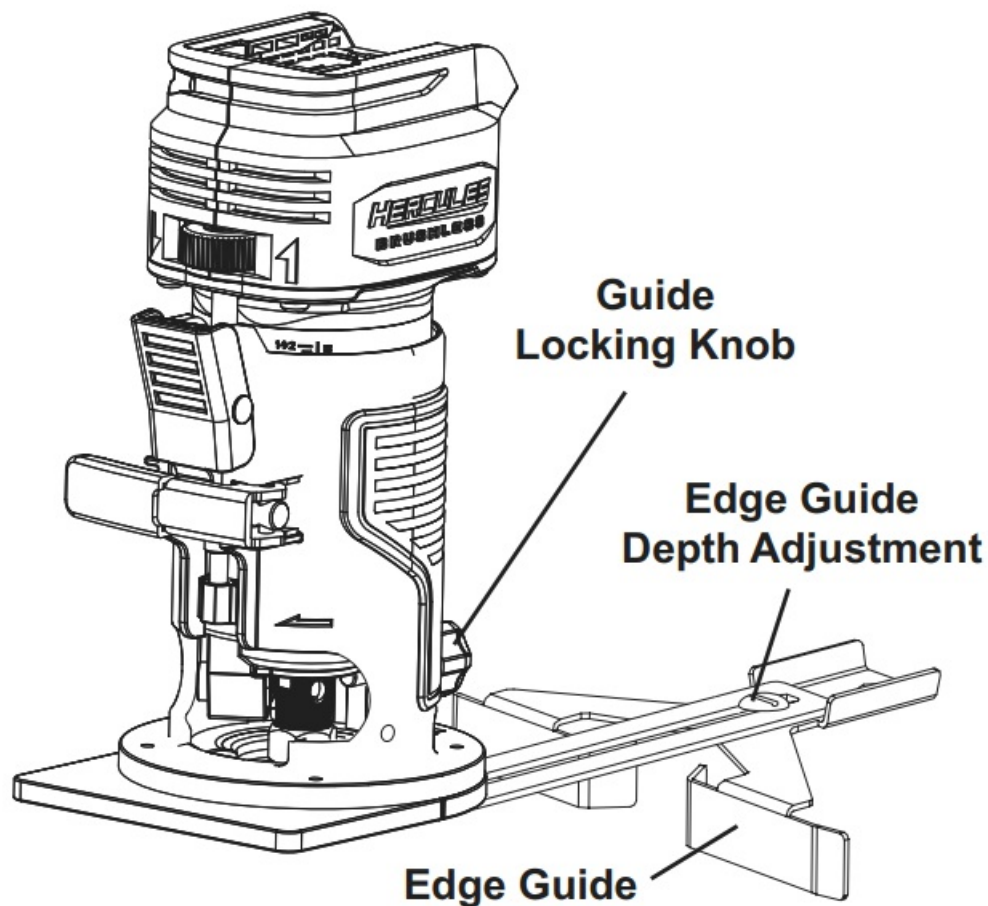

3. Secure the Edge Guide in position by tightening the Guide Locking Knob clockwise.
4. To adjust the Edge Guide:
  - a. Loosen the Edge Guide Wing Nut counterclockwise.

- b. Slide the Edge Guide to desired working position.
  - c. Retighten the Wing Nut to secure the Edge Guide.
5. Align the Edge Guide along the material to be routed to cut parallel with the workpiece edge.

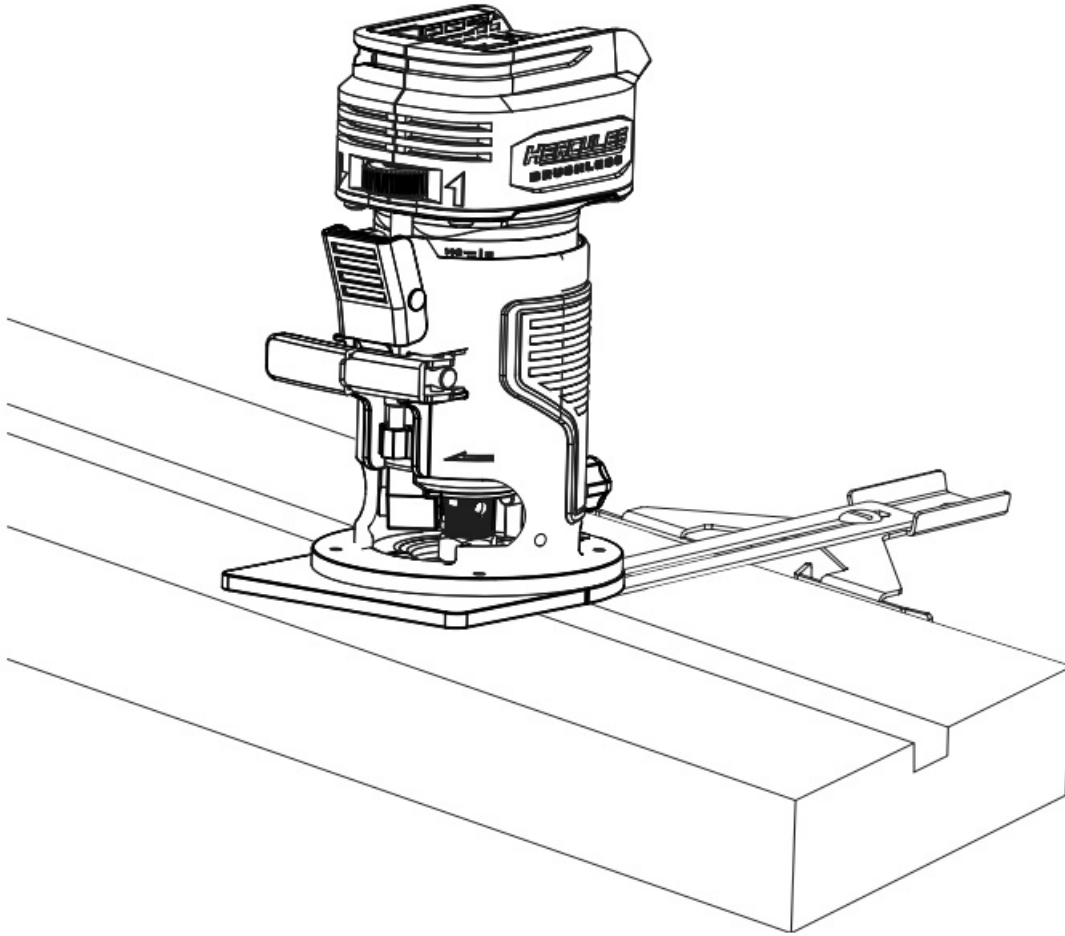

**Note:** The Edge Guide may be used for circle cutting by turning the Edge Guide over and using the center gap in the Edge Guide to follow the circle.

### **Temporary Guide Installation**

A temporary guide can be used to make a straight cut which does not parallel the edge of the workpiece.

1. Clamp a suitable straight board across the workpiece parallel to the desired location of the cut.
2. Install the Edge Guide Assembly with the Edge Guide facing outward and up. The Wing Nut should be installed in the hole furthest from the raised edge of the Edge Guide.

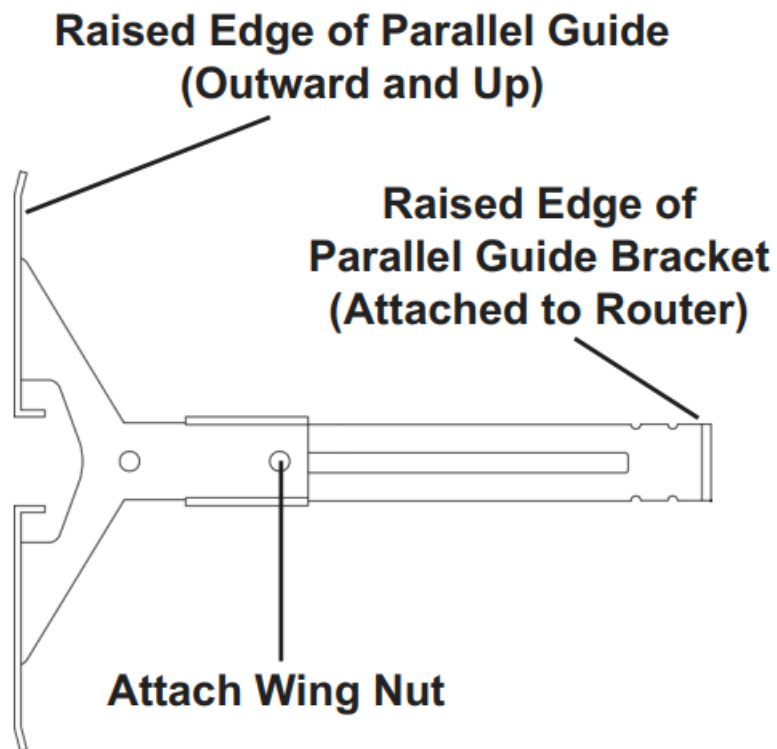

3. Align the Edge Guide along the temporary guide secured to the workpiece to cut parallel with the temporary guide.

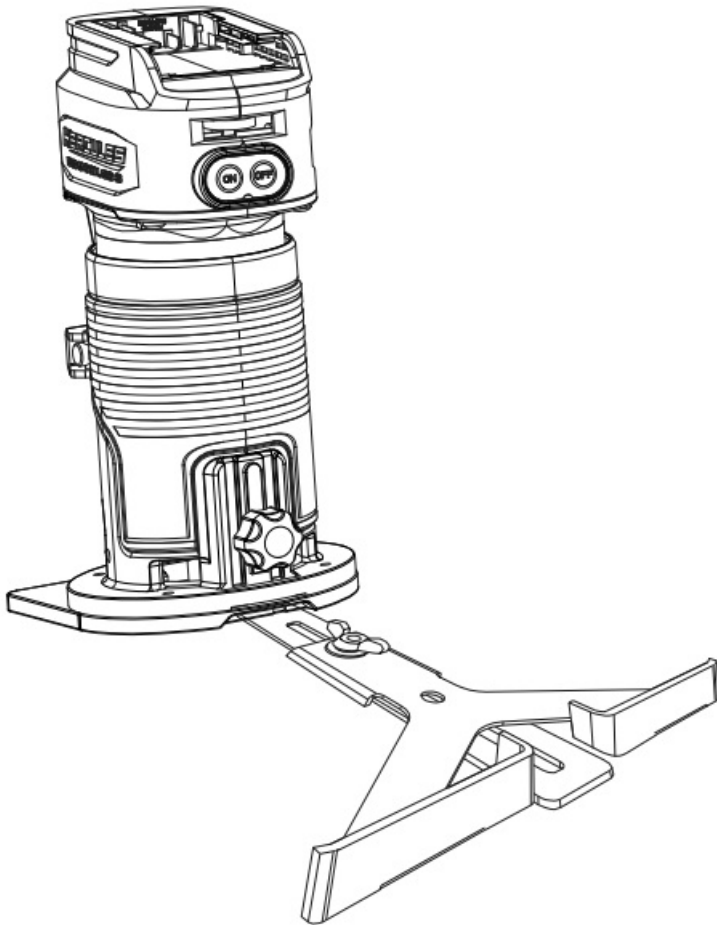

### Circle Cutting Installation

1. Install the Edge Guide as shown.
2. Set the distance from the center hole in the Edge Guide to the far edge of the router bit equal to the radius of

the circle. Lock the Edge Guide in place with the Guide Locking Knob and Wing Nut.

3. Align the center gap in the Edge Guide with the center point of the circle.
4. Drive a nail through the center hole to secure the Edge Guide in place.
5. Use the nail in the center to rotate the Router and make a circle cut.

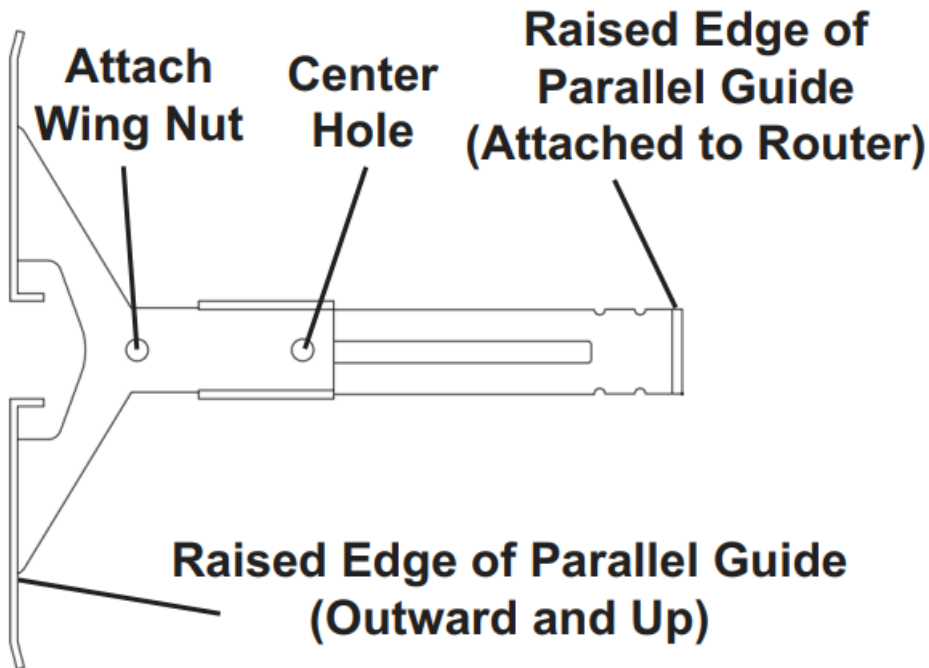

### Roller Guide Installation

The Roller Guide trims in relation to both the workpiece's top surface and its edge surface. The Router must be adjusted to cut accurately in two dimensions.

1. Assemble the Roller Guide as shown. Attach to the Router Base.
2. Adjust the Router Base so the cutting depth will be flush with the surface that you will be trimming to match.
3. Loosen the Guide Locking Knob and adjust the Roller Guide so that its Roller Wheel is below the bit by approximately 3/4" to 1". Tighten it in position using the Guide Locking Knob.
4. Center the cutting bit over the edge to be trimmed by loosening the Roller Guide Locking Knob and sliding the Roller Wheel into position. Tighten the Roller Guide Locking Knob.

**Note:** To make fine adjustments, partially loosen Roller Guide Locking Knob and use the Roller Guide Fine Adjustment. When the adjustments are finalized, tighten the Roller Guide Locking Knob.

4. Make a test cut on a piece of scrap material to ensure that the adjustment is correct.

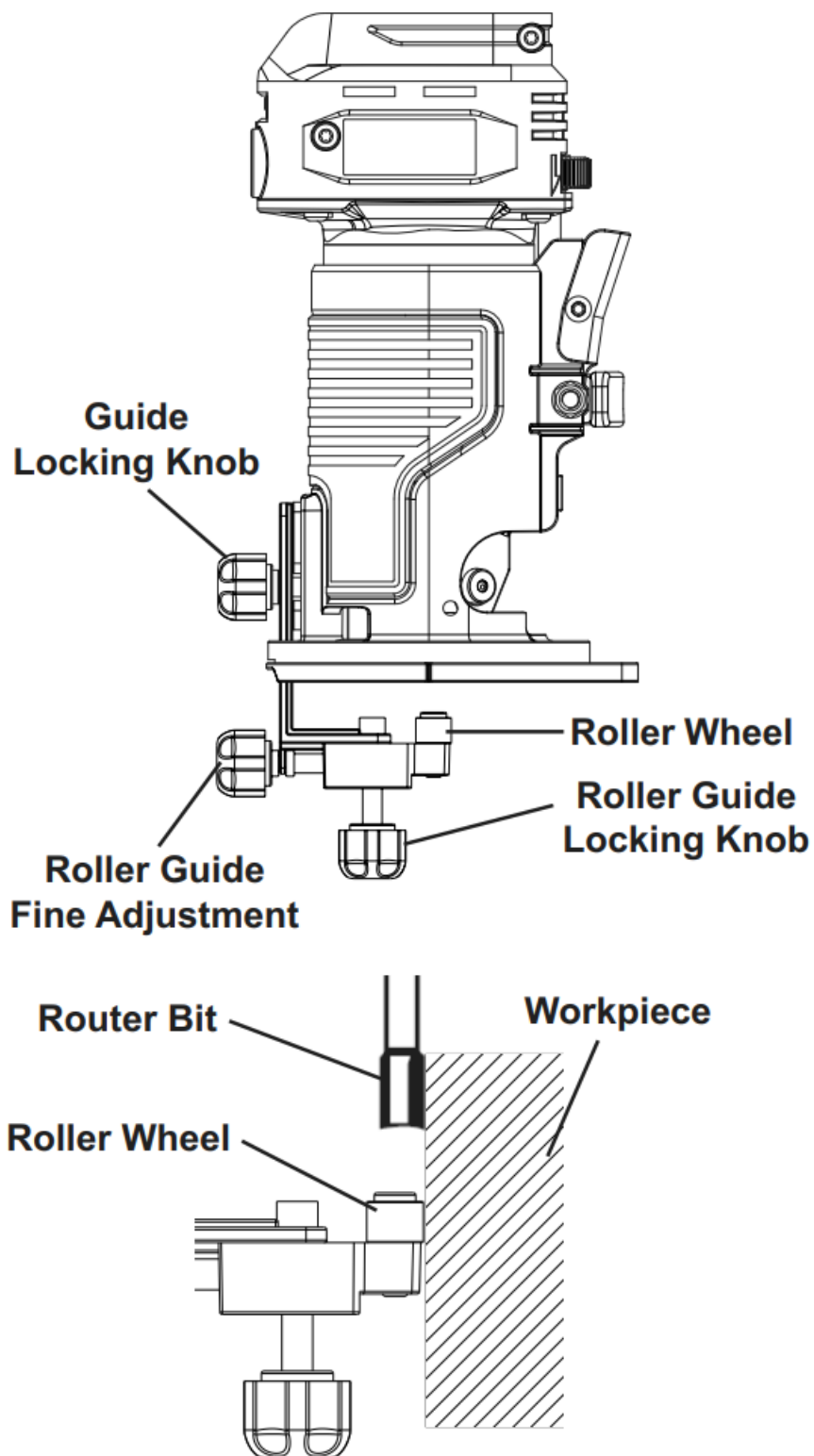

### Template Guide Installation

**NOTICE!** The Template Guide is for use with a template on the workpiece only. Remove the Template Guide when using this product for any other application.

1. Remove the four screws from the bottom of the Sub-Base, then remove the Sub-Base.
2. Place the Template Guide in the opening of the Base with its collar facing away from the Base.
3. Reassemble the Sub-Base to the Base with its four screws.
4. Secure the template to the workpiece:
  - a. Determine the template offset by subtracting the Router Bit diameter from the Template Guide outside

diameter and divide by two. Example: Template Guide outside diameter is 5/8", minus the Router Bit diameter of 3/8" equals 1/4", divide by two equals 1/8" offset.

b. Secure the template to the workpiece using the appropriate offset from the desired cut line.

**Note:** If clamps are used to secure the workpiece, make sure they do not interfere with the Router while cutting.

5. Place the Router on the template with the collar of the Template Guide against the edge of the template. Apply light pressure to keep the Template Guide flat against the template edge. Cut the material along the desired cut line.

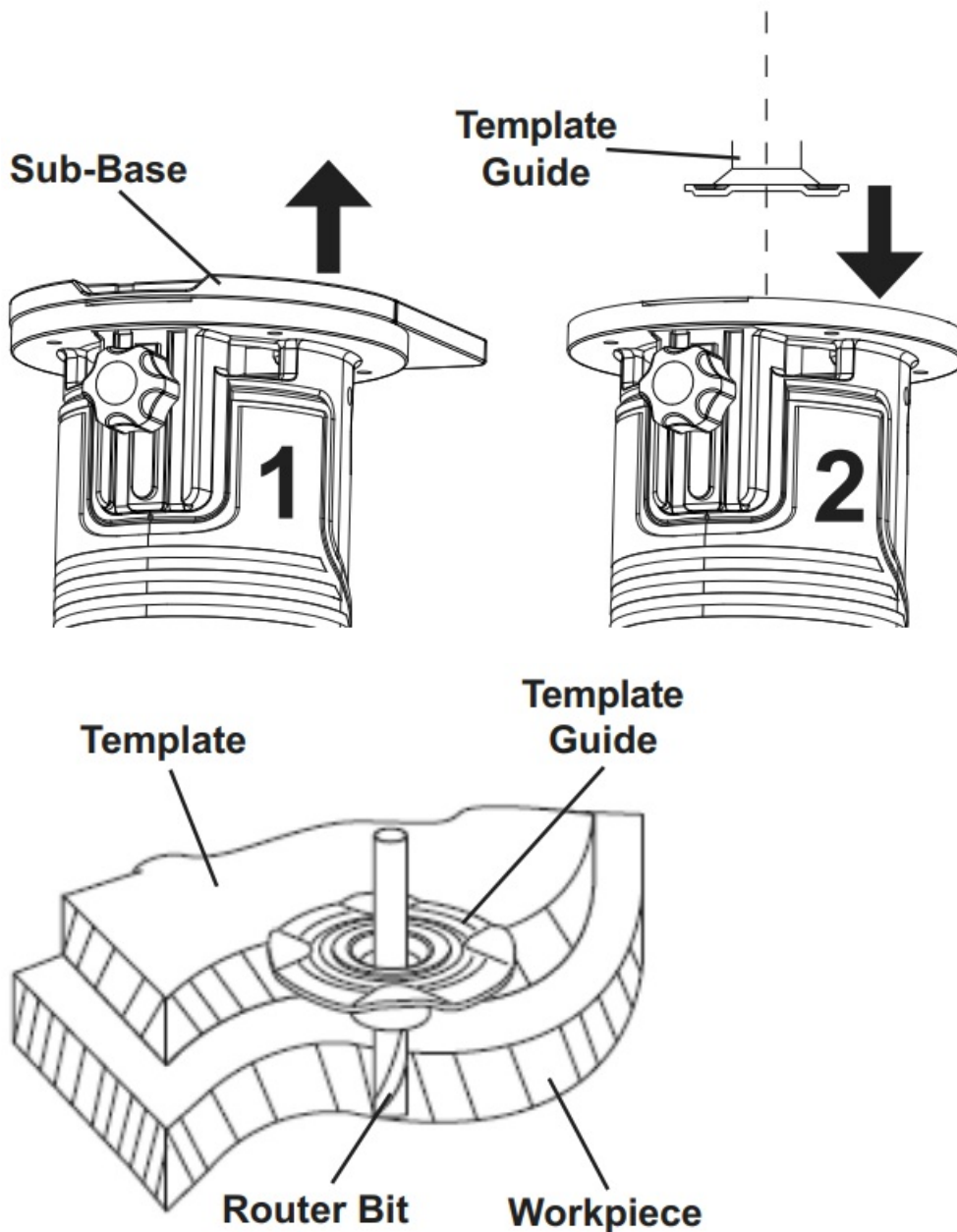

### Dust Port Installation

The Router is supplied with a Dust Port to connect to a dust collector.

Note The Dust Port has a raised bump on one side, and a hole for a Thumb Screw on the other side.

1. Insert the Dust Port's raised bump into the hole on the outer housing.
2. Insert the Thumb Screw into the other hole and secure the Dust Port to the Router.
3. Make sure Dust Port is secure before using the router.



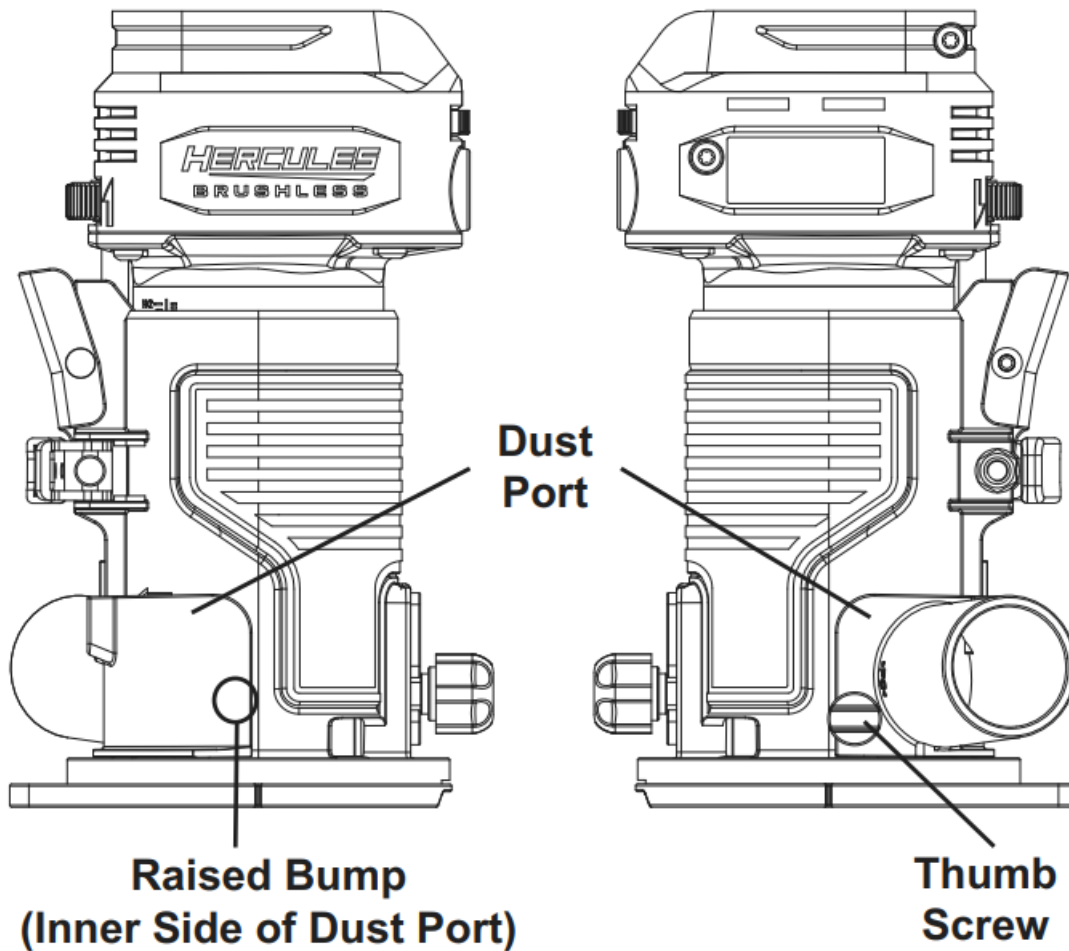

### Battery Charging

Charge battery after unpacking and before using the tool.  
Follow instructions included with the battery charger.

### OPERATION

**!** Read the ENTIRE IMPORTANT SAFETY INFORMATION section at the beginning of this manual including all text under subheadings therein before set up or use.

### Tool Changing

#### Router Bit Installation

#### **WARNING! TO PREVENT SERIOUS INJURY:**

Use only rotary cutting bits of the correct shank diameter for the collet mounted. Use only rotary cutting bits suitable for the speed of the tool.

**WARNING! TO PREVENT SERIOUS INJURY:** Carefully inspect cutting bits for cracks, chips, or other damage before installing. Do not use bits that have been dropped, cracked, or damaged.  
The bit may shatter causing serious injury.

1. Use only bits with 1/4" shank size.
2. Use only bits that are marked as suitable for the type of material being cut.
3. Use only bits that are marked with a speed equal or higher than the speed marked on the tool.



4. Open the Locking Lever.
5. Push and hold the Quick Release Lever.
6. Hold the Router Housing carefully, move the Motor Housing upwards and remove it from the Router Housing.

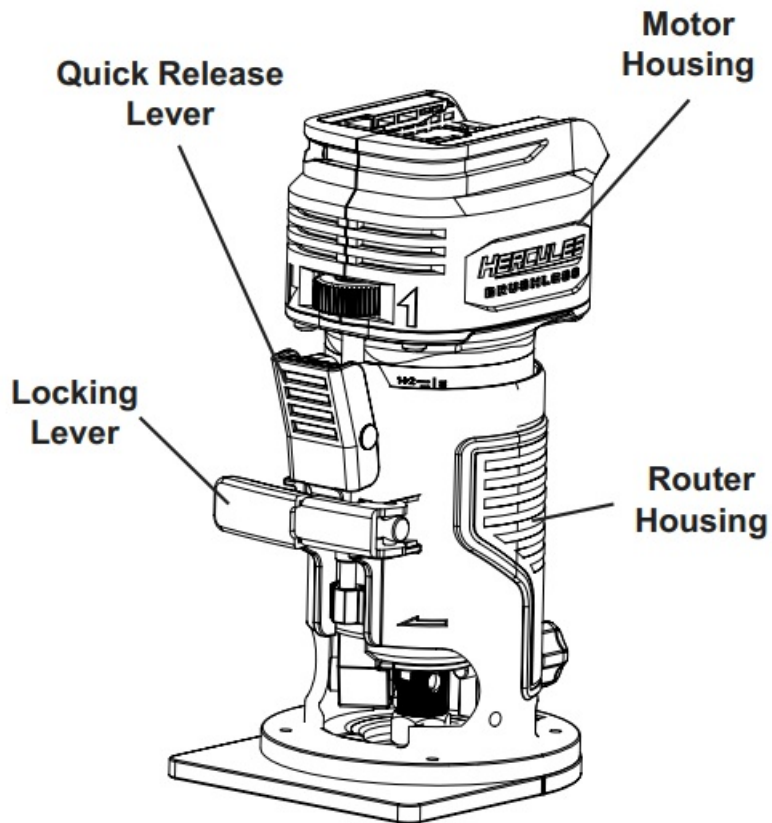

7. Place the Motor Housing upside down on its top with the Collet Assembly pointing up.
8. Rotate the Spindle and press the Spindle Lock until it engages, and hold to prevent the Spindle from rotating.
9. Loosen the Collet Assembly counterclockwise with the included Wrench, but do not remove.

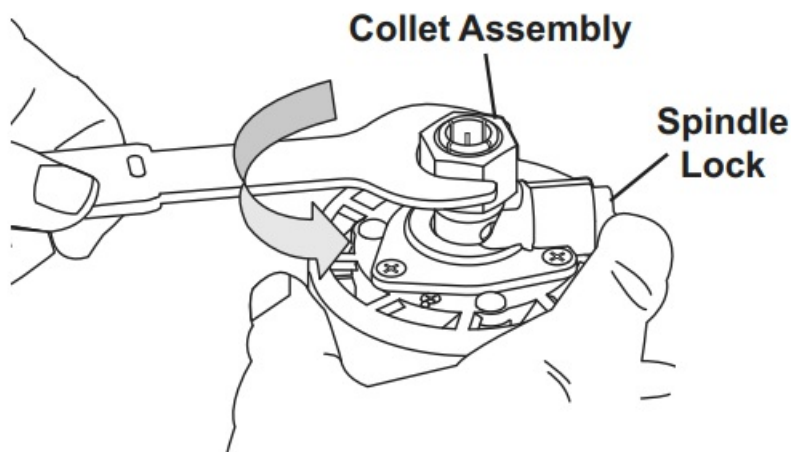

10. Insert at least 3/4 of the shank end of the new router bit (sold separately) into the opening in the Collet Assembly.

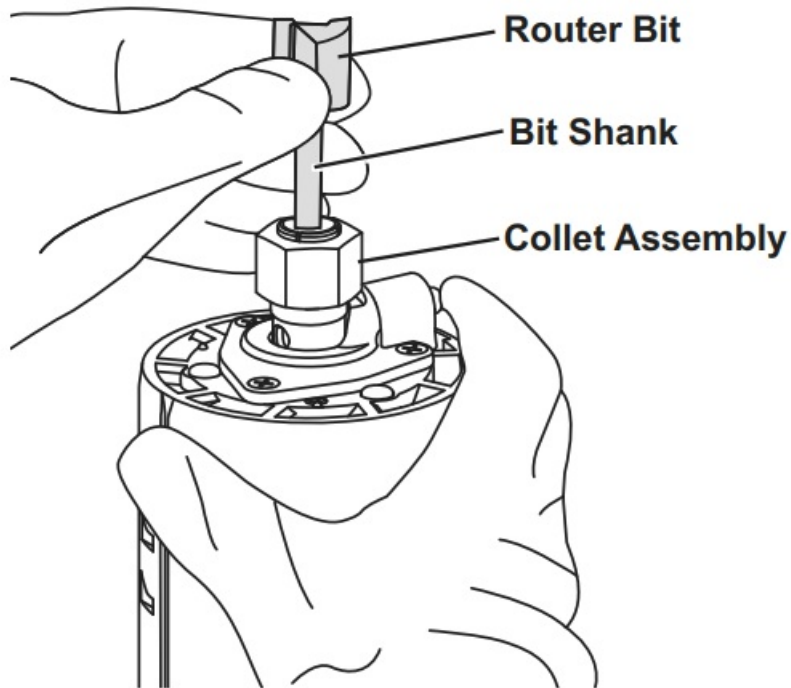

11. While still holding the Spindle Lock, tighten the Collet Assembly. Make sure Collet Assembly is secure before using the Router.
12. Release the Spindle Lock and confirm the Spindle can rotate freely.

### **Adjusting Cutting Depth**

1. Open the Locking Lever.
2. Push and hold the Quick Release Lever.
3. Hold the Router Housing carefully, slowly move the Motor Housing upwards or downwards to desired position.
4. Release Quick Release Lever when Router is in desired position.
5. Further adjustments to Router Position can be made by moving the Fine Depth Adjustment Wheel left or right. Router Bit should just barely touch the surface of the workpiece.
6. When Router is in the desired position, close the Locking Lever.
7. The depth scale on the Motor Housing now shows the starting position. This starting position will vary depending on the bit used.
8. Add the desired depth of cut to the starting position. For example, if the starting position is  $1/2"$  and the desired depth of cut is  $1/4"$ , the correct adjustment on the scale is  $3/4"$ .
9. Release the Locking Lever, and adjust the Motor Housing until the correct reading is shown on the depth scale; in this example  $3/4"$ . Tighten the Locking Lever.

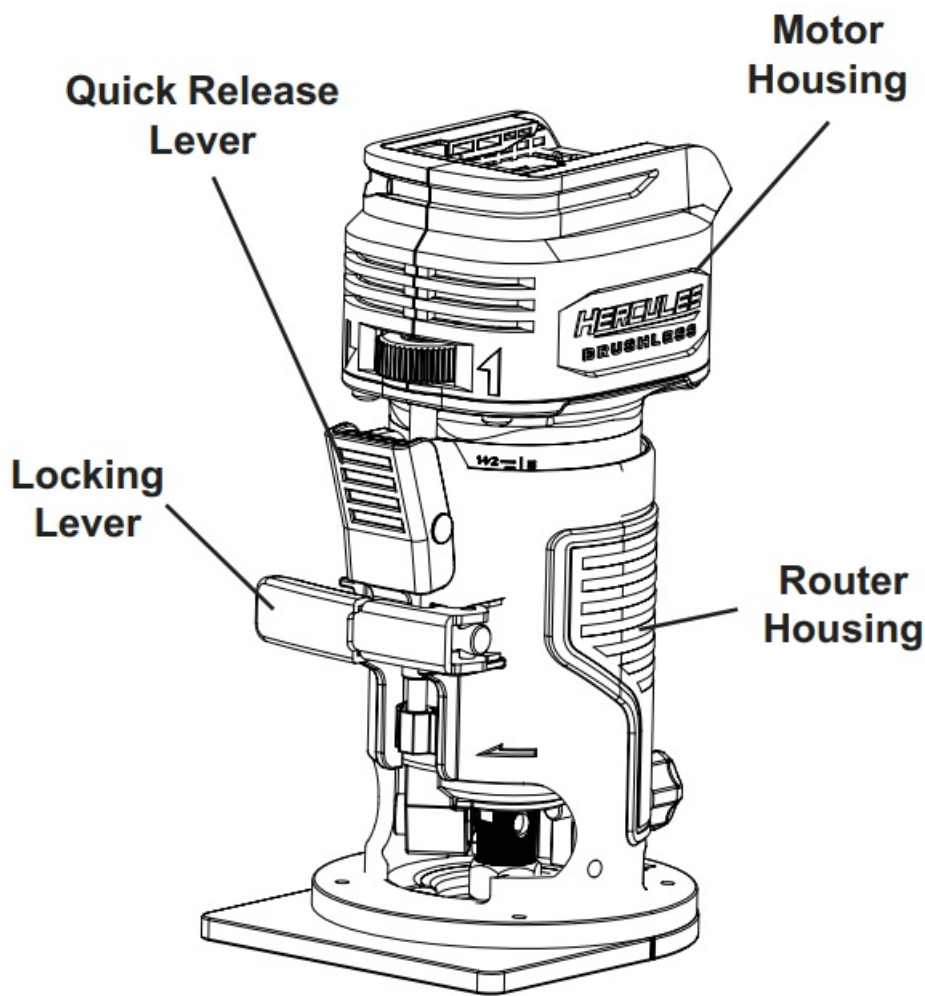

### Workpiece and Work Area Set Up

1. Designate a work area that is clean and well-lit.  
The work area must not allow access by children or pets to prevent distraction and injury.
2. Secure loose workpieces using a vise or clamps (not included) to prevent movement while working.
3. Confirm the workpiece is free of any obstacles (nails, screws, etc.,) before operation. Remove them if required.
4. Verify that there are no utility lines or hardware in or near the workpiece.

### General Operation

**⚠ WARNING!** TO PREVENT SERIOUS INJURY: During operation, fine dust will be generated. Wear NIOSH-approved breathing protection.

1. Confirm the Collet is tight on the router bit and the Locking Lever is in the locked position.
2. Place the Router on the workpiece, making sure the router bit is not in contact with the workpiece.
3. Hold the tool by gripping the textured surface opposite the Locking Lever. Use another hand on top of the battery pack to maintain control.
4. Adjust Router speed to suit workpiece and router bit diameter. To adjust speed, rotate the Variable Speed Control. Speed ranges from 1 (slowest speed) to 6 (fastest speed).
  - a. Generally, use the lower settings for larger diameter cutting bits and the higher settings for smaller cutting bits. The correct setting will also depend on the density of the material, depth of cut, and feed speed of the

Router.

Material	Speed Ranges
Hardwood	4-6
Softwood	5-6
Chipboard	3-5
Plastic	2-3
Aluminum	1-4

5. Press and hold the “ON” Power Button for one second or until Router starts.  
**Note:** Momentarily pressing the “ON” Power Button will switch on the LED lights.
6. Wait until the router bit has reached its full speed before making contact with the workpiece.
7. Move the Router with a slow, controlled motion. Pay attention to the direction of feed. Do not force the Router into the cut; let the cutter do the work.
  - a. When using the Edge Guide: Cut parallel to the edge of the workpiece with the Edge Guide following the edge.
  - b. When using a Temporary Guide: Cut with the Edge Guide following the edge of the temporary guide.
  - c. When making a Circle Cut: With the nail in place through the center hole of the Edge Guide, plunge the router bit into the workpiece and rotate the Router in a circle around the nail.
  - d. When using the Roller Guide: Cut the edge of the workpiece with the Roller Guide following the edge of the workpiece.
  - e. When using the Template Guide: Cut the edge of the workpiece with the Template Guide following the edge of the template.
8. Always route against the rotation direction of the router bit. Move the Router counterclockwise when routing on workpiece edges, move the Router clockwise when routing the inside of the workpiece.  
**Note:** An engraved arrow on the side of the Router Base indicates the router bit’s direction of rotation.

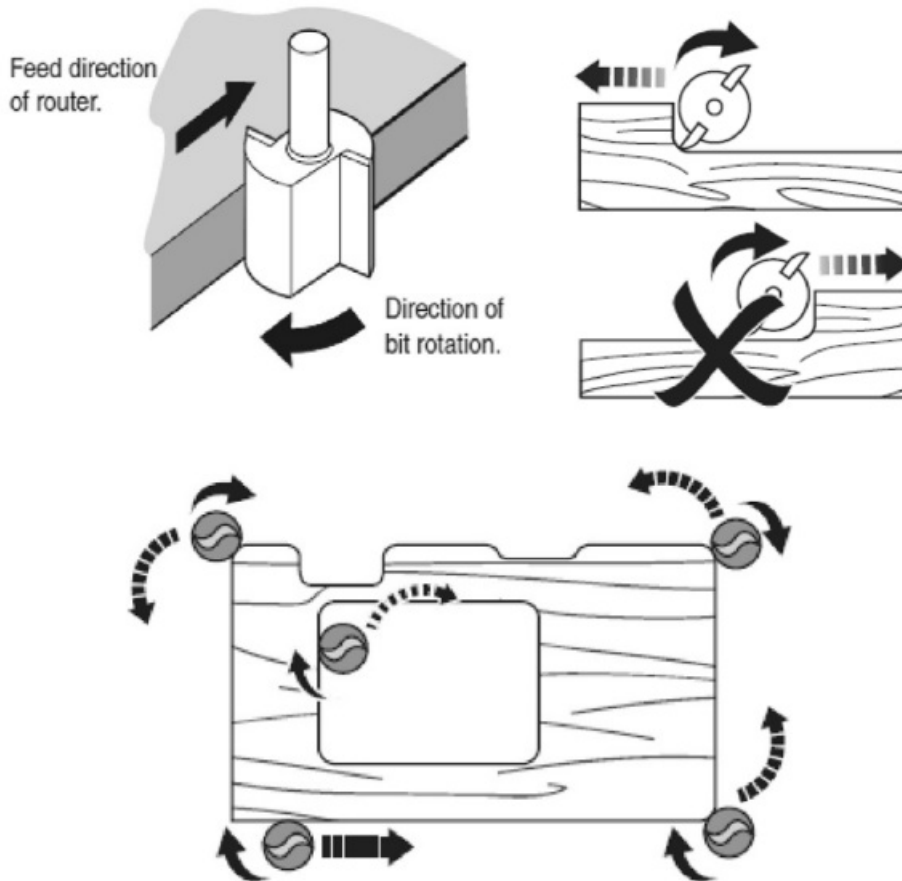

**⚠ WARNING! TO PREVENT SERIOUS INJURY:** Make sure the Router lays flat on the workpiece during operation! Do not try to make cuts with the router held only by one hand!

**Note:** Keep the Router moving at all times; do not stop in one position or use too slow of a feed rate to avoid burning the workpiece. Avoid aggressive feed rates that slow down / overload the motor extensively. Use several passes to achieve the desired depth; limit cutting passes to approximately 1/8" (3mm) depth.

9. Bring the Router to a stop at the end of the cut. Press the "OFF" Power Button. Wait until the router bit has come to a complete stop before removing the Router from the workpiece.
10. To prevent accidents, turn off the tool and remove its Battery Pack after use. Clean, then store the tool indoors out of children's reach.

## MAINTENANCE AND SERVICING

**⚠** Procedures not specifically explained in this manual must be performed only by a qualified technician.

**⚠ WARNING** TO PREVENT SERIOUS INJURY FROM ACCIDENTAL OPERATION: Release the Trigger and remove the Battery Pack before performing any procedure in this section.

TO PREVENT SERIOUS INJURY FROM TOOL FAILURE:

Do not use damaged equipment.

If abnormal noise or vibration occurs, have the problem corrected before further use.

## Cleaning, Maintenance, and Lubrication

1. BEFORE EACH USE, inspect the general condition of the tool. Check for:

- leaking, swollen, or cracked battery pack,
- loose hardware,

- misalignment or binding of moving parts,
  - cracked or broken parts,
  - damaged electrical wiring,
  - any other condition that may affect its safe operation.
2. AFTER USE, wipe external surfaces of the tool with clean cloth.
  3. For Router Bit installation, reference Router Bit Installation on page 10.
  4. Li-Ion BATTERY MUST BE RECYCLED OR DISPOSED OF PROPERLY.  
Do not short, incinerate or open battery.
  5. Periodically, wear ANSI-approved safety goggles and NIOSH-approved breathing protection and blow dust out of the motor vents using dry compressed air.
  6. Periodically wipe Collet and router bits with a light oil to prevent rust.
  7. Disconnect battery pack and store battery pack, charger, and tool in dry, indoor area out of reach of children and away from metal objects (i.e., paperclips, coins) to prevent shorting.

## **Troubleshooting**

Problem	Possible Causes	Likely Solutions
Tool will not start.	<ol style="list-style-type: none"> <li>1. Tool/s thermal reset breaker tripped (if equipped).</li> <li>2. Battery Pack not properly connected.</li> <li>3. Battery Pack not properly charged.</li> <li>4. Battery Pack burnt-out.</li> <li>5. Internal damage or wear. (Trigger, for example.)</li> </ol>	<ol style="list-style-type: none"> <li>1. Turn off tool and allow to cool. Press reset button on tool.</li> <li>2. Remove Battery Pack, make sure there are no obstructions, reinsert the Battery Pack according to its shape (it should only fit one way), and press firmly until the Battery Pack locks in place.</li> <li>3. Make sure Charger is connected and operating properly. Give enough time for Battery Pack to recharge properly.</li> <li>4. Dispose of old Battery Pack properly or recycle. Replace Battery Pack.</li> <li>5. Have technician service tool.</li> </ol>
Tool operates slowly.	<ol style="list-style-type: none"> <li>1. Excess pressure applied to workpiece.</li> <li>2. Battery Pack power low.</li> <li>3. Battery Pack wearing out.</li> </ol>	<ol style="list-style-type: none"> <li>1. Decrease pressure; allow tool to do the work.</li> <li>2. Recharge Battery Pack.</li> <li>3. Dispose of old Battery Pack properly or recycle. Replace Battery Pack.</li> </ol>
Performance decreases over time.	<ol style="list-style-type: none"> <li>1. Router bit dull or damaged.</li> <li>2. Battery Pack wearing out.</li> </ol>	<ol style="list-style-type: none"> <li>1. Keep Router bits in optimal condition. Replace as needed.</li> <li>2. Dispose of old Battery Pack properly or recycle. Replace Battery Pack.</li> </ol>
Excessive noise or rattling.	Internal damage or wear (bearings, for example.)	Have technician service tool.
Overheating.	<ol style="list-style-type: none"> <li>1. Forcing tool to work too fast.</li> <li>2. Router bit dull or damaged.</li> <li>3. Blocked motor housing vents.</li> </ol>	<ol style="list-style-type: none"> <li>1. Allow tool to work at its own rate.</li> <li>2. Keep Router bits in optimal condition. Replace as needed.</li> <li>3. Wear ANSI-approved safety goggles and NIOSH-approved dust mask/respirator while blowing dust out of motor using compressed air.</li> </ol>
 <b>Follow all safety precautions whenever diagnosing or servicing the tool. Disconnect power supply before service.</b>		

Record Product's Serial Number Here:

**Note:** If product has no serial number, record month and year of purchase instead.

**Note:** Replacement parts may be available for this item.

Visit [harborfreight.com/parts](https://www.harborfreight.com/parts) for a list of in stock parts. Reference UPC 193175476555.

## 5-YEAR LIMITED WARRANTY

This Hercules tool is warranted to the original purchaser to be free from defects in materials and workmanship for a period of five (5) years beginning on the date of purchase. This warranty does not cover battery packs and battery chargers, which are covered under separate warranties. To obtain warranty service, visit your local Harbor Freight retail store. Warranty registration is not required. The product or part must be returned to us with proof of purchase (e.g. in-store receipt or packing slip/invoice) and may require shipment by purchaser to a service center at purchaser's expense. If our inspection verifies a covered defect in materials or workmanship during the warranty period, we will, at our option, repair or replace the defective product. We will return repaired products within a reasonable time at our expense, but if we determine that there is no defect, or that the defect resulted from causes not within the scope of our warranty, then we will return the product to you if you pay return shipping costs.

This warranty does not cover any failure or damage that we determine is due directly or indirectly to normal wear and tear, misuse, use not for the intended purpose or not in accordance with the product manual, abuse, accident, rental, modification or alteration, unauthorized repair, improper installation, neglect, lack of maintenance, or any other failure not arising from defective materials or workmanship. Fraudulent returns or claims will be denied. The repair or replacement described in this warranty shall be your sole and exclusive remedy. THIS WARRANTY IS EXCLUSIVE AND IN LIEU OF ALL OTHER EXPRESS WARRANTIES, WRITTEN OR ORAL, AND ANY IMPLIED WARRANTIES ARE DISCLAIMED TO THE EXTENT PERMITTED BY LAW AND OTHERWISE LIMITED TO THE DURATION OF THE EXPRESS WARRANTY HEREIN. HARBOR FREIGHT SHALL NOT BE LIABLE UNDER ANY CIRCUMSTANCES FOR ANY INCIDENTAL, INDIRECT, SPECIAL, CONSEQUENTIAL, OR PUNITIVE DAMAGES OR COSTS ARISING FROM THIS WARRANTY OR THE USE OF THIS PRODUCT. SOME STATES DO NOT ALLOW LIMITATIONS ON HOW LONG AN IMPLIED WARRANTY LASTS OR THE EXCLUSION OR LIMITATION OF INCIDENTAL OR CONSEQUENTIAL DAMAGES, SO THESE LIMITATIONS MAY NOT APPLY TO YOU. THIS WARRANTY GIVES YOU SPECIFIC LEGAL RIGHTS, AND YOU MAY ALSO HAVE OTHER RIGHTS WHICH VARY FROM STATE TO STATE.

## Customer Support

Visit our website at: <http://www.harborfreight.com>

Email our technical support at: [productsupport@harborfreight.com](mailto:productsupport@harborfreight.com)

For technical questions, please call 1-888-866-5797

Copyright© 2022 by Harbor Freight Tools®. All rights reserved. No portion of this manual or any artwork contained herein may be reproduced in any shape or form without the express written consent of Harbor Freight Tools.

Diagrams within this manual may not be drawn proportionally. Due to continuing improvements, actual product may differ slightly from the product described herein. Tools required for assembly and service may not be included.

The logo for Hercules, featuring the word "HERCULES" in a bold, italicized, sans-serif font. A registered trademark symbol (®) is located at the end of the word. Below the text is a thick, dark, horizontal brushstroke that tapers at both ends.



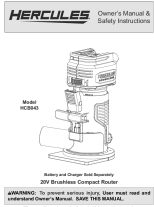

**[HERCULES HCB043 20V Brushless Compact Router](#)** [pdf] Owner's Manual  
HCB043 20V Brushless Compact Router, HCB043, 20V Brushless Compact Router, Brushless Compact Router, Compact Router, Router

References

- [User Manual](#)