



HenracTech TY-DIY-S04 WiFi Smart Control User Manual

[Home](#) » [HenracTech](#) » HenracTech TY-DIY-S04 WiFi Smart Control User Manual 

Contents

- [1 HenracTech TY-DIY-S04 WiFi Smart Control](#)
- [2 Checklist before using the device](#)
- [3 Specifications](#)
- [4 Add Device](#)
- [5 Inching mode](#)
- [6 Selflock mode](#)
- [7 InterLock mode](#)
- [8 Work with Alexa](#)
- [9 Works with Google Home](#)
- [10 Documents / Resources](#)



HenracTech TY-DIY-S04 WiFi Smart Control

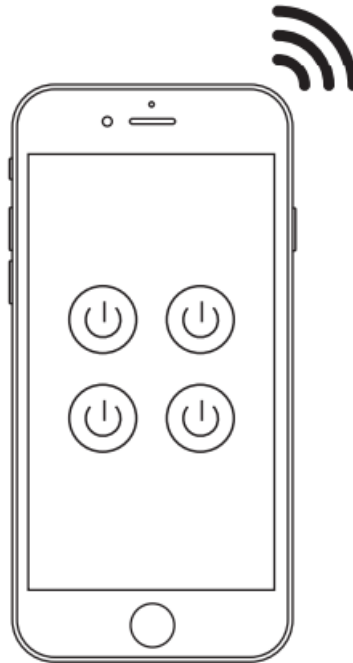

Checklist before using the device

1. Your USB power adapter should be more than 800mA output
2. Your smart phone or tablet should have connected a 2.4G WiFi internet
3. The device only supports 2.4G WiFi. If you use a 5G router (it provides two WiFi Signal: 5G and 2.4G), please select the 2.4G WiFi to connect your smart phone.
4. Download and install the Tuva Smart APP or Smart Life APP from APP Store or Google Play Store. Register and log in.
5. During pairing process, make sure that your IOS or Android device and the device are within the range of your WiFi router.
6. Make sure your router is MAC-open, if not, please cancel the router's MAC filtering setting first

Specifications

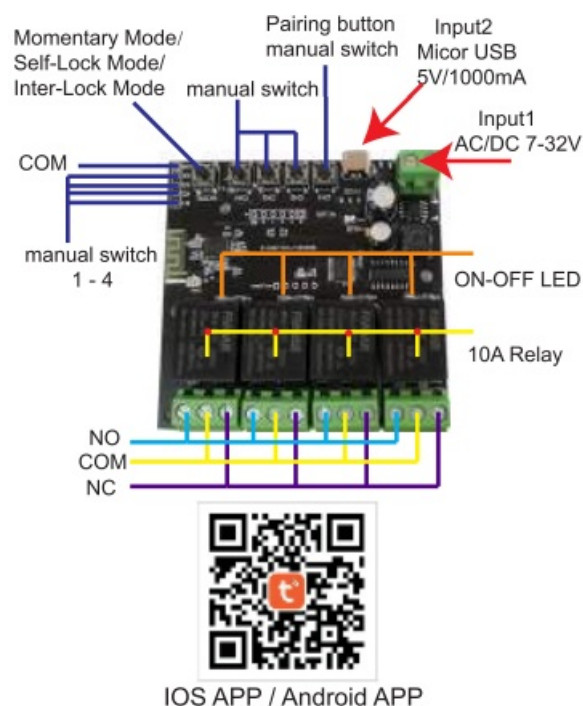

Add Device

1. Power up the device by micro-USB or 7 – 32V terminal
2. Keep pressing the pairing button (for seconds) until led indicator fast blinks
3. Launch the APP, Tap the icon + on the top right to add a device. Then select Electrician – Socket (WiFi), confirm the indicator LED rapidly blinks.
4. Select the 24G WIFI as the one your mobile device connects with, Input correct passwords. Then, Tap Next.
5. It will auto-connect with the device. The process will take 1 minute. Once the process is complete, it will prompt you that you can rename the device Enter a new name and Save.

Note: If you fail to add it during the process, it will prompt you the FAQ, please read carefully and retry accordingly.

Inching mode

- Once you press the manual switch or control from the app, the relay will activate for 0.7 second, then release automatically.
- You can use it to control the gate/door opener/ elevator/computer/remote controller key/ any momentary buttons.

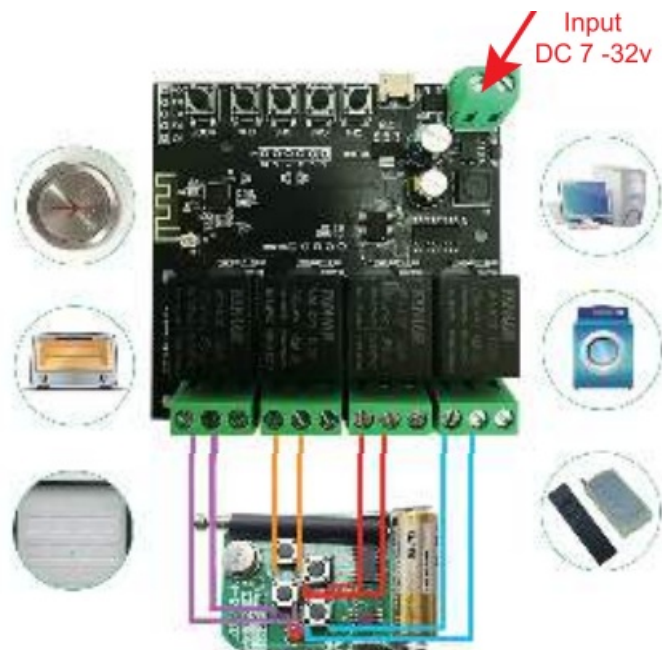

Selflock mode

- Once you press the manual switch or control from the app, the relay will activate to keep ON or OFF normally
- You can use it to control the light/fan/humidifier or other home appliances.

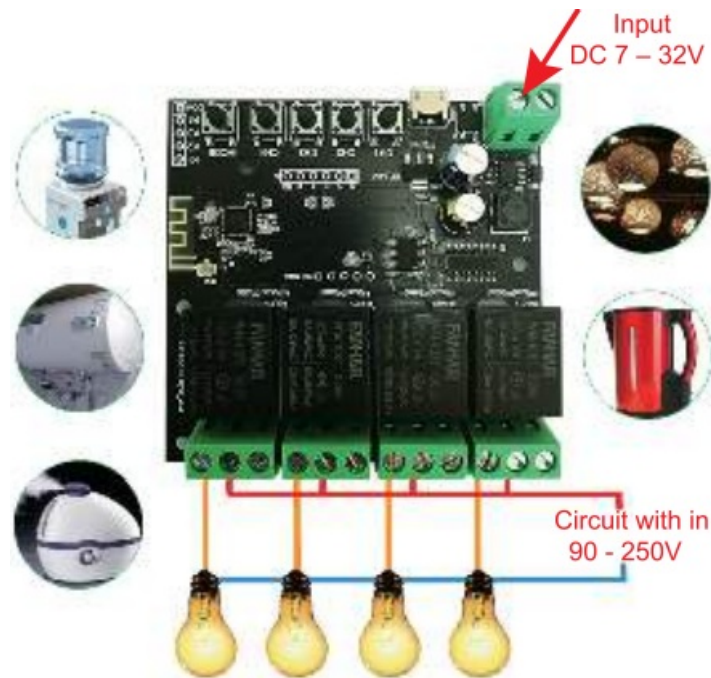

InterLock mode

- Once you press the manual switch or control from the app, the relay will activate, but the other relay release automatically.
- You can use it to control the motor/curtain or other home appliances.

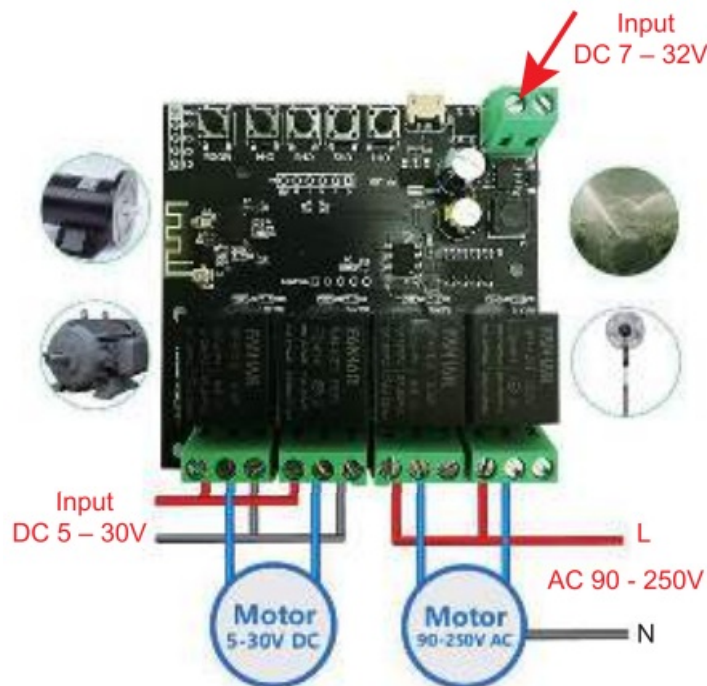

Work with Alexa



1. Open Alexa APP, tap on the menu on upper left corner, Go to Skills.
2. Enter "Tuya Smart" or "smart life" in the search field and search.
3. Tap "Tuya smart" or "smart life"
4. Enable the skill
5. Enter your account information and tap on "Log in" to link your account to your Amazon account.

Works with Google Home



1. Launch Google Home app, tap the menu.
2. Tap Home control.
3. Under Devices, tap the + icon.
4. Tap “Tuya Smart” or “Smart Life”

Documents / Resources

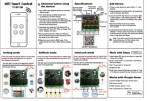

[HenracTech TY-DIY-S04 WiFi Smart Control](#) [pdf] User Manual
TY-DIY-S04 WiFi Smart Control, TY-DIY-S04, WiFi Smart Control, Smart Control, Control

[Manuals+.](#)