

[Home](#) » [HENCO](#) » **HENCO CU-6ZONEB-H Hence Logic Control Unit Installation Guide** 

Contents [[hide](#)]

- [1 HENCO CU-6ZONEB-H Hence Logic Control Unit](#)
- [2 Specifications](#)
- [3 Key Features](#)
- [4 Quick Installation Guide](#)
- [5 CONTROL UNIT](#)
- [6 FAQs](#)
- [7 Documents / Resources](#)
 - [7.1 References](#)



HENCO CU-6ZONEB-H Hence Logic Control Unit



Specifications

Feature	Detail
Model	CU-6ZONEB-H
Brand	HENCO
Zones Controlled	6 Zones
Power Supply	230V AC, 50 Hz
Max Current Load	Typically 3 A (check product manual)
Relay Output	For each zone (pump, boiler control)
Mounting Type	DIN rail or wall mount
Indicator LEDs	For each zone's status
Actuator Compatibility	230V thermal actuators
Housing	Plastic enclosure
Certifications	CE certified

Key Features

- Controls up to 6 separate heating zones
- Compatible with room thermostats and thermal actuators
- Integrated LED indicators for quick zone diagnostics
- Centralized logic ensures energy-efficient heating
- Output terminals for pump and boiler control
- Overheat protection and fault diagnostics
- Modular design for easy installation and scalability

Usage

- Home underfloor heating systems
- Small office heating control
- Renovation or retrofit heating solutions
- Zoned comfort customization

Product Details

- **Installation:** Simple wiring with clear labeling
- **Operation:** Thermostats signal the control unit, which activates the corresponding actuators and pump.
- **Maintenance:** Minimal; visual inspection and testing of relays recommended annually

Scan the qr-code

and type the article code 'CU-6ZONEB-H' in the search bar for:

- Instruction video
- Written instructions
- Wiring schematics

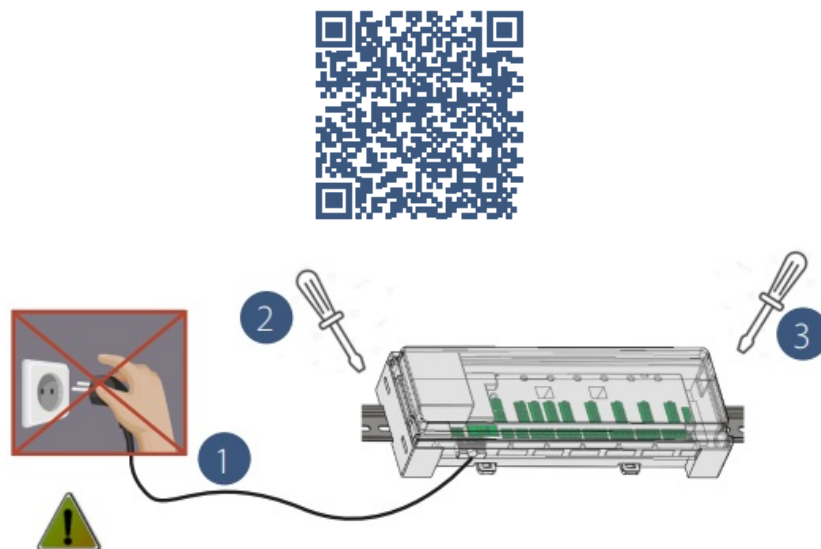

Quick Installation Guide

The descriptions and photographs contained in this document are supplied by way of example and illustration only. Henco Industries reserves the right to carry out any technical and design improvements to its products without prior notice. Henco hereby objects to any term, different from or additional to Henco terms, contained in any buyer communication in any form, unless agreed to in a writing signed by an officer of Henco. 2012/19/EU: Products marked with this symbol cannot be disposed of as unsorted municipal waste in the European Union. For proper recycling, return this product to your local supplier upon the purchase of equivalent new equipment, or dispose of it at

designated collection points. For more information, see: <https://www.henco.be/en/henco-logic>

CONTROL UNIT

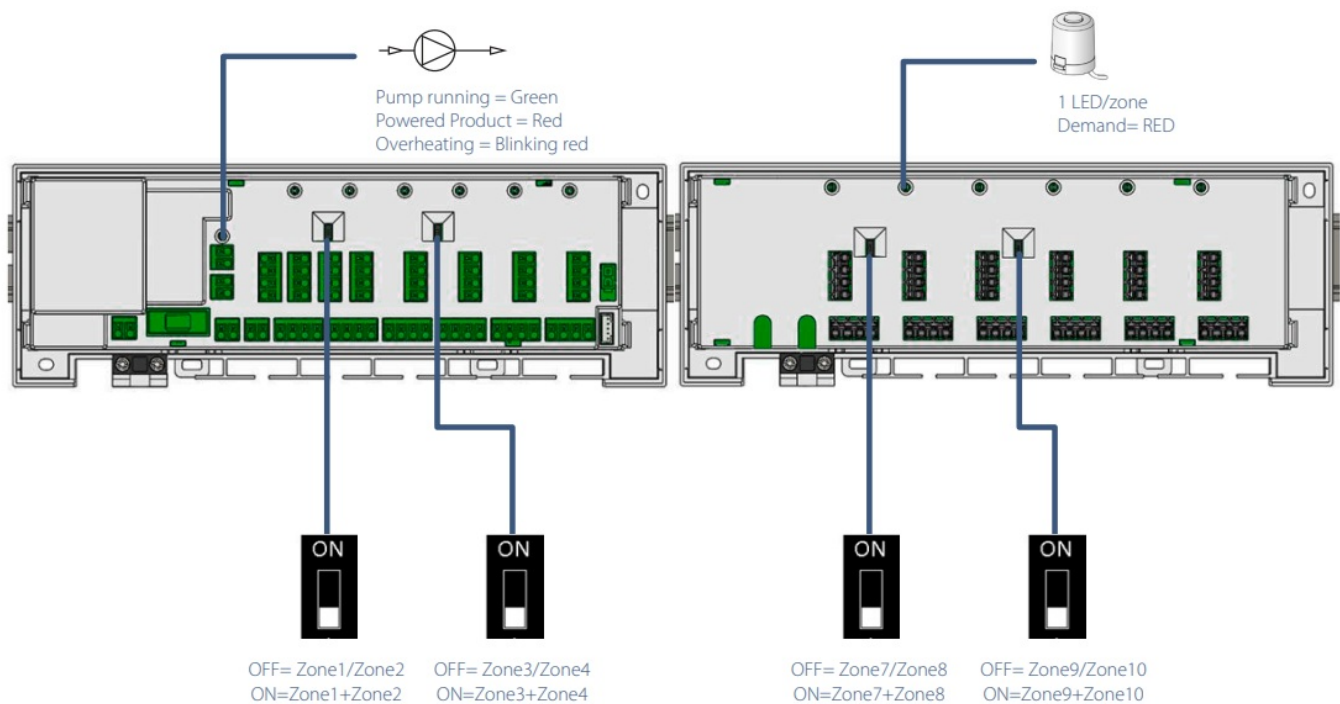

- +32 14 28 56 60
- info@henco.be

Safety warnings and operating instructions

This product should be installed preferably by a qualified professional. All instructions in this Installation & Operation manual should be observed when working with the controller. Failures due to improper installation, improper use or poor maintenance are voiding manufacturer liability.

FAQs

• What thermostats work with the HENCO CU-6ZONEB-H?

Any 230V room thermostats with on/off control logic are typically compatible.

• Can I control a pump or boiler with this unit?

Yes, it includes output terminals for both pump and boiler relay activation.

• Is it expandable beyond 6 zones?

No, this model is fixed at 6 zones, but multiple units can be installed in parallel.

Documents / Resources



[HENCO CU-6ZONEB-H Hence Logic Control Unit \[pdf\]](#) Installation Guide
CU-6ZONEB-H Hence Logic Control Unit, CU-6ZONEB-H, Hence Logic C
ontrol Unit, Logic Control Unit, Control Unit

References

- [User Manual](#)

📁 HENCO

🔍 Control Unit, CU-6ZONEB-H, CU-6ZONEB-H Hence Logic Control Unit, Hence Logic Control Unit, HENCO, Logic Control Unit



Leave a comment

Your email address will not be published. Required fields are marked *

Comment *

Name

Email

Website

☐ Save my name, email, and website in this browser for the next time I comment.

Post Comment

Search:

e.g. whirlpool wrf535swhz

Search

[Manuals+](#) | [Upload](#) | [Deep Search](#) | [Privacy Policy](#) | [@manuals.plus](#) | [YouTube](#)

This website is an independent publication and is neither affiliated with nor endorsed by any of the trademark owners. The "Bluetooth®" word mark and logos are registered trademarks owned by Bluetooth SIG, Inc. The "Wi-Fi®" word mark and logos are registered trademarks owned by the Wi-Fi Alliance. Any use of these marks on this website does not imply any affiliation with or endorsement.