

Hellberg SafetyHub Getting Started App



Hellberg SafetyHub Getting Started App User Manual

[Home](#) » [Hellberg](#) » Hellberg SafetyHub Getting Started App User Manual 

Contents

- [1 Hellberg SafetyHub Getting Started App](#)
- [2 Product Usage Instructions](#)
- [3 Onboarding](#)
- [4 Create a company profile \(part 1\)](#)
- [5 Adding headsets to a company \(part 1\)](#)
- [6 Administrating headsets \(users\)](#)
- [7 Editing headset settings as an admin](#)
- [8 Setting up Teams \(part 1\)](#)
- [9 Join a Team \(if part of a company\)](#)
- [10 Edit and adjust the headset settings](#)
- [11 Download the latest headset software](#)
- [12 Documents / Resources](#)
 - [12.1 References](#)
- [13 Related Posts](#)



Hellberg SafetyHub Getting Started App

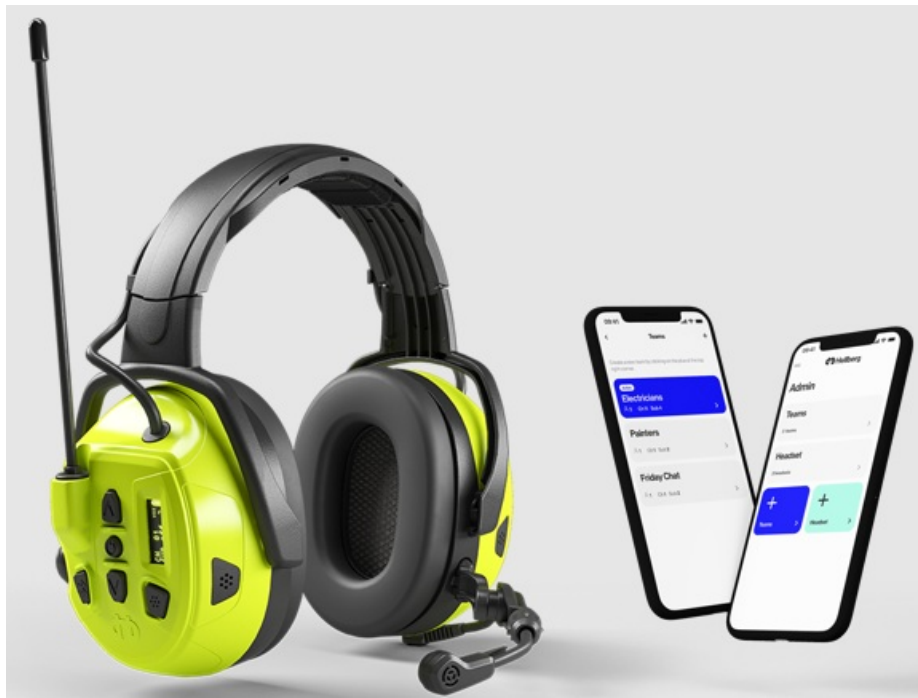

Specifications:

- Product Name: Hellberg SafetyHub
- Features: Company profile creation, Admin dashboard, Headset management, Safety settings

Product Usage Instructions

- **Onboarding:**

Start by reading through the onboarding views to get an overview of the available features.

Create a Company Profile:

Part 1:

1. Select “Create new company profile” to set up your company. Choose a name for the profile and enter your email address.

Part 2:

1. Save your new Company ID after creating the profile. Click “Send Email with ID” to store the ID for future log-ins.

Admin Dashboard:

You can add headsets (users) to your company and set up Teams for group communication from the admin dashboard.

Adding Headsets to a Company:

Part 1:

1. Click on the green headset button and power on the first headset.
2. Put the headset in pairing mode by navigating through the menu.

Part 2:

1. Select the headset from the list, accept Bluetooth pairing, and name the headset.

Part 3:

1. Enable safety mode if desired and delete the headset from your phone's paired devices list for adding more headsets.

Administering Headsets:

- You can edit individual headset settings and delete headsets from the company under the Headsets menu.
- **Editing Headset Settings as an Admin:**
You can edit safety settings and assign Teams to users from this view.

FAQ:

- **Q: How can I delete a headset from the company profile?**
A: You can swipe right on the headset name or enter its settings to click the trash-can icon for deletion.
- **Q: Can I change the company profile name after creation?**
A: Yes, you can edit the company profile name from the settings menu in the Admin Mode.

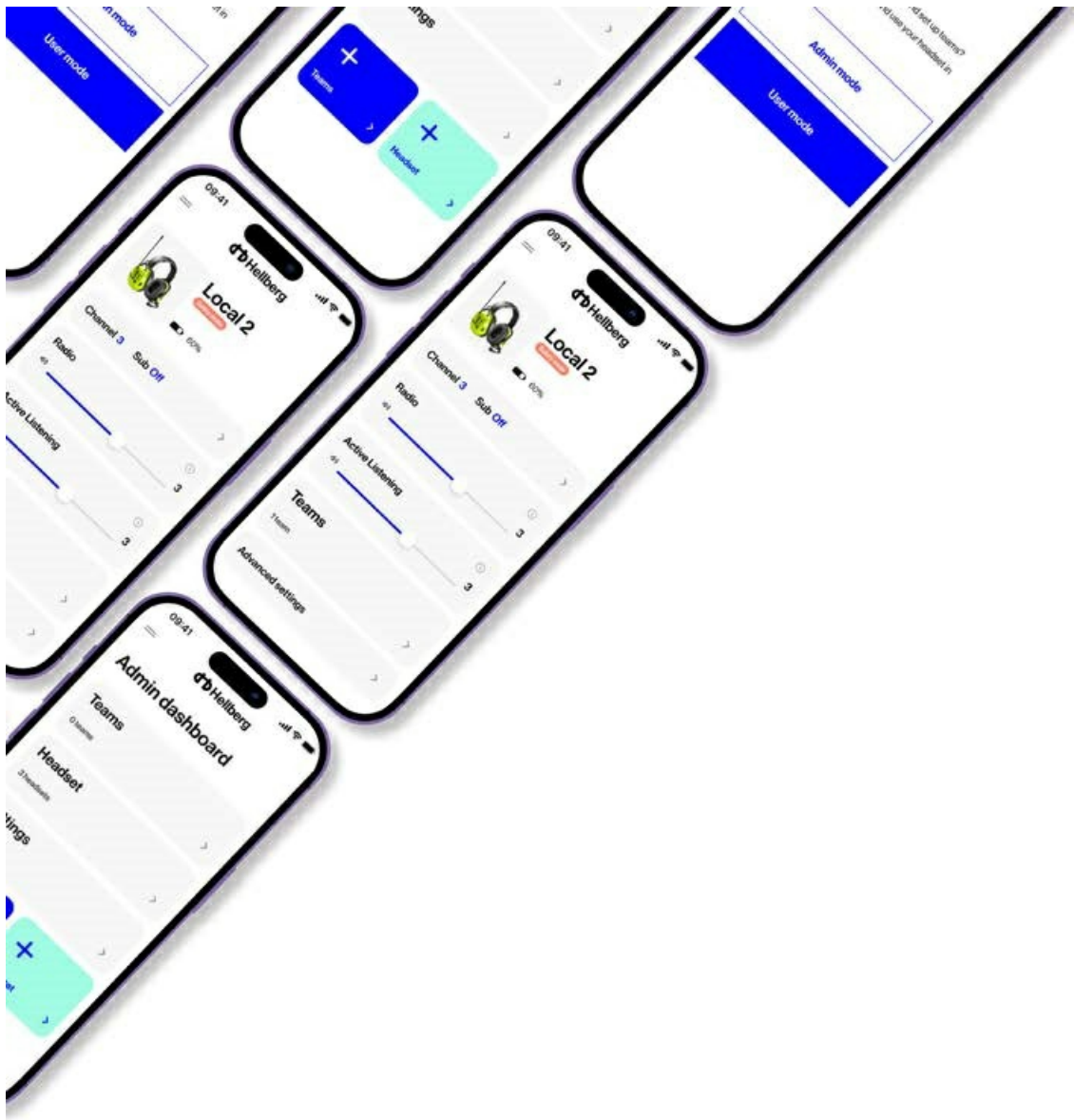

Onboarding

- Start by reading through the onboarding views.
- They will give you an overview of the features available.

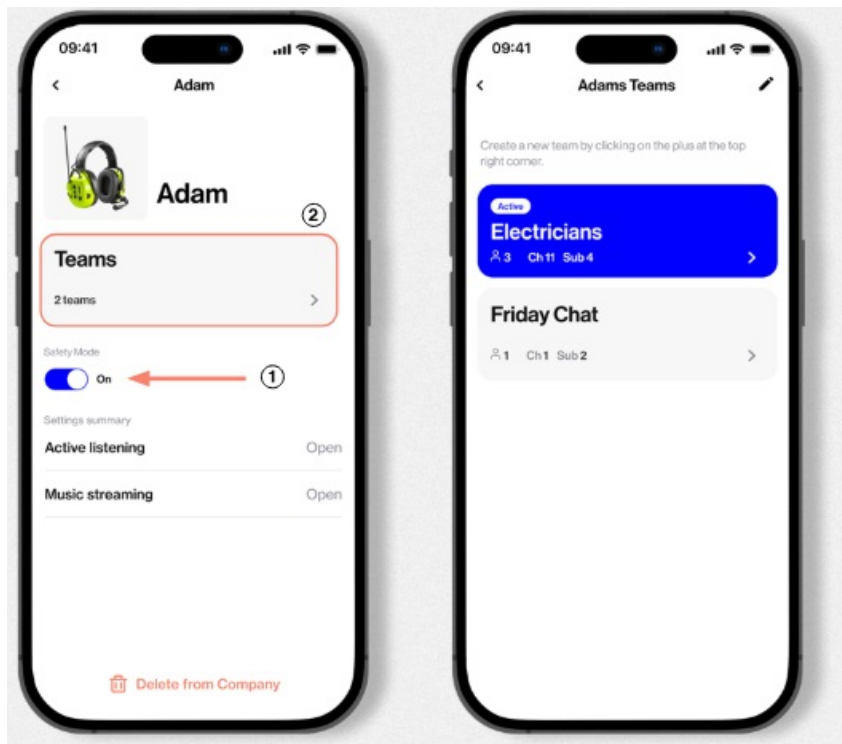

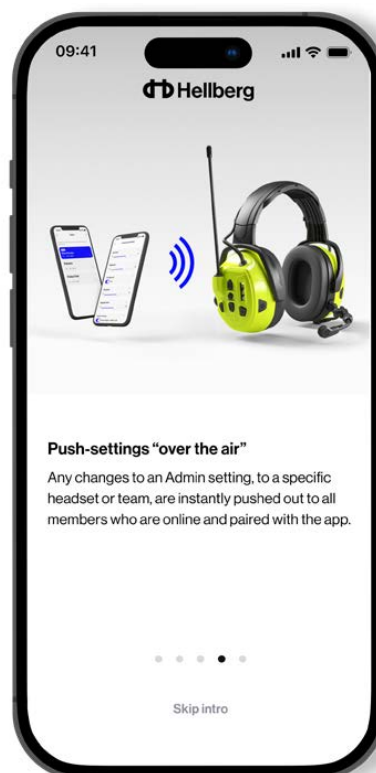
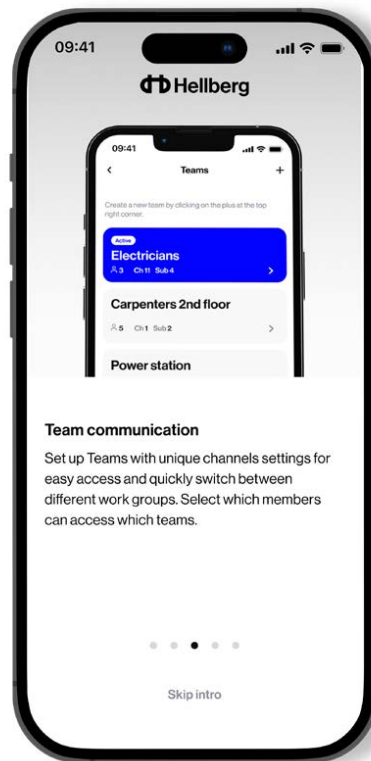

• Admin or User mode

- which should I choose?
- After the Onboarding you will need to decide if you will be an Admin or a User and select what suits your needs best.
- Admins create a company profile from where all Headsets and Teams (channel-settings) are added and administrated. An admin can also access the user mode.
- Users will be able to access the headset menu-settings from the app, without needing to operate it via the

headset-buttons and LED display.

- If the headset has been added to a Company profile, the Admin will be able to "push-out" Teams- and safety settings to the headset.

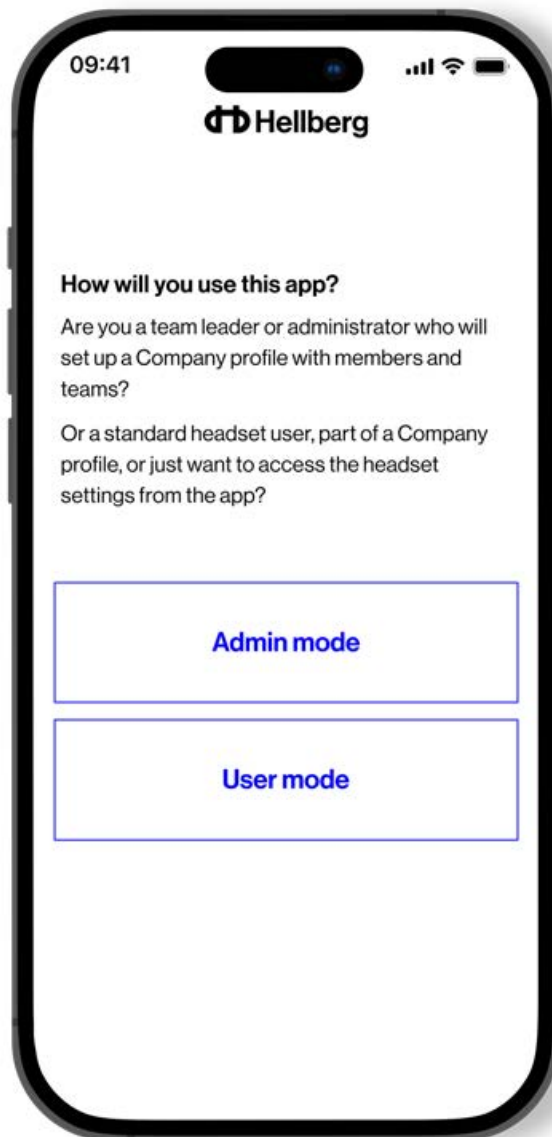

Create a company profile (part 1)

1. Select "Create new company profile"

Select "Create new company profile" to begin setting up your company. If you already created a profile or have been given

access by another Admin, select "Use existing company profile".

2. Choose a name for your company profile.

Choose a name for your company profile. It does not need to be your real company name.

3. Enter your Email address

Enter your Email address. It is important that you submit an Email address you have access to.

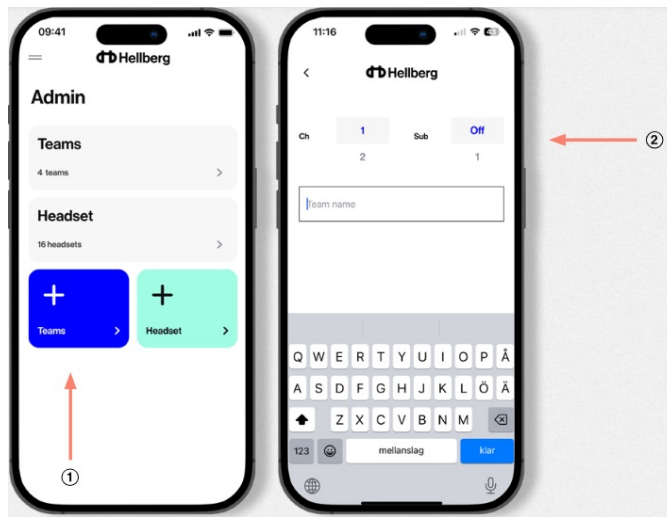

Create a company profile (part 2)

4. Company profile is now created. Note! It is important that you save your new Company ID. You will need it next time you log-in to your company profile.
5. Click "Send Email with ID" to open your Email-app with the Company ID added to the email. A quick way to store and access your company ID.

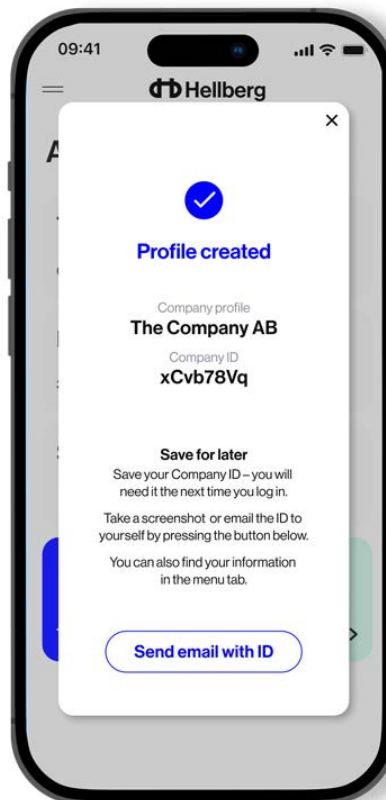

Admin Dashboard

This is the admin dashboard from where you will be able to add headsets (users) to your company and set up Teams (channel-settings for group communication).

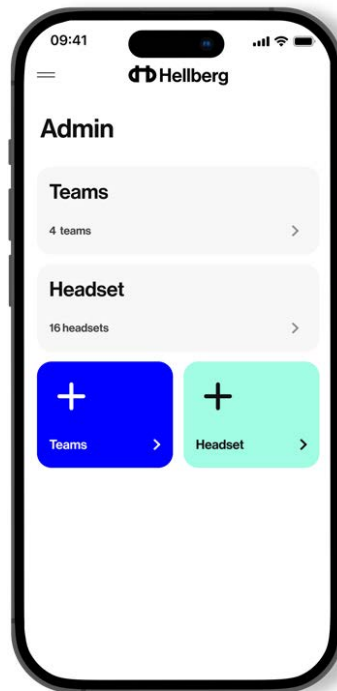

Adding headsets to a company (part 1)

1. Click the + on the green headset button.
2. Power on the first headset to be added.
3. Press the headsets menu button > until you see "Bluetooth" in the LED, then press the On/Off button to select and press > to enter pairing mode.
4. Click the Scan button in the app.

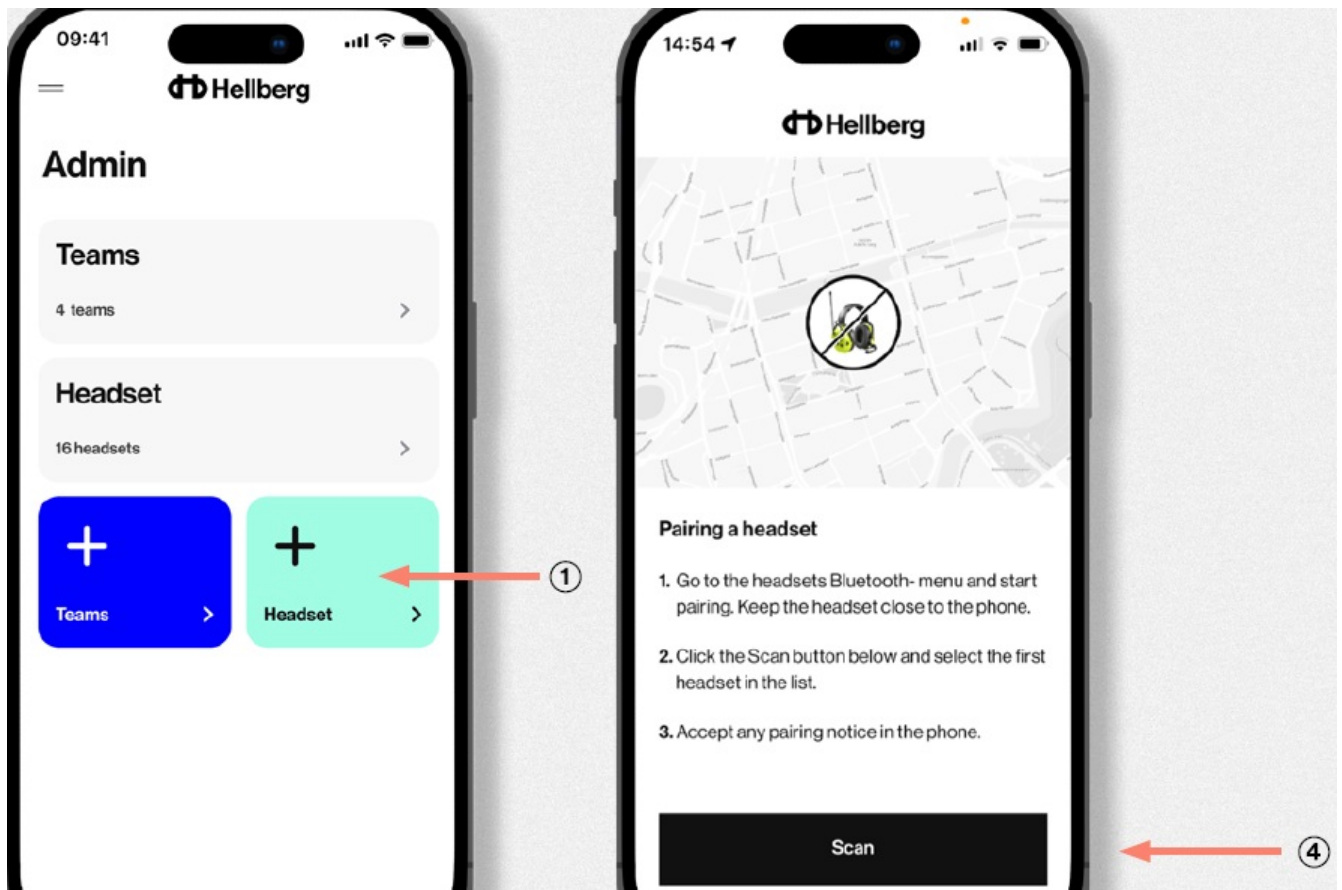

Adding headsets to a company (part 3)

- Once the headset is named and added to the company, it will disconnect from your phone and empty its paired devices list.
- You now get the option to enable safety mode in the headset. You can do this now or at a later stage.
- To eliminate any problems when adding the next headset, you need to delete the headset from your phones' paired devices (in your phones' Bluetooth settings).

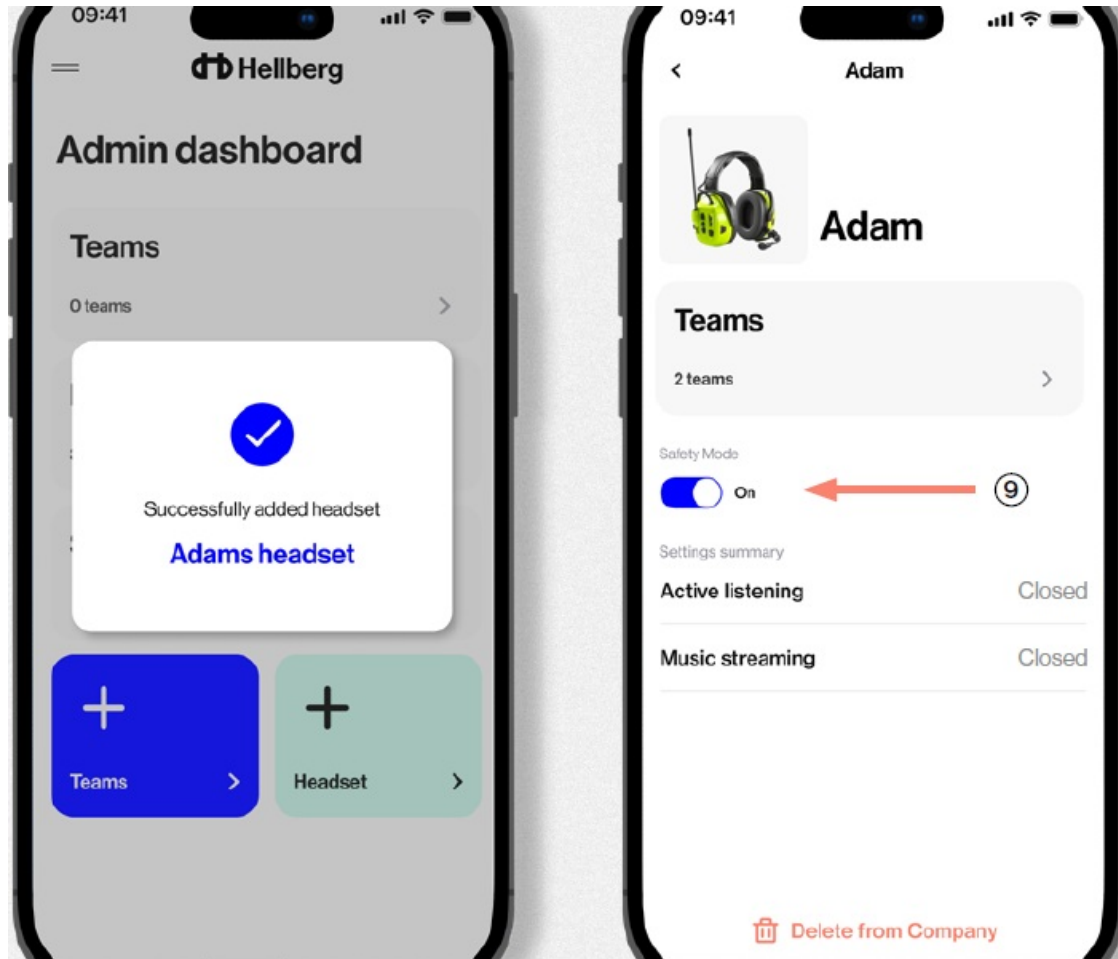

Administrating headsets (users)

- All headsets added are listed under the Headsets menu.
- Select a headset from the list to edit its individual Teams- and safety-settings.
- To delete a headset (user), swipe to the right or click on the head-set name to enter its settings and click the trash-can to delete.

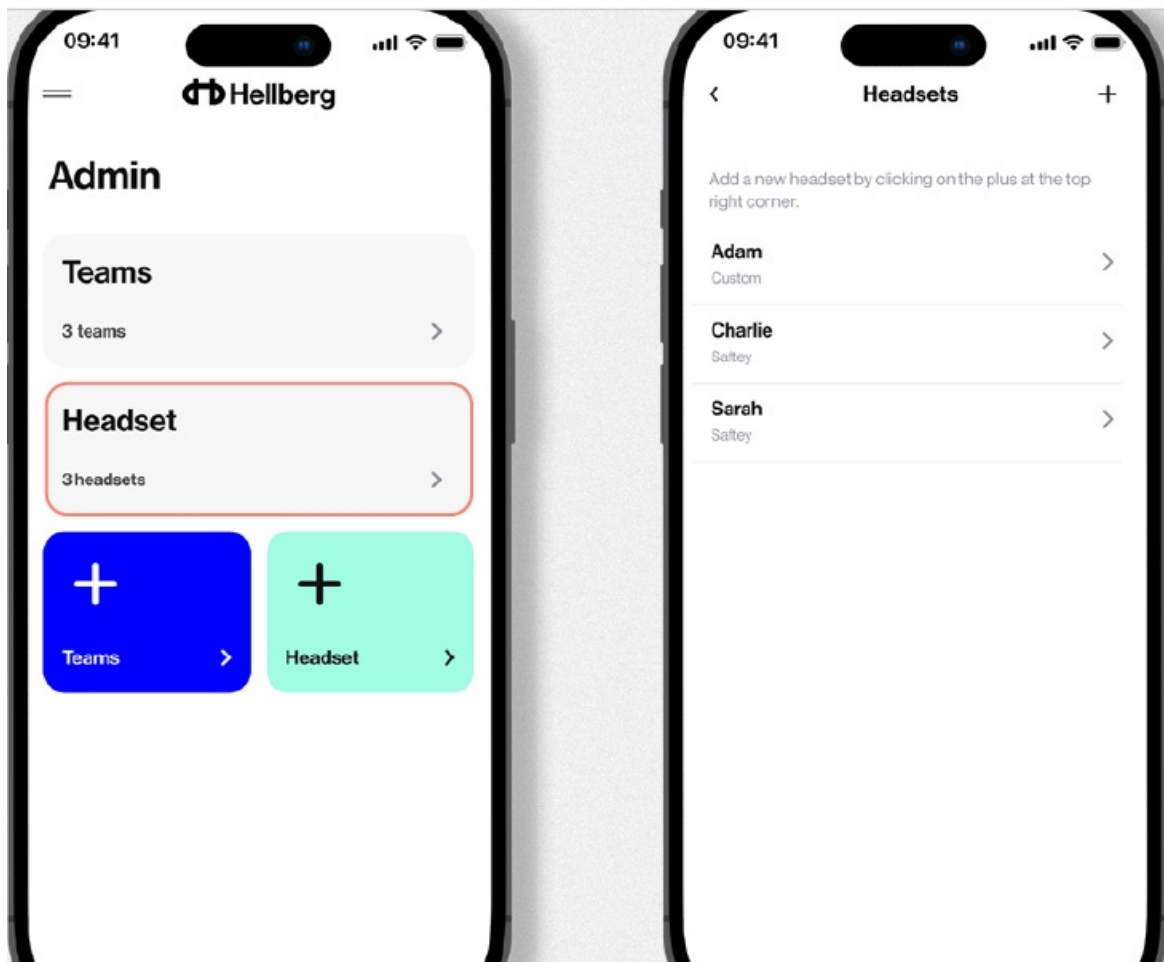

Editing headset settings as an admin

In this view you can edit safety settings for an individual headset, and delete the headset from the company by clicking the trash-can.

1. **Safety mode**

Swipe the toggle ON to disable music streaming (via A2DP Blue-tooth) as well as prevent the Active Listening function from being turned off.

2. **Teams menu**

From here you select which Teams the user will have access to. Add or remove teams by clicking the pen in the top right corner.

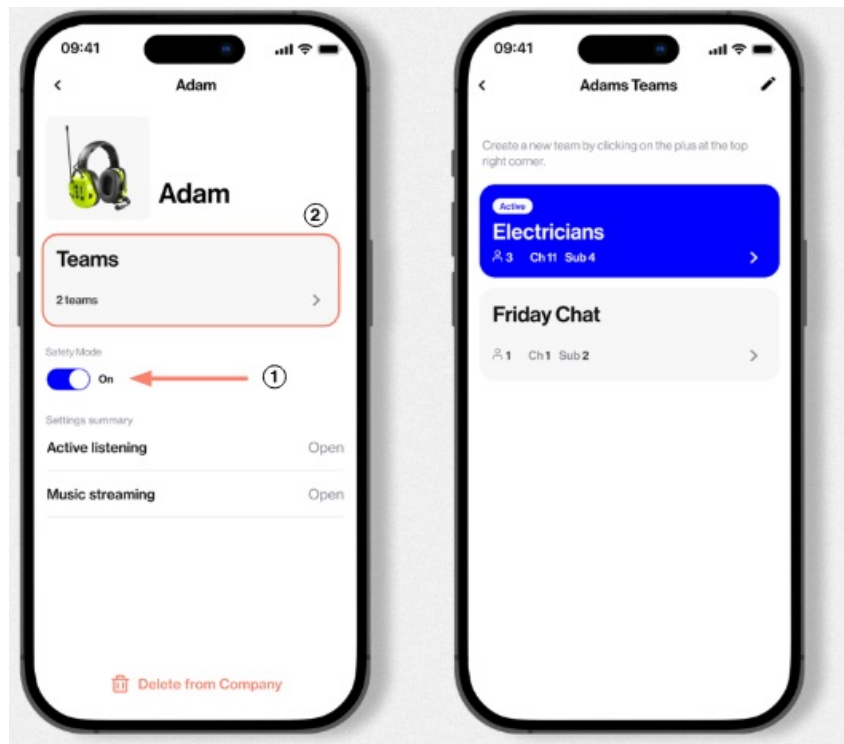

Setting up Teams (part 1)

- A "Team" is an easy accessible channel pre-set. Having multiple Teams allows a user to quickly switch between different channel settings without having to change channel and sub-channel manually on the headset.
- The user simply select the team to join and the channel settings are updated in the headset.
 1. Click + in the blue Teams button.
 2. Select a channel and sub-channel.

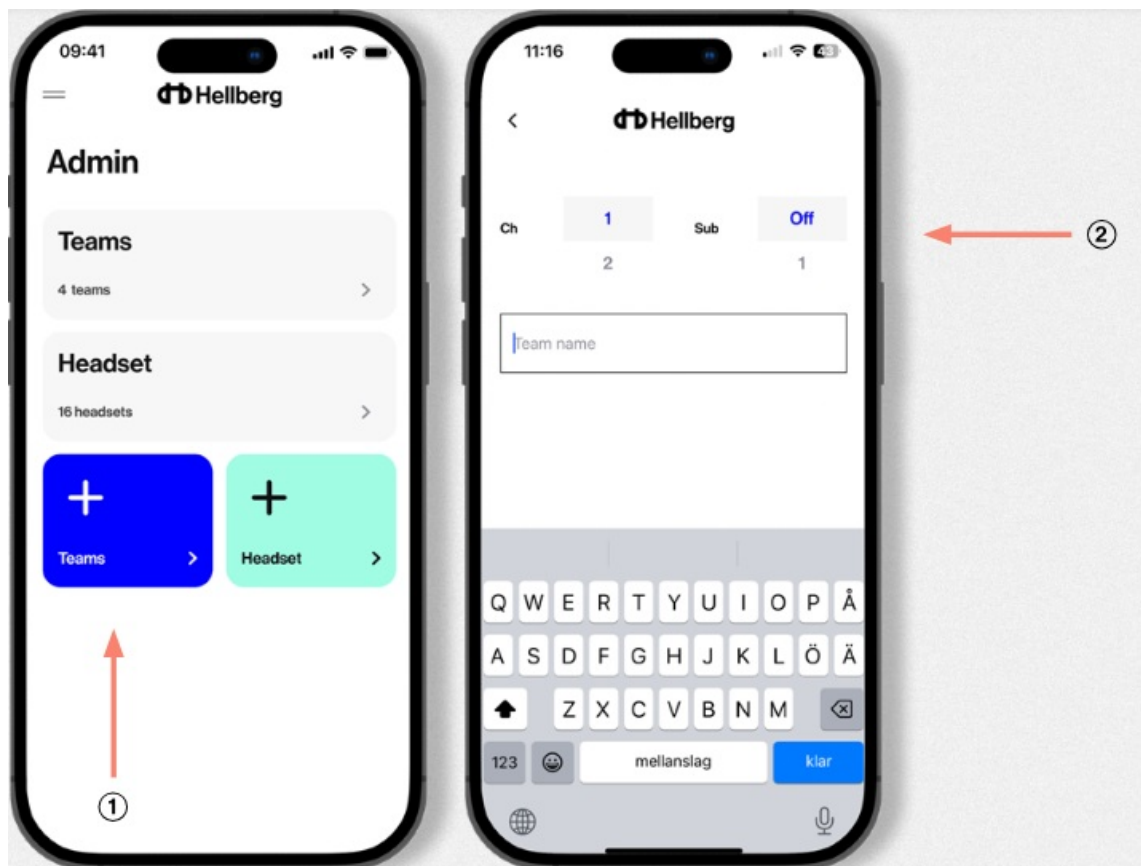

Setting up Teams (part 2)

3. Give the team a name.

4. Select which users should have access to the team.
5. Click the "Create team" button.

The team settings are "pushed-out" over internet to the selected users. Edit and push-out new settings at any time.

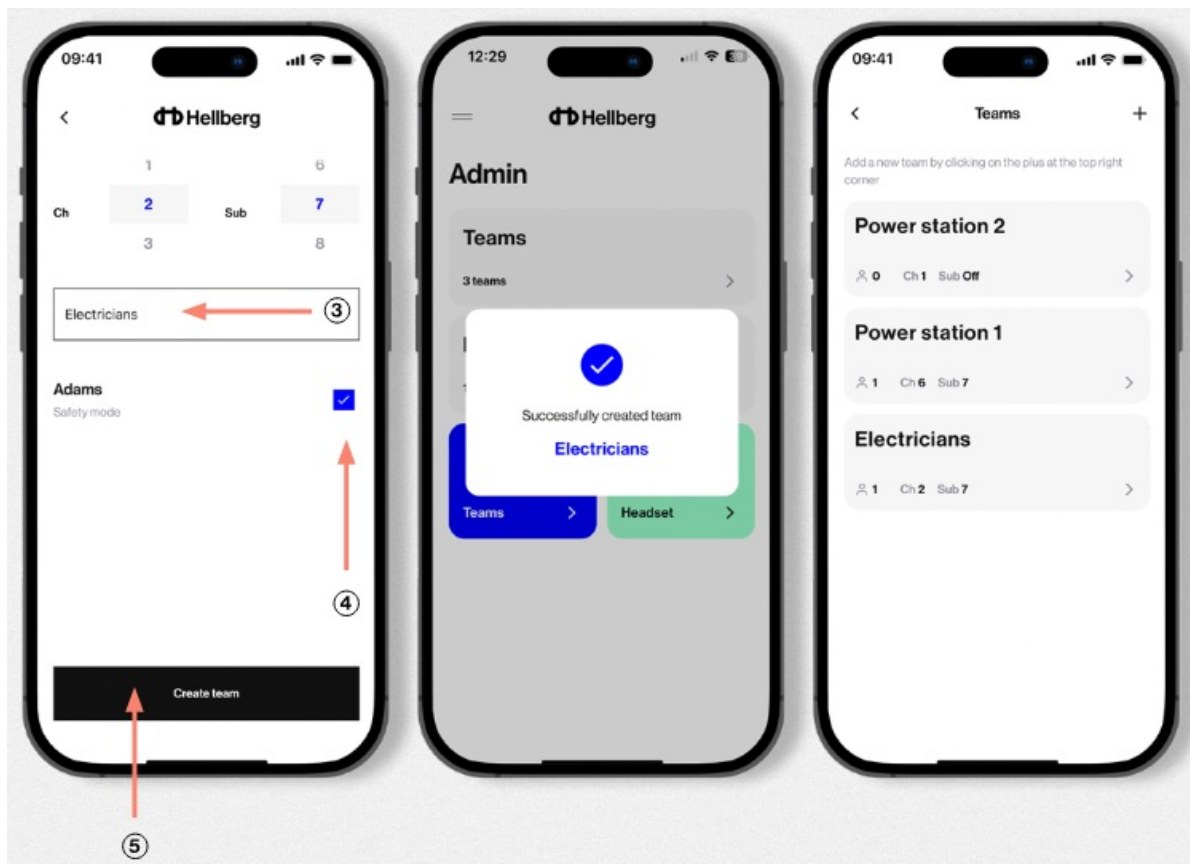

User mode

- A user will be able to access the headset menu-settings from the app, without needing to operate it via the headset-buttons and LED display.
- If the headset has been added to a Company profile, the Admin will be able to "push-out" Teams- and safety settings to the headset.
- Select the "User mode" button to begin.

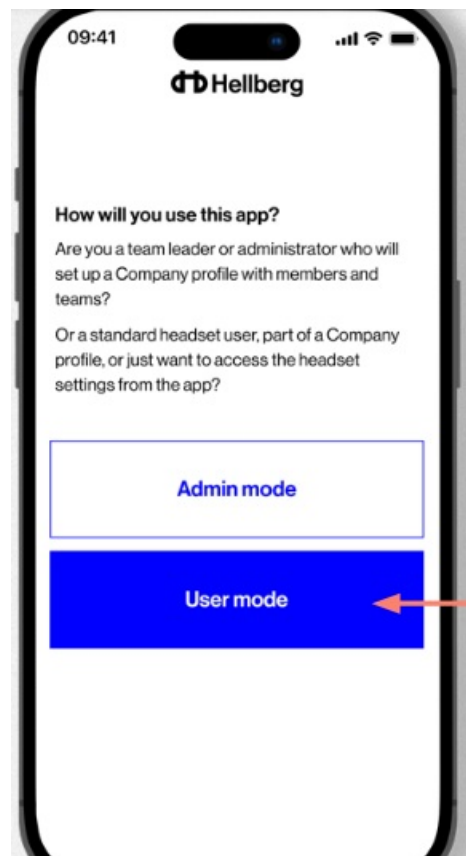

Pairing a headset as a user (part 1)

1. Power on the headset.
2. Press the Headset menu button > until you see "Bluetooth" in the LED, then press the On/Off button to select and press > to enter pairing mode.
3. Click the Scan button in the app and select the first headset that shows up in your list. Keep the phone close to the headset.
4. Accept any Bluetooth pairing notice from the headset.

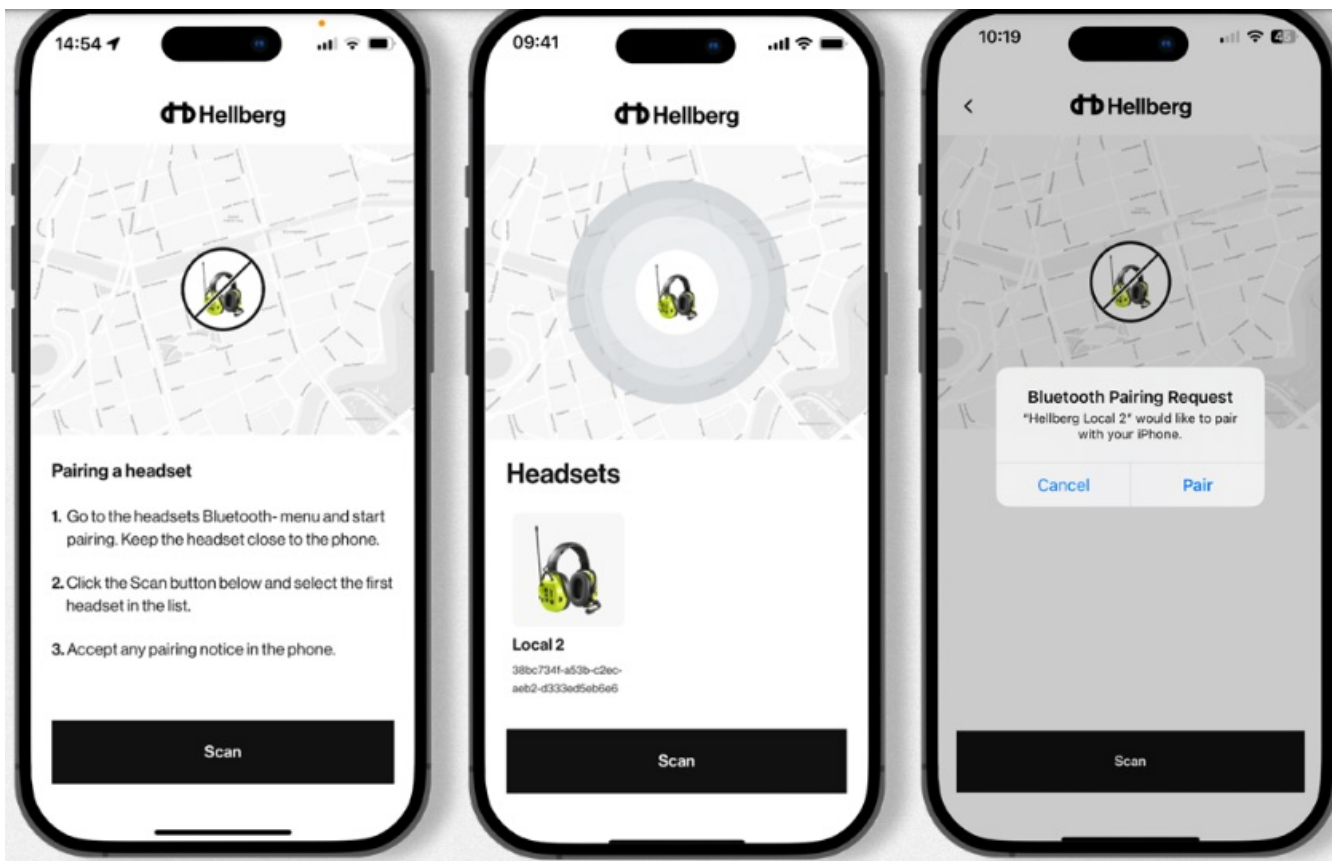

Pairing a headset as a user (part 2)

5. You are now in the Headset Dashboard. If your headset have been added to a company it will show your headset name and if safety mode is activated. If you are not part of a company it will show "Hellberg Local 2" as headset name.
6. (iPhone users only) To be able to stream music and make phone calls you have to find the "Bluetooth Paired Devices list" in your phone and select "Hellberg Local 2" to enable the "Bluetooth® Classic" protocol.

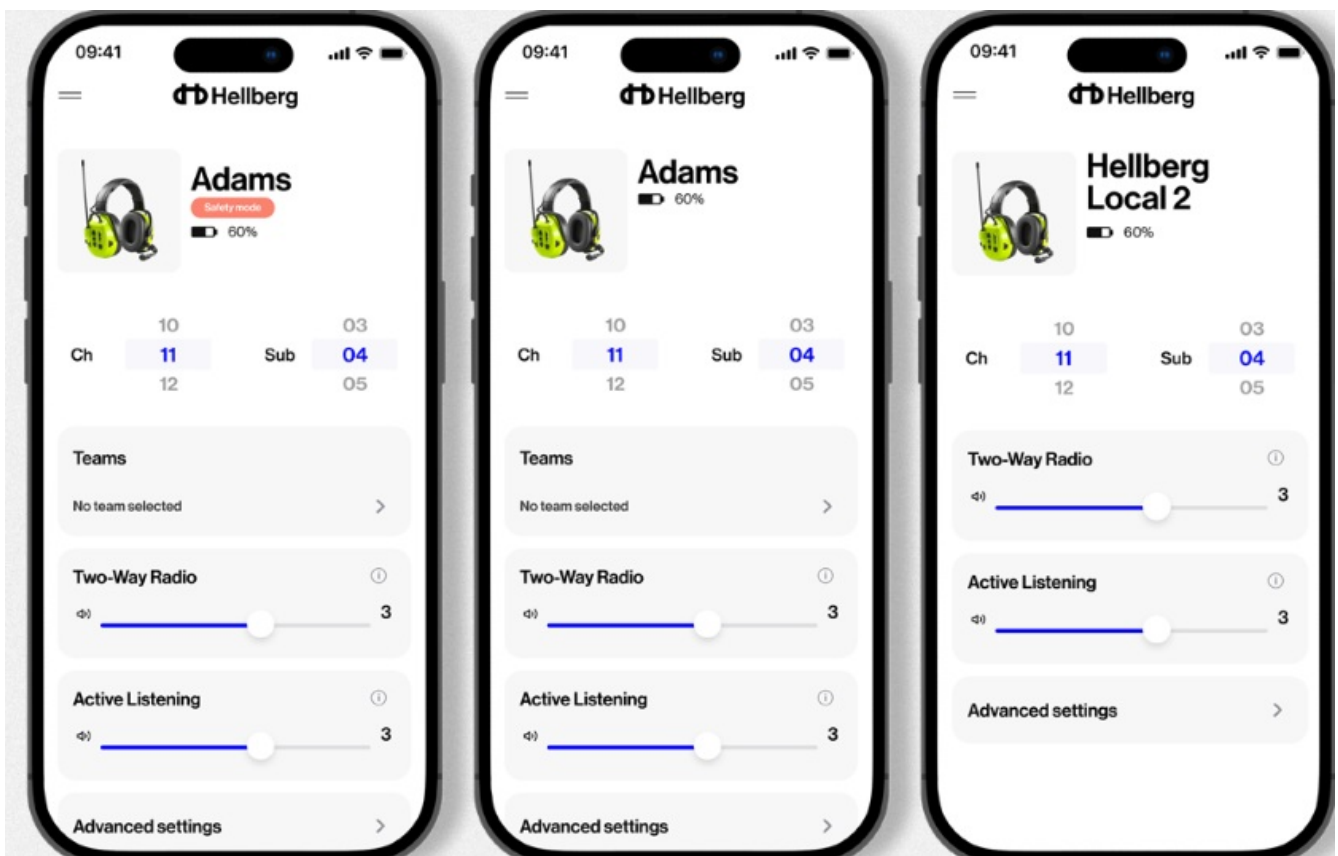

Join a Team (if part of a company)

1. Select the Teams menu to see the list of accessible teams
2. Select a team
3. The teams channel settings are updated in the headset

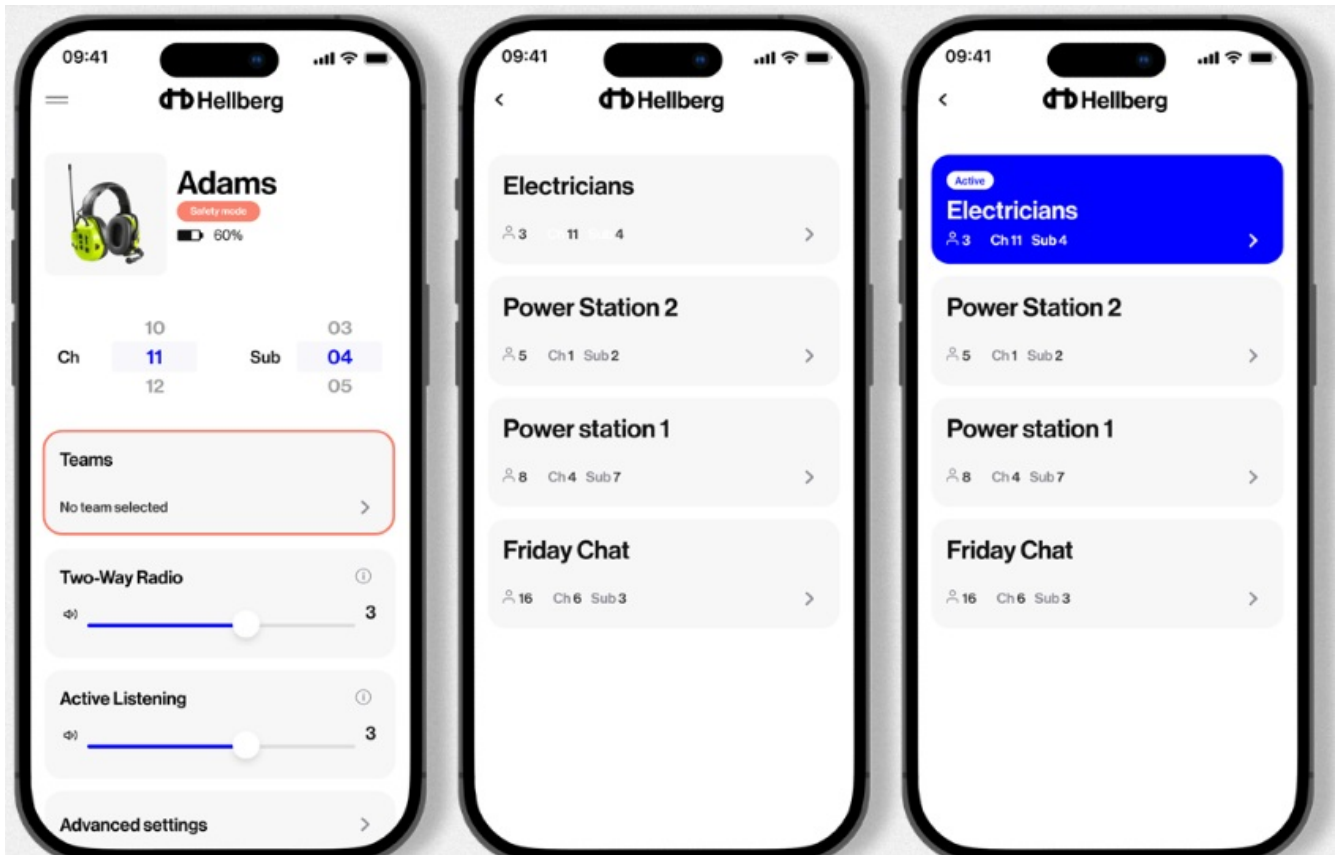

Edit and adjust the headset settings

- You can edit and adjust all settings available in the headsets menu directly from the apps' Headset Dashboard.
- Scroll to select channel and sub-channel. (if you have joined a team, changing this will deactivate the team selection)
- Volume settings for the Two-Way Radio and Active Listening are available in this view. If you have "safety mode" activated, you will not be able to turn off the Active Listening function.
- Select the "Advanced settings" menu to explore even more settings.
- Click the (i) for a short introduction to each function.

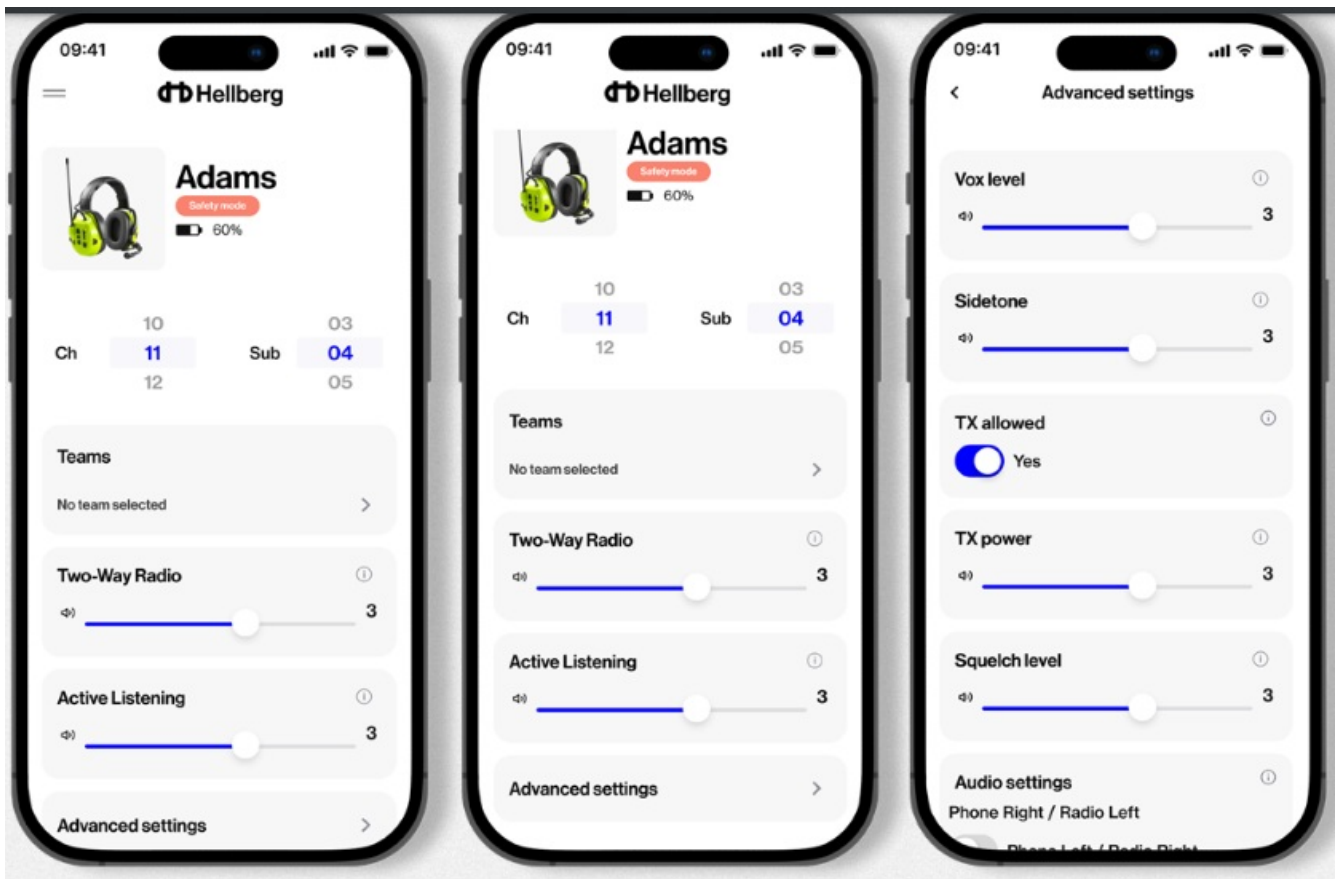

The app main menu

- From the main menu of the app you can access the Admin and Headset dashboards. If you are using the app in user- mode, clicking on Admin will ask you to enter a Company ID.
- If you are logged-in as an Admin, you will see your Company profile. You are also able to change your company name and Email.
- The information menu contains contact information, FAQ's and product guides.
- Software update lets you download the latest available software for your headset.

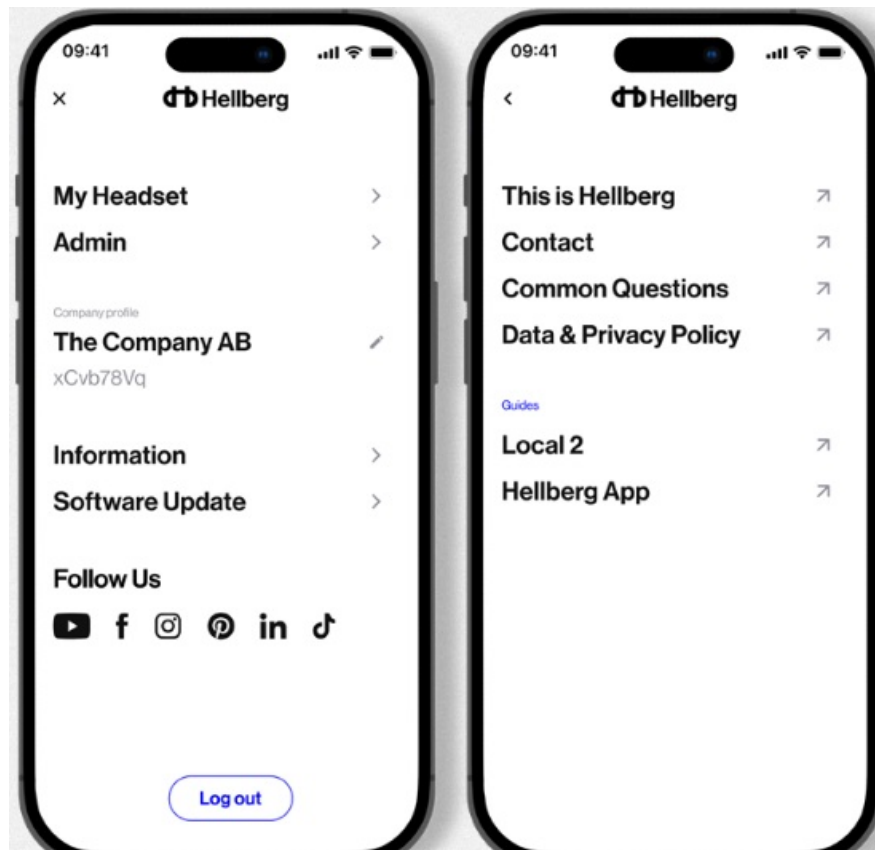

Download the latest headset software

From here you can update your headset with the latest available software.

1. Click the "Start" button to transfer the software from the app to your headset.
2. Once transferred, an "Update" button will appear. Click this to start the process, which may take up to one hour.
 - The headset battery must be charged to at least 50% for the process to start. Keep the headset and phone paired during the entire process.
 - The headset will reboot several times during the process. When the headset LED screen lights up normal, the update is finished and you can continue to use your headset.

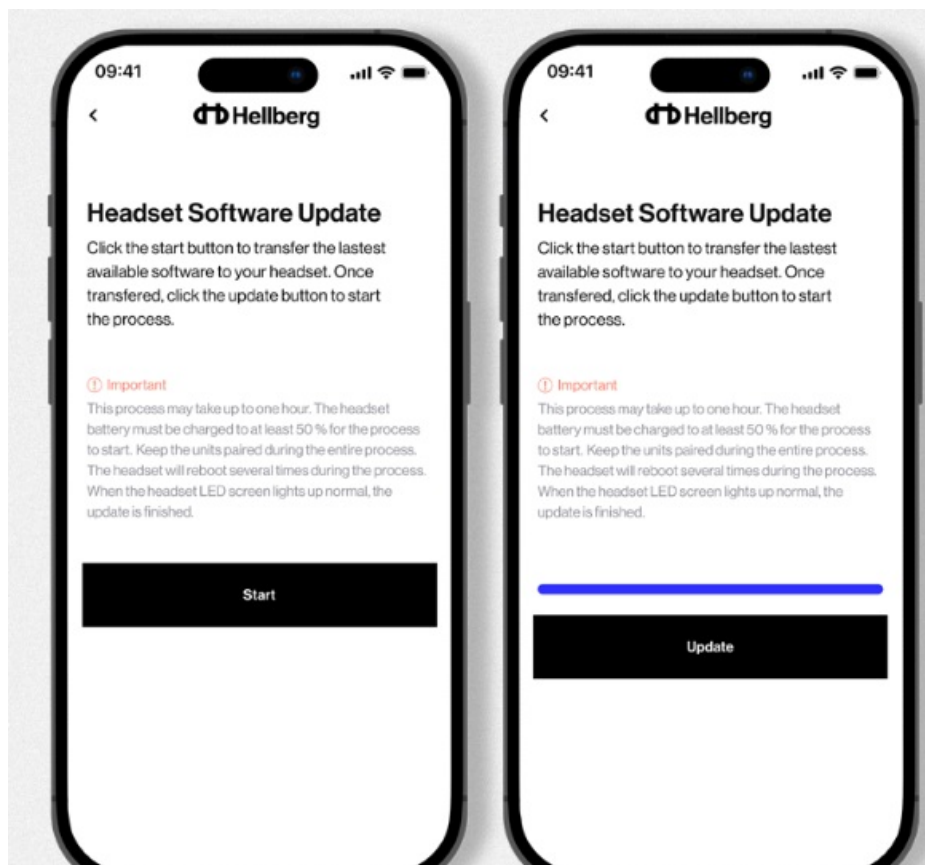

- Hellberg Safety AB Stakebergsv. 2, 443 61 Stenkullen



- info@hellbergsafety.se
- hellbergsafety.com

Documents / Resources

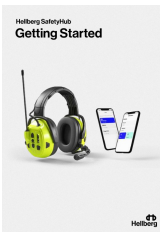
	<p>Hellberg SafetyHub Getting Started App [pdf] User Manual SafetyHub Getting Started App, Getting Started App, Started App, App</p>
---	---

References

- [Hellberg Safety | Head Protection](#)

- [User Manual](#)

[Manuals+](#), [Privacy Policy](#)

This website is an independent publication and is neither affiliated with nor endorsed by any of the trademark owners. The "Bluetooth®" word mark and logos are registered trademarks owned by Bluetooth SIG, Inc. The "Wi-Fi®" word mark and logos are registered trademarks owned by the Wi-Fi Alliance. Any use of these marks on this website does not imply any affiliation with or endorsement.