



Contents [[hide](#)]

- [1 EINNER HWM-H6010IVSMC+++ Automatic Washing Machine](#)
- [2 INTRODUCTION](#)
- [3 CONTENT OF YOUR PACKAGE](#)
- [4 SAFETY PRECAUTIONS](#)
- [5 PRODUCT DESCRIPTION](#)
- [6 INSTALLATION](#)
- [7 CONTROL PANEL](#)
- [8 PROGRAM TABLE](#)
- [9 PROGRAM OPTIONS](#)
- [10 CLEANING AND MAINTENANCE](#)
- [11 TROUBLESHOOTING](#)
- [12 Frequently Asked Questions](#)
- [13 Documents / Resources](#)
 - [13.1 References](#)

HEINNER

EINNER HWM-H6010IVSMC+++ Automatic Washing Machine



Specifications

- Model: HWM-H6010IVSMC+++
- Capacity: 6 kg
- Power Supply: 220-240V~50Hz

Automatic washing machine

- Loading capacity: 6 kg
- Spin capacity: 1000 rpm
- Energy class: C

INTRODUCTION

Before using the appliance, please read carefully this instruction manual and keep it for future reference.

This instruction manual is designed to provide you with all required instructions related to the installation, use and maintenance of the appliance.

In order to operate the unit correctly and safety, please read this instruction manual carefully before installation and usage.

CONTENT OF YOUR PACKAGE

- Automatic washing machine

- User manual
- Warranty card

SAFETY PRECAUTIONS

1. Before operating your new washing machine, please read this instruction carefully. Please do not throw away this user manual; keep it for future reference. You or somebody else might need it in the future.
2. Please make sure the socket is grounded securely, the water source connection is reliable.
3. Your machine is designed to be used domestically. Commercial use will cause your warranty to be cancelled.
4. The appliance is not intended for use by people (including children) with reduced physical, sensory or mental capabilities, or lack of experience and knowledge unless they have been given supervision or instruction concerning use of the appliance by a person responsible for their safety.
5. This appliance can be used by children aged from 8 years and above and persons with reduced physical, sensory or mental capabilities or lack of experience and knowledge if they have been given supervision or instruction concerning use of the appliance in a safe way and understand the hazards involved.
6. Children should be supervised to ensure that they do not play with the appliance. Children of less than 3 years should be kept away unless continuously supervised.
7. Keep your pets away from your machine.
8. If the supply cord is damaged, it must be replaced by the service agent or similarly qualified persons in order to avoid a hazard.
9. Please check the packaging of your machine before installation, and the outer surface after the package is opened. Do not operate damaged machines or machines with opened package.
10. Have your machine installed only by authorized person. Any interference to your machine by anyone other than authorized person shall cause your warranty to be void.
11. Before operating the washing machine, remove the 4 transportation screws from the back of the machine. If the screws are not removed, it may cause heavy vibration, noise and product malfunction, (voiding the guarantee).
12. Your machine is not covered under warranty for faults caused by any kind of external f

actors (pesticides, fire, etc.)

13. The washing machine must only be installed in enclosed spaces. The necessary ambient temperature for your machine's ideal operation is 15-25°.
14. Use your machine only for laundries that have been specified as suitable for washing by the manufacturer.
15. Please ensure that the clothes you will place in your machine do not contain any foreign substances (nail, needle, coins, lighter, matches, clip etc.) in their pockets. These foreign substances can damage your machine.
16. It is recommended to perform the first washing operation in a short programme and without laundry by inserting 30 ml of detergent into the main compartment of the detergent drawer.
17. As detergent or softener exposed to air for a long time may cause residues, put your detergent or softener in the detergent drawer at the beginning of every washing.
18. It is advised that you unplug your machine and close the water inlet tap if you will not use your machine for a long time. Also, leaving the door of your machine will prevent the formation of bad odors due to humidity.
19. The maximum permissible inlet water pressure, 1 MPa, for appliances intended to be connected to the water mains. The minimum permissible inlet water pressure, 0.1 MPa, if this is necessary for the correct operation of the appliance
20. Some water might be left in your machine after the trials and tests conducted due to Quality Control procedures. This will not damage your machine.
21. Remember that packaging materials of your machine may be dangerous for children.
22. Keep the packaging materials in a place where children cannot reach or dispose of them appropriately.
23. Use pre-wash programs only for very dirty laundry.
24. Never open the detergent drawer when the appliance is running.
25. In case of any breakdown, unplug the appliance first and then turn the tap off. Do not attempt to repair by yourself, always contact for authorized service advice.
26. The amount of laundry you put in your washing machine should not exceed the maximum amount indicated.
27. Never force the door to open when the machine is running.
28. Washing floury clothes in your machine damages the machine. Do not wash floury clothes in your machine.
29. This appliance is intended to be used in household and similar applications such as:

staff kitchen areas in shops, offices and other working environments; farmhouses; by clients in hotels, motels and other residential type environments; bed and breakfast type environments; areas for communal use in blocks of flats or in launderettes.

You must read these warnings. You can thus protect yourself and your beloved ones against fatal injuries and risks.

DANGER OF GETTING BURNT!

Do not touch discharging hose and water during discharging as the appliance may reach high temperatures when running.

DEATH RISK DUE TO ELECTRICAL CURRENT!

1. Do not use multiple receptacles or extension cord.
2. Do not plug in damaged plug sockets.
3. Never pull the cable when unplugging – always grip the plug itself.
4. Do not plug-in or out the plug from the receptacle with wet hands to prevent electrocution!
5. Never touch the machine with wet hands or feet.
6. Call the nearest authorized service for a replacement if the power cord malfunctions.

DANGER OF FIRE!

1. Do not keep inflammable liquids near your machine.
2. The sulphure content of paint removers might cause corrosion. For this reason, never use paint-removing materials in your machine.
3. Never use products that contain solvent material (like washing gas) in your machine.
4. Remove all the objects in the pockets of your laundries (needle, paperclip, lighter, matches etc.) when placing them your machine.

Fire and Explosion risk may occur

FLOODING RISK!

1. Check whether the water runs fast or not before placing the discharge hose on the

sink.

2. Take necessary measures to prevent the slipping of your hose.
3. The backfiring force of a hose that is not placed appropriately can displace the hose.
Prevent the stopper inside your sink from blocking the sink hole.

FALL AND INJURY HAZARD!

1. Do not climb on your machine. The upper table of your machine may break and you might get injured.
2. Tidy the hose, cable and packaging of your machine during installation. You might trip over and fall.
3. Do not turn your machine upside down, or on its side.
4. Do not lift your machine by holding it from extruding parts (detergent drawer, door).
These parts might break and cause you to get injured.
5. There's the risk of tripping and injury if the materials like hose and cables are not properly stored after your machine is installed. Machine must be carried by 2 people or more.

CHILD SAFETY!

1. Do not leave children unattended near the machine. Children might lock themselves up into the machine and death risk might occur. Children should be supervised to ensure that they do not play with the appliance. Children must not be allowed to play with the appliance or to climb into the drum.
2. Door glass and surface might be extremely hot while your machine operates. Thus, especially touching the machine might give damage to the skins of children.
3. Keep packaging material away from children.
4. Poisoning might occur if the detergent and maintenance materials are consumed, and eyes or the skin might be irritated if they come into contact with the skin. Keep the cleaning materials away from the reach of children.

SAVING INFORMATION

Some important information to get more efficiency out of your machine: The amount of laundry you put in your washing machine should not exceed the maximum amount indicated. By this way, your machine shall run in saving mode. Not using the pre-wash

feature for little and normal-dirty laundry shall save electricity and water.

PRODUCT DESCRIPTION

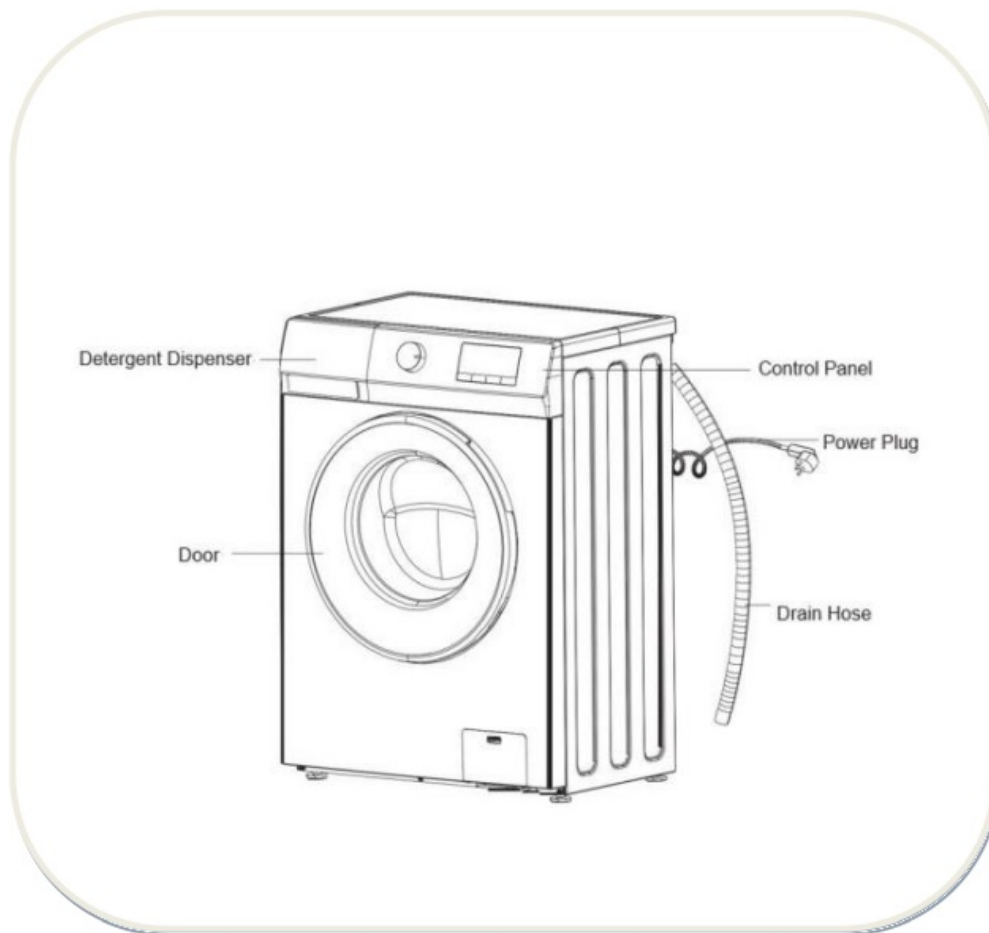

INSTALLATION

REMOVING THE TRANSPORTATION SCREWS

1. Before operating the washing machine, remove the 4 transportation screws from the back of the machine. If the screws are not removed, it may cause heavy vibration, noise and product malfunction (voiding the guarantee).
2. For this reason, transportation safety screws shall be loosened by being rotated approx. 30 mm following the direction of arrow shown using an appropriate wrench.

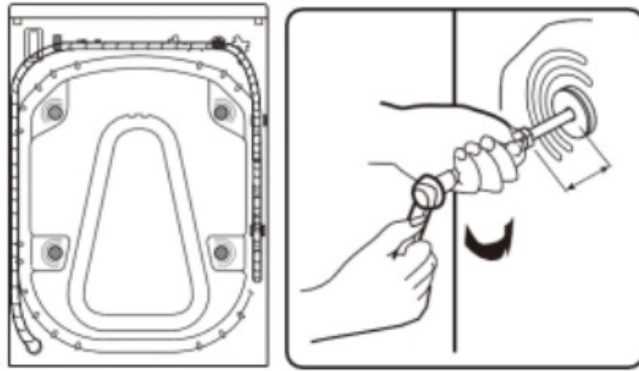

3. Push two transportation bolts on horizontal direction inward and loose transportation bolt.

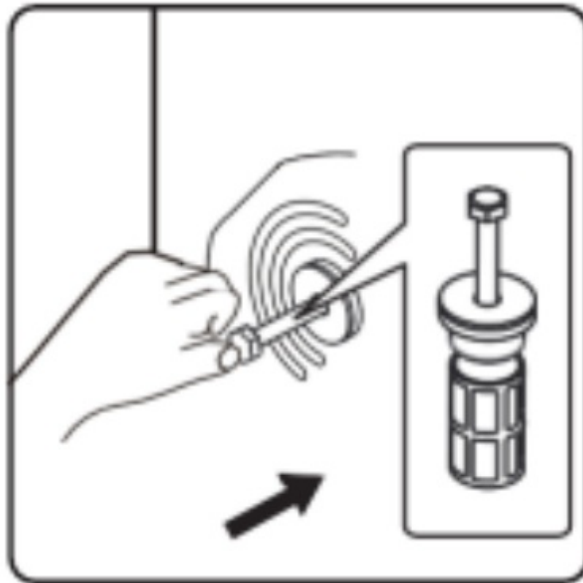

4. Transportation screws shall be removed by pulling out.

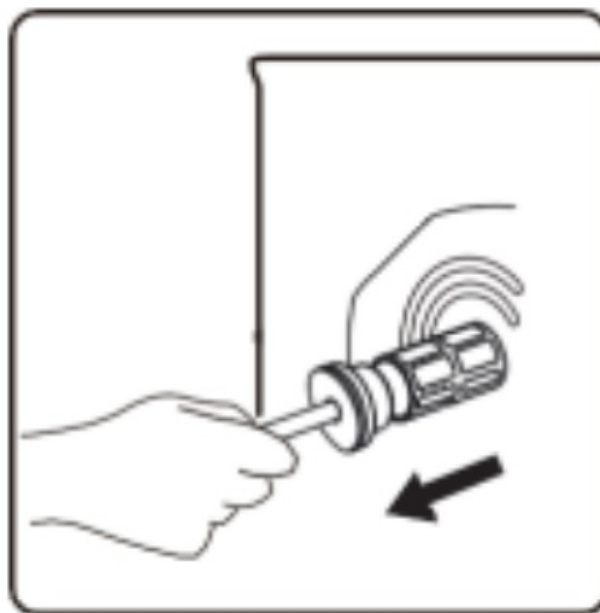

To ensure safety and reduce noise, you should install the transportation bolt cover supplied with the unit (see the annex accompanying the unit). Lean and place the transportation bolt into hole and press it following the shown direction until it clicks.



5. The transportation safety screws should be stored to be used in case of transportation.

NOTE: You should absolutely remove the transportation screws of your machine before the first usage. Faults occurring in the machines operated with transportation screw fitted shall be out of scope of warranty.

ADJUSTMENT

Do not install your machine on a carpet or such grounds that would prevent the ventilation of its base. To ensure silent and vibration-free operation of your machine, it should be deployed on a non-sliding and firm ground. You can adjust the balance of your machine through the stays. Loosen the plastic adjustment locknut.



Lift the machine slightly and adjust the stays upward and downward by rotating them

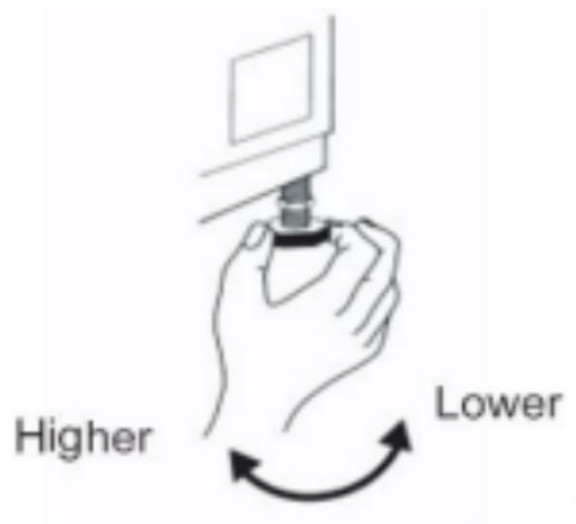

After maintaining the balance, compress the plastic adjustment nut upward again.



Never put cardboard, wood or suchlike materials under your machine if you are intending to stabilize the distortions on the ground. When cleaning the ground, on which your machine rests, be careful not to disorder stays stabilization.

ELECTRICAL CONNECTION



- Your washing machine is set to 220-240V and 50Hz.
- The mains cord of your washing machine is equipped with a specific earthed plug. This plug should always be inserted to a earthed socket of 10 amps.
- The current value of the fuse should be 10 amps. Fuse current value of the power line connected to this plug should also be 10 amperes.
- If you don't have such a receptacle and fuse confirming with this, please have it done by a qualified electrician.
- We do not take the responsibility of the damages that occur due to ungrounded usage. NOTE: Operating your machine under low voltage will cause the life cycle of your machine to be reduced and its performance to be restricted.

W A T E R I N L E T H O S E C O N N E C T I O N

- Your machine may have either a single inlet (cold) or double water inlets (cold/hot) based on its specifications. White-capped hose should be connected to cold water inlet and red-capped hose to hot water inlet (applicable for machines with double water inlets).
- Mount new water inlet hoses to a $\frac{3}{4}$ " , threaded faucet.
- If the water inlet hose is not already installed, it must be screwed to the appliance. The blue marked hose is only for cold water. Depending on the model, the hot water hose marked with red should also be connected, for models having dual inlets. Screw by hand the inlet hose onto the tap, tightening the nut.
-

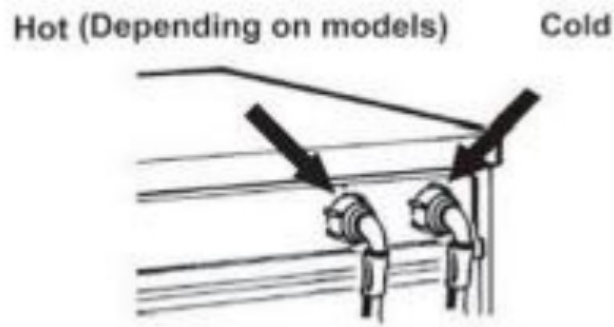

Flow of water with pressure of 0,1-1 Mpa will allow your machine to operate more efficiently. (0,1 Mpa pressure means that more than 8 litres of water will flow through a fully-tapped faucet per one minute.)

- Ensure that points of contact do not leak by tapping the faucet completely after carrying making the connections.
- Ensure that the new water inlet hoses are not bent, broken, crushed and resized.
- Fix the inlet hose to the cold water tap and to the inlet valve on the rear side of the machine. C old fill Inlet valve



Note: Use only the new water inlet hose coming with your machine while making water inlet connections of your machine. Never use old, used or damaged water inlet hoses.

WATER DISCHARGE CONNECTION

- Never attempt to extend the water discharge hose by jointing.
- Do not put discharging hose of your machine in a vessel, bucket.
- Make sure that the water discharge hose does not bend, buckle, be crushed or extended.
- Connect the drain hose to the drain or hook it over the edge of a sink by means of the

“U” bend.

- Fit the “U” bend D, if not already installed, at the end of the drain hose.
-

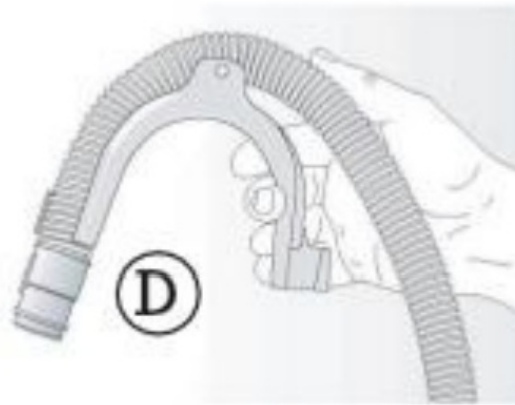

If the washing machine is connected to an integrated drainage system, ensure that the latter is equipped with a vent to avoid simultaneous loading and draining of water (siphoning effect).

- Ensure that there are no kinks in the drain hose. Secure the hose so that it cannot fall down. After wash phase, machine will drain out hot water.
- Small hand basins are not suitable.
- Fix the drain hose securely to prevent scalding during machine drainage



Quick Start

Before washing, please make sure it's installed properly.

Before washing at first time, the washing machine shall be operated in one round of the whole procedures without clothes in as follows.

1. Before Washing

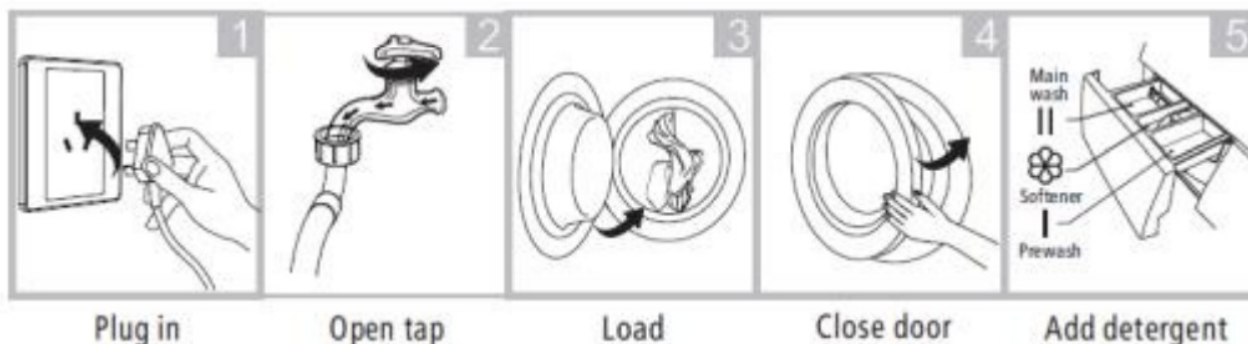

Note! Detergent only need to be added in “case I “after selecting pre-washing for machines with this function.

2. Washing

- Power On
- Select a short programme
- Start

Before Each Washing

The working condition of the washer should be (0-40)°C.If used under 0°C,the inlet valve and draining system may be damaged. If the machine is placed under condition of 0°C or less, then it should be transferred to normal ambient temperature to ensure the water supply hose and drain hose are not frozen before use.

Please check the labels and the explanation of using detergent before wash. Use non-foaming or less-foaming detergent suitable for machine washing properly

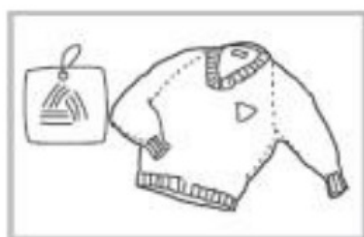

Check the label



Take out the items out of the pockets

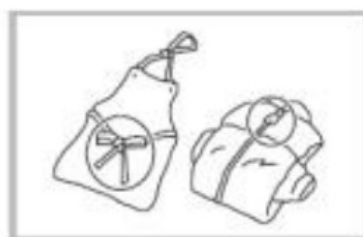

Knot the long strips,zip or button



Put small clothes into the pillow slip



Turn easy-pilling and long-pile fabric inside out

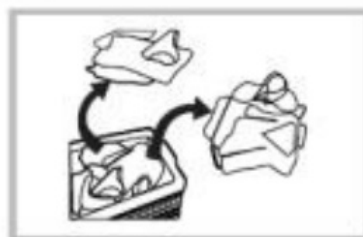

Separate clothes with different textures

SEPARATING LAUNDRIES

- Your laundry has product labels on them that specify their specifications. Wash or dry your laundry according to the specifications on the product label.
- Separate your laundries according to their types (cotton, synthetic, sensitive, wool etc.), their temperatures (cold, 30°, 40°, 60°, 90°) and degree of contamination (slightly stained, stained, highly stained).
- Never wash your coloured and white laundry together.
- Wash your coloured laundries separately in the first washing as they may bleed.
- Ensure that there are no metallic materials on your laundries or in the pockets; if so, take them up.



CAUTION: Faults that will emerge in case of penetration of foreign substances into your machine are not included within the scope of warranty.

- Zip up and button up your laundries.
- Remove the metallic or plastic hooks of tulle curtains or curtains or place them in a washing net or bag and then muzzle them.
- Reverse textiles such as pants, knitwear, t-shirt and sweat suit.
- Wash socks, handkerchief and suchlike small laundries in a washing net.

PUTTING LAUNDRIES IN THE MACHINE

- Open the door of your machine.
- Spread your laundries in your machine.

NOTE: Maximum loading capacity may vary based on the laundry type you will wash,

degree of contamination and the programme you have chosen. Do not exceed maximum dry loading capacity indicated in the programme table for washing programmes

ADDING DETERGENT INTO MACHINE

Always use high efficiency, low foam detergent for a front load machine. The choice of detergent depends on: Type of fabric (cottons, easy care/synthetics, delicate items, wool), Colour, The wash temperature, Degree and type of soiling.

Note: Any whitish residues on dark fabrics are caused by insoluble compounds used in modern phosphate-free powder detergents. If this occurs, shake or brush out the fabric or use liquid detergents. Use only detergents and additives specifically produced for domestic washing machines. When using descaling agents, dyes or bleaches for the pre-wash, make sure that they are suitable for use in domestic washing machines. Descalers could contain products which could damage your washing machine. Do not use any solvents (e.g. turpentine, benzine). Do not machine wash fabrics that have been treated with solvents or flammable liquids

THE DETERGENT DRAWER

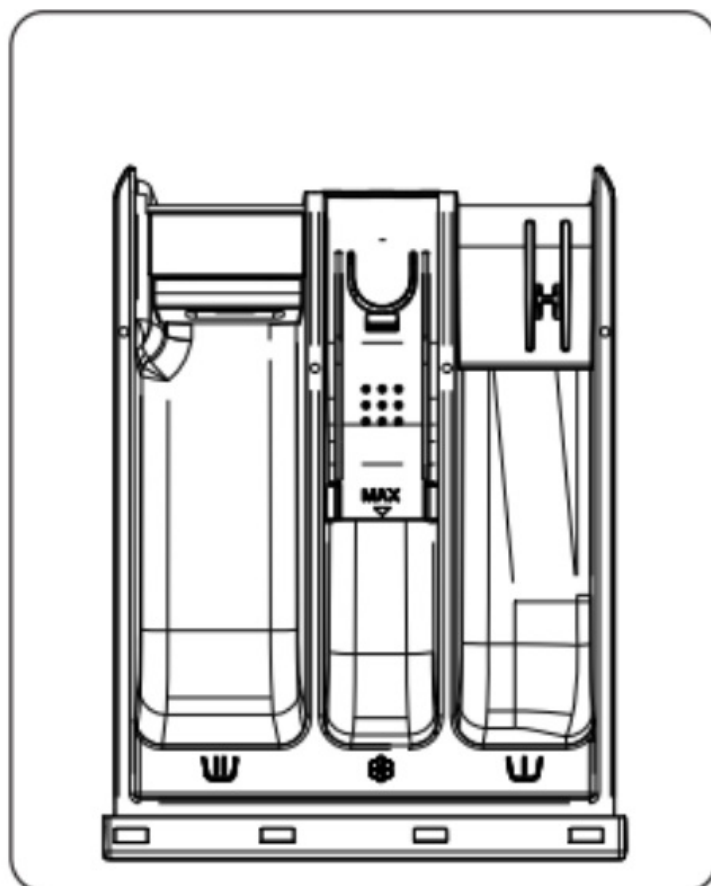

Pre-wash detergent compartment:



This compartment must only be used when the pre-wash feature is selected. Pre-wash feature is recommended for very dirty laundry.

Main wash detergent compartment:



In this compartment, only materials like detergent (liquid or powder), stain remover and water softener.

Softener compartment:





You can use fabric softener for your laundry, liquid starch. Pour additives only up to the "MAX" mark.

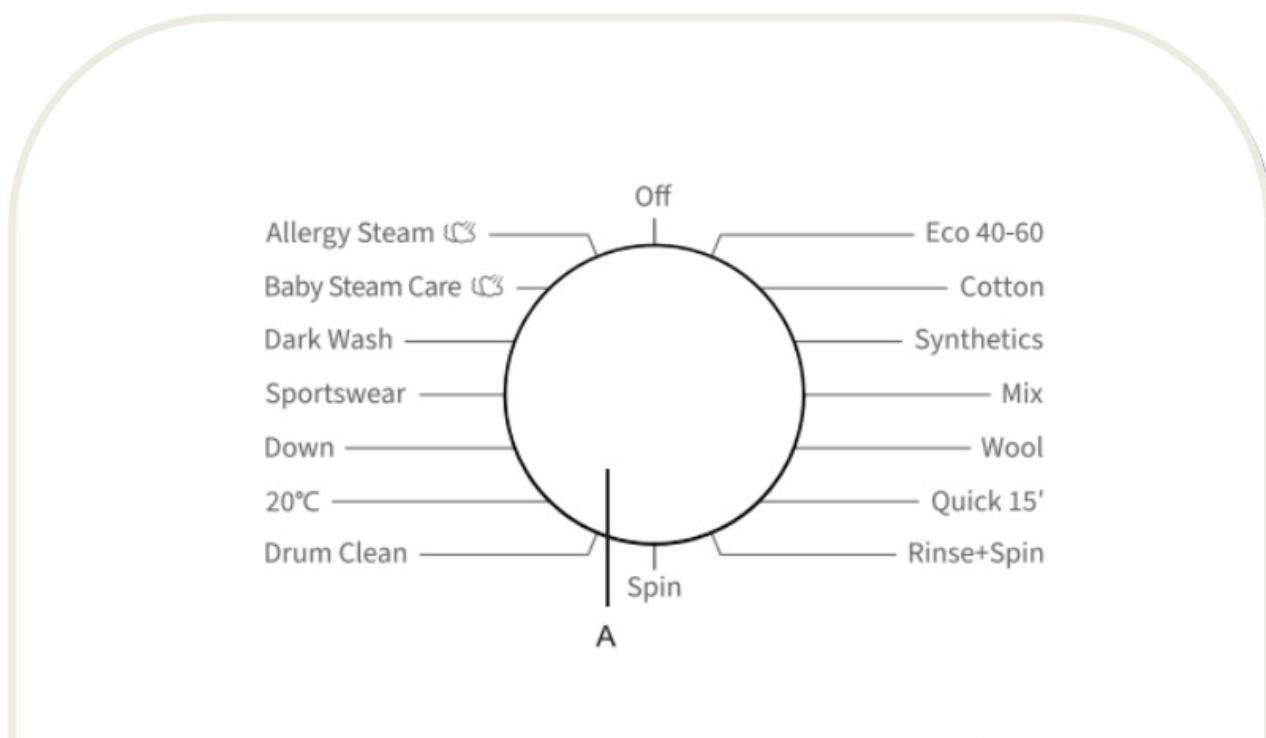





CONTROL PANEL





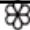



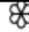

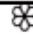
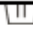
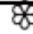
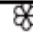





- D. "Spin" button
- E. "Favourite" button
- F. "Options" button
- G. "Delay End" button
- H. "Start/Pause" button
- I. Child Lock Function 
- J. Mute Function 

PROGRAM TABLE

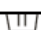
COTTON	
Washing temperature	--, 20°C, 30°C, 40°C, 60°C, 90°C
Maximum dry laundry amount	6 kg
Maximum spin speed (rpm)	1000
Detergent compartment	Required:  Optional: 
Laundry type / descriptions	Heavily and moderately soiled cotton, or linen. For very heavily soiled items select the "Prewash" function.
SYNTHETICS	
Washing temperature	--, 20°C, 30°C, 40°C, 60°C
Maximum dry laundry amount	6 kg
Maximum spin speed (rpm)	1000
Detergent compartment	Required:  Optional: 
Laundry type / descriptions	Programme for lightly to moderately dirty laundry
ECO 40-60	
Washing temperature	-
Maximum dry laundry amount	6 kg
Maximum spin speed (rpm)	1000
Detergent compartment	Required:  Optional: 
Laundry type / descriptions	Normally soiled cotton laundry.
MIX	
Washing temperature	--, 20°C, 30°C, 40°C
Maximum dry laundry amount	3 kg
Maximum spin speed (rpm)	1000
Detergent compartment	Required:  Optional: 
Laundry type / descriptions	Mixed loads of moderately soiled cotton and synthetic fabrics.

WOOL	
Washing temperature	--, 20°C, 30°C, 40°C
Maximum dry laundry amount	2 kg
Maximum spin speed (rpm)	600
Detergent compartment	Required:  Optional: 
Laundry type / descriptions	Machine washable wool. (Refer to the washing label attached to the clothing).
QUICK 15'	
Washing temperature	--, 20°C, 30°C, 40°C
Maximum dry laundry amount	1 kg
Maximum spin speed (rpm)	800
Detergent compartment	Required:  Optional: 
Laundry type / descriptions	Cotton, mixed fabrics. Items worn for a short time or newly bought.
RINSE+SPIN	
Washing temperature	-
Maximum dry laundry amount	7 kg
Maximum spin speed (rpm)	1000
Detergent compartment	Optional: 
Laundry type / descriptions	This program is defaulted to two rinses and spin.
SPIN	
Washing temperature	-
Maximum dry laundry amount	6 kg
Maximum spin speed (rpm)	1000
Detergent compartment	-
Laundry type / descriptions	Select the speed of the spin manually.
DRUM CLEAN	
Washing temperature	90°C
Maximum dry laundry amount	-
Maximum spin speed (rpm)	800
Detergent compartment	Required:  Optional: -
Laundry type / descriptions	Program to remove dirt and bacterial residue that can breed in the machine after it has been used for a period, especially when low temperature washes are used regularly.

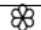
20°C	
Washing temperature	20°C
Maximum dry laundry amount	6 kg
Maximum spin speed (rpm)	1000
Detergent compartment	Required:  Optional: 
Laundry type / descriptions	This program is suitable for cotton clothes with light stain, saving energy.
DOWN	
Washing temperature	--, 20°C, 30°C, 40°C
Maximum dry laundry amount	2 kg
Maximum spin speed (rpm)	600
Detergent compartment	Required:  Optional: 
Laundry type / descriptions	Machine-washable items stuffed with synthetic fibres, such as pillows, quilts and bedspreads; also suitable for items stuffed with down.
SPORTSWEAR	
Washing temperature	--, 20°C, 30°C, 40°C
Maximum dry laundry amount	2 kg
Maximum spin speed (rpm)	1000
Detergent compartment	Required:  Optional: 
Laundry type / descriptions	Sportswear and leisure wear made from microfibre fabrics.
DARK WASH	
Washing temperature	--, 20°C, 30°C, 40°C, 60°C
Maximum dry laundry amount	3 kg
Maximum spin speed (rpm)	1000
Detergent compartment	Required:  Optional: 
Laundry type / descriptions	Dark textiles made of cotton and dark easy-care textiles

BABY STEAM CARE	
Washing temperature	40°C, 60°C, 90°C
Maximum dry laundry amount	2 kg
Maximum spin speed (rpm)	1000
Detergent compartment	Required:  Optional: 
Laundry type / descriptions	It is suitable for baby clothes and underwear, etc., which sterilizes and disinfects through high temperature steam.
ALLERGY STEAM	
Washing temperature	40°C, 60°C
Maximum dry laundry amount	2 kg
Maximum spin speed (rpm)	1000
Detergent compartment	Required:  Optional: 
Laundry type / descriptions	It is suitable for high temperature resistant and less fading fabrics which removes allergens such as pollens, mites and parasites through high temperature steam.

Program instructions

1. The Eco 40-60 programme is able to clean normally soiled cotton laundry declared to be washable at 40°C or 60°C, together in the same cycle, and that this programme is used to assess the compliance with the EU ecodesign legislation.

2. The power consumption of the off mode is 0.49W, and the left-on mode is 0.49W.
3. The most efficient programs in terms of energy consumption are generally those that perform at lower temperatures and longer duration.
4. Loading the household washing machine up to the capacity indicated by the manufacturer for the respective programs will contribute to energy and water savings.
5. Correct use of detergent, softeners and other additives. Do not apply excessive detergent. This may affect the washing results adversely.
6. Periodic cleaning, including optimal frequency and limescale prevention and procedure.
7. Noise and remaining moisture content are influenced by the higher the noise and the lower the remaining moisture content.
8. The product information and the energy consumption label, the product registration information can be obtained by scanning the QR code.

NOTE: Programme duration may change according to the amount of laundry, tap water, ambient temperature and selected additional functions.

Program	Selected temperature	Rated capacity (kg)	Maximum temperature in drum	Program duration (h:min)	Energy consumption (kWh/cycle)	Water consumption (litres/cycle)	Remaining moisture content	Maximum speed reached (rpm)
Eco 40-60 full load		6	40	03:18	0.84	45	61	1000

Eco 4 0-60 half load	–	3	32	02:36	0.45	35	62.3	1000
Eco 4 0-60 1/4 load	–	1.5	25	02:36	0.15	25	61.31	1000
20C	20°C	6	20	01:50	0.17	78	65	1000
Cotton	60°C	6	58	03:49	1.6	78	65	1000
Mix	40°C	3	40	01:58	0.5	50	50	1000
Quick 15'	40°C	1	40	00:30	0.3	17	65	800

The values given for programmes other than the Eco 40-60 programme and the wash cycle are indicative only

PROGRAM OPTIONS

1. PROGRAM START

After you have selected your options and placed detergent with in the detergent dispenser, turn on the water tap and press the “Start/Pause” button. It also displays the remaining program time.

2. AUXILIARY FUNCTIONS

Before starting the programme, you can optionally select an auxiliary function. At standby state, press “Options” button to select additional function for current program. Select only one function for each press, and then corresponding icon flashes. After starting up, program cannot b e changed.

- **SPIN**

The programe defaults to the partial max. spin speed. Press button to select other spin speeds. TE MP.

Each programme is corresponding to its default temperature. If needed, press “Temp.” button to ad just.

- **PREWASH**

Select the function to conduct pre-wash so as to enhance washing effects and better remove stains. This function is suitable for heavy dirt clothes.

Bef ore inflowing, laundry detergent/ washing powder can be added to pre-wash box, and washing powder must be added to main wash box.

- **ETRA RINSE** After set the function of rinsing adding, the program runs the rinsing process once again before running the softening, and the total running time of the program increases accordingly.

3. DELAY END

Delay End function allows to run the machine at the consumers’ convenience, for example, at night when electricity is cheaper. Only under the standby mode, this button is valid for selecting the reservation time.

- After the reservation function is selected, the time will increase 1h when each time the reservation button is pressed. Before reservation, if the program time does not satisfy the integral multiple of 1h, it shall be completed by pressing the reservation key for the first time, an d then the time increases 1h when each time the reservation button is pressed. If the reservation is selected, before the program runs, the current reservation can be canceled by turning the button to

select other programs.

- The delay time must be longer than the wash program length as the delay time is the time program will finish. For example: if the selected program time is 02:28, the delay time selected must be between 03:00 and 24:00.
- When the reservation process is operated, the icon of 'reservation time' will be on. When the reservation process is finished, the icon of 'reservation time' will be off, while the icon of the 'remaining time' will be on.

4. TO CANCEL THE PROGRAM OR RESELECT THE OPTIONS

Rotate the program to "Off" for 3 seconds to turn off the machine.

Select the new program and options.

Press "Start / Pause" button to turn on the machine without adding any extra detergent.

5. PROGRAMME END

The washing machine shows "End" at the end of the program, when the door is unlocked. If the knob is turned to "Off", the power will be cut off. If there is no button or knob operation within 2 minutes, the program will automatically power off .

6. DOOR LOCK

After the program starts the Door Lock icon will light up and the door will be locked.

After completing program, door lock unlocks automatically. During pause, if door opening condition can be met halfway, the door lock will unlock and its indicator light will go out. When door lock indicator light flashes, door shall not be opened forcibly so as to avoid personal injury

7. CHILD LOCK

To strengthen the safety of children, this machine is equipped with Child Lock function.

When the programme starts, press "Temp.+Spin"button for 2 seconds.

The machine will beep once. Scree will show "SAFE On". After 2 seconds, the screen will show the program left time. Repeat this operation, the machine will beep once.

The screen will show "SAFE OFF", the Child Lock will be released. When the Child Lock is set, all function buttons except "Off" will be shielded. Once any function except "Off" is chosen, the machine will beep.

The screen will show "SAFE On" for 2 seconds. After the program ends, Child lock function will release automatically. Any error alarm will release the Child Lock function. Turn off and on the machine manually will reset the machine.

Child Lock function cannot be set when the machine is in standby state.

8. **Mute function**

Press “Spin” and “Favourite” buttons simultaneously for 2 seconds. The display will show “bEEp oFF”. All the buzzing will be turned off except the error alarm. When the machine is in the mute state, repeat the same process: the screen will show “bEEp on”. All the buzzing will be activated. The Mute function will continue to take effect before you turn it down manually

9. **FAVOURITE**

After selecting the program and setting each parameter and starting, long press the Favorite key for 3s to memorize the selected program, temperature, rotational speed and other related settings, and then the Favorite symbol lamp will be on.

Under the circumstance that the Favorite lamp is not on, short press the Favorite key, then the program will be switched to the program memorized last time; and meantime, the temperature, rotational speed and other parameters will automatically change into the parameters memorized last time.

At this moment, if switching the program or pressing other keys, the panel will display a new program and parameters, and the Favorite symbol lamp will be off. When the user uses it for the first time, if he/she has never long pressed the Favorite key to collect programs, he/she can short press the Favorite key and then the cotton linen program and its default settings will be collected by default.

CLEANING AND MAINTENANCE

Appliance exterior and control panel

- Can be washed down with a soft, damp cloth.
- A little neutral detergent (non-abrasive) can also be used.
- Dry with a soft cloth.

Door seal

- Clean with a damp cloth when necessary
- Check the condition of the door seal periodically.

Detergent dispenser

1. Press the siphon cap in the softener compartment and remove the drawer (fig. E)
2. Remove siphon cap from the fabric softener compartment (fig. "F").
3. Wash all the parts under running water.
4. Refit the siphon cap in the detergent drawer and fit the drawer back inside its housing

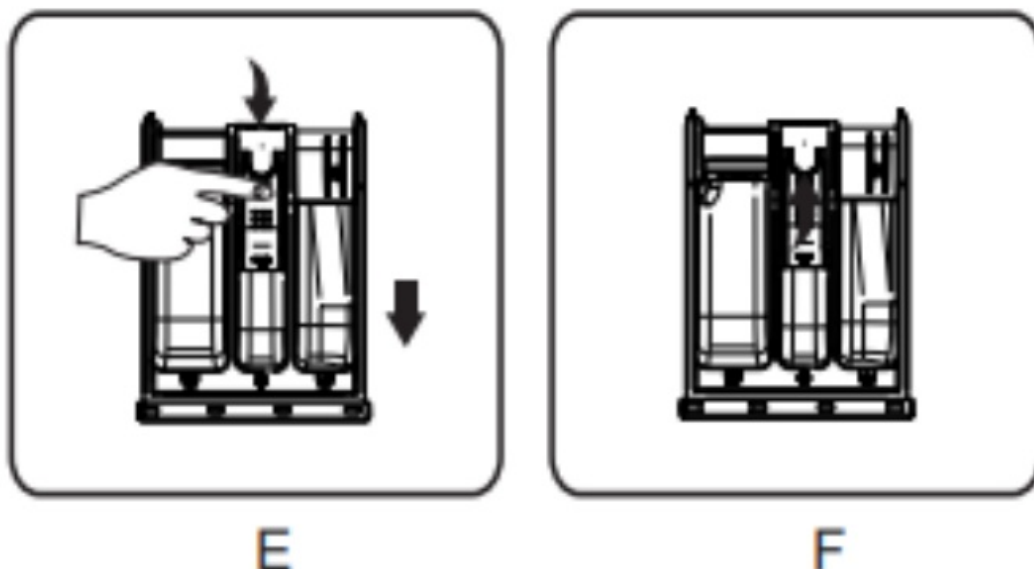

Filter

We recommend that you check and clean the filter regularly, at least two or three times a year. Especially:

- If the appliance is not draining properly or if it fails to perform spin cycles.
- If the pump is blocked by a foreign body (e.g. buttons, coins or safety pins).

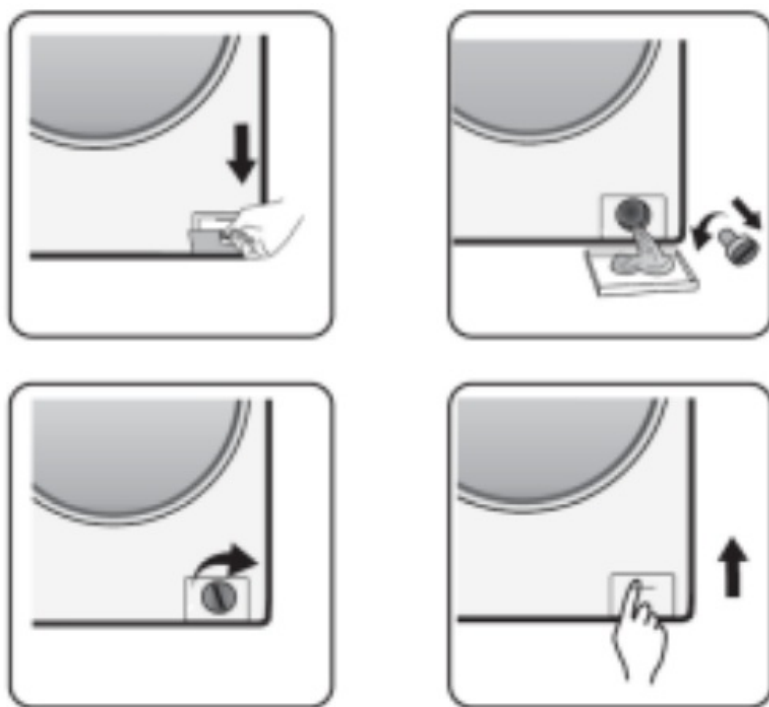

Important: Ensure that the water has cooled before draining the appliance.

1. Stop the appliance and unplug it.
2. Depending on the model, remove the plinth by holding it tightly on both sides, pushing it downward and tilting it to the front. Or, push down on the tabs provided on both the sides and remove it.
3. Place a container beneath it.
4. Open the filter but do not remove it completely. Slowly turn the filter counterclockwise until the water begins to drain out.
5. Wait until all the water has drained.
6. Now unscrew the filter completely and remove it.
7. Clean the filter and the filter chamber.
8. Check that the pump rotor moves freely.
9. Re-insert the filter and screw it in clockwise as far as it will go.
10. Reinstall the plinth.
11. Plug in the appliance once again.
12. Select a program and start it.

Water supply hose

Check the supply hose regularly for brittleness and cracks and replace it if necessary, using a new hose of the same type.

Mesh filter for water connection

Check and clean regularly. For washing machines with an inlet hose as shown on picture “D”



1. Close the tap and loosen the inlet hose on the tap.
2. Clean the internal mesh filter and screw the water inlet hose back onto the tap.
3. Now unscrew the inlet hose on the rear of the washing machine.
4. Pull off the mesh filter from the washing machine connection with universal pliers and clean it.
5. Refit the mesh filter and screw the inlet hose on again.
6. Turn on the tap and ensure that the connections are completely watertight.

TROUBLESHOOTING

Depending on the model, your washing machine is equipped with various automatic safety functions. This enables faults to be detected in good time and the safety system can then react appropriately. These faults are frequently so minor that they can be resolved within a few minutes.

The washing machine will not start, no indicator lamps are on.

Check whether:

- the mains plug is inserted into the socket.
- the wall socket is functioning correctly (use a table lamp or similar appliance to test it).

The washing machine will not start... and the “Start/Pause” indicator lamp flashes.

Check whether:

- the door is properly closed (child safety);
- the “Start/Pause” button has been pressed;
- the “Water tap closed” indication lights up. Open the water tap and press the “Start/Pause” button.

The appliance stops during the programme (varies depending on model)

Check whether:

- the door has been opened and the “Start/Pause” indicator lamp is flashing. Close the door and press the “Start/Pause” button again.
- check if there is too much foam inside, machine enters kill-foam routine. The machine will run again automatically after a period.
- the washing machine’s safety system has been activated (see “Fault description table”).

Residue from detergent and additives left in the detergent drawer at end of wash.

Check whether:

- the cover grid of the softener chamber and the separator of the main wash chamber are correctly installed in the detergent dispenser and all parts are clean
- sufficient water is entering. The mesh filters of the water supply could be blocked
- the position of the separator in the main wash chamber is adapted to the use of powder or liquid detergent

Machine vibrates during spin cycle.

Check whether:

- the washing machine is level and standing firmly on all four feet;
- the transport bolts have been removed. Before using the machine, it is imperative that the transport bolts are removed.

Final spin results are poor.

The washing machine has an imbalance detection and correction system. If individual heavy items are loaded (e.g. bathrobes), this system may reduce the spin speed automatically or even interrupt the spin completely if it detects too great an imbalance even after several spin starts, in order to protect the washing machine.

- If the laundry is still too wet at the end of the cycle, remove some articles of laundry and repeat the spin cycle.
- Excessive foam formation may prevent spinning. Use the correct amount of detergent.
- Check that the spin speed selector has not been set to " ".

ERROR CODE

F01 displayed on screen

The machine is not fed with water or insufficient water. Check:

- Faucet is fully open and has enough water pressure
- Water inlet pipe is knotted or not
- Filtering net of water inlet pipe is blocked or not (refer to maintenance and repair).
- Water pipe is frozen or not
- Press "Start/Pause" key after fault is removed. If fault occurs again, please contact the authorized service.

F03 displayed on screen

The washer is not emptied. The washer stops the program being executed. Shut down the machine and disconnect power supply. Check:

- Drainpipe is knotted or not.
- Filter in drain pump is blocked or not (refer to the cleaning of filter in drain pump).
Important: Ensure that the water has cooled before draining the appliance.
- The drain hose is frozen up.
- Plug in the appliance again.
- Select and start the "Spin" programme or push the "Start/Pause" button for at least 3 seconds and restart the desired programme.
- If the fault occurs again, please contact the authorized service.

If fault code “F13” is shown

Door lock is abnormal. Start program for 20 sec and unlock the washer door (PTC) to check whether the door is closed.

Open or close it again. After fault is removed, press “Start/Pause” key.

If fault occurs again, disconnect power supply and contact the authorized service.

If fault code “F14” is shown

Door open fault.

Action: Press “Start/Pause” button. The washing machine will try to open the door. The alarm will not be removed until the door is unlocked. Or, turn the nub to Off for 3 seconds to turn off the machine. Choose the desired programme to start the machine. The alarm will be removed.

If fault code “F24” is shown

Water level reaches overflow level.

Remove it by pressing “Start/Pause” key and feed water.

Select and start required program. If fault occurs again, disconnect power supply and contact the authorized service.

If else fault code “F04” , “F05”, “F06”, “F07”, “F23” is shown

Electronic module fails

Turn the nub to Off for 3 seconds to turn off the machine.

After fault is removed, press “Start/Pause” key.

If fault occurs again, disconnect power supply and contact the authorized service.

If fault code “Unb” is shown

Unbalance alarm shall be solved by the following methods

1. Laundry winding

Turn the knob to “off” for 3 seconds for shutdown, open the door, shake the clothes and put them back into the washing machine, then select the single dewatering program to dry again.

2. Too light-weighted laundry

Turn the knob to “off” for 3 seconds for shutdown, open the door, put in one or two towels, and then select the single dewatering program to dry again.

Before contacting the authorized service

1. Try to remedy the problem yourself (see Troubleshooting)
2. Restart the program to check whether the problem has solved itself.
3. If the washing machine continues to function incorrectly, call the authorized service



Environment friendly disposal

You can help protect the environment!

Please remember to respect the local regulations: hand in the non-working electrical equipment's to an appropriate waste disposal center.



HEINNER is a registered trademark of Network One Distribution SRL.

Other brands and product names are trademarks or registered trademarks of their respective holders.

No part of the specifications may be reproduced in any form or by any means or used to make any derivative such as translation, transformation, or adaptation without permission from NETWORK ONE DISTRIBUTION.

Copyright © 2013 Network One Distribution. All rights reserved.

www.heinner.com, <http://www.nod.ro>

<http://www.heinner.com>, <http://www.nod.ro>



This product is in conformity with norms and standards of European Community

Importer: Network One Distribution

Marcel Iancu Street, 3-5, Bucharest, Romania

Tel: +40 21 211 18 56, www.heinner.com , www.nod.ro

Frequently Asked Questions

• **Q: How do I ensure proper installation of the washing machine?**

A: Follow the installation steps provided in the manual, including removing transportation screws, loosening transportation safety screws, and installing the transportation bolt cover for safety and noise reduction.

• **Q: What precautions should I take during operation to prevent hazards?**

A: Avoid touching hot surfaces, keep inflammable liquids away, remove objects from laundry pockets, check water flow for discharge hose, ensure hose stability, and follow child safety guidelines.

Documents / Resources

	<p>HEINNER HWM-H6010IVSMC+++ Automatic Washing Machine [pdf] Use r Manual</p> <p>HWM-H6010IVSMC, HWM-H6010IVSMC Automatic Washing Machine, HWM-H6010IVSMC, Automatic Washing Machine, Washing Machine, Machine</p>
--	--

References

- [User Manual](#)

HEINNER

Automatic Washing Machine, HEINNER, HWM-H6010IVSMC, HWM-H6010IVSMC Automatic Washing Machine, Machine, Washing Machine

Leave a comment

Your email address will not be published. Required fields are marked *

Comment *

Name

Email

Website

☐ Save my name, email, and website in this browser for the next time I comment.

Post Comment

Search:

e.g. whirlpool wrf535swhz

Search

[Manuals+](#) | [Upload](#) | [Deep Search](#) | [Privacy Policy](#) | [@manuals.plus](#) | [YouTube](#)

This website is an independent publication and is neither affiliated with nor endorsed by any of the trademark owners. The "Bluetooth®" word mark and logos are registered trademarks owned by Bluetooth SIG, Inc. The "Wi-Fi®" word mark and logos are registered trademarks owned by the Wi-Fi Alliance. Any use of these marks on this website does not imply any affiliation with or endorsement.