

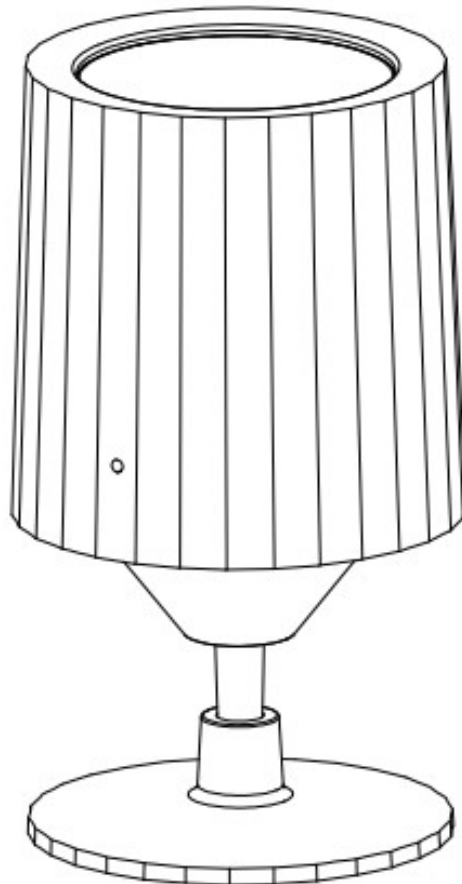

Heiman Technology M317-1Ever1.1 Smart Motion Sensor User Manual

[Home](#) » [Heiman Technology](#) » Heiman Technology M317-1Ever1.1 Smart Motion Sensor User Manual 



**Smart Motion Sensor
User Manual
M317-1Ever1.1**

*Please read the user manual carefully before operation.

The guide picture is for reference only, please in kind prevail.

Contents

- 1 [Product Introduction](#)
- 2 [Illustrations](#)
- 3 [Technical parameters](#)
- 4 [Networking](#)
- 5 [Visual indication](#)
- 6 [Working status instructions](#)
- 7 [Installation](#)
- 8 [Detection area](#)
- 9 [Installation instructions](#)
- 10 [Battery replacement](#)
- 11 [Statement](#)
- 12 [Documents / Resources](#)
 - 12.1 [References](#)

Product Introduction

This smart motion sensor, equipped with automatic valve adjustment technology and automatic temperature compensation technology, so the sensor stability is greatly enhanced, which can effectively prevent the sensor from false alarm and sensor sensitivity reduction caused by temperature changes.

It based on the Thread wireless communication protocol, featured by high security and intelligent linkage characteristics. Once the sensor detects someone moving, it will send a real time alarm message will be sent to user APP through the cloud server.

Illustrations

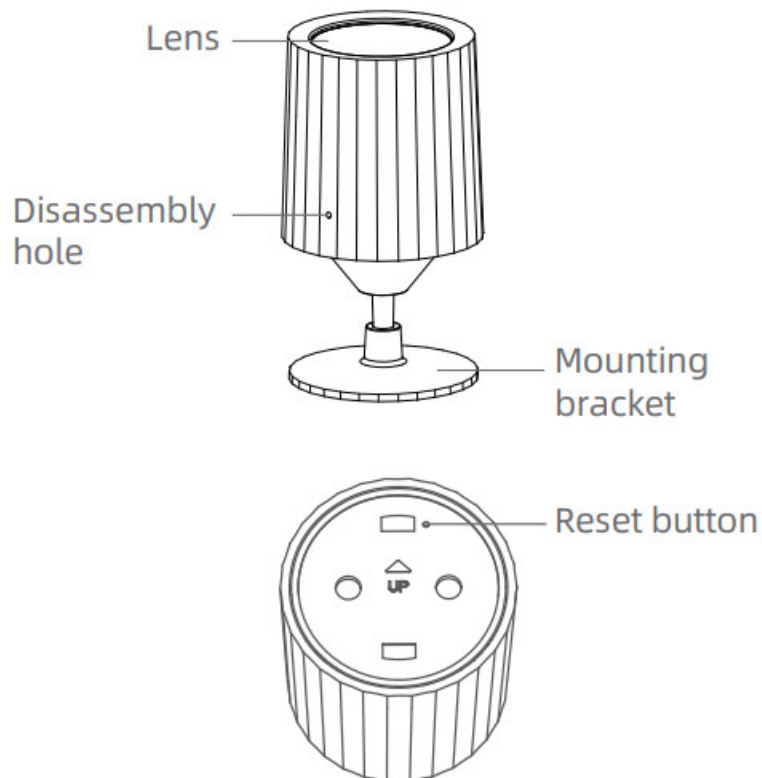

Technical parameters

Working voltage	DC 3V (CR2)	
Wireless protocols	Thread, BLE	
Wireless distance	570m(in the open area indoors)	
Installation mode	Wall mounting	Ceiling mounting
Detection angel	110°	360°
Mounting height	1.5m	2.8m
Detection distance	57m(25°C)	
Illuminance detection range	0-1200Lux	
Working temperature	-10°C – +55°C	
Working humidity	595%(no condensation)	
Dimensions	c42xH43mm(mounting bracket not included)	

Networking

1. Please make sure you have a Matter-compatible app and a Matter-compatible Thread Border Router.
2. Unplug the battery insulation sheet to power up the device, The green LED indicator will flash quickly (5 times/second), indicating the device has entered networking status.

Notes: if green LED indicator does not flash, try to press reset button for 5s till the green LED indicator flashes quickly, indicating the device has entered networking status.

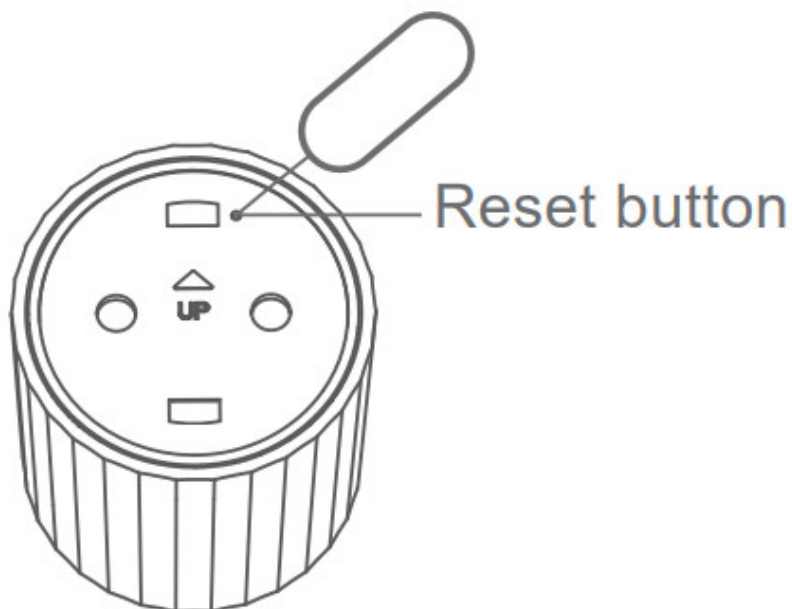

3. Open the Matter-compatible app and click the corresponding 'Add device' button. Then scan the Matter QR setup code in the manual or on the product to add the device to the app.
4. If networking inclusion is successful, the green LED indicator will be on for 3s and then goes off. If networking inclusion fails, the green LED indicator will flash slowly about 3s (twice/second).

Note: Press reset button again during networking status will stop networking process and green LED will flash slowly for 3s (twice/second) and go off.



Tips

Due to the APP upgrade and update, this guideline may be slightly different from the actual operation, please follow the instructions in the APP. The user could upgraded to the official latest software version to have a better user experience.

Visual indication

LED	Status
Red LED	In warm-up status, flashes for 30 seconds.
	Flashes for 1 second if someone moving is detected.
Green LED	Flashes quickly (5 times/second) during network inclusion status.
	Keeps on for 3 seconds and then goes off when networking is done.
	Flashes slowly for 3 seconds (twice/second) and then goes off if network inclusion fails.

Working status instructions

Warm-up status: after powered on, the sensor will enter warm-up status for 30 seconds, red LED flashes once per second.

Test status: the sensor will enter test status for about 20 minutes after warm-up period ends. In test status, when someone moving is detected, red LED will be on for about 1 second, and meanwhile “someone is moving” is reported to user APP, if it detects continuous human movement, red LED is on once/5 seconds, only if the sensor determines that no one is moving and it last for 1 minute, “No one moves” will be reported to user APP.

Power saving mode: the sensor will enter power saving mode at the end of the test mode. Power saving mode is also the sensor’s long-term working mode. In power saving mode, when someone moving is detected, red LED will be on for about 1 second, and meanwhile “someone is moving” is reported to user APP.

If it detects continuous human movement, neither the indicator LED nor the APP will alert someone moving is detected. Only after “no one moves” is reported, will the alert function be recovered.

The condition “no one moves” is reported is that the sensor determines that no one moves for a certain period of time, default value is 1 minute.

Installation

- Installation locations to avoid:

It’s forbidden to install the sensor where there is direct exposure to sunshine, under rotatable objects, near the air-conditioner or heat source, pets may touch or outdoors.

- Installation surface should be solid without vibration.
- Recommended installation locations:
- Install the sensor where intruder may pass by.

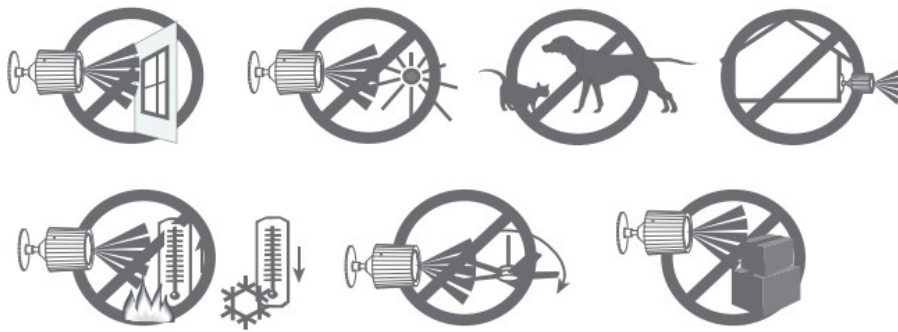

Detection area

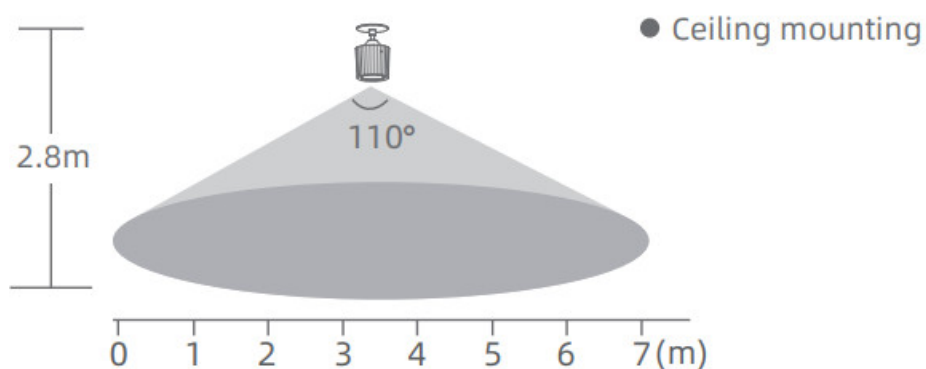
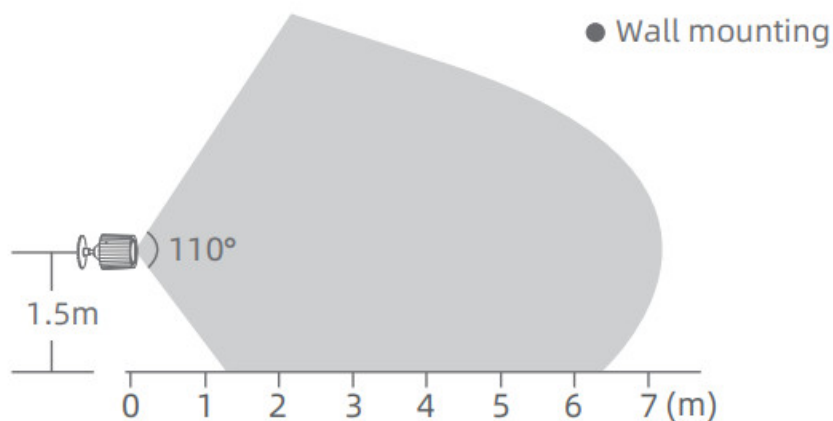

Installation instructions

Method 1:

Attach the sensor to user chosen installation place by double-sided adhesive tape.

Notes: for wall mounting, pay attention to the “ UP” icon on the bottom cover is upward.

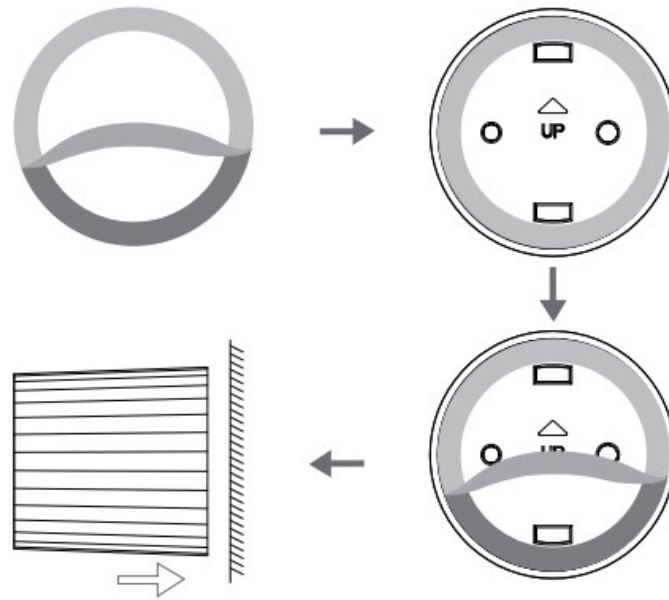



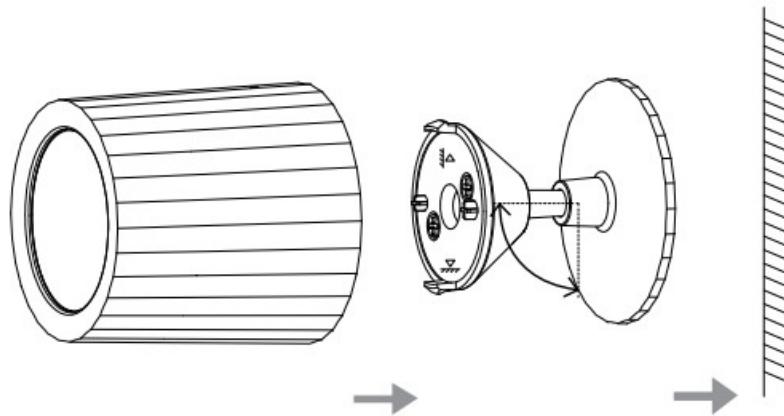

Method 2:

Attach the mounting bracket to the user chosen installation place by double-sided adhesive tape.

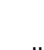

Notes:

- For wall mounting, “” icon on the mounting bracket should be upward. Align “” icon on the bottom cover and “” icon on the mounting bracket to lock them in place.
- For ceiling mounting, align “” icon on the bottom cover and “” icon on the mounting bracket to lock them in place.

Attention

- Make sure the installation surface is smooth, flat, stable, dry and clean.
- After installation, check if the sensor is installed firmly on the installation surface regularly.

Battery replacement

- Press the disassembly hole by the pin key, remove the bottom cover from the sensor body.

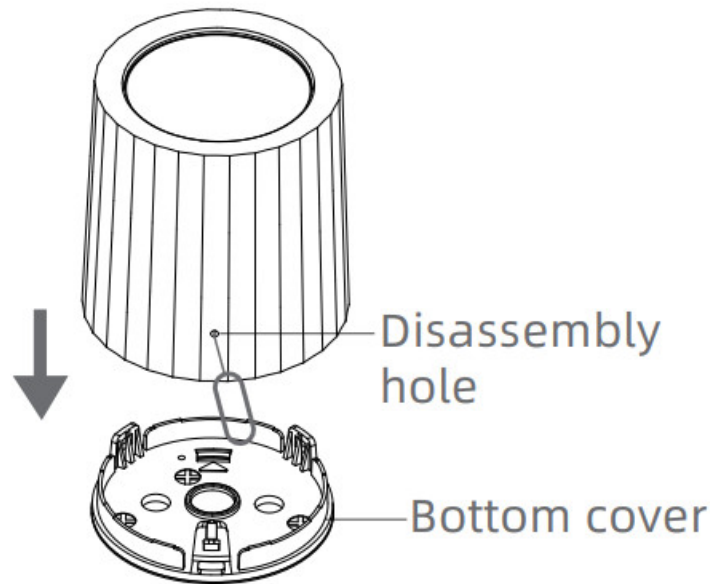

- Pay attention to the positive and negative electrode of the battery while replacing the battery. When the bottom cover is installed, please align the arrow icons shown as below. Dispose of used batteries in an environmental friendly way.

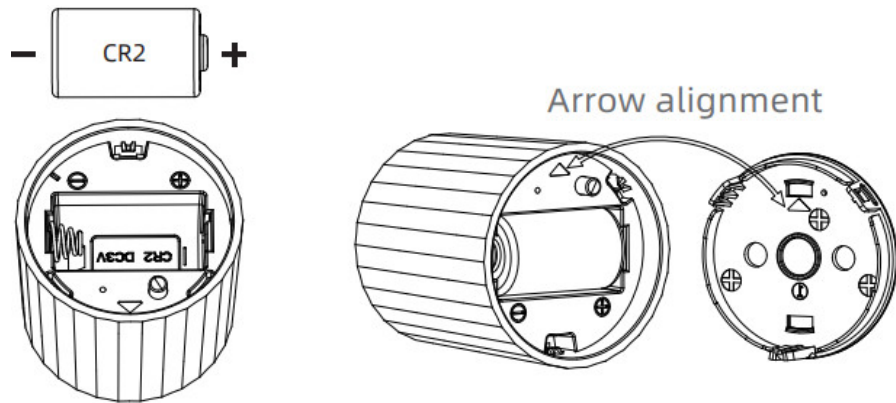

Statement

The information in the user manual is for reference only and does not constitute any form of commitment. Without the written permission of the manufacturer, any individual or organization shall not extract or copy part or all of the contents of this user manual, and shall not spread it in any form. As the technology is constantly updated, the manufacturer reserves the right to modify the user manual without prior notice. If the user manual and the actual operations is inconsistent, please refer to the actual operations and the final interpretation is reserved to the manufacturer herein.



Documents / Resources

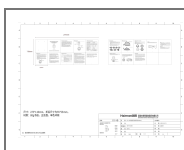

[Heiman Technology M317-1Ever1.1 Smart Motion Sensor](#) [pdf] User Manual
M317-1Ever1.1, M317-1Ever1.1 Smart Motion Sensor, Smart Motion Sensor, Motion Sensor, Sensor

References

- [User Manual](#)

Manuals+, **Privacy Policy**

This website is an independent publication and is neither affiliated with nor endorsed by any of the trademark owners. The "Bluetooth®" word mark and logos are registered trademarks owned by Bluetooth SIG, Inc. The "Wi-Fi®" word mark and logos are registered trademarks owned by the Wi-Fi Alliance. Any use of these marks on this website does not imply any affiliation with or endorsement.