

HEDD 20 MK2 Heinz Electro dynamic User Manual

[Home](#) » [HEDD](#) » HEDD 20 MK2 Heinz Electro dynamic User Manual 

Contents

- [1 HEDD 20 MK2 Heinz Electro dynamic](#)
- [2 Documents / Resources](#)
- [3 Related Posts](#)

HEDD

HEDD 20 MK2 Heinz Electro dynamic

HEDD-20-MK2-Heinz-Electro-dynamic-PRODUCT-IMAGE

How to connect two HEDD TYPE MK2 monitors with a DAC or pre-amp

1. Connect the right analog XLR signal into the ANALOG IN of the right speaker. Do the same for the left signal path.
2. Set the ANALOG/AES rotary switch on both speakers to ANALOG.
3. We recommend setting VOL. [dB] on both speakers to +12 for the highest possible headroom. Reduce INP. SENS. [dB] if necessary.

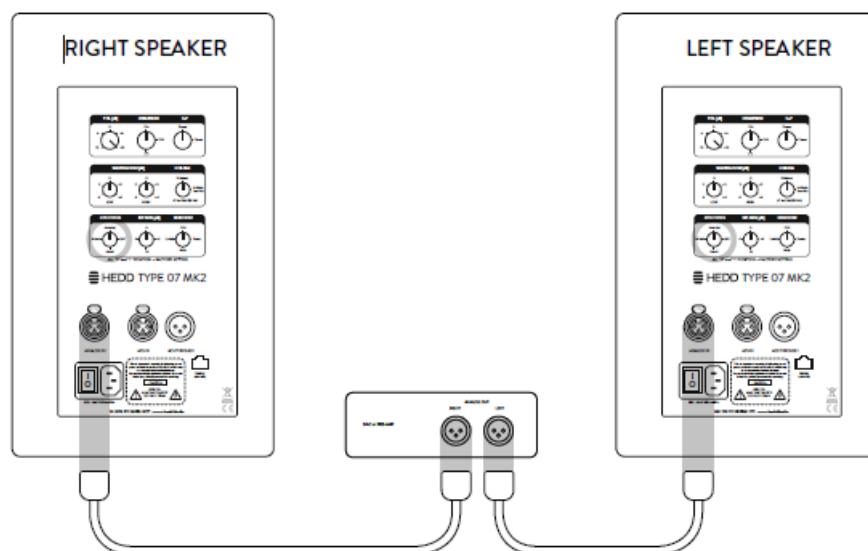

How to connect the BASS subwoofer and two TYPE MK2 satellites with a DAC or pre-amp

1. Connect the both left and right analog XLR signals into the ANALOG INPUTS of the subwoofer.
2. Set the ANALOG/AES rotary switch on the BASS to ANALOG.
3. Connect the satellites via balanced analog XLR connections and make sure the ANALOG/AES rotary switch is set to ANALOG on both satellites.
4. Change the LF RANGE on both speakers to select the FOR SUB (80 Hz) setting.
5. Adjust the VOL. [dB] settings on the satellites according to the table below for a neutral setting. Individual adjustments might be necessary depending on room behavior and placement of the speakers.
6. We recommend setting VOL. [dB] on the BASS to +12 for the highest possible headroom. Reduce INP. SENS. [dB] if necessary.

Recommended Vol. Setting	BASS 08	BASS 12
TYPE 05 MK2	+3 dB	+6 dB
TYPE 07 MK2	+3 dB	+6 dB
TYPE 20 MK2	-3 dB	0
TYPE 30 MK2	-3 dB	0

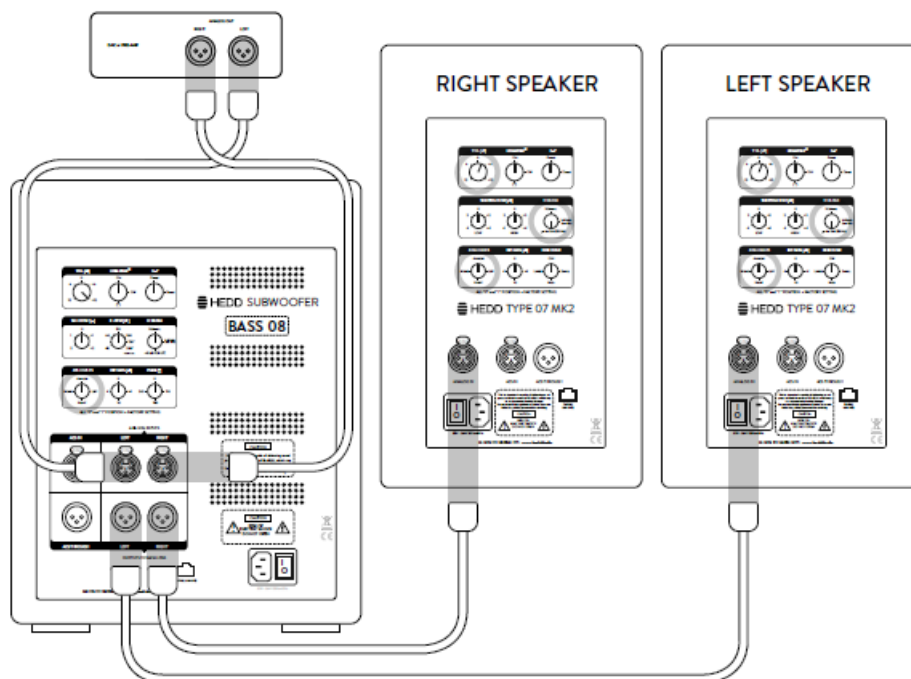

How to connect two HEDD BASS subwoofers and two HEDD TYPE MK2 satellites with a DAC or pre-amp

1. Connect the right analog XLR signal into the right ANALOG INPUT of the first subwoofer. Do the same for the left analog XLR signal and connect it into the left ANALOG INPUT of the second subwoofer.
2. Set the ANALOG/AES rotary switch on both BASS to ANALOG.
3. Connect the right satellite via balanced analog XLR connection and make sure the ANALOG/AES rotary switch is set to ANALOG. Do the same for the second BASS with the left signal path and connect it via analog XLR into the left speaker.
4. Change the LF RANGE on both speakers to select the FOR SUB (80 Hz) setting.
5. Adjust the VOL. [dB] settings on the satellites according to the table below for a neutral setting. Individual adjustments might be necessary depending on room behavior and placement of the speakers.
6. We recommend setting VOL. [dB] on both subwoofers to +12 for the highest possible headroom. Reduce INP. SENS. [dB] if necessary.

Recommended Vol. Setting	BASS 08	BASS 12
TYPE 05 MK2	+3 dB	+6 dB
TYPE 07 MK2	+3 dB	+6 dB
TYPE 20 MK2	-3 dB	0
TYPE 30 MK2	-3 dB	0

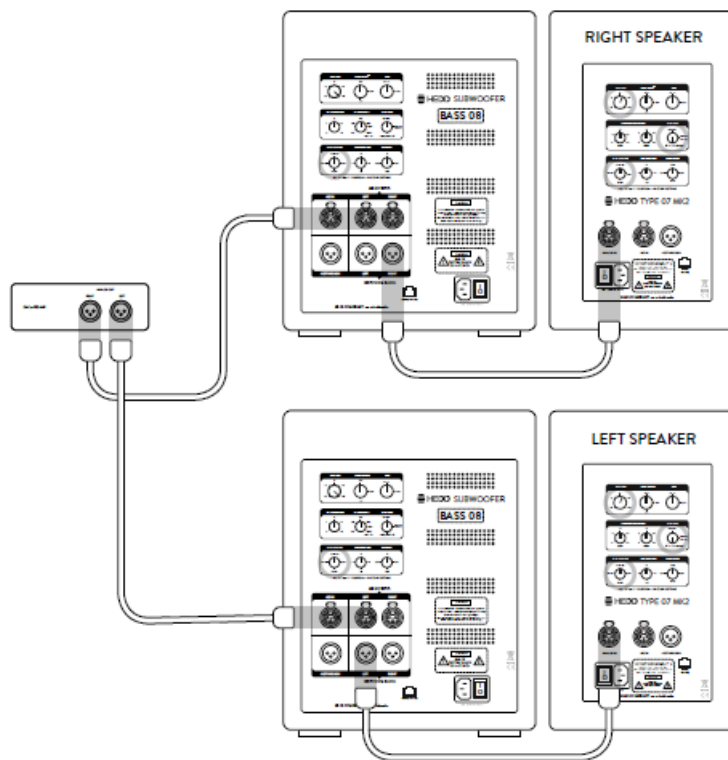

Documents / Resources

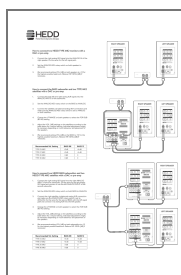

[HEDD 20 MK2 Heinz Electro dynamic](#) [pdf] User Manual
 20 MK2 Heinz Electro dynamic, Heinz Electro dynamic, Electro dynamic