



# HeathZenith 18000145 Wireless Push Button Instruction Manual

[Home](#) » [HeathZenith](#) » HeathZenith 18000145 Wireless Push Button Instruction Manual 

## Contents

- [1 HeathZenith 18000145 Wireless Push Button](#)
- [2 Product Information](#)
- [3 Safety Information](#)
- [4 Package Contents](#)
- [5 INSTALLATION](#)
- [6 SYNCING THE PUSH-BUTTON AND DOORBELL](#)
- [7 Troubleshooting](#)
- [8 Product Usage Instructions](#)
- [9 Mounting the Push-Button](#)
- [10 Low Battery Notification](#)
- [11 Frequently Asked Questions \(FAQ\)](#)
- [12 FCC STATEMENT](#)
- [13 Documents / Resources](#)
  - [13.1 References](#)
- [14 Related Posts](#)

***HeathZenith®***

**HeathZenith 18000145 Wireless Push Button**



## Product Information

### Specifications

- **Model:** 18000145 18000146
- **Product:** Wireless Push Button
- **Battery Type:** CR2032
- **Operating Distance:** 100M or 12E code
- **Mounting Options:** Screws or double-sided tape

### Safety Information

**WARNING:** To prevent possible SERIOUS INJURY or DEATH, never allow small children near batteries. If a battery is swallowed, seek immediate medical attention.

- Do not dispose of batteries in fire. Batteries may explode or leak.

### Package Contents

- 1x – Push-Button
- 2x – Screws
- 1x – CR2032 battery

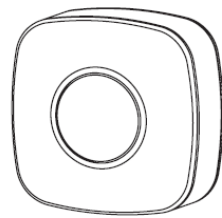

1x - Push-Button



2x - Screws



1x - Double-sided tape



1x- CR2032 battery

## INSTALLATION

### INSTALLING THE BATTERY TO PUSH-BUTTON

- Rotate the battery cover and remove it.
- Insert the battery according to the direction shown in the figure, with the positive pole facing outward and the negative pole facing inward.

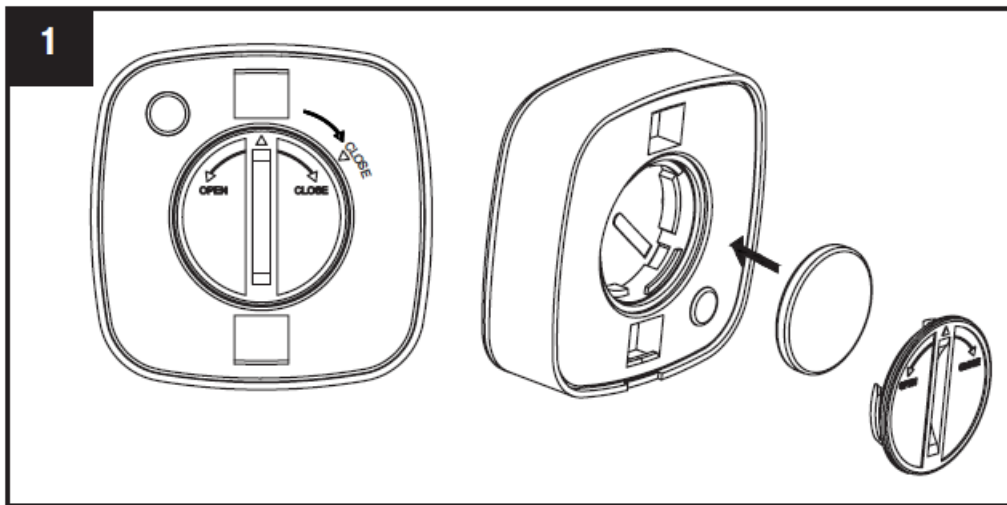

### PUSH-BUTTON CODE CONVERSION

#### Code conversion

- Push-button and doorbell default code pattern: 12E & Front door.
  - There is no need to convert the code for the first time using.
  - Press the silicone button in the back for 3 seconds, the indicator light of the push-button will flash 3 times. It indicates the push-button has been converted to 100M code.
  - Press the silicone button in the back for 3 seconds, the indicator light of the push-button will flash quickly once, it indicates the push-button has been converted to the 12E code.
  - Press the silicone button in the back for 3 seconds, the code can be converted between 100M and 12E.
- NOTE:** Only if the code of the push-button and doorbell is consistent, the push-button and doorbell will be working properly. Front door and rear door code conversion
- Press the silicone button in the back for 1 second and release, push-button will be converted between front

door and rear door.

### The indicator light displays in the following ways:

- **12E Front door:** The indicator light will flash quickly once.
- **12E Rear door:** The indicator light stays on for about 3 seconds. 100M Front door: The indicator light will flash slowly for about 3 seconds.
- **100M Rear door:** The indicator light will flash quickly for about 3 seconds.

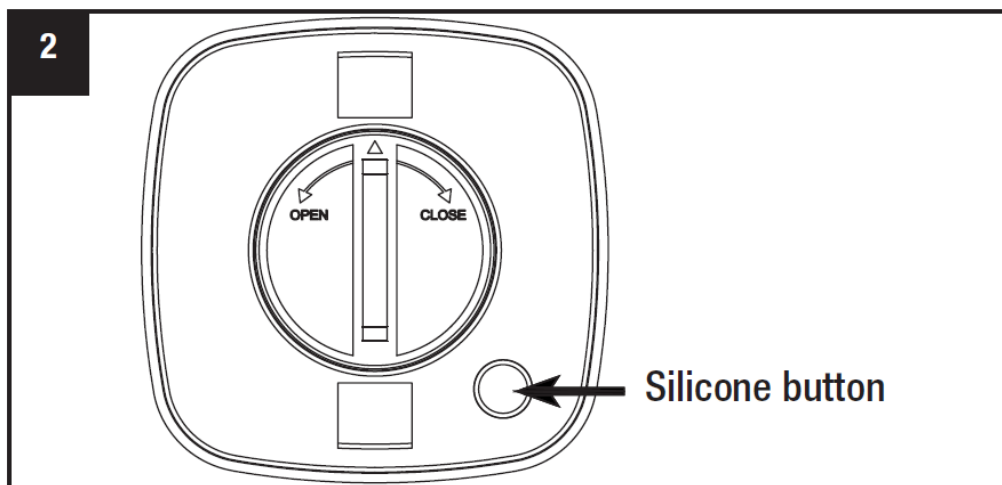

**NOTE:** Push-button default pattern is front door. While the desired tune is playing, press the push-button to lock in selected tune. If the push-button is in rear door pattern, the doorbell will only ring as “Ding”.

- push-button default pattern is 12E front door, may need to convert the code type based on the type of doorbell. When set to the front door you can use Sync/Music button of doorbell to set different tunes, when set to the rear door, the doorbell will only play Ding.

### SYNCING THE PUSH-BUTTON AND DOORBELL

- Press and hold the “SYNC” or “FUNCTION” button on the doorbell until the doorbell sounds a “beep-beep”.
- Press the push-button within 10 seconds. The doorbell will prompt a “Beep-Beep” tone to indicate the push-button is synced.
- Press the push-button to ensure operation.

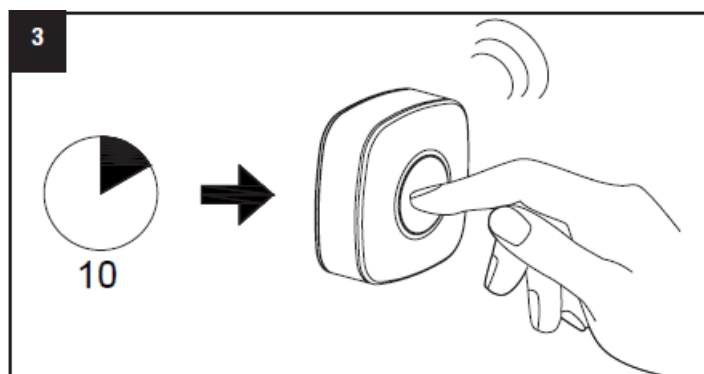

### TESTING THE PUSH-BUTTON AND DOORBELL

- Temporarily position the push-button where it will be mounted.
- Press the push-button to verify the doorbell and push-button work properly.
- If the doorbell does not sound, move the doorbell closer to the push-button and test again.

**NOTE:** Do not permanently mount the push-button until the push-button and doorbell are working properly.

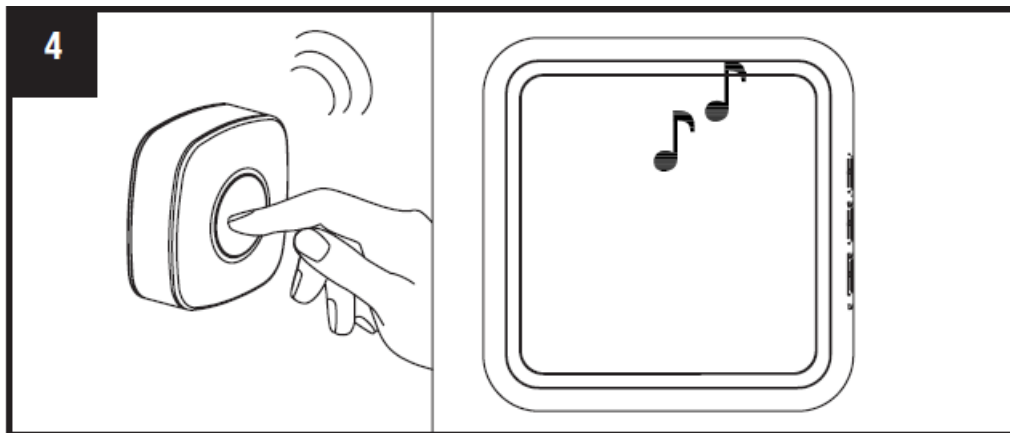

## Troubleshooting

To ensure operation, both the push-button and doorbell need to be in the same code (100M or 12E). Refer to Installation step 2 for more information. Please call 1-888-543-1388 for assistance in changing the codes to work with the existing chimes.

### PROBLEM #1

- The doorbell does not sound.

#### POSSIBLE CAUSE:

- The batteries are not installed correctly.
- The batteries are dead.
- The push-button and doorbell are not synced.
- The code of push-button doesn't match the code of doorbell.

#### SOLUTION:

- Make sure the batteries are installed according to the diagram inside the push-button and doorbell (not included).
- Check the charge of the push-button and doorbell batteries and replace them if necessary.
- Sync the push-button and doorbell:
- Press and hold the "Sync/Music" button on the doorbell until the doorbell prompts a "Beep-Beep".
- Press the push-button within 10 seconds. The doorbell will prompt a "Beep-Beep" tone to indicate the push-button is synced.
- Press the push-button to ensure operation.

Ensure the code of the push-button matches the code of the doorbell. To ensure operation, they will both need to

be in 100M or 12E code. Refer to Installation step 2 for more information. Please call 1-888-543-1388 for assistance in changing the codes to work with the existing chimes.

## **PROBLEM #2**

- The batteries seem okay, but the doorbell does not work after installation.

### **POSSIBLE CAUSE:**

- Doorbell or push-button is mounted on metal or near metal studs.
- Doorbell is mounted near a concrete floor or wall.
- Doorbell and push-button are installed too far apart.

### **SOLUTION:**

- Metal reduces transmission range. Use 1/4 in. to 1/2 in. (6 to 13 mm) wood shims to move the doorbell or push-button away from the metal surface.
- Concrete may reduce range. Move the doorbell away from the concrete surface.
- Locate the doorbell closer to the push-button.

## **Product Usage Instructions**

### **Front Door and Rear Door Code Conversion**

1. Ensure that the code of the push-button and doorbell is consistent for proper operation.
2. Press and hold the silicone button on the push-button until the indicator light flashes 3 times. This indicates that the push-button has been converted to the selected code (100M or 12E).

### **Mounting the Push-Button**

Use either screws or double-sided tape to mount the push-button.

- **Option 1:** Screw Mounting – Use the provided screws to securely attach the push-button to the desired location.
- **Option 2:** Tape Mounting – Use double-sided tape to attach the push-button to the desired location.
- To mount with screw, remove the back of the push-button by pushing in the tab on the bottom with a small screwdriver. Place the push-button back on the door jamb and mark the two screw holes. Attach with screws and snap on the front of the push-button.
- When attaching the push-button with double-sided tape, remove the paper from both sides of the double-sided tape and apply to a clean surface.

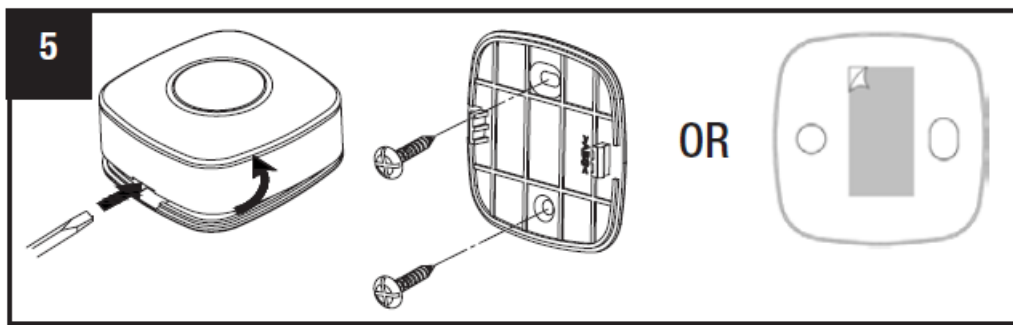

**NOTE:** Do not permanently mount the push-button until it is successfully paired with the doorbell.

## Low Battery Notification

If the push-button battery is low, the doorbell will prompt with a “Ding Dong” sound 3 times, and the indicator light of the doorbell will remain on for 10 seconds. This indicates that the push-button battery needs to be replaced with new batteries. After press the push-button, the doorbell prompts “Ding Dong” 3 times and the indicator light of the doorbell will remain on for 10 seconds, this indicates that the push-button battery is low, you need to replace with new batteries for push-button.

**NOTE:** The low battery notification requires the doorbell to support this function. If the doorbell does not support it, please ignore this part and refer to the doorbell manual for available tunes.

- “Sync” button may have different place and marking for different doorbells, please refer to the instructions for the operation of Sync/Music.

## Frequently Asked Questions (FAQ)

### 1. Q: What should I do if a battery is swallowed?

**A:** If a battery is swallowed, seek immediate medical attention.

### 2. Q: Can I dispose of batteries in fire?

**A:** No, do not dispose of batteries in fire as they may explode or leak.

### 3. Q: How do I contact the support team?

**A:** Please contact our support team at 1-888-543-1388 for assistance before returning the product to the store.

## 1-YEAR LIMITED WARRANTY

- This product is guaranteed to be free of factory defective parts and workmanship for a period of 1 year from date of purchase. Purchase receipt is required for all warranty claims.
- This warranty does not include expendable items (such as light bulbs, batteries, etc.), repair service, adjustment and calibration due to misuse, abuse or negligence. Unauthorized service or modification of the product or of any furnished component will void this warranty in its entirety. This warranty does not include reimbursement for inconvenience, installation, setup time, loss of use, unauthorized service, or return shipping charges. This warranty is not extended to other equipment and components that a customer uses in conjunction with this product.

## FCC STATEMENT

This device complies with Part 15 of the FCC Rules.

**Operation is subject to the following two conditions:**

1. this device may not cause harmful interference, and
2. this device must accept any interference received, including interference that may cause undesired operation.

**WARNING:** Changes or modifications to this unit not expressly approved by the party responsible for compliance could void the user's authority to operate the equipment.

**NOTE:** This equipment has been tested and found to comply with the limits for a Class B digital device, pursuant to part 15 of the FCC Rules. These limits are designed to provide reasonable protection against harmful interference in a residential installation. This equipment generates, uses and can radiate radio frequency energy and, if not installed and used in accordance with the instructions, may cause harmful interference to radio communications. However, there is no guarantee that interference will not occur in a particular installation. If this equipment does cause harmful interference to radio or television reception, which can be determined by turning the equipment off and on, the user is encouraged to try to correct the interference by one or more of the following measures:

- Reorient or relocate the receiving antenna.
- Increase the separation between the equipment and receiver.
- Connect the equipment into an outlet on a circuit different from that to which the receiver is connected.
- Consult the dealer or an experienced radio/TV technician for help

This device complies with FCC radiation exposure limits set forth for an uncontrolled environment. The distance between user and products should be no less than 20cm. This device contains licence-exempt transmitter(s)/receiver(s) that comply with Innovation, Science and Economic Development Canada's licence-exempt RSS(s).

**Operation is subject to the following two conditions:**

1. This device may not cause interference.
2. This device must accept any interference, including interference that may cause undesired operation of the device.

The device has been evaluated to meet general RF exposure requirement. The distance between user and products should be no less than 20cm.

**FCC Responsible Party:**

Globe Electric  
2264 East 6th Street  
San Bernardino, CA 92410  
[www.globe-electric.com](http://www.globe-electric.com)

Before returning to the store, please contact our support team for assistance at 1-888-543-1388.





[HeathZenith 18000145 Wireless Push Button](#) [pdf] Instruction Manual  
GB145TX, 2AQUQGB145TX, gb145tx, 18000145, 18000145 Wireless Push Button, Wireless Push Button, Push Button, Button

## References

- [User Manual](#)

Manuals+.