

HDWR Global CR30HF RFID Reader With Access Control



# HDWR Global CR30HF RFID Reader With Access Control User Manual

[Home](#) » [HDWR Global](#) » HDWR Global CR30HF RFID Reader With Access Control User Manual 

## Contents

- [1 HDWR Global CR30HF RFID Reader With Access Control](#)
- [2 FAQ](#)
- [3 Specifications](#)
- [4 Installation](#)
- [5 Wiring](#)
- [6 Connection Diagram](#)
- [7 Function Table](#)
- [8 Quantitative contents of the set](#)
- [9 Documents / Resources](#)
  - [9.1 References](#)
- [10 Related Posts](#)



**HDWR Global CR30HF RFID Reader With Access Control**

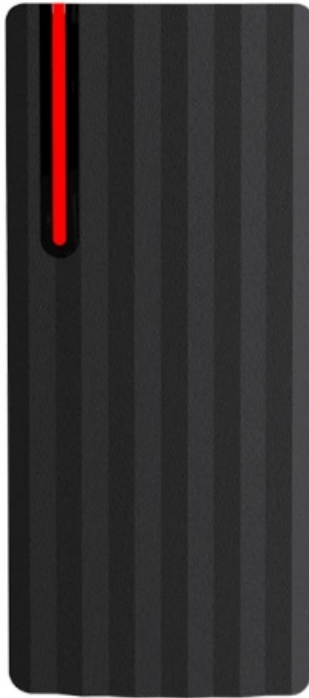

### Card Reading:

The LED will turn green and the buzzer will beep when a card is read, and the reader will send a Wiegand signal.

### External LED and Buzzer Control

- When the input voltage for the LED is low, the LED will turn green.
- When the input voltage of the buzzer is low, the buzzer will make a sound.

### Quantitative contents of the set:

Name	Quantity
RFID Reader	1
Wall Fixing Plugs	2
Self-tapping Screws	2

### FAQ

#### Q: What is the power input range for this RFID reader?

A: The power input range is +DC (9-18V DC).

#### Q: How many Wiegand bits are available for data output?

A: 26 Wiegand bits are available for data output.

**RFID reader with access control SecureEntry-CR30HF**

## Specifications

- **Warranty:** 1 year
- **Type:** RFID Reader with Access Control
- **Interface:** Wiegand 34
- **Verification Type:** 13,56 MHz RFID Card
- **Access Control:** Yes
- **Supported Cards:** 13,56 MHz
- **Voltage:** 9-18V DC
- **Degree of protection:** IP66
- **Reading Distance:** 0-5cm
- **Readable Chip Types:** MF
- **Operating current:** ≤50mA
- **Operating temperature:** -25°C – 60°C
- **Operating Humidity:** 10%-98%
- **Product dimensions:** 12 x 7.5 x 2 cm
- **Product weight:** 155 g
- **Package weight:** 195 g

### Set contents:

- RFID Reader with Wires
- Mounting pins and screws
- Manual

## Features

- IP66 rated for resistance to water ingress and low temperatures
- Can be mounted outdoors
- Support 13,56 MHZ RFID cards
- Compact shape

## Installation

- Two holes (A, C) for screws and one hole for cable (B) should be drilled in the wall.
- Rubber pins should be placed in the holes (A, C).
- The cable must be pulled through the wire hole (B).
- Attach the device to the wall with 2 screws.
- Finally, attach the front cover to the device.

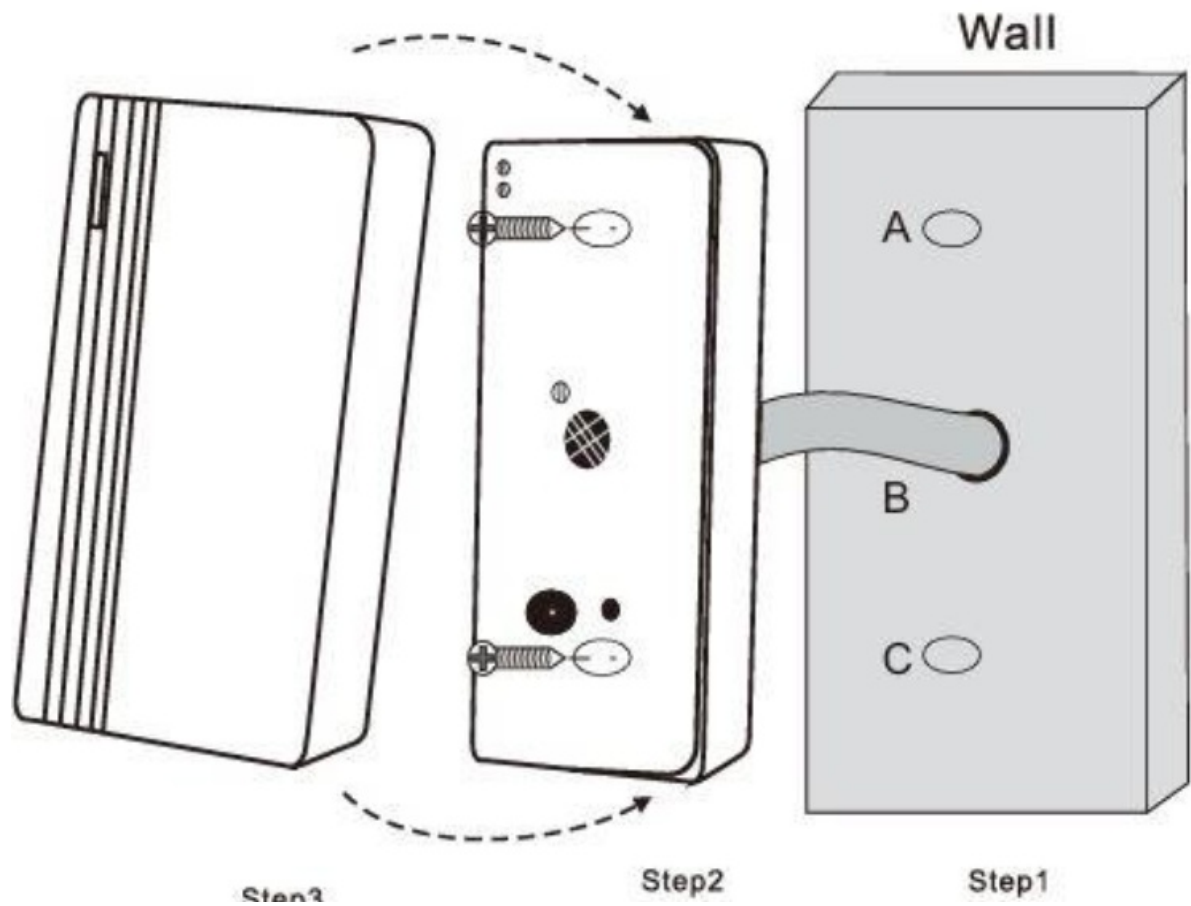

## Wiring

Model	Function	Comments
Red	Power	+DC (9-18V DC)
Black	GND	Ground
Green	D0	Data 0
White	D1	Data 1
Brown	Led	Green Control LED
Yellow	Buzzer	Buzzer control

(Note: Brown and yellow wires are optional connections)

## Connection Diagram

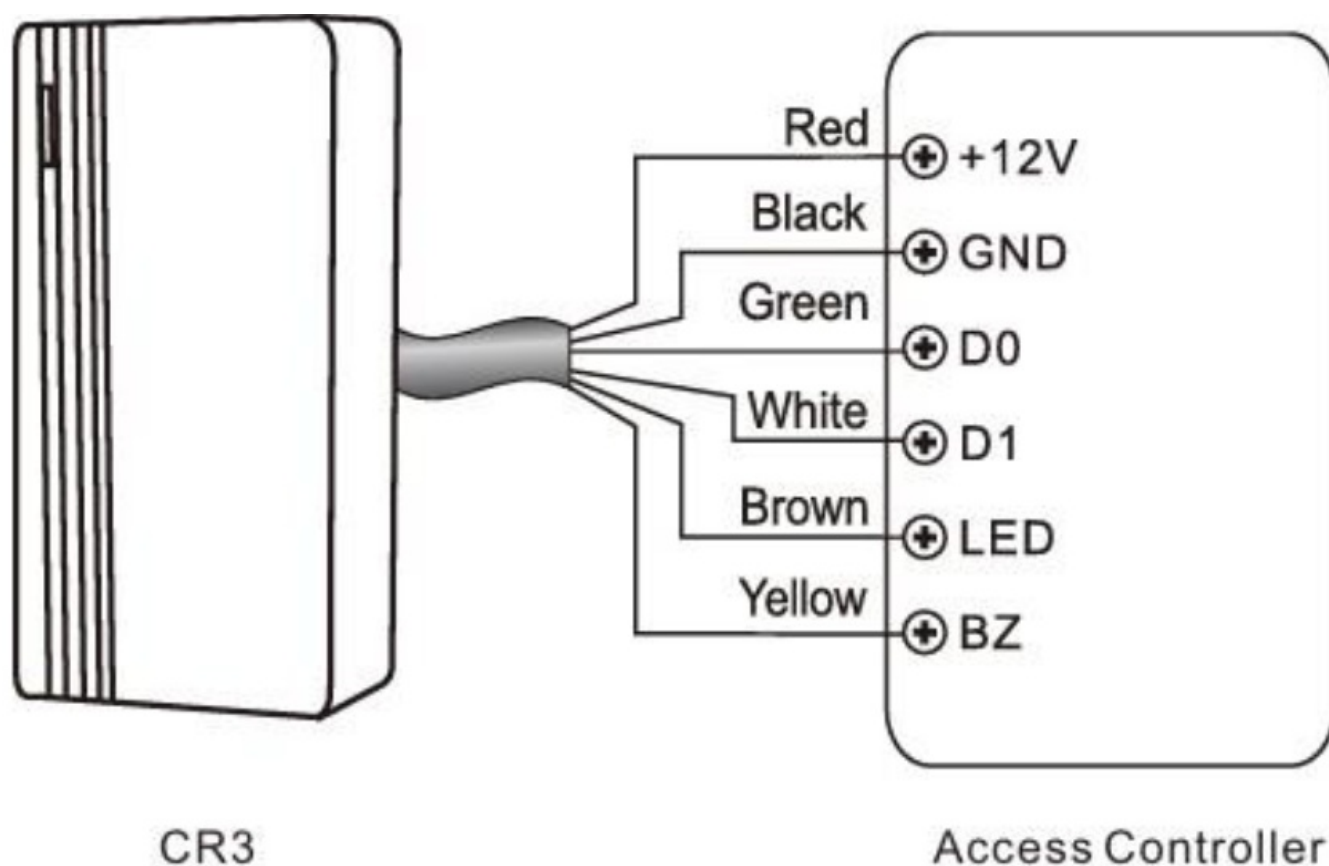

### Function Table

Card Reading	The LED will turn green and the buzzer will beep, meanwhile, the reader will send a Wiegand signal
External LED control	When the input voltage for the LED is low, the LED will turn green
External buzzer control	When the input voltage of the buzzer is low, the buzzer will make a sound
Wiegand Data Output	26 Wiegand bits are available

### Quantitative contents of the set

Name	Quantity
RFID Reader	1
Wall fixing plugs	2
Self-tapping screws	2

Documents / Resources

<div>User Manual</div> <div>RFID reader with access control</div> <div>SecureEntry-CR30HF</div> <div></div>	<div><a href="#">HDWR Global CR30HF RFID Reader With Access Control</a> [pdf] User Manual</div> <div>CR30HF RFID Reader With Access Control, CR30HF, RFID Reader With Access Control, Reader With Access Control, Access Control, Control</div>
--	---

References

- [User Manual](#)

[Manuals+](#), [Privacy Policy](#)

This website is an independent publication and is neither affiliated with nor endorsed by any of the trademark owners. The "Bluetooth®" word mark and logos are registered trademarks owned by Bluetooth SIG, Inc. The "Wi-Fi®" word mark and logos are registered trademarks owned by the Wi-Fi Alliance. Any use of these marks on this website does not imply any affiliation with or endorsement.