



# HB Products HBLC Level Controller Instruction Manual

[Home](#) » [HB Products](#) » HB Products HBLC Level Controller Instruction Manual 

## HB Products HBLC Level Controller Instruction Manual



**Covers: HBLC, HBLT, HBSLC & HBSLT**

For analog measurements of liquids like NH<sub>3</sub>, water, HFC/HFO refrigerants, CO<sub>2</sub>, Hydro carbons and alcohols.  
Can be used in refrigeration systems and similar demanding systems.

## Contents

- 1 Introduction
- 2 Safety Instructions
- 3 Application Examples
- 4 Installation Instructions
- 5 How to connect the sensor
- 6 Use the HB tool for setting up the sensor
- 7 LED indication
- 8 Fault detection
- 9 Sensor Repair
- 10 Further Information
- 11 Quick guide
- 12 Documents / Resources
  - 12.1 References
- 13 Related Posts

## Introduction

HBLC, HBLT , HBSLC and HBSLT are intelligent liquid level sensors which can be installed in a vessels or in a standpipes. The sensors can be mounted directly in a stand pipe or in a vessel. The HBLC and HBSLC are sensor without an external pipe which means they measure between the sensor element and the vessel or standpipe whereas the other types has an external pipe and measures between the inner rod and the outer pipe. Installation and configuration is similar for the two product types and they share the electronic heads.

The sensor can be installed in refrigeration systems and similar demanding applications with high pressures and aggressive fluids.

The sensors comes in different versions with or without a cable for direct valve control. All versions emits a 4-20mA analog signal, which is proportional or disproportional to the liquid level, via the M12 plug. The sensors are available in special versions which contains a controller able to control a valve directly, without using a PLC.



## Safety Instructions

**CAUTION!** Always read the instruction manual before commencing work! Heed all warnings to the letter! Installation of the sensor requires technical knowledge of both refrigeration and electronics. Only qualified personnel should work with the product. The technician must be aware of the consequences of an improperly installed sensor and must be committed to adhering to the applicable local legislation.

If changes are made to type-approved equipment, this type approval becomes void. The product's input and output, as well as its accessories, may only be connected as shown in this guide. HB Products assumes no responsibility for damages resulting from not adhering to the above.

**Explanation of the symbol for safety instructions.** In this guide, the symbol below is used to point out important safety instructions for the user. It will always be found in places in the chapters where the information is relevant. The safety instructions and the warnings in particular, must always be read and adhered to.

**CAUTION!** Refers to a possible limitation of functionality or risk in usage.



**NOTE!** Contains important information about the product and provides further tips.

The person responsible for operation must commit to adhering to all the legislative requirements, preventing accidents, and doing everything to avoid damage to people and materials.

**Intended use, conditions of use.** The level sensor is designed for continuous measurement of liquids, but please note the sensor design and setup has to comply with the liquid. The table show how sensors comply to liquids. It can be used in refrigeration systems and similar environments. If the sensor is to be used in a different way and if the operation of the product in this function is determined to be problematic, prior approval must be obtained from HB Products.

**Prevention of collateral damage** Make sure that qualified personnel assess any errors and take necessary precautions before attempting to make replacements or repairs, to avoid collateral damage.

**Disposal instructions:** The sensor is constructed so that the modules can easily be removed and sorted for disposal.



Comply



Not comply

Product	HFC,HFO	Oil,Hydro-carbons,Co2	NH3,Water,Alcohols
HBLC-Fgas			
HBLC & HBSLC-CO2 HBLC & HBSLC-Oil HBLC & HBSLC-HFC			
HBLC & HBSLC			
HBLT & HBSLT-A2 & A3			
HBLT-A1/AKS41			
HBLT & HBSLT-Flex			
HBLT & HBSLT-Wire			

### Application ExamplesHBLC and HBSLC

HBLC consist of a PTFE covered rod and requires a electrical connection to the overflow pipe or to the pipe segment where it is installed. The sensor is more sensitive to turbulent conditions but with a high filter time it is able to control the level even in turbulent conditions. The simple design is less sensitive to contamination compared to HBLT.

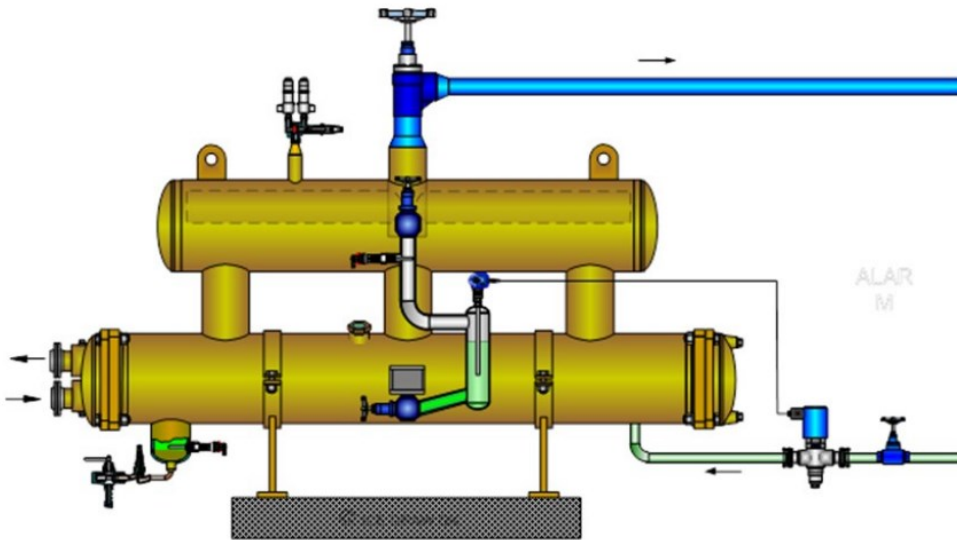

HBSLC connected to a modulating valve – an alternative to low pressure float control.

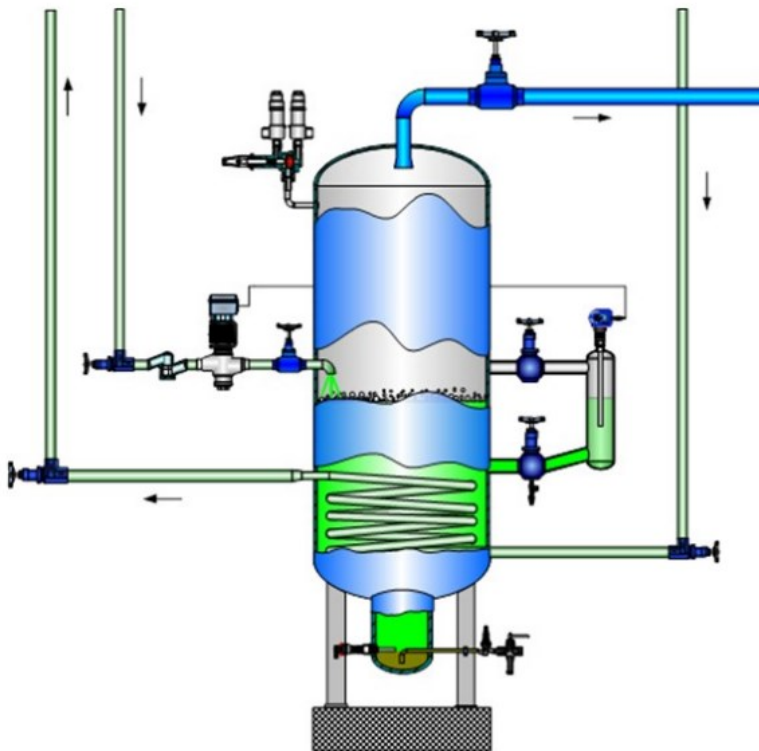

An economiser with an HBSLC connected to the modulating valve, type Siemens MVS661.

## Application Examples

HBLT and HBSLT are designed for level measurement of liquids and is typically used in chillers, pump separators, coolers and condensers. The sensors can be mounted in vessels, containers and standpipes without an external pipe.

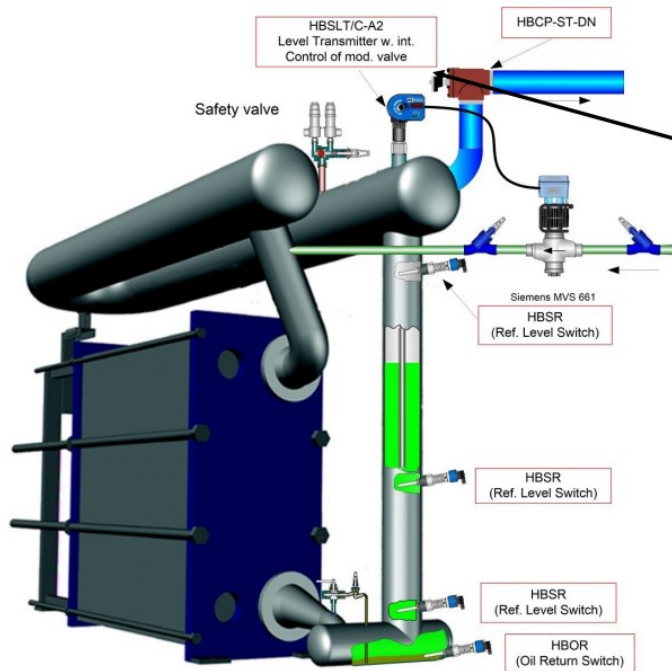

#### HBSLT/C

Sensor with integrated cable for direct control of 4-20 mA controlled modulating valve like Siemens MVS-series or Danfoss ICM-series or similar. LED display is included

#### HBSLT/S

Sensor with integrated cable for direct control of stepper motor valves. HBSLT/S-version is without LED display.

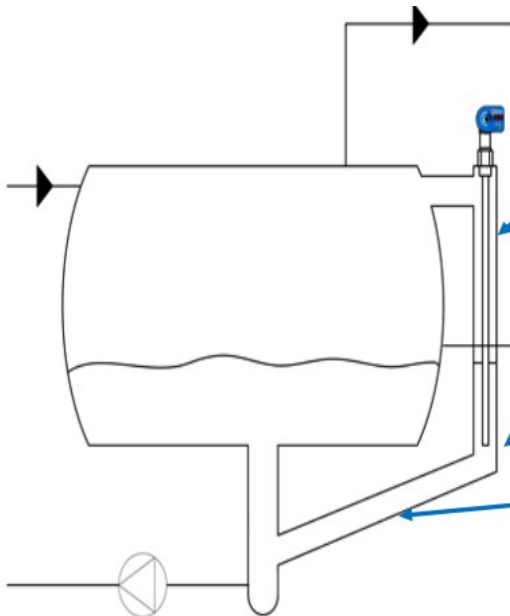

Standpipe should be insulated to reduce boiling in the standpipe.

Sensor must have a minimum of 50 mm between the sensor end and the bottom of the pipe.

Drain pipe must be placed at an angle of 5-10°, to avoid oil pockets in standpipe as these cause inaccurate measurement.

## Application Examples HBLC and HBSLC

Level sensor installed directly in a vessel



Level sensor installed in a standpipe connected to a receiver.

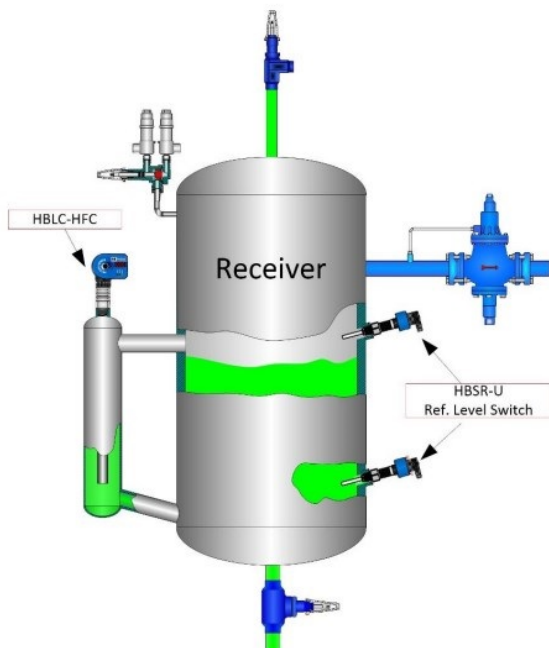

## Installation Instructions

Mount the sensor rod in a standpipe or vessel with the right thread connection. Liquid sealant is used for sensors without an outer pipe and the conic NPT thread. For the BSPP threads a washer is used. Teflon tape can be used on versions with an outer pipe.

**CAUTION!** In case of welding work on the unit, we recommend to remove the electronic head or at least to make sure that proper earthing is carried out to avoid damaging the electronics.

## Mounting instruction



The electronic head is mounted and demounted using either the three pinon screws or a union. The threaded union is mainly used on sensors for low temperature applications. The threaded union should be tightened firmly using a tool to secure good electrical contact and avoid loose connections.

Liquid sealant should be used for HBLC and HBSLC and products with a rod without outer pipe



Teflon tape can be used for HBLT and HBSLT and products with an outer pipe



Mount the sensor on the vessel. Torque 80-150 Nm.





Connection diagram for simple sensor

Suited for

- Sensors with simple electronic head

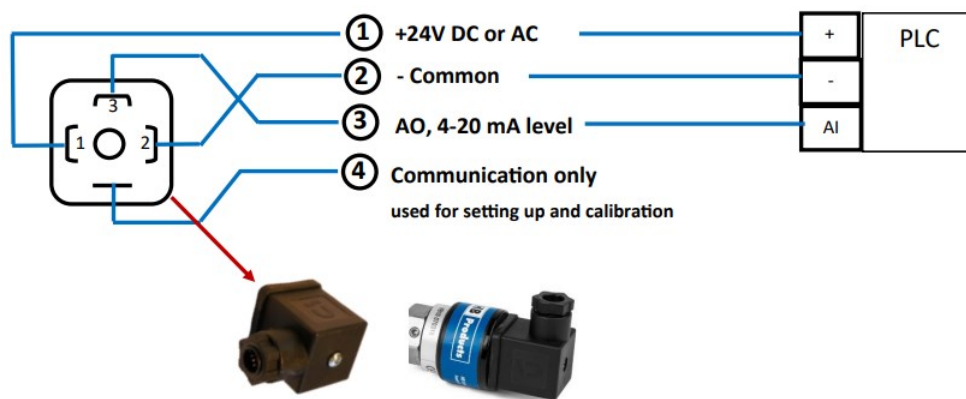

Connection diagram for sensors without control cable.

Suited for

- HBLC
- HBLT and HBLT-wire



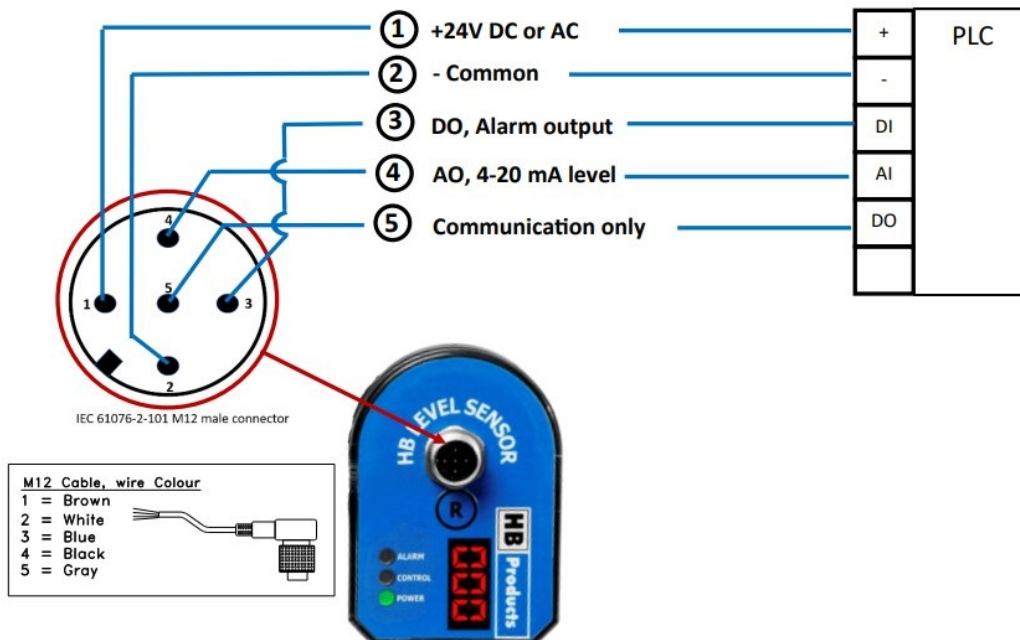

### Digital output on pin 3

The sensor versions without a cable has an alarm output on pin 3. Remote setpoint is not available

## How to connect the sensor

### Three different type of sensors

- A simple sensor version with 4-20 mA output
- A advanced sensor version with 4-20 mA output, LED indications, display and multiple settings
- A controller version with both cable for direct valve control and analog output, LED indications, display and multiple settings

The M12 connection is also used for power supply. Some versions are able to control a valve directly. They have a cable, which can be connected directly to the valve.

### Simple version

- Analog output
- Simple setup



Circular head with ISO4400/DIN43650 connector

### Advanced version

- Analog output
- Advanced setup
- LED indicators
- Display (option)

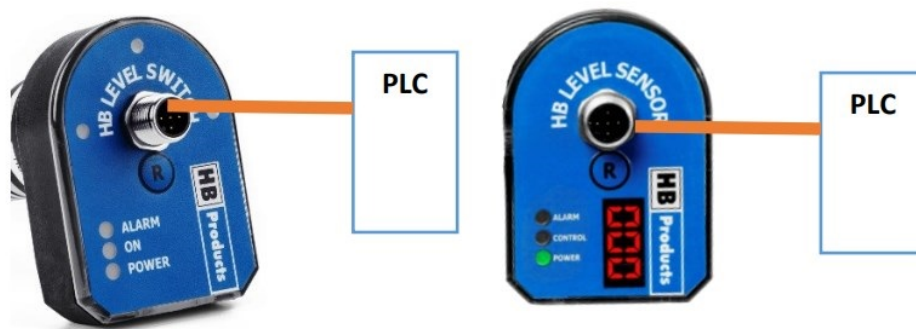

Large head with M12 EN61076-2 connector  
With or without display and output cable

### Controller sensor

- Analog output
- Advanced setup
- Display
- LED indicators
- Valve control

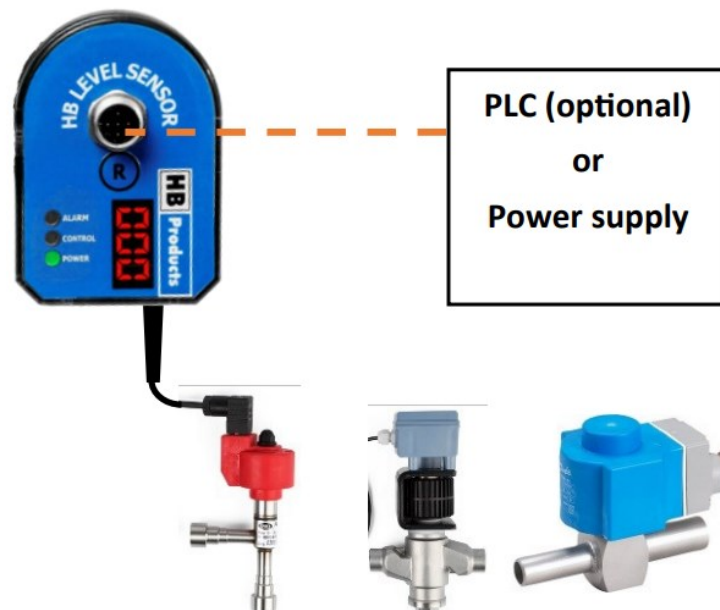

Connection diagram for sensors with control cable for all common stepper motor valves — here shown with Carel E2V

Suited for

- HBSLT/S and HBSLT–wire/S
- HBSLC/S

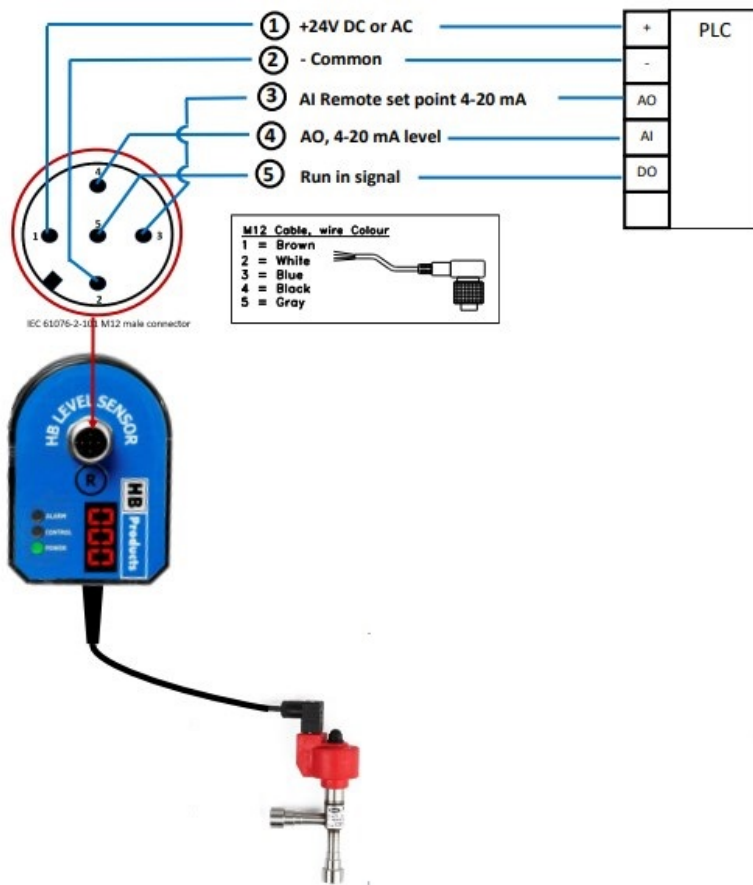

**Note:** The sensor is powered via the M12 plug only. Do not supply the sensor via the cable.

The sensor has a built-in controller for a stepper valve. The sensor provides both the analog output via the cable to control the valve. The level measurement signal for the PLC comes via the M12 plug.

On pin 3 it is possible to send an analog 4-20 mA signal to the controller and change the setpoint. The signal is scaled linear like analog output.

The cable is connected according to the drawing and the parameters are set as shown in the next section.

For the stepper motor setup a special menu is activated

HBLT-Wire Tool - Level sensor

Basic settings   **Advanced settings**   Diagnostic

HBLT-Wire advanced settings:

Alarm setting in %: 80	Setpoint level in %: 35	<b>Stepper motor step: 480</b>
Alarm Delay in sec.: 10	P-band in %: 30	Stepper motor speed in mS: 20
Alarm relay function: NC	Ramp startup % in sec.: 5	Home recal. time in hours: 24
Filter time const. in sec.: 20	Valve speed open % in sec.: 5	Stepper motor phase current: 450 mA
Control/Level mode: Control	Valve speed close % in sec.: 5	Stepper motor holding current: 100 mA
	Minimum valve opening in %: 0	
	Maximum valve opening in %: 100	

Set the configuration:  
Selected basic settings are also configured!!   **Read configuration is successfully**

Save to sensor   Show sensor settings

Save settings:  
Save settings file

Load settings:  
Load settings file

## Color coding

A+ = yellow(2)  
A- = white (4)  
B- = green (1)  
B+= brown (3)

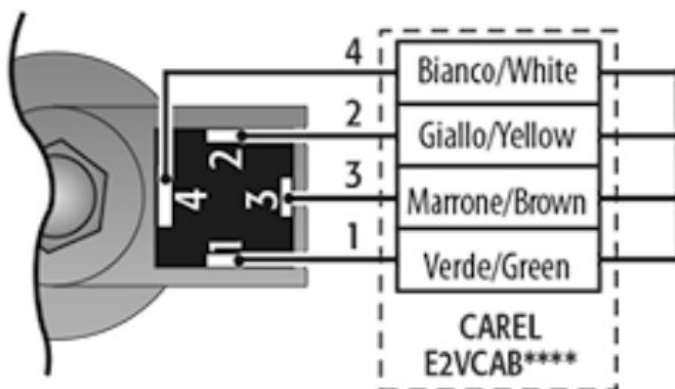

Connection diagram for sensors with control cable for pulse modulating valve — here shown with Danfoss AKV/AKVA

Suited for

- HBSLT/PWM and HBSLT–wire/PWM
- HBSLC/PWM

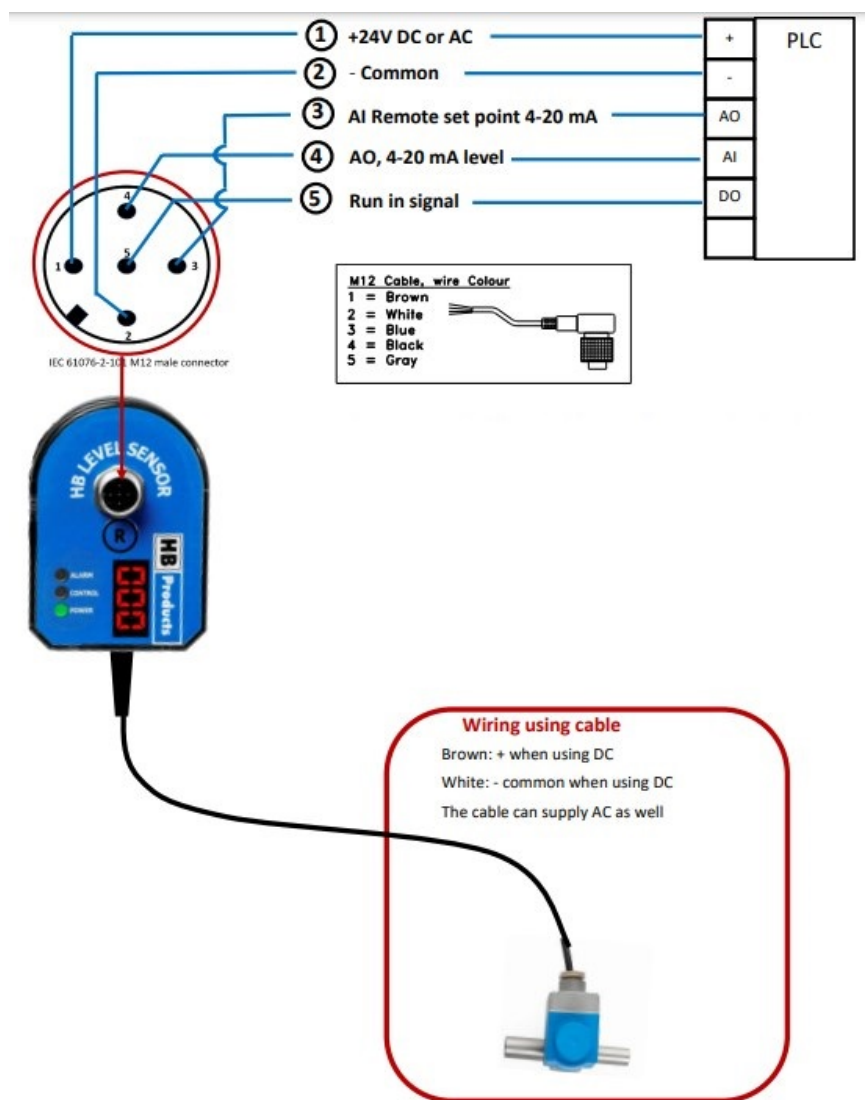

**Note:** The sensor is powered via the M12 plug only. Do not supply the sensor via the cable.

The sensor has a build in controller for a pulse modulating valve. The sensor provides both the analog output via the cable to control the valve. The level measurement signal for the PLC comes via the M12 plug .

On pin 3 it is possible to send an analog 4-20 mA signal to the controller and change the setpoint. The signal is scaled linear like analog output.

The cable is connected according to the drawing and the parameters are set as shown in the next section.

Connection diagram for sensors with control cable for modulating valve — here shown with Siemens MVS661

Suited for

- HBSLT/C and HBSLT–wire/C
- HBLC/C

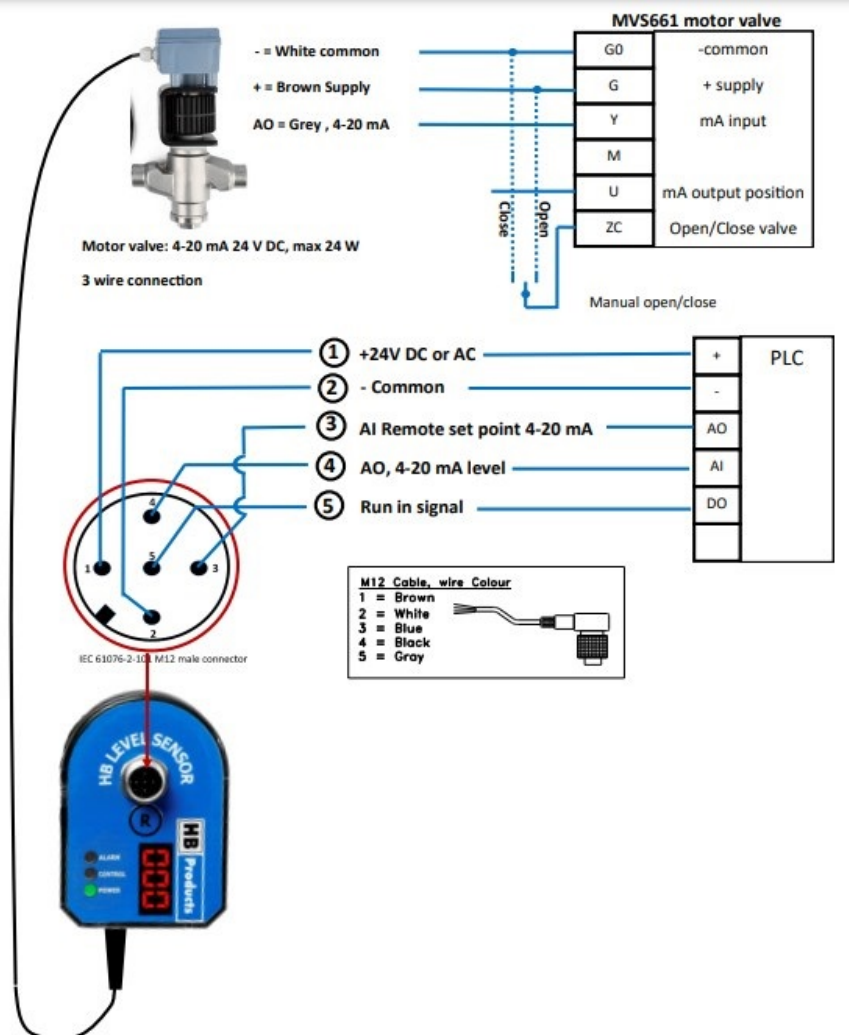

The sensor has a built in controller for a pulse modulating valve. The sensor provides both the analog output via the cable to control the valve. The level measurement signal for the PLC comes via the M12 plug .

On pin 3 it is possible to send an analog 4-20 mA signal to the controller and change the setpoint. The signal is scaled linear like analog output.

The cable is connected according to the drawing and the parameters are set as shown in the next section.

**Note:** The sensor is powered via the M12 plug only. Do not supply the sensor via the cable.

Connection diagram for sensors with EX approval and two wire connection

Suited for

- HBLT and HBLT-wire
- HBLC

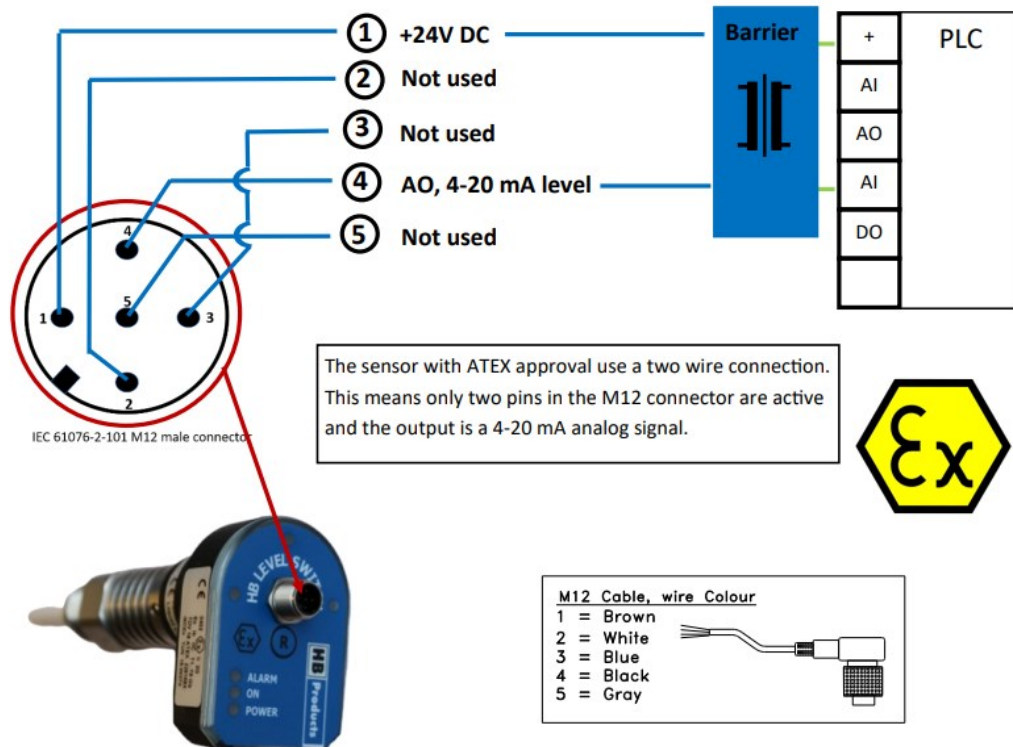

## Scaling and offsetting the output

### Scaling the analog output

The output is scaled linear from minimum to maximum and it is done in the HB-tool.

### Offsetting minimum and maximum

If your sensor height doesn't match your vessel height it is possible move the minimum level and maximum level beyond the physical sensor by adjusting the offset value in the HB-tool. It is also possible to make the offset by making a calibrations to known levels also in the tool.

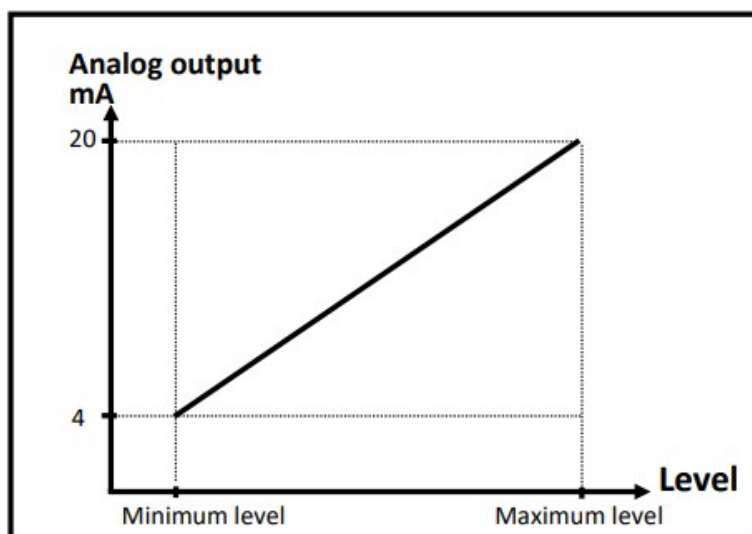

## Setting up the sensor

When the sensor is delivered with one of the predefined liquids it is pre-calibrated and need no further calibration. The simple sensor can still be setup using a simple tool where filter time and calibration can be made. The



advanced sensors has multiple parameters.

All sensor are connected to a PC using an USB/M12 cable and the simple sensor need an additional adapter

The USB cable and the ISO4400/DIN43650 to M12 adapter



The HBtool is downloaded from the HBproducts web page.



### Setup using a splitter box

When using a splitter box it is possible to run the refrigeration system and connect a PC to the sensor at the same time. The splitter box is not suited for normal operation, but only for installation and modification. The splitter box is connected to the M12 plug on the HBX sensor and then both the pc and the normal M12 plug can be connected.



## Use the HB tool for setting up the sensor

### Simple versions only

The HB tool is very simple for this version. Only the filter time can be changed under the configuration tab. The calibration is similar to calibration of the advanced, please follow the instruction further on in the manual.

Calibration is similar to calibration of the advanced sensor versions

Filter time averages the output over a period and reduce fluctuations

HB

Zero calibration in pF: 32.7 pF

SPAN calibration in pF: 123.4 pF

Actual measurement in pF: 32.6 pF

4mA Control 20mA

0% Level 100 %

0% Level 0%

Zero calibration Calibrate known level 100 %

Send Zero/Span values Enable Zero and Span configuration:

### Advanced versions only

#### Setup — level or control

The sensor can operate in two different modes

- As sensor input to a PLC, computer or other device that



Basic settings | **Advanced settings** | Diagnostic

HBLT-Wire advanced settings:

Alarm setting in %:	80	<input type="checkbox"/>	Setpoint level in %:	35	<input type="checkbox"/>
Alarm Delay in sec.:	10	<input type="checkbox"/>	P-band in %:	30	<input type="checkbox"/>
Alarm relay function:	NC	<input type="checkbox"/>	Ramp startup % in sec.:	5	<input type="checkbox"/>
Filter time const. in sec.:	20	<input type="checkbox"/>	Valve speed open % in sec.:	5	<input type="checkbox"/>
Control/Level mode:	Control	<input checked="" type="checkbox"/>	Valve speed close % in sec.:	5	<input type="checkbox"/>
			Minimum valve opening in %:	0	<input type="checkbox"/>
			Maximum valve opening in %:	100	<input type="checkbox"/>

## Setting up the sensor

The HB tool has three pages of settings. Some fields will be shown in grey when they are not relevant/active with the setting chosen. Detailed explanations of the individual fields will show up when the mouse is moved over the field. Only the latest version of the tool has this feature.

When you like to change a setting ,you just type in a new value or select in the drop down. After changing the value you store the data by clicking “save to sensor”. The data is then saved and stored in the sensor and remains there even when the power supply is disconnected.

HBLC Tool - Level sensor

Basic settings | **Advanced settings** | Diagnostic

HBLC advanced settings:

High or low alarm: Low ☒ Alarm LED indication: Alarm ☐

Zero calibration in gF: SPAN calibration in gF:

HBLC Tool - Level controller

Basic settings | **Advanced settings** | Diagnostic

Communication settings:

Disable comm

Read configuration is successfully

Show sensor settings

Sensor SW version: ---

HBLC basic settings:

Control/Level mode:	Control	<input type="checkbox"/>	Filter time const. in sec.:	20	<input type="checkbox"/>	Select mechanical type:	HBLT-A2 probe	<input checked="" type="checkbox"/>
Setpoint level in %:	35	<input type="checkbox"/>	Run in signal:	OFF	<input type="checkbox"/>	Refrigerant:	NH3	<input type="checkbox"/>
P-band in %:	30	<input type="checkbox"/>	Zero & span cal. function:	OFF	<input type="checkbox"/>	Sensor length in mm:	1000	<input type="checkbox"/>
Alarm setting in %:	80	<input type="checkbox"/>	Alarm Delay in sec.:	10	<input type="checkbox"/>	mA input function:	Remote setp.	<input type="checkbox"/>
Offset max level in mm:	0	<input type="checkbox"/>						
Offset min level in mm:	0	<input type="checkbox"/>						

Configuration instruction:

1) Configure sensor.  
If 'Read configuration is successfully' Select 'Show current configuration' to check current set values. Change relevant parameters and 'Save to sensor' or 'Reset sensor'

Set the configuration:

Save to sensor

Reset data to default:

Reset sensor

Select all data

Setting file loaded:

## Basic settings

Here you make the primary settings of the sensor

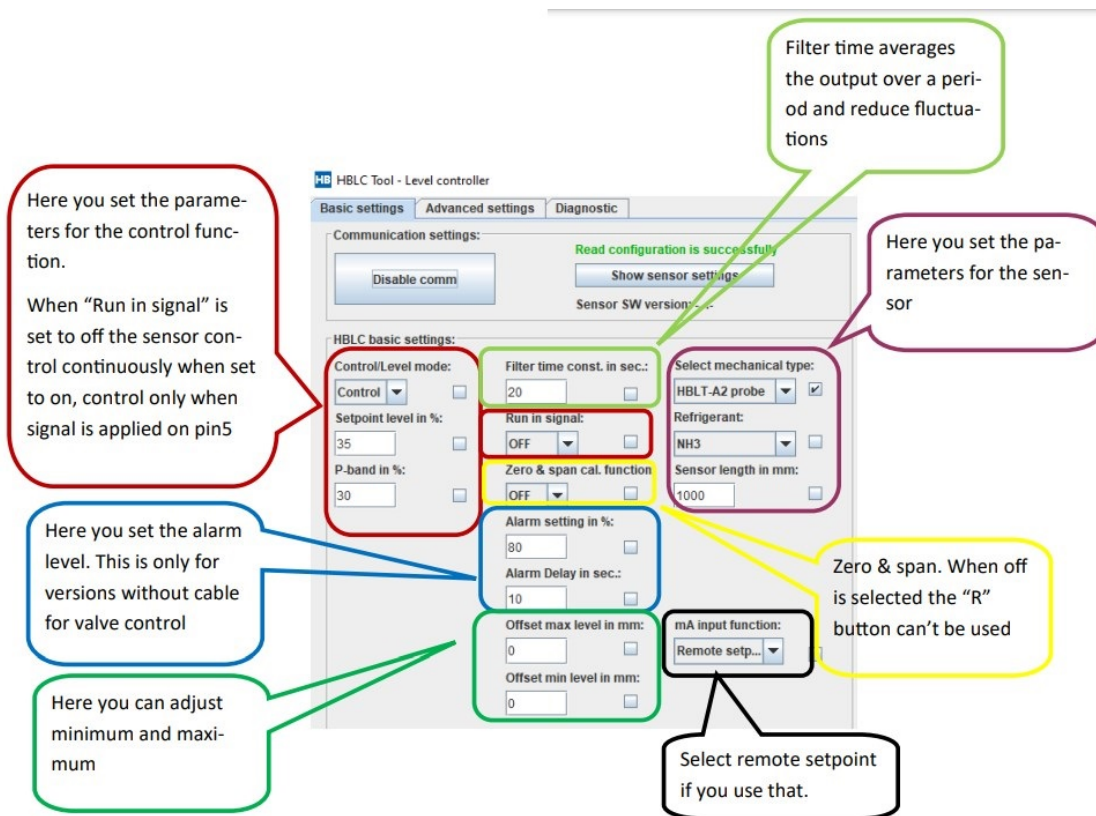

**Setpoint level in %** (control mode only) Desired level: Shows the percentage level that one wants to remain in the container or the level indicator.

**P-band in %** (control mode only) Proportional band: Control area that describes how much the valve should open, dependent upon the deviation from the desired level. If proportional band is set to 10%, for example, a liquid level that is under 5% will make the valve open 50%; the valve will open to 100% if the level is under 10%. Small proportional band results in a system which reacts quickly, while a large proportional band results in a system that reacts more slowly.

**Filter time const. in sec.** Filter function: Averages the measurement so that the control function is performed based on an average measurement in a programmable time span (in seconds). This is increased if there are brief fluctuations in the measurement which lead to unstable control.

**Run in signal remote activation:** with this function it is possible to activate centralized control. If one does not want this, the function must be set to OFF, otherwise the sensor's control function will not work (power LED will flash when run-in signal is active or if this function is deactivated).

**Zero & span cal. Function** **Calibrating function:** ON in case calibration of the sensor is allowed. After start-up and possibly the first calibration, the tool can be connected and is deactivated.

**Alarm setting in %** Alarm, H/L: Indicates the desired alarm level. It is given in % of max measurement range.

**Alarm delay in sec** **Delay – alarm:** The delay from when the liquid level falls/rises to under/over the selected alarm, indicated in seconds.

**Offset max/min level in mm.** here you can adjust for a sensor smaller than the vessel at max level and min level

**Select mechanical type:** select the type of sensor you have

**Refrigerant:** Indicates the type of refrigerant the sensor shall measure on.

**Measurement length in mm Measurement in mm:** Indicates the length of the sensor in mm typically printed on the electrical part

## Advanced settings

Here you make the advanced settings of the sensor

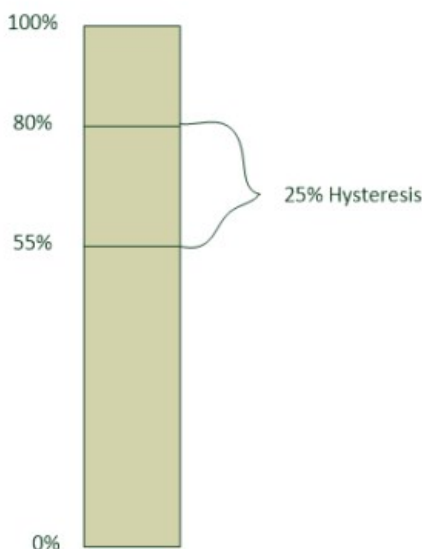
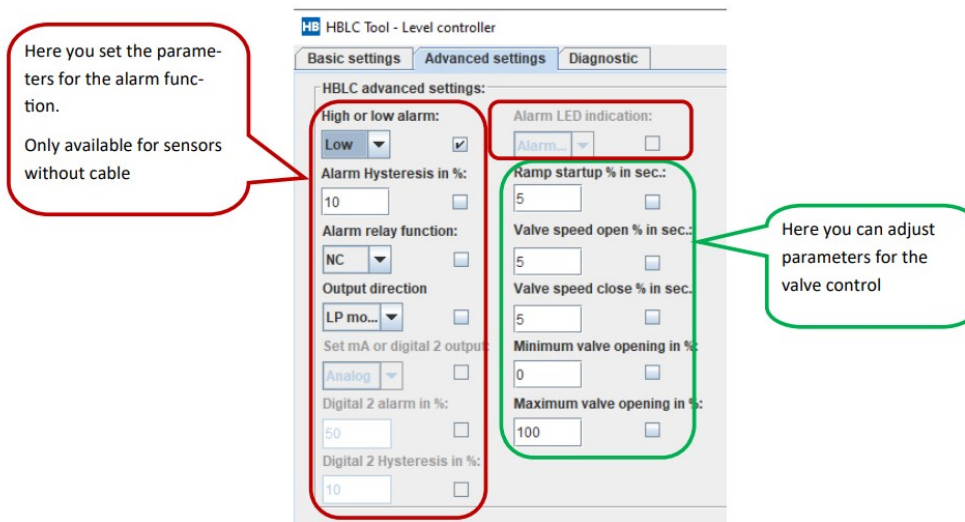

**Alarm relay function:** Here, the relay function is indicated, depending upon the instructions – NO or NC (normally open/normally closed). Here the signal can be changed from alarm on below or above the alarm setpoint

**Output direction:** Here you select either LP-mode (low pressure control) or HP-mode (high pressure control). In LP-mode, the container is filled so that the level is maintained, and in HP-mode the container is emptied so that the level is maintained. LP-mode = 4-20 mA. HP-mode = 20-4 mA.



**Set mA or digital 2 output** Select the sensor output digital or analog

**Digital 2 alarm in %:** set the alarm setpoint

**Digital Hysteresis in %:** Indicates the deviation required before the alarm is deactivated, following activation of the alarm. Alarm hysteresis in percent of the probes calibrated span 0 and 100%.

Alarm setting is as well in % of the probes calibrated span 0 and 100%.

E.g. alarm setting = 80%, Alarm hysteresis = 25%

**Set LED indication:** Determines the function LED lighting has.

### Diagnostic (calibration of sensor)

Here you make the calibration of the sensor. If the sensor is operating in one of the predefined liquid it is delivered with a calibration and does normally not need further calibration. If you need higher accuracy the sensor can be calibrated

The screenshot shows the 'Diagnostic' tab of the 'HBLT-Wire Tool - Level sensor' software. It features several input fields and buttons for sensor calibration. Callouts provide detailed instructions for each field and button.

**Callouts:**

- Zero calibration in pF:** Here you can see and change the zero calibration. The value is normally calculated based on an automatic calibration and should not be changed.
- SPAN calibration in pF:** Here you can see and change the SPAN which is a part of the calibration. The value is normally calculated based on an automatic calibration and should not be changed.
- Actual measurement in pF:** Here you can see the actual measurement value.
- Visualization of the control signal and the level:** Points to the control signal and level visualization area.
- Zero calibration button:** Use this button to make the zero calibration.
- Calibrate known level button and field:** Use the button and the field to make a calibration to a known level between 1 and 100%.

**Fields and Buttons:**

- Zero calibration in pF:** 32.7 pF
- SPAN calibration in pF:** 123.4 pF
- Actual measurement in pF:** 32.6 pF
- Control signal:** 0% (range 4mA to 20mA)
- Level:** 0% (range 0% to 100%)
- Buttons:** Zero calibration, Calibrate known level, Send Zero/Span values, Enable Zero and Span configuration.
- Field:** 100 %

### LED indication

- Green LED indicates 24 V DC supply; it flashes during operation. If “run-in” is not used, this function must be deactivated in the tool.
- Yellow LED indicates control. The flashing sequence indicates if the valve is closing or opening.
- Red LED indicates high- or low-level alarm, depending upon the setup.



3-digit display: (not available on /S stepper motor control version.)  
Showing 0...100 % linearly corresponding to 4...20 mA.

LED Signal	ON/OFF/Frequency	Functionality
Green	ON	Supply voltage connected
	Flash	Run In start signal / in operation.
	OFF	No supply voltage
Yellow	ON	Activation of valve control / and during calibration
	OFF	Valve control not active
Red	ON	Alarm, high or low level, depending upon the setup.
	Flash slow	No contact to sensor probe or sensor probe shorted
	Flash fast	USB cable connected and communication active
	OFF	No alarm
Yellow + Red	Flash	Insufficient Power supply
All	Flash	USB cable connected and communication active
	OFF	No alarm

### Calibration directly on the sensor (advanced versions only)

#### Calibration instructions:

0% or 100% for calibration can be carried out independent of each other. We recommend only calibrating at 0% if a high degree of accuracy is desired.

**Note:** To use this function the “Zero & span cal. Function “ field found under basic settings have to be on – default is off

#### Instruction for 0% calibration:



- Connect the supply cable
- Empty the vessel
- Activate “R” for 5 seconds to activate calibration mode = Yellow LED is on (ON) during the 5 second activation and turns off (OFF) when calibration mode is activated.
- Activate “R” once = Yellow LED flash once. Afterwards, the green LED flashes to confirm calibration.

#### Instruction for 100% calibration:

- Fill the vessel to 100%.
- Activate “R” for 5 seconds to activate calibration mode = Yellow LED is on (ON) during the 5 second activation and turns off (OFF) when calibration mode is activated.
- Follow the instructions under “Configurations Instructions” regarding the installation of drivers in the program.
- Activate “R” twice = Yellow LED flashes twice. Afterwards, the green LED flashes to confirm calibration.

#### Fault detection

General: In case of fault, it is normally enough to replace the electronic part.

Fault	Reason	Correction of fault
No LED is on / not operating.	No supply to the sensor or defective cable/plug	Check and find faults in the power supply, or replace the supply cable.
Yellow and red LED flash.	Power supply is not sufficient.	Install proper power supply.
Valve open and close too fast.	Refrigerant is boiling in the stand-pipe	Increase “filter” settings and eventually increase P-band as well.
No contact activation	There may be dirt between the electronic housing and the mechanical housing.	Separate the two parts and clean the spring tip. Remember to apply silicone grease to the spring tip so as to avoid problems with moisture
Delay in sensor activation	May be caused by gas and bubbles in the system.	Check if the sensor is placed optimally so that gas is avoided.
The valve is not performing the control function well enough.	Oil has accumulated in the level indicator glass which cannot escape.	Drain the level indicator of oil and, if necessary, clean the oil from the rod.
There is no alignment between the output signal and the level in the level indicator.	The sensor is incorrectly calibrated.	Perform calibration.



**NOTE!** Fault detection and/or changing the electronic function can be carried out without releasing pressure from the system or disassembling the mechanical part of the sensor.

#### Sensor Repair

In case of faults with the sensor, it will typically only be necessary to replace the electronics. Please contact your local distributor about how to handle complaints.

## Further Information

For further information, please visit our website, [www.hbproducts.dk](http://www.hbproducts.dk), or send an email to: [support@hbproducts.dk](mailto:support@hbproducts.dk).

HB Products A/S – Bøgekildevej 21 – DK8361 Hasselager – [support@hbproducts.dk](mailto:support@hbproducts.dk) – [www.hbproducts.dk](http://www.hbproducts.dk)

## Quick guide

### Installation

The sensor is installed in the vessel using liquid sealant or PTFE tape like shown in the manual and the electrical unit is connected. If the electronic unit has the threaded union, make sure it is firmly tightened to secure good electrical connection.

### Setup

The sensor is delivered pre-calibrated for the liquid you specified when ordering and ready for use. To obtain a more accurate measurement you need to calibrate the sensor as described in the complete manual. You need a computer and a USB/M12 cable to do the calibration and more advanced setup. The setup is done in the HB-tool which is downloaded from the HBproduct web page [www.hbproducts.dk](http://www.hbproducts.dk)

### Measurement signal

The sensor output is a 4-20mA provided on pin 4 in the M12 plug. The signal grow linear to the level. More advanced wiring and wiring of sensors controlling a valve is described in the complete manual.

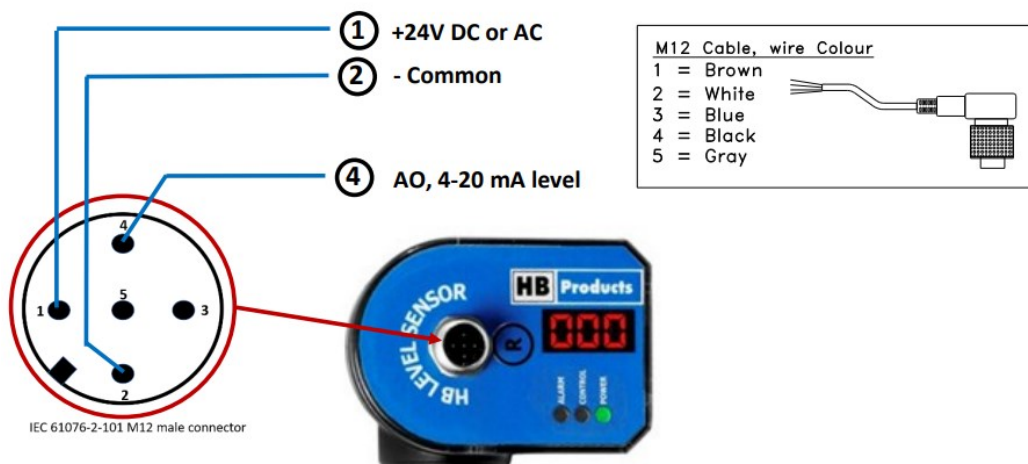

### LED indication

When the sensor is operating the green LED should be on or flashing

LED Signal	ON/OFF/Frequency	Functionality
Green	ON	Supply voltage connected
	Flash	Run In start signal / in operation.
	OFF	No supply voltage

### Documents / Resources

	<p><a href="#">HB Products HBLC Level Controller</a> [pdf] Instruction Manual  HBLC Level Controller, HBLC, Level Controller, Controller</p>
---	--

### References

- [HB Optimal solutions for level measurement and control of oil and refrigerants](#)
- [HB Optimal solutions for level measurement and control of oil and refrigerants](#)