



HAY Parade Table Lamp Instruction Manual

[Home](#) » [HAY](#) » HAY Parade Table Lamp Instruction Manual 

HAY

PARADE TABLE LAMP
COLLECTION

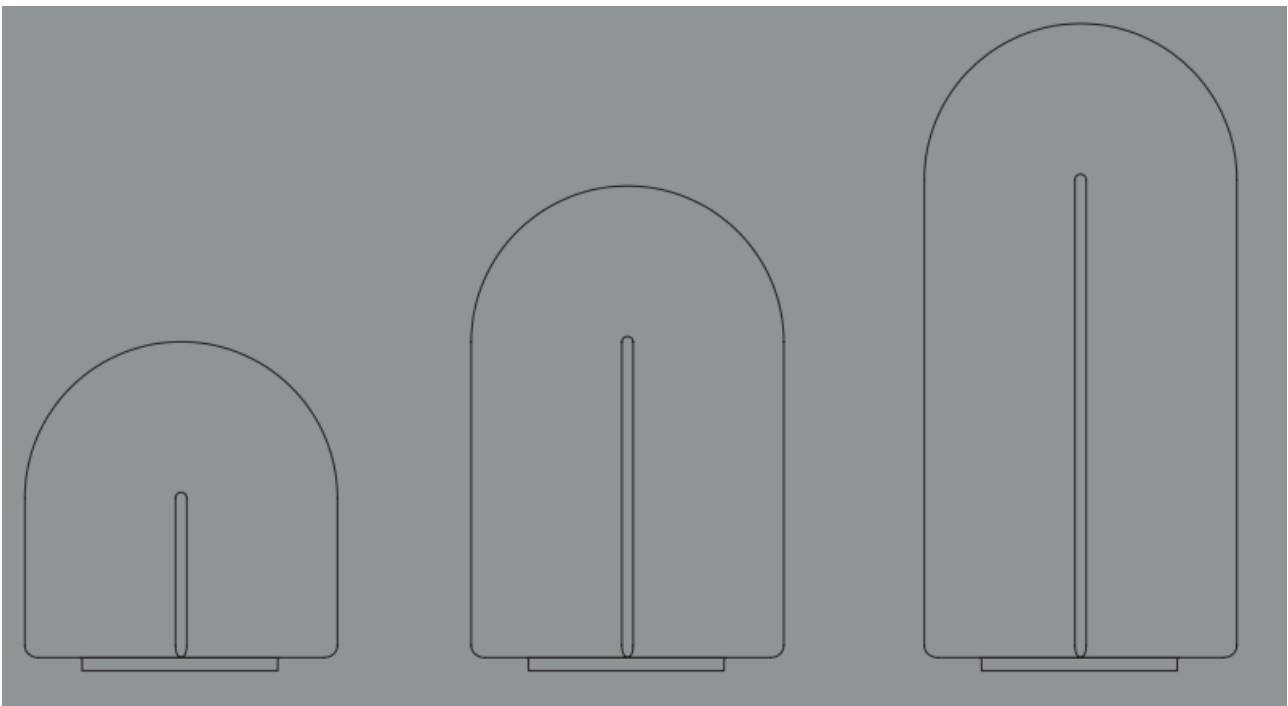

DESIGN BY JONAS TRAMPEDACH & VIOLA HEYN-JOHNSEN

Contents

1 GENERAL INFORMATION

2 PARTS

3 NOTE

4 CARE & MAINTENANCE

5 Documents / Resources

5.1 References

GENERAL INFORMATION

TECHNICAL DATA

This product is supplied with an integrated LED light source. The expected lifespan of the LED light source is 25,000 hours, which equates to 8-10 years of general use. When the light source reaches its end of life, the whole luminaire should be replaced.

FITTING TYPE | Integrated LED POWER (W) | 5 W COLOUR TEMPERATURE | 2800K warm white

ATTENTION

Ensure that the power supply to the circuit has clearly been turned OFF before installing the product. In some countries, electrical installation must be carried out by authorised electricians/ contractors; please check with your local authority for guidance.

The product must not be modified in any way.

HAY accepts no responsibility for any products that have been modified or tampered with. The external flexible cable or cord of this luminaire cannot be replaced. If the cord is damaged, the luminaire should be replaced. This lamp is designed for indoor use only.

NOTE | This equipment has been tested and found to comply with the limits for a Class B digital device, pursuant to part 15 of the

FCC Rules. These limits are designed to provide reasonable protection against harmful interference in a residential installation. This equipment generates, uses and can radiate radio frequency energy and, if not installed and used in accordance with the instructions, may cause harmful interference to radio communications.

However, there is no guarantee that interference will not occur in a particular installation. If this equipment does cause harmful interference to radio or television reception, which can be determined by turning the equipment off and on, the user is encouraged to try to correct the interference by one or more of the following measures:

- Reorient or relocate the receiving antenna.
- Increase the distance between the equipment and receiver.
- Connect the equipment to an outlet on a different circuit to the one the receiver is connected to.
- Consult the dealer or an experienced radio/TV technician for help.

CAUTION | Changes or modifications to this unit not expressly approved by the party responsible for compliance could void the user's authority to operate the equipment. This device complies with part 15 of the FCC Rules. Operation is subject to the following two conditions:

- This device may not cause harmful interference.
- This device must accept any interference received, including interference that may cause undesired operation.

CARE AND MAINTENANCE

The product can be cleaned with a soft damp cloth and mild detergent, or a dry microfibre cloth. Do not use alcohol or any other solvents to clean the product and avoid using abrasive or rough sponges. Ensure that the power supply has been turned OFF before cleaning the product.



PARTS

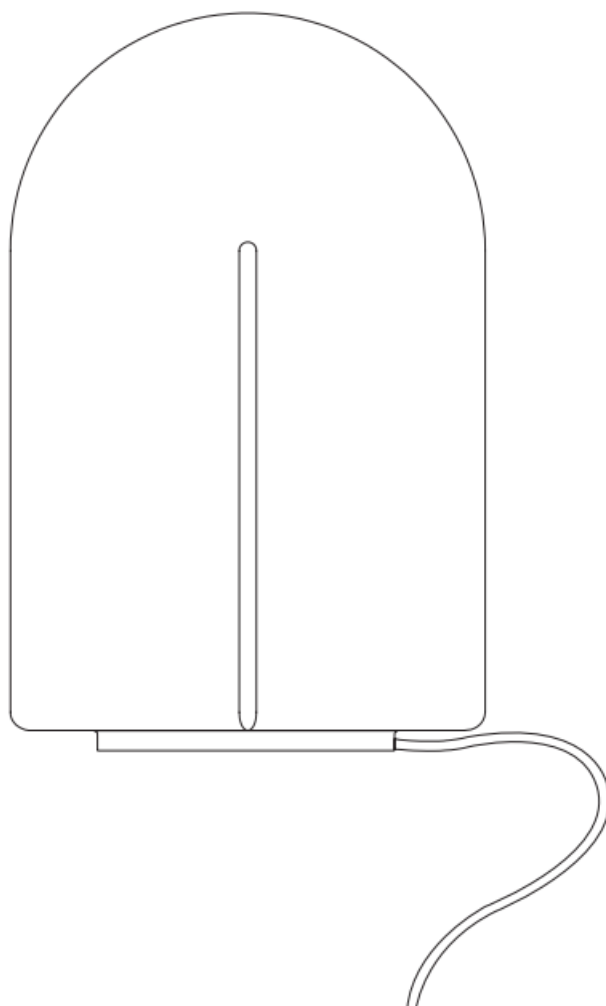

Lamp Shade

NB: Comes in three different sizes

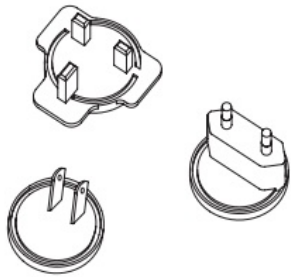

Adapter

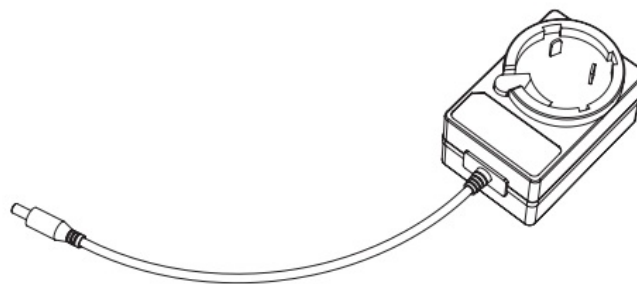

Power supply

Unpack all the parts and check that you have received all the parts listed.
Plug the trailing cable into the power supply.
Attach the correct adapter for your region.
The lamp is now ready for use.

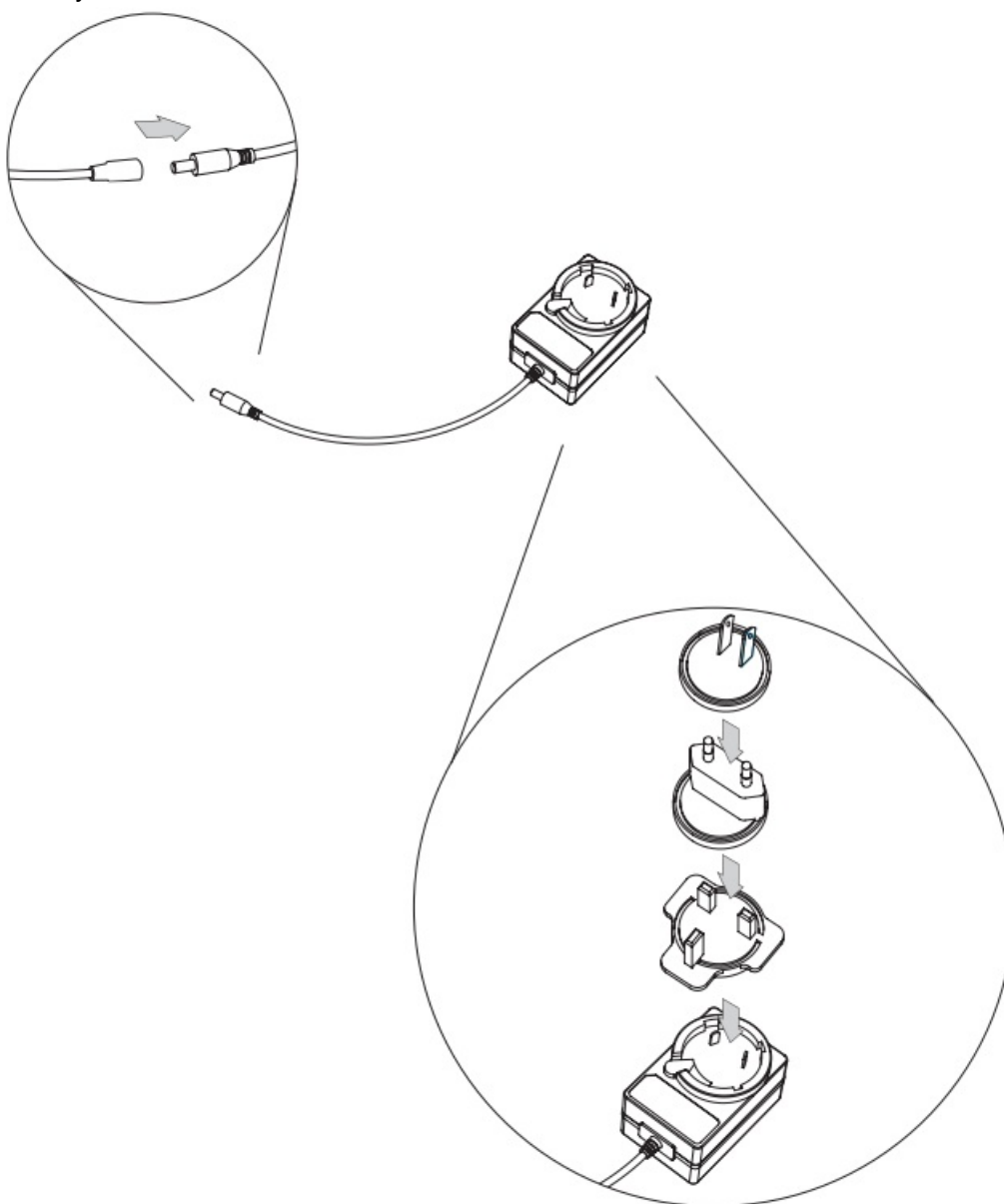

The lamp is now ready to use.

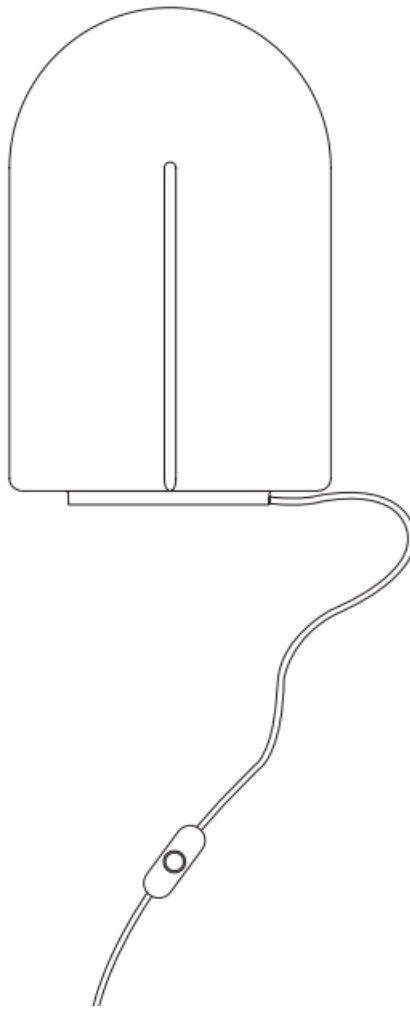

NOTE

If your lamp needs any parts replacing, it is possible to disassemble the light engine from the glass. Make sure the lamp is disconnected from the power supply. Turn it upside down and unscrew the two screws slightly but not all the way.

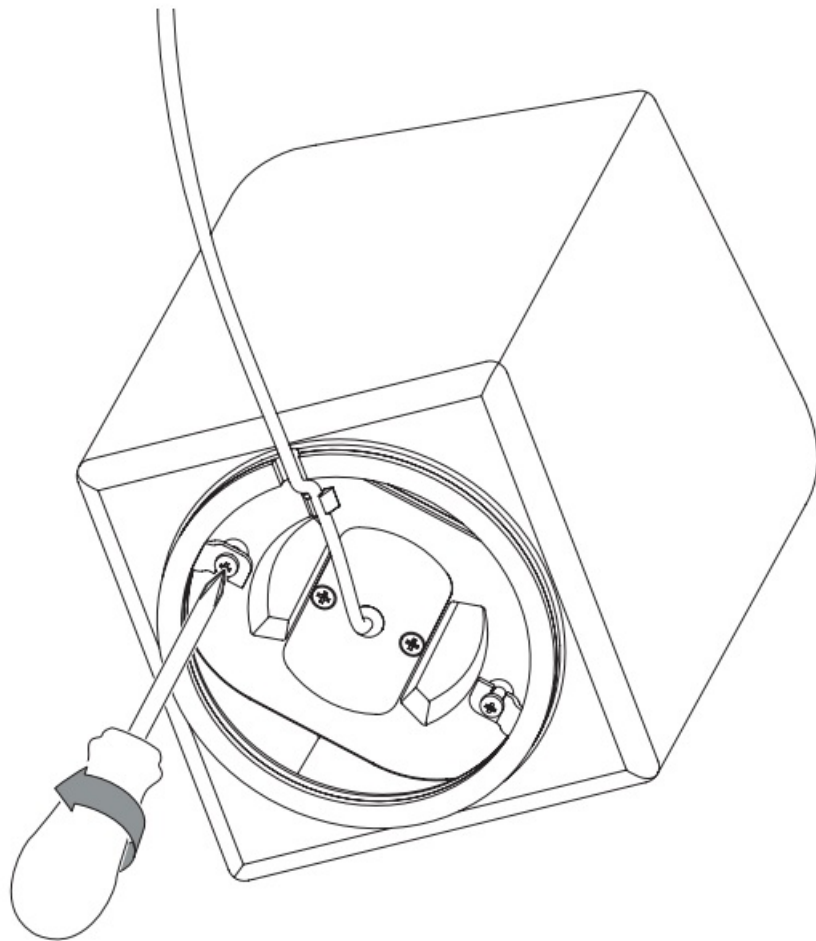

Turn the light engine counterclockwise until the two screws are free from the hooks on the bracket, tilt the light engine and pull it out from the glass shade.
Now you can replace any broken parts with original HAY replacement parts.

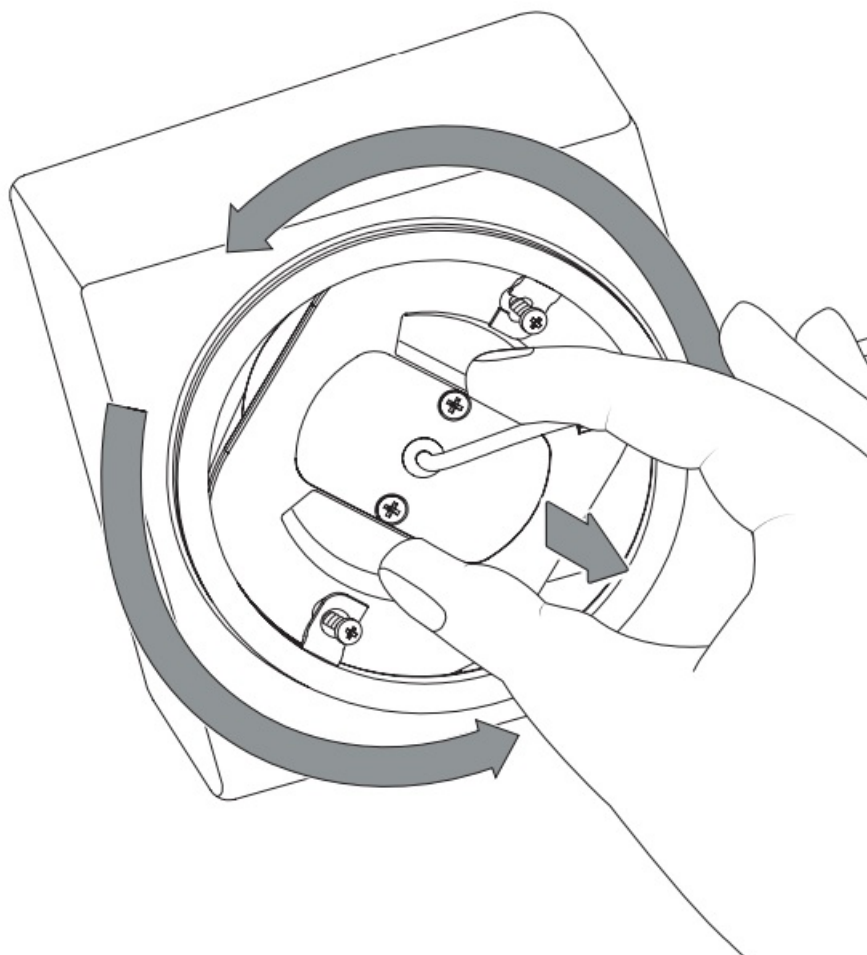

Place the light engine back into the glass shade and turn clockwise, locking the two screws into the hooks on the bracket.

Then use a screwdriver to fasten the two screws to ensure the light is properly assembled. The lamp is now ready to use again.

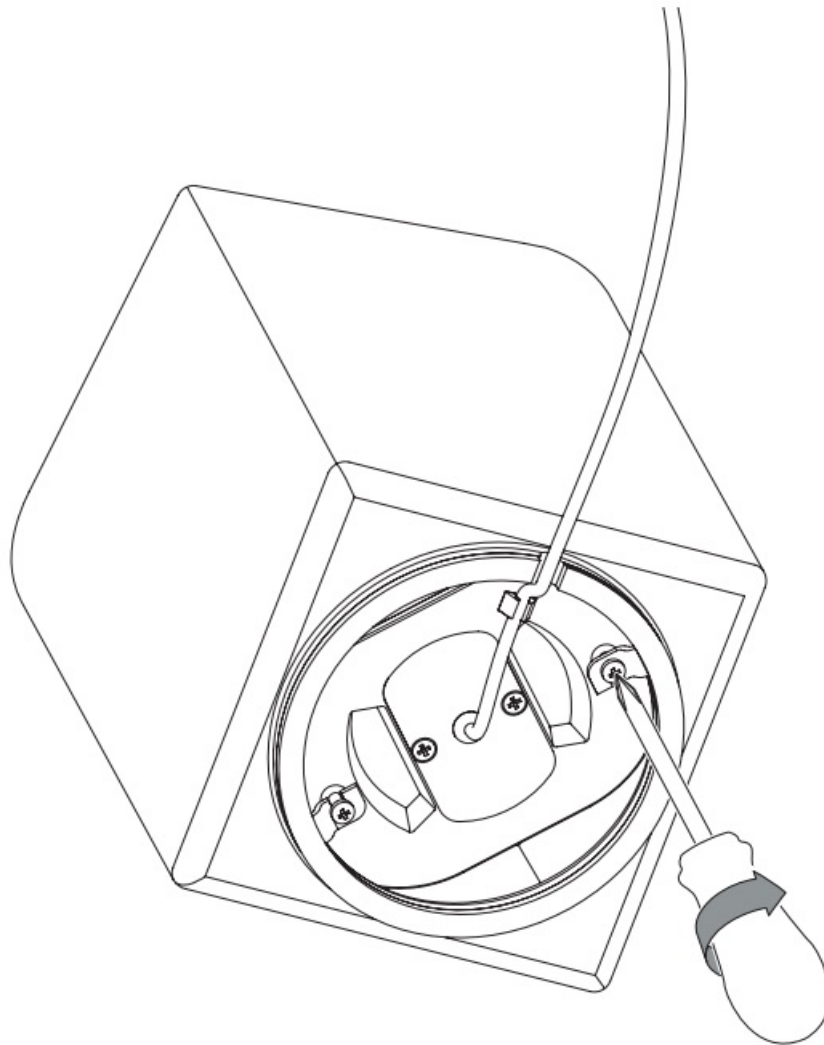

CARE & MAINTENANCE

Our Care & Maintenance offers guidance for optimal maintenance of your HAY product. It includes advice and instructions on cleaning and caring for specific materials to prolong the life of your lighting.



<https://hay.dk/hay-care-and-maintenance>

Please find our Care & Maintenance guide by scanning the QR code



<https://hay.presscloud.com/digitalshowroom/#/gallery/parade-table-lamp>

You can find more relevant information on Parade Table Lamp Collection by scanning the QR code
You can also find the same information here hay.dk/downloads

HAY

Havnen 1 8700 Horsens Denmark

+45 4282 0282 / hay@hay.com

www.hay.com

Documents / Resources



[HAY Parade Table Lamp](#) [pdf] Instruction Manual
Parade Table Lamp, Parade, Table Lamp, Lamp

References

- HAY [HAY.dk – latest products, designer news and retailer info](#)
- HAY [HAY - Danish-Inspired Furniture + Accessories for Modern Living](#)