



HAY LBM LED Table Lamp Instruction Manual

[Home](#) » [HAY](#) » HAY LBM LED Table Lamp Instruction Manual 

Contents

- [1 HAY LBM LED Table Lamp](#)
- [2 Product Information](#)
- [3 PARTS](#)
- [4 CARE & MAINTENANCE](#)
- [5 Documents / Resources](#)
 - [5.1 References](#)
- [6 Related Posts](#)



HAY LBM LED Table Lamp



Product Information

The LBM Table Lamp is a modern and stylish lamp designed for indoor use. It comes with an integrated LED module that emits a warm white light with a color temperature of 3000K. The LED module has a power rating of 8W and produces a brightness of 300-350 lumens. The expected lifespan of the LED module is 25,000 hours, which is equivalent to 8-10 years of general use. When the LED module reaches its end of life, the entire luminaire should be replaced. The lamp is equipped with a three-step dimmable feature and a magnetic cable management system for convenient cable placement.

Technical Data

- Fitting Type: Integrated LED
- Power: 8W
- Color Temperature: 3000K warm white

Attention

Before installing the product, ensure that the power supply to the circuit has been turned off. In some countries, electrical installation must be done by authorized electricians or contractors, so please check with your local authority for guidance. The product should not be modified or tampered with. HAY does not accept responsibility for any modified or tampered products. The external flexible cable or cord of the luminaire cannot be replaced. If the cord is damaged, the entire luminaire should be replaced. The replacement of the light source should be done exclusively by a qualified electrician to avoid electrical hazards.

Care and Maintenance

To unpack and set up the table lamp:

1. Carefully unpack the lamp from its packaging. No assembly is required.
2. Reposition the magnetic cable management feature on the back of the lamp according to your preference for cable placement.
3. Plug the trailing cable into the power supply and attach the appropriate adapter for your region. The lamp is now ready to use.
4. The lamp's inline switch has a three-step dimmable feature. The first push sets the lamp to maximum

brightness, the second push to medium brightness, the third push to the lowest brightness, and the fourth push turns the lamp off.

For detailed instructions on cleaning and caring for the lamp to prolong its life, please refer to the Care & Maintenance guide provided. You can find the guide by scanning the QR code or visiting hay.dk/downloads.

For more information about the LBM Table Lamp, you can scan the QR code or visit hay.dk/downloads.

Contact Information:

HAY

Havnen 1 8700 Horsens

Denmark

+45 4282 0282

hay@hay.com

www.hay.com

Date: 04/05/2022

TECHNICAL DATA

This product is supplied with an integrated LED module (3000K warm white, 300-350 lumens). The expected lifespan of the LED module is 25,000 hours, which equates to 8-10 years of general use. When the light source reaches its end of life, the whole luminaire should be replaced.

FITTING TYPE | Integrated LED

POWER (W) | 8 W

COLOUR TEMPERATURE | 3000K warm white

ATTENTION

Ensure that the power supply to the circuit has clearly been turned OFF before installing the product. In some countries, electrical installation must be carried out by authorised electricians/contractors; please check with your local authority for guidance.

The product must not be modified in any way. HAY accepts no responsibility for any products that have been modified or tampered with. The external flexible cable or cord of this luminaire cannot be replaced. If the cord is damaged, the luminaire should be replaced. The light source contained in this luminaire should be exclusively replaced by a qualified electrician in order to avoid an electrical hazard. This lamp is designed for indoor use only.

CARE AND MAINTENANCE

Do not use wet or damp cloths for cleaning and maintaining the shade. Please use a dry, lint-free cloth or duster to remove any dirt. The product can be cleaned with a soft damp cloth and mild detergent, or a dry microfibre cloth. Do not use alcohol or any other solvents to clean the product and avoid using abrasive or rough sponges. The external flexible cable or cord of this luminaire cannot be replaced; if the cord is damaged, the luminaire shall be destroyed. Ensure that the power supply has been turned OFF before cleaning the product.

PARTS

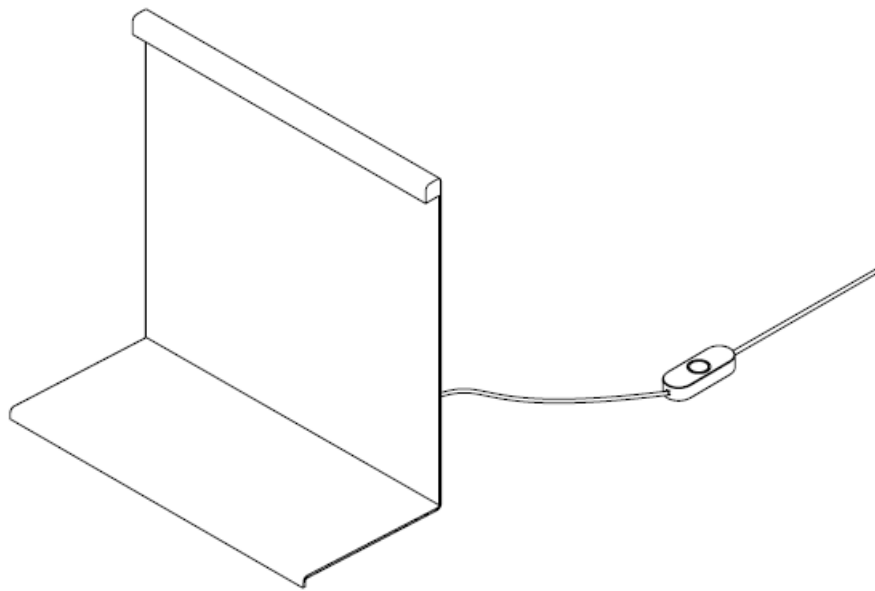
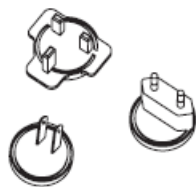
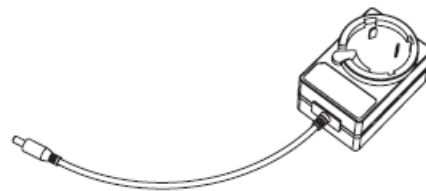

Table lamp



Adapter



Power supply

Unpack the table lamp carefully from its packaging. There is no assembly required for this lamp.

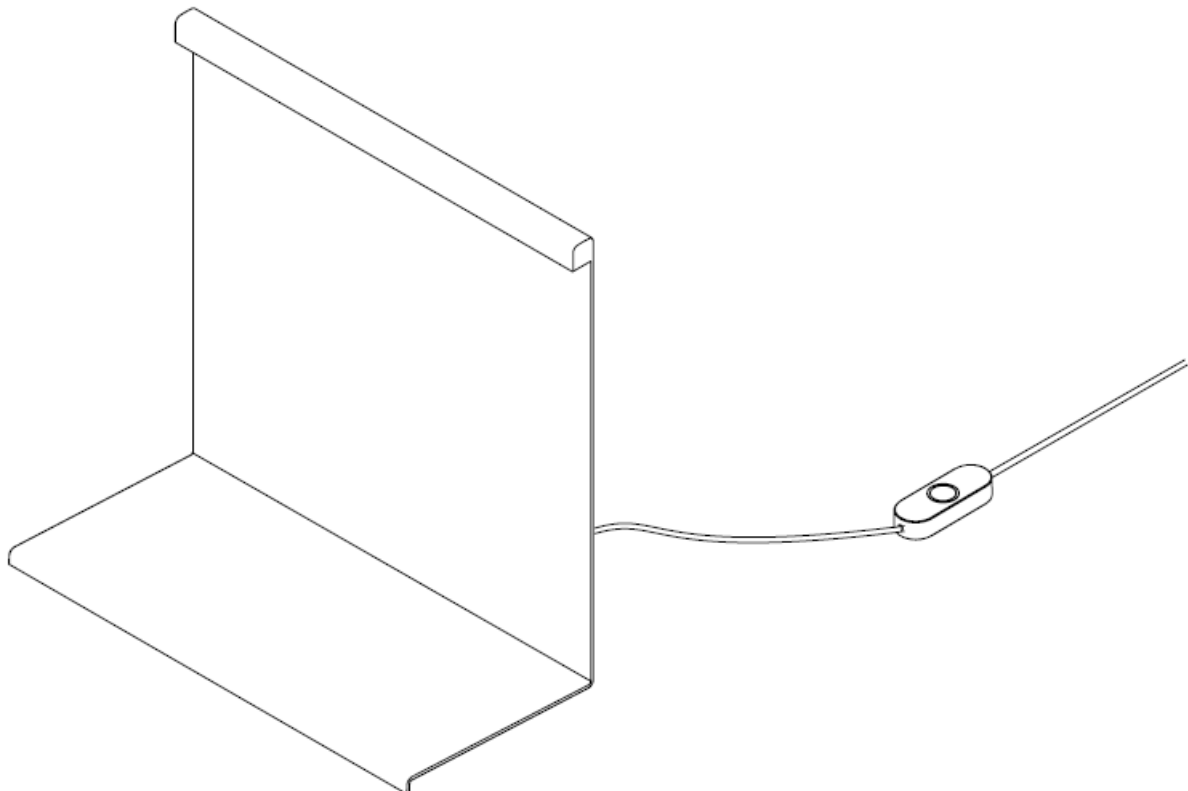

Mounted on the back of the lamp is a magnetic cable management feature. This can be manually repositioned anywhere on the backside of the lamp, depending on how you would like the cable to trail away from the lamp.

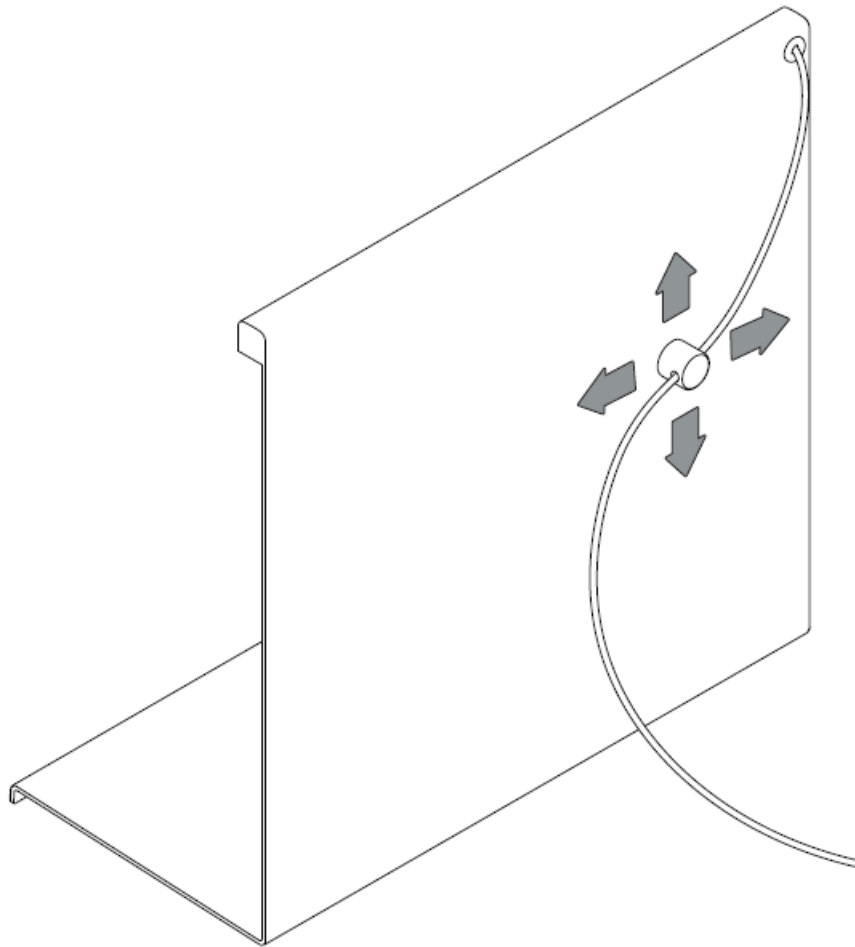

Plug the trailing cable into the power supply. Attach the correct adapter for your region. The lamp is now ready to use.

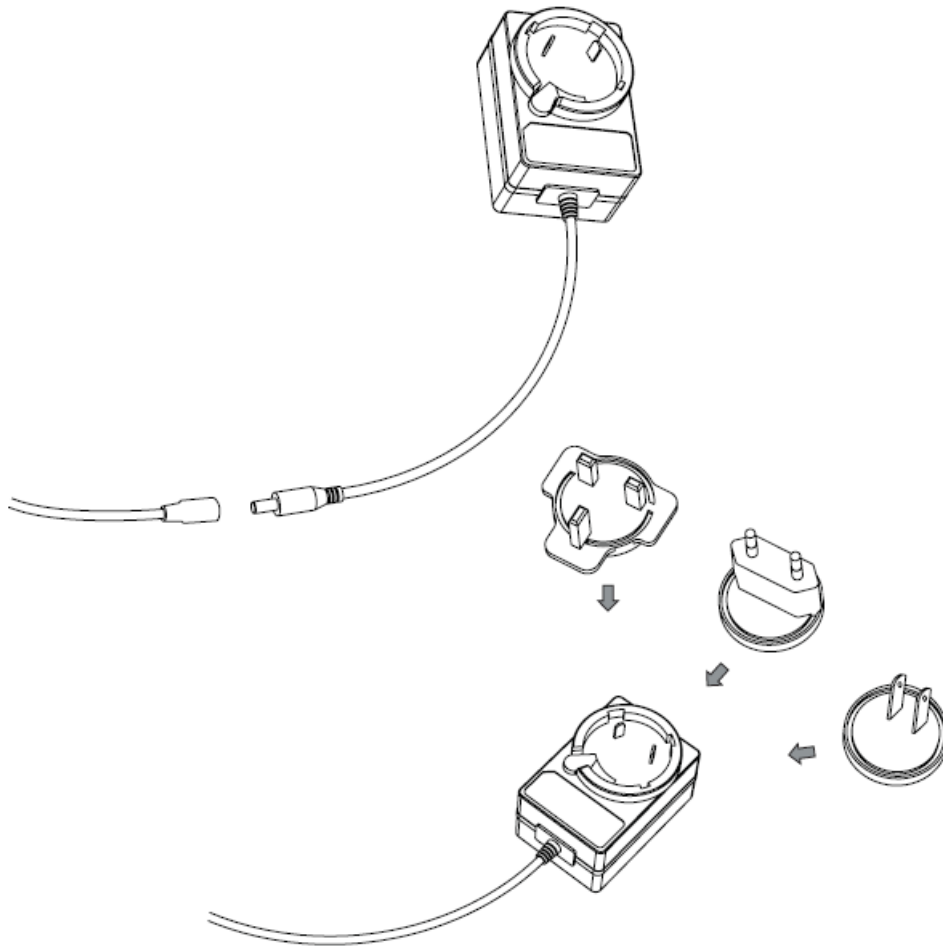

The lamp's inline switch has a three-step dimmable feature. First push sets the lamp to maximum brightness, second push to medium brightness and the third push to lowest brightness. Fourth push turns the lamp off.

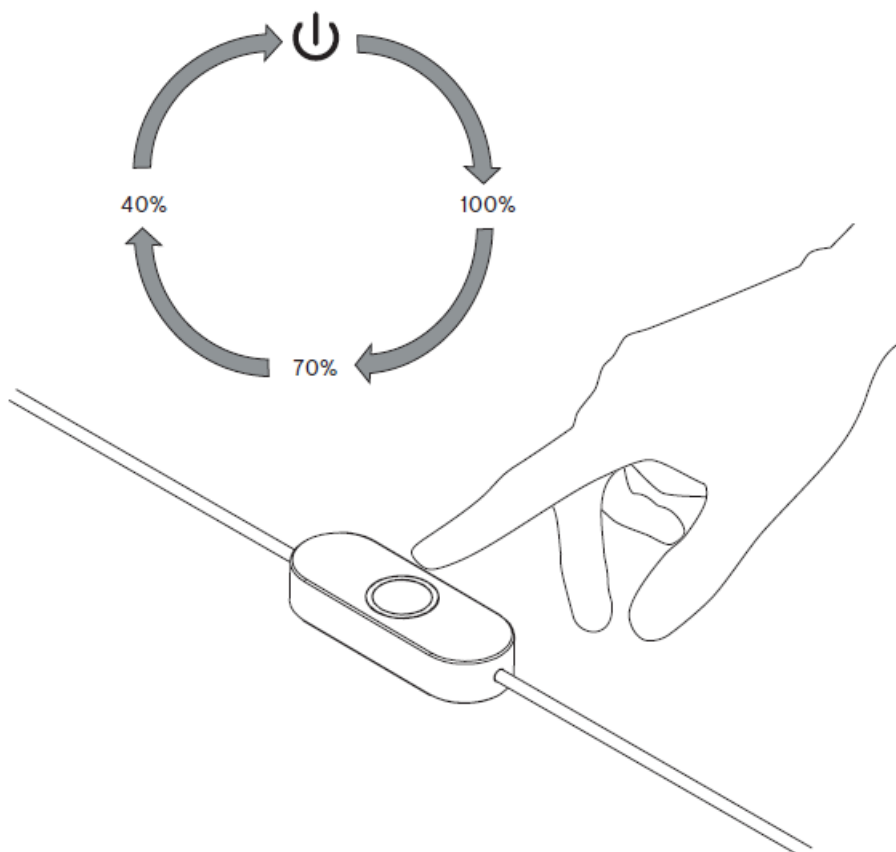

CARE & MAINTENANCE

Our Care & Maintenance offers guidance for optimal maintenance of your HAY product. It includes advice and instructions on cleaning and caring for specific materials to prolong the life of your lighting.



Please find our Care & Maintenance guide by scanning the QR code



You can find more relevant information on LBM Table Lamp by scanning the QR code

You can also find the same information here [hay.dk/downloads](https://www.hay.dk/downloads)

Havnen 1 8700 Horsens Denmark
+45 4282 0282 / hay@hay.com
www.hay.com

Documents / Resources



[HAY LBM LED Table Lamp](#) [pdf] Instruction Manual
LBM LED Table Lamp, LBM, LED Table Lamp, Table Lamp, Lamp

References

- HAY [HAY.dk – latest products, designer news and retailer info](#)
- HAY [HAY Summer Sale: 15% Off Contemporary Furniture & Accessories](#)
- HAY [HAY.dk – latest products, designer news and retailer info](#)