



Havit Lighting RGBCW LED Strip Touch Panel Controller Installation Guide

[Home](#) » [Havit Lighting](#) » Havit Lighting RGBCW LED Strip Touch Panel Controller Installation Guide 

Contents

- [1 Havit Lighting RGBCW LED Strip Touch Panel Controller](#)
- [2 Function introduction](#)
- [3 Product Data](#)
- [4 Wiring diagram](#)
- [5 Operation](#)
- [6 Installation](#)
- [7 FAQ](#)
- [8 Documents / Resources](#)
 - [8.1 References](#)



Havit Lighting RGBCW LED Strip Touch Panel Controller



Important: Read All Instructions Prior to Installation

Function introduction

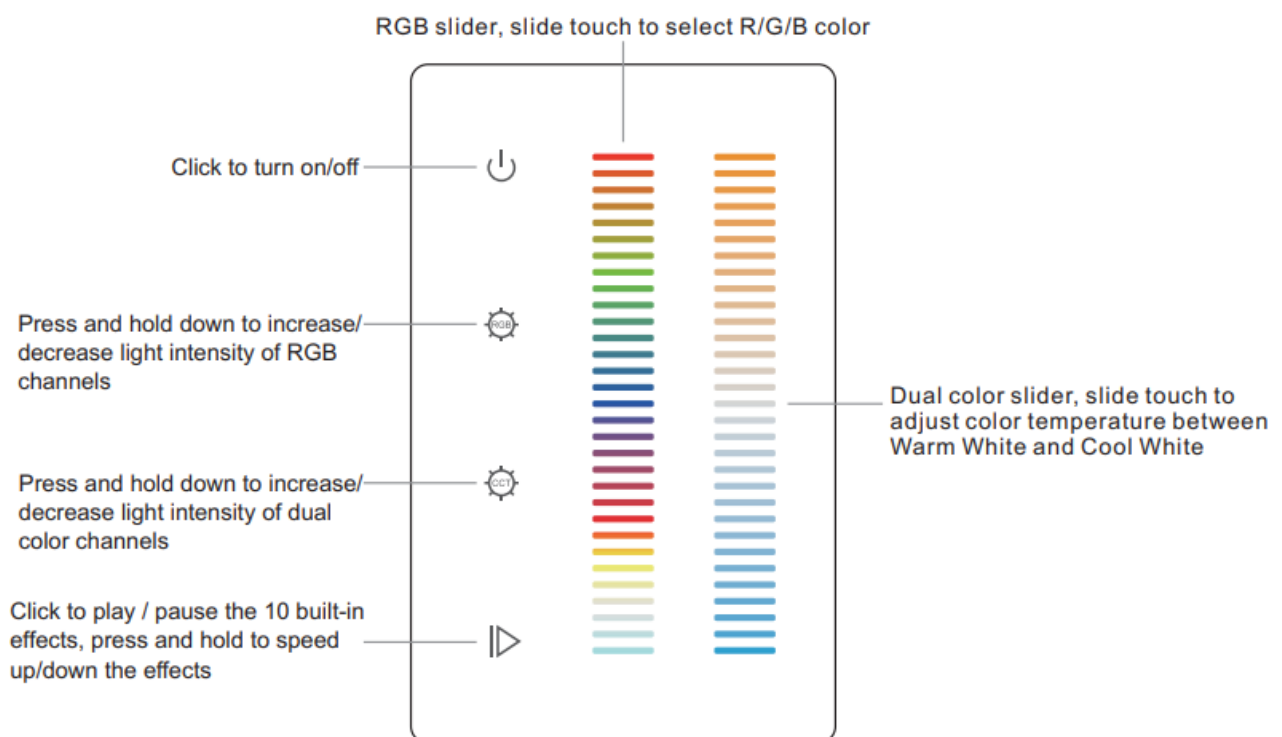

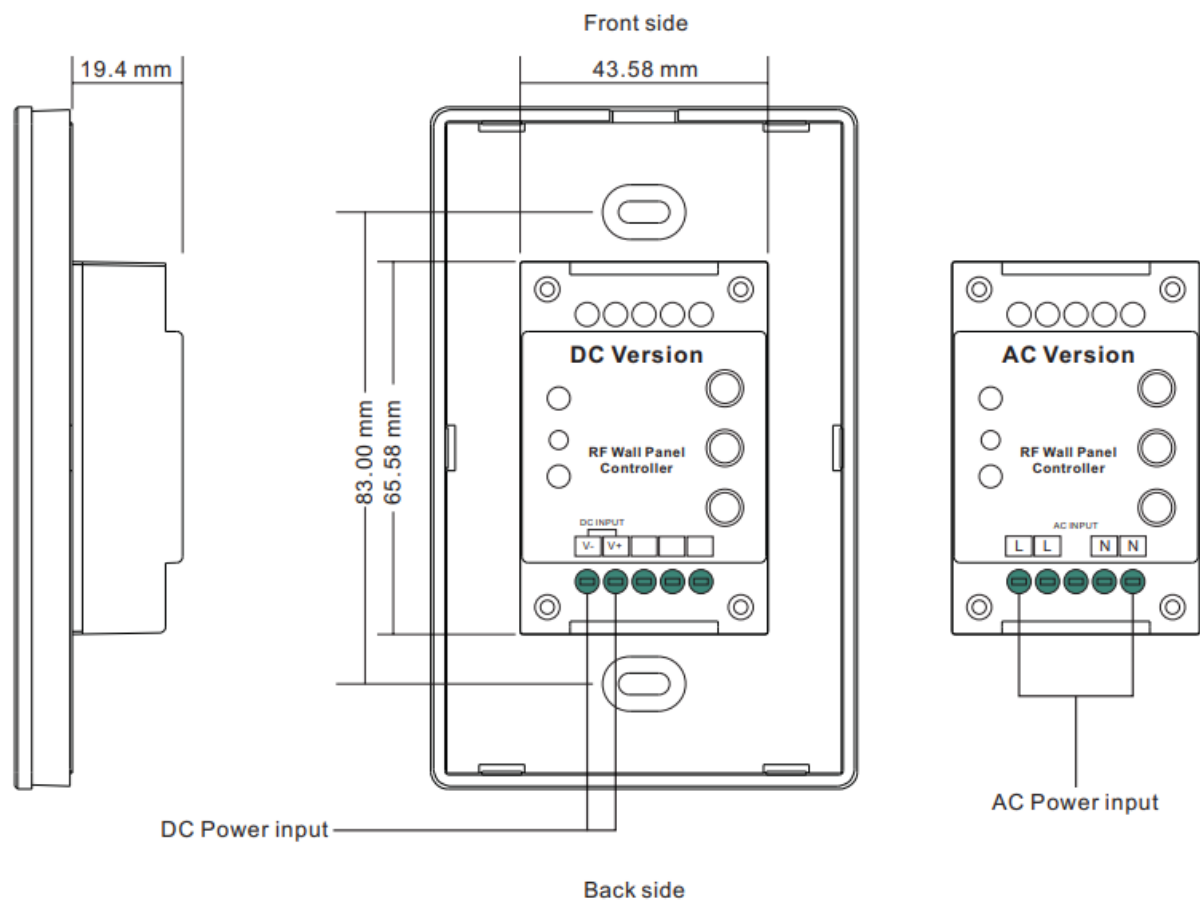

Product Data

DC Version

AC Version

Output Signal	RF signal	RF signal
Power Supply	12-24VDC	100-240VAC
Power consumption	< 20 mA	< 15 mA
Operating temperature	0-40°C	0-40°C
Relative humidity	8% to 80%	8% to 80%
Dimensions	75x120x29.1mm	75x120x29.1mm

- Touch-sensitive
- Glass interface(white & black)
- Compatible with all universal series RF receivers, radio frequency: 916.5MHz
- Control RGB+CCT color
- Control 1 zone of RF receiver
- Waterproof grade: Ip20

Safety & Warnings

- DO NOT install with power applied to device.
- DO NOT expose the device to moisture.

Wiring diagram

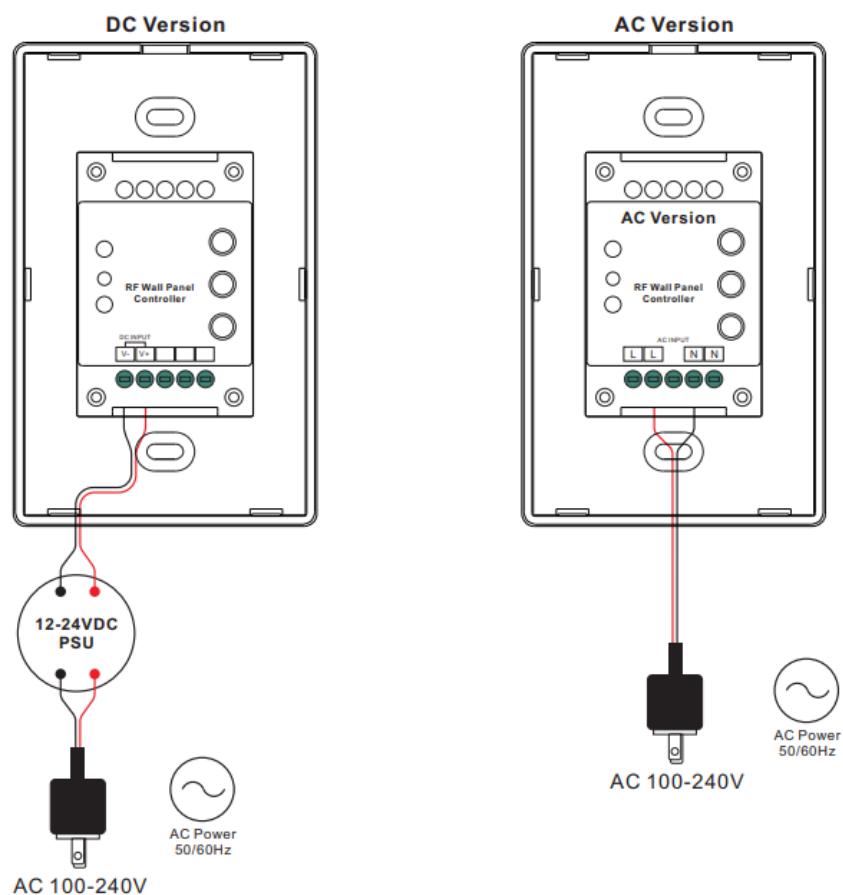

Operation

1. Do wiring the wall panel & RF receiver according to wiring diagram (please refer to the instructions of RF receiver that you would like to pair with)
2. Power on, then touch the button  to turn on the controller, indicator of the controller turned blue

Pair with RF receiver

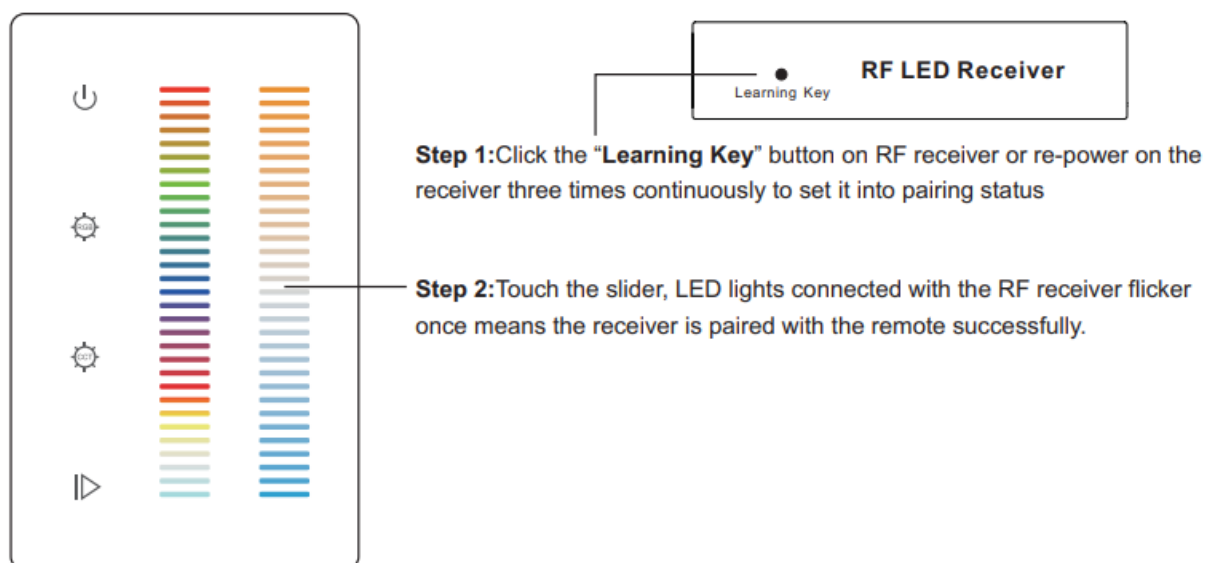

Built-in 10 color-changing modes are as follows:

- Mode 1: Any two colors of RGB mix fade-in & fade-out
- Mode 2: RGB three colors mix fade-in & fade-out
- Mode 3: RGB three colors mix fade-out & fade-in
- Mode 4: RGB flash
- Mode 5: RGB three colors fade-in & fade-out successively
- Mode 6: RGB three colors fade-in successively
- Mode 7: RGB three colors fade-out successively
- Mode 8: RGB three colors jump changing successively
- Mode 9: R&B two colors mix fade (R in B out), then G fade-in, then R&B mix fade (R out B in), then G fade-out
- Mode 10: B fade-out, then G&B mix fade (G out B in), then R&G mix fade (R out G in), then R fade-in

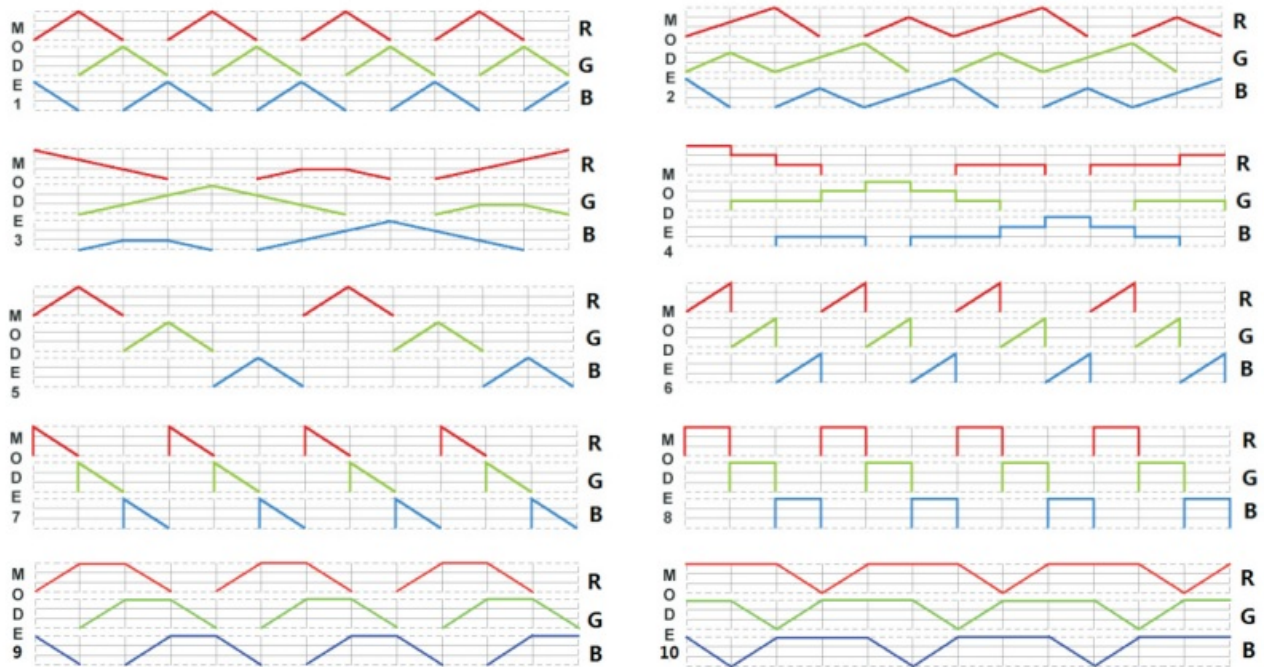

Installation

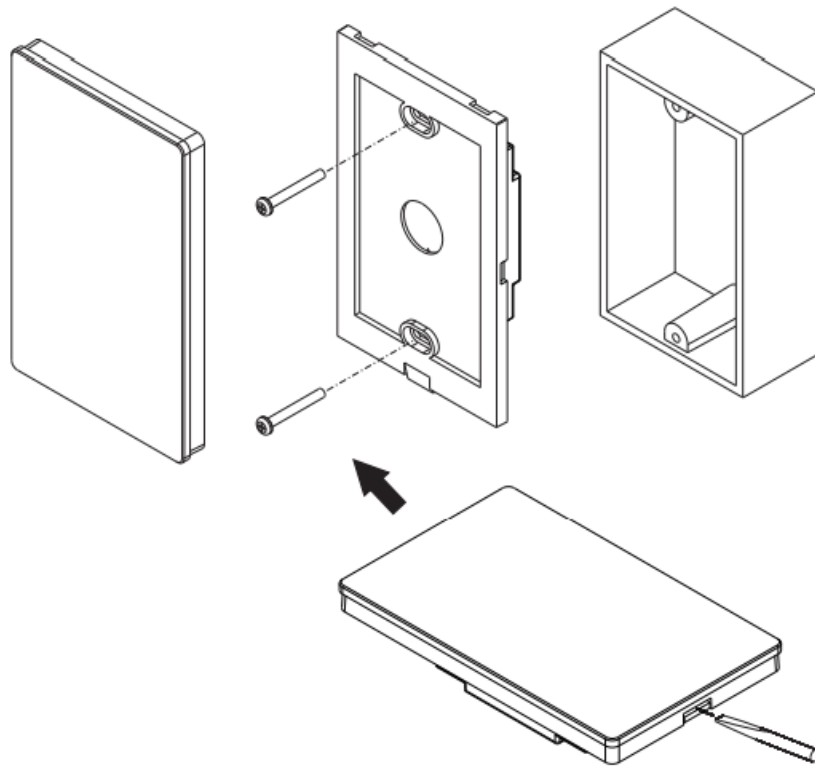

FAQ

How do I adjust the color temperature using the dual-color slider?

To adjust the color temperature between Warm White and Cool White, simply slide-touch the dual color slider on the controller.

How can I increase/decrease the light intensity of the RGB channels?

To adjust the light intensity of the RGB channels, press and hold down on the RGB slider to increase or decrease the intensity.

Documents / Resources

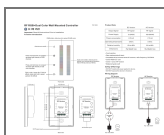

[Havit Lighting RGBCW LED Strip Touch Panel Controller](#) [pdf] Installation Guide
RGBCW LED Strip Touch Panel Controller, RGBCW, LED Strip Touch Panel Controller, Touch Panel Controller, Panel Controller, Controller

References

- [User Manual](#)

[Manuals+](#). [Privacy Policy](#)

This website is an independent publication and is neither affiliated with nor endorsed by any of the trademark owners. The "Bluetooth®" word mark and logos are registered trademarks owned by Bluetooth SIG, Inc. The "Wi-Fi®" word mark and logos are registered trademarks owned by the Wi-Fi Alliance. Any use of these marks on this website does not imply any affiliation with or endorsement.