

Havit Lighting HV9105-1009-5C 4 in 1 RF+WiFi LED Controller Installation Guide

[Home](#) » [Havit Lighting](#) » Havit Lighting HV9105-1009-5C 4 in 1 RF+WiFi LED Controller Installation Guide 

Havit Lighting HV9105-1009-5C 4 in 1 RF+WiFi LED

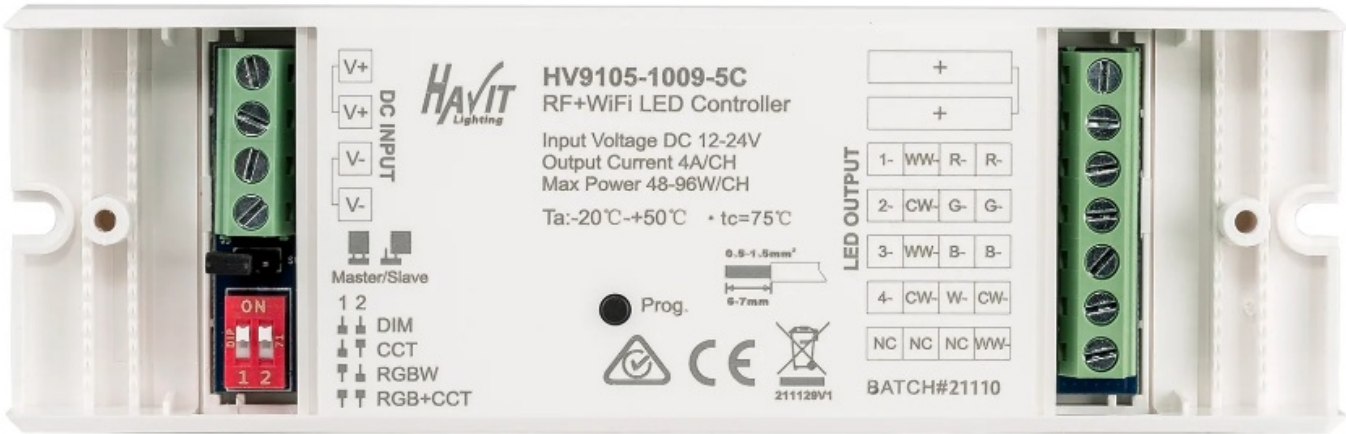

Important: Read All Instructions Prior to Installation

Contents

1

Function introduction

2

Product Data

3

Safety & Warnings

4

Operation

5

Wiring Diagram

6

Documents / Resources

7

Related Posts

Function introduction

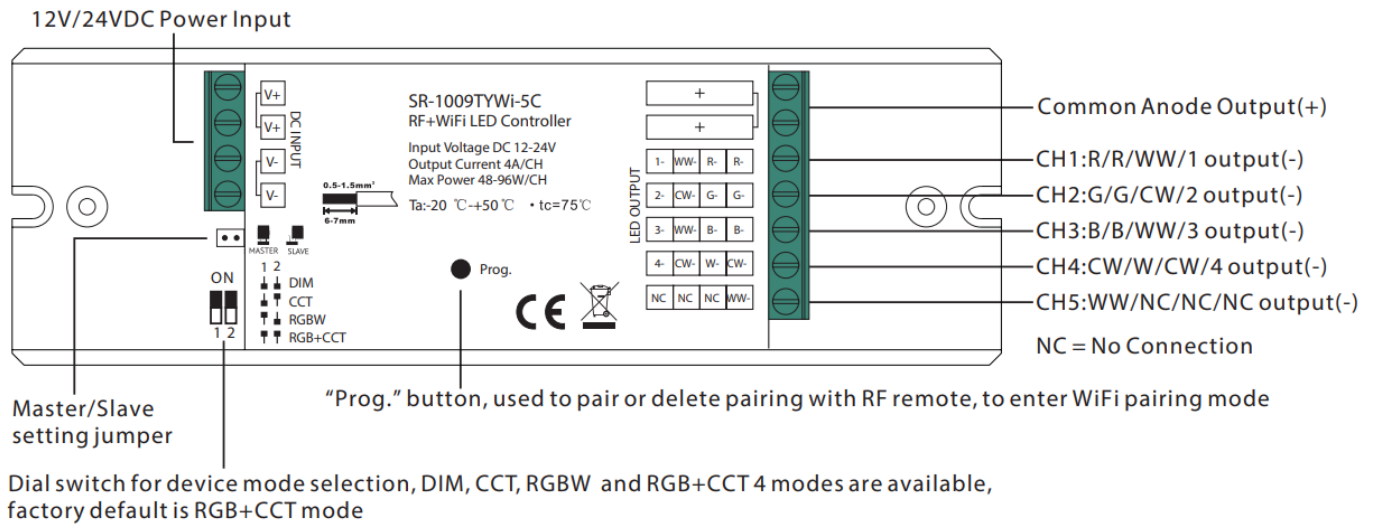

Product Data

No.	Input Voltage	Output Current	Output Power	Remarks	Size(LxWxH)
1	12-24VDC	5x4A	5x(48-96)W	Constant voltage	145×46.5×16mm

- RF+WiFi LED controller
- 5 channels 12/24V constant voltage output
- Max. 4Aoutput per channel
- RF frequency: 434/869.6/916.5MHz
- Compatible with universal legacy RF remotes
- Waterproof grade: IP20

Safety & Warnings

- DO NOT install with power applied to device.
- DO NOT expose the device to moisture.

Operation

1. Do wiring according to wiring diagram.
2. Pair the WiFi LED controller to the smart phone or tablet:

Step 1: Download the "TuyaSmart"APP from APP store or google play, and register an account as instructed, then log in the account. Please enable bluetooth on your smart phone in advanceDownload the "TuyaSmart"APP from APP store or google play, and register an account as instructed, then log in the account. Please enable bluetooth on your smart phone in advance

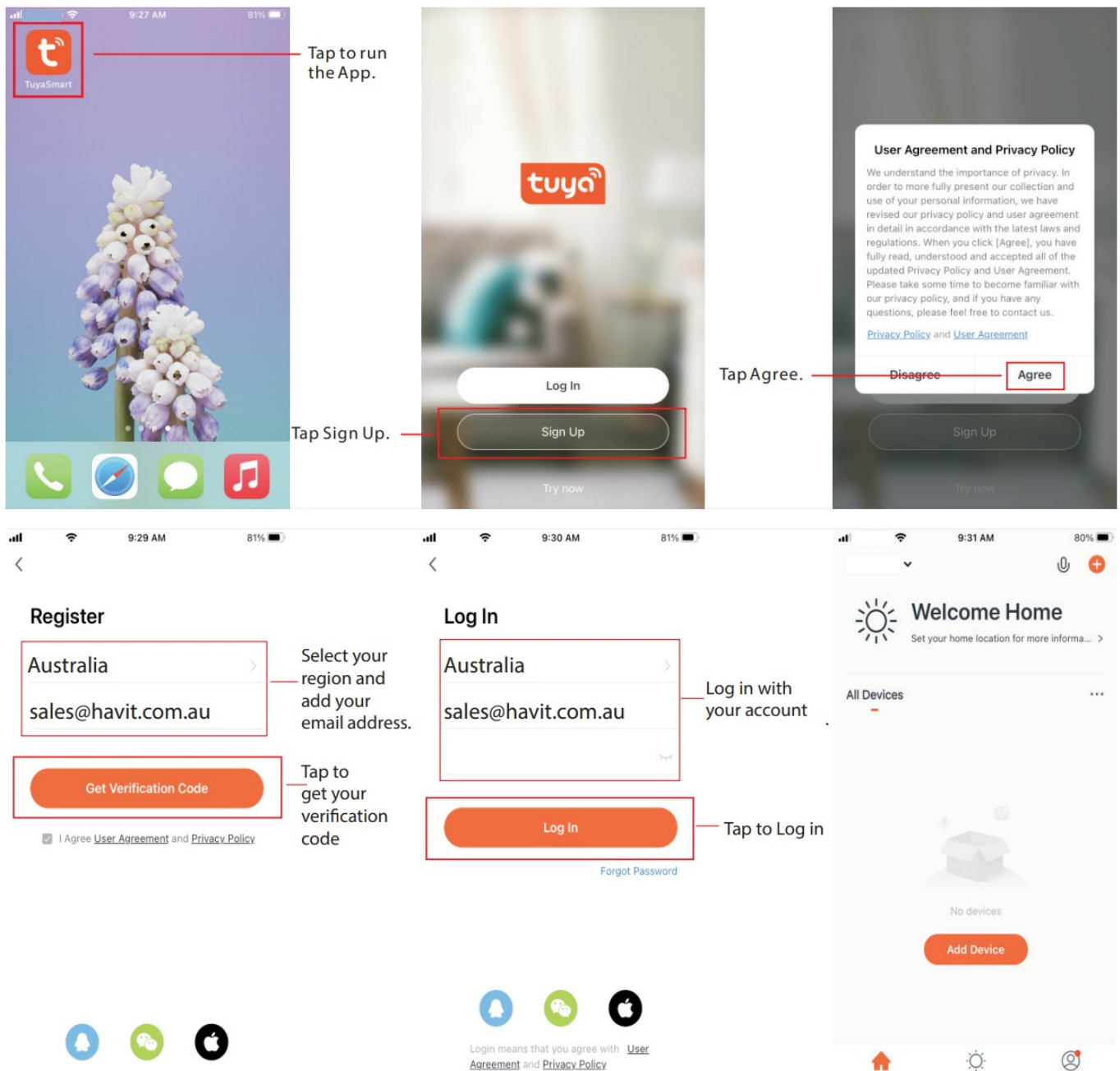

Step 2: Short press the “PROG” Button 5 times continuously (or turn off power of the controller 5 times) to reset the WIFI LED Controller to set it into PAIRING Mode, LED Light will blink rapidly, Then tap “Add Device” to pair the controller to WiF i LED controlle

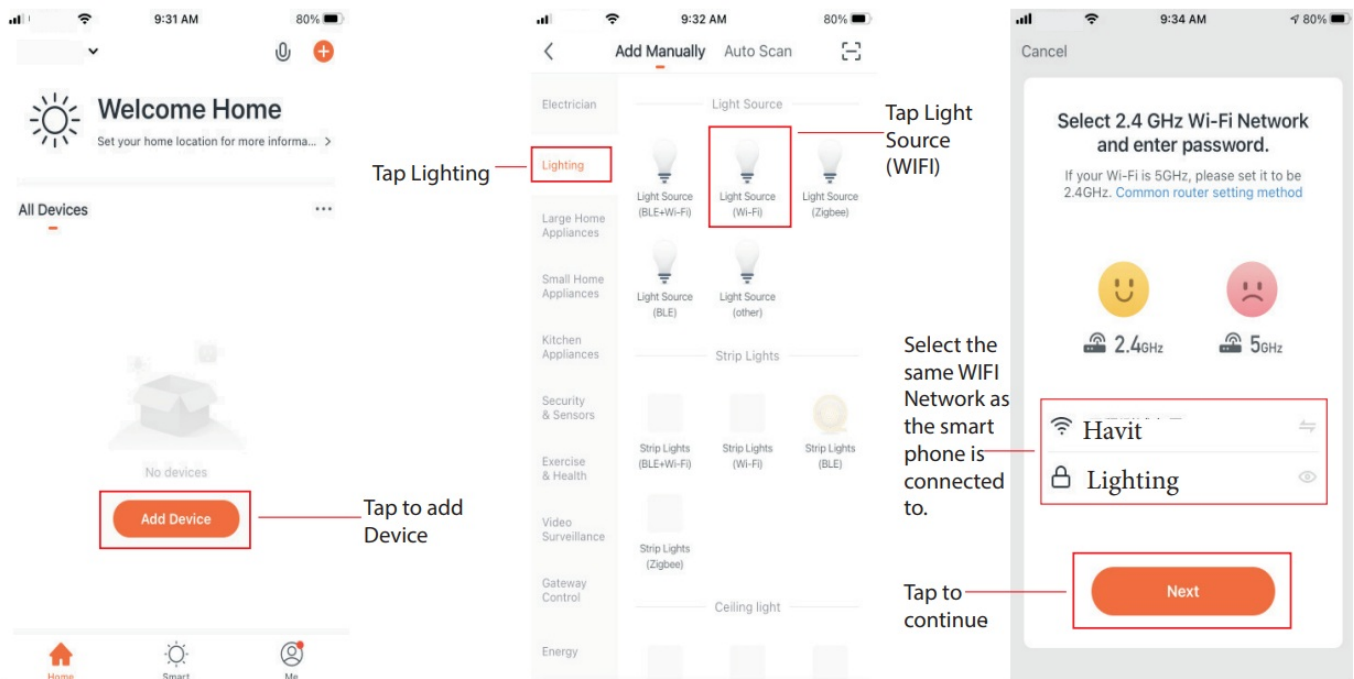

Wiring Diagram

1. RGB+CCT Mode

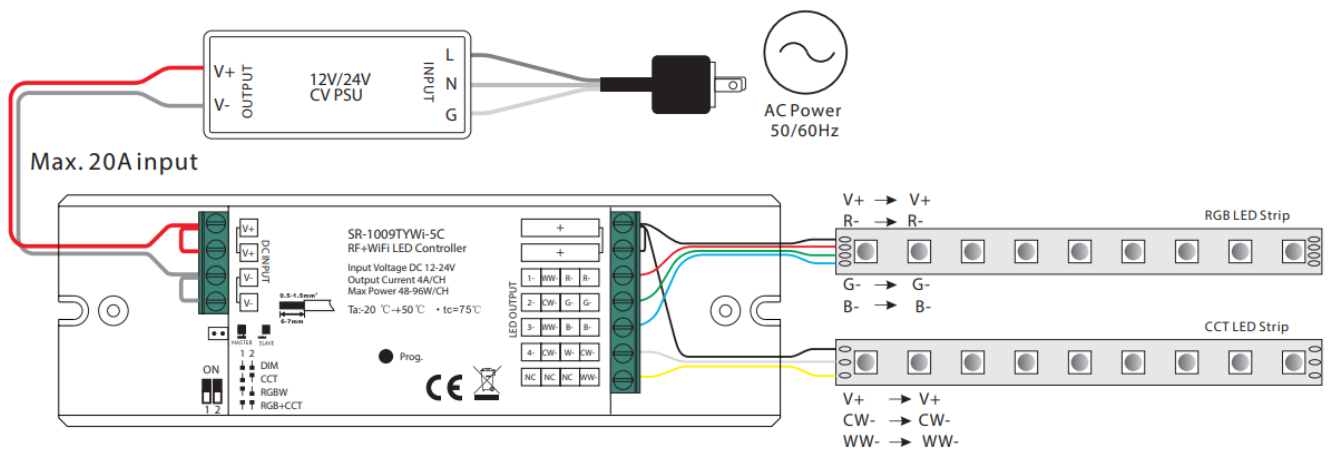

Note: please make sure the dip switches are at position for RGB+CCT mode as shown in above diagram

2. RGBW Mode

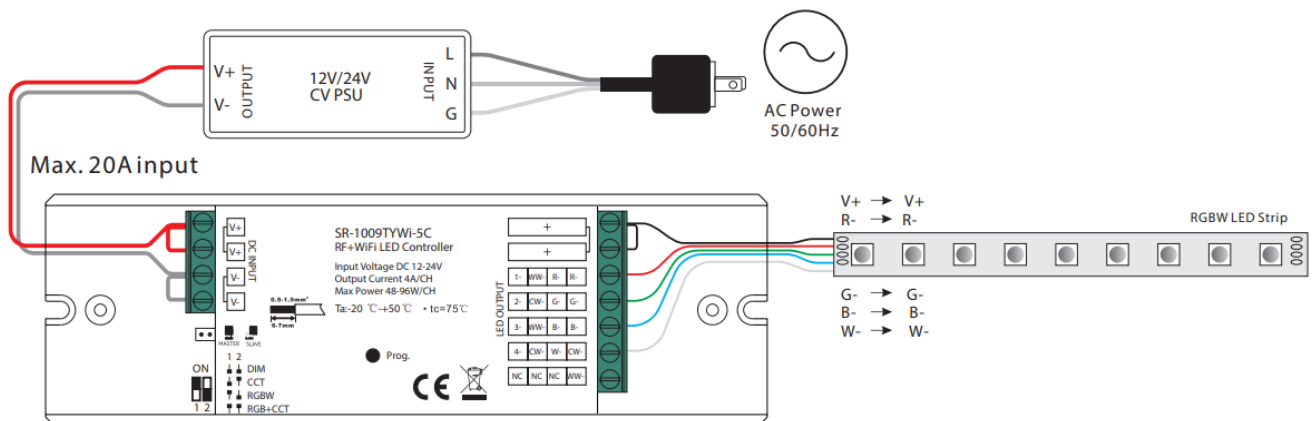

Note: please make sure the dial switches are at position for CCT mode as shown in above diagram.

3. CCT Mode

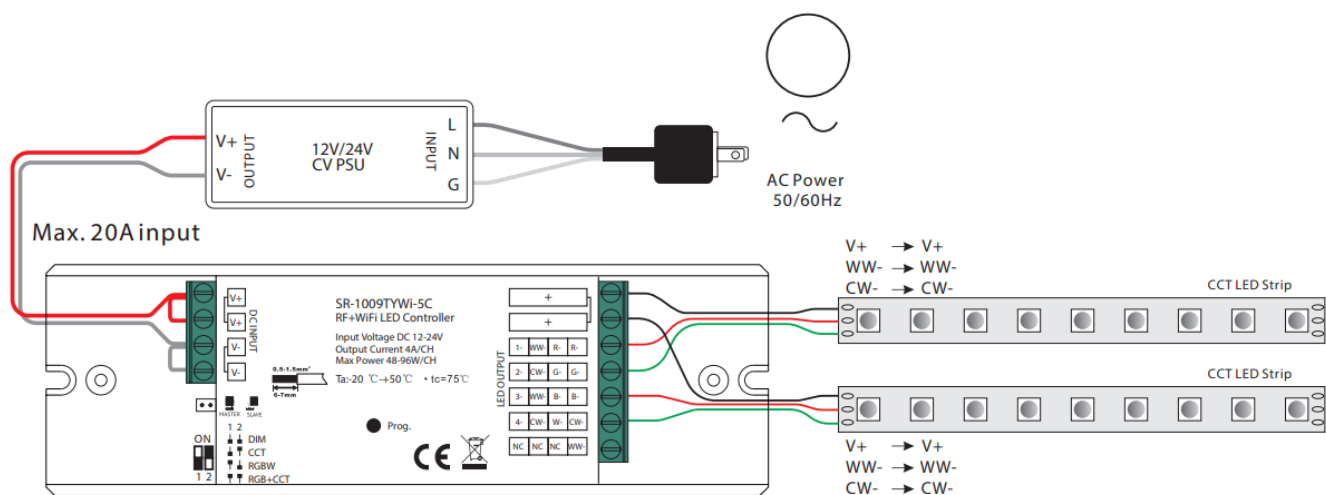

Note: please make sure the dial switches are at position for CCT mode as shown in above diagram.

4. DIM Mod e

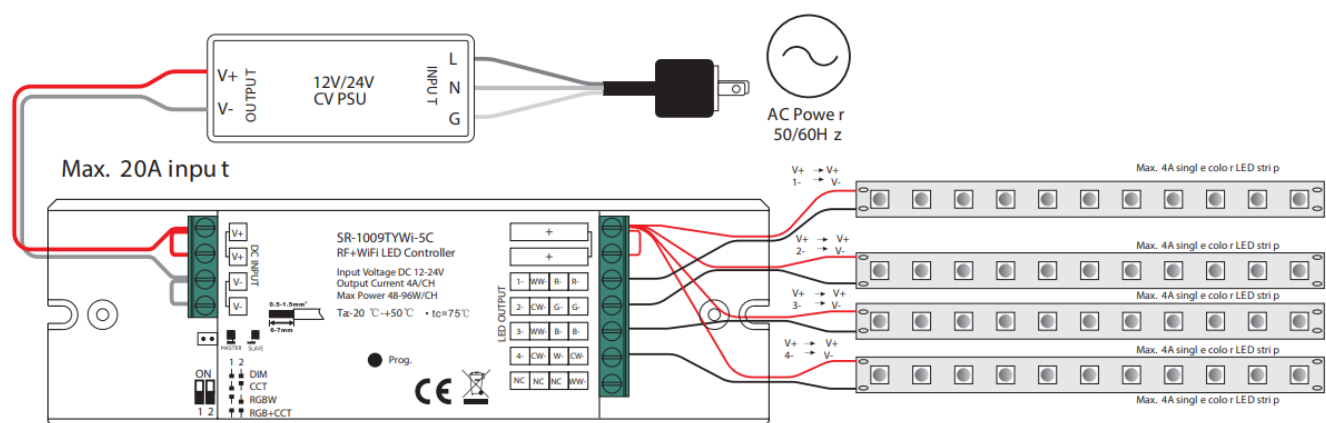

Note: please make sure the dip switches are at position for DIM mode as shown in above diagram .

HAVIT

Lighting

Documents / Resources



[Havit Lighting HV9105-1009-5C 4 in 1 RF+WiFi LED Controller \[pdf\] Installation Guide](#)
 HV9105-1009-5C, RF WiFi, RF WiFi LED Controller, LED Controller