



Hatchimals 6044069 Interactive HatchiBabies Ponette Instruction Manual

[Home](#) » [Hatchimals](#) » Hatchimals 6044069 Interactive HatchiBabies Ponette Instruction Manual 

Contents

- 1 Hatchimals 6044069 Interactive HatchiBabies Ponette
- 2 BATTERY SAFETY INFORMATION
- 3 CARE AND MAINTENANCE
- 4 GETTING STARTED
- 5 HOW TO INSTALL BATTERIES
- 6 GAMES
- 7 HATCHING TIME
- 8 MORE WAYS TO PLAY
- 9 HATCHIBABY
- 10 FREQUENTLY ASKED QUESTIONS
- 11 VIDEO – PRODUCT OVERVIEW
- 12 References
- 13 Related Posts



Hatchimals 6044069 Interactive HatchiBabies Ponette



BATTERY SAFETY INFORMATION

- Batteries are small objects.
- Replacement of batteries must be done by adults.
- Follow the polarity (+/-) diagram in the battery compartment.
- Promptly remove dead batteries from the toy.
- Dispose of used batteries properly.
- Remove batteries for prolonged storage.
- Only batteries of the same or equivalent type as recommended are to be used.
- DO NOT incinerate used batteries.
- DO NOT dispose of batteries in a fire, as batteries may explode or leak.
- DO NOT mix old and new batteries or types of batteries (i.e. alkaline/standard/rechargeable).
- Using rechargeable batteries is not recommended due to possible reduced performance.
- Rechargeable batteries are only to be charged under adult supervision.
- Replaceable-rechargeable batteries are to be removed from the toy before being charged.
- DO NOT recharge non-rechargeable batteries.
- DO NOT short-circuit the supply terminals.

CARE AND MAINTENANCE

- This product is intended for indoor use only.

- Do not use outdoors – dirt, grass, and cement will scratch the finish and/or block the sensors.
- Do not submerge the toy in water.
- Do not play around with water as this is a hazard and can cause a malfunction or damage to the electronic assemblies.
- Do not put any foreign objects in the sensors.
- Keep the toy away from direct sunlight and/or direct heat.

CONSUMER INFORMATION

Safety Precautions:

- Parental guidance is recommended.
- Regularly examine for damage to the toy.
- In the event of any damage, remove from use.
- This toy is not intended for children under 3 years old.
- Keep hands, hair, and loose clothing away from moving parts when the power switch is turned ON.
- Turn off the HATCHIMAL™ when not in use.
- During play, keep the HATCHIMAL™ in your sight so that you can supervise it at all times.
- Users should keep strict accordance with the instruction manual while operating the product.

NOTE: In an environment with electrostatic discharge, the toy may malfunction and require the user to reset the toy. To reset the product, turn it completely off, then turn it back on. If normal operation does not resume, move the product to another location and try again. To ensure normal performance, replace the batteries, as low batteries may not allow full function.



Requires 2 x 1.5 V AA (LR6) batteries (included). Batteries or battery packs must be recycled or disposed of properly. When this product has reached the end of its useful life, it should not be disposed of with other household waste. The Waste Electrical and Electronic Equipment Regulations require it to be separately collected so that it can be treated using the best available recovery and recycling techniques. This will minimize the impact on the environment and human health from soil and water contamination by any hazardous substances, decrease the resources required to make new products and avoid using up landfill space. Please do your part by keeping this product out of the municipal waste stream!



The “wheelie bin” symbol means that it should be collected as “waste electrical and electronic equipment”. You can return an old product to your retailer when you buy a similar new one. For other options, please contact your local council.

GETTING STARTED

When you first get your Hatchimal egg out of the box, to turn it on, remove the twist locks located at the bottom of the egg. Discard the twist locks.

THINGS YOU NEED TO KNOW

1. I only hatch once.
2. I cannot hatch without you holding me.

3. Before I hatch, you must play with me in my egg.
4. If you put my egg down on a flat surface you can see my egg rock
5. You can turn off the egg by tilting the egg upside down until the lullaby stops and the lights go out (approximately 25 seconds).
6. If my egg is off, hold the bottom of the egg to wake me up.
7. Each accessory is used for a different activity.
8. To use the rattle or the cuddle buddy, face the 'H' toward you and touch the accessory to my chest.

CARE AND SAFETY

- The egg is VERY FRAGILE. Always use two hands.
- Accidentally breaking the egg results in missing the hatching experience.
- To clean, wipe me gently with a clean damp cloth.
- Keep the top of the egg away from your eyes and face during the hatch.
- DO NOT submerge me in water. This will damage the electronics.

ACCIDENTALLY BROKE THE EGG?

Be very careful with the egg. If it accidentally breaks before I'm ready to hatch, you cannot put me back in the egg. If you break the egg before I'm ready to hatch, follow steps 5-6 on page 4, "HATCHING TIME!"

HOW TO INSTALL BATTERIES

For best results, put in new batteries after your Hatchimal hatches.

1. Open the battery door with a screwdriver.
2. If used batteries are present, remove these batteries from the unit. DO NOT remove or install batteries using sharp or metal tools. Install new batteries as shown in the polarity diagram (+/-) inside the battery compartment.
3. Replace battery door securely.
4. Check your local laws and regulations for correct recycling and/or battery disposal.

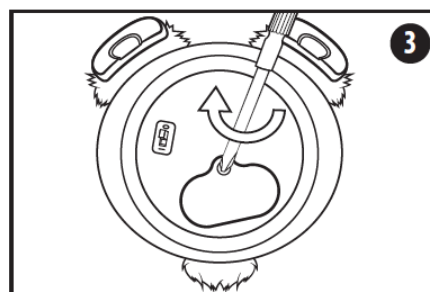
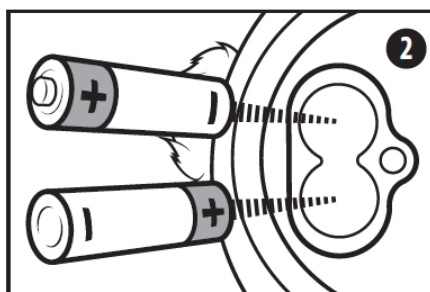
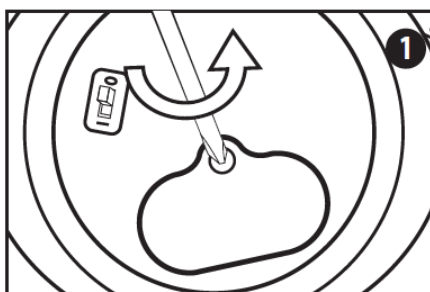

LOW BATTERIES

Eyes will flash red and orange and Hatchibaby™ will snore when batteries are low.

IN-EGG LOVE!

- Hold the bottom of the egg to hear my heartbeat and to cuddle me.

- Tickle the bottom of the egg with quick pats to make me wiggle and giggle.
- Tilt the egg backwards and hold it sideways to rock me to sleep.
- Quickly tilt the egg upside down and right side up to play with me.
- Tap on the egg and I'll tap back. I can only hear you when I'm quiet!
- Put the egg down on a flat surface to see it rock side to side.

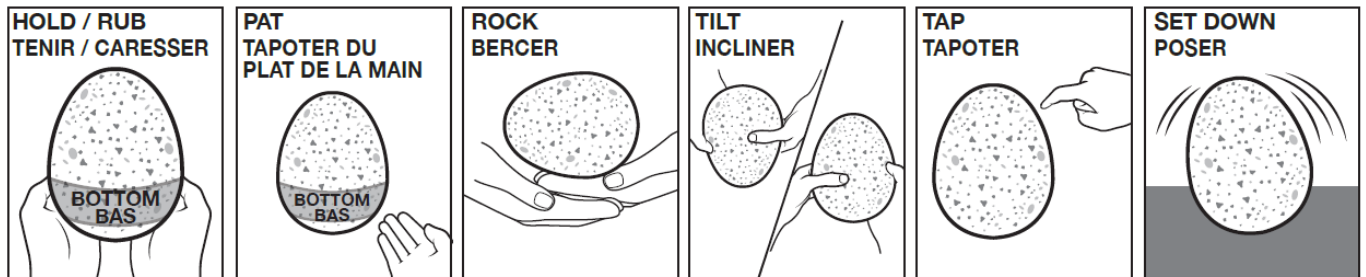

When you see rainbow eyes, I am ready to hatch! Don't worry, I cannot hatch without you there. For a complete list of in-egg activities, refer to the cheat sheet.

GAMES

BOUNCY BABY

1. Hold my right foot for 3 seconds to enter. My eyes will flash blue and I will say 'Yay' in my own Hatchimals language.
2. Once I say 'Ready, set, go', the music starts and it's time to play.
3. Bounce me backwards and forwards while the music is playing.
4. When the music stops, you must stop bouncing me.
5. Get 3 to win.

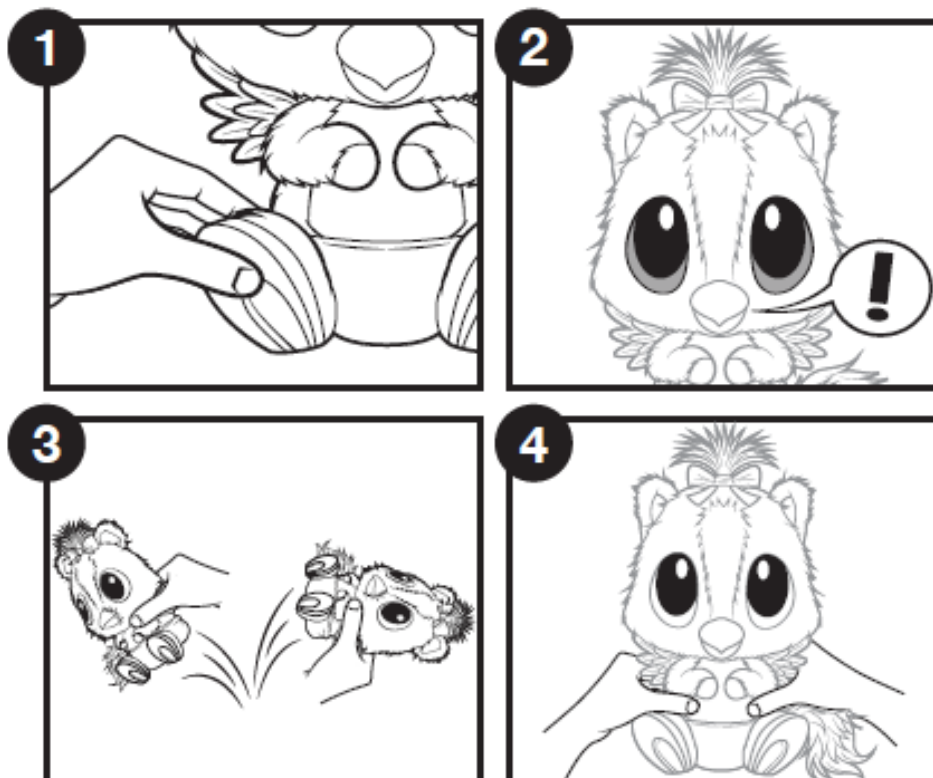

ANIMAL COLORS

1. Hold my left foot for 3 seconds to enter. My eyes will flash green and I will say 'Yay' in my own Hatchimals language.
2. Once I say 'Ready, set, go', I start making an animal sound and it's time to play.
3. Tap my forehead sensor when you see the color that goes with the animal sound I'm making.
 - Chick "Peep Peep" = yellow
 - Sheep "Bah Bah" = white
 - Frog "Ribbit Ribbit" = green
 - Pig "Oink Oink" = pink
4. Get 8 to win.

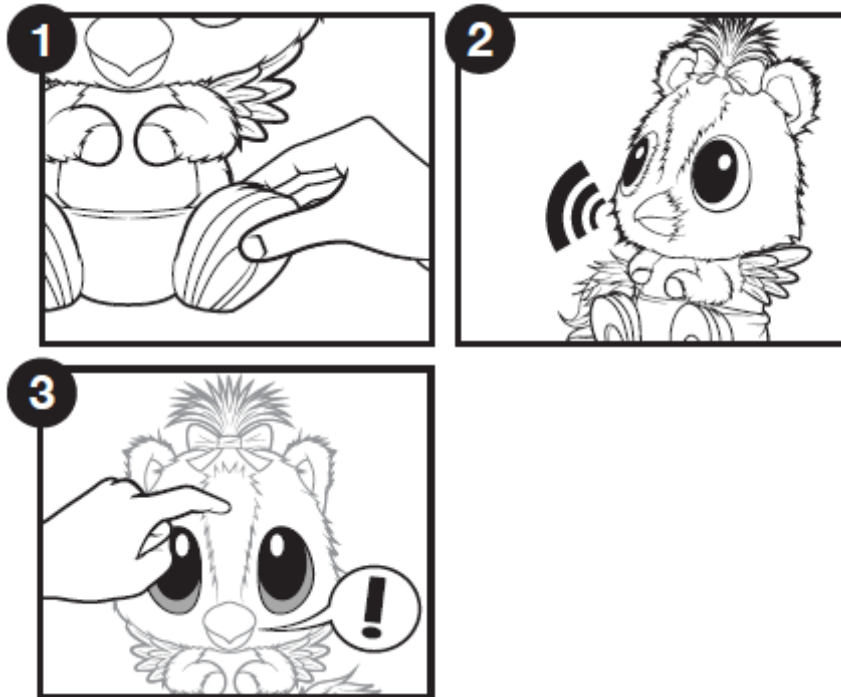

HATCHING TIME

When you see rainbow eyes, I am ready to hatch!

1. Rub the bottom of the egg to encourage me to start hatching.
2. Keep the top of the egg away from your eyes and face during the hatch.
3. If I stop and you hear tapping, tap on the egg to encourage me.
4. If I stop and you hear me panting, hold the egg to hear my heartbeat.
5. When I have finished hatching, I will sing 'Hatchy Birthday.'
6. Remove extra eggshell pieces that might block my way.
7. Now pull me out of the egg!
8. Touch one of my toes to make sure I've finished hatching.

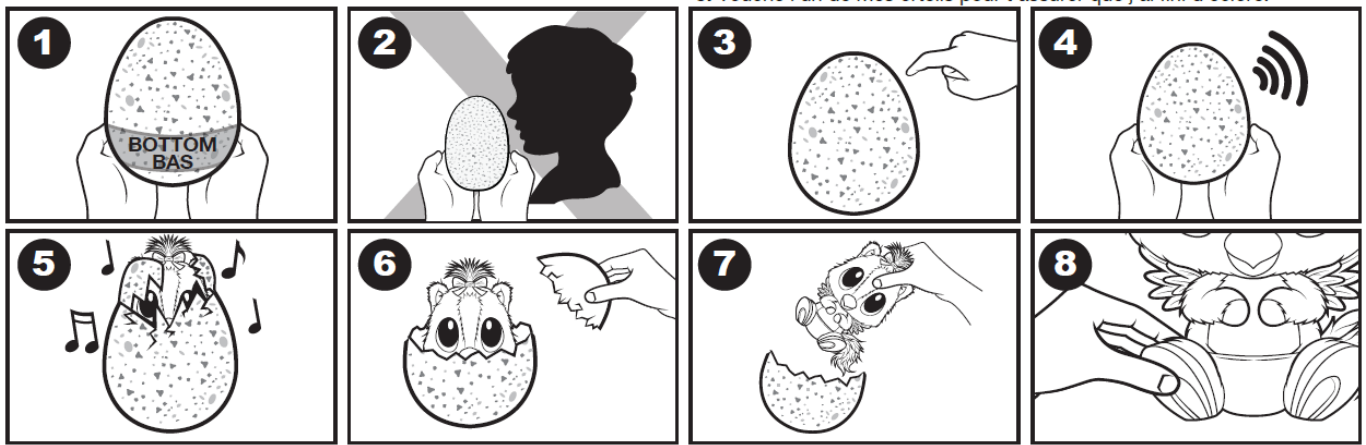

MORE WAYS TO PLAY

LEARN TO “TALK”

1. Hold both feet for 2 seconds.
2. My eyes will flash teal and I will say ‘Hello’ in my own Hatchimals language. Keep holding my feet.
3. When my eyes turn solid teal, say something for up to 4 seconds.
4. Let go of my feet and I will repeat it back to you!

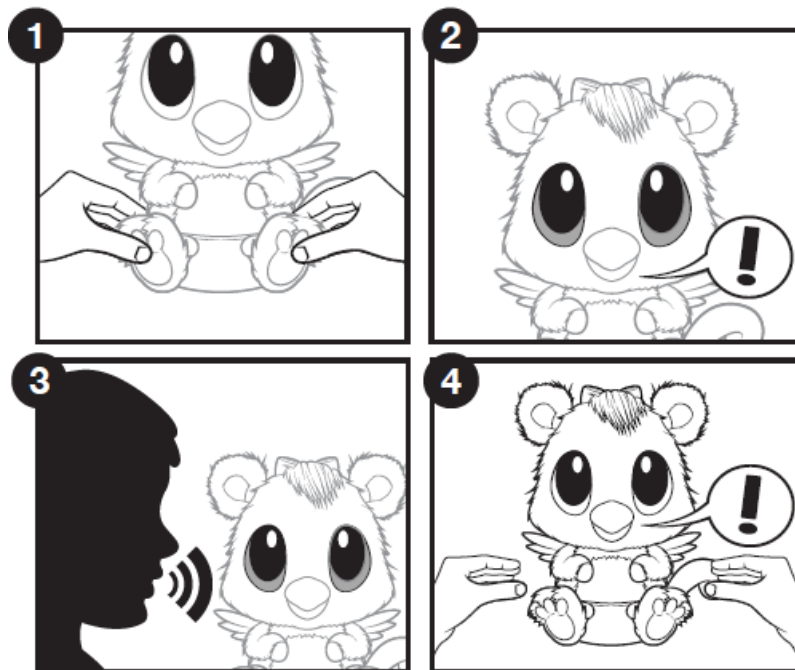

PEEK-A-BOO

1. Cover my eyes for 2 or more seconds, then pull your hand away.
2. I will say ‘Peek-a-boo’ in my own Hatchimals language.

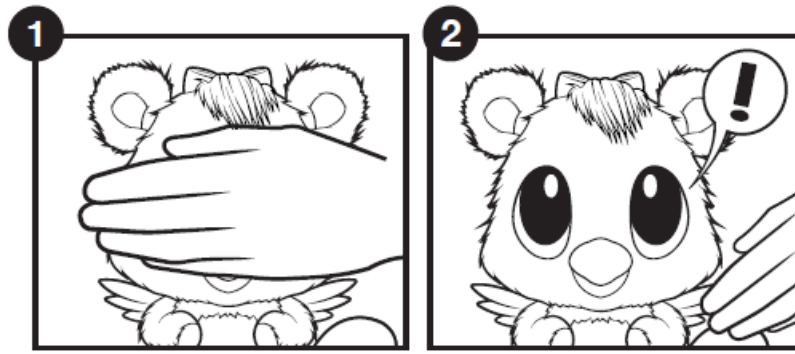

HATCHIBABY

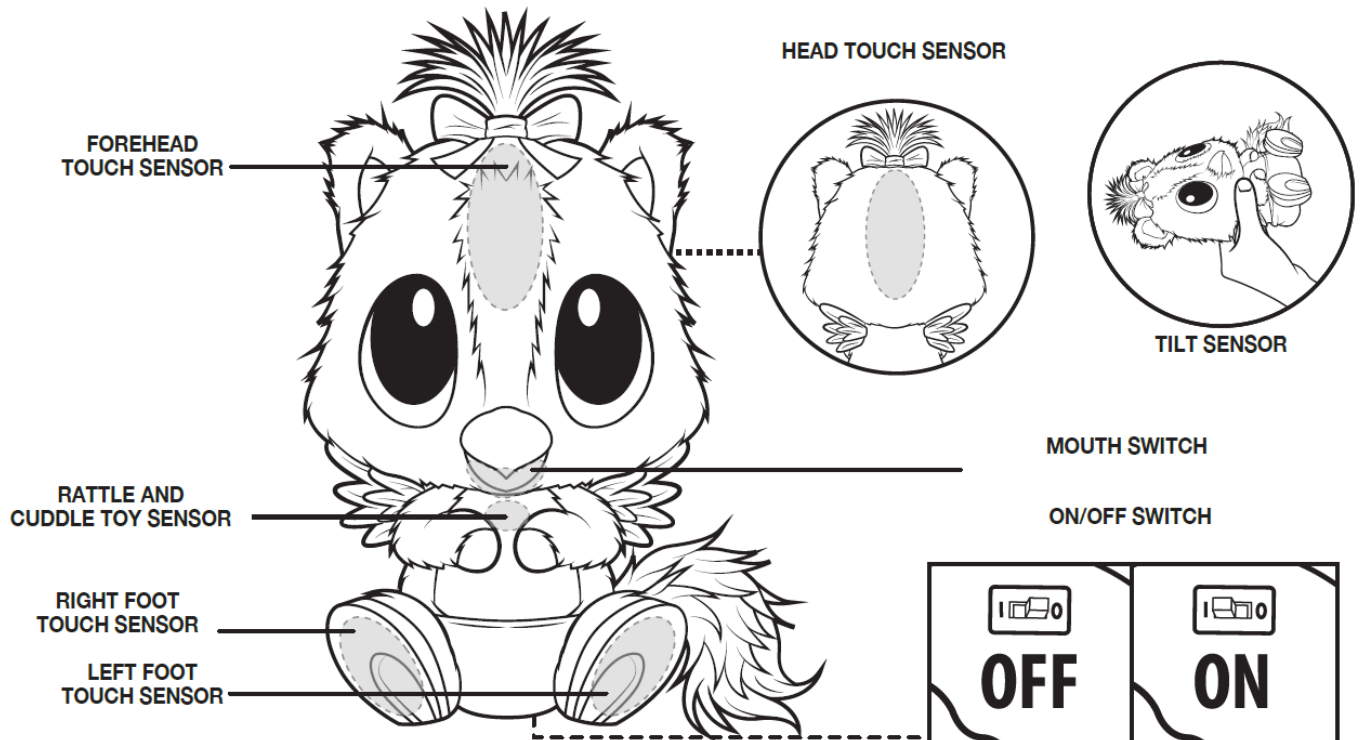

ACCESSORIES

BRUSH

- Brush my hair.

HIGHCHAIR

1. Sit me in my high chair.
2. Use it to store my accessories.

EGG BASE

1. Put me in my egg base so I can rock and play.
2. If you give me my rattle when I'm in my egg base, I'll sing a nursery rhyme!
3. When I throw a tantrum (red eyes), put me in my egg base for a time out.
4. When I'm sleepy (white eyes), put me in my egg base for a nap.

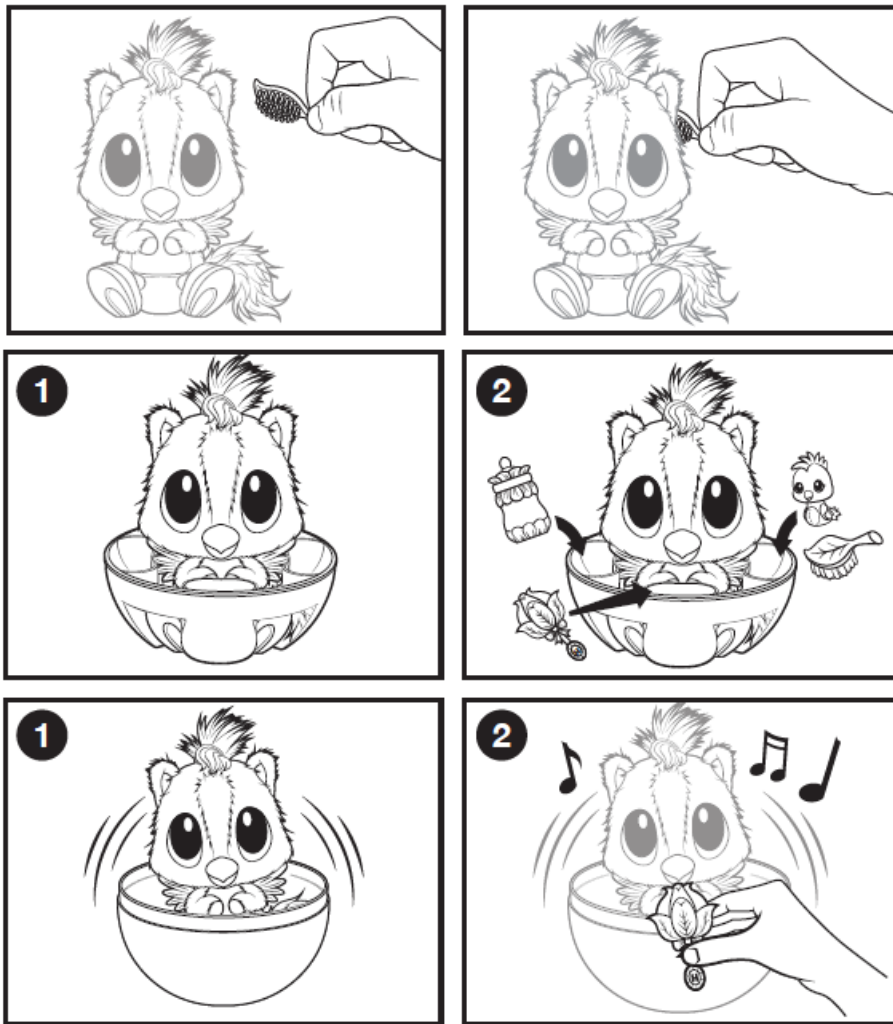

FIND THE ACCESSORIES!

- A. Once I'm out of the egg, twist the secret message post clockwise to unlock it. Then pull it out and unroll it to read about me.
- B. Peel and reveal the compartments in the egg to discover my secret accessories (bottle, rattle, cuddle buddy and hairbrush).
- C. Once you've pulled out the accessories, twist the accessory holder counterclockwise to unlock it, then pull it out. The accessory holder becomes a highchair!
- D. You can also reuse my egg base as a nest! When you put me in, make sure my wings are near the wing symbols.

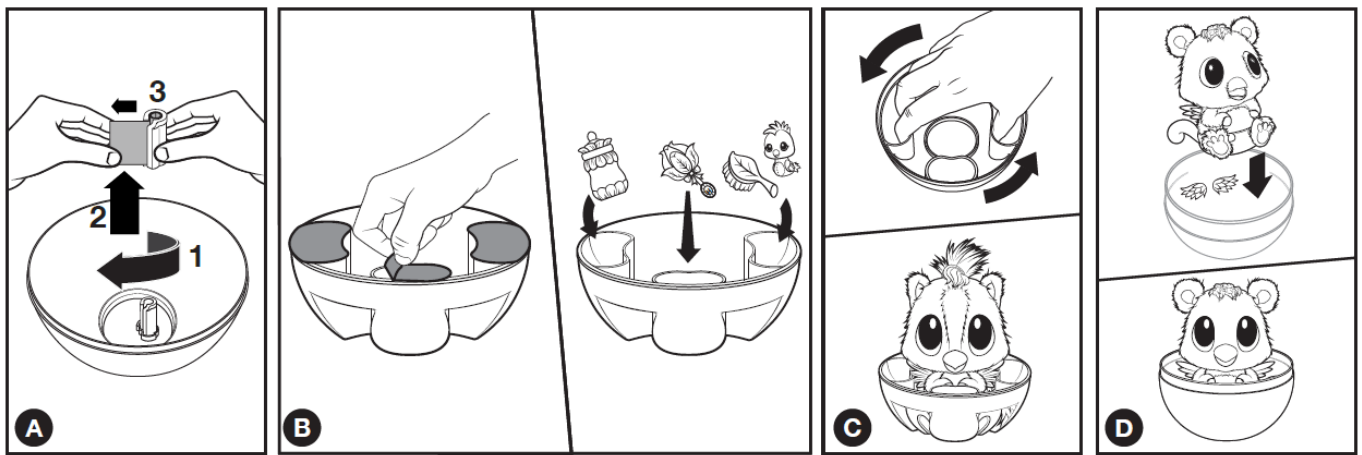

ACCESSORIES

BOTTLE

1. When I'm hungry (purple eyes), put the bottle in my mouth and press down on my lower beak to feed me. Keep pressing to keep feeding. If you feed me too much, I get gassy (orange eyes).
2. Hold me upright and pat the back of my head to burp me!

CUDDLE BUDDY

1. Hold the cuddle buddy so the 'H' is facing you. Now bring the cuddle buddy to my chest so I can talk to it.
2. If you keep holding it to my chest, I will start to fall asleep.
3. When I'm sleepy (white eyes), it will help me fall asleep.
4. You can also use my cuddle buddy to comfort me when I'm sad (blue eyes).

RATTLE

1. Hold the rattle so the 'H' is facing you. Now bring the rattle to my chest to make me dance (rainbow eyes).
2. While I'm dancing, you can tap my toes to play a drum beat.
3. Touch the back of my head to exit.

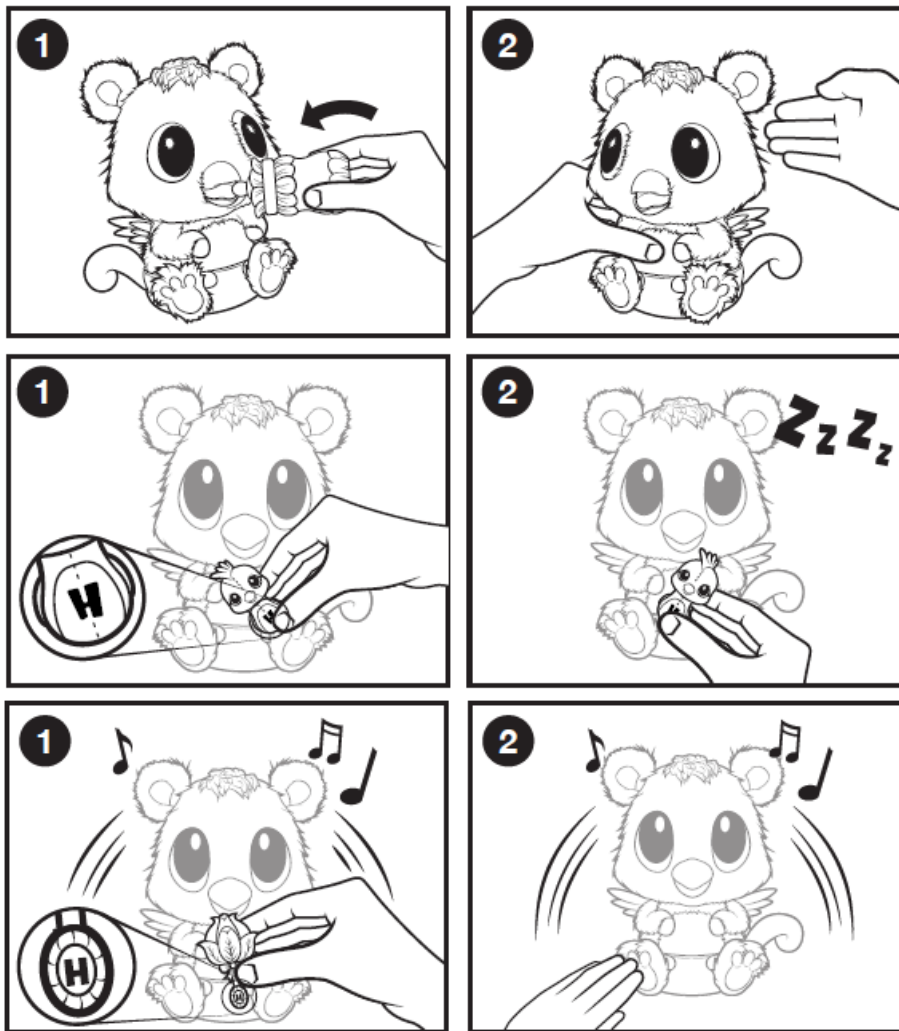

GET TO KNOW YOUR BABY!

- Pet my head
- Nuzzle my nose/forehead
- Tickle my feet (quick touches)
- Rock me to sleep
- Tilt me upside down and right side up to play

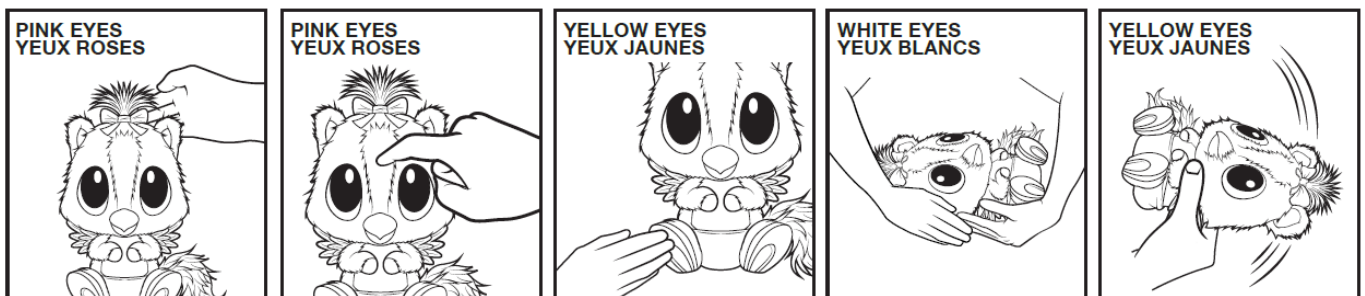

SECRET TRICK

- Each Hatchibaby species has their own secret trick. To discover mine, touch and hold the back of my head and touch my forehead sensor twice at the same time.
- If you do not interact with me for about 2 minutes, I will fall asleep. To wake me up, touch my forehead sensor.

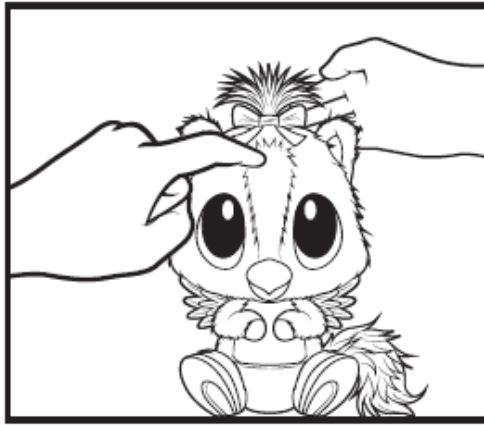

SPIN MASTER LTD., 225 KING STREET WEST, TORONTO, ON M5V 3M2 CANADA

- 1-[800-622-8339](tel:800-622-8339)
- customercare@spinmaster.com

FCC STATEMENT

This device complies with Part 15 of the FCC rules. Operation is subject to the following two conditions: (1) This device may not cause harmful interference, and (2) This device must accept any interference received, including interference that may cause undesired operation. This equipment has been tested and found to comply with the limits for Class B digital devices pursuant to Part 15 of the FCC rules. These limits are designed to provide reasonable protection against harmful interference to radio communications. This equipment generates, uses and can radiate radio frequency energy and, if not installed and used in accordance with the instruction, may cause harmful interference to radio communication. However, there is no guarantee that interference will not occur in a particular installation. If this toy does cause interference to radio or television reception (you can check this by turning the toy off and on while listening for the interference), one or more of the following measures may be useful:

- Reorient or relocate the receiving antenna
- Increase the separation between the toy and the radio or the TV
- Consult the dealer or an experienced TV-radio technician for help.

CANADIAN STATEMENT: ICES-003 statement

CAN ICES-3(B)/NMB-3(B).

NOTE: Changes, adjustments or modifications to this unit, including but not limited to, replacement of any transmitter component (crystal, semiconductor, etc.) could result in a violation of FCC rules under part 15 and/or 95 and must be expressly approved by Spin Master Ltd. or they could void the user's authority to operate the equipment. Shielded cables must be used with this unit to ensure compliance with the Class B FCC limits.

SPIN MASTER LTD., 225 KING STREET WEST, TORONTO, ON M5V 3M2 CANADA

Customer Care

- 1-[800-622-8339](tel:800-622-8339)
- customercare@spinmaster.com
- www.spinmaster.com

TM & © Spin Master Ltd. Patent pending. All rights reserved. Remove all packaging before use. Retain this information, addresses, and phone numbers for future reference. Content may vary from pictures. An adult should periodically check this toy to ensure no damage or hazards exist, if so, remove it from use. Children should be supervised during play. Spin Master reserves the right to discontinue the use of the www.hatchimals.com website at any time. Meets CPSC Safety Requirements. MADE IN CHINA.

- T.19133-0001_GBL_IS
T.19133-0001_20100206_GBL_IS_R5 T.19133-0001_20100207_GBL_IS_R5
- T.19133-0010_GBL_IS
T.19133-0010_20100206_GBL_IS_R5 T.19133-0010_20100207_GBL_IS_R5
- T.19133-0003_GBL_IS
T.19133-0003_20100210_GBL_IS_R5 T.19133-0003_20100211_GBL_IS_R5
- T.19133-0011_GBL_IS
T.19133-0011_20100210_GBL_IS_R5 T.19133-0011_20100211_GBL_IS_R5



Warning: CHOKING HAZARD – Small parts. Not for children under 3 years.

Easy-to-follow instruction videos:

[Youtube.com/hatchimals](https://www.youtube.com/hatchimals)

- **IRELAND** – 1800 992 249
- **FRANCE** – 0800 909 150, servicefr@spinmaster.com
- **AUSTRALIA** – 1800 316 982, customercare@spinmaster.com

WWW.SPINMASTER.COM

WWW.HATCHIMALS.COM

FREQUENTLY ASKED QUESTIONS

What is the Hatchimals 6044069 Interactive HatchiBabies Ponette?

The Hatchimals 6044069 Interactive HatchiBabies Ponette is a plush interactive toy that hatches from an egg, providing children with an engaging and interactive play experience.

What is the price of the Hatchimals 6044069?

The Hatchimals 6044069 Interactive HatchiBabies Ponette is priced at \$79.95, reflecting its interactive features and quality design.

What are the dimensions of the Hatchimals 6044069?

The dimensions of the Hatchimals 6044069 are 8 inches in length, 7 inches in width, and 10 inches in height, making it a manageable size for children to hold and play with.

How much does the Hatchimals 6044069 weigh?

The Hatchimals 6044069 weighs 1 pound, making it lightweight and easy for young children to handle.

What is the minimum age recommendation for the Hatchimals 6044069?

The manufacturer recommends the Hatchimals 6044069 for children aged 60 months (5 years) and older, ensuring it is suitable for young kids.

What type of batteries does the Hatchimals 6044069 require?

The Hatchimals 6044069 requires 2 AA batteries to operate its interactive features.

Are batteries included with the Hatchimals 6044069?

Typically, the batteries are not included with the Hatchimals 6044069, so you may need to purchase 2 AA batteries separately.

What interactive features does the Hatchimals 6044069 offer?

The Hatchimals 6044069 features various interactive elements, including sound responses and touch-sensitive reactions, allowing for a personalized play experience.

How does the hatching process work with the Hatchimals 6044069?

The Hatchimals 6044069 hatches from its egg when a child interacts with it, using gentle tapping and encouragement to help it emerge.

What educational benefits does the Hatchimals 6044069 provide?

The Hatchimals 6044069 encourages imaginative play, fosters emotional development, and helps enhance fine motor skills through interaction.

What makes the Hatchimals 6044069 a great gift for children?

The combination of its interactive hatching feature, cute design, and engaging sounds makes the Hatchimals 6044069 an exciting and delightful gift for young fans.

What themes does the Hatchimals 6044069 represent?

The Hatchimals 6044069 represents themes of nurturing, friendship, and discovery, allowing children to engage in imaginative play.

What kind of sounds does the Hatchimals 6044069 make?

The Hatchimals 6044069 produces a variety of sounds, including playful noises, songs, and responses to touch, enhancing the interactive experience.

How can the Hatchimals 6044069 enhance social skills in children?

The interactive nature of the Hatchimals 6044069 encourages children to share, take turns, and engage in cooperative play, fostering social interaction.

Why is my Hatchimals 6044069 Interactive HatchiBabies Ponette not hatching?

Ensure that you are rubbing the egg and interacting with it properly. If it still doesn't hatch, check the batteries to ensure they are fully charged and correctly inserted.

Why is my Hatchimals 6044069 Interactive HatchiBabies Ponette not responding to touch?

The sensors may not be detecting interaction properly. Try cleaning the surface of the egg or the toy, and replace the batteries if the HatchiBabies still don't respond.

VIDEO – PRODUCT OVERVIEW

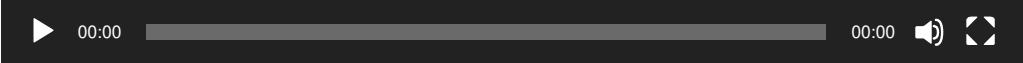

[Download the PDF link: http://downloads/2024069/HatchiBabies-6044069-Ponette-Instruction-Manual-Interactive-HatchiBabies-Ponette-Instruction-Manual.mp4](#)

References

- [User Manual](#)

[Manuals+](#), [Privacy Policy](#)

This website is an independent publication and is neither affiliated with nor endorsed by any of the trademark owners. The "Bluetooth®" word mark and logos are registered trademarks owned by Bluetooth SIG, Inc. The "Wi-Fi®" word mark and logos are registered trademarks owned by the Wi-Fi Alliance. Any use of these marks on this website does not imply any affiliation with or endorsement.