

HATCH
HBR4100
Restore-1
Smart Sound
Machine



Hatch HBR4100 Restore-1 Smart Sound Machine User Manual

[Home](#) » [Hatch](#) » Hatch HBR4100 Restore-1 Smart Sound Machine User Manual 

Contents

- [1 Hatch HBR4100 Restore-1 Smart Sound Machine](#)
- [2 How to Connect](#)
- [3 Get to know your Hatch Restore](#)
- [4 Quick Tips](#)
- [5 FCC](#)
- [6 FAQs](#)
- [7 Video-Hatch HBR4100 Restore-1 Smart Sound Machine](#)
- [8 Reference Link](#)
- [9 References](#)

HATCH

Hatch HBR4100 Restore-1 Smart Sound Machine



How to Connect

1. Step 1

Plug In Hatch Restore

Connect your power cable then plug it into your power outlet. Always keep your device plugged in.



2. Step 2

Download the Hatch Sleep App

Download the app on your phone or tablet then create an account.



3. Step 3

Complete Setup

Follow the steps in the Hatch Sleep app to connect your device. Wi-Fi is required.

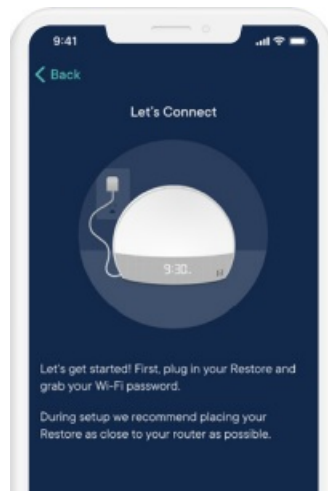

Get to know your Hatch Restore

[Hatch HBR4100 Restore-1 Smart Sound Machine User Manual](#)

Top Touch Sensor

- **Turn On:** Tap top
 - **Turn Off:** Press & hold top
- Skip:** Tap to skip through your routine steps.



Side Controls

- **Right:** Tap to increase or decrease brightness.
- **Left:** Tap to increase or decrease volume.



Quick Tips

- **Alarm**

- The dot next to the time indicates your alarm is on. Use the app or the alarm button on the bottom of Restore to turn your alarm on or off.

Wish to snooze? Tap the top of Restore for another 9 mins!

- **Clock Brightness**

Dim or turn off the clock in the app. Visit Clock Display under Settings.

FCC

FCC Caution: Any Changes or modifications not expressly approved by the party responsible for compliance could void the user's authority to operate the equipment. This device complies with part 15 of the FCC Rules. Operation is subject to the following two conditions:

1. This device may not cause harmful interference, and
2. this device must accept any interference received, including interference that may cause undesired operation.

IMPORTANT NOTE: This equipment has been tested and found to comply with the limits for a Class B digital device, under part 15 of the FCC Rules.

These limits are designed to provide reasonable protection against harmful interference in a residential installation. This equipment generates, uses, and can radiate radio frequency energy and, if not installed and used by the instructions, may cause harmful interference to radio communications. However, there is no guarantee that interference will not occur in a particular installation. If this equipment does cause harmful interference to radio or television reception, which can be determined by turning the equipment off and on, the user is encouraged to try to correct the interference by one or more of the following measures:

- Reorient or relocate the receiving antenna.
- Increase the separation between the equipment and the receiver.
- Connect the equipment to an outlet on a circuit different from that to which the receiver is connected.

- Consult the dealer or an experienced radio/TV technician for help.

FCC Radiation Exposure Statement: This equipment complies with FCC radiation exposure limits set forth for an uncontrolled environment.

ISED Warning: This device complies with Innovation, Science, and Economic Development Canada license-exempt RSS standard(s).

Operation is subject to the following two conditions:

1. this device may not cause interference, and
2. this device must accept any interference, including interference that may cause undesired operation of the device.

Need help?

Hatch support is a dream.

Contact us at support@hatch.co.



Follow @hatchforsleep and see what dreams are made of.

FAQs

What is the Hatch HBR4100 Restore-1 Smart Sound Machine?

The Hatch HBR4100 Restore-1 Smart Sound Machine is a sleep aid device that offers customizable sleep routines, combining soundscapes, light settings, and relaxation content to help improve your sleep quality.

How does the Hatch HBR4100 Restore-1 Smart Sound Machine simulate a sunrise?

The Hatch HBR4100 Restore-1 gradually increases the light intensity to mimic a natural sunrise, helping you wake up gently and in sync with your body's natural rhythm.

What sound options are available on the Hatch HBR4100 Restore-1 Smart Sound Machine?

The Hatch HBR4100 Restore-1 offers a variety of soundscapes, including white noise, nature sounds, and meditation content. Additional content can be accessed through the Hatch Sleep Membership.

What comes in the package with the Hatch HBR4100 Restore-1 Smart Sound Machine?

The Hatch HBR4100 Restore-1 package includes the sound machine, a power adapter, and a quick start guide for easy setup.

Is the Hatch HBR4100 Restore-1 Smart Sound Machine portable?

The Hatch HBR4100 Restore-1 needs to be plugged into a power outlet, making it suitable for home use rather than portable purposes.

How does the sunset feature work on the Hatch HBR4100 Restore-1 Smart Sound Machine?

The Hatch HBR4100 Restore-1 simulates a sunset by gradually dimming the light, creating a calming environment that signals your body it's time to sleep.

What kind of warranty comes with the Hatch HBR4100 Restore-1 Smart Sound Machine?

The Hatch HBR4100 Restore-1 typically comes with a limited warranty that covers manufacturing defects, but the specifics can vary, so it's best to check the warranty details provided by the seller.

What is the Hatch Sleep Membership for the Hatch HBR4100 Restore-1 Smart Sound Machine?

The Hatch Sleep Membership for the Hatch HBR4100 Restore-1 is a subscription service that provides access to an expanded library of soundscapes, sleep stories, meditations, and other exclusive content.

How does the Hatch HBR4100 Restore-1 Smart Sound Machine help with sleep?

The Hatch HBR4100 Restore-1 helps improve sleep by offering features like calming sounds, a sunrise alarm, and a customizable sleep routine that promotes relaxation and a consistent bedtime.

What colors does the Hatch HBR4100 Restore-1 Smart Sound Machine offer for the reading light?

The Hatch HBR4100 Restore-1 allows you to choose from various warm and soft light colors, all of which can be customized to your preference for reading or relaxation.

What type of power source does the Hatch HBR4100 Restore-1 Smart Sound Machine use?

The Hatch HBR4100 Restore-1 uses a corded electric power source and must remain plugged into an outlet for continuous operation.

Video-Hatch HBR4100 Restore-1 Smart Sound Machine

Reference Link

[Hatch HBR4100 Restore-1 Smart Sound Machine User Manual-Device. report](#)

References

- [User Manual](#)

[Manuals+](#), [Privacy Policy](#)

This website is an independent publication and is neither affiliated with nor endorsed by any of the trademark owners. The "Bluetooth®" word mark and logos are registered trademarks owned by Bluetooth SIG, Inc. The "Wi-Fi®" word mark and logos are registered trademarks owned by the Wi-Fi Alliance. Any use of these marks on this website does not imply any affiliation with or endorsement.